

IEC 60320 C13 to NBR 14136

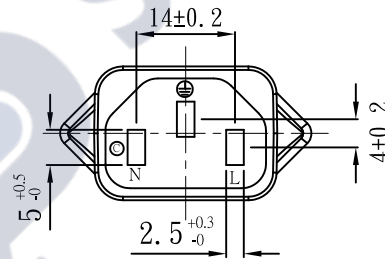
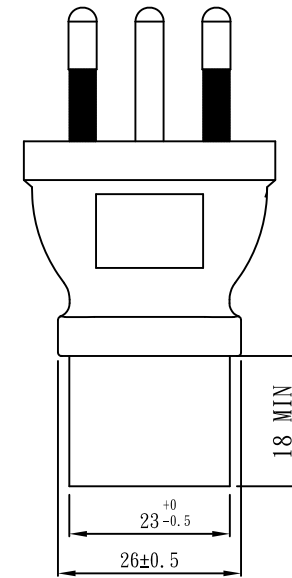
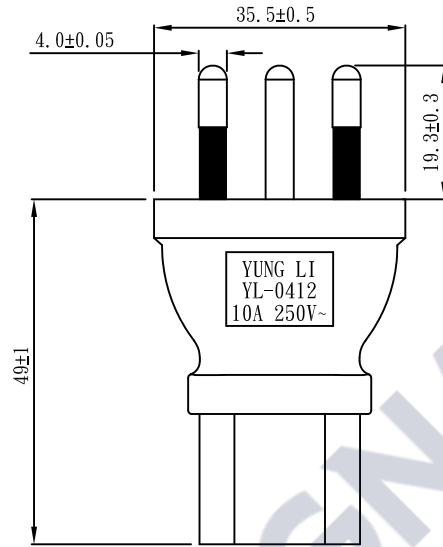
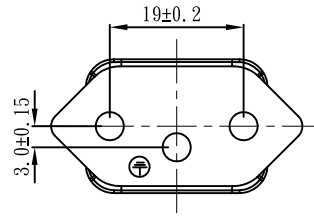

Note:

- 1.Rating:10A 250V
- 2.Insulation Resistance:100MΩ
- 3.Dielectric Voltage:2000V/sec

TOLERANCE >0±0.30 >1.0±0.50 >10.0±1.0 >20.0±2.0 Angle: ±1°	APPROVED		DATE		YUNG LI CO., LTD.				
	CHECKED		DATE						
	DRAWN		DATE		CUSTOMER				
	TYPE	YL-0412				P/N			
						MATERIAL	P. V. C	UNIT	mm
	DRAWING NO.	CY-A0412	REV	B	SCALE	1:1			