

MARKING: YP-61A YUNG-LI  $\frac{3}{250}$  BS1363/A    APPR. BY ASTA LIC 1359   SASO 2203 MS 589/A 

REV	DATE	DRAWN	Description
C	2019.01.23	SUKI	YP-61 changed YP-61A.
D	2021.03.29	SUKI	Add UKCA of receptacle.

UK CA CE  10  N18720

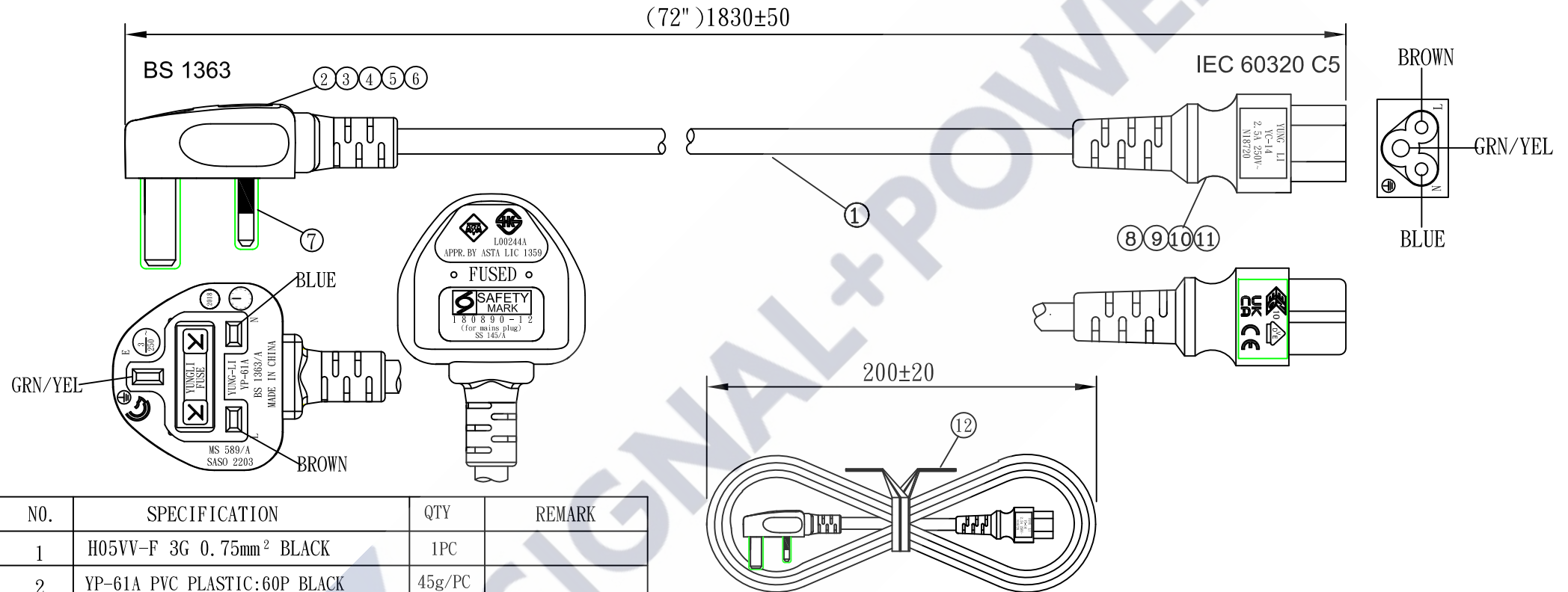

NO.	SPECIFICATION	QTY	REMARK
1	H05VV-F 3G 0.75mm <sup>2</sup> BLACK	1PC	
2	YP-61A PVC PLASTIC:60P BLACK	45g/PC	
3	FRAME: BLACK	1PC	
4	FUSE LID	1PC	
5	FRAME LID	1PC	
6	FUSE:3A	1PC	
7	SLEEVE WHITE	1PC	
8	YC-14 H. S. G	1PC	
9	TER:98732PS-0	1PC	
10	TER:98714PS-0	2PCS	
11	YC-14 PVC PLASTIC:50P BLACK	18g/PC	
12	MINI TIE:L=130mm BLACK	1PC	

TOLERANCE >0±0.30 >1.0±0.50 >10.0±1.0 >20.0±2.0 Angle: ±1°	APPROVED		DATE		SIGNAL+POWER			
	CHECKED		DATE					
	DRAWN	SUKI	DATE	21.03.29	CUSTOMER			
	TYPE	YP-61A/YC-14			P/N	P-06BM-UK		
	DRAWING NO.	CY-B0590-01	REV	D	MATERIAL	P. V. C	UNIT	mm
				SCALE		