



VOLTA

USER MANUAL

www.sunslice-solar.com

I. INTRODUCTION

Thank you for your purchase. We hope you will have a great experience using the Sunslice Volta.

The Volta was designed in Belgium by two young engineers whose ultimate goal was to create a practical and elegant wallet which could provide a charging solution for our daily life.

This manual contains important safety and product care information, as well as step-by-step instructions for using your Volta. To get the greatest benefit from your purchase, we recommend you read the manual thoroughly, and keep it in a safe place in case you need to refer to it later. In case you face any issue with your product, please contact us directly at service@sunslice-solar.com.

At the end of this manual, you will find information about other products created and offered by Sunslice. You can also find them on our website www.sunslice-solar.com.

IN THE BOX :

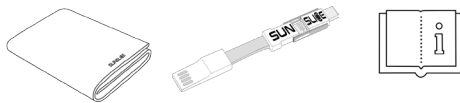

COMPATIBLE WITH :



II. PRODUCT OVERVIEW

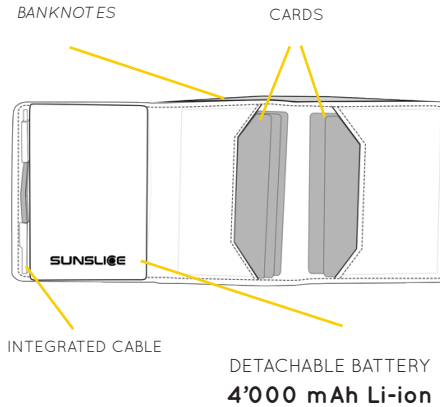

BATTERY INTERFACE

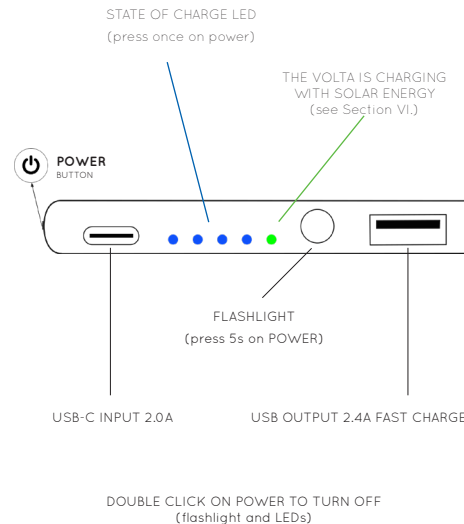

III. SPECIFICATIONS

Battery Capacity	4'000 mAh Li-ion
Battery Input	5V/2.0A - USB-C
Battery Output	5V/2.4A - USB
Dimensions Volta	100x80x19mm
Weight	150 g

IV. CHARGING THE VOLTA

VIA WALL OUTLET

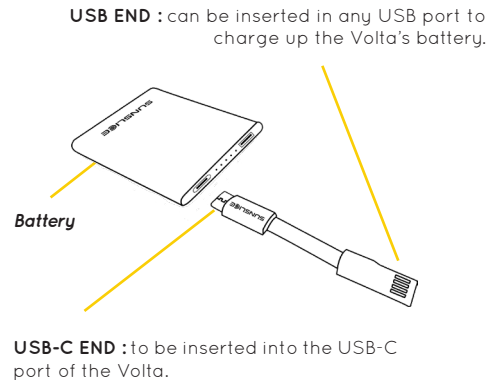

We recommend charging the Volta fully before the first use.

V.

CHARGING YOUR DEVICE

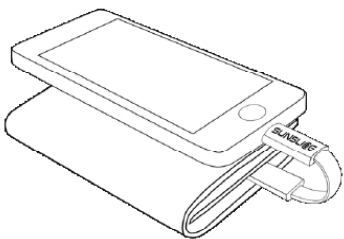

Connect the Volta to your mobile device with the universal USB cable provided. Choose the right output as described below. The blue LED indicators confirm that the device is charging.

 The 4'000 mAh battery can charge a smartphone in around 1 hour.

CHOOSE THE RIGHT CABLE OUTPUT

The universal cable provided with the Volta is constituted of 3 different outputs. You can therefore charge the majority of your devices with this single cable.

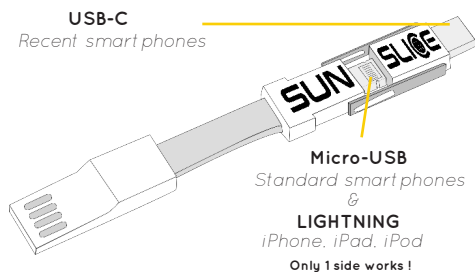

VI.

THE SUNSLICE PORTFOLIO

Our ultimate mission is to provide "Energy Anywhere". We are continuously working to develop new ideas and products to give you access to energy, anytime, anywhere. The Volta's battery is detachable, and compatible with our range of products by combining it with the other extensions.

Discover them on:
www.sunslice-solar.com

PHOTON

BACKPACKING EXCELLENCE

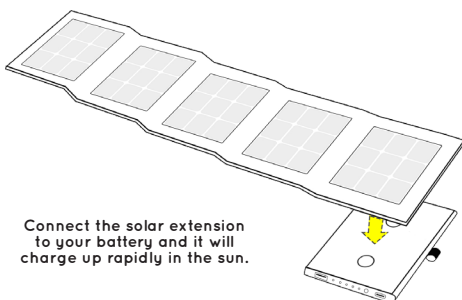

PHOTON LIGHT

THE SOLAR CARD

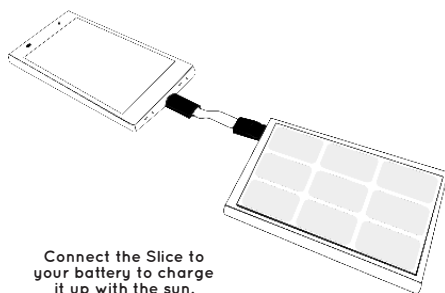

VII.

OUR WARRANTY

PREMIUM QUALITY

We select the finest materials to insure a high quality and durability for all of our products.

PROTECTION CIRCUIT

The Volta is equipped with a charging and discharging protection circuit to avoid damaging your devices.

2 YEAR WARRANTY

The Sunslice Volta has a 2 year warranty. In case something goes wrong, contact us by email at service@sunslice-solar.com

PLEASE CONTACT US DIRECTLY



VIII.

PRECAUTIONS

- Keep the magnets integrated in the Sunslice Volta away from a phone and any other electronic device.
- Do not leave the Sunslice Volta out in the rain, keep away from water. Do not expose the battery of the Volta to fire or excessive heat.
- Do not short-circuit the battery with lead or any metal objects.
- Do not use excessive force when plugging or removing cables. Do not twist the charging cable excessively.
- Keep the battery ports free from dust, lint, etc that may prevent proper connections.
- Do not disassemble the charger or change its structure in any way.
- Stop using the Sunslice Volta if it generates unusual smell, heating, distortion or any other abnormality.

- Keep away from children.

You are welcome on our website
www.sunslice-solar.com
to learn more about our products!

Henri & Geoffroy

www.sunslice-solar.com

Sunslice SPRL
Chemin du Cyclotron 6,
1348 Louvain-la-Neuve, Belgium