

FUSION

USER MANUAL

www.sunslice-solar.com

I. INTRODUCTION

Thank you for your purchase. We hope you will have a great experience using the Sunslice Fusion.

The Fusion has been developed by Sunslice, a Belgian company created by 2 young engineers, with the ultimate goal to give people access to energy everywhere. This solar charger, with an ideal solar charging speed for travellers is extremely practical and can be carried with you everywhere to make you enjoy the sun twice.

This manual contains important safety and product care information, as well as step-by-step instructions for using your Fusion. To get the greatest benefit from your purchase, we recommend you read the manual thoroughly, and keep it in a safe place in case you need to refer to it later.

Geoffroy & Henri

IN THE BOX



COMPATIBLE WITH



KEY FEATURES

- OPTIMISED DESIGN
- RESISTANT TEXTILE
- LIGHT, THIN AND ULTRA-PORTABLE
- SHOCK-RESISTANT
- HIGH EFFICIENCY SOLAR CELLS
- WATER-RESISTANT
- 7 WATTS SOLAR POWER
- 4'000 mAh BATTERY*
*optional
- HIGH EFFICIENCY BATTERY*
*optional
- OVERCHARGING CIRCUIT

II. PRODUCT OVERVIEW

ULTRA EFFICIENT SOLAR CELLS
7.0 WATTS

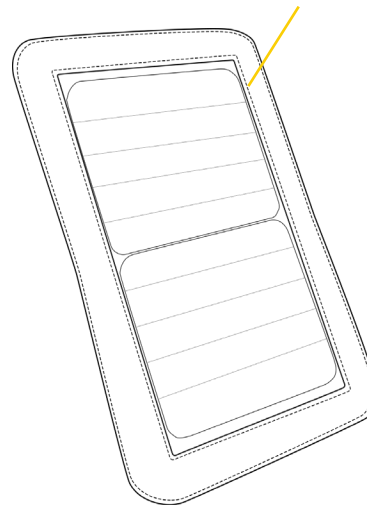

BATTERY INTERFACE*

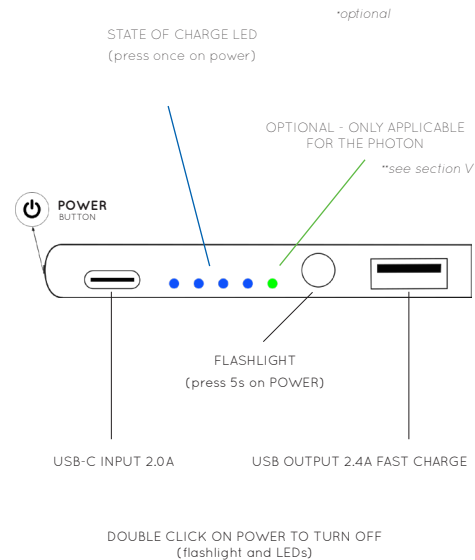

III. SPECIFICATIONS

BATTERY CAPACITY	4'000 mAh Li-ion
SOLAR POWER	7.0 Watts
BATTERY INPUT	5V/2.0A - USB-C
BATTERY OUTPUT	5V/2.4A - USB
FUSION DIMENSIONS	270x170x2mm
WEIGHT	170 g

IV. FIRST USE

FIRST USE

The Fusion charges with the energy of the sun.

Connect your device to the Fusion at its back-side with a USB-cable. Put the Fusion in the sun and it will start charging.

The connected device should ideally be an external battery. Connecting your phone to the Fusion directly is also possible but will reduce its performances.

CHARGING THE FUSION

IN A WALL PLUG*

*optional

USB END : can be inserted in any USB port to charge up the Fusion's battery.

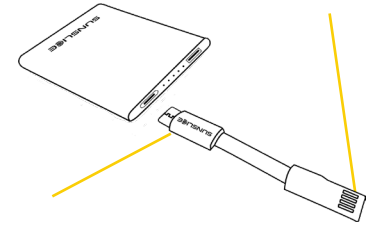

USB-C END : to be inserted into the USB-C port of the Fusion

IN THE SUN



Put the Fusion in the sun and the connected device will start charging automatically.

NB : in case there is not enough sun, your device could deny access to the charging of the Fusion. We highly encourage to charge an external battery with the Fusion first and to use this battery afterwards to charge your device.



CHARGING YOUR DEVICE

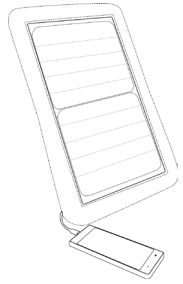

Connect the Fusion or the external battery to your device with an adapted USB-Cable. In the case you ordered a 3-in-1 cable on our website, choose the right output as described hereunder.

 The Fusion will produce enough energy in around 3h to fully charge a phone (depending on the phone).

CHOOSE THE RIGHT OUTPUT

The universal Sunslice 3-in-1 cable available on our website can charge all types of phones thanks to its 3 USB-outputs. Please note that iPhones can only be charged with one side of the cable. If it doesn't charge your phone, turn the cable around and try again.

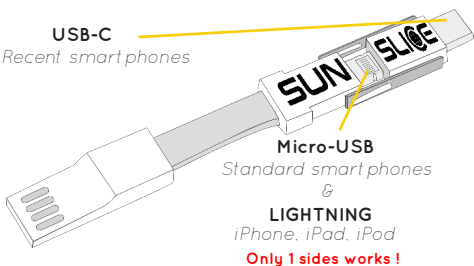

VI. THE SUNSLICE PORTFOLIO

A lot of different charges are available on our website, in order to give you an ideal solution to any situation.

Visit our website to discover our products :

www.sunslice-solar.com

PHOTON

SMALL AND ULTRA-EFFICIENT
(The size of a wallet)

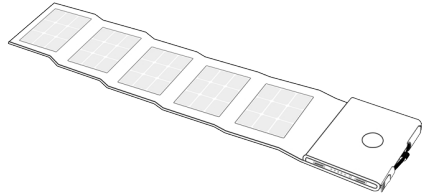

The Photon is the smallest solar charger in the world. It has an optimised integrated battery as well as super efficient solar cells and can charge a phone in only 3h with the only power of the sun.

VOLTA

ENERGY IN YOUR WALLET
(The first wallet that can charge your phone)

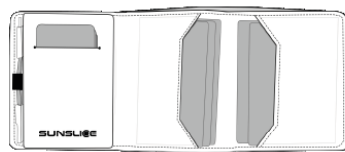

The Volta is a genuine leather wallet that integrates a detachable power-bank as well as the Sunslice 3-in-1 cable and makes you able to charge your phone anywhere and at any time.

It includes also RFID technology to protect your cards against data-theft.

VII. INCREASE THE SUNSLICE EXPERIENCE

Here are some recommendations for an optimal experience.

- Incline the Fusion in the right direction to receive as much sunlight as possible. It is best to place the panels perpendicular to the Sun in order to maximize performances.

- Choose a well illuminated spot, don't shade any of the panels and try to expose them to the same light. Placing the panels behind a window reduces the solar performance.

- Placing and carrying the Fusion on a backpack is a practical way to charge it on the move. However, the Fusion charges best when it is left static and well exposed.

- Different phone models and devices (e.g. for smartphones : One Plus, Iphone, Huawei, etc) react differently to charging depending on their own electronic characteristics. Charging time and performance can thus vary accordingly.

VIII. OUR WARRANTIES

PREMIUM QUALITY

We select the finest materials to insure a high quality and durability for all of our products.

PROTECTION CIRCUIT

The Fusion is equipped with a charging and discharging protection circuit to avoid damaging your devices.

HIGH EFFICIENCY SOLAR CELLS

The Fusion is equipped with highly efficient, ultra-thin SunPower® solar panels. They are among the best panels available on the market, supplying more energy from a smaller surface area than cheaper solar panels.

2 YEARS WARRANTY

The Sunslice Fusion has a 2 year warranty. In case something goes wrong, please contact us directly by email at : service@sunslice-solar.com

PLEASE CONTACT US DIRECTLY



IX. PRECAUTIONS

- Keep the magnets integrated in the Sunslice Fusion away from a phone and any other electronic device.

- Do not puncture, throw, drop, bend or modify your Sunslice Fusion. Do not crack the solar panels.

- Do not leave the Sunslice Fusion out in the rain, keep away from water. Do not expose the battery of the Fusion to fire or excessive heat.

- Do not short-circuit the optional battery with lead or any metal objects.

- Do not use excessive force when plugging or removing cables. Do not twist the charging cable excessively.

- Do not disassemble the charger or change its structure in any way.

- Stop using the Sunslice Fusion if it generates unusual smell, heating, distortion or any other abnormality.

- Keep away from children.

You are mostly welcome on our website to learn more about our products !

www.sunslice-solar.com

Sunslice SPRL
Chemin du Cyclotron 6,
1348 Louvain-la-Neuve, Belgium