



RangeCam

USER GUIDE

What You'll Need:

- Camera
- Smart Phone/Computer
- Credit Card
- IMEI and SIM (Preinstalled) numbers
- SD Memory Card

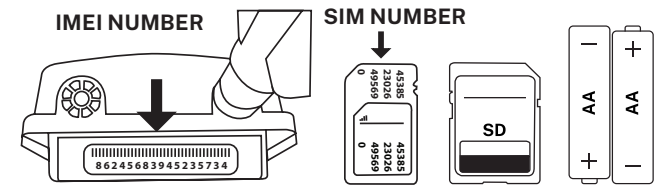

1. Charge Your Solar Panel:

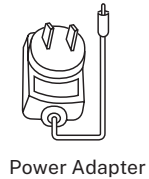

Power Adapter

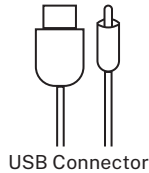

USB Connector

Premium & Mega Solar Panels:

1. Charge for 8-10 hours with power adapter or USB connector via 5V IN Port.
2. Then connect Solar Panel to Camera via 12V OUT Port.

Standard Solar Panels:

1. Charge for 8-10 hours with power adapter or USB connector via 12V IN Port.
2. Then connect Solar Panel to Camera via 12V OUT Port.

Premium & Mega Solar Panels:

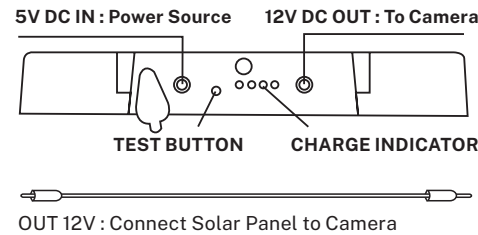

Standard Panels:

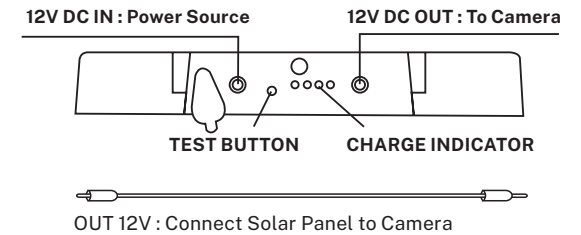

2. Create Account | Activate Camera

Quick Setup:

1. Scan the camera QR Code with your smartphone camera app.
2. Click the link that appears in your camera app to register your account and automatically add your camera's IMEI and SIM.
3. The SIM card is preinstalled in your camera. It is the white chip that is plugged into the left of the camera display.
4. Enter your billing details.

Pro Tip:

Not all cameras are equipped with QR codes for activation like the one show below. Check the front of the box or inside the enclosure door.



(EXAMPLE ONLY)

If your camera does not have a QR code, you must follow the Manual Setup process.

Manual Setup:

1. Unlatch and Open Camera.
2. Identify IMEI/SIM Numbers.
3. Register: Type **app.barnowl.tech** in your web browser or scan the QR code found on your camera box.
4. Type in the IMEI/SIM numbers.
5. Insert SIM and press until it clicks into place.
6. Enter your Billing Details.

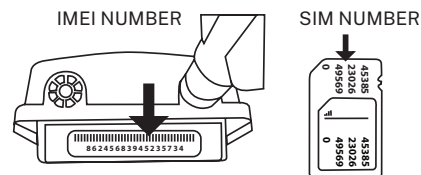

3: Test & Deploy

Steps:

1. Attach Antenna(s).
2. Insert SD Card and AA Batteries.
3. Send a **Test Photo** and set Toggle Switch to "ON".
4. Deploy.

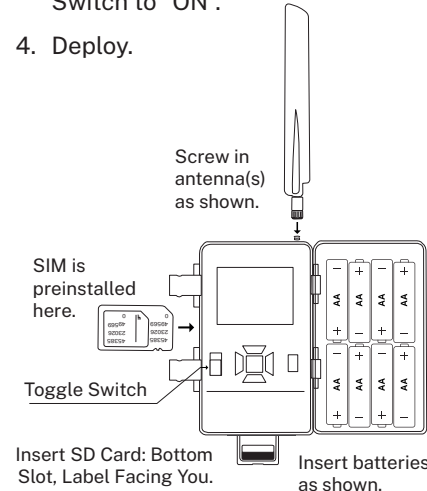

Test Photo: Steps

We recommend taking a Test Photo to make sure your camera is transmitting before leaving your site.

1. Set Toggle Switch to "Setup".
2. Wait for "Searching" message to disappear from camera display.
3. Press OK button to send Test Photo.

"Send FTP" will show up on the display, followed by "Send Succeed". This confirms that your camera is receiving signal and transmitting directly to your Barn Owl HQ Account.

4. Set Toggle Switch to the "ON" position.

Your camera is ready to transmit and camera settings can be updated in your Barn Owl HQ account by typing **app.barnowl.tech** in your web browser.

Note:

When camera is switched ON, the camera display will shut off.



Barn Owl HQ

USER GUIDE

Barn Owl: Camera Settings

Trigger Settings:

Your camera settings determine how and when photos are taken. Click the 3 dots ●●● on your camera to update settings—pictured on the right. Barn Owl cameras can capture images via motion, periodically, or on-demand. For the best experience, we recommend updating settings via Barn Owl HQ and not on the camera body.

Types of Triggers:

- **Motion Trigger:**
When “ON”, camera automatically triggers on motion.
- **Trigger Delay:**
Time delay between motion-triggers.
Displayed as: HH:MM:SS
- **Periodic Trigger:**
Time delay between automatically-recurring triggers, regardless of motion.
Displayed as: HH:MM
- **Trigger Window:**
Time window where the camera will operate, according to the camera's clock.
Displayed as: HH:MM-HH:MM

Example:

You want 3 scheduled images per day at 8am, 12pm, and 4pm.

Example Settings:

1. Set Your Periodic Trigger to: 04:00.
 - The camera will trigger every 4 hours.
2. Turn Trigger Window to ON and set for: 08:00-16:00.
 - The camera will trigger between 8am and 4pm.

Pro Tip:

Increase your image quality with the “Photo Size” option in the app.

Note: Higher quality images use more data.

Pro-Tip:

To avoid false motion triggers, make sure to minimize the amount of unnecessary moving objects, like tree branches, directly in front of the camera lens.

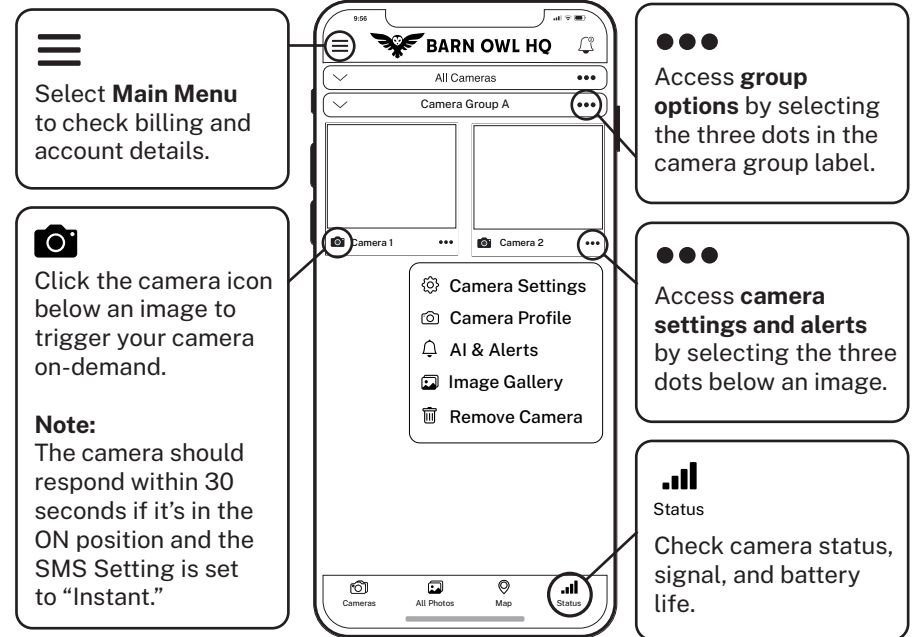

Help Guide:

Visit: BarnOwl.Tech/FAQ for a full list of common questions and instructions.

Visit: Help.BarnOwl.Tech for instructions on Barn Owl HQ, camera hardware, and troubleshooting tips.

Warranty & Returns

We offer a 45-Day return policy. If you are not satisfied with your camera, contact support for a full refund. The Limited Warranty covers Camera and Solar Panel defects in material or workmanship under normal use during the Warranty Period of 2 years from date of purchase.

Barn Owl Care

For a small monthly fee per camera, Barn Owl will provide a lifetime warranty for theft and accidental damage. For more information on Barn Owl Care, please see the Billing tab under Main Menu > Account and Billing or contact us directly.

Contact Info

Sales: (720) 594-5533

shop@barnowl.tech

Support: (720) 594-3649

support@barnowl.tech