



SecuFIRST

DID701 S / B / BB
Wi-Fi doorbell with wireless bell

Big Manual



This big manual would help you through all the possible questions you might have during the use of the camera. Below is the overview of the topics within:

- | | |
|---|---------|
| 1. Product Overview | P03~P08 |
| 2. How to Install | P09~P17 |
| 3. Preparation Before Setup on Smart Device | P18~P19 |
| 4. Camera Setup on Smart Device | P20~P28 |
| 5. Add Second Smartphone/Tab | P29~P31 |
| 6. Notification Setting | P32~P35 |
| 7. Advance settings | P36~P68 |
| 8. Connect Wired Internet | P69~P74 |
| 9. Record motion detection | P75~P82 |
| 10. Playback recording | P83~P88 |
| 11. Connect a wireless chime | P89~P93 |



The background of the slide is a detailed architectural floor plan of a building. The drawing is rendered in a light gray color and shows various rooms, corridors, and structural elements. A prominent feature is a large, circular room in the lower-left quadrant. The overall layout is complex, with many lines and shapes representing the building's footprint and internal divisions.

Product Overview

Product Overview – Wi-Fi Doorbell

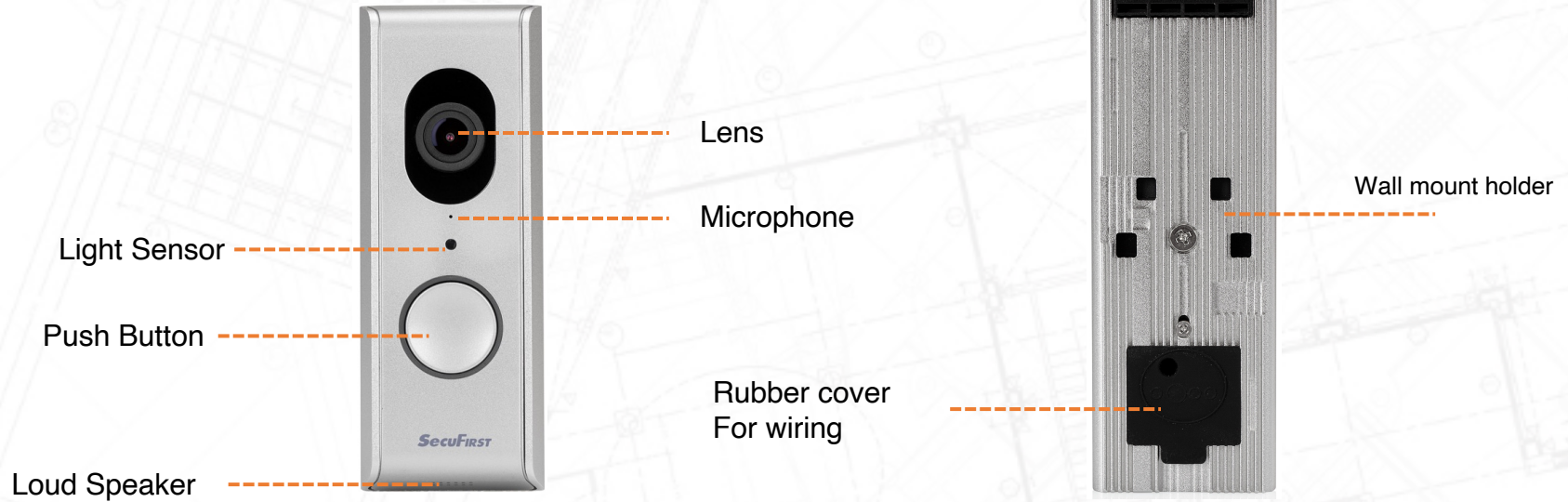

Product Overview – Wi-Fi Doorbell

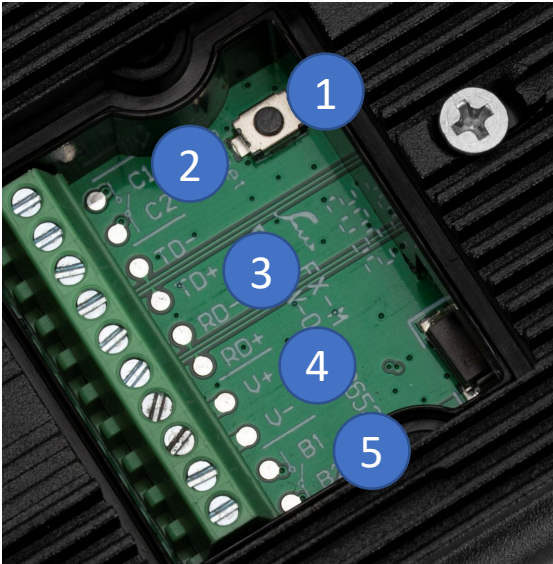

1. Reset button (Hold for 10 seconds)
2. Connection Wired Chime indoor (C1, C2 / 0V) It's only possible to connect a Mechanical Chime which is powered by an 8V AC transformer. The separate power supply is AC, so it doesn't matter which wire goes to C1 and C2.
3. RJ45 internet cable connection (TD-, TD+, RD-, RD+) Note, an internet cable has 8 wires. We only need 4 wires to connect to the Wi-Fi Doorbell.

TD- = Internet cable, Orange color wire

TD+ = Internet cable, Orange / White color wire.

RD- = Internet cable, Green color wire.

RD+ = Internet cable, Green / White color wire.

Note, wired internet only works when you firstly connect the internet cable to the Wi-Fi Doorbell and router. After that, insert the adapter in the socket.

Product Overview – Wi-Fi Doorbell

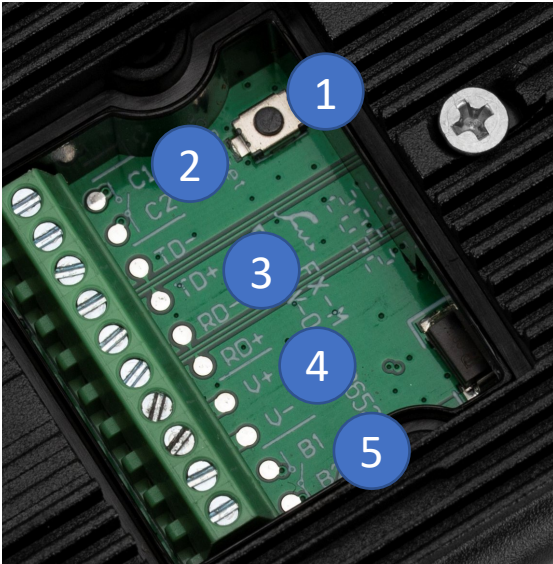

4. Adapter connection (V+, V- / 12V 1A)
V+ = Red Wire V- = Black wire
Note, pay attention to connect correctly!!!
5. Connection for electrical lock (B1 + B2 / 0V).

Product Overview – Wireless Bell



Loud Speaker



Volume Settings

No function when
bundle using with Wi-
Fi Doorbell

No function when
bundle using with Wi-
Fi Doorbell

Product Overview – APP



The camera comes with free to download app called “SecuFirst HD Professional Edition”

You could scan below QR code to download the app.



Android Phone
Scan Here



iOS Phone
Scan Here

The background of the slide is a detailed architectural floor plan of a building. It features a complex network of lines representing walls, corridors, and structural elements. There are numerous small circles scattered across the plan, likely representing doors, windows, or specific installation points. The drawing is rendered in a light, faded style, serving as a technical backdrop for the text.

How to install

How to install

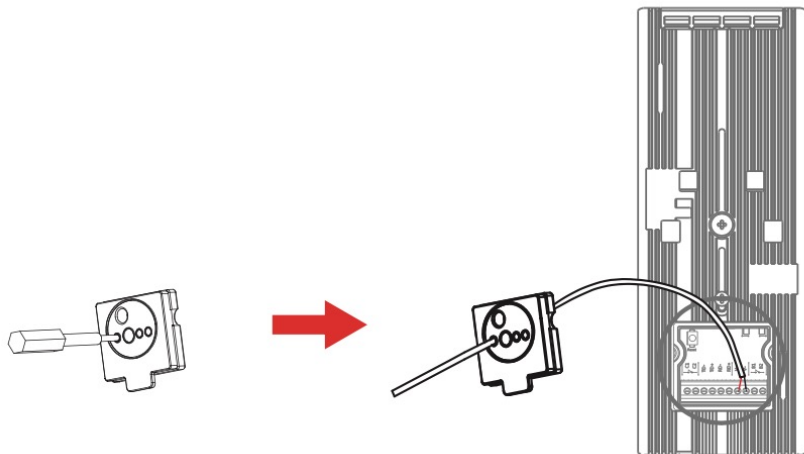

Remove the rubber cover on the backside of the Wi-Fi Doorbell.

Connect the adapter with the extension cord. Use the screwdriver to punch a hole into the rubber cover. Insert the extension cord through the rubber cover.

Connect the extension cord to the Wi-Fi Doorbell (V+ red wire, V- black wire). After that, insert the adapter into the power socket.

Close the rubber cover again.
Note, don't connect an internet cable during the installation.

See below pages for connection diagram

How to install

DID701 Connected with the DC Adapter



DID701

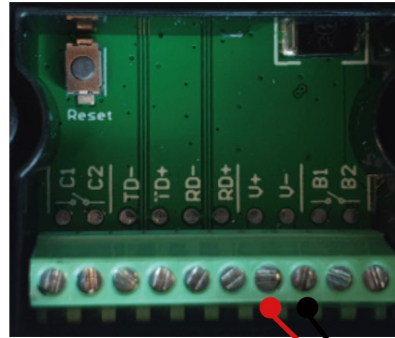

V+ = Red WIRE

V- = Black WIRE



DC Adapter

How to install

DID701 Connected with Wired Chime (Optional)



DID701

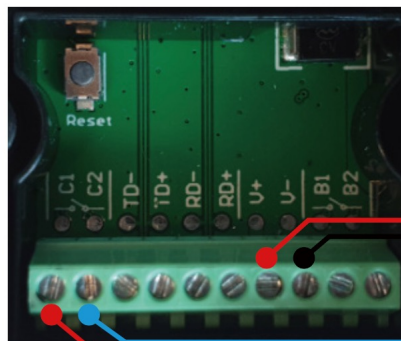

2 wires old doorpush
Contact C1 / C2



V+ V-

DC Adapter



8V 230V AC
Transformer



Mechanical
Chime

How to install

DID701 Connected with OUR Internet Connector (Optional)

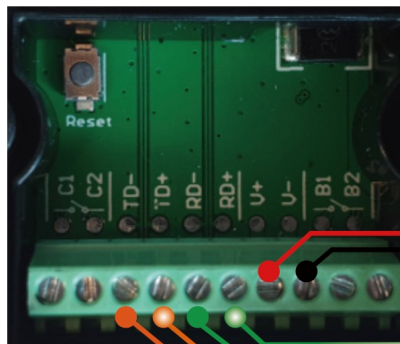

V+ V-
DC Adapter

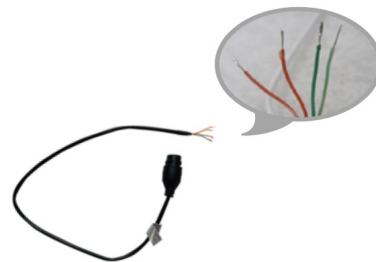

Connection with the
RJ45 plug in the box
ORANGE/WHITE TO TD+
ORANGE TO TD-
GREEN/WHITE TO RD+
GREEN TO RD-

Contact TD+ / TD- /
RD+ / RD-

Rj45 cable

DID701

How to install

DID701 Connected Directly with Standard Internet Cable (Optional)



DID701

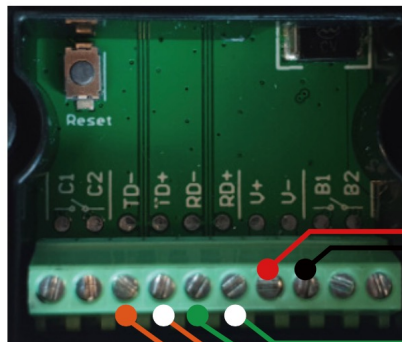

Contact TD+ / TD- /
RD+ / RD-



V+ V-
DC Adapter

Connection with your own RJ45 cable

- TD + = Ethernet cable, Orange / White color wire.
- TD - = Ethernet cable, Orange color wire.
- RD + = Ethernet cable, Green / White color wire.
- RD - = Ethernet cable, Green color wire.



Rj45 cable

How to install

DID701 Connected with Electrical Lock (Optional)

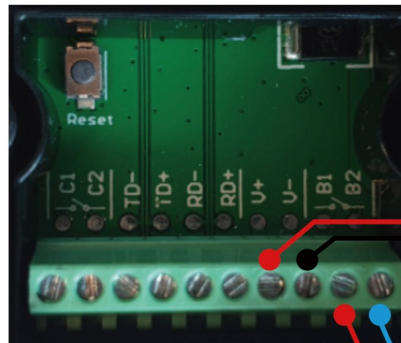

V+ V-

DC Adapter



Electronic lock



Power supply to the lock

DID701

Contact B1 / B2

How to exchange SD Card

Pre installed 16GB micro sd card. If you want to exchange to a bigger micro sd card, follow the below steps.

1. Please remove the screws and rubber cover in the back of the metal housing first.
2. Slide the camera upward to separate the camera with metal housing.
3. Remove the rubber cover of the Micro SD Card slot on the left side of the camera.
4. Insert the Micro SD Card and put back the rubber cover.
5. Slide the camera back in the metal housing.

Note, a micro sd card can be 16, 32 , 64 or 128GB. Do not use a bigger card. The specs of a suitable micro sd card is Maximum 128GB, UHS1 and class 10

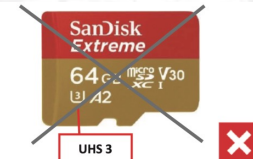
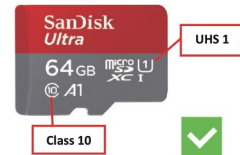
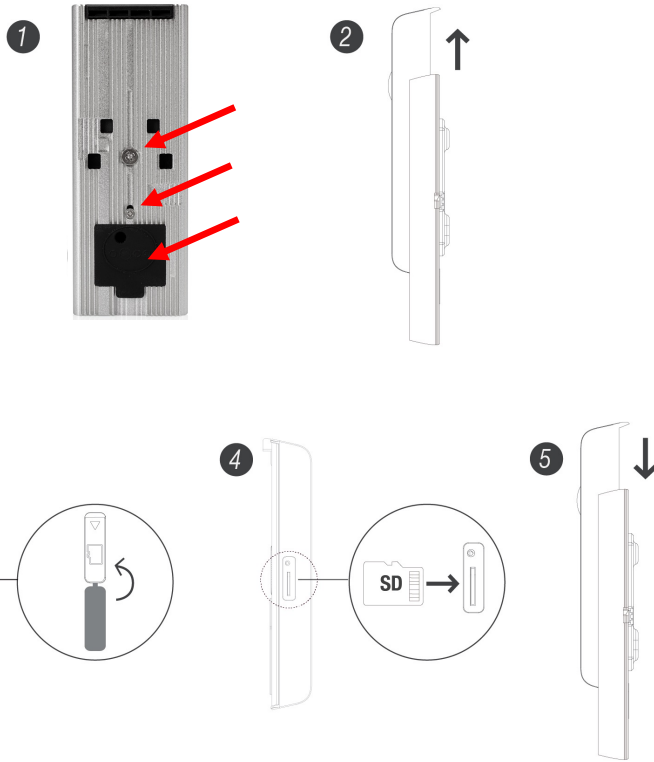

How to install – Wall Mount

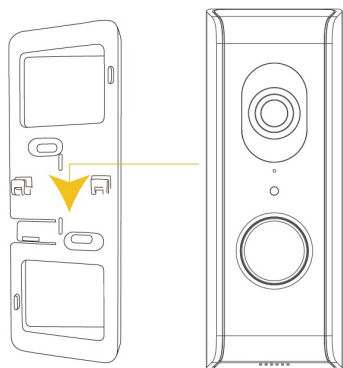
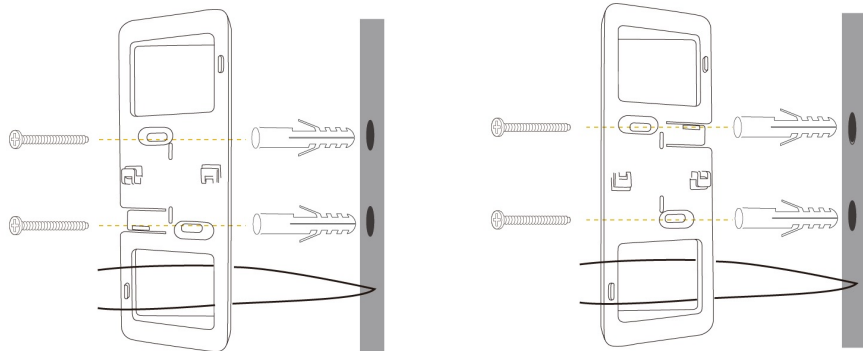

A

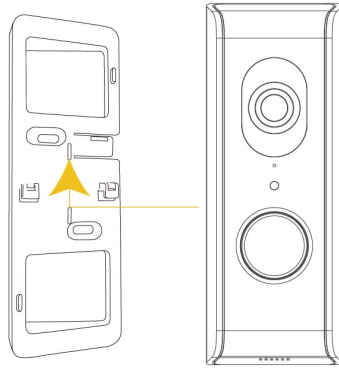
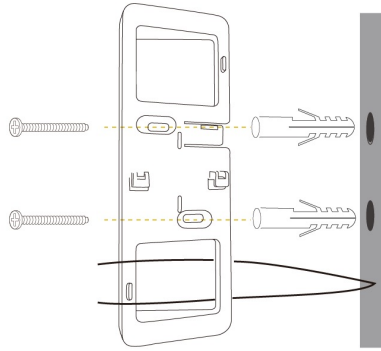

B

A) Install the bracket where the previous doorbell was, next to the door, with the 2 small screws included or the anchors when necessary.

Make sure the wires are fed through the appropriate square opening in the bracket. Then line up the video doorbell on the bracket and slide down until secure.

Once installed, turn power back on. Wait until the LED ring repeatedly flashes 3 times (approximately 1.5 minutes for the unit to re-boot) and you are able to start the device setup.

B) The bracket included has slight angle which could be used for different installation needs. If more angle needed on the other side, simply turn the bracket upside down and follow the installation instruction.

Or go to YouTube and search “SecuFirst DID701”

You could find more instruction videos for setup and installation.

The background of the slide is a faint, light-colored architectural floor plan. It shows various rooms, corridors, and structural elements like walls, doors, and windows. The lines are thin and grey, creating a technical drawing aesthetic. The text is centered over this background.

Preparation before Setup on Smart Device

Preparation before installation

SecuFIRST

Login information Wi-Fi Doorphone.

DID Code WiFi doorphone: DGAE -.....



New Security password:

New Admin password:

App Wi-Fi Doorphone: SecuFirst HD Professional Edition



Helpdesk SecuFirst:

E-mail: info@secufirst.eu

Telephone: 0031 (0)85 00 80 888

To install this camera you need to prepare the following information:

1. Your own Wi-Fi name, and your own Wi-Fi password.
 - The camera must be registered on your own Wi-Fi network during this installation.
 - Please note, it is our help desk number 1 problem that customers enter their own Wi-Fi network password incorrectly during this installation. The result is that the camera cannot connect and will not display an image. Check your Wi-Fi password carefully (on the back of the router / own documentation).
 2. Think of a new security password and document it carefully.
 3. Security password: Provides access to live video images from your Wi-Fi camera. During the installation with the app you will be asked to change this password. Make up this passwords in advance to move faster through the installation.

The new password need to contain:

 - A) At least 12 characters.
 - B) At least one capital letter (Example: A)
 - C) At least one lowercase letter (Example: a).
 - D) At least one digit (Example: 1).
 - E) At least one reading sign (Example:!).
- * During the installation, keep your phone or tablet close to the camera (max. 1 meter)

The background of the slide is a detailed architectural floor plan of a building. It shows various rooms, corridors, and structural elements like walls, doors, and windows. The drawing is rendered in a light gray color, providing a technical and professional aesthetic. The text is centered over this background.

Camera Setup on Smart Device

Android Device Setup

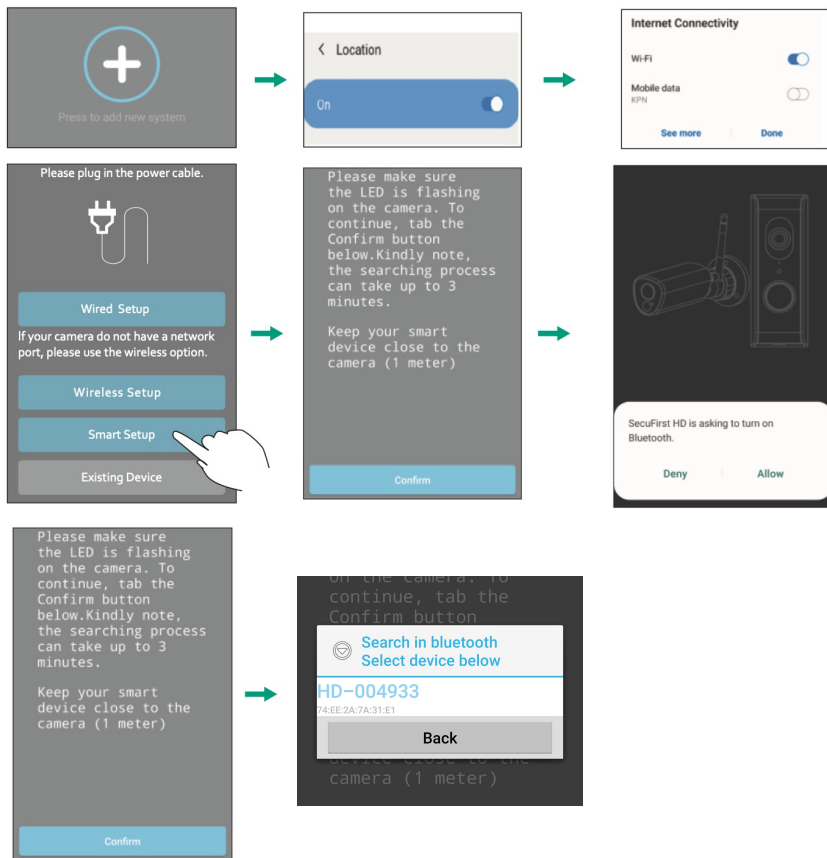

1. Open the app "SecuFirst HD Professional Edition" and tap "Press to add new system".
2. The app will request you to turn on and off some connections, depending on the current settings of your phone.
 - Location: On (Only needed during the installation for better searching performance of the Wi-Fi networks).
 - Wi-Fi: On
 - Mobile data: OffTap "Smart Setup"

Tap "Confirm" if the push button LED of the Wi-Fi Doorbell is flashing.

Tap "Allow" to enable Bluetooth on your smart device.

The app will show the founded camera. Tab on the "DID701 Doorbell" number to select.

Connect the camera to your own Wi-Fi network.

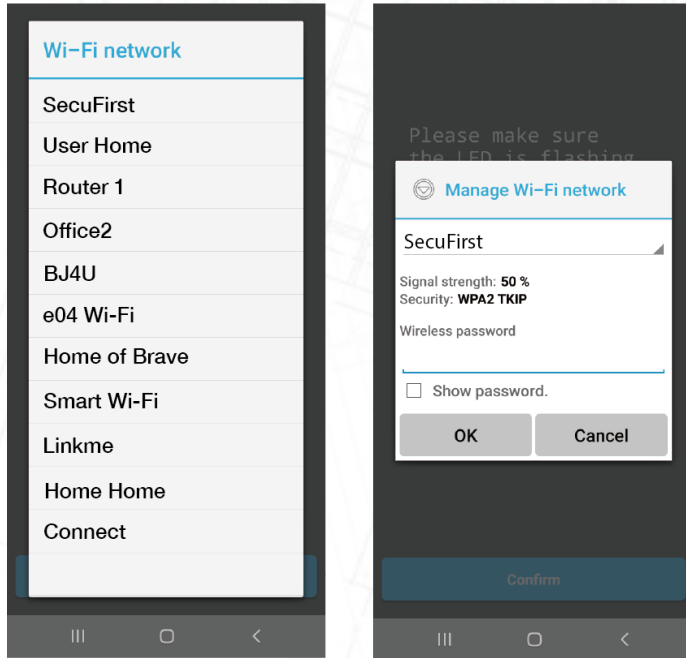

1. The app will show you the Wi-Fi networks which the camera can see. Select your own Wi-Fi network (2.4Ghz)
2. Insert your own Wi-Fi password.

Please note, it is our help desk number 1 problem that customers enter their own Wi-Fi network password incorrectly during this installation. The result is that the camera cannot connect and will not display an image. We advice you to tab the box "Show password" to avoid any typing mistakes. If you did insert a wrong Wi-Fi password, please remove the camera from your app and start from point 6 in this Quick Start Guide.

Adjust the Security Password

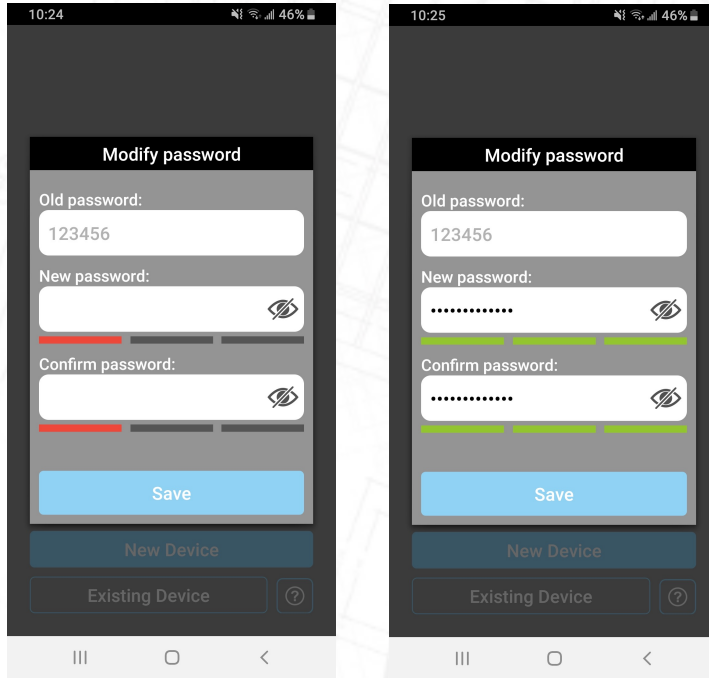

1. Adjust the Security password.
During this installation the default password of the camera is 123456. We don't think this is save enough and force to change this password during the installation.
2. The new password need to contain:
 - A. At least 12 characters.
 - B. At least one capital letter (Example: A)
 - C. At least one lowercase letter (Example: a).
 - D. At least one digit (Example: 1).
 - E. At least one reading sign (Example:!).
3. Fill in a new security password. Below the password it must show 3 green bars, then the password meets up to our demands. Tab the eye on the right side of the password to also see the filled in password. This avoids typing mistakes.
4. Re-confirm the password in the second line.
5. Tab "Done" on your keyboard and press "Save" in the app.

Do not forget to turn on your mobile data.

Live View of Camera

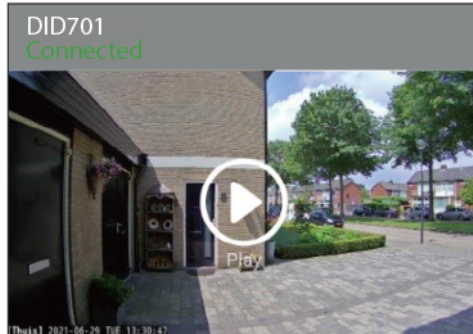
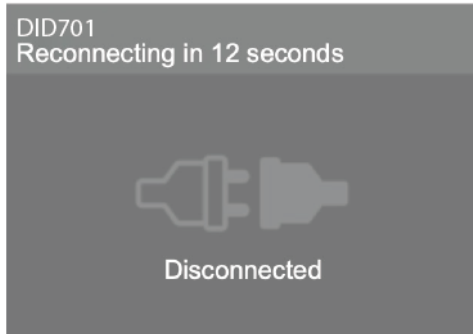

1. The Doorbell will restart in 30 seconds.
2. The camera will try to connect with your own Wi-Fi network and password which you have filled in (9.1 and 9.2) The camera will show in green "Connected". Press Play to go to the live image of the camera.

Live View of Camera

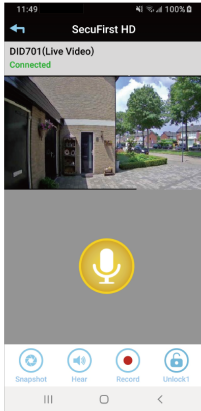
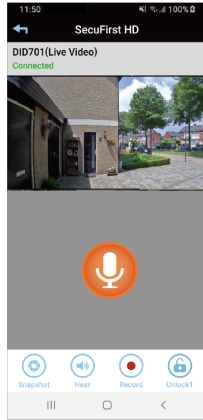
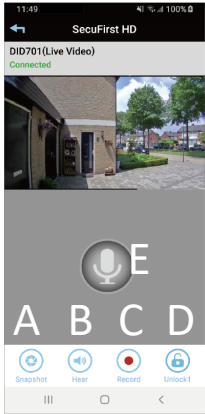

In the Live view of the camera you see these options:

- A) Make a snapshot of the image you have on your phone.
- B) Audio unmute / mute for Wi-Fi Doorbell
- C) Record the live video manually
- D) Optional. If you have electric locks then it's possible to connect to the Wi-Fi doorbell. With the app you can open a door after you confirmed the password.
- E) Microphone. Tab 1x to turn on the microphone of your phone. Now you can communicate with your visitor.

- Microphone Grey: Microphone off, you will hear your visitor, but the visitor will not hear you.
- Microphone Orange: You can communicate with your visitor.
- Microphone Yellow: You can communicate with your visitor, the volume increase of the speaker in the Wi-Fi Doorbell.

To get a Yellow microphone:

- Tab the grey microphone so it will become Orange.
- Tab and hold the Orange microphone again, for 3 seconds. When you let go, the microphone become Yellow.

- F) Leave the live view. Note, always leave the live view when you want to close the app. The Wi-Fi Doorbell will not call the smart devices if somebody is already in the live view.

Setting in the main menu

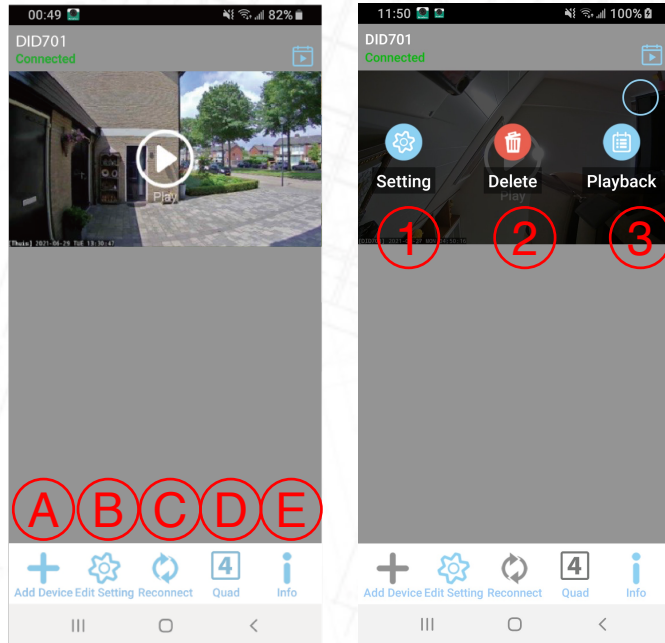

- A. Add a new device. Only needed when you buy another SecuFirst branded item like: IP camera, Door Entry, Alarm, Home automation and Lighting.
- B. Edit settings. When you tab on this button then 3 buttons will appear in the screenshot.
- C. Reconnect button. If the camera doesn't show "Connected",
- D. Quad view setting. If you have more than one camera or doorbell, you could press it to select the camera you wish to see the live view at once.
- E. Info button.

Once press "Edit settings" the three functions will display on the screen:

1. Setting: You could edit the setting of the camera from this button.
2. Delete: Delete the camera to setup new one or to reset it.
3. Event: Check on the playback of the device.

Go to Advance Setting

1. Tab "Edit Setting"
2. Tab "Setting" above in the app.
3. Tab "Advanced" Below in the app.
4. The app will ask you to fill in the password which you made in step 10 of this Quick start guide, then press "OK". If you select "Auto Login" then next time you login, there is no need to re-enter the password.
5. Tab "OK".

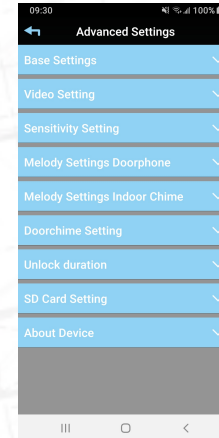
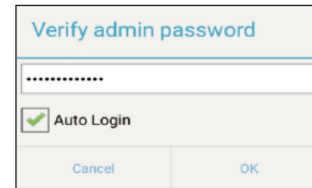
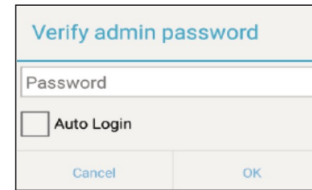
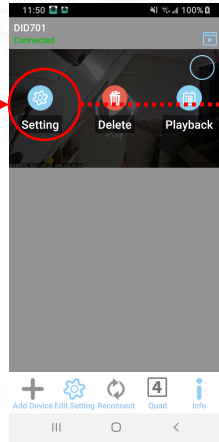
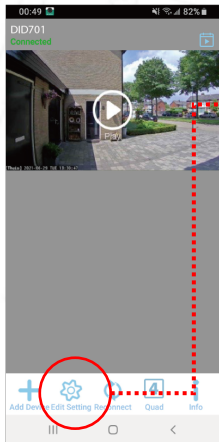

Playback Recording

1. Tab "Edit Setting"
2. Tab "Event" above in the app.
3. A filter will show which looks default 1 hour back on the micro SD card. If you want to look back further, kindly enlarge the filter by for example adjust the start date.
4. Tab "OK".
5. You will get an overview of recordings. These can be playback with 2 different ways.
6. Tab "Date / time" of the recording. The video will stream to your phone, leaving nothing behind.
7. Tab "Download" to copy the recording from your Micro SD card to your phone. When the download has been completed, the download button will change to a share button. Tab the share button to directly share your video with What's app, E-mail, etc.

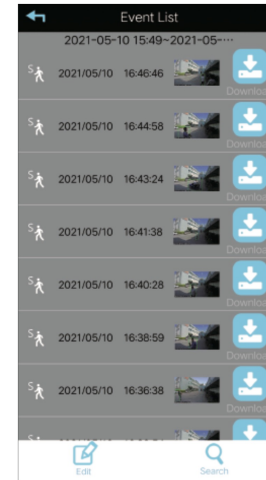
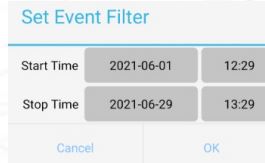
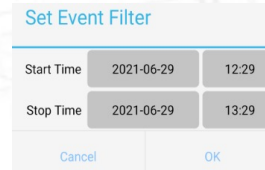
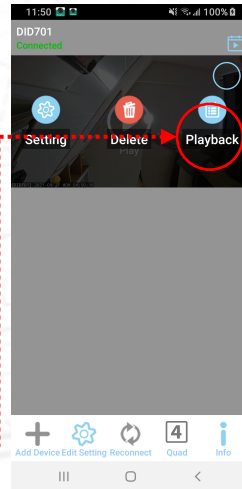

WhatsApp

A faint, light-colored architectural floor plan of a building is visible in the background. It shows various rooms, corridors, and structural elements like walls and doors, rendered in a technical drawing style.

Add a 2nd Phone or Tablet

If the Doorbell is installed on the 1st phone or tablet, you can easily add the camera on a 2nd phone or tablet. The Doorbell is already installed, so you don't have to do this again.

Add a 2nd Phone or Tablet

1. Download the SecuFirst HD Professional Edition app on the 2nd phone or tablet.
2. Tap “Press to add new system”.
3. When asked by the app, turn on location and turn off your mobile data.
4. Tab “Existing Device”.
5. Insert manually the 3 white lines (Below pictures we explain each line in detail)
 1. System naam: (Insert a chosen name for the camera).
 2. DID code: (Insert the DID code of your camera).
 3. Security password: (Enter the security password you changed).
 4. Tab “OK” or “Save”.
 5. The 2nd phone or tablet is connected to the camera

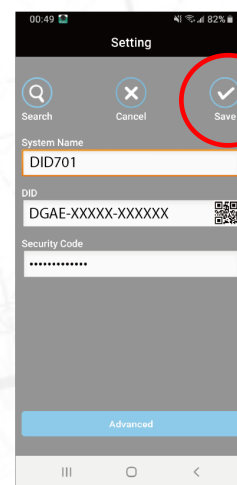
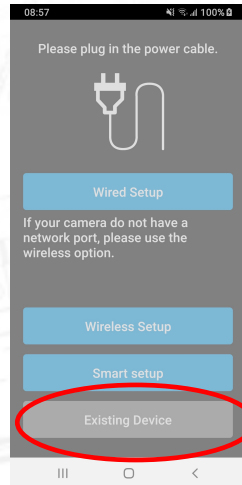
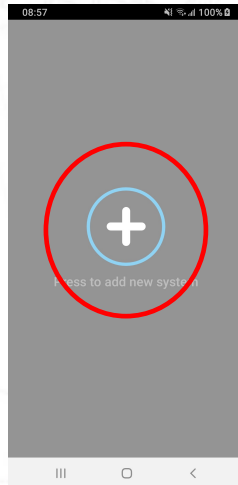

Add a 2nd Phone or Tablet

- System Name
 - Give the camera a name. You can invent these yourself. This does not have to be the same name as on the first device.
- DID Code
 - Every SecuFirst camera has its own unique DID code. You can find your DID Code in 2 places.
 1. The QR code sticker on the camera itself
 2. In the app of the 1st phone or tablet which has been used to install the camera.
 - The DID code can be found in the app on the 1st phone or tablet on which you have installed the camera.
 1. Open the SecuFirst HD app
 2. Tab “Edit setting”
 3. Tab “setting”
 4. The DID code is visible in the 2nd line.
- Security code of the camera
 - During the installation you changed the security code yourself to a password of at least 12 characters, at least 1 uppercase letter, a lowercase letter, a number and a reading sign such as ! # ?
 - Only you have this password. If you do not remember the password, you will need to completely reinstall the camera (Reset the camera, and remove the camera from the app on the first device). If you are going to reinstall the camera, the app will again ask you to enter a new password.

A faint, light-colored architectural floor plan of a building is visible in the background. It shows various rooms, corridors, and structural elements like walls and doors, rendered in a technical drawing style.

Notification Setting

When you have more than one phone or tablet setup with the Wi-Fi Doorbell, you could change the notification setting to allow notification or stop it when needed.

Notification Setting

1. Open the SecuFirst HD app
2. Tab below on Edit Settings
3. Tab above on Settings
4. Tab on the button Advanced Settings
5. Enter the admin password (During the installation of the camera you needed to change the default password)
Tab auto login on if you want to save the password to this phone.
6. Tab OK.

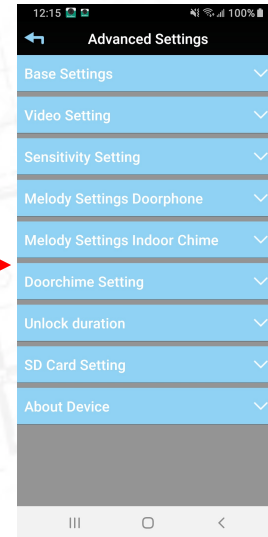
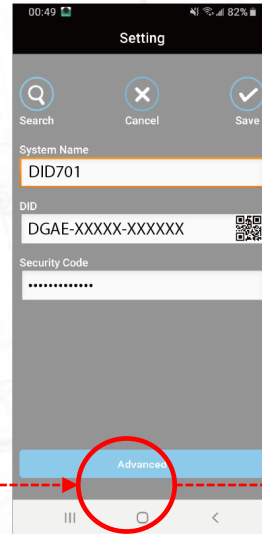
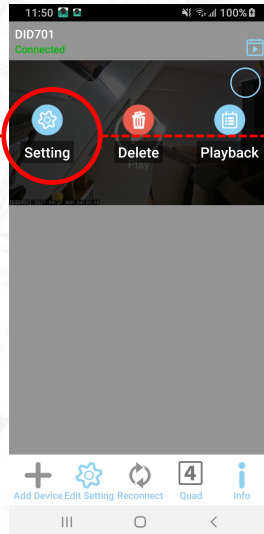
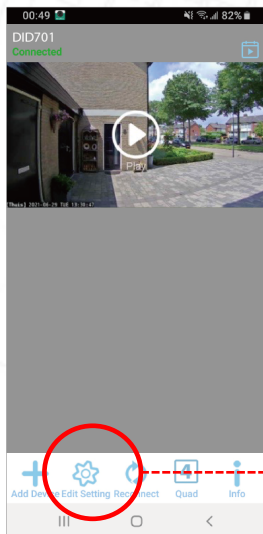

Notification Setting

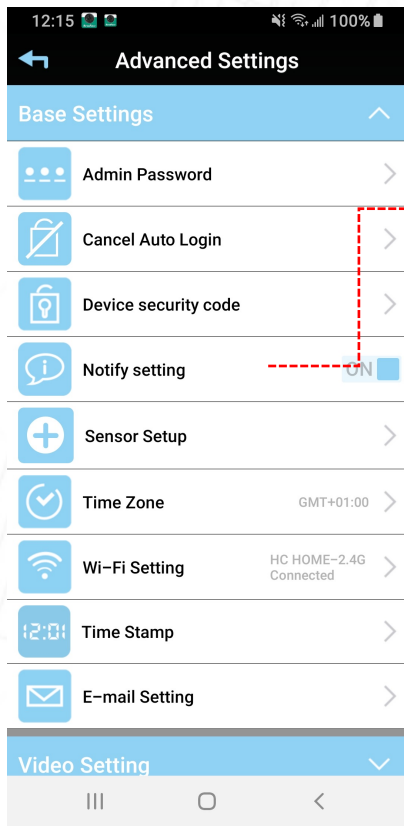

If the camera see motion, it will start to record and send a push message to your mobile phone(S) or tablet(s).

This function only applies to motion detection. It doesn't have effect on the calling page when a visitor will press the Wi-Fi door phone. Turn the switch to your preferred setting.



ON = When the camera see movement, it will start to record and send a push message.



OFF = When the camera see movement, it will start to record and will NOT send a push message.

TIP, A camera cannot be compared with an alarm system. Because it is outdoor, 99,9% of all movement recordings are correct. The mail man, children's, cars etc. are all correct movements, but no need to be alarmed. Our advice is to turn off the Notify settings and only look back recordings when something has happened.

Important: When the Notify setting is setup to **OFF**, that means **ALL** the phone or tablet that has setup with the Wi-Fi Doorbell will **"NOT"** receive any notification. If you only want to turn off notification temporary on specific device, please follow instruction on following pages.

Notification Setting

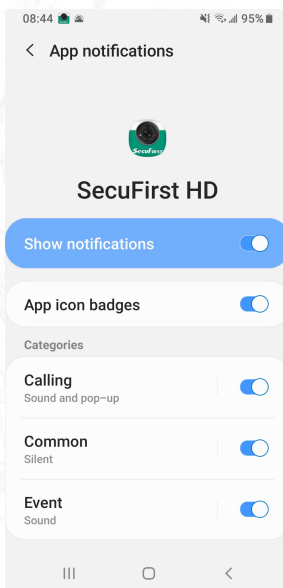
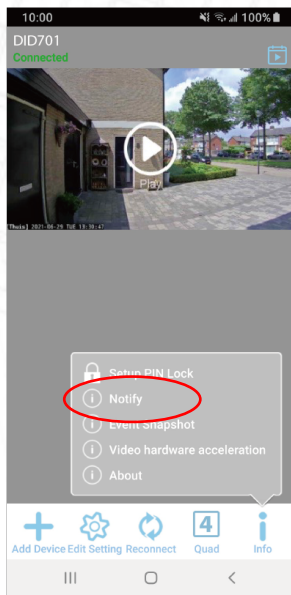
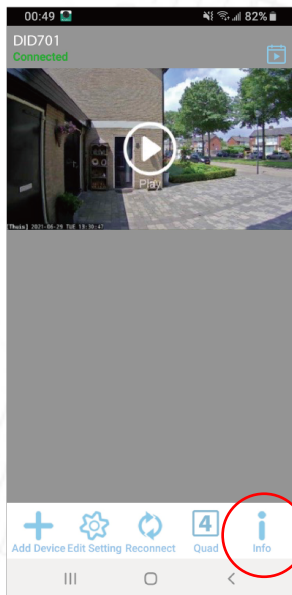

- At the home page as below, tap “Info” button
- Tap “Notify” on the list
- It will take you to the phone setting for App notification.
- At here you could choose to turn OFF all notification or specific notification of SecuFirst APP.
- The change made here will only apply to this specific phone or tablet. All other devices setup will not be changed.

Advanced settings of the Doorbell

With every SecuFirst camera you can login into the advanced settings of the Doorbell.

All changes in the advanced settings will apply to all smartphones or tablets which are connected to the Doorbell.

The advanced settings are only available when the Doorbell show connected in the app.

Advanced settings of the camera – How to go to Advance settings

1. Open the SecuFirst HD app
2. Tab below on Edit Settings
3. Tab above on Settings
4. Tab on the button Advanced Settings
5. Enter the admin password (During the installation of the camera you needed to change the default password)
Tab auto login on if you want to save the password to this phone.
6. Tab OK.

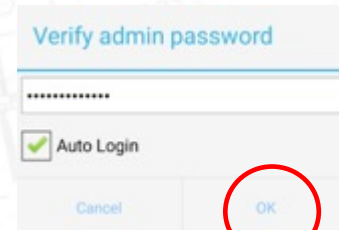
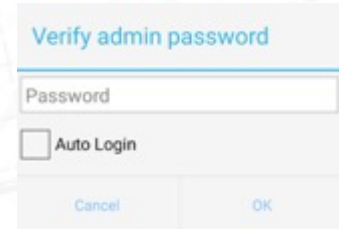
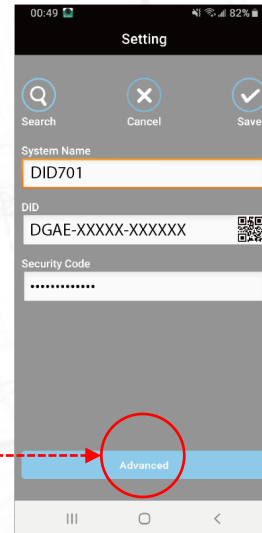
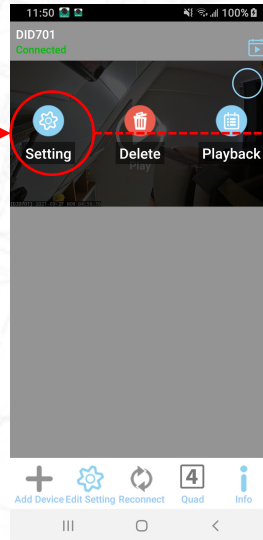
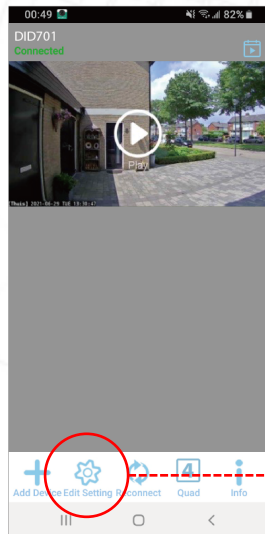

Advanced settings of the camera – How to go to Advance settings

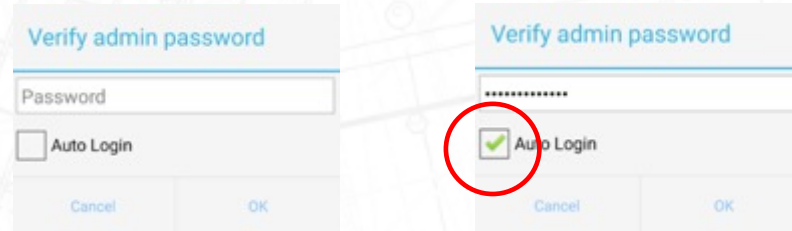

When enter the advanced settings, it will be required to enter the admin password.

It's possible to tab the box Auto login. When auto login is selected, the app will not request to enter the password again. It will be saved in the app.

If you would like to cancel the auto login, tab this option. The next time when you enter the advanced settings, the app will request to insert the admin password again

Advanced settings – Base Settings

There will appear a menu with blue bars .

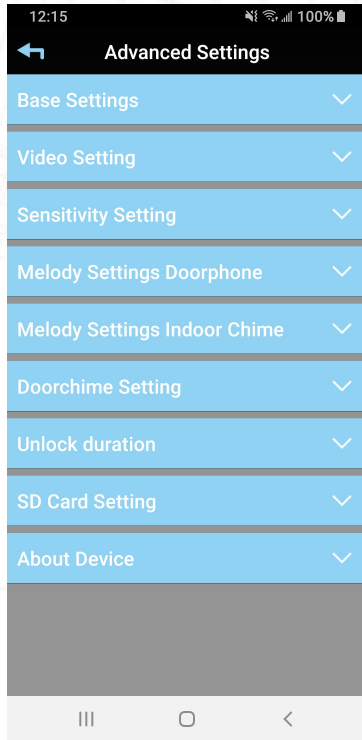

When Tab a blue bar to get more options.
We start with the first blue bar, Base Settings.

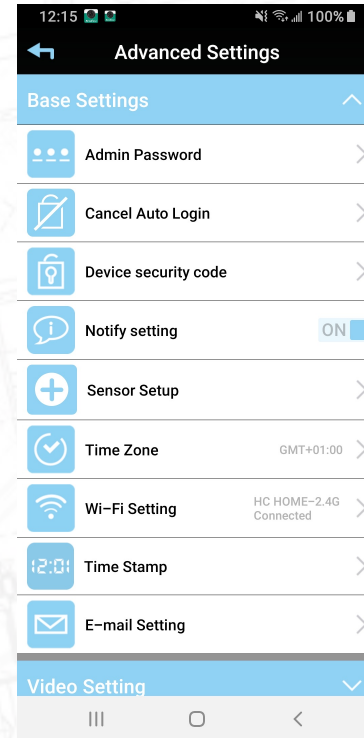

Base Settings – Admin Password

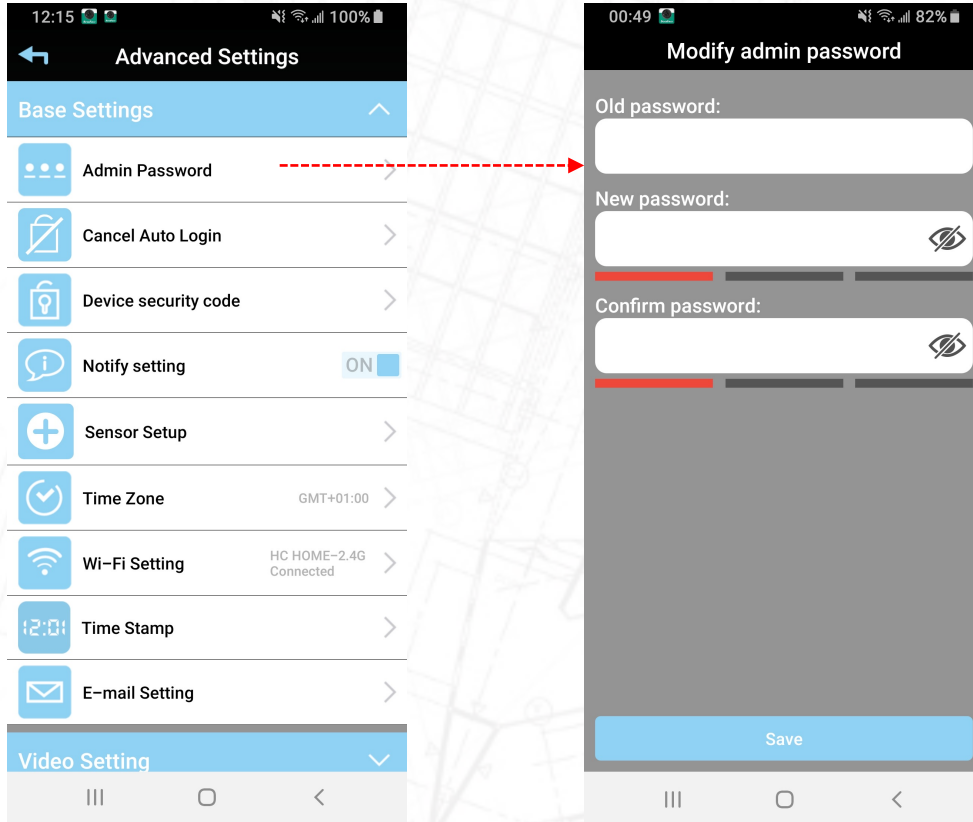

During the installation of the camera, you were requested to change the default Security and admin passwords (123456) to a password of your choice.

During the installation you have changed both passwords (Same password for Security as for Admin)

The Admin password gives access to the advanced settings.

In this option in the advanced settings, it's possible to change the Admin password. For example, a family of 4 people. All 4 people are allowed to see the live view, playback and answer calls. It will not be saved if all 4 can also change the settings of the camera. By changing the admin password, then share this with only 1 person, so that 1 person will have access to the advanced settings. The other 3 people of the family cannot enter.

Base Settings – Cancel Auto Login

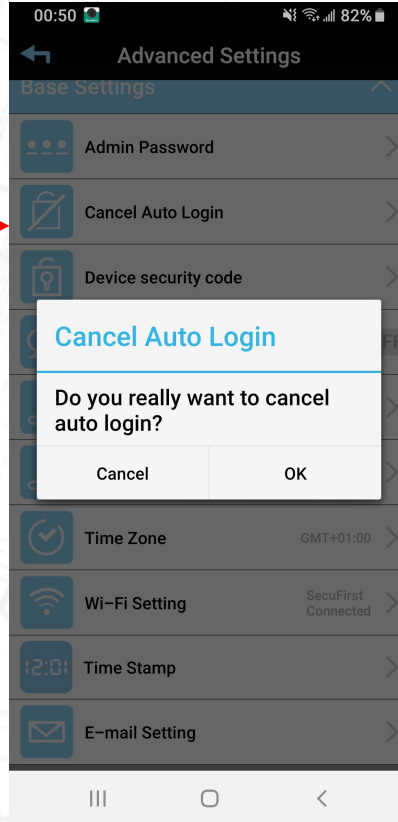
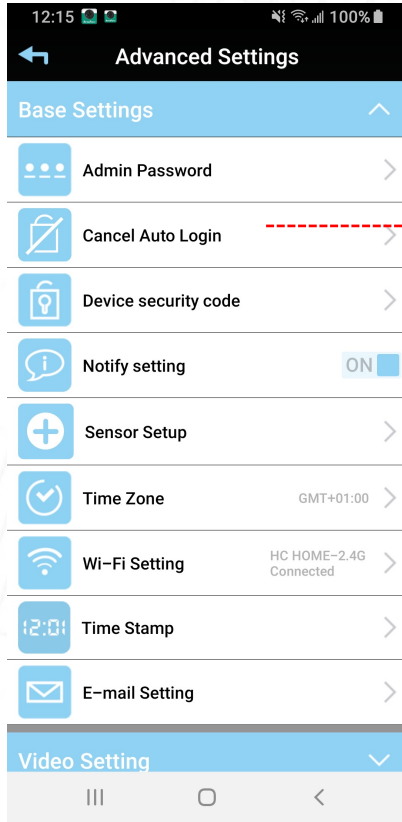

When enter the advanced settings, it will be required to enter the admin password. It's possible to tab the box Auto login.

When auto login is selected, the app will not request to enter the password again. It will be saved in the app.

If you would like to cancel the auto login, tab this option. The next time when you enter the advanced settings, the app will request to insert the admin password again

Base Settings – Device Security Code

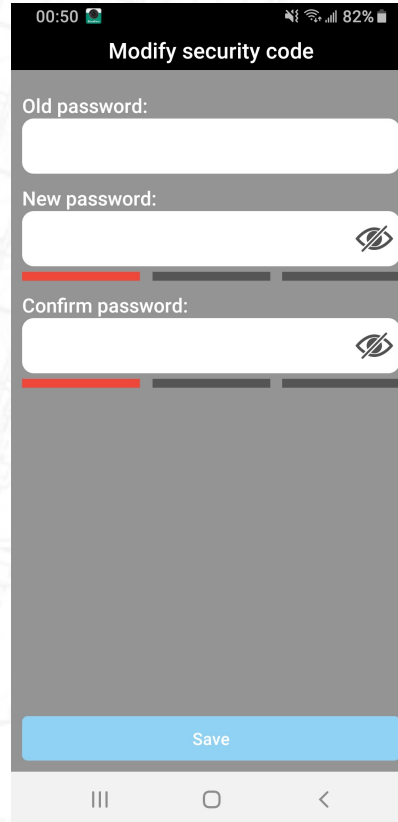
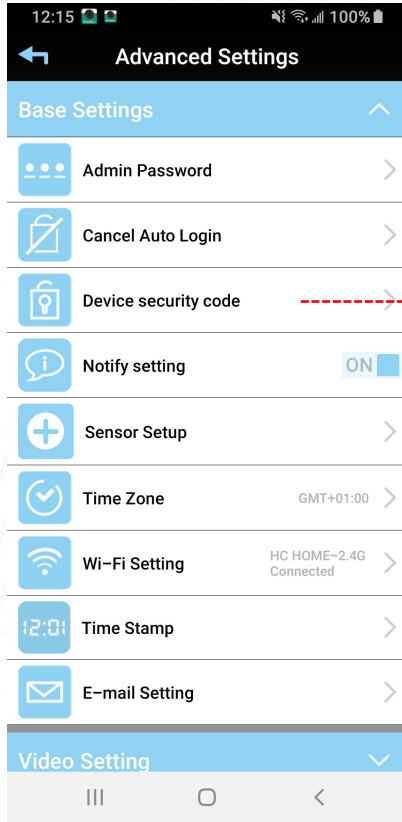

The default Security passwords is 123456. During the installation you have changed both passwords (Same password for Security as for Admin).

The Security password, together with your unique DID code, gives access to the camera.

In this option in the advanced settings, it's possible to change the Device Security password to your own choice.

Base Settings – Notify setting

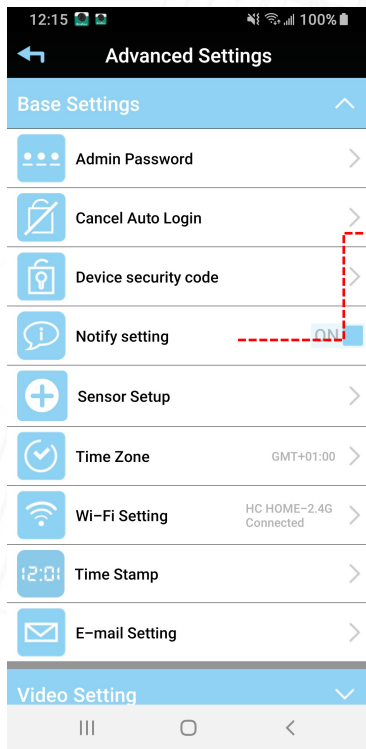

If the camera see motion, it will start to record and send a push message to your mobile phone(S) or tablet(s).

This function only applies to motion detection. It doesn't have effect on the calling page when a visitor will press the Wi-Fi door phone. Turn the switch to your preferred setting.

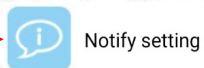

Notify setting



ON = When the camera see movement, it will start to record and send a push message.



Notify setting



OFF = When the camera see movement, it will start to record and will NOT send a push message.

TIP, A camera cannot be compared with an alarm system. Because it is outdoor, 99,9% of all movement recordings are correct. The mail man, children's, cars etc. are all correct movements, but no need to be alarmed. Our advice is to turn off the Notify settings and only look back recordings when something has happened.

Important: When the Notify setting is setup to **OFF**, that means **ALL** the phone or tablet that has setup with the Wi-Fi Doorbell will **“NOT”** receive any notification. If you only want to turn off notification temporary on specific device, please follow instruction on following pages.

Base Settings –Sensor Setup

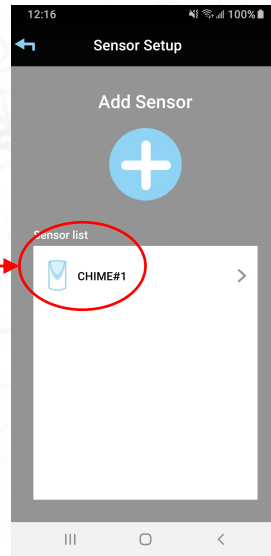
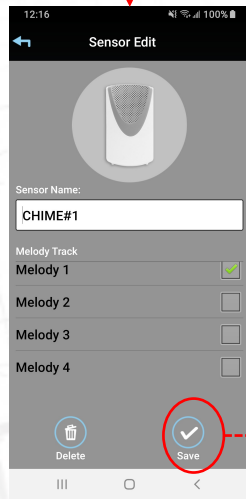
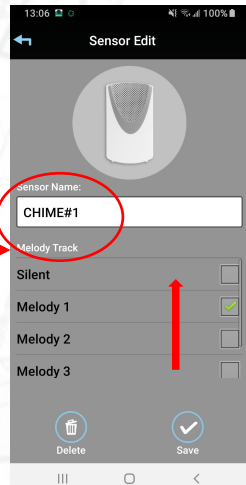
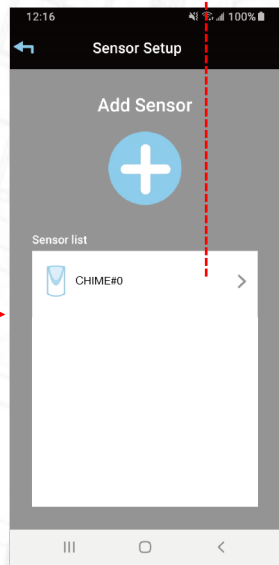
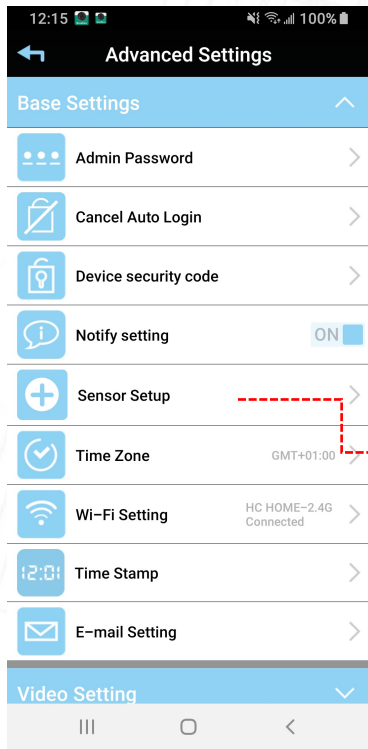

A wireless chime is connected to the Wi-Fi doorbell. This sensor is using the 868Mhz protocol (our own protocol, not linkable with other 868Mhz products from other brands).

Tap on sensor settings, then on the already paired wireless chime. This function allows you to set the melodies of the wireless chime or change the name of the chime.

Base Settings –Sensor Setup



It's possible to expand the wireless chimes to the Wi-Fi doorbell. Additional chimes can be ordered on our website www.secufirst.eu

Please note, a maximum of 2 wireless chimes can be connected to the Wi-Fi doorbell.

Base Settings –Sensor Setup

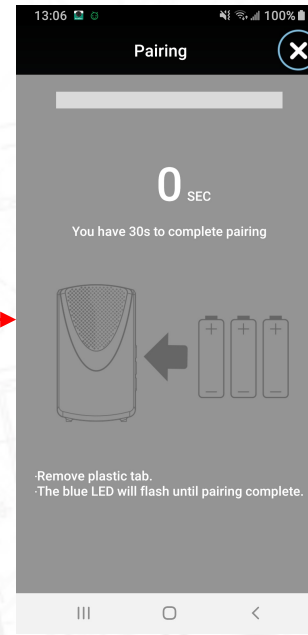
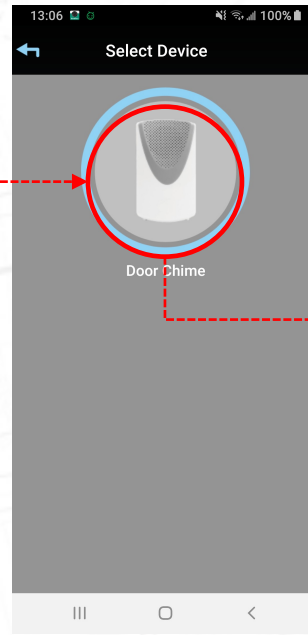
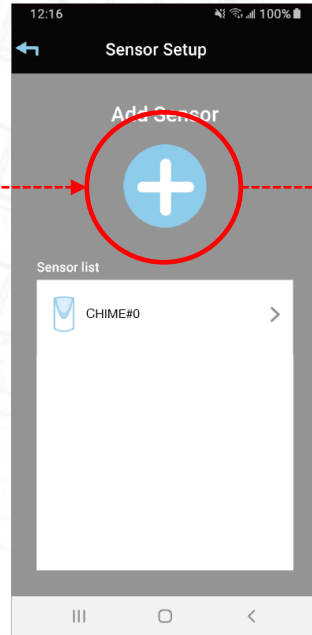
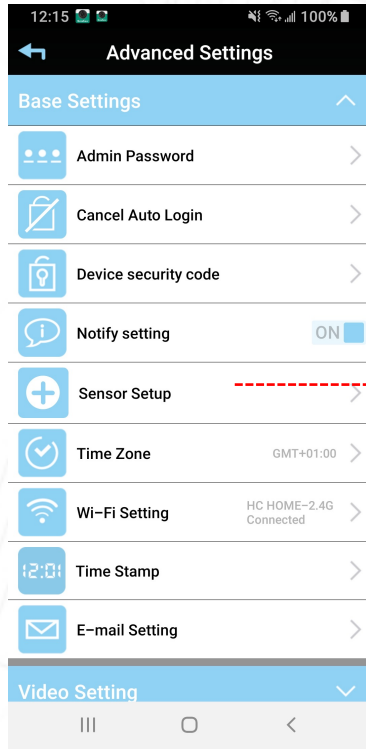

Tab on “+”

Select “Door Chime”

Insert the batteries within 30 seconds

Base Settings –Sensor Setup

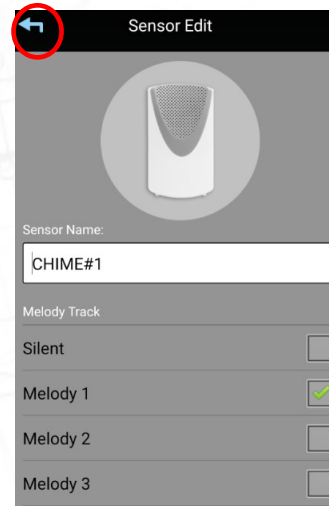
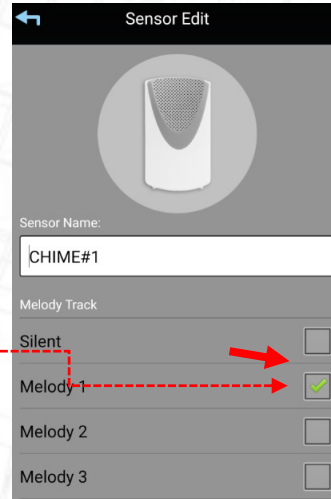
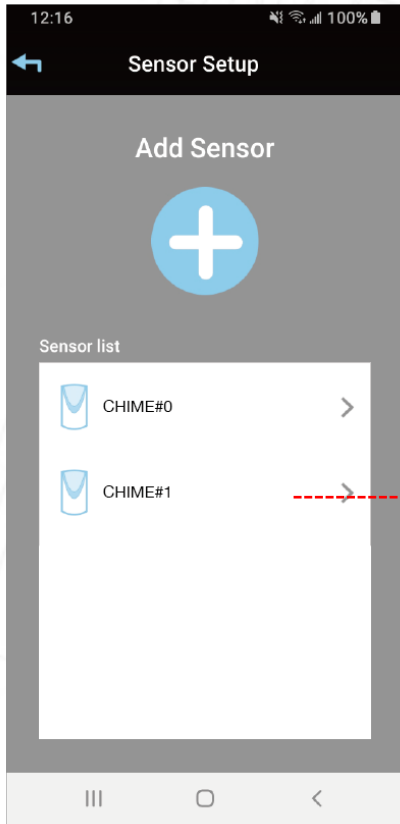

Tab the chime to select a melody and change name.

Leave the setting

Base Settings – Time Zone

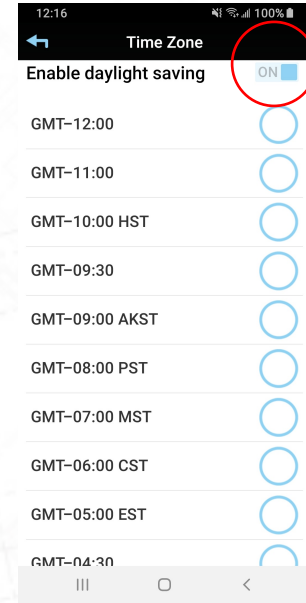
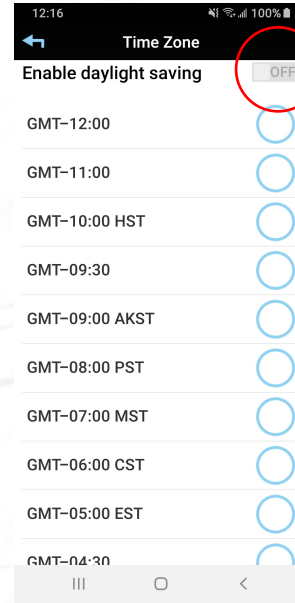
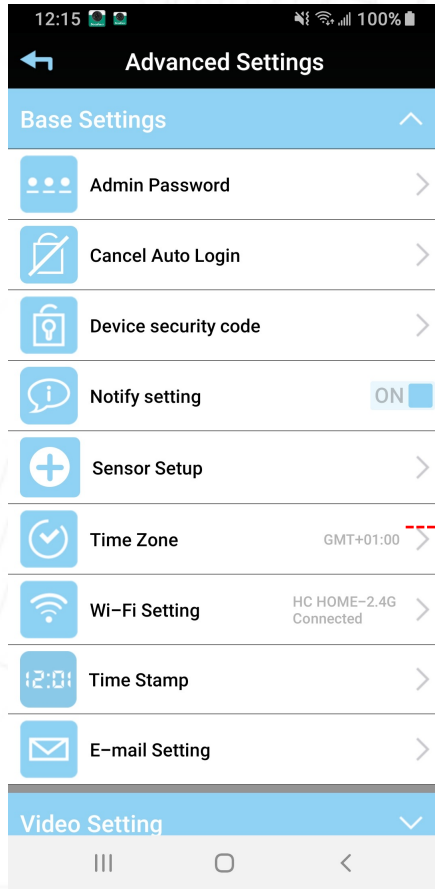

Set the correct time zone for the camera.

The time zone in Nord Europe is GMT +1.

Please note, on the top of the app is the option Summer time with a switch on/off.

Turn on daylight saving time when it is summertime. The time zone setting is necessary to put the correct timestamp in the recorded videos.

Base Settings – Wi-Fi

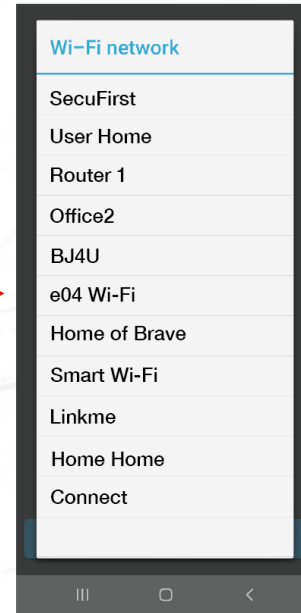
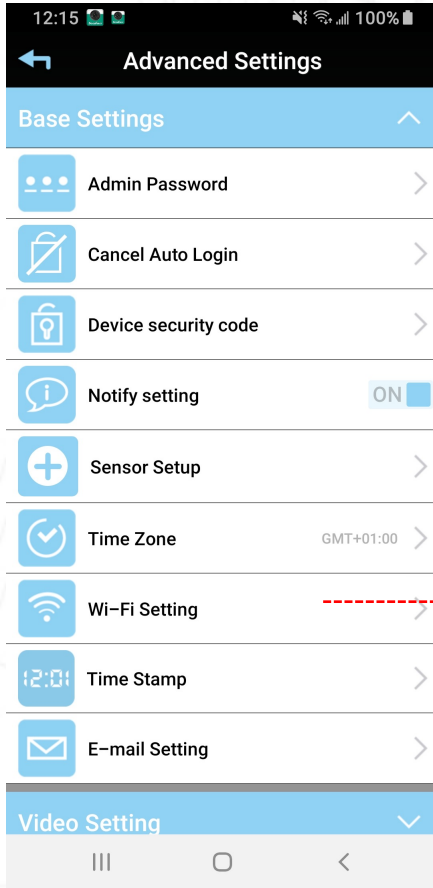

Connect the camera to another Wi-Fi network if desired.

This only works if the Wi-Fi network which have been installed on the camera is also available.

This function is intended to transfer the camera, for example, from your Wi-Fi router to another booster or repeater in the house.

Base Settings– Time Stamp

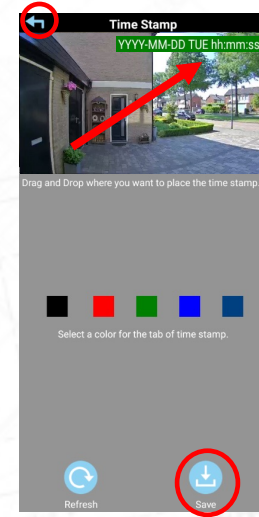
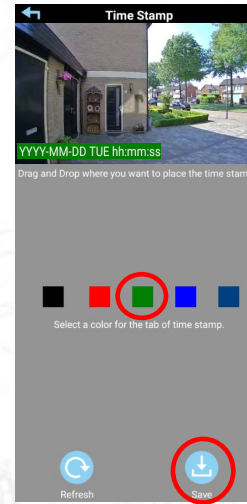
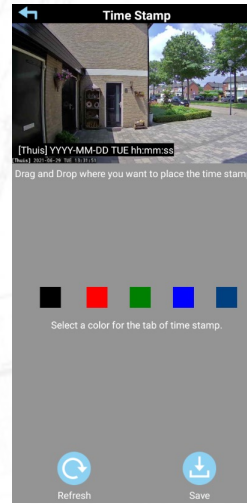
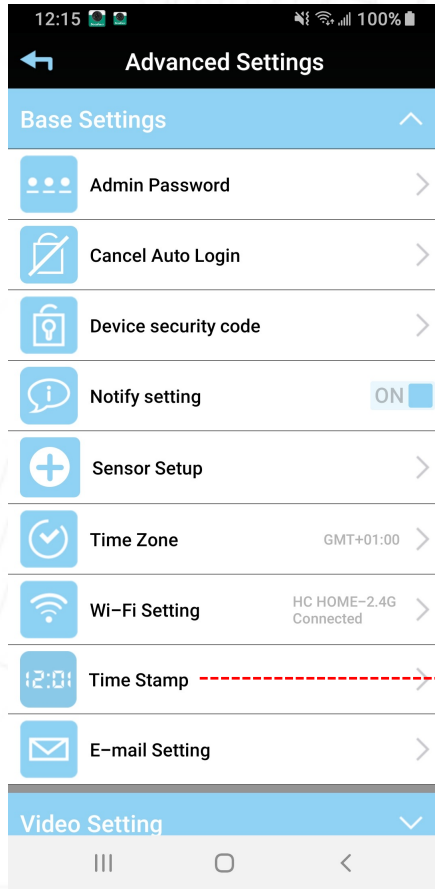

A timestamp is burned into every recorded video.

This way you know on which date and time a certain recording took place. Please note, the timestamp works together with the time zone settings, 2 headings above. Make sure the time zone and daylight saving time switch are set correctly.

In this option you can change the color of the timestamp. Tap a desired color and press save.

Press the timestamp with your finger for 1 second. The timestamp can be moved to another location in the image. This is to prevent the timestamp from being a nuisance in the recordings. Press save

Email Settings

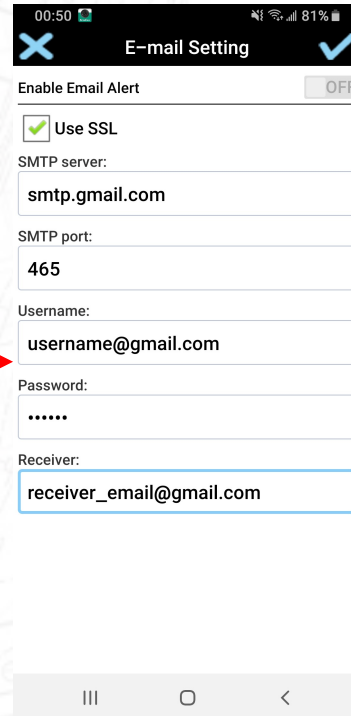
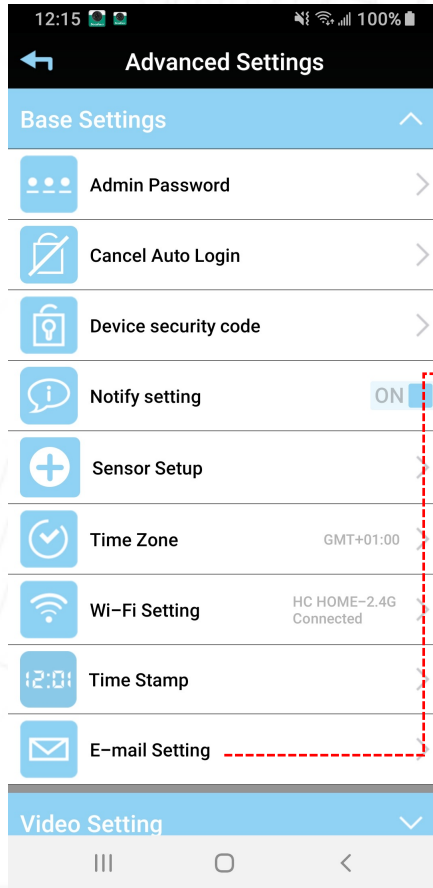

In addition to receive a push notification from our app, when there is motion detection, you can also receive an email with this option.

This option is only available with a Gmail email account.

The email contains only text when there has been movement. There are no attachments of photos or video material from the camera. We do this with on purpose.

The moment your images are e-mailed, they are also stored in the server of the e-mail provider.

Tip, as with the push notifications, we recommend that you do not set the e-mail function. 99.9% of all movements/recordings are justified, but not alarming.

Video Setting – Video Quality

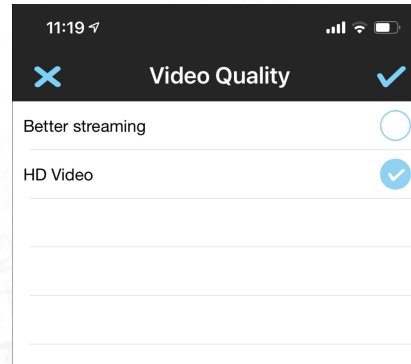
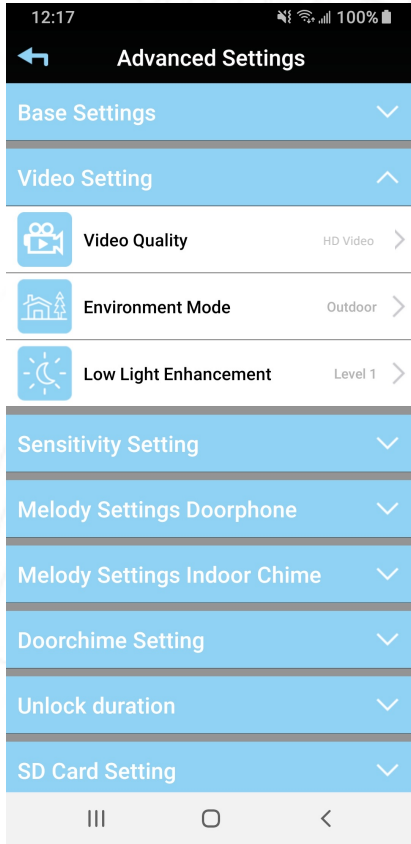

The video quality can be set for the live view in the app. This function is intended for cameras that receive poor Wi-Fi reception from the router or the internet subscription speed.

If the camera shows slow images that are not smooth, you can lower the video quality.

Better Streaming: The camera needs an upload speed from your router of at least 3 Mbit

HD Video: The camera needs an upload speed from your router of at least 8 Mbit

Please note, the video quality is only for the live view in your app. The recordings on the Micro SD card are 1080P recordings at all times. You cannot adjust this in the app. The downloaded video files are smooth images at all times. Bad internet have no effect on the recordings.

Video Setting - Environment Mode

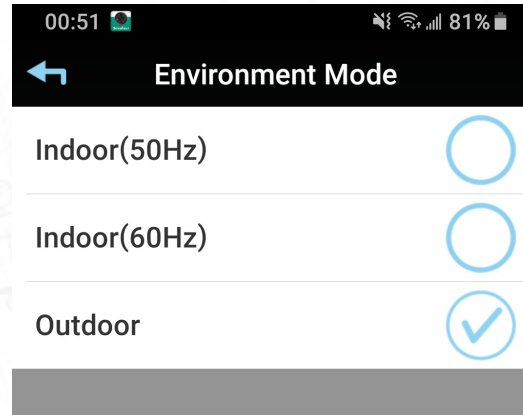
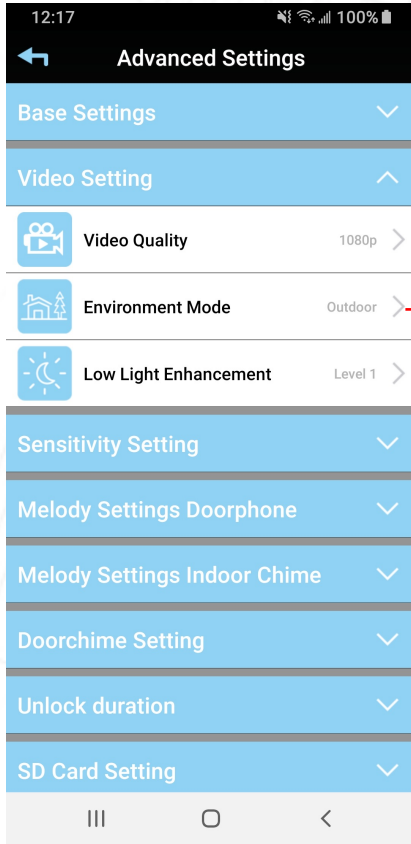

SecuFirst has various cameras for indoor or outdoor use. By default, an outdoor camera is already set to outdoor.

It is of course possible to place an outdoor camera inside. Then set the environment mode to within the house. This option lets the camera lens handle the colors in the image differently. There is a difference between artificial light and the sun light.

For indoor use there are 2 options, 50 Hz and 60 Hz. The reason for this is old light sources such as fluorescent beams. These can cause disturbances in the live image. If you experience this, you can set the indoor camera to 60Hz, then the interference will be gone.

Video Setting – Low Light Enhancement

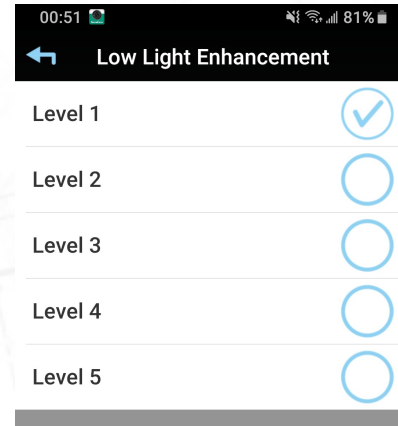
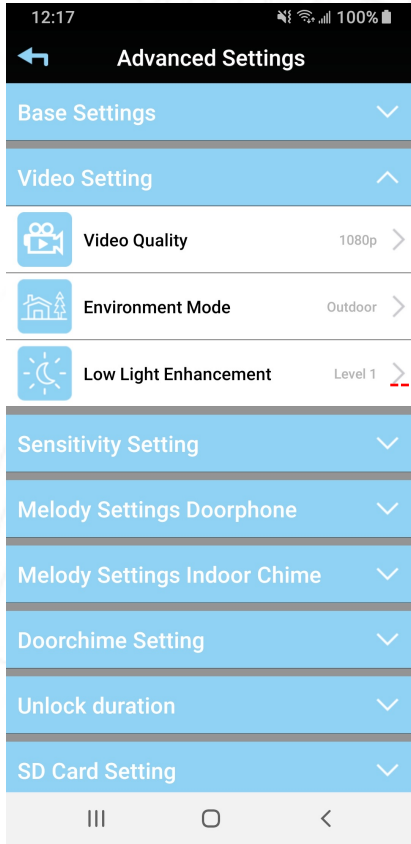

This option is for the southern countries which are close to the equator. If the low sun shines directly into the lens, a white haze may appear in the live image (similar to brightness of an TV).

If the white haze is visible, it can be removed by setting the low light settings to level 5. In Northern Europe you will not see any difference between the different levels in the live image, because there is no white haze.

Sensitivity Setting – Detect Mode

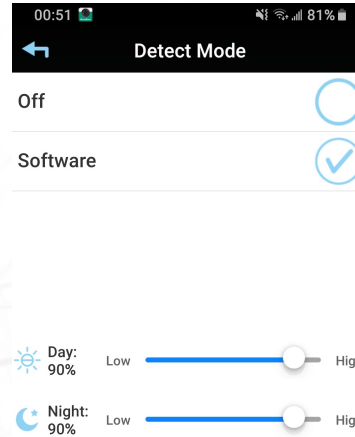
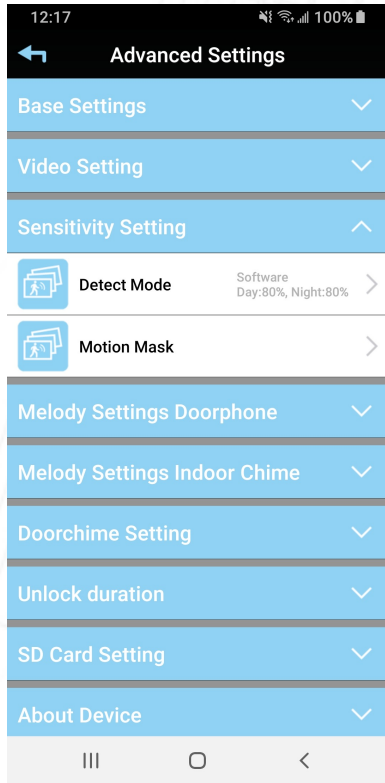

The camera can record motion detection.

Detect mode on (Software) means: The camera will record to the Micro SD card when there is motion. You are also able to adjust the sensitivity of the detection for day and night time.

When the detect mode is turned on (Software), there will appear 2 bars at the bottom of the image.

The detecting sensitivity can be set for both day and night. Low (0%) is very insensitive, High (100%) is very sensitive to detect motions.

Detect mode off means: The camera will not record to the Micro SD card if there is movement.

Sensitivity Setting – Motion Mask

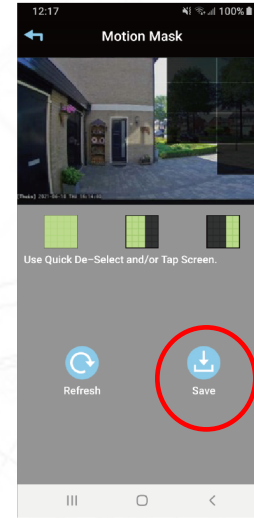
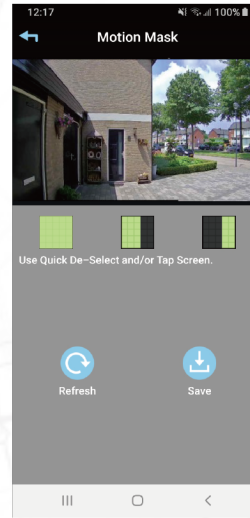
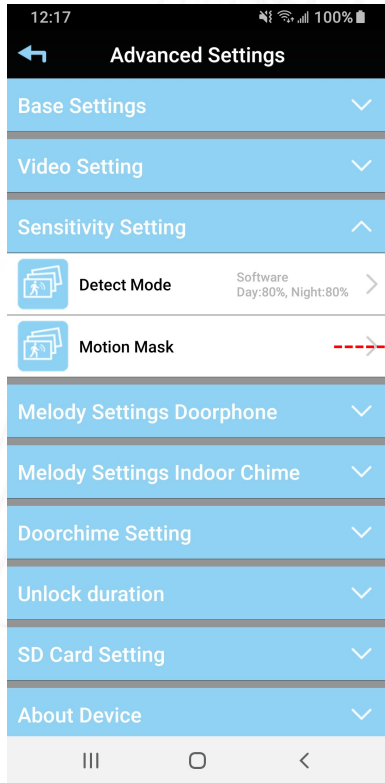

In addition to sensitivity, it is also possible to make parts of the image insensitive to motion detection. We call this “Motion mask”.

This option will be visible in the advanced settings when the detect mode is turned on. Tap the blue “Sensitivity Settings” bar and then tap “Motion mask”. An image of what the camera sees becomes visible. Tap the photo with your finger, you will see that a small black area is created.

Everything in the image that is black is not sensitive to motion detection. For example, you can screen off the public road so as not to get motion detection recordings of passing cars. Then tap save at the bottom.

Melody Settings Doorphone

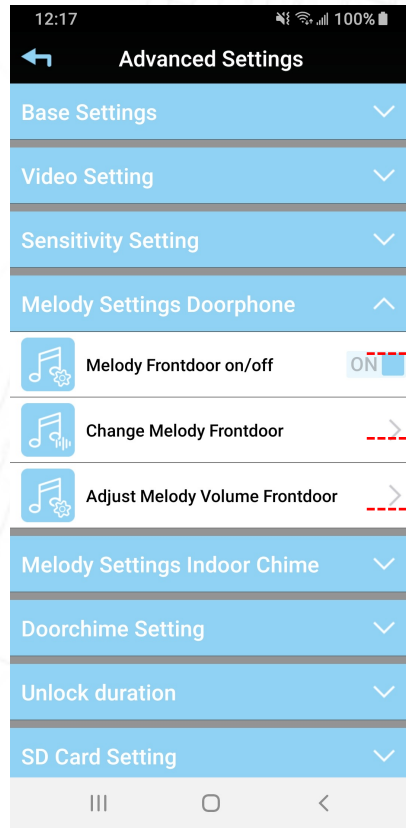

This setting is for changing the melody of the outdoor unit of the Wi-Fi doorbell itself.

- Melody Frontdoor On / Off.

By default, Wi-Fi doorbell will let you hear a melody out of the speaker, when someone presses the Wi-Fi doorbell. With this setting you can turn On or Off this melody by tapping the slider to ON or OFF.

- Change Melody Frontdoor.

If the function Melody Frontdoor on / off is set to on, you can choose between various melodies coming out of the Wi-Fi doorbell speaker when you press it. Stand next to the Wi-Fi doorbell, and tap “Change Melody Frontdoor”. You won't see anything in the app, but the doorbell will let you hear the melody change every time you tap this feature. Once you have found the right melody, stop tapping. The setting will automatically be saved.

- Adjust Melody Volume Frontdoor.

If the function Melody Frontdoor on / off is set to on, you can adjust the volume of the melody.

Stand next to the Wi-Fi doorbell, and tap "Adjust Melody Volume Frontdoor". You won't see anything in the app, but at the doorbell you'll hear the volume change every time you tap this feature. Once you've found the right volume, stop tapping. The setting will automatically be saved.

Melody Settings Indoor Chime

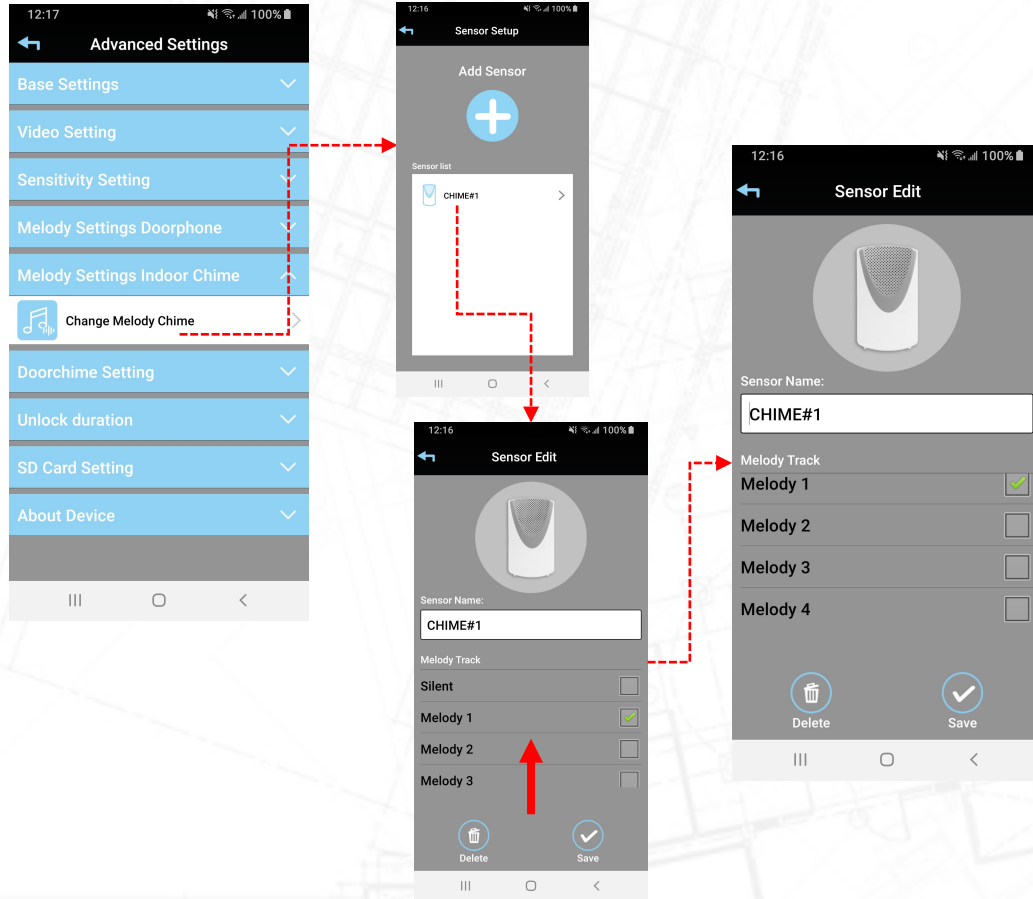

This setting is for changing the melody of the indoor unit (wireless indoor chime).

- **Change Melody Chime**
A wireless chime is connected to the Wi-Fi doorbell. This sensor is using the 868Mhz protocol (our own protocol, not linkable with other 868Mhz products from other brands). Tap on sensor settings, then on the already paired wireless chime. This function allows you to set the melodies of the wireless chime.

Melody Settings Indoor Chime



You can change the volume of the wireless indoor chime on the chime itself by pressing the speaker button.

The volume will change from high to low.

The other two buttons on the chime do not work in combination with the Wi-Fi doorbell. Or you could change the melody of the chime in the Advance Settings of the app

Doorchime Setting

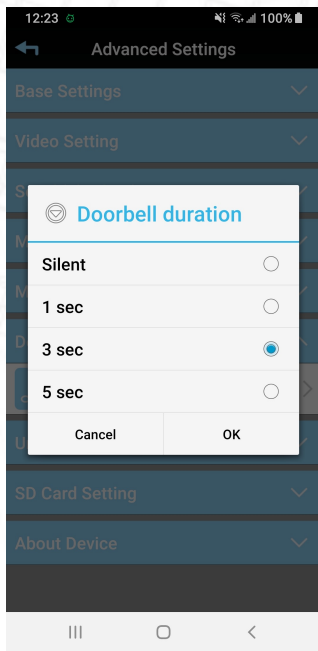
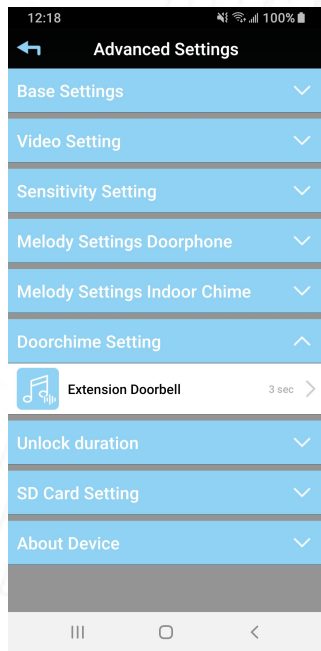

Use this function if you have installed a wired chime in addition to our adapter.
(4 wires connected to the Wi-Fi doorbell).

- Extension Doorbell
Set the time for how long your own wired chime should ring.

Compare it with the old situation, when there was only a door press button at the front door.

If someone pressed the door press button for 1 second, you heard the inside chime ring for 1 second.

In most cases you can set the time to 1 or 3 seconds to match the sound of before.

This is independent of the number of seconds that your visitor presses the door push of the Wi-Fi doorbell. For example, your visitor may press the door button for 1 second, but the wired chime will be heard for 3 seconds.

Unlock Duration

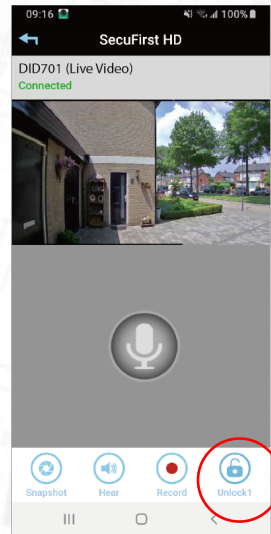
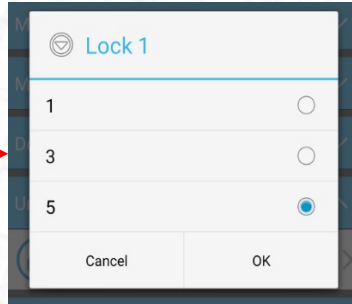
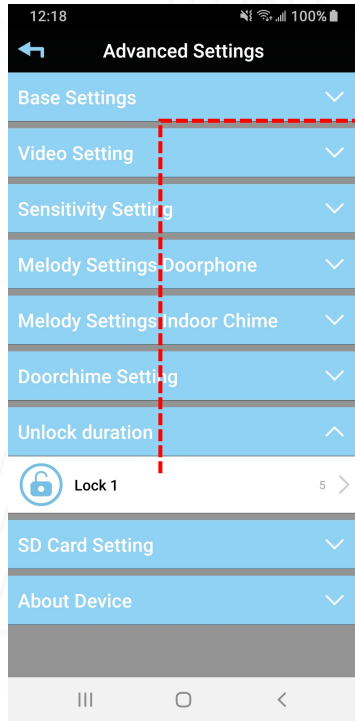

Use this function if you have connected an electric lock to the Wi-Fi doorbell.

- Lock 1

An electric lock or fence can be connected to the Wi-Fi doorbell.

The wires of the lock must be connected to contacts B1 and B2 of the Wi-Fi doorbell. This is a potential free contact, 0V. With locking 1, you can indicate how long the electric lock should be open, if you tap unlock in the live image of the app.

SD Card Setting – SD Card Format

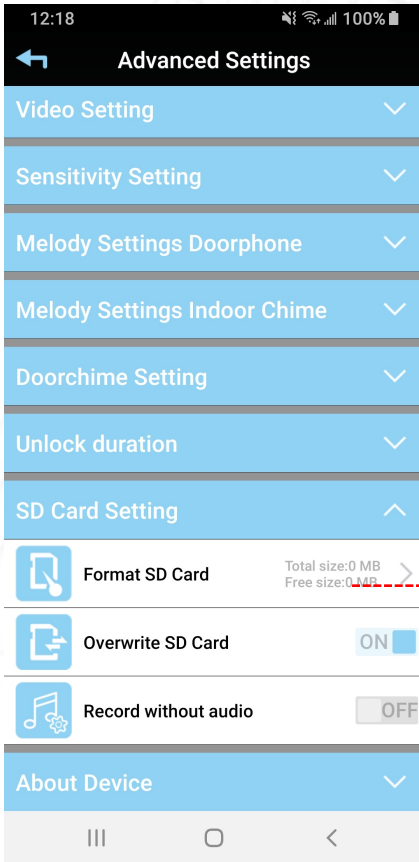

The micro SD card that is placed in the camera must be format at least 1x before it can start to record. The camera will format the micro SD card to FAT32 extension.

The micro SD card must meet a number of requirements:

- Maximum size 128GB
- UHS1
- Class 10

The procedure to insert a micro SD card in the camera:

- Remove the adapter from the camera
- Insert the micro SD card into the camera
- Plug the camera adapter back into the wall outlet
- Wait 1 minute for the camera to start up
- Open the app and format the micro SD card 1x in the advanced settings.

Record Motion Detection – SD Card Format

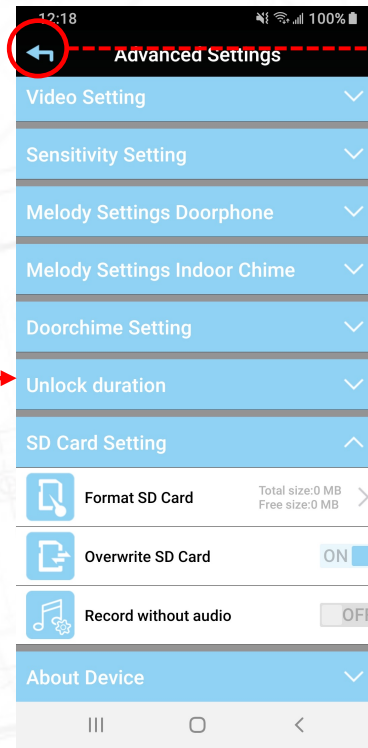
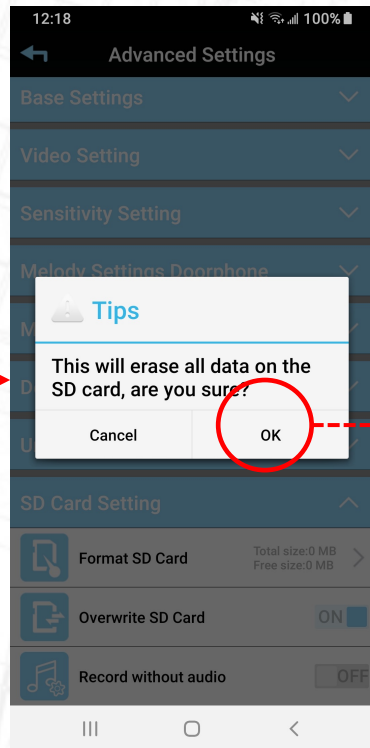
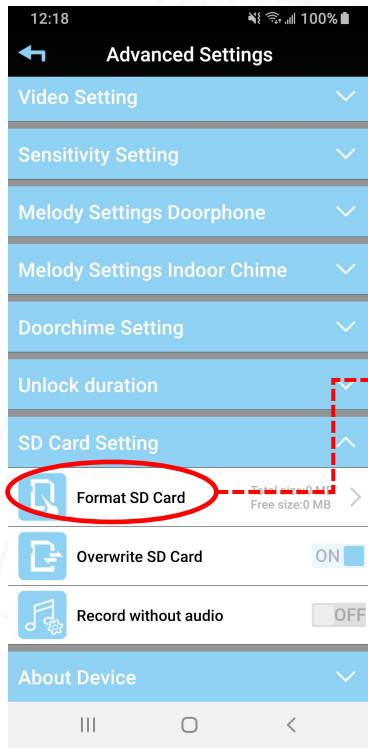

SD Card Setting – Overwrite SD Card

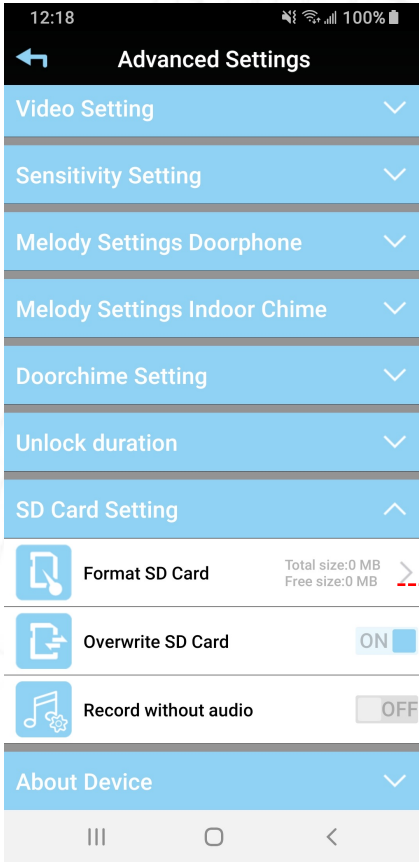

A micro SD card can become full of recordings. To avoid to remove the recordings on the micro SD card every time, this overwrite function is inside the app.

Set this feature to ON. This means that if the micro SD card is full of recordings, the next recording will overwrite the oldest recording.

In practice, this means that you can continuously look back at your recordings for an x period of time. If you turn OFF this function, the camera will continue to record the video until the micro SD card is full. After that, the camera will stop recording and will not overwrite the recordings.

SD Card Setting – Record Without Audio

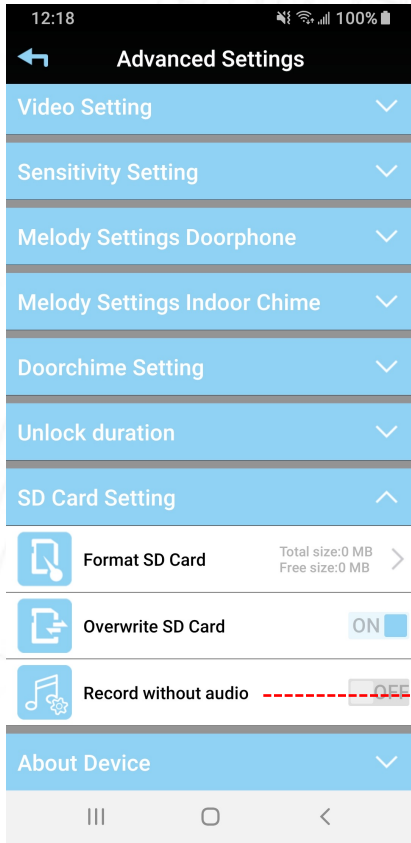

In some countries it is illegal to record audio with the video material.

ON: Record video without audio

OFF: Record video with audio.

About Device

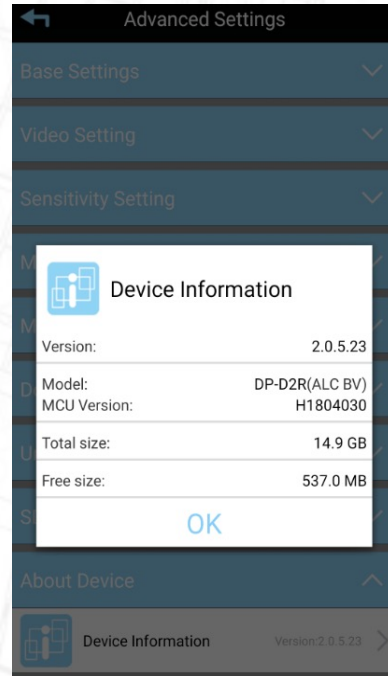
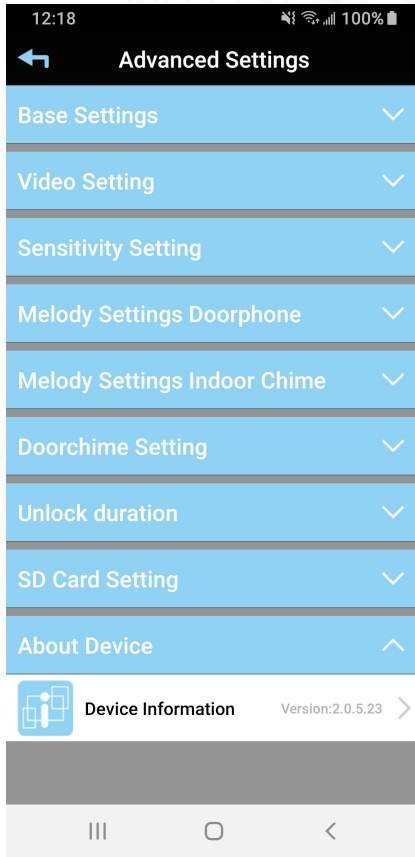

In this option you can find information about your product.

- Current Firmware Version
- Model / type number
- Size of the micro SD card in the camera and then how much is still free available on the micro SD card.

About Device – Update Firmware

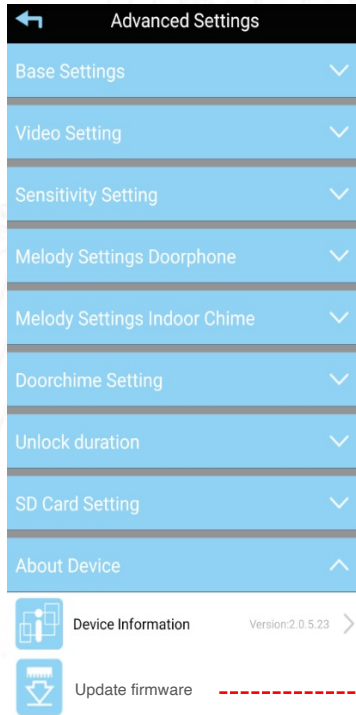

Under device information there can appear a 2nd white bar with Firmware update.

This white bar is only visible if SecuFirst has released a new firmware for your product.

New firmware is only available if a micro SD card has been installed in the product. Without a micro SD card it is not possible to receive the latest firmware.

Tab Update Firmware to install the latest firmware version to your device.

A faint, light-colored architectural floor plan of a building is visible in the background. It shows various rooms, corridors, and structural elements like walls and doors, rendered in a technical drawing style.

Connect wired internet.

On every SecuFirst camera you have the option to connect it to your wireless Wi-Fi network or via a wired internet cable.

Connect wired internet.

- The advantages of connecting an internet cable are:
 - Reliable internet. Wi-Fi is a problem all over the world.
 - Faster internet connection. Wi-Fi has internet speed loss through the air.
 - No password is required. If you get a new modem router from the (new) provider, the camera will work again immediately.
- A SecuFirst camera is not the same as a computer. The camera will only work on wired internet if you follow the order below.
 - Remove the camera adapter from the power socket.
 - Connect the Lan cable to the camera AND modem / router.
 - Insert the camera adapter back into the power socket.

The camera will start up with wired internet. If you do not apply this order, the camera will start up with wireless internet.

How to install

DID701 Connected with OUR Internet Connector (Optional)



DID701

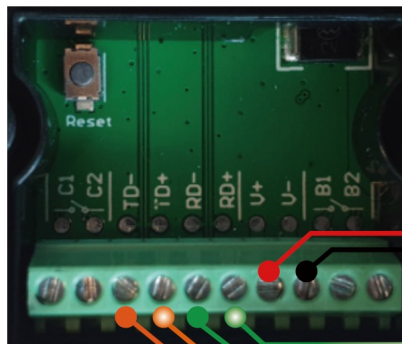

Contact TD+ / TD- /
RD+ / RD-



V+ V-
DC Adapter

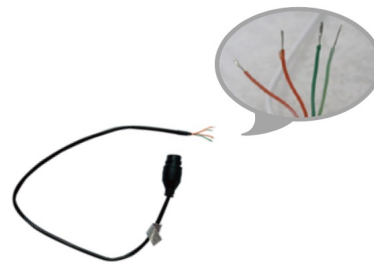

Connection with the
RJ45 plug in the box
ORANGE/WHITE TO TD+
ORANGE TO TD-
GREEN/WHITE TO RD+
GREEN TO RD-

Rj45 cable

How to install

DID701 Connected Directly with Standard Internet Cable (Optional)



DID701



Contact TD+ / TD- /
RD+ / RD-



V+ V-
DC Adapter

Connection with your own RJ45 cable

- TD + = Ethernet cable, Orange / White color wire.
- TD - = Ethernet cable, Orange color wire.
- RD + = Ethernet cable, Green / White color wire.
- RD - = Ethernet cable, Green color wire.



Rj45 cable

Connect wired internet.

- There are 2 ways to install the camera with wired internet:
 1. First install the camera on Wi-Fi using the supplied manual. When the wireless setup is complete, perform the following steps:
 1. Unplug the camera's adapter from the electrical outlet.
 2. Connect the internet cable to the camera and the modem router
 3. Then plug the adapter of the camera back into the wall socket.
 4. The camera starts up, but with the internet cable instead of Wi-Fi.
 2. Install the camera directly with wired internet.
 1. Unplug the camera's adapter from the electrical outlet
 2. Connect the internet cable to the camera and the modem router
 3. Then plug the adapter of the camera back into the wall socket.
 4. Let the camera start up, wait about 1 minute.
 5. Connect your phone or tablet to the same (Wi-Fi) network that you have wired the camera to.
 6. Open the SecuFirst app.
 7. Press "Add system" (+)
 8. Choose the installation option: "Installation with wired internet".
 9. The camera is found, tap "Next"
 10. Replace the passwords of your choice.

Connect wired internet – Important Notice

During installation, the default security password of the camera is 123456. We do not think this is secure enough and require you to change this password. The password must meet:

- A) Minimum 12 characters.
- B) At least one capital letter (Example: A)
- C) At least one lowercase letter (Example: a)
- D) At least one digit (Example: 1).
- E) At least one punctuation mark (Example: !).

The background of the slide is a detailed architectural floor plan of a building. It features a complex grid of lines representing walls, corridors, and rooms. There are numerous small circles and squares scattered throughout the plan, likely representing doors, windows, or specific points of interest. The overall style is technical and precise, typical of a professional architectural drawing.

Record Motion Detection

Record Motion Detection

Micro SD card requirements:

You can record videos only to a micro SD card. This micro SD card must comply with:

- Class 10
- UHS1
- Maximum 128GB

We prefer to use an A brand micro SD card (higher quality)



UHS 1

Class 10



UHS 3



How to exchange SD Card

Pre installed 16GB micro sd card. If you want to exchange to a bigger micro sd card, follow the below steps.

1. Please remove the screws and rubber cover in the back of the metal housing first.
2. Slide the camera upward to separate the camera with metal housing.
3. Remove the rubber cover of the Micro SD Card slot on the left side of the camera.
4. Insert the Micro SD Card and put back the rubber cover.
5. Slide the camera back in the metal housing.

Note, a micro sd card can be 16, 32 , 64 or 128GB. Do not use a bigger card. The specs of a suitable micro sd card is Maximum 128GB, UHS1 and class 10

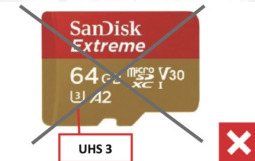
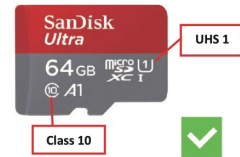
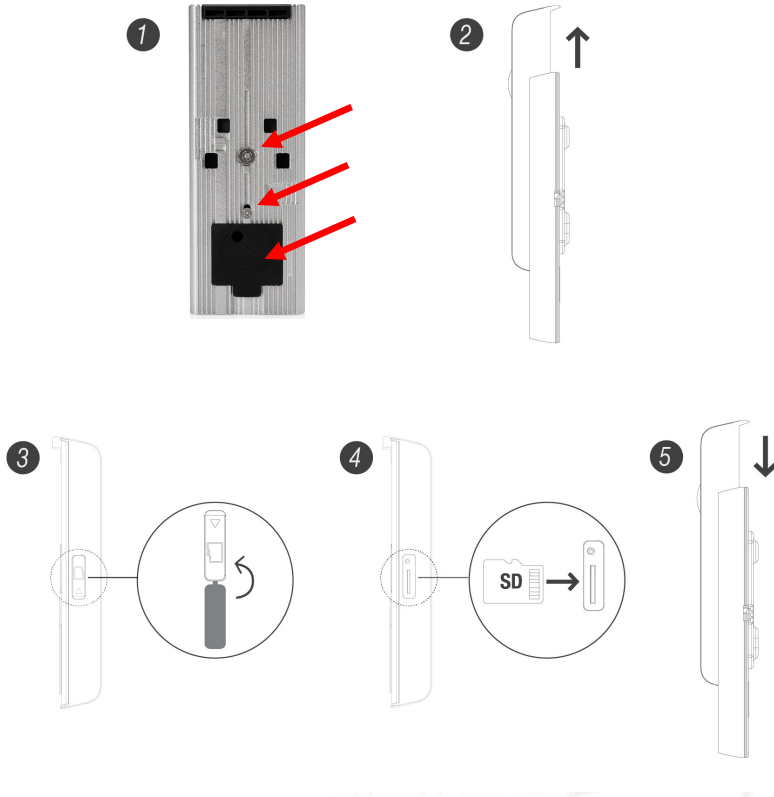

Record Motion Detection – SD Card Format

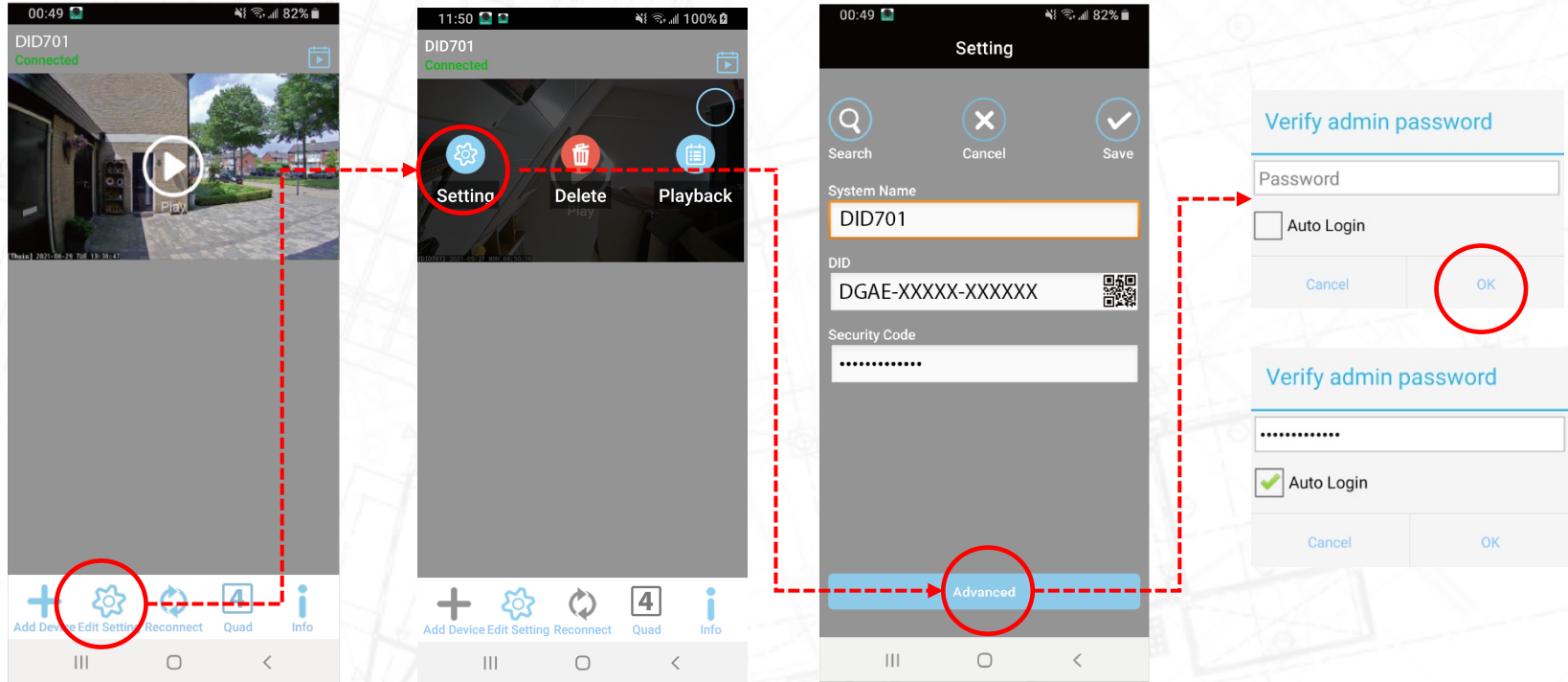

Record Motion Detection – SD Card Format

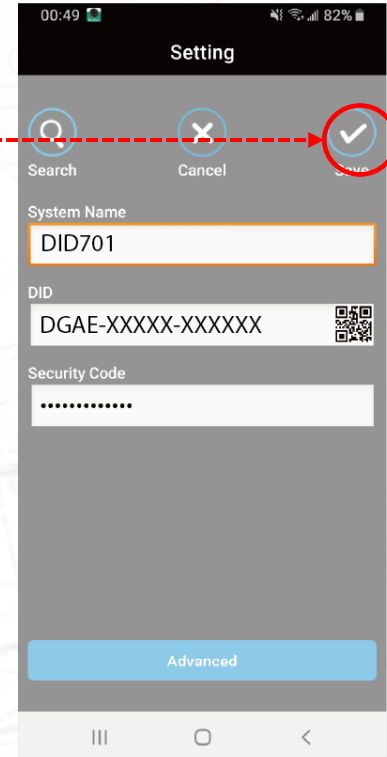
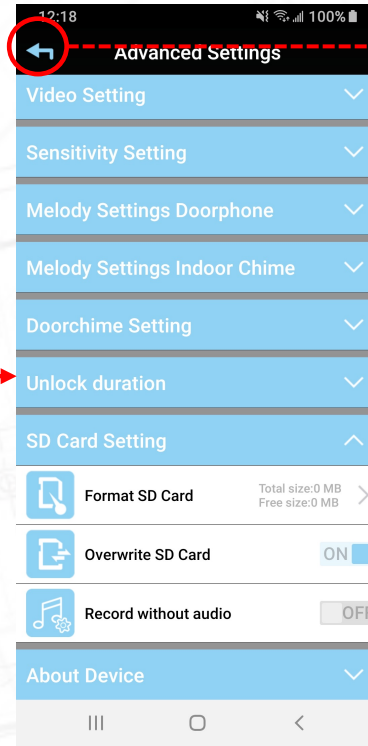
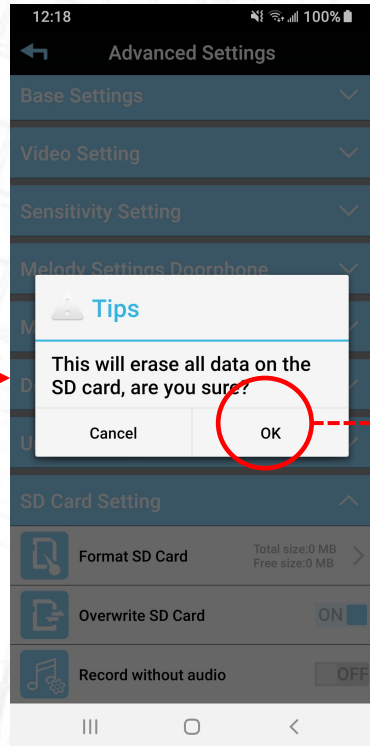
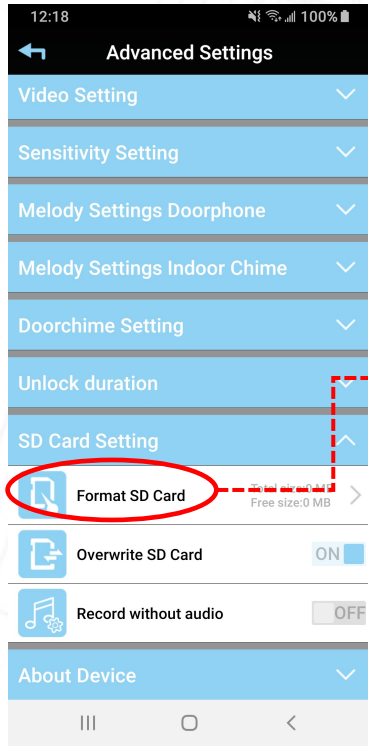

Record Motion Detection – Turn ON Motion Detection Recording

Go to the advanced settings of the camera via the app

Select the blue bar “Sensitivity” and then “Detect mode”.

Here you can switch the motion recordings on (Software) or off.

Detect mode on (Software) means: The camera will record to the micro SD card when there is movement. Detect mode off means: The camera will NOT record to the micro SD card if there is movement.

When the detect mode is turned on (Software), there will appear 2 bars at the bottom of the image.

The detecting sensitivity can be set for both day and night. Low (0%) is very insensitive, High (100%) is very sensitive to detect motions.

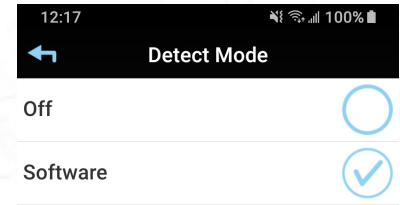

Record Motion Detection – Motion Masking

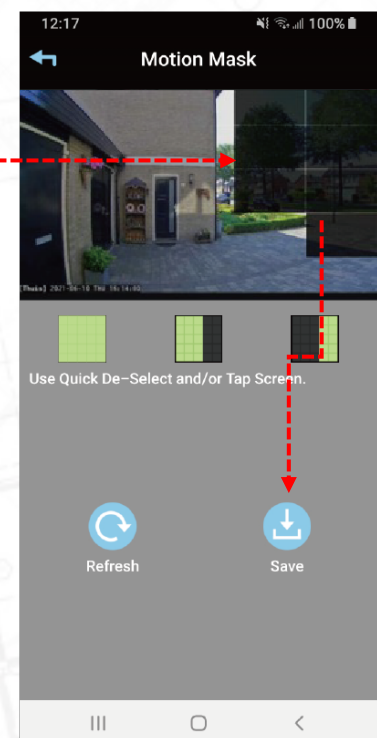
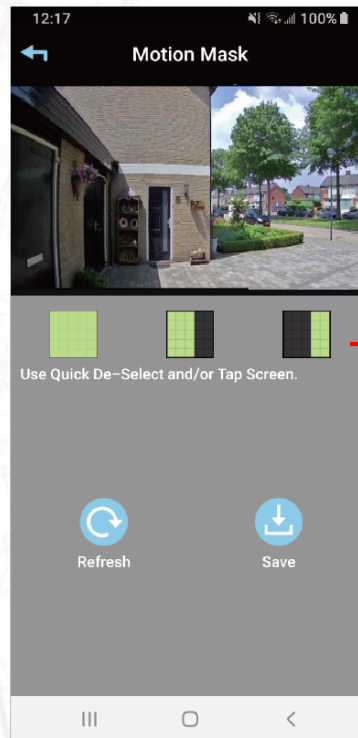
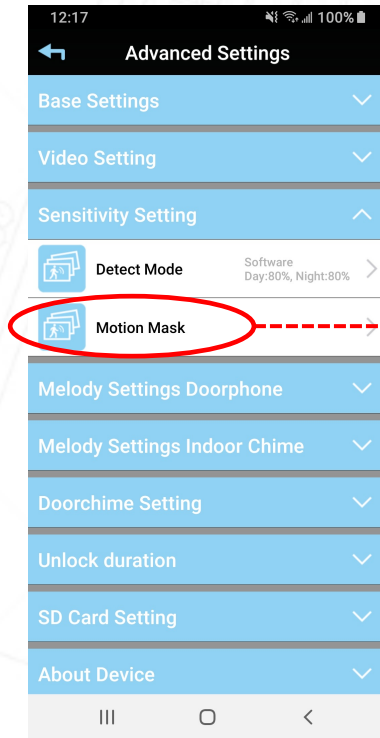

Follow the red arrow to setup motion masking

Record Motion Detection – Motion Masking

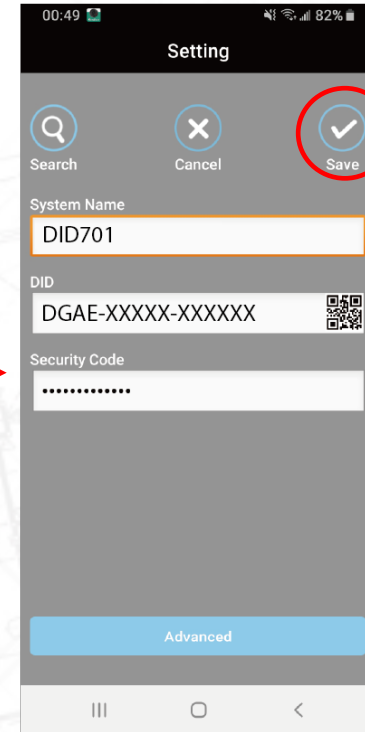
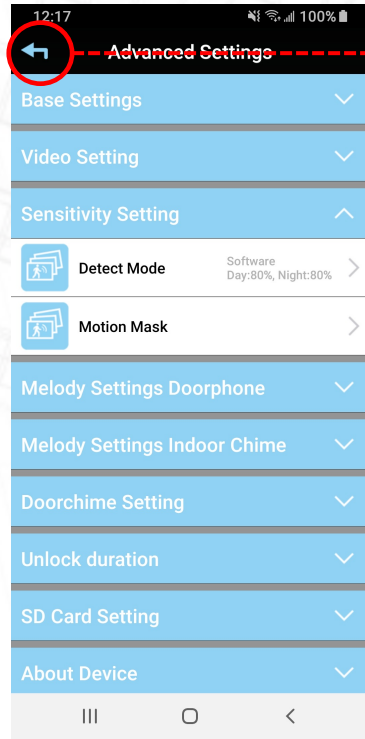

Follow the red arrow to setup motion masking

The background of the slide is a detailed architectural floor plan of a building, rendered in a light gray color. The plan shows various rooms, corridors, and structural elements like walls and doors. The text 'Playback Recordings' is centered over this background.

Playback Recordings

Playback Recordings

The recordings are saved on to a micro SD card. The images can be streamed or downloaded from anywhere in the world via the app. The only requirement is that your phone has internet. It does not matter whether this is your own Wi-Fi network, mobile data (3G, 4G or 5G) or Wi-Fi from a hotel.

Open the SecuFirst HD app

Tap edit settings at the bottom of the app

At the top of the app, tab Playback (Android) or Event (Apple)

A filter will appear in which you can specify the time period which you want to see the video recordings on the micro SD card. By default, the filter looks back 1 hour from when you tab Playback or Event. If you want to look back more than 1 hour, tab the start date or start time, and move it to the desired date. Then press OK. All recordings of the selected time frame are displayed.

Playback Recordings

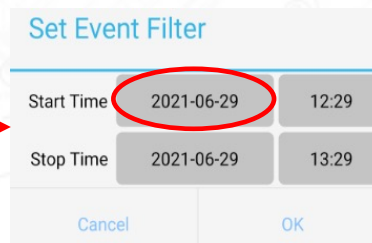
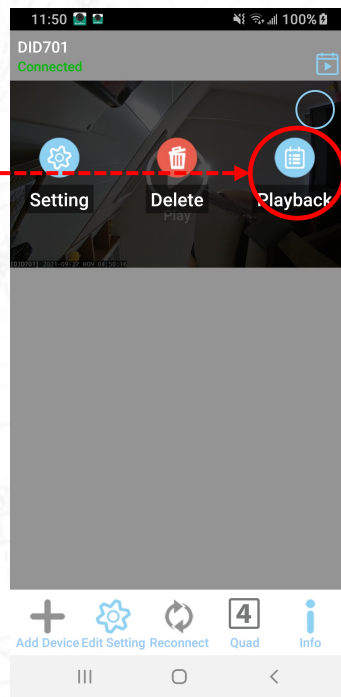
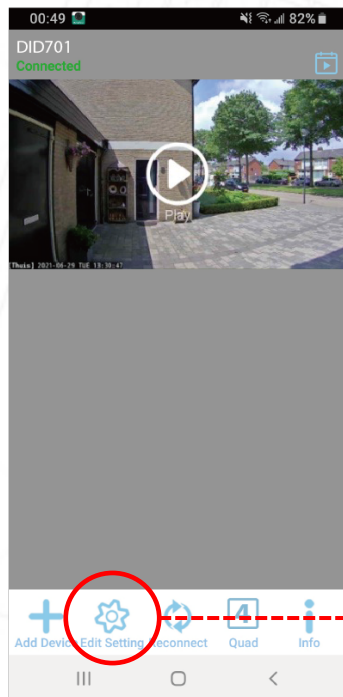

Select a start date, press “OK”

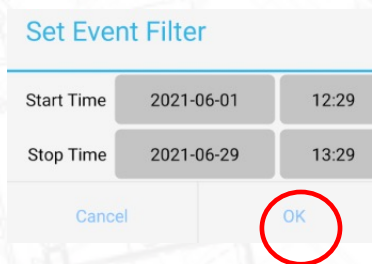

Playback Recordings

There are two ways to playback the recordings:

1. Stream the video:
 1. Tab the date / time of the video.
 2. The video will stream from the micro SD card to your phone. After watching the video, nothing will stay behind on your phone's hard drive.
2. Download the video:
 1. Tab the download button of the relevant video.
 2. The video will be copied from the micro SD card to your phone's hard drive. When the video is downloaded, the download button changes to a share button.
 3. If you tab on the share button, you can share the video with various apps on your phone, such as email or What's app.

Playback Recordings

The video can also be found manually on your phone:

1. For Android:

1. Go to “My files”
2. Tap “Internal storage”
3. Tap on the folder “Record”
4. Tap on the folder “your DID code of the camera”
5. All downloaded videos are stored here.

2. For Apple (iOS):

1. Apple limits the storage of your phone or tablet.
2. You can only find the videos if the phone or tablet is connected to the computer, through the program iTunes.
3. This is also the reason why in our app, after downloading the video, the download button changes to a share button. You can immediately share the video without the intervention of a computer.

Playback Recordings – File Sharing

Stream the video

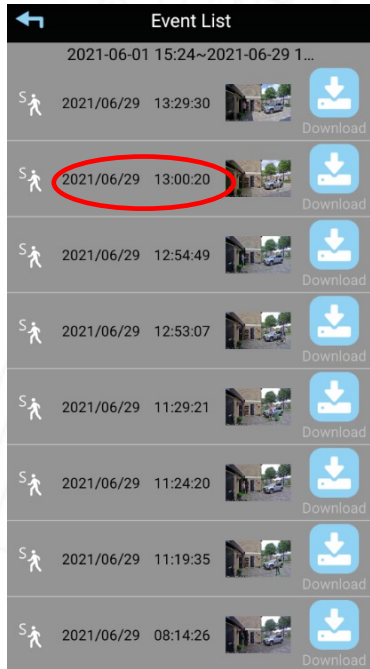

Download the video

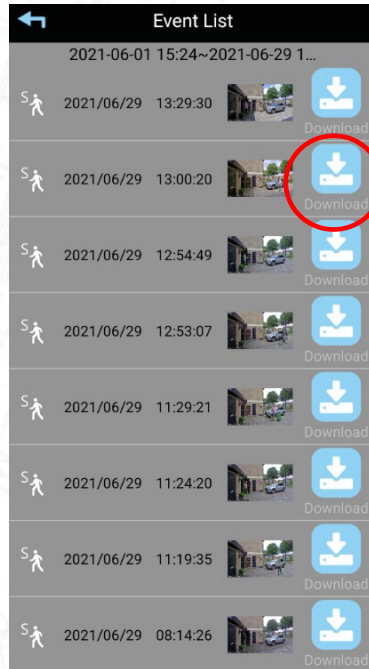

Share the video

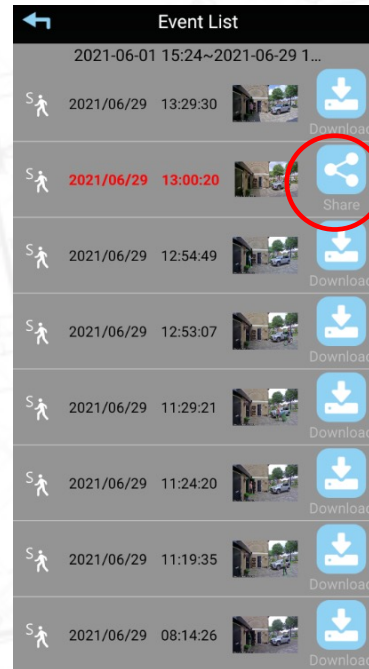

Share to email
Or Whats App

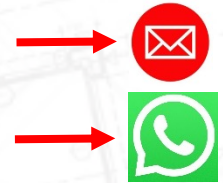

The background of the slide is a detailed architectural floor plan of a building. It shows various rooms, corridors, and structural elements like walls, doors, and windows. The drawing is rendered in a light gray color, providing a technical and professional aesthetic. The text is centered over this background.

Connect a wireless chime

Base Settings –Sensor Setup



It's possible to expand the wireless chimes to the Wi-Fi doorbell. Additional chimes can be ordered on our website www.secufirst.eu

Please note, a maximum of 2 wireless chimes can be connected to the Wi-Fi doorbell.

Connect a wireless chime

1. Tab "Edit Setting"
2. Tab "Setting" above in the app.
3. Tab "Advanced" Below in the app.
4. The app will ask you to fill in the password then press "OK". If you select "Auto Login" then next time you login, there is no need to re-enter the password.
5. Tab "OK".

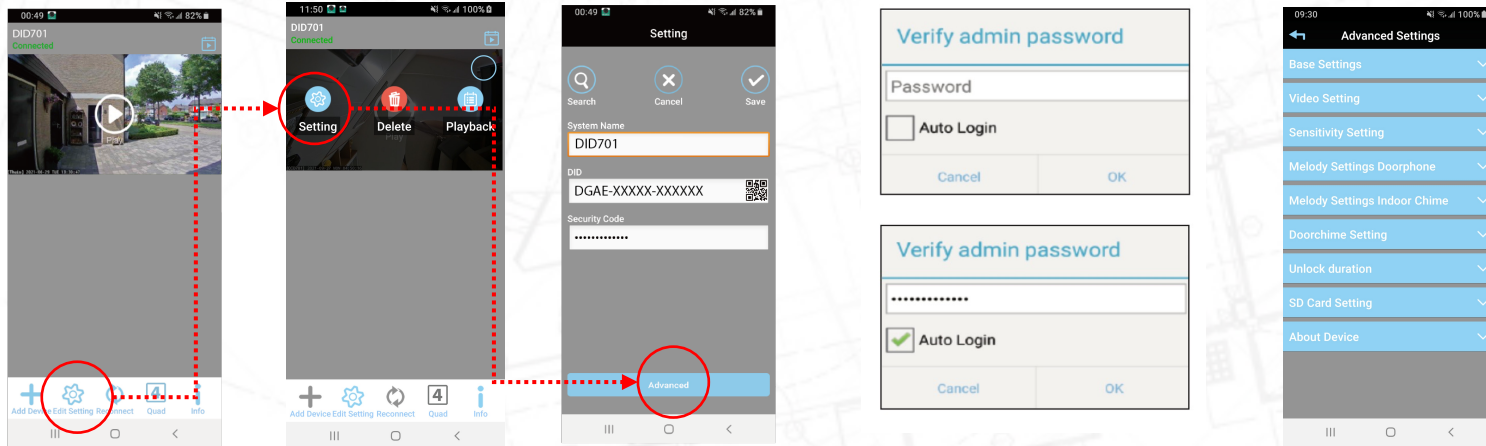

Connect a wireless chime

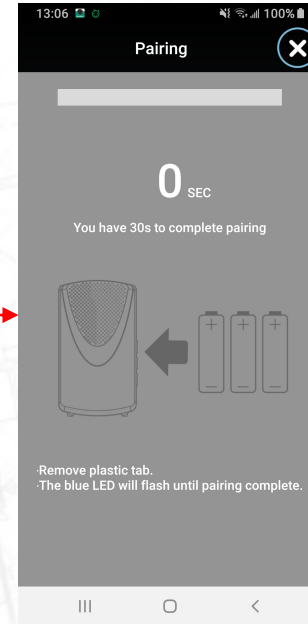
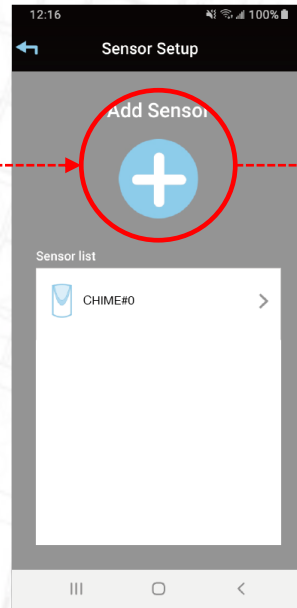
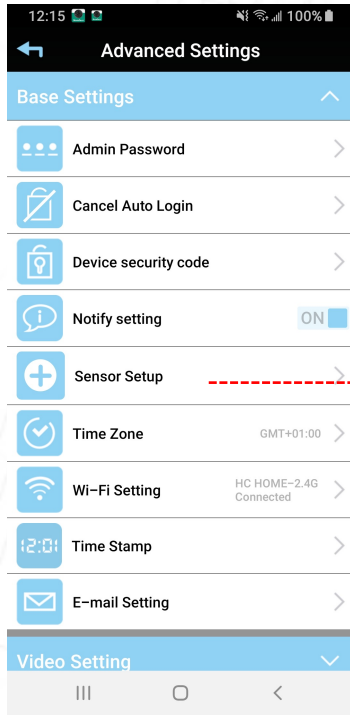

Tab on “+”

Select “Door Chime”

Insert the batteries
within 30 seconds

Connect a wireless chime

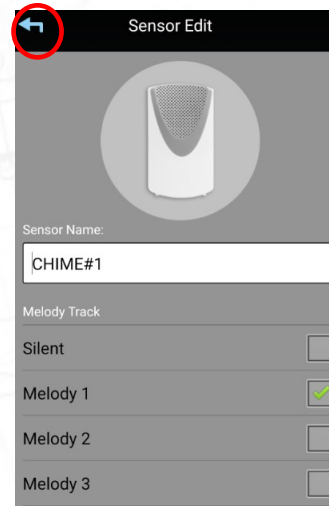
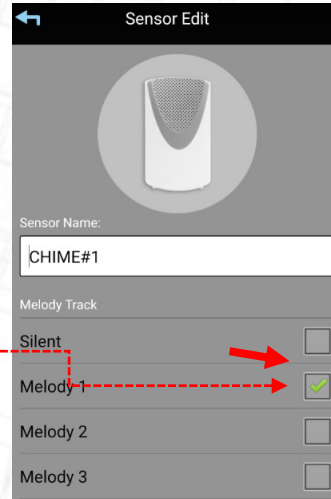
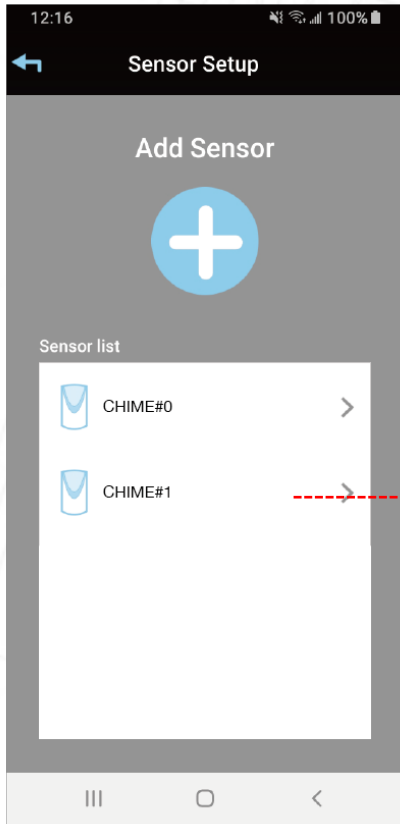

Tab the chime to select a melody and change name.

Leave the setting

The logo for SecuFIRST, with 'Secu' in a bold red font and 'FIRST' in a bold black font, both in a sans-serif typeface. The background of the entire slide is a light grey architectural floor plan with various lines, circles, and rectangles representing building structures and rooms.

SecuFIRST

- Thank you for choosing SecuFirst.

For more information, please visit our website

www.secufirst.eu

- Helpdesk SecuFirst:

E-mail: info@secufirst.eu

Telephone: 0031 (0)85 00 80 888