

# waykar

## Home Dehumidifier

Please read the manual carefully  
before using the unit

**YDA-858E**

USER MANUAL



## FOR CUSTOMERS

Thank you for purchasing our dehumidifier.

**Waykar** wishes that our products and services can bring convenience to your work and life. We highly recommend that you keep the manual for reference if you encounter unexpected events using the unit.

Please read the manual carefully to ensure proper use of the dehumidifier. Our dehumidifiers are widely used in family bedrooms, bathrooms, basements, offices and storage rooms, etc.

The dehumidifiers from **Waykar** provide quick and efficient operation to reduce room's humidity and bring you a healthy and comfortable life.

## TO ACCESS CUSTOMER SUPPORT FASTER

If there is any problem of the product, please contact Waykar Customer Service at [support@waykar.com](mailto:support@waykar.com) with your Purchase Order ID to help you address the problem more effectively.

## BEFORE FIRST USE:

To prevent any internal damage, it is very important to keep refrigeration units (like this one) upright throughout their journey.

Please leave it standing upright and outside the box for **24 HOURS** before plugging it in.

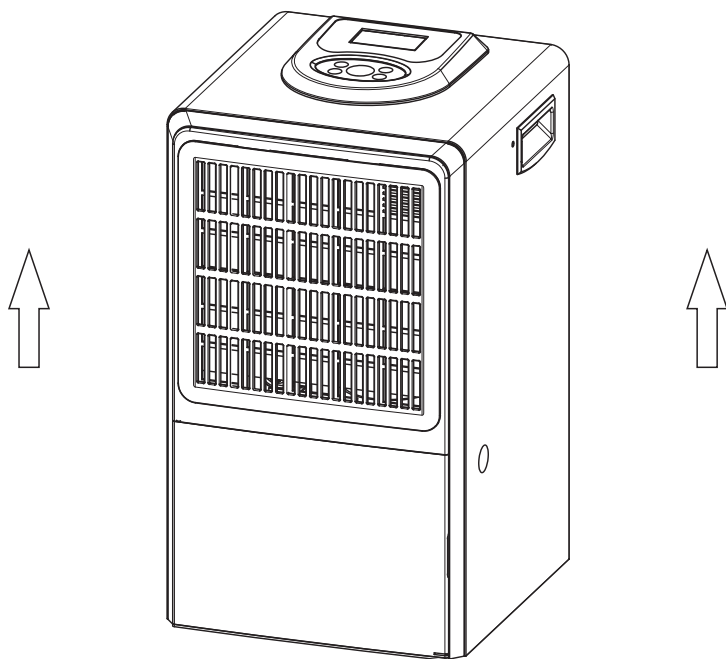

# TABLE OF CONTENTS

Safety Instructions .....	01
Parts Description .....	02
Control Interface.....	03
Operation Instructions.....	04
Cleaning and Maintenance.....	10
Common Faults and Solutions .....	11
Safety Note.....	14
Technical Parameters.....	15
Warranty & Contact Us.....	16

## Statement

The graphics and functions provided in this manual may not be the same as the actual product. Please always refer to the actual product.

The model of the machine on the manual is for reference only. Please check the corresponding content and operate the machine based on the actual product.

The right to interpret the relevant terms belongs to the company.

# SAFETY INSTRUCTIONS

## Safety Notes:

For your safety, please read the manual carefully and keep the manual before you use the manual for reference.

Please use this product according to the instructions of installation and operation of this manual.

- Before cleaning the dehumidifier, turn off the power and unplug it from the power outlet.
- Please do not place the machine near any heat source or flammable goods.
- Do not insert your fingers or sticks into the air inlet or outlet.
- Always keep the machine on even surface, instead of placing on uneven or sloping ground.
- Do not spray water, insecticides or flammable liquids on the unit.
- This machine should not be placed in a confined and narrow space.
- When the power cord is damaged, it must be replaced by the qualified technician approved by our company.
- When using the dry clothes function, the clothes should be kept at least 40cm away from the air to prevent water from entering the outlet and damage the machine.
- The machine power wiring must be in accordance with national wiring rules, and, power line should be connected to the reliable external Earth Line.
- The fixed wiring of the machine connection must be equipped with an all-pole disconnect device (air switch) with at least 0.118-inch distance of electric shock.
- Model specification of safety tube:3.15A.
- This appliance can not be used by children aged under 8 years old and persons with reduced physical, sensory or mental capabilities or lack of experience and knowledge unless they have been given supervision or instructions concerning use of the appliance in a safe way and understand the hazards involved. Children shall not play with the appliance. Cleaning and user maintenance shall not be made by children without supervision.
- When using dehumidifier, other objects surrounding the machine need to be kept at least a distance of 7.9 inches (20cm) as shown in the picture on the right:

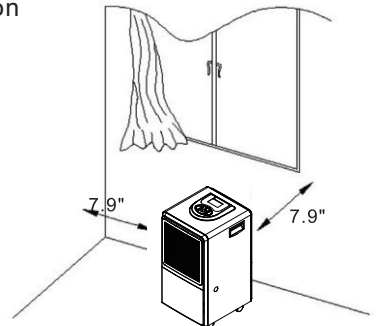

# PARTS DESCRIPTION

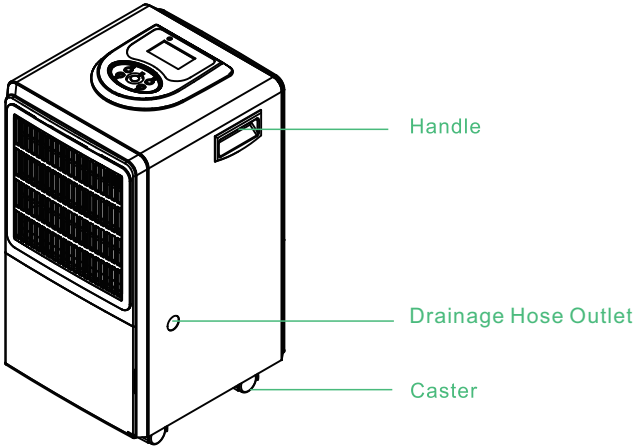
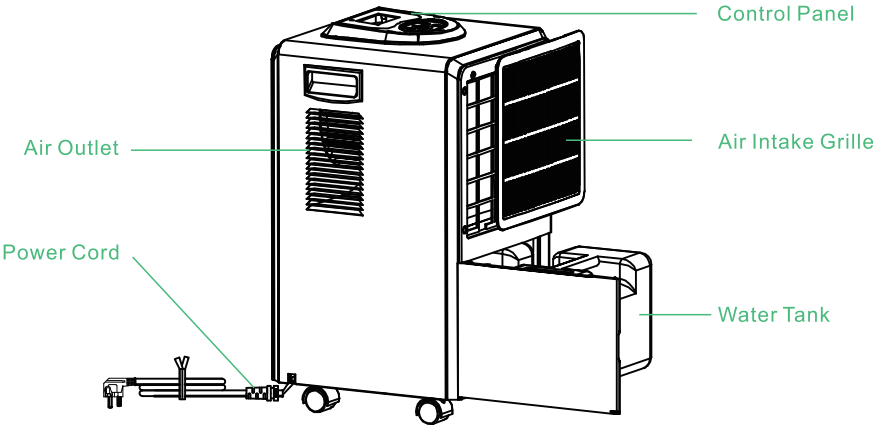

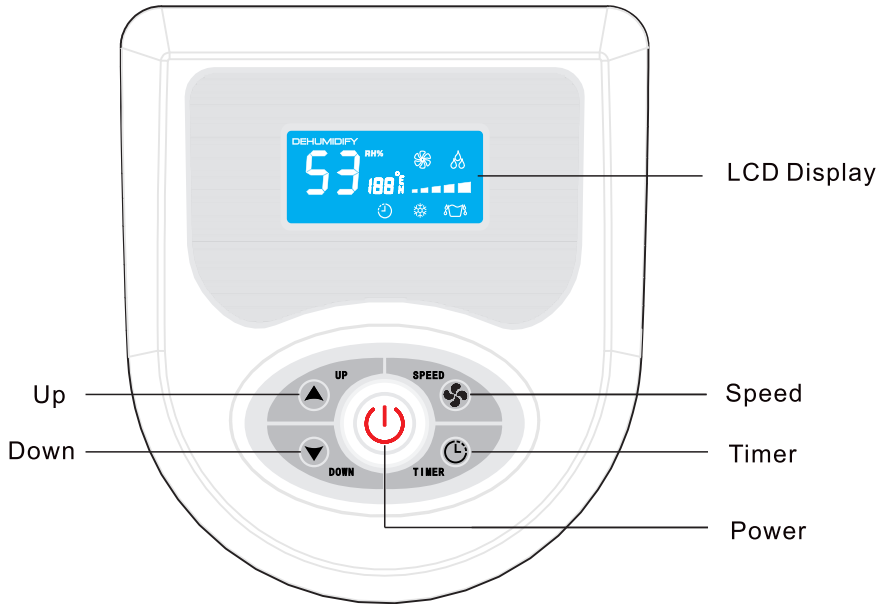

# 1. Control Panel





## Button Instructions

 **Up Button**  
Press to set the humidity up

 **Power Button**  
Press to turn the machine on or off

 **Down Button**  
Press to set the humidity down

 **Timer Button**  
Press to initiate the auto-start and auto-stop feature

 **Speed Button**  
Press to control the fan speed



## 2.Setting

### Setting Humidity

The humidity level can be set within a range of 10%RH to 99%RH in 1% increment.

- -When it starts to work, it will first automatically detect and show the room's humidity.
- -Press " UP " to make the humidity increase by 1%RH. Press "DOWN" to make it decrease by 1%RH.
- -When the humidity level is higher or drops to the level you have set, the dehumidifier will automatically begin to work or stop.
- -When the humidity level is set at 30%RH, the dehumidifier will work at continuous dehumidifying mode.

### Timer Setting

This TIMER setting function is designed for you to set a time to turn off or turn on the machine, automatically by the timer.

Press the " TIMER " button, you will enter " TIMER " setting mode: Press " UP " button to select the timer increase by 1 hour, press " Down " button to decrease by 1 hour.

Long press " UP " or " DOWN " button for seconds can continuously set a time within the range of 1 to 24 hours, it can be reset after invalid.

After no operation for seconds, it will automatically exit the TIMER setting mode.

If the time is set to 00, this is called the invalid time.

When no TIMER setting, " 188 " on the screen will display the current temperature; when you successfully set the " TIMER ", " 188 " will display the remaining setting time, and if you press the " TIMER " again for seconds, the remaining time will display the current temperature and turn back to the remaining time automatically after seconds.

# OPERATION INSTRUCTIONS



## Speed Button

You can press to the " SPEED " button to select either High or Low fan speed.

High fan speed will result in quicker moisture removal.

Set the speed high for maximum moisture removal. When the humidity has been reduced and quiet operation is more preferred, you can set the fan speed back to Low.

## Overflow Protection

When the water tank is full of water, the machine will turn off automatically. The indicator light "  " will flash. After you empty the water from the water tank, the indicator light "  " will turn off. The machine will restart to work.

## Auto Defrost

When the dehumidifier is running at a lower temperature, the system will automatically determine whether there is a presence of frost. If any frost exists, it will defrost automatically.

## Defrost Action

The fan runs at high wind speed when the compressor stops, and the screen displays the defrosting symbol. When defrosting, it is in high wind speed mode, but after defrosting, it will return to previous setting wind speed.

## Action Description

Power on:





Compressor starts after the fan has worked for a few seconds (tens of seconds when the first power-on).

Power off:

Compressor shuts down at once, and the fan will stop after a few seconds. (When other malfunction occurs, or the humidity reaches desired level, the fan will stop after tens of seconds).

The compressor features a " 3 minutes delay protection function " , when the dehumidifier is powered, the compressor can only start after 3 minutes after its last shutdown.

### 3. Display Status Description

- When the machine is powered on, the fan indicator "  " will flash.
- When the environment humidity reaches the setting value and stop dehumidification (just to maintain the setting value), the "  " indicator and humidity figure will flash on the screen.
- When the machine is running, the "  " indicator will display continuously from left to right in order.
- When running at low wind speed, the fan indicator will rotate in a lower speed, but in a high speed when high wind speed.
- After successfully set the TIMER, the "  " will light up , otherwise, it will be off.
- When defrosting, the "  " icon will flash , but go out vice versa.
- If the water tank is full , the FULL TANK indicator will light up. Otherwise, it will be off.

## 4. Faults & Protection Codes:

Number	Error Code	Name of The Fault
1	E1	Humidity sensor error
2	E2	Defrost temperature sensor error
3	E4	Temperature sensor error
4	E7	The water tank is full, empty the tank

### Attention

1. When the E1, E2, or E4 occurs, both the compressor and fan will not stop, but only signal the alarm and display the alarm code. If you power off the machine, it can be restarted after powered again.

2. When one of the above malfunctions occurs, the buzzer will alarm for a few seconds. Press any key during the alarm to release the alarm sound.

If the malfunction is still present, please don't hesitate to contact Waykar Customer Service email: [support@waykar.com](mailto:support@waykar.com) for help.

#### Note:

Before starting the machine, please ensure that the air outlet has been opened, otherwise the machine will overheat. Do not pull out the power cord directly to stop the machine.

## 5. Empty The Water Tank

Two ways are available to remove the collected water.

### Use The Water Tank

When the water tank is already full, the WATER FULL indicator will light up, the dehumidifier will automatically shut down until the tank has been emptied and placed back to the unit.

### Ways to Empty the Water Tank

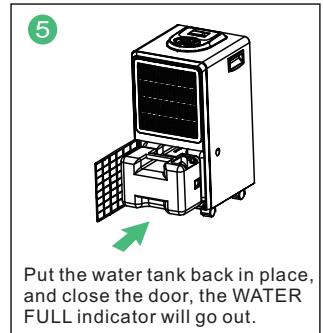
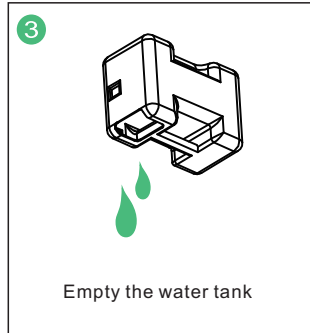
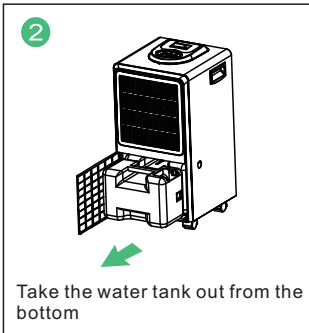
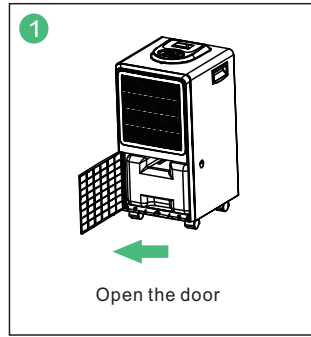
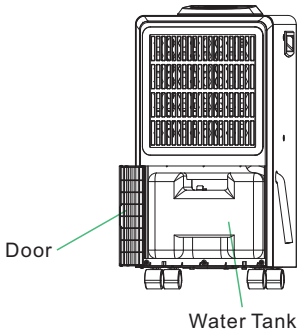

### Note:

If the water tank is dirty, just use cold water or warm water to clean it. Do not use detergent, steel wool, chemically treated dust cloth, gasoline, benzene, thinner or other solvents. Otherwise, it may damage the water tank and cause it to leak.

## 6. Continuous Drainage

Remove the power supply, open the door, take out the water tank, insert the water hose into the continuous drainage port, put the water tank back in place, and close the door. Connect the power supply to start the operation. The outlet of the water hose should be lower than the continuous drainage port by more than 3.9 inches, and the water hose cannot be bent.

(Note: The diameter of continuous drainage port is 0.63 inches.)

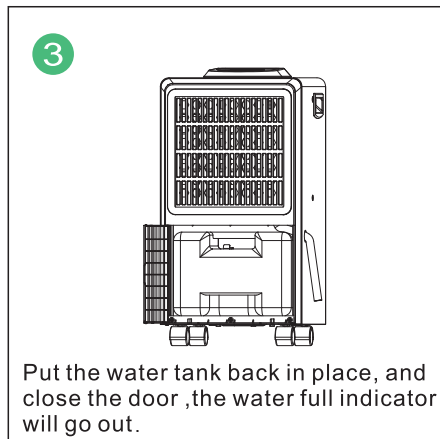
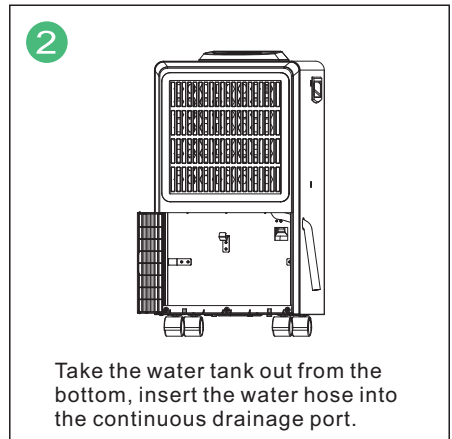
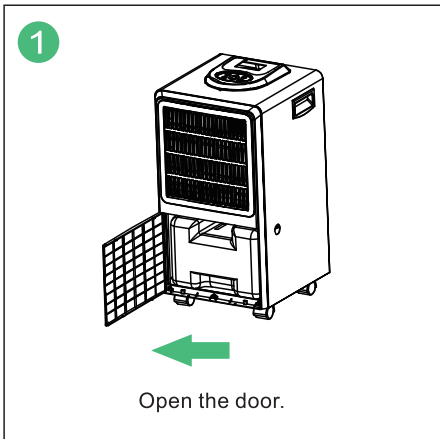

## CLEANING AND MAINTENANCE

### ⚠ WARNING:

Turn the dehumidifier off and remove the plug from the wall outlet before Cleaning.

### A- Cleaning the dehumidifier body

Please use a soft and slightly wet textile or cloth to clean it.

### B- Cleaning filter

1. Pull out the filter.
2. Clean the filter: Use a vacuum cleaner to gently remove the dust from the surface of the filter. If the filter is very dirty, wipe it with warm water and a mild detergent and dry it completely.
3. Slowly insert the filter back to the machine body.

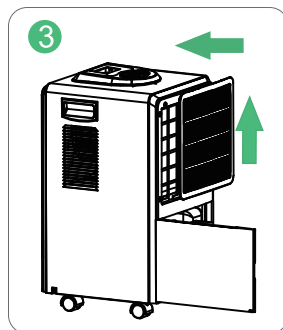
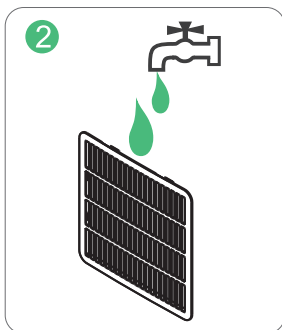
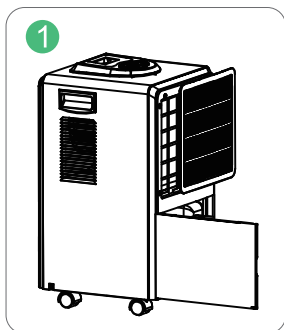

### C-Dehumidifier storage

When you want to store the dehumidifier because you don't use it for a long time. Please pay attention to the following steps:

1. Empty the water in the water tank.
2. Roll up the power cord and tie it up.
3. Clean the filter.
4. Place the machine in a cool and dry environment.

# COMMON FAULTS AND SOLUTIONS

Check the information below for troubleshooting steps, it will save you time to resolve issues that may happen with the unit.

The list includes most of the common cases, but not the results of defective unit, crafts or materials in the unit.

If all troubleshooting steps have been exhausted and the issue is still occurring, please feel free to reach out to Waykar Customer Service to get further assistance.

Problem	Reason	Method
Dehumidifier does not work	The power cord is unplugged.	Make sure that the unit's plug is inserted properly into the power outlet.
	Is the Full Tank indicator blinking? (The tank is full or in a wrong position.)	Empty the water in the water tank and then reposition the tank.
	Is the room temperature above 95°F (35°C) or below 41°F (5°C).	This product does not apply to over hot or cold environment, the machine will automatically enter the protection mode. It is a normal phenomenon.
	Is the room temperature between 41°F(5°C) and 68°F(20°C) ?	When running under lower ambient temperature, the machine will automatically defrost, which is a normal phenomenon. It will restart dehumidification again until the defrosting process finished.
	The dehumidifier is in the defrosting process.	It is normal the compressor ceases while defrosting process. Wait until the process finished, it will restart dehumidification again.
	Is the room humidity lower or reaching the preset humidity level? (When the room humidity has reached the preset level, the dehumidifier will enter Standby Mode and the indicator on LCD will flash. )	Please set the humidity decrease by 5% than the room humidity or set the humidity to 30%.
	This is to prevent the frequent start of the machine. Does the machine stop working just now?	Please wait for more than 3 minutes.
	Room humidity is low.	The dehumidifier is designed to work in the humidity range of 30%-80%. Above or below this range, it will not work.



# COMMON FAULTS AND SOLUTIONS

Dehumidifier does not dry the air as it should	The air filter is dirty.	Clean the air filter.
	Is the air inlet or air outlet obstructed?	Remove the obstruction from the air inlet or outlet.
	The dehumidifier size is too small for application.	Increase the quantity of dehumidifier. Or change to a higher capacity dehumidifier.
	Poor air circulation.	Please leave about 7.9inch (20cm) around the product
	Did not allow enough time to remove the moisture.	Allow enough time to remove the moisture. When first installed, allow at least 3-4 days to maintain the desired RH.
	The room has not been sealed properly.	Check that all doors, windows and other openings are securely closed.
	Room temperature is too low, or below 41°F (5°C): The machine will not work or undergo poor dehumidifying efficiency in low temperature.	Please wait until the temperature rises to above 5°C or higher.
The dehumidifier makes loud noise when operating	The dehumidifier is not positioned levelly.	Move the machine to a horizontal position.
	Is there blocking around the air inlet? The air filter is clogged.	Clean up the dirt or lint on the air outlet and intake.
	Is the filter installed correctly?	Please check whether the packing bag of the filter had been removed and the filter has been installed correctly.
Dehumidifier operates continuously	Check if the dehumidifier is in Continuous Mode	Do Not set the humidity too low. Typically, 40-50% are good for use.
	Room humidity is too high.	Change humidity settings. Or change to a higher capacity dehumidifier.
	Doors and windows are open.	Ensure that all doors, windows and other openings are closed.

## COMMON FAULTS AND SOLUTIONS

Overflow of water on floor	Hose to connector or hose connection may be loose.	Connect the hose with the drainage port tightly.
	The water tank has not been installed properly.	Re-install the water tank properly.
	The float of water tank has been stuck.	Move the float and let it swing freely.
	The magnet on the float has come off.	Put the magnet in right position.

### Warning:

If the dehumidifier is still not working properly as expected and the troubleshooting steps or solutions above may not resolve the issue, please unplug the power and shut down the dehumidifier, then contact Waykar Customer Service at [support@waykar.com](mailto:support@waykar.com).

# SAFETY NOTE



- 1 When using, please do not put the machine at the soft and uneven ground, avoid vibration and movement.

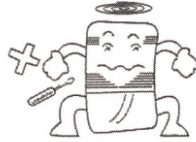

- 2 Do not insert thin rods and hard objects into the machine body to avoid malfunction and danger.



- 3 When using, please keep the machine away from heating furnace, electric kettle and other heat sources.



- 4 When using, please close doors and windows to achieve the best remove humidity effect.

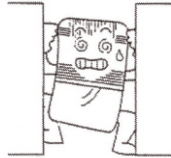

- 5 Please do not put objects around the body. If the ventilation is blocked, the dehumidification effect will be affected.



- 6 If do not use the product for a long time, please unplug the power cord.



- 7 When cleaning the dehumidifier, please use the wet textile to wipe gently, do not shoot the water directly.



- 8 Please do not put any object on the dehumidifier.



- 9 Please clean the filter every two weeks (do not use hot water above 104°F, alcohol, gasoline or toluene.)

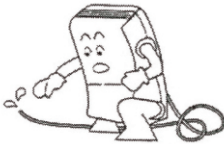

- 10 When continuous drainage, the drain hose must be placed horizontally, without unevenness and winding.



- 11 After cleaning the filter, please do not dry it under direct sunlight, in case deformation.



- 12 Before moving and carrying the machine, please first pour out the water in the tank.

## TECNICAL PARAMETERS

MODEL NO	YDA-858E
POWER SOURCE	120V~60Hz
RATED POWER (95°F, 90%RH)	1120W
RATED CURRENT (95°F, 90%RH)	10A
MOISTURE REMOVAL CAPACITY (65°F, 60%RH)	43 Pints/Day (20.3L/Day)
MOISTURE REMOVAL (80 °F, 60%RH)	62 Pints/Day (29.6L/Day)
MOISTURE REMOVAL (86 °F, 80%RH)	103 Pints/Day (48.6L/Day)
MOISTURE REMOVAL (95 °F, 90%RH)	130 Pints/Day (61.6L/Day)
INPUT POWER (65°F, 60%RH)	550W
INPUT CURRENT (65°F, 60%RH)	4.9A
IEF (65°F, 60%RH)	1.60 liters/kWh
MOTOR FLA	0.7A
MOTOR COMPRESSOR	RLA: 6.4A LRA: 38A
REFRIGERANT	R410A/16.93ozs (480g)
MAXLMUM ALLOWABLE PRESSURE	800PSIG (5.5MPa)
HIGH PRESSURE	580PSIG (4.0MPa)
LOW PRESSURE	247PSIG (1.7MPa)
DIMENSIONS	13.8x15.0x26.0inch
WEIGHT	60LB



### WARNING:

This product can expose you to chemicals including Styrene and its compounds, which is known to the State of California to cause cancer and birth defects or other reproductive harm. For more information go to: [www.P65Warnings.ca.gov](http://www.P65Warnings.ca.gov).

## Warranty

---

Waykar offers a 12-month warranty to all of our products together with the original proof of purchase when a defect occurred, including those newly purchased and unused, from Waykar or through an authorized reseller, wholly or substantially, or as a result of faulty manufacturing parts, or workmanship during the Warranty Period. The warranty does not apply if damage is caused by other factors, including but without limitation of:

- (a) Normal wear and tear;
- (b) Abuse, mishandling, accident or failure to follow operating instructions;
- (c) Exposure to liquid or infiltration of foreign particles;
- (d) Servicing or modification of the product other than by Waykar.

There are our general terms for the warranty service, but we always encourage our customers to contact us if any issues, regardless of warranty terms. If you are experiencing an issue with Waykar product, you can reach out to us at [support@waykar.com](mailto:support@waykar.com), we will dedicate our efforts to resolve it for you.

## Extend Your Warranty by 1 Year

---

Register your product at [www.waykar.com](http://www.waykar.com) to extend your 1-year warranty by an additional year.

\*Please fill out all required fields and include your Order ID, Date of Purchased if applicable.

## Customer Support

---

If you have any questions or concerns about your product, please feel free to contact our expert support team. Waykar customer service is here to help.

### **Waykar Office**

13211, Spring Street Baldwin Park, CA, US

Email: [support@waykar.com](mailto:support@waykar.com)

Live Chat: [www.waykar.com](http://www.waykar.com)

### **Support Hours**

24 Hours available

\*Please have your Order Number ready before contacting customer support.

# waykar

For FAQs and more information please visit:

[www.waykar.com](http://www.waykar.com)



@Waykar



@Waykar



@Waykar



@Waykar



(Scan the QR Code for Live Chat)

We are expecting to see our products fulfill your life and hear your voice.

Your satisfaction means a lot to us.

Please tag us if you share a snap on your social media.

[www.waykar.com](http://www.waykar.com)