

BagBoy®

NITRON™ Instructions



For additional assistance, please contact us at 1-800-955-2269
Warranty information is available at bagboy.com

ENGLISH

We congratulate you on your purchase of a Bag Boy Nitron golf cart and appreciate your confidence in our products. Please read the following important information and assembly instructions before the first use.

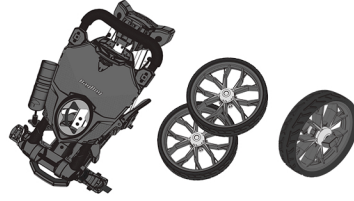

Remove the cart from the carton and check that the following items are included:

- 1 Nitron frame
- 2 Rear wheels
- 1 Front wheel
- 1 Umbrella holder
- 1 Allen key

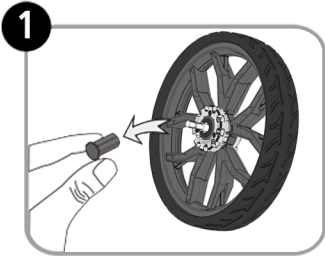

Remove the black plastic cap from the rear wheel axles.

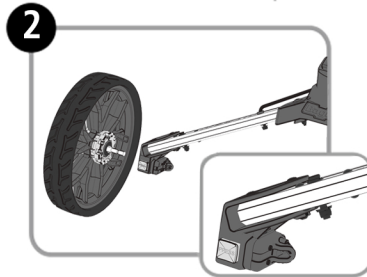

Install the rear wheels by pressing the "PRESS" button and inserting the axle of the wheel into the cart until the wheel clicks into place.

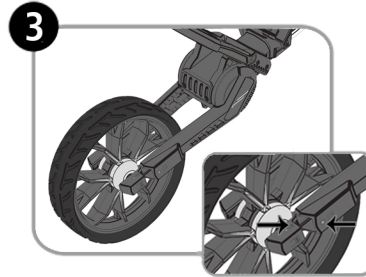

Install the front wheel by aligning the STAR on the wheel axle and the front fork of the cart and slide the front wheel into the fork blades until it clicks and locks into place.

NOTE: The fork blades may need to be spread apart and the fit will be snug.

TO UNFOLD THE NITRON

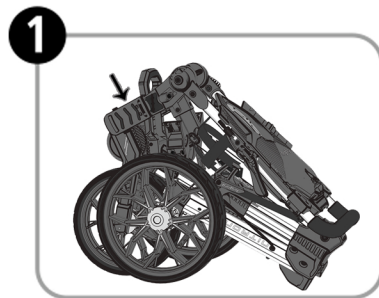

With the cart on the ground, pull sharply on the upper bag bracket and lift the Nitron until the cart fully opens.

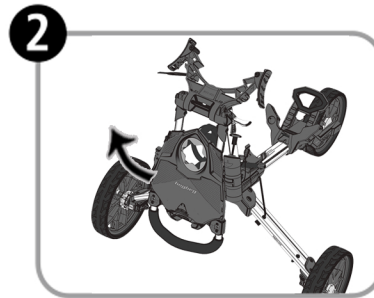

Flip the gray Handle Release Lever and adjust the handle to the desired height. Close the lever to lock the handle into position.

ADDITIONAL FEATURES

Hand Operated Parking Brake

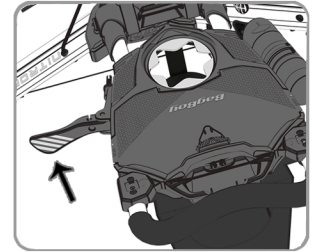

Pull upward to engage the parking brake and push down to release the parking brake.

Umbrella Holder (optional)

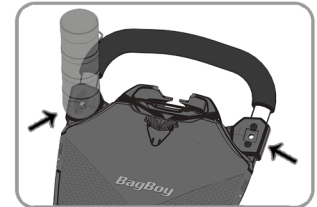

Can be installed on either side of the handlebar in the area marked with the umbrella symbol.

Mobile Device Holder

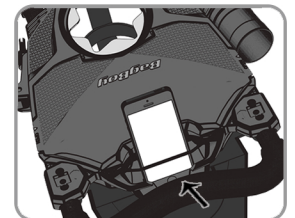

Located on the back of the scorecard holder is a slot and bungee system designed to hold a smartphone or GPS unit in place. CAUTION: This bungee does not LOCK the phone in place. Please remove the device before folding the cart.

TO FOLD THE NITRON

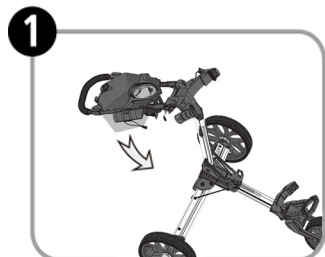

Flip the gray Handle Release Lever and lower the handle to the downward position and lock into place.

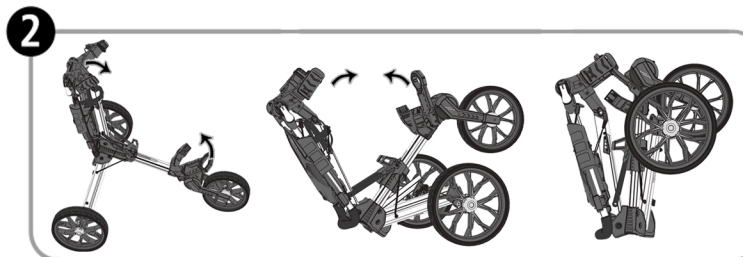

Holding the upper and lower bag bracket, pull both sides together until the front wheel folds inward and the cart is completely closed.

FRONT WHEEL ALIGNMENT / TRACKING

If the cart is not tracking straight you can easily re-align the front wheel by using the provided allen wrench and locating the allen head screw on the front fork of the cart.

Pulling to the left: Turn clockwise.
Pulling to the right: Turn counterclockwise.

