

RL2000ST

Stainless Steel, Environmentally Sealed, NTEP Certified 1:10,000 Class III Single Cell, IP67



Picture is a representation of actual product.

Approvals



Order Information

Load Rating	Part #	Est. Weight	Price
50 lb	72741	2 lb	Consult
100 lb	72742	2 lb	Consult
200 lb	72743	2 lb	Consult
250 lb	72744	2 lb	Consult
300 lb	72745	2 lb	Consult
500 lb	72746	2 lb	Consult
750 lb	72747	2 lb	Consult
1,000 lb	72748	2 lb	Consult
1,500 lb	72749	2 lb	Consult
2,000 lb	72750	2 lb	Consult
2,500 lb	72751	2 lb	Consult
3,000 lb	72752	4 lb	Consult
5,000 lb	72753	4 lb	Consult
Conduit Adapter Kit* (must be factory installed to maintain warranty)			
3/8-24 nipple	31533*	1 lb	Consult
3/8-24 to 1/4-18 NPT	31534*	1 lb	Consult

*PN 31533 and PN 31534 must be installed together to form the Conduit Adapter Kit.

Dimensions

Rated Capacity	A	B	C	D	E
lb/in					
50 to 300	1/4-28 UNF	0.65	0.46	2.00	2.40
500 to 1,000	1/2-20 UNF	0.90	0.71	2.00	2.40
1,500 to 2,500	1/2-20 UNF	1.15	0.96	2.00	2.40
3,000	1/2-20 UNF	1.15	0.96	3.00	3.90
5,000	3/4-16 UNF	1.15	0.96	3.00	3.90

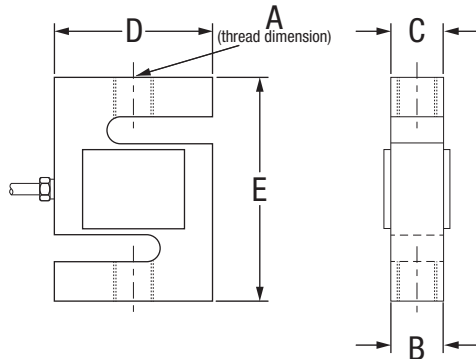

Specifications

- Full Scale Output:** 3.0 mV/V
- Output Resistance:** 350 (±3.5) ohm
- Input Resistance:** 430 (± 60) ohm
- Material/Finish:** Stainless steel
- Temperature:** Compensated range 14 °F to 104 °F (-10 °C to 40 °C)
Operating range 0 °F to 150 °F (-18 °C to 65 °C)
- Seal Type:** Environmentally sealed, IP67
- Safe Overload:** 150% full scale
- Rated Excitation:** 5 to 10 VDC (15 V maximum)
- Combined Error:** 0.03% full scale
- Insulation Resistance:** 5,000 megohm
- Cable Length:** 20 ft
- Cable Diameter:** 0.190 in polyurethane jacket
- Cable Color Code:** Red +Excitation
Black -Excitation
Green +Signal
White -Signal
- Warranty:** Two-year limited
- Approvals:** NTEP 03-007
FM