



Picture is a representation of actual product.

**Approvals**



**Order Information**

Load Rating	Part #	Est. Weight	Price
<b>NTEP Certified</b>			
100 lb	46511	2 lb	Consult
250 lb	46503	2 lb	Consult
300 lb	181826	2 lb	Consult
500 lb	46504	2 lb	Consult
750 lb	46505	2 lb	Consult
1,000 lb	46506	2 lb	Consult
2,500 lb	46507	2 lb	Consult
3,000 lb	46508	4 lb	Consult
5,000 lb	46509	4 lb	Consult
10,000 lb	46510	4 lb	Consult
<b>Non-NTEP Certified</b>			
50 lb	17013	2 lb	Consult
15,000 lb	158375	7 lb	Consult
20,000 lb	158376	13 lb	Consult
<b>Conduit Adapter Kit* (must be factory installed to maintain warranty)</b>			
3/8-24 nipple	31533*	1 lb	Consult
3/8-24 to 1/4-18 NPT	31534*	1 lb	Consult

\* PN 31533 and PN 31534 must be installed together to form the Conduit Adapter Kit

**Dimensions**

Rated Capacity	A	B	C	D	E
lb/in					
50 to 300	1/4-28 UNF	0.65	0.46	2.00	2.40
500 to 1,000	1/2-20 UNF	0.90	0.71	2.00	2.40
2,500	1/2-20 UNF	1.15	0.96	2.00	2.40
3,000	1/2-20 UNF	1.15	0.96	3.00	3.90
5,000	3/4-16 UNF	1.15	0.96	3.00	3.90
10,000	3/4-16 UNF	1.40	1.21	3.00	3.90
15,000	1-14 UNS	1.63	1.46	3.44	5.50
20,000	1 1/4-12 UNF	1.88	1.68	4.44	7.00

**Interchangeable Products**

VPG® REVERE  
**9363** ..... page 244  
ARTECH®  
**SS2010**

**Weigh Module Available**

RICE LAKE WEIGHING SYSTEMS  
**ITCM Isolated Tension Cell Mount** ..... page 28

**Specifications**

- Full Scale Output:**  
3.0 (± 0.008) mV/V
- Output Resistance:**  
350 (± 3.5) ohm
- Input Resistance:**  
390 (± 15) ohm
- Material/Finish:**  
Stainless steel
- Temperature:**  
Compensated range  
14 °F to 104 °F (-10 °C to 40 °C)  
Operating range  
0 °F to 150 °F (-18 °C to 65 °C)
- Seal Type:**  
Environmentally sealed, IP67
- Safe Overload:**  
150% full scale
- Rated Excitation:**  
5 to 10 VDC (15 V maximum)
- Combined Error:**  
0.03% full scale
- Insulation Resistance:**  
5,000 megohm
- Cable Length:**  
20 ft
- Cable Color Code:**  
Red +Excitation  
Black -Excitation  
Green +Signal  
White -Signal
- Warranty:**  
Two-year limited
- Approvals:**  
NTEP 98-078  
cFMus

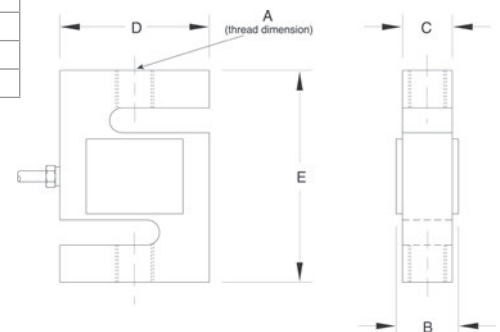

**RICE LAKE  
LOAD CELLS**