

Atlantis[®] Wall Panel Drainage System

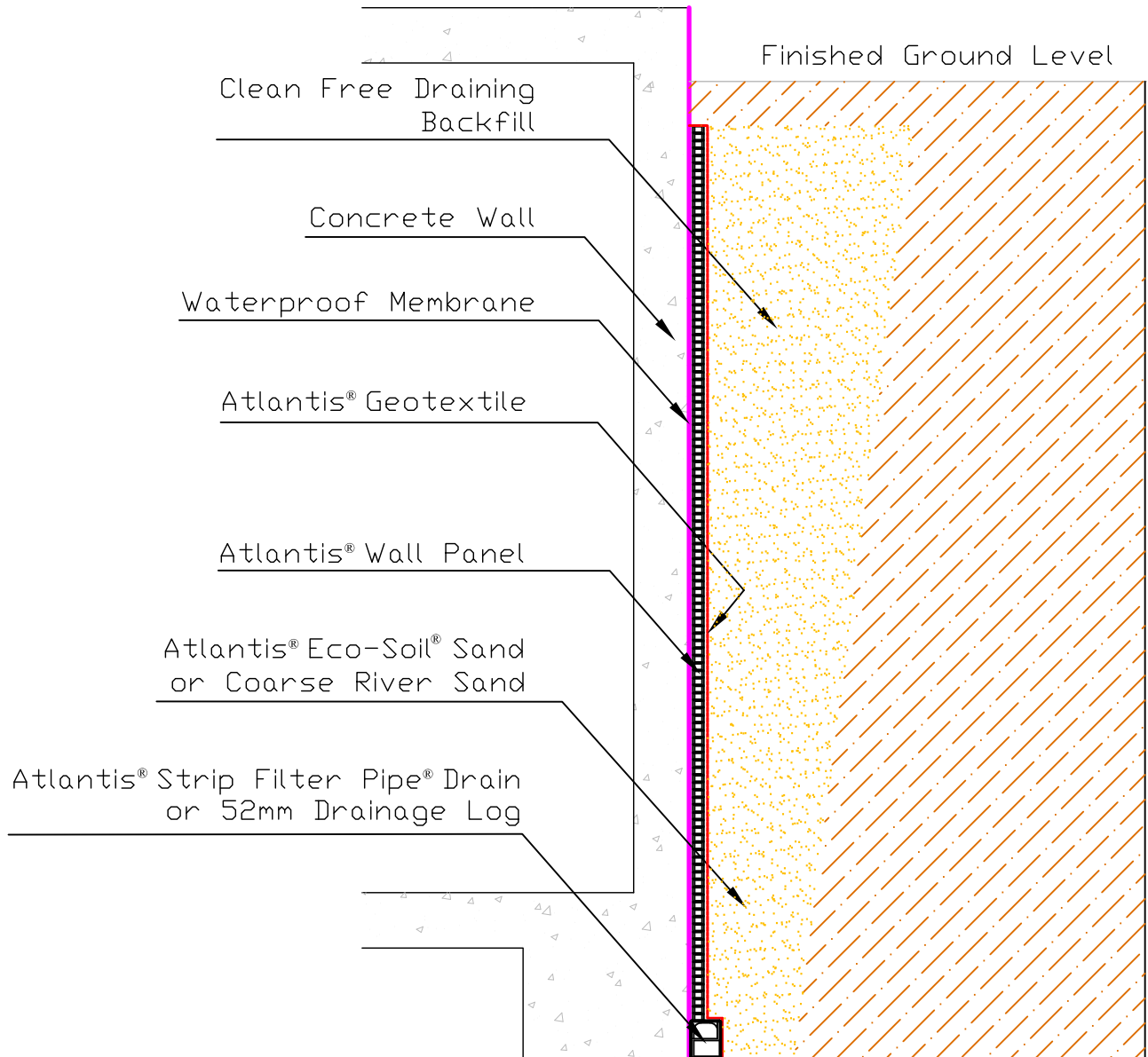

DISCLAIMER: All information provided in this publication is correct to the best of the Company's Knowledge and is given out in Good Faith. This information is intended only as a general guide, no responsibility can be accepted for any errors, omissions or In-correct assumption. As each project is unique, and as Rebirth Pty Ltd, Atlantis Water Management, Atlantis Corporation Pty Ltd and Its Distributors and Agents World Wide have no direct control over the methods employed by the User in Specifying, Installing or Supervising of its products hence no Responsibility is accepted by Rebirth Pty Ltd, Atlantis Water Management, Atlantis Corporation Pty Ltd and Its Distributors and Agents World Wide. Users should satisfy themselves as to the suitability of the product for their purpose.

All product designs, and specification are subject to change without further notice. All Atlantis[®] products are tested in approved NATA laboratories, and safe allowed tolerance should be practised in actual field, due to any unforeseen situations, onsite and on products. All material contained within this brochure is copyright, and belongs to Rebirth Pty Ltd Australia. No part of this brochure may be reproduced or transmitted in any form or by any means, electronic, mechanical, photocopying, recording or otherwise, without prior written permission of Rebirth Pty Ltd. Australia, Atlantis Water Management, Atlantis Corporation Pty Ltd. Copyright © 2005 by Rebirth Pty Ltd. Australia, Atlantis Water Management, Atlantis Corporation Pty Ltd. Australia.

Drawing No: ADP 0031

Atlantis[®] Wall Panel Drainage System - with Mini Matrix[®] tank

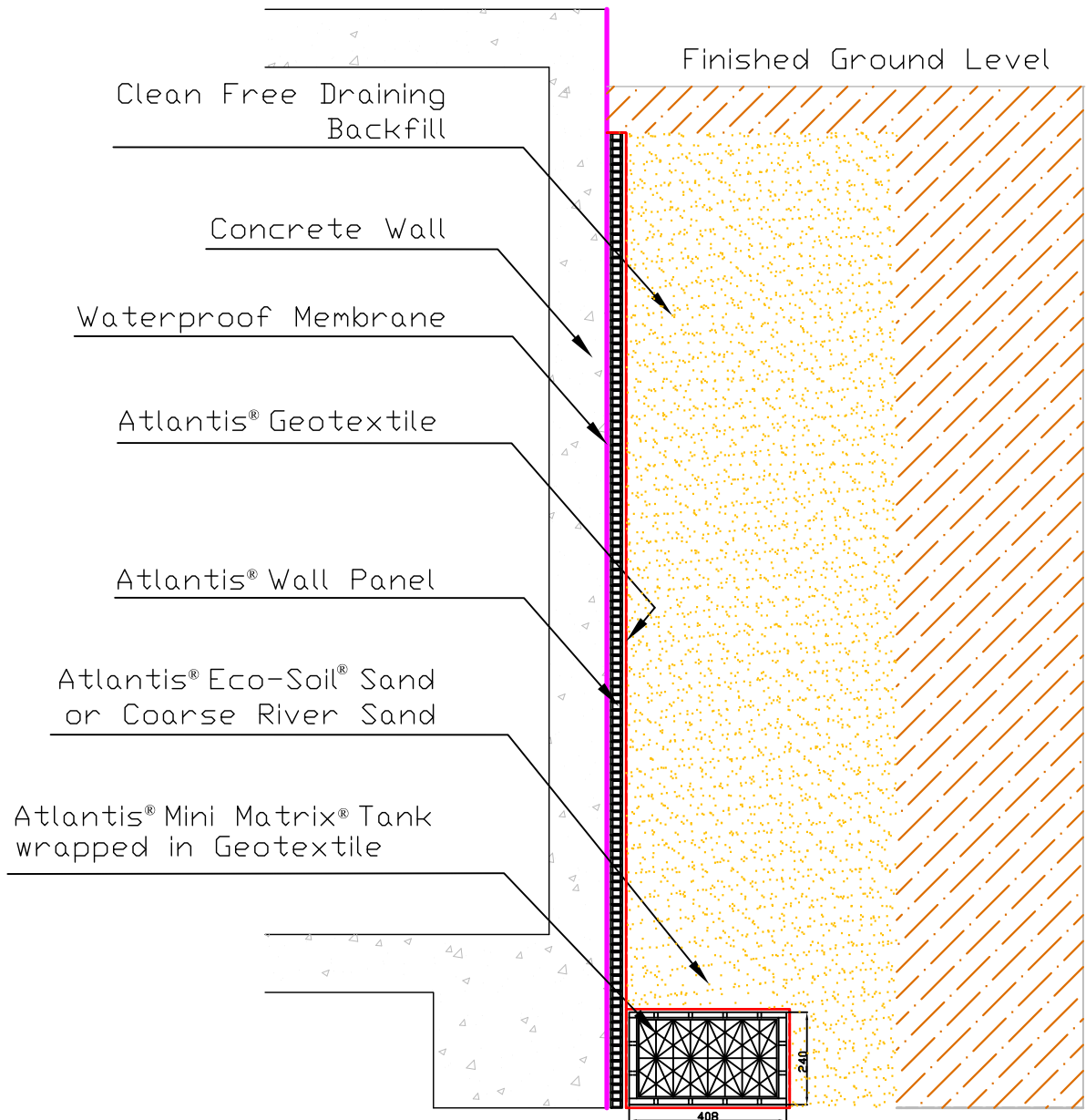

DISCLAIMER: All information provided in this publication is correct to the best of the Company's Knowledge and is given out in Good Faith. This information is intended only as a general guide, no responsibility can be accepted for any errors, omissions or In-correct assumption. As each project is unique, and as Rebirth Pty Ltd, Atlantis Water Management, Atlantis Corporation Pty Ltd and Its Distributors and Agents World Wide have no direct control over the methods employed by the User in Specifying, Installing or Supervising of its products hence no Responsibility is accepted by Rebirth Pty Ltd, Atlantis Water Management, Atlantis Corporation Pty Ltd and Its Distributors and Agents World Wide. Users should satisfy themselves as to the suitability of the product for their purpose.

All product designs, and specification are subject to change without further notice. All Atlantis[®] products are tested in approved NATA laboratories, and safe allowed tolerance should be practised in actual field, due to any unforeseen situations, onsite and on products. All material contained within this brochure is copyright, and belongs to Rebirth Pty Ltd Australia. No part of this brochure may be reproduced or transmitted in any form or by any means, electronic, mechanical, photocopying, recording or otherwise, without prior written permission of Rebirth Pty Ltd. Australia, Atlantis Water Management, Atlantis Corporation Pty Ltd. Copyright © 2005 by Rebirth Pty Ltd. Australia, Atlantis Water Management, Atlantis Corporation Pty Ltd. Australia.

Drawing No: AQP 0031a

Atlantis[®] Wall Panel Drainage System - with Tiny Matrix[®] tank

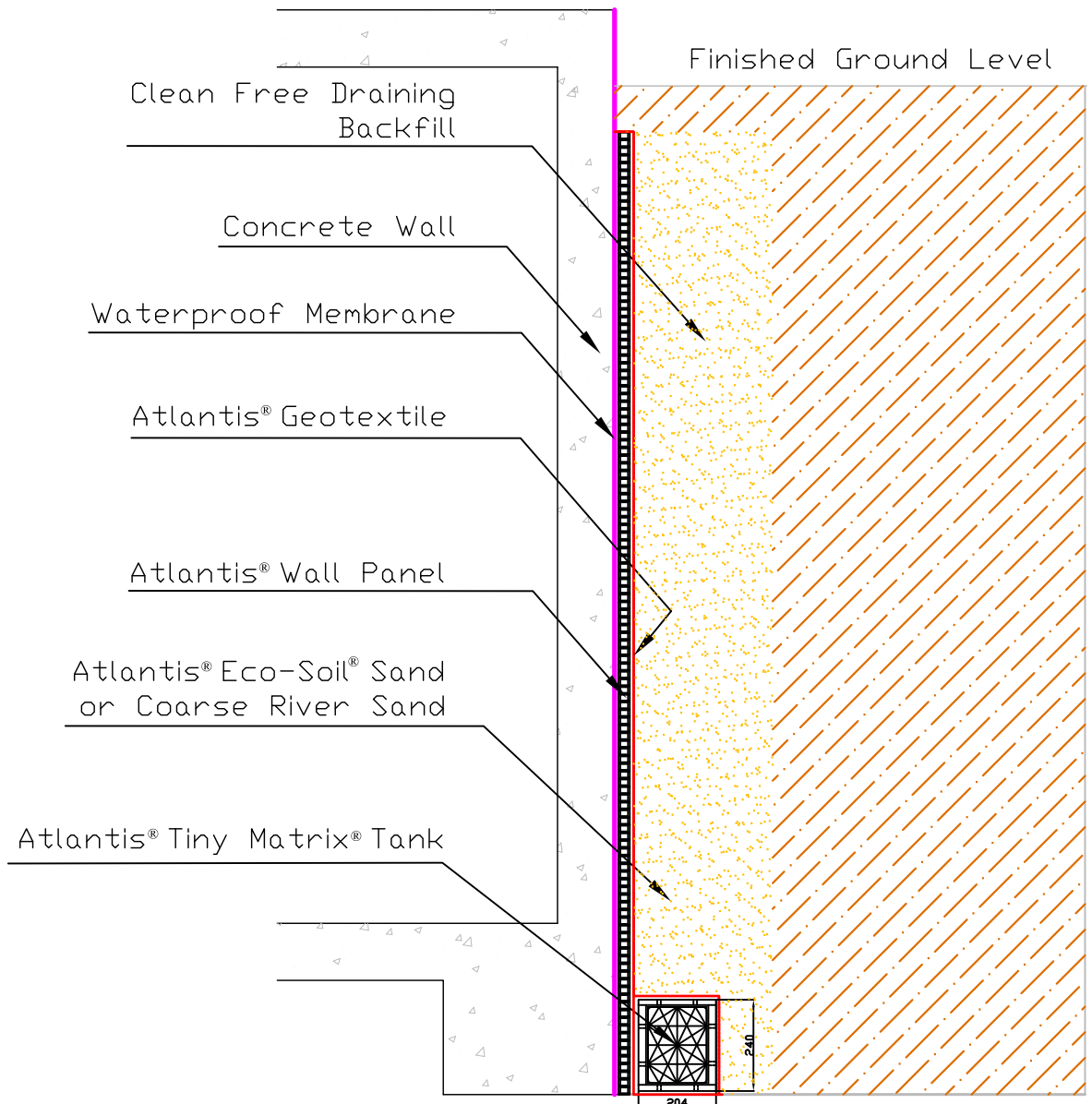

DISCLAIMER: All information provided in this publication is correct to the best of the Company's Knowledge and is given out in Good Faith. This information is intended only as a general guide, no responsibility can be accepted for any errors, omissions or In-correct assumption. As each project is unique, and as Rebirth Pty Ltd, Atlantis Water Management, Atlantis Corporation Pty Ltd and Its Distributors and Agents World Wide have no direct control over the methods employed by the User in Specifying, Installing or Supervising of its products hence no Responsibility is accepted by Rebirth Pty Ltd, Atlantis Water Management, Atlantis Corporation Pty Ltd and Its Distributors and Agents World Wide. Users should satisfy themselves as to the suitability of the product for their purpose.

All product designs, and specification are subject to change without further notice. All Atlantis[®] products are tested in approved NATA laboratories, and safe allowed tolerance should be practised in actual field, due to any unforeseen situations, onsite and on products. All material contained within this brochure is copyright, and belongs to Rebirth Pty Ltd Australia. No part of this brochure may be reproduced or transmitted in any form or by any means, electronic, mechanical, photocopying, recording or otherwise, without prior written permission of Rebirth Pty Ltd. Australia, Atlantis Water Management, Atlantis Corporation Pty Ltd. Copyright @ 2005 by Rebirth Pty Ltd. Australia, Atlantis Water Management, Atlantis Corporation Pty Ltd. Australia.

Drawing No: ADP 0031b

Frequently Asked Questions and Answers Wall Panels



Question: How do you prevent geotextile from clogging?

Answer: By backfilling with a free draining coarse river sand with no fines.

Question: Can I shotcrete the wall panels?

Answer: Yes.

Question: Can I cut the wall panels?

Answer: Yes, a circular saw or hacksaw can be used to cut the panels to fit. Where possible try to ensure that geotextile covers the 'new' edge to prevent the panel from filling with backfill.

Question: How do I fix the wall panels to the wall?

Answer: A liquid adhesive or adhesive tape can be used to fix the panels to the wall.

Question: What back fill material do I use?

Answer: A free draining backfill material with no fines such as washed river sand.

Question: Do I need to use protection board?

Answer: Protection board is not usually required unless specified. Take care that the edges of the drainage cells do not damage the waterproofing when being installed.

Question: What type of drain do I use under the wall panels?

Answer: The Atlantis Strip Filter Pipe[®] can be used to transport water to the stormwater system or re-use tank.

Question: Do you need additional waterproofing protection?

Answer: Additional waterproofing for retaining walls not usually required unless specified. In some applications, such as basement car park, additional waterproofing used to provide extra protection.

