

# 15.6 Inch QLED Portable Monitor User Manual



In order to ensure your safe use of this product, please read this manual carefully before using this product and keep it properly.

## Table of contents

---

### Chapter 01 Preparations

---

- Welcome!
- Checking the package contents
- Monitor introduction
- Product Appearance & Interface Function Introduction

### Chapter 02 Specifications

---

### Chapter 03 Connecting

---

- TYPE-C signal transfer
- Supported Devices & Models (Type-C)
- HDMI signal transfer

### Chapter 04 Setting Up(Windows10)

---

- 1.Extend Mode /Duplicate Mode/Display Mode
  - 1-1.Way1: Set on the device'Display Settings
  - 1-2.Way2: Set via Windows key + P keyboard shortcut
- 2.Rotate the Screen

### Chapter 05 Screen Adjustment

---

- On-Screen Display Menu Introduction
- Setting- Brightness
- OSD SETTING
- Setting- Color Temp
- Setting- Reset
- Save settings

### Chapter 06 Q&A

---

### Chapter 07 Service Support

---

## Chapter 01 Preparations

### Checking the Package Contents

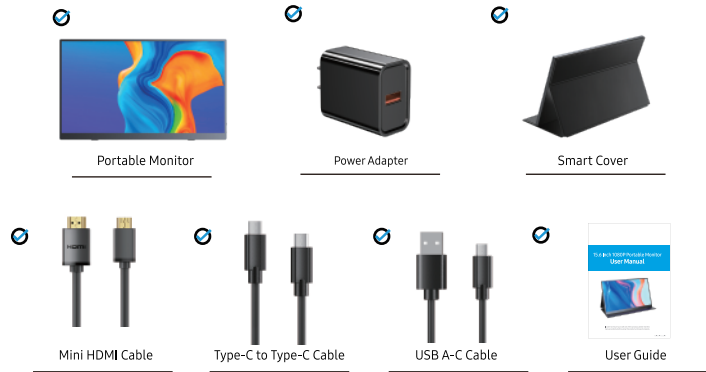

#### Note:

- If any of the above items is damaged or missing, please contact us immediately. ([support@uperfectmonitor.com](mailto:support@uperfectmonitor.com))
- The appearance of the components may differ from the images shown.

## Monitor Introduction

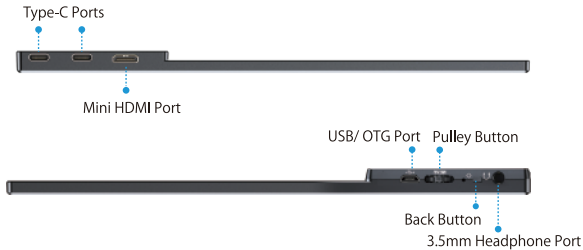
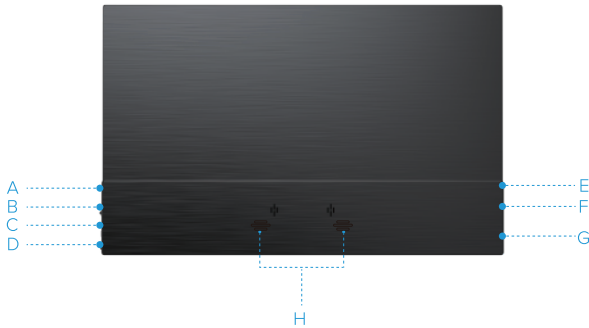
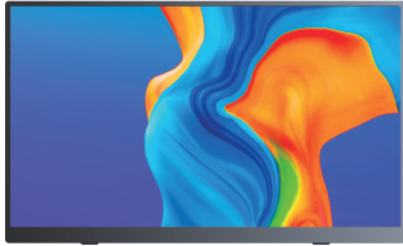

## Product Appearance & Interface Function Introduction

### A: Micro USB-B OTG Port:

This port is used to connect mouse and keyboard.

### B: Pulley button:

Scroll up the Pulley button in the main interface to open the volume menu and adjust the volume by up and down.

Scroll down the Pulley button in the main interface to open the Brightness menu, and up and down to adjust the brightness.

Press the Pulley button to enter the OSD (On-Screen Display) menu.

Scroll the Pulley button up and down in the menu to control the cursor;

Press the Pulley button to Confirm.

### C: Back/ Switch Button:

Short press to go back to the previous step.

Long press to turn on/ off the monitor.

### D: HP Port

The HP port is for earphones.

### E: Mini HDMI Port:

For signal transmission.

### F & G: Full Featured Type-C Ports

For power & signal transmission.

### H: Speakers

## Installing the stand case

A



Step1: Place the holster as shown above, part "1" is magnetic.

B

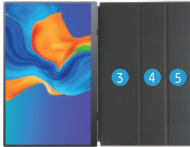

Step2: Place the monitor as shown above, part "1" can be sticky.

C

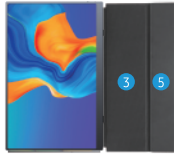

Step3: Fold the Leather cases part "5" to part "4" as shown.

D



Step4: Stand up the monitor and adjust the angle

## Chapter 02 Specifications

Color	Black
Model	M156J02
Resolution	1920*1080
Brightness	500 cd/m <sup>2</sup>
Color Gamut	99% Adobe RGB
Display Color	1.07B, 100% DCI-P3
Contrast Ratio	1000:1
Interface	Mini HDMI Port
	Type-C Port * 2
	3.5mm Headphone Jack
	Micro USB-B OTG Port
Panel Type	IPS

# Chapter 03

## Connecting

### TYPE-C signal transfer

**Note:** For more stable power supply, it is recommended to use our original power adapter to power.

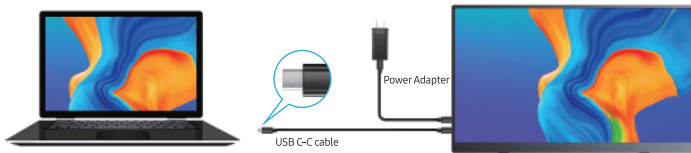
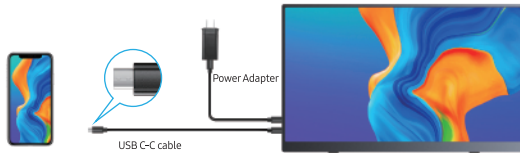

## Supported Devices & Models (Type-C)

Laptop Model	
Brand	Model
Apple	Macbook 12", Macbook 13" 2017, MacbookPro 2016/2017/2018, New Macbook Air 2018, iPad Pro 2018
Google	ChromeBook Pixels, PixelBook Pen, MagicBook
Lenovo	YogaC930, Yoga 5 Pro, Yoga 6 Pro, ThinkPad X1 Carbon2017, Miix 720, Legion Y7000/Y7000P/Y7000K
Dell	XPS13, XPS15, G3/G5/G7, Inspiron 5000/7000
HP	Pavilion X2, EliteBook Folio G1, EliteBook 1050 G1 Microsoft Surface Book2
ASUS	U306, U321 series, U4100, ROG series
Huawei	Matebook D, Matebook X, Matebook X Pro, Matebook E, Matebook 13
Razer	Blade Stealth
More Brands	Continuous update...

**Note:** Please check the Type C port of your PC/Laptop whether supports audio and video signal transmission(Thunderbolt3 ). If it is just a Type C for charging, you need connecting HDMI to transmit signal.

Mobile Phone Model	
Brand	Model
Samsung	S8, S8+, S9, S9+, S10, S10+, S10e, Note8, Note9
Huawei	Mate10, Mate10 Pro, Mate20, Mate20 Pro, Mate 20X, Mate P20, Mate P20 Pro, HonorNot10, Mate P30, Mate P30 Pro
More Brands	Continuous update...

**Note:** Please check the Type C port of your phone whether supports audio and video signal transmission ( USB 3.1).

## HDMI signal transfer

**Note:** For more stable power supply, it is recommended to use our original power adapter to power.

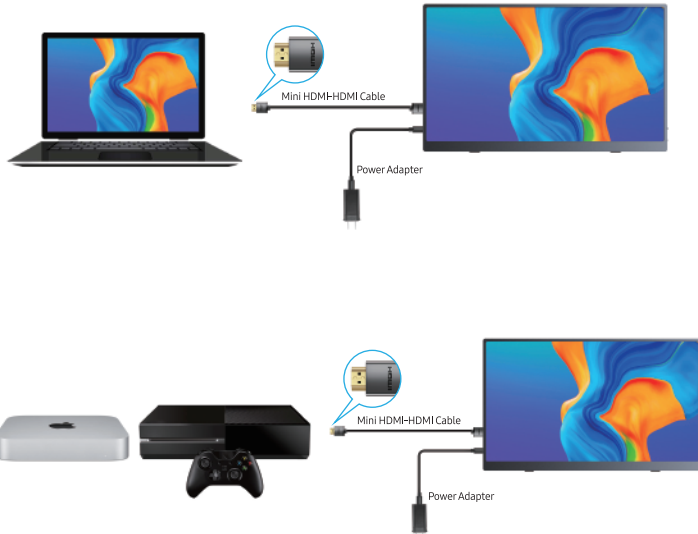

## For Non Thunderbolt 3.1 Android Phones/ iPhone

**Note:** If the Type-C port of your phone is not a full-featured Type-C port, or your phone is micro USB port, Lightning port, for example: Google Pixel 3, you need to buy the adapter as below. In order to enhance our customer experience, you can contact us, we will send you for free.

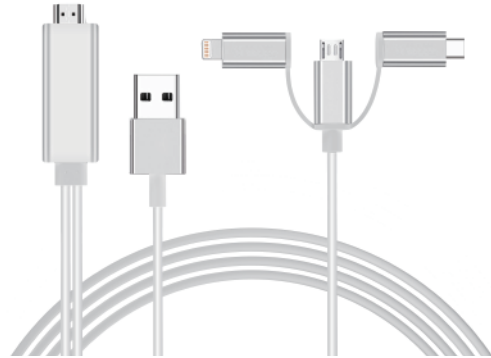

# Chapter 04

## Setting Up(Windows10)

### Extend Mode /Duplicate Mode/Display Mode

#### Way1: Set on the device'Display Settings

- A: Verify that your cables are connected properly to the new monitors.
- B: Right-click anywhere on your desktop and select Display settings to open the Display page.
- C: Scroll down to Multiple displays, then select an option from the drop-down list to determine how your desktop will display across your screens. For the largest work area, select Extend desktop.

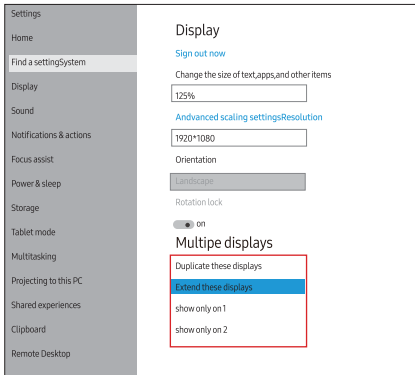

**Note:** If you cannot see the additional monitor(s) listed, click Detect. If does not work, try restarting your computer and do steps again.

#### Way2: Set via Windows key + P keyboard shortcut

- A: Verify that your cables are connected properly to the new monitors.
- B: Enter the "Windows" key and "P" keyboard at the same time.
- C: select an option from the drop-down list to determine how your desktop will display across your screens. For the largest work area, select Extend desktop.

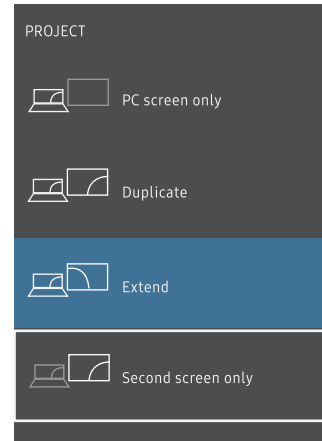

**Note:** If you cannot see the additional monitor(s) listed, click Detect. If does not work, try restarting your computer and do steps again.

## Rotate the Screen

- 1: Verify that your cables are connected properly to the new monitors.
- 2: Right-click anywhere on your desktop and select Display settings to open the Display page.
- 3: Under the "Select and rearrange displays" section, select the monitor that you want to adjust.
- 4: Under the "Scale and layout" section, use the Orientation drop-down menu to select Landscape or Portrait screen.

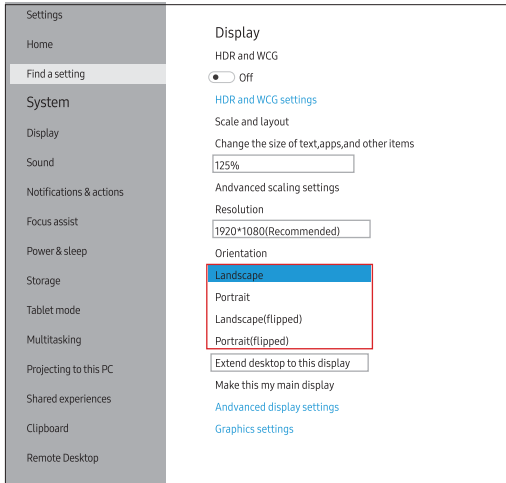

## Chapter 05 Screen Adjustment

### On-Screen Display Menu Introduction

#### SETTING - BRIGHTNESS

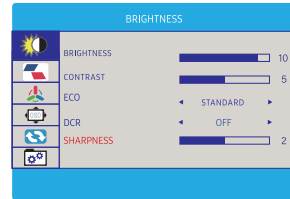

**BRIGHTNESS:** 1-10  
**CONTRAST:** 1-10. You can adjust brightness between bright and dark areas. If the contrast ratio is high, the screen will be sharp and sticky. The image quality will be clear.  
**ECO:** STANDARD/ RTS/ FPS/ TEXT/ MOVIE/ GAME  
**DCR:** (Dynamic contrast) ON / OFF  
When the dynamic contrast is ON, the brightness and contrast values cannot be changed.  
**SHARPNESS:** 1-4



**NOTES:** If you choose other ECO mode than STANDARD, you can not set the parameters.

#### SETTING - IMAGE

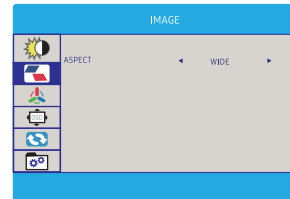

**ASPECT:** WIDE/ 4:3  
Recommend to set it at WIDE.



## SETTING - COLOR TEMP.

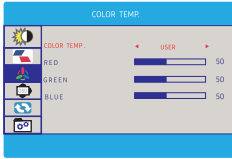

COLOR TEMP.:USER/ WARM/ COOL  
RED  
GREEN  
BLUE

## SETTING - OSD

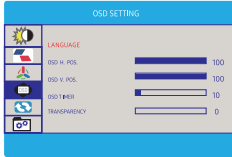

## SETTING - OSD

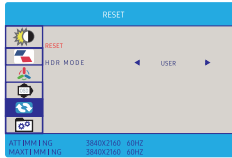

RESET  
HDR MODE:OFF/ 2084/ AUTO

## SETTING - OSD



SIGNAL SOURCE:HDMI/ TYPE C1/ TYPE C2  
You can also press the back button to quick  
choose the signal source.  
VOLUME  
FREESYNC:ON/ OFF  
OD:ON/ OFF

## SAVE SETTINGS

### How to save all the settings of the monitor?

- 1.If it is an HDMI signal source, the monitor settings can be directly
- 2.If it is a TYPE C signal source, the monitor need to connected to an external power supply first, then you can save the settings.

## Chapter 06 Q&A

**Q:** Abnormal conditions occurred - like the splash screen or spots when using the monitor.

- A:**
1. It is caused by an insufficient power supply. Monitor required large power support. Please use the attached genuine cable provided to power the monitor.
  2. If use the mobile power bank to power the monitor, please confirm whether the mobile power bank is a PD power bank that has reached 30W or more. Please contact us if you need a power bank.
  3. If the resolutions above do not work, please try another computer device. If it failed, please contact us for the replacement of the cable.

**Q:** The monitor fails to start and the screen is blank.

- A:**
1. Please TURN ON the power supply.
  2. Please check whether the connection is correct. Please unplug the cable and reconnect. Please use the genuine cable and the power adapter.
- Note: Most Samsung mobile phones can not power for the monitor, please power the monitor with an additional power adapter.
3. Please contact us if the troubleshooting above does not help.

**Q:** : The display is TURN-ON, shows "NO SIGNAL" or "POWER SAVING".

- A:**
1. Please check if the mobile phone supports USB3.1./Thunderbolt 3. when you are using Type-C to Type-C to connect the monitor and the mobile phone. An HDMI adapter is required to transfer the signal if your mobile phone does not support USB3.1./Thunderbolt 3.
  2. Please check whether the connection is correct. Please use the genuine cable provided.
  3. Please try another computer. If it failed, please contact us for the replacement of the cable.

**Q:** The monitor is constantly restarting.

**A:** 1. It is caused by an insufficient power supply. Monitor required large power support. Please use the attached genuine cable provided to power the monitor.

2. If use the mobile power bank to power the monitor, please confirm whether the mobile power bank is a PD power bank that has reached 30W or more. Please contact us if you need a power bank.

3. If the resolutions above do not work, please try another computer device. If it failed, please contact us for the replacement of the cable.

## Chapter 07

### Service Support

Dear Customer,  
Thank you for purchasing the Portable USB Monitor!  
We offer 100% money back guarantee in 30 days and 90 days replacement, 12 month warranty for any issue, professional tech support to ensure no-worry service.  
Any query or problem, please contact us via [support@uperfectmonitor.com](mailto:support@uperfectmonitor.com).

