

# 15.6 Inch Portable Monitor Touchscreen User Manual



In order to ensure your safe use of this product, please read this manual carefully before using this product and keep it properly.

## Table of contents

---

### Chapter 01 Preparations

---

Checking the package contents

Monitor introduction

Product Appearance & Interface Function Introduction

---

### Chapter 02 Specifications

---

### Chapter 03 OSD Menu introduction

---

### Chapter 04 Connecting

---

TYPE-C signal transfer

Supported Devices & Models (Type-C)

HDMI signal transfer

### Chapter 05 Setting Up(Windows10)

---

1.Extend Mode /Duplicate Mode/Display Mode

1-1.Way1: Set on the device/Display Settings

1-2.Way2: Set via Windows key + P keyboard shortcut

2.Rotate the Screen

---

### Chapter 06 Q&A

---

### Chapter 07 Service Support

## Chapter 01 Preparations

### Checking the Package Contents



Portable Monitor



18W PD Adapter

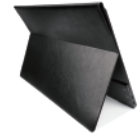

Protective sleeve



MINI HDMI Cable



Type-c to Type-c Cable\*2



Type-a to Type-c Cable



User Manual

### Note:

•If any of the above items is damaged or missing, please

contact us immediately. ([help@upperfectmonitor.com](mailto:help@upperfectmonitor.com))

•The appearance of the components may differ from the images shown.

## Monitor Introduction



- speaker
- Type-C port 1
- Type-C port 2
- Mini HDMI Port
- Menu Button/Roll Key
- Type-C OTG Port
- 3.5mm Audio Port

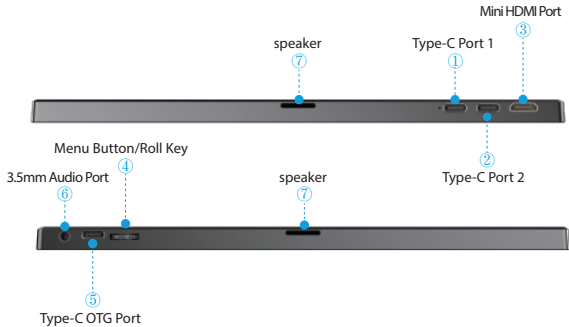

## Product Appearance & Interface Function Introduction

### ① Type-C Port 1

For both power supply and signal transmission(if your device is low on power, please connect it to an external power supply).

### ② Type-C Port 2

For both power supply and signal transmission(if your device is low on power, please connect it to an external power supply).

### ③ Mini HDMI Port

Audio and video signal transmission.

### ④ Menu Button/Roll Key

Scroll up/down buttons to adjust volume.

Press/scroll up /down the button to open the On-Screen Display (OSD) menu.

Use the scroll button up and down the menu to control the cursor and press the scroll button to confirm.

### ⑤ Type-C OTG Port

OTG interface. Support extended connection of mouse and keyboard, hard disk/U disk data transfer.

### ⑥ 3.5mm Audio Port

For Headphone/Sound Box Extension Port.

### ⑦ Speakers

## Chapter 02

### Specifications

Model	M156E07
Panel Type	IPS Screen
Size	15.6 inches
Aspect Ratio	16 : 9
Resolution	1920 * 1080
Viewing Angle	178°
Contrast Ratio	800:1
Brightness	250 cd/m <sup>2</sup>
Built-in Speakers	8Ω/1W*2
Input Interface	Mini HDMI*1, Type-C to Type-C*2, Type-C OTG *1
Response Time	3ms
Refresh Rate	60 Hz
Show the Number of Colors	262K(6bit)
Touch Screen	10-Points Touch Screen Technology

## Chapter 03

### OSD Menu Introduction

#### Set key:

1. Press the MENU button " ≡" to activate the setting.
2. Scroll the " " " " button up and down to toggle between options in the Menu.
3. To select the item on the menu you want to adjust by pressing the MENU button " " ≡.
4. Scroll up and down the " " and " " buttons to adjust the parameters, and finally press the MENU button " ≡ to confirm.

#### Color Effect

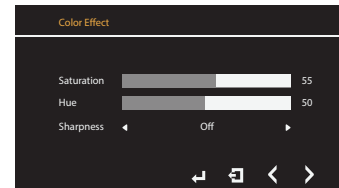

#### OSD Setting

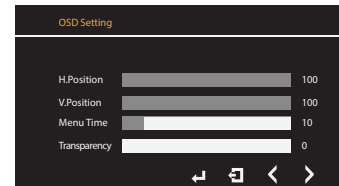

## Temperature

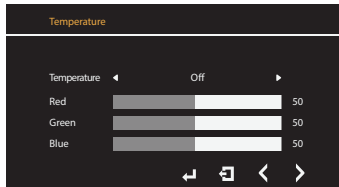

## Option

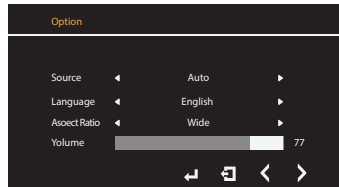

## Advance

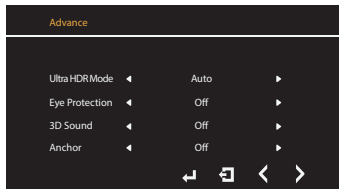

## Reset

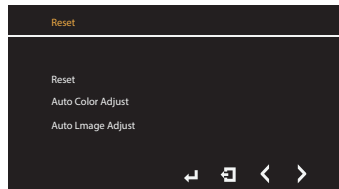

## Information

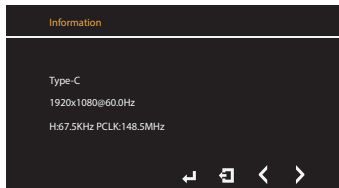

## Chapter 04 Connecting

### TYPE-C signal transfer

**Note:** For a more stable power supply, it is recommended to use our original power adapter to power.

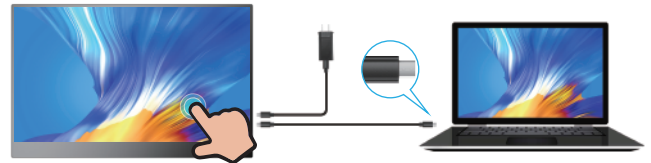
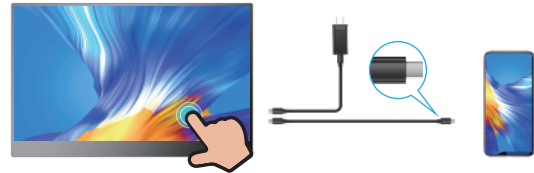

## Supported Devices & Models (Type-C)

Laptop Model	
Brand	Model
Apple	Macbook 12", Macbook 13" 2017, MacbookPro 2016/2017/2018, New Macbook Air 2018, iPad Pro 2018
Google	ChromeBook Pixels, PixelBook Pen, MagicBook
Lenovo	YogaC930, Yoga 5 Pro, Yoga 6 Pro, ThinkPad XI Carbon2017, Mixx 720, Legion Y7000/Y7000P/Y7000K
Dell	XP513, XP515, G3/G5/G7, Inspiron 5000/7000
HP	Pavilion X2, EliteBook Folio G1, EliteBook 1050 G1, Microsoft Surface Book2
ASUS	U306, U321 series, U4100, ROG series
Huawei	Matebook D, Matebook X, Matebook X Pro, Matebook E, Matebook 13
Razer	Blade Stealth
More Brands	Continuous update...

Note: Please confirm whether the Type C port of your PC/Laptop supports audio and video signal transmission (Thunderbolt3). If it is a Type C port only for charging, you need to use the HDMI port to transfer signal.

Mobile Phone Model	
Brand	Model
Samsung	S8, S8+, S9, S9+, S10, S10+, S10e, Note8, Note9
Huawei	Mate10, Mate10 Pro, Mate20, Mate20 Pro, Mate 20X, Mate P20, Mate P20 Pro, HonorNot10, Mate P30, Mate P30 Pro
More Brands	Continuous update...

Note: Please confirm whether the Type C port of your phone supports audio and video signal transmission (USB 3.1).

## Mini HDMI signal transfer

- Note: 1. For a more stable power supply, it is recommended to use our original power adapter to power.  
2. When connecting to HDMI device, you need to power the monitor firstly, and then connect the HDMI to Mini HDMI cable.

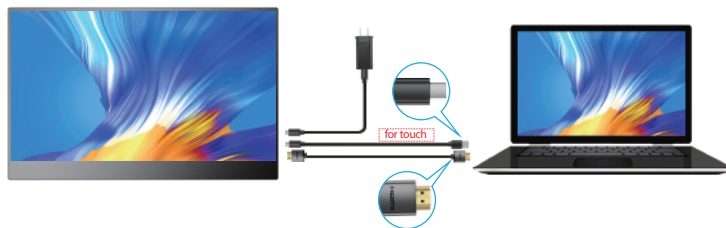

## Chapter 05

# Setting Up(Windows10)

**Note:** If the Type C of your laptop/phone is not a full-featured Type C port, or your phone is with micro USB port, lightning port, for example Google Pixel 3, you need to buy the adapter as below. Any questions you can feel free to contact us.

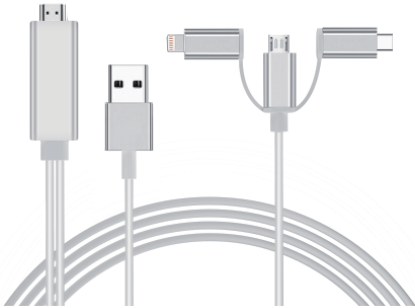

## Extend Mode /Duplicate Mode/Display Mode

### Way1: Set on the device' Display Settings

A: Verify that your cables are connected properly to the new monitors.

B: Right-click anywhere on your desktop and select Display settings to open the Display page.

C: Scroll down to Multiple displays, then select an option from the drop-down list to determine how your desktop will display across your screens. For the largest work area, select Extend desktop.

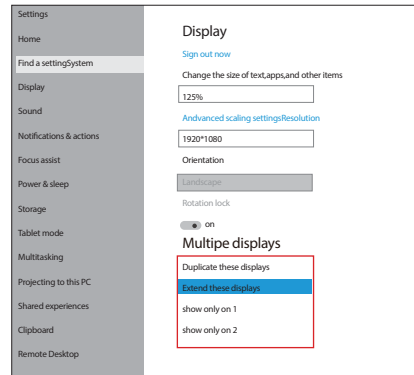

**Note:** If you cannot see the additional monitor(s) listed, click Detect. If does not work, try restarting your computer and do steps again.

## Way2: Set via Windows key + P keyboard shortcut

A: Verify that your cables are connected properly to the new monitors.

B: Enter the "Windows" key and "P" keyboard at the same time.

C: select an option from the drop-down list to determine how your desktop will display across your screens. For the largest work area, select Extend desktop.

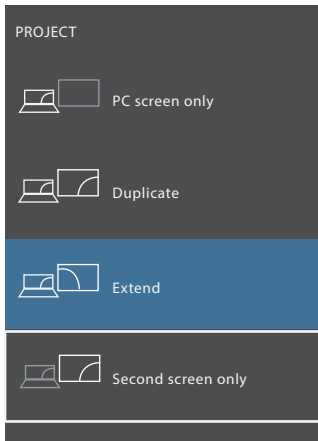

Note: If you cannot see the additional monitor(s) listed, click Detect. If does not work, try restarting your computer and do steps again.

## Rotate the Screen

1: Verify that your cables are connected properly to the new monitors.

2: Right-click anywhere on your desktop and select Display settings to open the Display page.

3: Under the "Select and rearrange displays" section, select the monitor that you want to adjust.

4: Under the "Scale and layout" section, use the Orientation drop-down menu to select Landscape or Portrait screen.

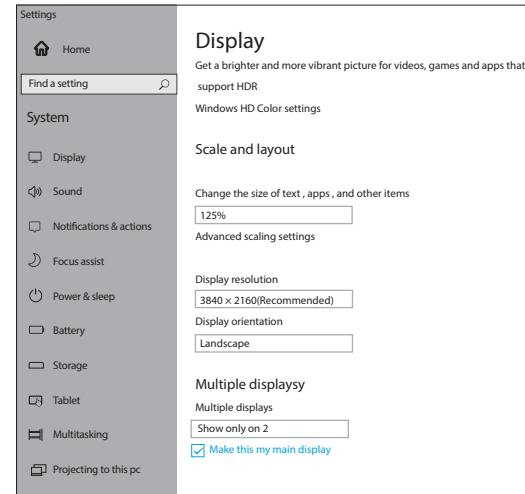



## Chapter 06

### Q&A

**Q:** The monitor keeps switching and flicker, although it connected to outlet for extra power supply.

**A:** This situation is generally caused by insufficient voltage; Please check whether the factory-packed cables are used, and then check whether an external PD power supply is used.

**Q:** Can we supply energy from power bank without using self power adapter?

**A:** That depends on the output of the power bank, because this monitor requires at least 18W power supply.

And if the output of your power bank is only 10W , this power bank will not supply enough energy for the monitor.

The output of power adapter we provide is 18W, so a power bank with output above 18W is recommended.

**Q:** Is it possible to set the default contrast? I have to adjust each time from 10% to 70%, each time I connect to my Macbook Pro laptop.

**A:** How to save the settings of brightness, volume, etc.

·When the HDMI port is used for display and monitor powered by Type C port, all the settings will be saved automatically.

·But when the Type-C port is used for display without external power supply, brightness and volume will not be saved after the monitor is powered off, this design is to avoid that the monitor doesn't work when connected to phones which could not provide enough power for monitor with high brightness setting. So to avoid the brightness is reset everyday, please give the monitor an external power supply with Type C port and do not cut off the power.

Actually, all the portable monitors on Amazon all have this same design.

---

**Q:** Touchscreen isn't responsive or not working.

**A:** 1. For mobile phones

① Touchscreen is not working when connecting to a mobile phone supporting USB3.1. Please contact us

to upgrade the display program.

② Touchscreen isn't responsive or not working if the phone doesn't support USB3.1. Please check the phone model to ensure if it supports USB3.1.

2. For game devices (Nintendo, XBOX, PS4, etc.), the touch-function is unresponsive.

3. For Computer/Micro-host. Please check the connection. Please use the genuine cable provided. Incorrect connection may arouse touch-function unresponsive in most cases.

4. If the connection is correct and the touch-function is still unresponsive. Please try another computer. If it failed, please contact us for the replacement of the touch cable.

# Chapter 07

## Service Support

Dear Customer,  
Thank you for purchasing the Portable USB Monitor!  
We offer 100% money back guarantee in 30 days and 90 days replacement, 12 months warranty for any issue, professional tech support to ensure no-worry service.  
Any query or problem, please contact us via [help@uperfectmonitor.com](mailto:help@uperfectmonitor.com)

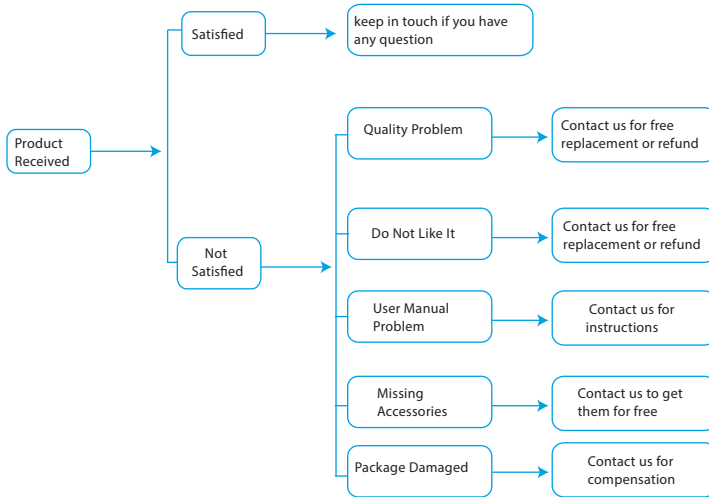



Please read the user manual in the product packaging carefully before using the device. This product has been designed with personal considerations in mind, but incorrect use may cause electric shock and fire. To avoid damaging the safety parts inside the machine, please observe the following rules during the installation, use and repairing:

1. To prevent from fire disaster or electronic shock, please do not put the monitor in humidity or even in a worse condition;
2. Before using the device, make sure all cables are connected properly and the power cord is not damaged, if there is any damage, please contact us immediately;
3. To avoid dust, moisture and extreme temperatures, please Don't place the device in any Damp area. Please place the device on a stable surface when in use;
4. Don't put any object or splash any liquid into the openings of the device casing;
5. Please use the power cord provided with the machine, and if you use other power cord, which is not provided by the Seller, or the power cord with the device is damaged, please contact our professional After-Service Team immediately, we will provide you the best solution in 12 hours;

This Tip is very important when you use the Monitor;

6. Please use a Adapter to supply power for the display. The Mobile Phone Charger and Power Bank that meet power supply demand can also supply power for the display. If you are not sure the power supply types, please contact our professional After-Service Team immediately, we will provide you the best solution in 12 hours;
7. Do not attempt to open the rear case of the device. There are no spare parts in the device that the customers can use to repair. If any abnormality occurs, please contact our professional After-Service Team immediately, we will provide you the best solution in 12 hours;

To avoid Personal injury, please observe the following rules:

1. Do not place the monitor on a sloping table unless there are security measures;
2. Do not drop or throw objects or toys onto the screen, because it will result in personal injury, product and the screen damage;

To prevent other injuries, please observe the following rules:

1. Please turn off the monitor when you leave for a long time please;
2. Do not allow Children to throw or insert objects into the monitor;
3. Do not install spare parts that are not specifically designed for this device;
4. Please Unplug the power cord when the device is unattended for a long time;
5. Do not touch the power cord or signal cable when lightning strikes, otherwise it may cause electric shock;
6. Do not let any object compress or wrap the power cord;
7. Do not place the monitor where the power cord can be easily damaged.

To prevent the machine damage, the following situations should be avoided:

1. Place the monitor where it is easy to fall;
2. Place the display near a radiator or heat source;

Do not rub the screen with a hard object as it will scratch or permanently damage the screen.

Do not use your fingers to press the screen for a long time, otherwise it will produce screen smear, and even a screen damage.

Red, green, and blue pixel defects may appear on the screen, but it does not affect the display function.

The power cord is the main isolation device and must be put in an Easy-to-operate place.

If possible, try to use the recommended resolution for best results. Because if you use other resolution other than the recommended resolution, a screen abnormality may occur. But this is a feature of a LCD panel with the fixed resolution.

A still picture on the screen for a long time will cause damage to the screen and produce afterimages. Please make sure to use the screen saver, the afterimage and related issues are not covered in the scope of product repairing warranty.

If you encounter any technical problems while using this device, please contact our professional After-Service Team immediately.