

Drywall Screw Premium Fine Thread

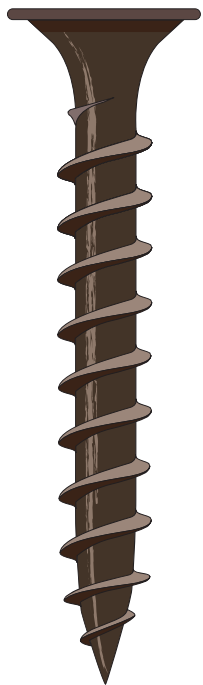

- For attaching gypsum board to light gauge steel framing
- High-quality phosphate coating finish
- Extreme sharp point for faster engagement

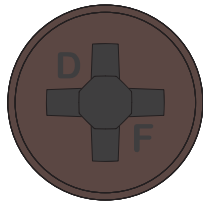

#2 Phillips Drive



Extreme Sharp Point

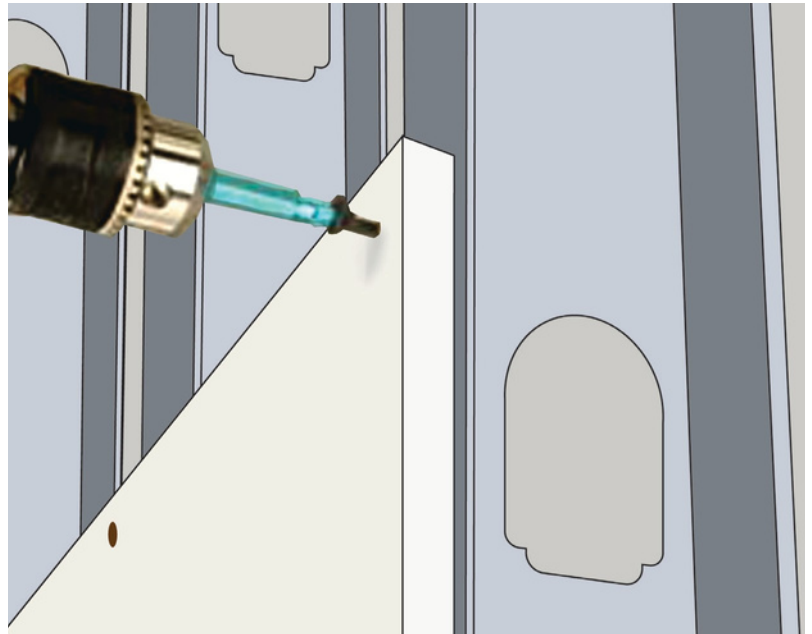

Applications

- 1/2" to 5/8" single-layer gypsum boards to 1/2" to 5/8" SIC gauge
- 1/2" to 5/8" double-layer gypsum boards to 1/2" to 5/8" SIC gauge
- 25 gauge steel studs, runners, furring and Z-furring channels
- 1" coreboard to metal angle runners in solid position

Specifications

- SIC Gauge – #6, #8
- Lengths – 1 in. to 3 in.
- Recess Type – #2 Phillips
- Thread Type – Fine
- Finish – Dark Gray Phosphate
- Screws are manufactured in an ISO 9002 and ISO 14001 certified and approved factory, ICCES approval pending

Installation Guides

- Use a standard screwgun with a depth-sensitive nose piece
- Suggested screwgun specification for optional performance – 4 amps minimum and RPM range of 0 to 4,000
- Overdrive may result in failure or strip out of the work surface
- Ensure the fastener penetrates beyond the metal by three full thread pitches
- Screw is fully seated when head is flush with work surface

Drywall Screw Premium Fine Thread

Product Size
And
Ordering
Information

			Length Metric	Qty. Per Carton	Wt. Per Carton (lbs.)
DF1FDWS10M	DFF41174	#6 / 1 in.	25mm	10M	29
DF118FDWS10M	DFF41578	#6 / 1-1/8 in.	29mm	10M	32
DF114FDWS8M	DFF41167	#6 / 1-1/4 in.	32mm	8M	32
DF158FDWS5M	DFF41168	#6 / 1-5/8 in.	41mm	5M	22
DF2FDWS35M	DFF41169	#6 / 2 in.	51mm	3.5M	22
DF212FDWS25M	DFF41170	#8 / 2-1/2 in.	64mm	2.5M	20
DF3FDWS2M	DFF41171	#8 / 3 in.	76mm	2M	22
DF1FDWS5	DFF41177	#6 / 1 in.	25mm		5
DF118FDWS5	DFF41581	#6 / 1-1/8 in.	32mm		5
DF114FDWS5	DFF41196	#6 / 1-1/4 in.	41mm		5
DF158FDWS5	DFF41200	#6 / 1-5/8 in.	51mm		5
DF2FDWS5	DFF41204	#6 / 2 in.	64mm		5
DF212FDWS5	DFF41208	#8 / 2-1/2 in.	76mm		5
DF3FDWS5	DFF41212	#8 / 3 in.	89mm		5

Product
Dimensions
(mm)

Gauge	B Head Dia.	Recess Depth	W Gauge Width	d Stock Dia.	d1 Minor Dia.	d2 Major Dia.	TPI
#6	8.00	0.50	#2	2.68	2.27	3.45	15
	8.50	0.80		2.72	2.45	3.58	
	8.00	0.50		2.68	2.27	3.45	
#8	8.50	0.80		2.72	2.45	3.58	

Pull-Out
Test
Data

Screw Gauge	Metal Gauge	Tension (lbs.)	Shear (lbs.)
#6	20	237	557
	25	139	278
#8	20	237	557
	25	139	278

Standard
Corrosion
Test Results

Finish	Test	Standard	Results
Dark Gray Phosphate	Salt Spray	ASTM 8117	48 Hours No Red Rust

CAUTION - Always wear Safety Goggles or Glasses. Screws are sharp, handle carefully. Do not place screws in mouth. **KEEP OUT OF REACH OF CHILDREN**

PRECAUCIÓN - Utilice siempre gafas o gafas de seguridad. Empuñaderas están afilados, manipúlelos con cuidado. No coloque tornillos en la boca. **MANTENER FUERA DEL ALCANCE DE LOS NIÑOS**

Made to Conform to ASTM C1002. All Fasteners are Manufactured in an ISO 9002 and ISO 14001 Certified and Approved Factory.

Fabricado conforme a ASTM C1002. Todas las fijaciones están manufacturadas en una fábrica con certificaciones ISO 9002 e ISO 14001 aprobada.

 **ISO 9002 14001**
Factories **ISO 9001**
CERTIFIED IN ISO 9001

Durafast is a registered trademark of Phillips Fastener, LLC #2,363,216 (Class 6), Phillips Fastener, LLC # 2363216 (Class 6).
© 2021 Phillips Fastener, LLC. All rights reserved.



WARNING: Cancer and Reproductive Harm
- www.P65Warnings.ca.gov.