

## Drywall Screw Premium Coarse Thread

---

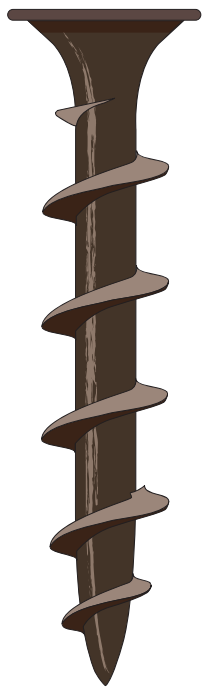

- For attaching gypsum board to wood framing
- High-quality phosphate coating finish
- Extreme sharp point for faster engagement

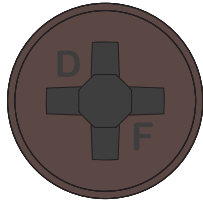
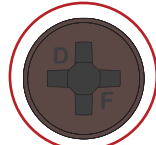

#2 Phillips Drive



Extreme Sharp Point

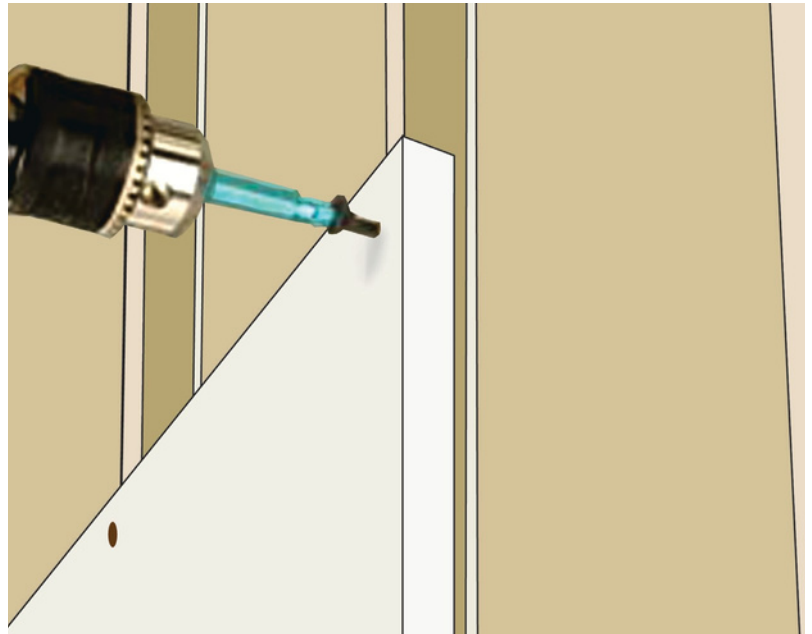

---

### Applications

- 1/2" to 5/8" single-layer gypsum boards to wood studs and runners
- 1/2" to 5/8" double-layer gypsum boards to wood studs and runners

---

### Specifications

- SIC Gauge – #6, #8, #10
- Lengths – 1 in. to 6 in.
- Recess Type – #2 Phillips
- Thread Type – Coarse
- Finish – Dark Gray Phosphate
- Screws are manufactured in an ISO 9002 and ISO 14001 certified and approved factory; ICCES approval pending

---

### Installation Guides

- Use a standard screwgun with a depth-sensitive nose piece
- Suggested screwgun specification for optional performance – 4 amps minimum and RPM range of 0 to 4,000
- Screw is fully seated when head is flush with work surface
- Overdrive may result in failure or strip out of the work surface

## Drywall Screw Premium Coarse Thread

### Product Size And Ordering Information

				Qty. Per Carton	Wt. Per Carton (lbs.)
DF1CDWS10M	DFF41159	#6 / 1 in.	25mm	10M	29
DF118CDWS10M	DFF41665	#6 / 1-1/8 in.	29mm	10M	32
DF114CDWS8M	DFF41160	#6 / 1-1/4 in.	32mm	8M	32
DF158CDWS5M	DFF41161	#6 / 1-5/8 in.	41mm	5M	22
DF2CDWS3M	DFF41162	#6 / 2 in.	51mm	3M	22
DF212CDWS25M	DFF41163	#8 / 2-1/2 in.	64mm	2.5M	20
DF3CDWS2M	DFF41164	#8 / 3 in.	76mm	2M	22
DF312CDWS1M	DFF41183	#10 / 3-1/2 in.	89mm	1M	17
DF4CDWS1M	DFF41185	#10 / 4 in.	102mm	1M	21
DF412CDWS1M	DFF41187	#10 / 4-1/2 in.	114mm	1M	23
DF5CDWS1M	DFF41189	#10 / 5 in.	127mm	1M	24
DF6CDWS1M	DFF41191	#10 / 6 in.	152mm	1M	25
DF1CDWS5	DFF41224	#6 / 1 in.	25mm		5
DF118CDWS5	DFF41116	#6 / 1-1/8 in.	29mm-		5
DF114CDWS5	DFF41228	#6 / 1-1/4 in.	32mm		5
DF158CDWS5	DFF41232	#6 / 1-5/8 in.	41mm		5
DF2CDWS5	DFF41236	#6 / 2 in.	51mm		5
DF212CDWS5	DFF41240	#8 / 2-1/2 in.	64mm		5
DF3CDWS5	DFF41244	#8 / 3 in.	76mm		5
DF312CDWS5	DFF41182	#10 / 3-1/2 in.	89mm		5
DF4CDWS5	DFF41184	#10 / 4 in.	102mm		5
DF412CDWS5	DFF41186	#10 / 4-1/2 in.	114mm		5
DF5CDWS5	DFF41188	#10 / 5 in.	127mm		5
DF6CDWS5	DFF41190	#10 / 6 in.	152mm		5

### Product Dimensions (mm)

Gauge	B Head Dia.	Recess Depth	W Gauge Width	d Stock Dia.	d1 Minor Dia.	d2 Major Dia.	TPI
#6	8.00	0.50	#2	2.68	2.27	3.45	15
	8.50	0.80		2.72	2.45	3.58	
#8	8.00	0.50	#2	2.68	2.27	3.45	15
	8.50	0.80		2.72	2.45	3.58	
#10	8.00	0.50	#2	2.68	2.27	3.45	15
	8.50	0.80		2.72	2.45	3.58	

### Pull-Out Test Data

Screw Gauge	Metal Gauge	Tension (lbs.)	Shear (lbs.)
#6	20	237	557
	25	139	278
#8	20	237	557
	25	139	278
#10	20	237	557
	25	139	278

### Standard Corrosion Test Results

Finish	Test	Standard	Results
Dark Gray Phosphate	Salt Spray	ASTM 8117	48 Hours
			No Red Rust

**CAUTION** - Always wear Safety Goggles or Glasses. Screws are sharp, handle carefully. Do not place screws in mouth. **KEEP OUT OF REACH OF CHILDREN**

**PRECAUCIÓN** - Utilice siempre gafas o gafas de seguridad. Empuñaduras están afilados, manipúlelos con cuidado. No coloque tornillos en la boca. **MANTENER FUERA DEL ALCANCE DE LOS NIÑOS**

Made to Conform to ASTM C1002. All Fasteners are Manufactured in an ISO 9002 and ISO 14001 Certified and Approved Factory.

Fabricado conforme a ASTM C1002. Todas las fijaciones están manufacturadas en una fábrica con certificaciones ISO 9002 e ISO 14001 aprobada.



**ISO 9002 14001**  
**Factories ISO 9001**  
**CERTIFIED** IN ISO 9001

Durafast is a registered trademark of Phillips Fastener, LLC #2,363,216 (Class 6), Phillips Fastener, LLC # 2363216 (Class 6). © 2021 Phillips Fastener, LLC. All rights reserved.



WARNING: Cancer and Reproductive Harm  
- www.P65Warnings.ca.gov