

9605

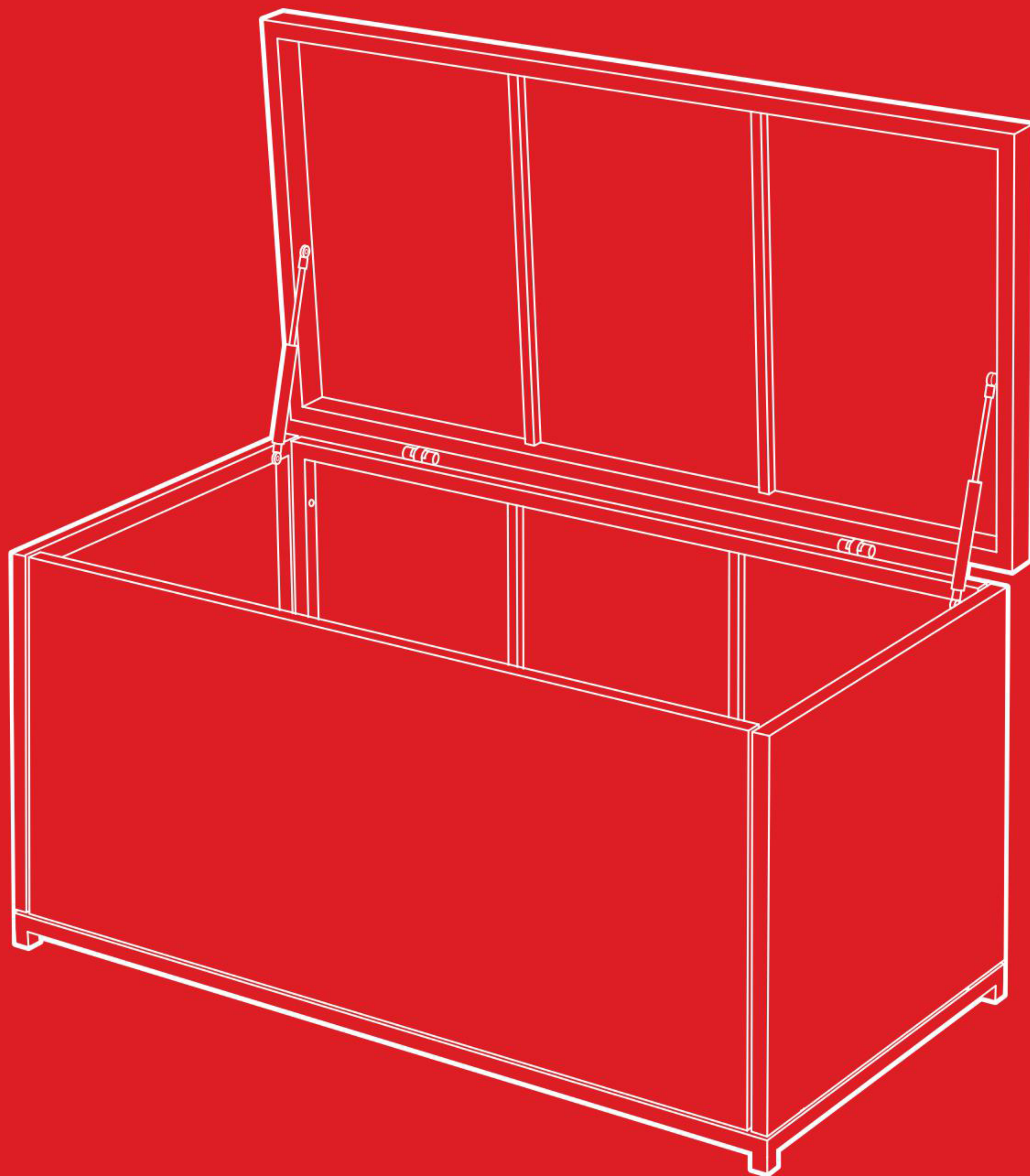

INSTRUCTION MANUAL

Wicker Storage Box

NOTICE

Please retain these instructions for future reference.

- Do not stand on or use any part of this item as a step ladder.
- Firmly secure all bolts, screws and knobs before use.
- Reconfirm that all bolts, screws, and knobs are secure every 90 days.
- Fasten screws loosely during initial assembly. Do not firmly tighten the screws until the item is completely assembled.
- Do not use or store this item in the proximity of open flame or flammable/combustible chemicals.
- Be aware that some parts are heavy and have sharp edges.
- If any parts are missing, broken, damaged, or worn, stop using this product until repairs are made and/or factory replacement parts are installed.
- Do not use this item in a way inconsistent with the manufacturer's instructions as this could void the product warranty.

REQUIRED ITEMS



ALLEN WRENCH
(PROVIDED)

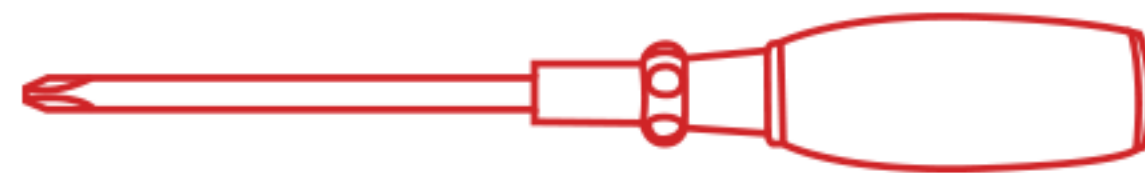

SCREW DRIVER
(DO NOT PROVIDED)



1 PERSON
ASSEMBLY



APPROXIMATELY
20 MIN.
ASSEMBLY

HARDWARE

1 30mm SCREW

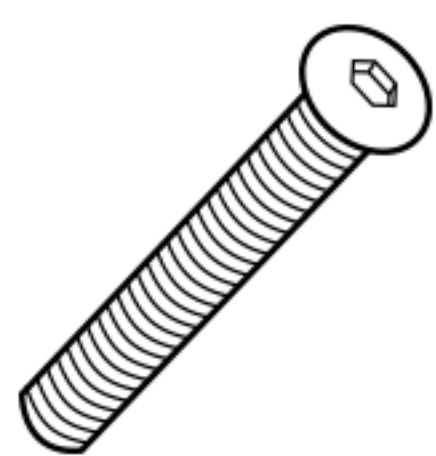

4 PCS

2 45mm SCREW

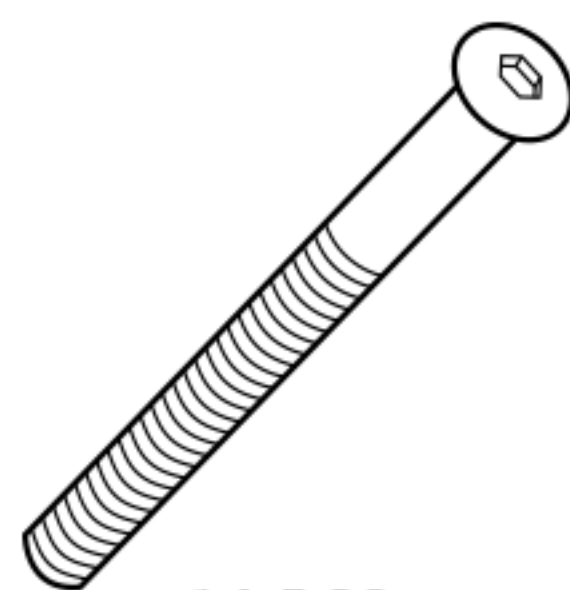

14 PCS

3 WASHER



16 PCS

4 SPACER



2 PCS

5 SPACER

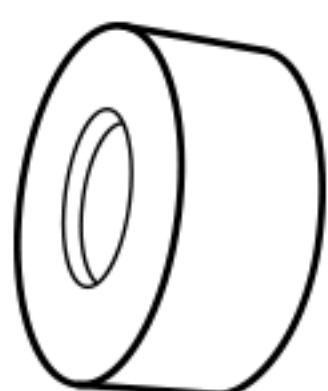

2 PCS

6 NUT



2 PCS

7 ARM

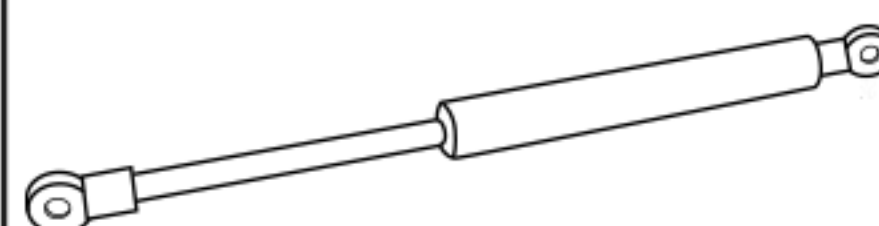

2 PCS

8 20mm SCREW



18 PCS

9 60mm CONNECTOR

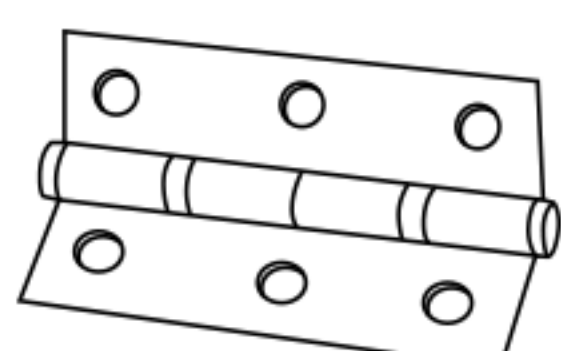

3 PCS

10 HANDLE RING

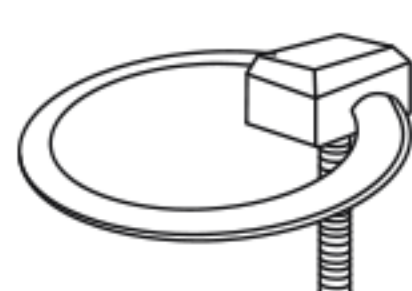

1 PCS

11 INNER BAG

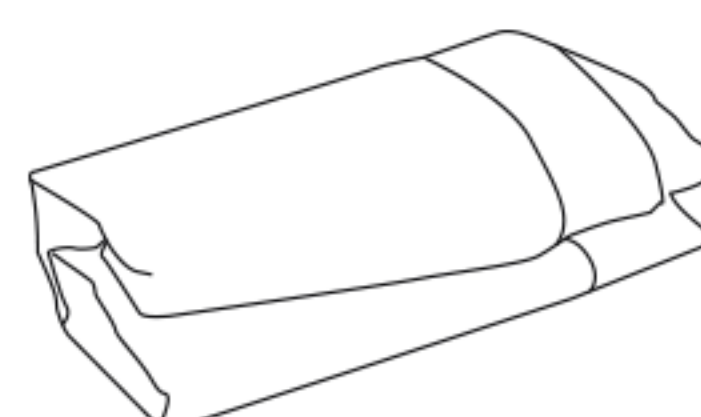

1 PCS

PARTS

A

BOTTOM

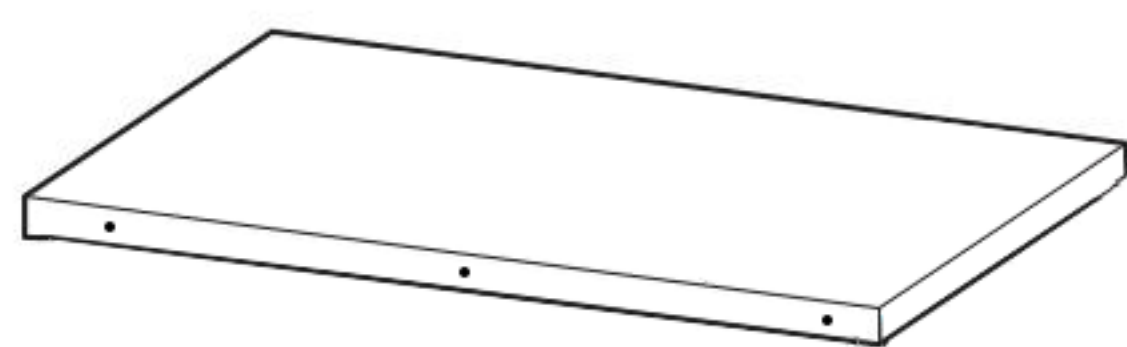

1 PC

B

BACK

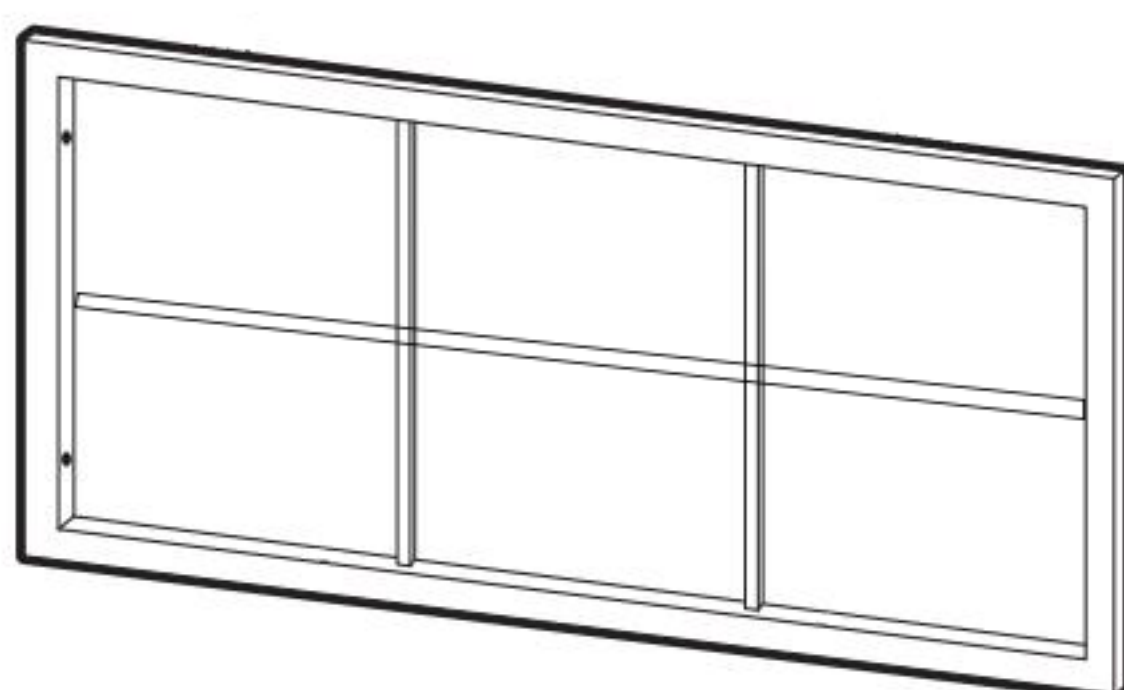

1 PC

C

FRONT

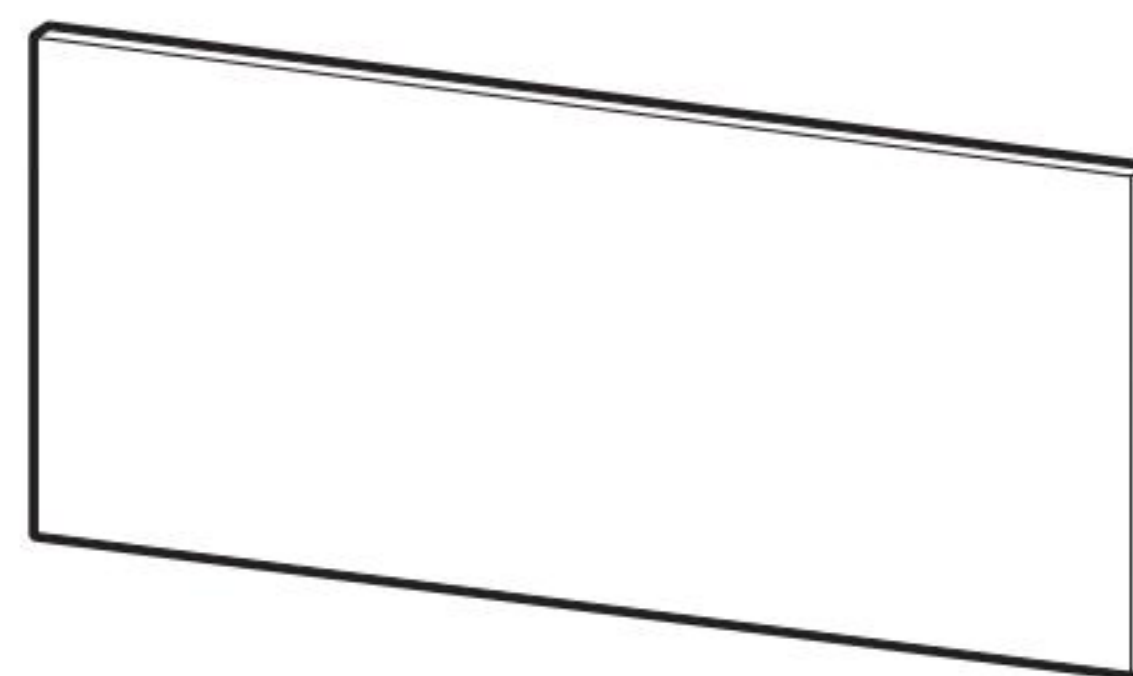

D

LEFT SIDE

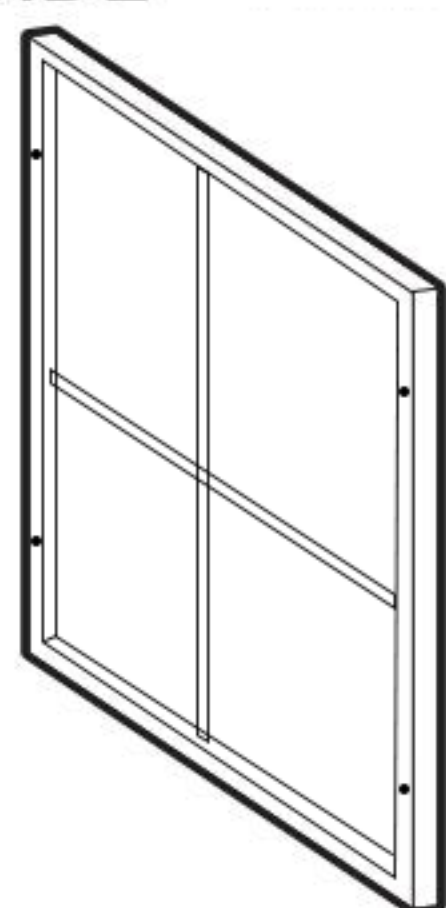

1 PC

E

RIGHT SIDE

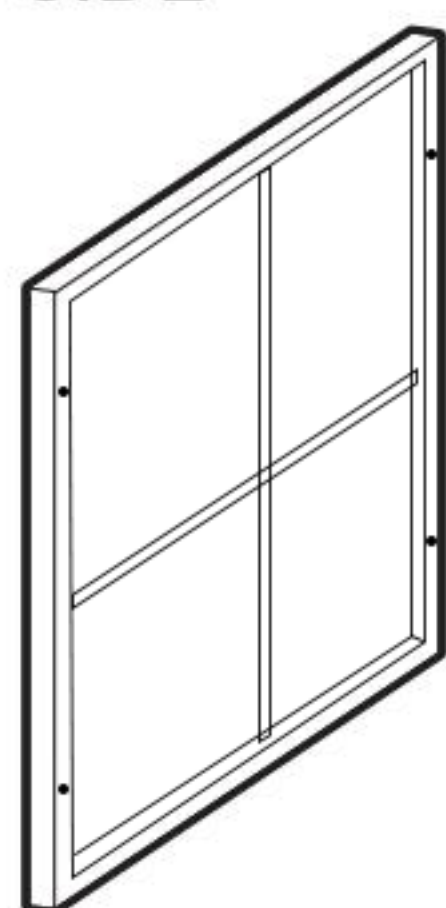

1 PC

F

LID

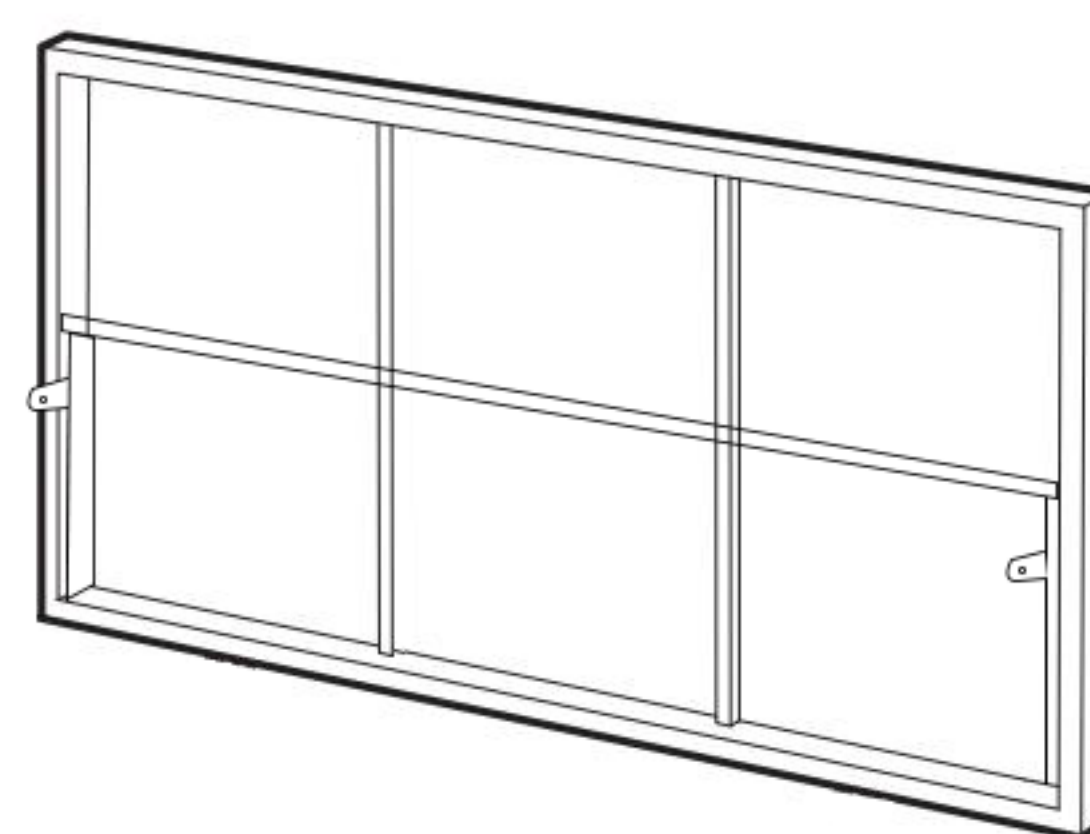

1 PC

PRODUCT ASSEMBLY

1

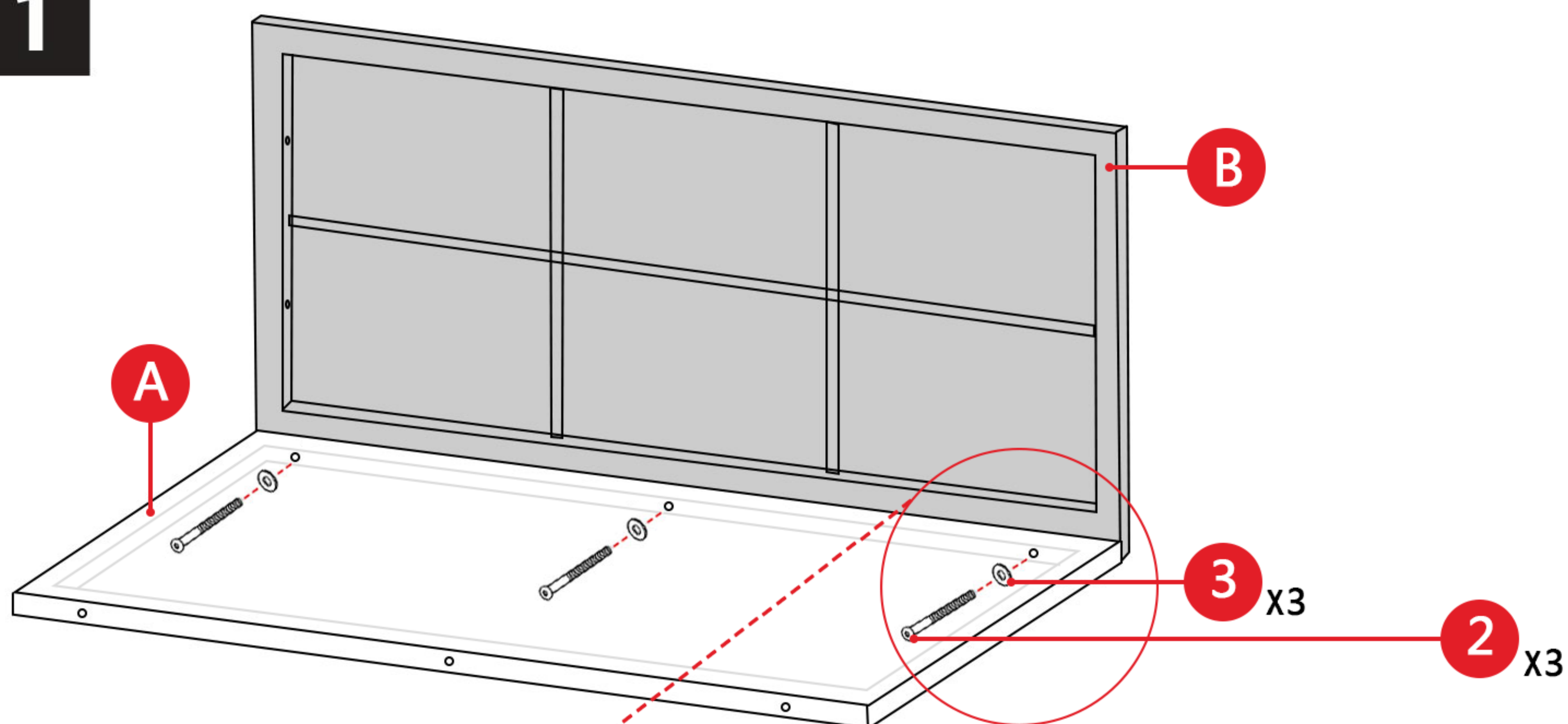

Attach the part B back to the part A bottom with three part 2 screws and three part 3 washers.

2

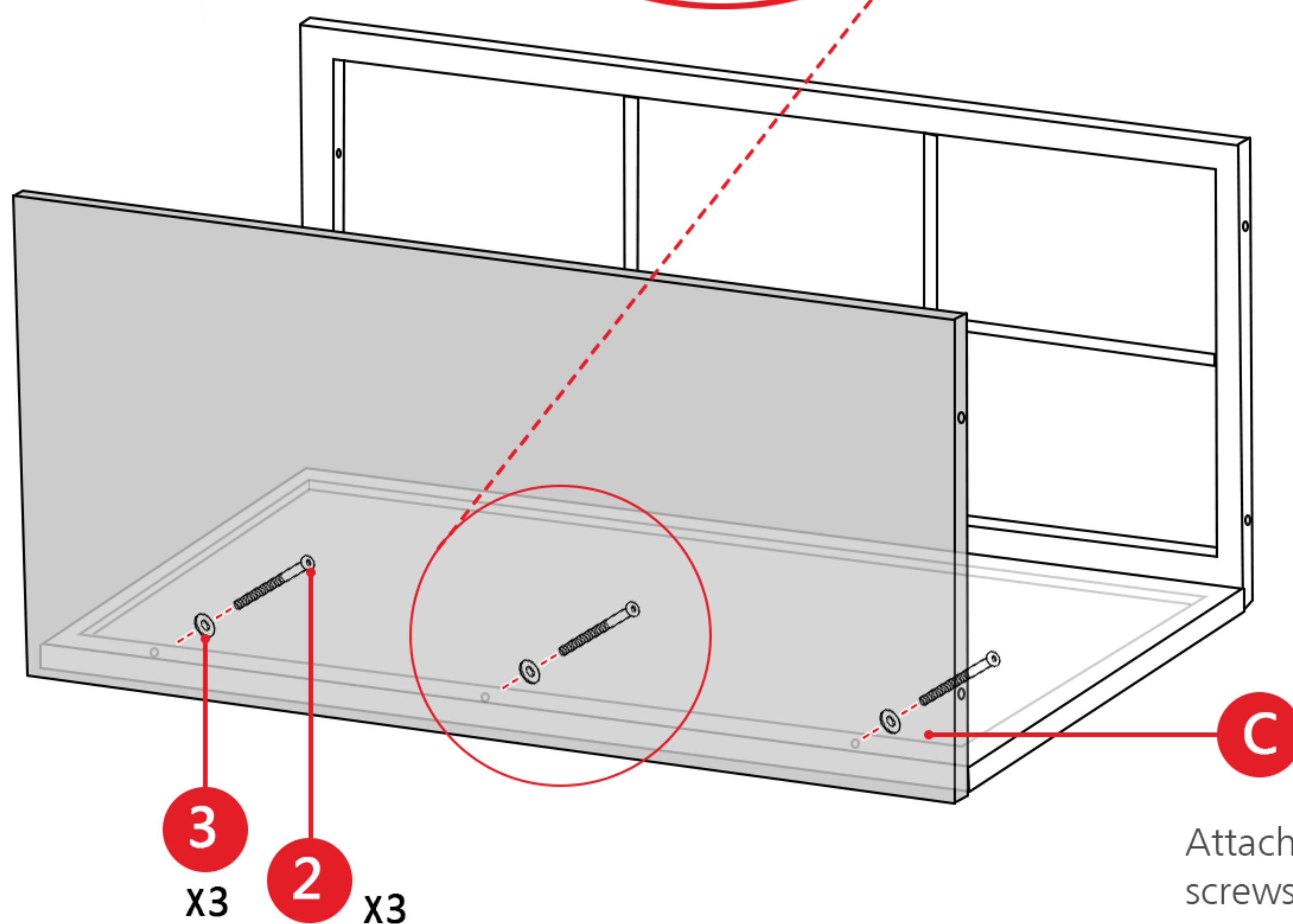

Attach the part C front with three part 2 screws and three part 3 washers.

PRODUCT ASSEMBLY

3

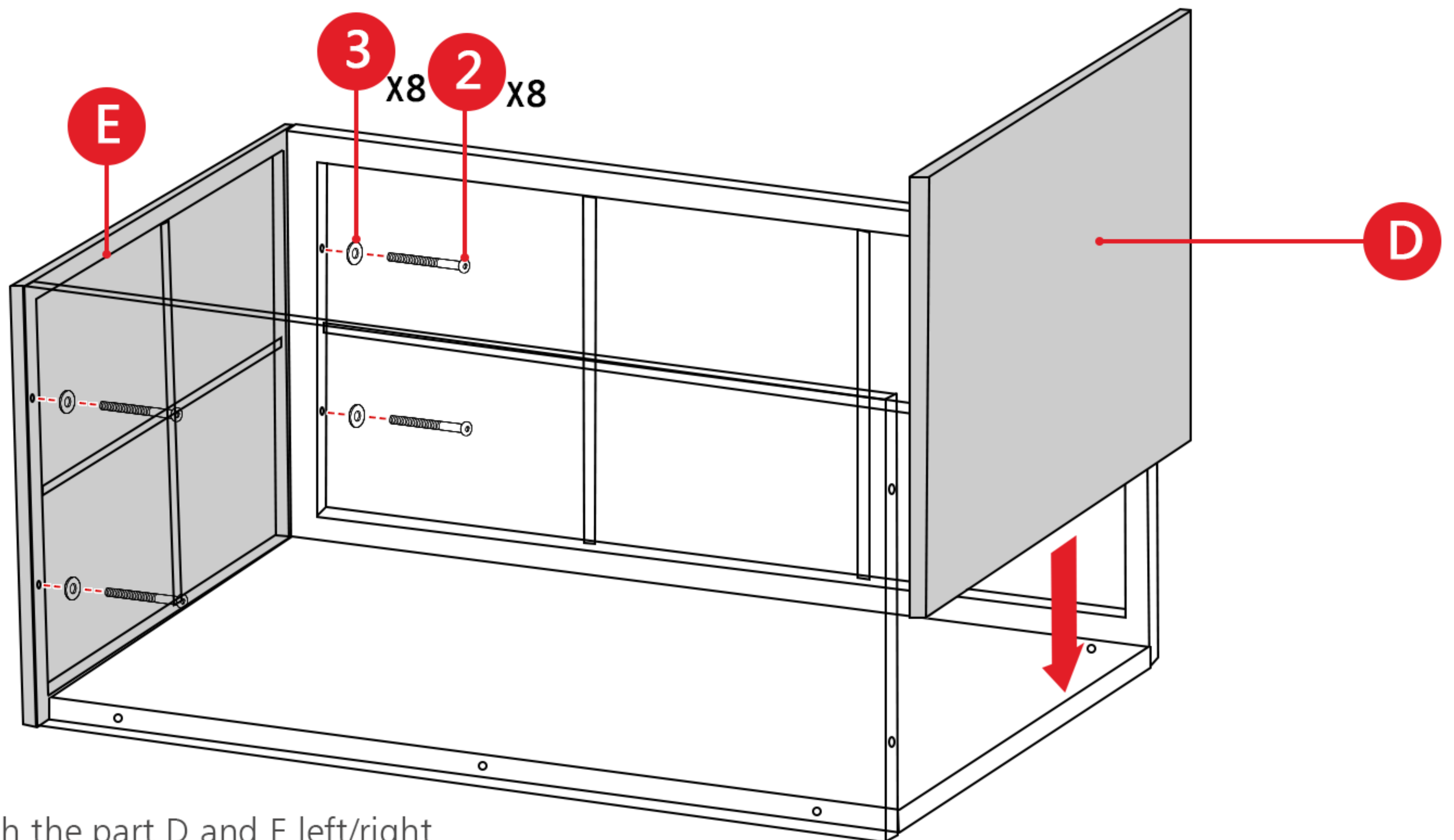

Attach the part D and E left/right sides with eight part 2 screws and eight part 3 washers, four screws/washers per side

4

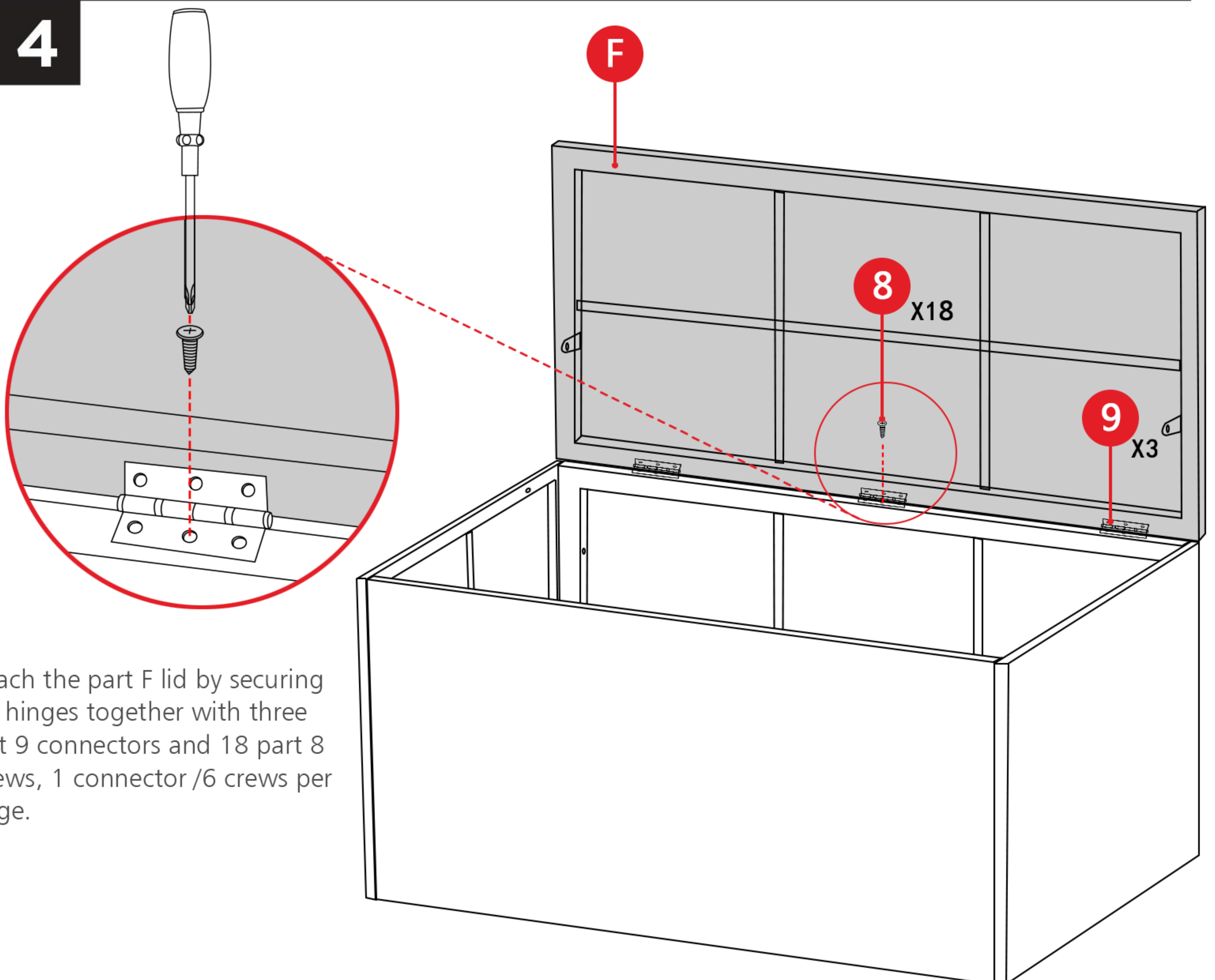

Attach the part F lid by securing the hinges together with three part 9 connectors and 18 part 8 screws, 1 connector /6 screws per hinge.

PRODUCT ASSEMBLY

5

①

Attach the two part 7 arms with two part 1 screw, two part 3 washers, two part 4 spacers, and two part 6 nuts

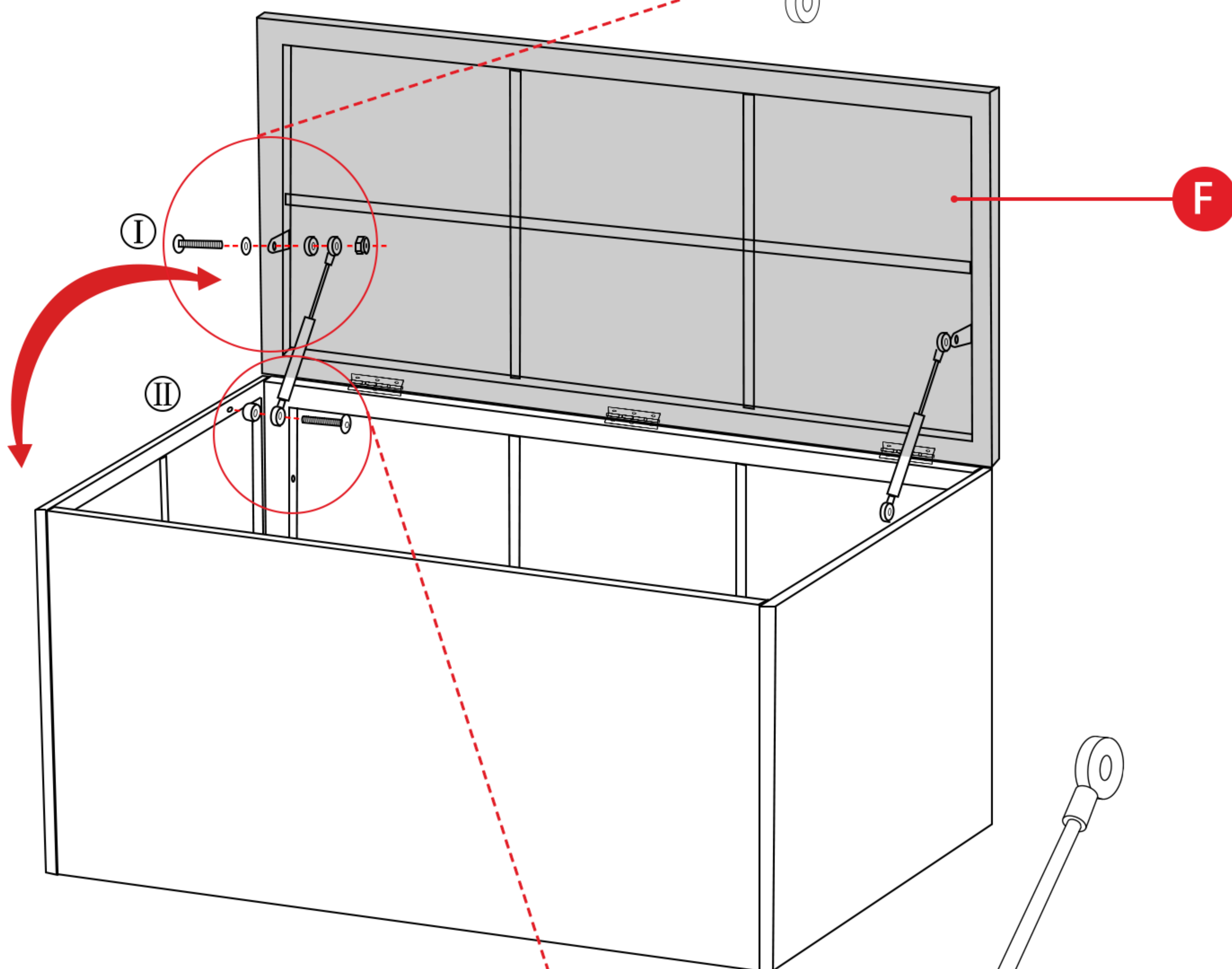
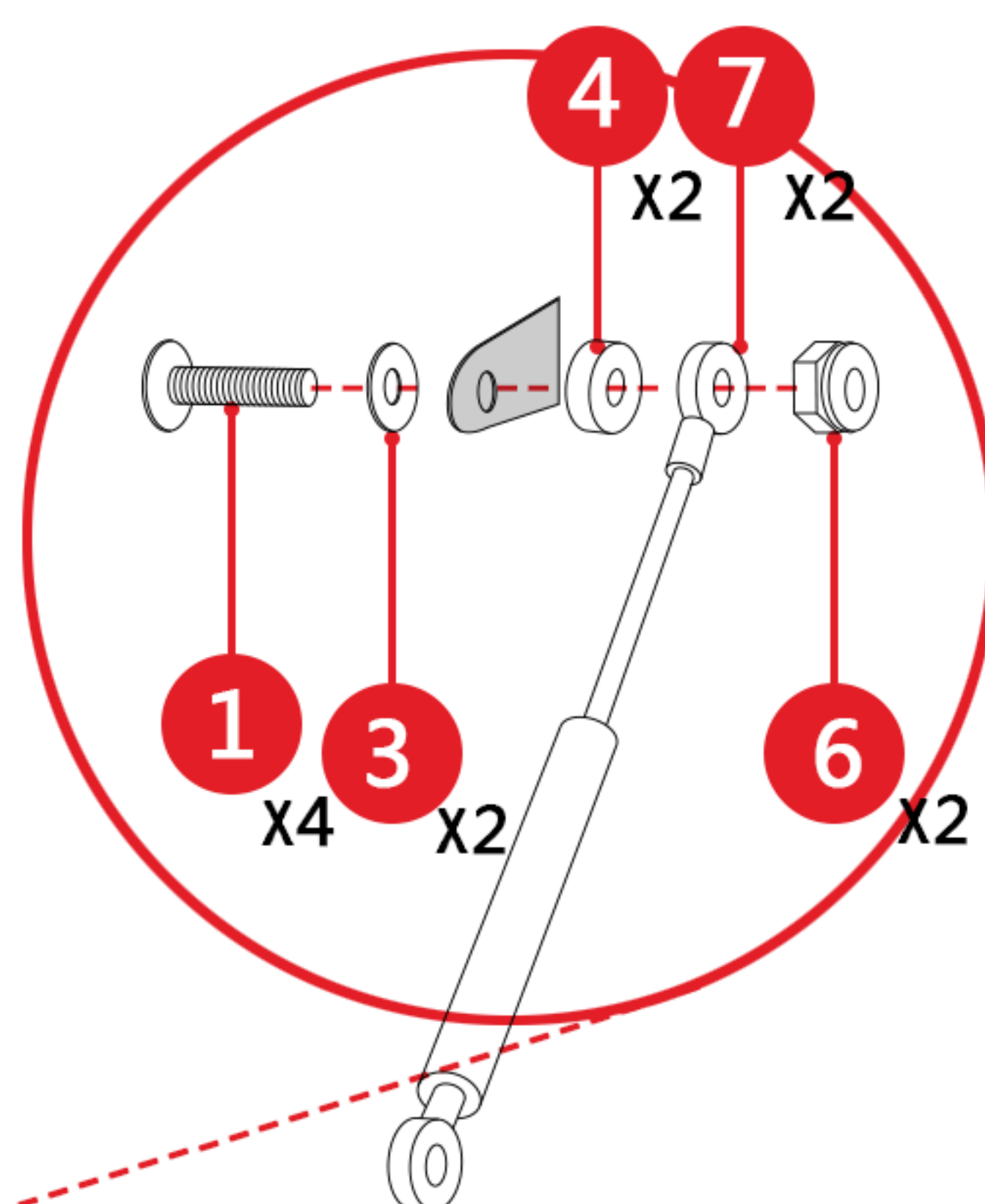

②

Attach the two part 7 arms with two part 1 screw and two part 5 spacers.

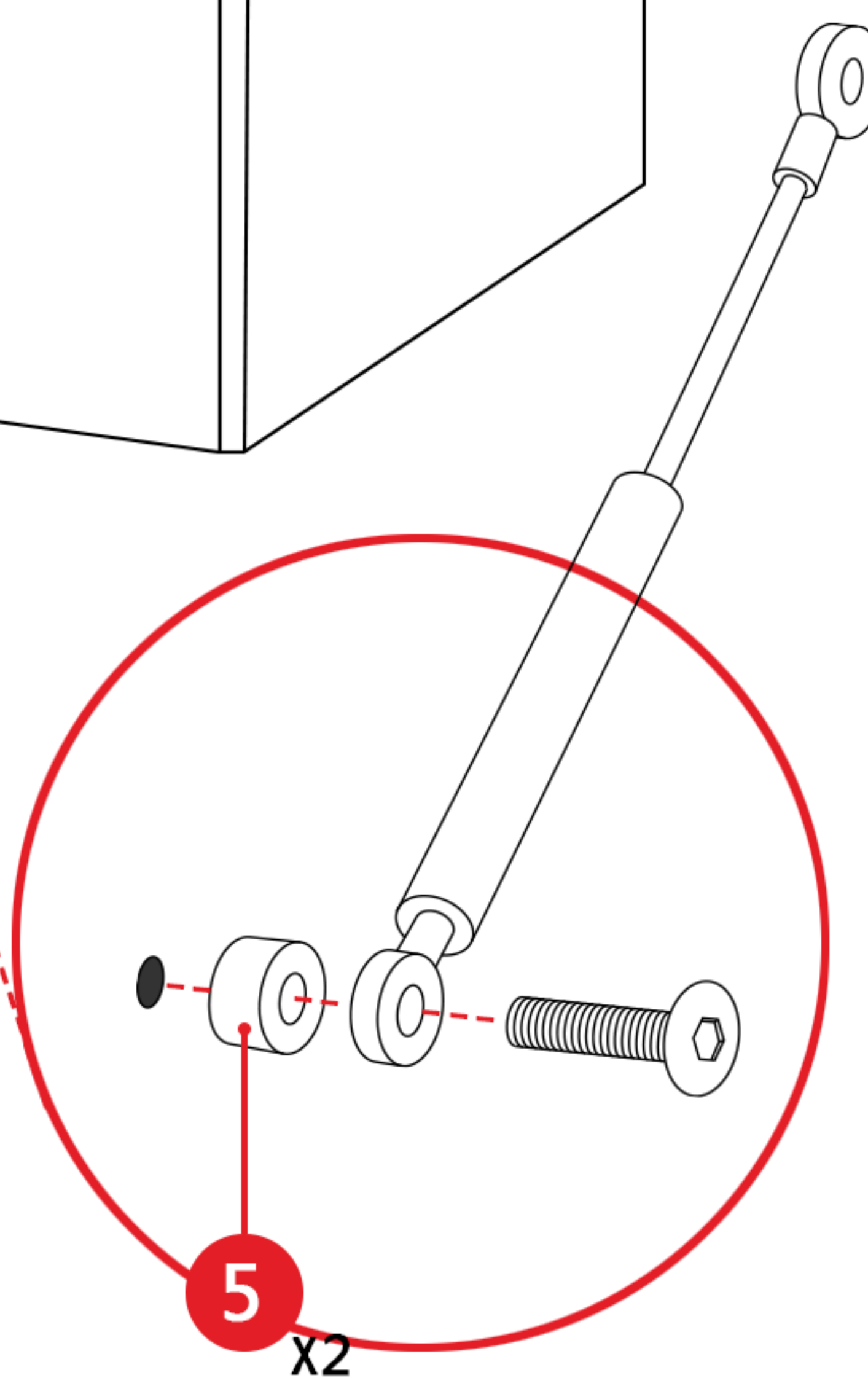

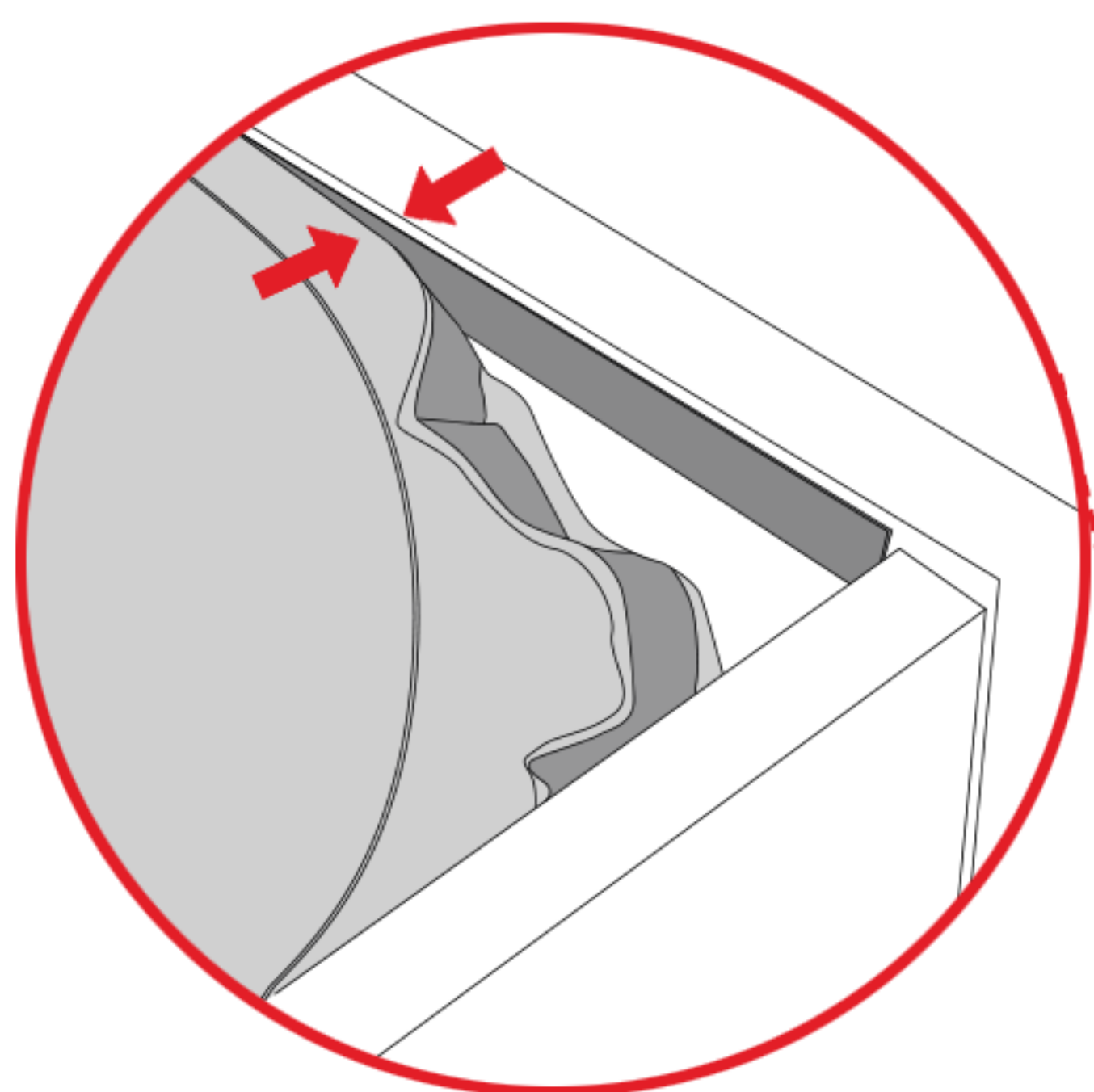

Attach part 11 inner bag with magic tape on four sides.

Attach the part 10 handle ring.

