

**Instruction Guide:**  
- Sprinter -  
**Air Compressor Kit**

# Checklist



- + REVIEW PACKING SLIP TO ENSURE YOU'VE RECEIVED ALL COMPONENTS**
- + PREPARE ALL TOOLS NECESSARY FOR PRODUCT INSTALLATION**
- + PRE-MEASURE DISTANCES OF ALL PRODUCT MOUNTING LOCATIONS**
- + CONFIRM CLEARANCES FOR OTHER INSTALLED BUILD COMPONENTS**
- + FOLLOW ALL SAFETY PRECAUTIONS WHEN WORKING ON THE VEHICLE**

# Packing Slip



## Components List

VNSPD-050-(SUBASSEMBLY#)

### Air Compressor Mount

VNSPD-050-SA1

Quantity : x1

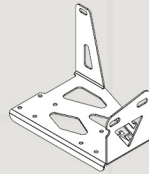

### Air Accessory Set (16pcs)

87400

Quantity : x1



### Chuck Mount (Engine Bay)

VNSPD-050-SA2

Quantity : x1



### Air Brake Tubing (50ft)

38952BA

Quantity : x1

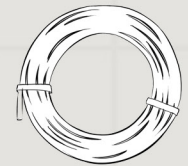

### Chuck Mount (Pinch Seam)

VNSPD-050-SA3

Quantity : x1



### ARB Twin Compressor

CKMTA12

Quantity : x1

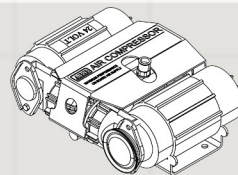

# Packing Slip



## Hardware Kit

VNSPD-050-HK

**1/2" Steel Flat Washer**

Quantity : x4



**5/16" Button Head Bolts**

Quantity : x2

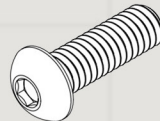

**5/16" Steel Flat Washers**

Quantity : x2



**5/16" Nylon Lock Nuts**

Quantity : x2



**1/4" Push-In x FIP  
Bulkhead Unions**

Quantity : x2



**1/4" MIP  
Interchange Couplers**

Quantity : x2



**1/4" Push-In x MIP  
Branch Tee**

Quantity : x1

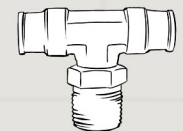

# Step 01



## Begin to secure the Air Compressor Mount into place inside the bay

Along the upper edge of the firewall on the driver-side, locate the chassis bolt that will be unfastened and reused to secure the Air Compressor Mount into place.

Note\* Leave the mount slightly offset down and to the left in order to leave clearance for the removal of the hood hinge bolts in the following step

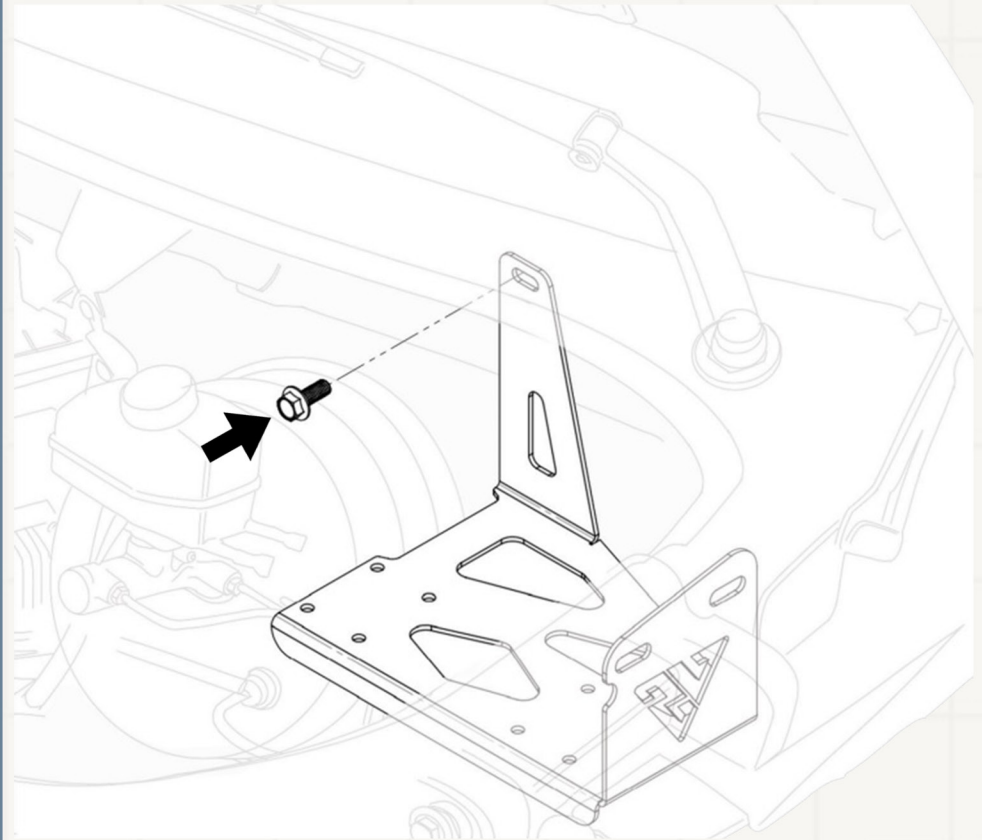

Hardware:



REUSE x1 FIREWALL BOLT

+ + +

# Step 02



## Finish securing the Air Compressor Mount into place inside the bay

Along the driver-side, remove and reuse the hood hinge bolts to finish installing the Air Compressor Mount into place within the upper righthand corner inside of the engine bay.

Note\* It may be helpful to have support from a friend when removing hood hinge bolts

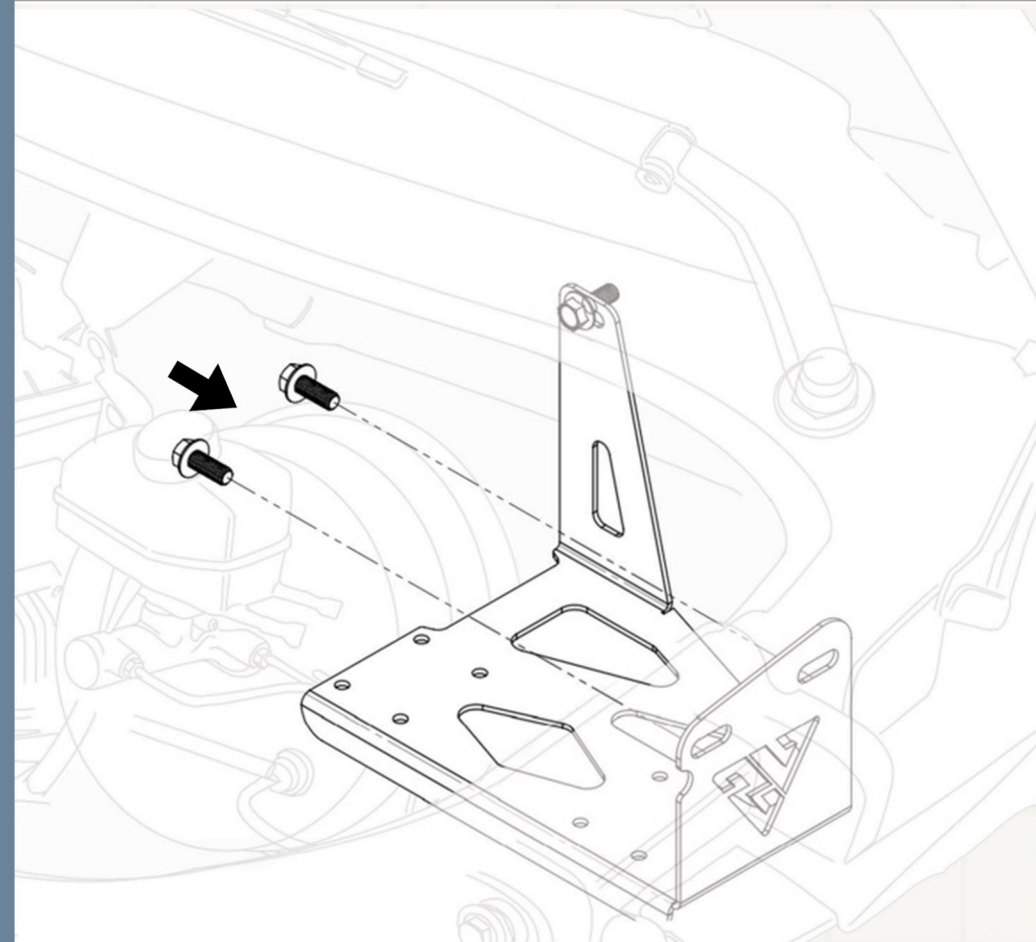

Hardware:



REUSE x2 HOOD HINGE BOLTS

+ + +

# Step 03



## Mount the ARB Twin Compressor inside of the engine bay

Using the hardware included inside of the box for the ARB Twin Compressor, thread the hardware through the (x8) top-facing through-holes on the Air Compressor Mount.

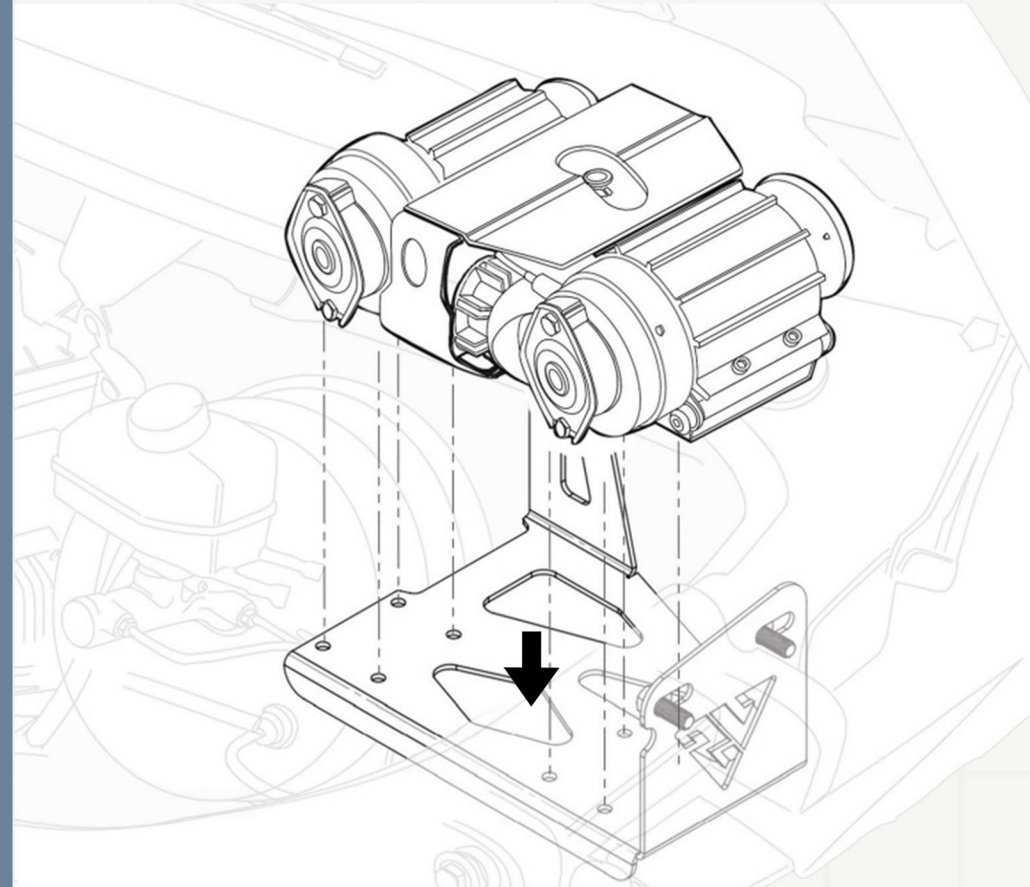

Hardware:

**USE HARDWARE INCLUDED WITHIN  
ARB COMPRESSOR KIT**



# Step 04



## Install the Engine Bay Chuck Mount through the passenger-side of the bay

On the passenger-side of the engine bay, remove and reuse the hood hinge bolts to install the Engine Bay Chuck Mount into place in the upper lefthand corner of the bay.

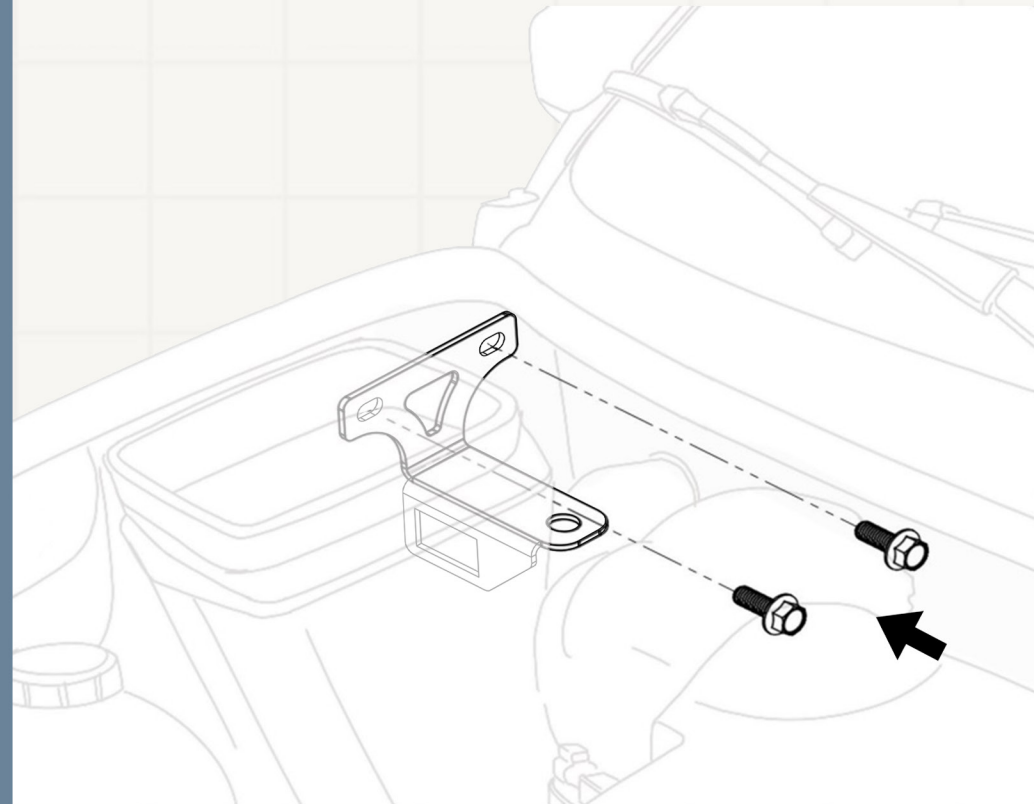

Hardware:



REUSE x2 HOOD HINGE BOLTS

+ + +



# Step 05



## Mark and drill bolt holes along the pinch seam for the other Chuck Mount

Using the Pinch Seam Chuck Mount as a reference for bolt hole spacing, mark and drill (x2) bolt holes along the length of the vehicle's pinch seam.

Note\* Be sure to pre-measure the length of air brake tubing that you intend to use for your system to ensure that your mounting location is correctly-placed

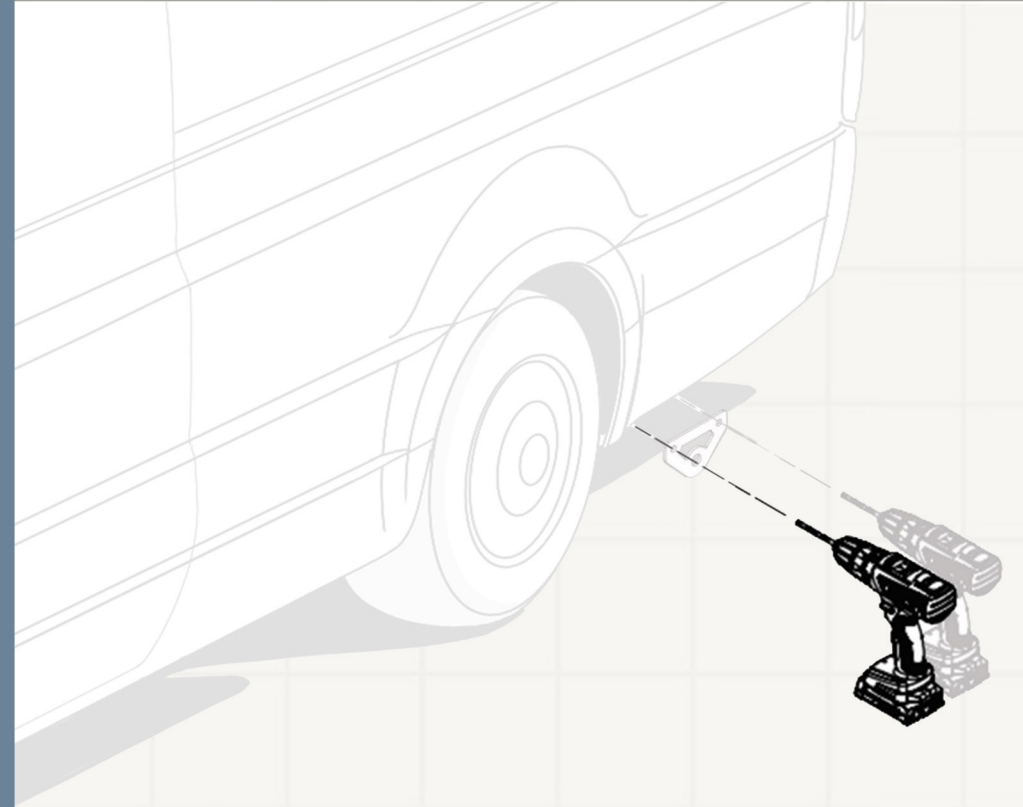

Hardware:



x2 HOLES



# Step 06



## Install the Pinch Seam Chuck Mount to your preferred location

From the outside facing in, use (x2) of the 5/16" button head bolts w/ (x2) of the 5/16" steel flat washers to secure the remaining Chuck Mount along the length of the pinch seam threaded through (x2) 5/16" serrated flange nuts on the reverse side.

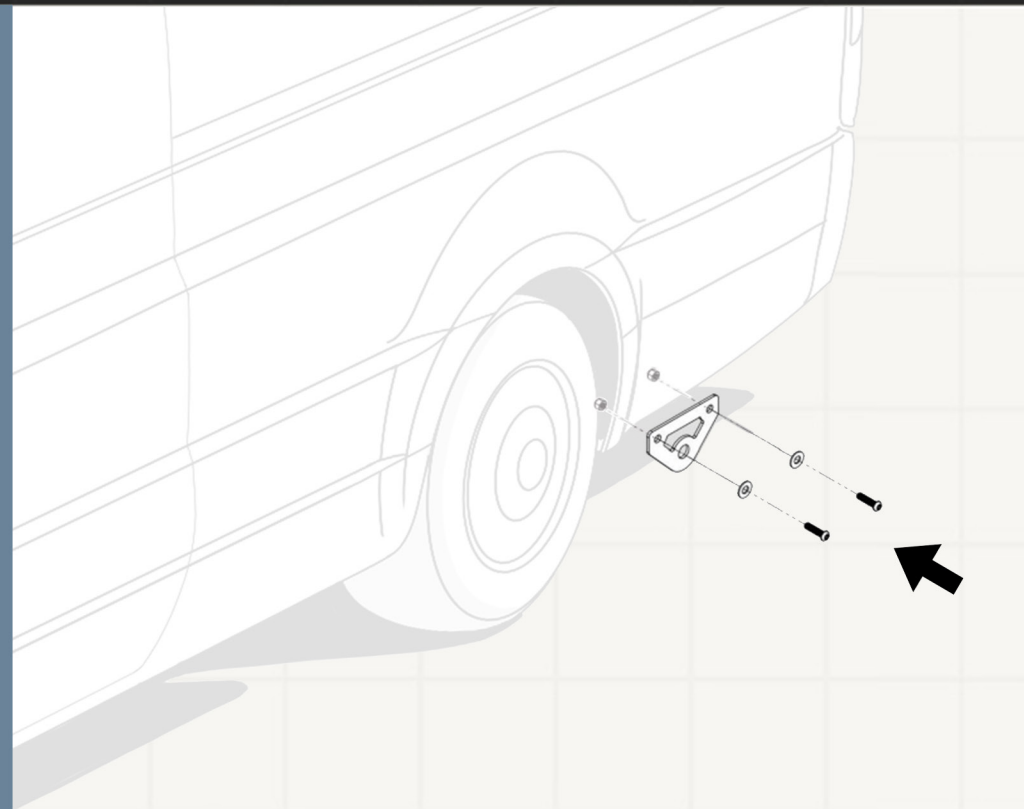

Hardware:



You've Reached the Finish Line

