

Installation guide

Exchange Water tap

-

*for kitchens from
the end of 2018*

Expansion:



1.

Remove the bowls from the rinsing compartment.

Loosen the lock with the aid of a 27mm wrench.
(pic. 1).



2.

Pull off the blue-white hose (pic. 2).

Note:

It is also possible to first remove the hose and then unscrew the cap.

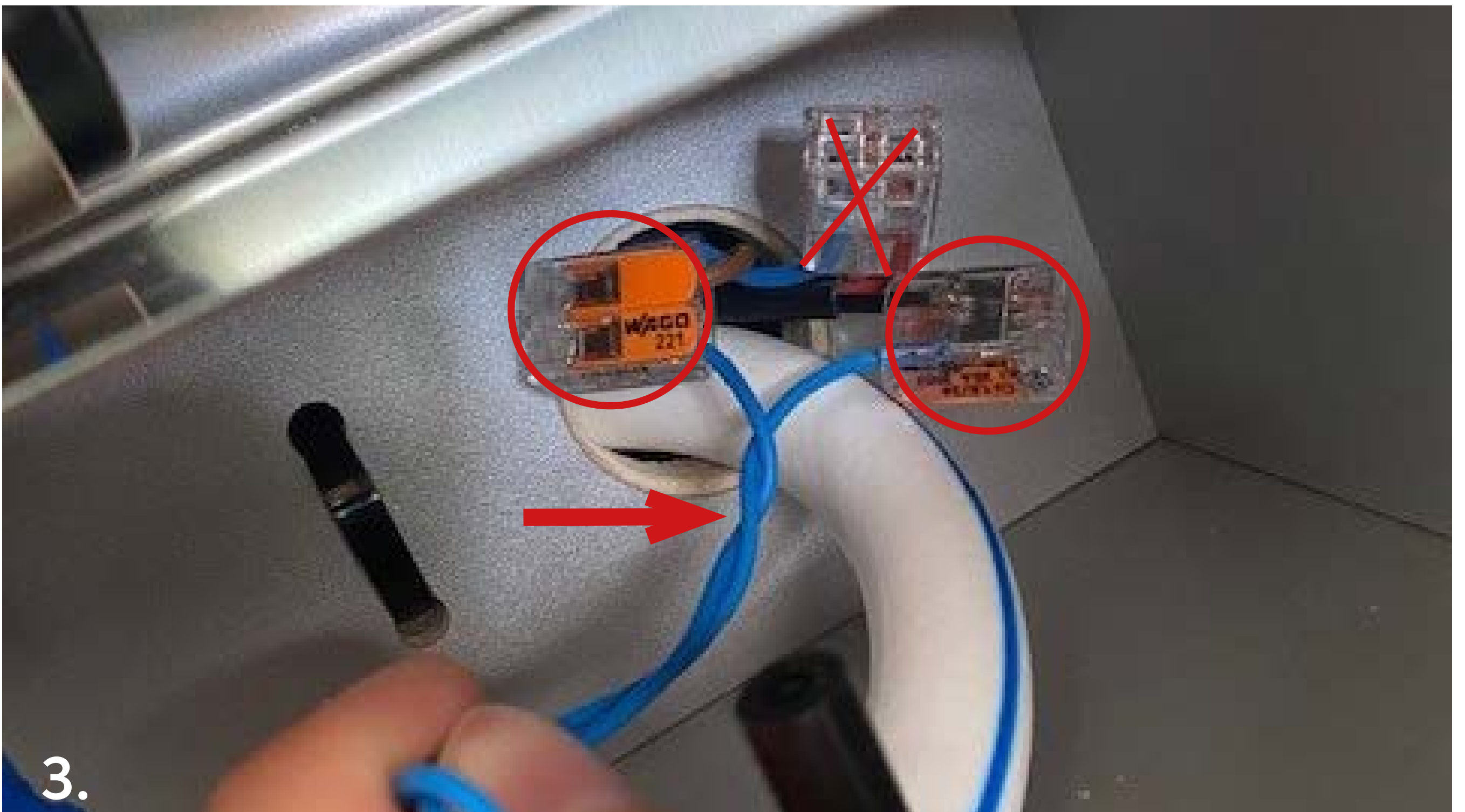

Loosen only the two Wago clips that are connected to the water tap (red circle, pic. 3).

Important:

Do not disconnect all 3 Wago clips , because the 3rd clip (red X, pic. 3) is responsible for plus and minus and should not be reconnected.

Installation:



Put the cables including the new water tap back into the hole in the sink and connect the two cables with the Wago clips. (pic. 4).

Note:

The arrangement is not relevant for the two cables.



Fasten the blue-white hose to the water tap (pic. 5).



Close the cover on the Water tap (pic. 6).

If you have any further questions please contact us:
+49 (0) 8063 / 20 760 - 0 oder info@vanessa-mobilcamping.de

VanEssa mobilcamping | Lauser Strasse 27 | 83620 Grosshöhenrain | Deutschland
Tel. +49 (0) 8063/20 760-0 | info@vanessa-mobilcamping.de