



Project	
Notes	
Type	Date
Cat. No.	

**BLP™ Series**

**LED Backlit Panel**



**DESCRIPTION**

Typically used to replace traditional fluorescent lights lay-in fixture. The BLP series is a next generation family of edge lit led flat panel fixtures designed to lay in drop ceilings in offices, schools, and healthcare applications. The flat panels are fully dimmable, compatible with building controls, motion sensors, and daylight harvesting systems. The design of the BLP series panels produces an even and consistent shadow-less light. Equipped with adjustable wattages, ranging from twenty-five to fifty watts. The LED's enable long life, high lumen maintenance, high CRI, low maintenance, and constructed without hazardous materials.

**Specification Features**



**Construction**

Extruded aluminum housing featuring a matte white finish with smooth opalescent acrylic lens. Lens design and materials provide uniform appearance without pixelation.

**Qualifications**

All luminaires are built to UL 1598 and 2108 standards, and bear appropriate ETL labels. Damp location labeling is standard. Emergency equipped fixtures labeled UL924. Adheres to LM70, LM80, and TM21 industry standards. DesignLights Consortium® (DLC) qualified product. Not all models of this product may be DLC qualified. Please check the DLC Qualified Products List at [www.designlights.org/QPL](http://www.designlights.org/QPL) to confirm which models are qualified.

**Warranty**

5-year Limited Warranty. See warranty documentation for more information.

**Electrical**

Equipped standard with 0-10V continuous dimming driver that works with any standard 0-10V control/dimmer. Long-Life LED's hours at L80 with projected life over 100,000 hours for reduced life cycle maintenance costs.

**Installation**

Suitable for recessed mounting within T-Bar grid. Optional surface mounting, suspension and flange kit for drywall ceiling available.

**Options**

Optional On/Off or Bi-Level Motion sensor, high voltage transformers, emergency battery backups, whips and cords.

**BLP Series**

- 2x2 Housing**  
25W, 30W, 40W
- 2x4 Housing**  
30W, 40W, 50W

- Rated Life 100,000 hours
- Limited Warranty 5 Years
- Efficacy ~ 140 lm/W
- Continuous Dimming



**QuickShip/DLC Qualified**

- BLP-22-40-MVD-840
  - BLP-22-30-MVD-840
  - BLP-22-25-MVD-840
  - BLP-24-50-MVD-840
  - BLP-24-40-MVD-840
  - BLP-24-30-MVD-840
- Available February 2020

**Ordering Information**

Example: BLP-22-40-MVD-840

BLP	22	40/30/25	MVD	8	40
<b>Series</b> BLP LED Backlit Panel, Adjustable Wattage	<b>Form Factor</b> 22-2"x2"² 24-2"x4"²	<b>Rated Wattage</b> <b>2x2 Housing</b> 40- 40W (4400 Lumens) <b>2x4 Housing</b> 50- 50W 5500 Lumens,	<b>Driver Type</b> MVD- 120-277V; 0-10V Dimming³	<b>CRI</b> 8 80+ CRI³	<b>Color Temp</b> 40 4000K³
<b>Options</b>			<b>Options</b>		
<b>Emergency Backup</b> EML8 800lm EML16 1600lm			<b>Controls</b> MOSB- Integral Bi-Level Microwave Sensor MOS- Microwave Sensor, On/Off	<b>Accessories</b> FW3 6' 3 Wire Fixture Whip FW4 6' 4 Wire Fixture Whip FW312- 12' 3 Wire Fixture Whip	<b>Mounting Accessories</b> SM-BLP-22- 2'x2' Surface Mount Kit SM-BLP-24- 2'x4' Surface Mount Kit FK-22-2'x2' Flange Kit FK-24- 2'x4' Flange Kit

Specifications and Dimensions subject to change without notice.

## Performance Summary

Input Voltage	120-277V
Input Frequency	50/60 Hz
Rated Wattage	See Performance Table
Delivered Lumens	See Performance Table
Efficacy	110 lm/W
CRI	80+, R9 > 0
Available CCT <sup>1</sup>	4000K
Beam Angle	120°
Rated Life	50,000 hours
L70 <sup>2</sup>	> 72,000 hours or > 45,000
Power Factor	>0.95
THD	< 2.3%
Dimming	0-10V Continuous(10-100%)
Operating Temp.	-20°C to 45°C

## Performance Data

Lens Type	Form Factor	Catalog No.	Rated Wattage (W)	Delivered Lumens	Efficacy (lm/W)
Frosted Acrylic	2x2	<a href="#">BLP-22-40-MVD-840</a>	40W	4,400	110
	2x4	<a href="#">BLP-24-50-MVD-840</a>	50W	5,500	110

### NOTES:

- <sup>1</sup> Made to order items. Minimum 90 day lead time. Minimum 500 order quantity.
- <sup>2</sup> DLC Listed
- <sup>3</sup> Quick ship: 4000K. Other CCTs may require a lead time or be special order  
Typical color consistency. May vary or be changed.
- <sup>4</sup> Actual performance may differ as a result of end-user environment and application. All values are design or typical values, measured under laboratory conditions at 25 °C.



Specifications and Dimensions subject to change without notice.

Product Dimensions

BLP-22

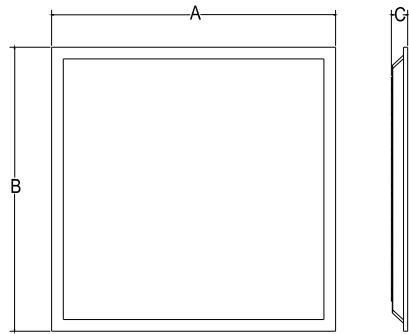

Dimensions	A	B	C
2*2ft	24in.	24in.	1.0 in.

BLP-24

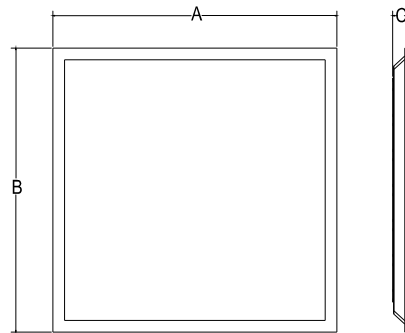

Dimensions	A	B	C
2*4ft	48in.	24in.	1.0 in.

Installation Instructions

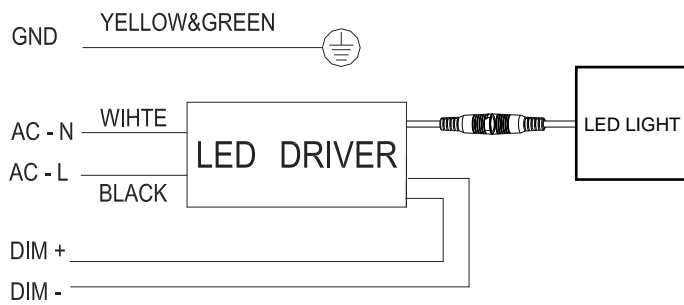

Step1

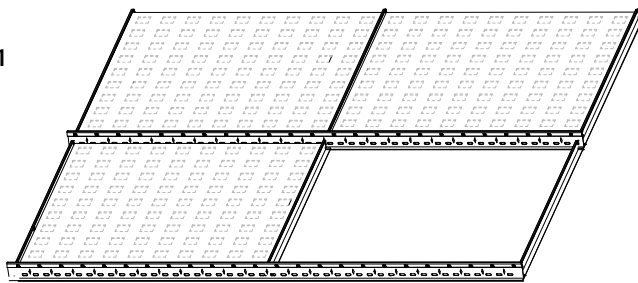

Step1-1

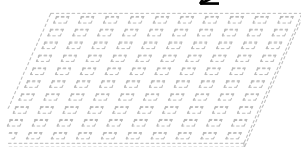

Step1-2

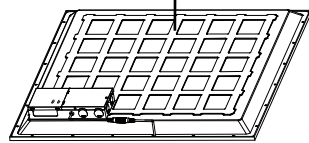

Step2

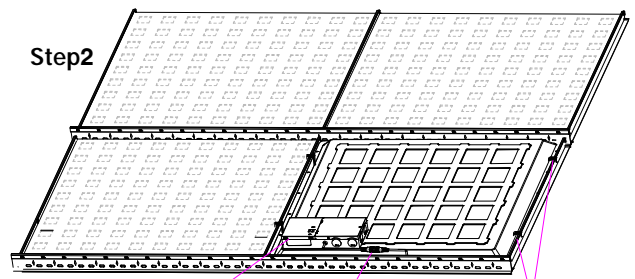

Step2-3

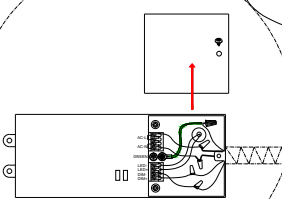

Step2-2

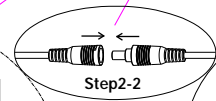

Step2-1

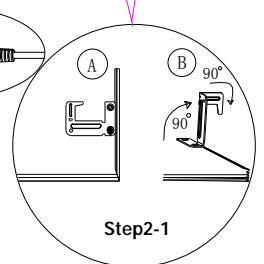

Specifications and Dimensions subject to change without notice.

Photometric Data

BLP-22-40-MVD-835 Tested in accordance to IESNA LM-79

Coefficients of Utilization

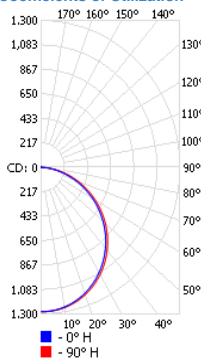

Zonal Lumen Summary

Zone	Lumens	% Lamp	% Luminaire
0-30	998.9	27.10%	27.10%
0-40	1,637.90	44.40%	44.40%
0-60	2,901.60	78.70%	78.70%
60-90	781.1	21.20%	21.20%
0-90	3,682.70	99.90%	99.90%

Coefficients of Utilization

Effective Floor Cavity Reflectance: 20%

RCC %:	80				70				50	
	RW %:	70	50	30	0	70	50	30	0	50
RCR: 0	1.19	1.19	1.19	1.19	1.16	1.16	1.16	1	1.11	1.11
1	1.09	1.04	1	0.96	1.06	1.02	0.98	0.84	0.97	0.94
2	0.99	0.9	0.84	0.78	0.96	0.89	0.82	0.71	0.85	0.8
3	0.9	0.79	0.71	0.65	0.87	0.78	0.7	0.6	0.75	0.68
4	0.82	0.7	0.61	0.55	0.8	0.69	0.61	0.52	0.66	0.59
5	0.76	0.63	0.54	0.47	0.74	0.62	0.53	0.45	0.59	0.52
6	0.7	0.56	0.47	0.41	0.68	0.55	0.47	0.39	0.54	0.46
7	0.65	0.51	0.42	0.36	0.63	0.5	0.42	0.35	0.49	0.41
8	0.6	0.47	0.38	0.32	0.59	0.46	0.38	0.31	0.45	0.37
9	0.56	0.43	0.34	0.29	0.55	0.42	0.34	0.28	0.41	0.34
10	0.53	0.39	0.31	0.26	0.51	0.39	0.31	0.26	0.38	0.31



© 2019 GlobaLux Lighting, LLC. All rights reserved. For informational purposes only. Reproduction in whole or part is prohibited without prior written consent of the copyright owner. The information presented in this document does not form part of any quotation or contract, is believed to be accurate and reliable and may be changed without notice. No liability will be accepted by the publisher for any consequences of its use. GlobaLux Lighting reserves the rights make changes in specification at any time without notice.

GlobaLux Lighting LLC  
 www.globaluxlighting.com  
 2037 S. Vineyard Ave  
 Ontario, CA 91761  
 Ph: 909-591-7506