



## **Mobile & Consumer Electronics Accessory**

| PRODUCTS LINE UP |

MOBILE & TWS CASE

Luxurious Sand Texture & Double Protective Case

# SANDY CASE

It is a new concept and new material smartphone case that adds a unique texture of sand to the luxury of the brand. In addition, you can enjoy clearer sound by applying a 'FOCUS SOUND SYSTEM' that transmits sound to the front of the conventional bottom.



## SANDY CASE



### FEATURE

- Focus Sound System (FSS) - Excluding Galaxy S7/S7 Edge/Note5
- Double layered protection
- Optimal Camera Hole
- Unique texture



### LINE UP



YELLOW



BLACK

Double Protection Case

# HARDSHELL CASE

Designed with the most basic protection as the top priority. The shock-resistant polycarbonate and flexible TPU dual structure make your smartphone safer. It also incorporates the brand's value with its finely processed intaglio logo.



## HARDSHELL CASE

### FEATURE

- Combining scratch-resistant PC with flexible TPU
- Dual structure for shock protection
- Luxurious intaglio logo
- Optimal camera hole and button design



### LINE UP



WHITE

BLACK

Complete transparency

# CRYSTAL CLEAR CASE

Protect the side of the device with flexible materials while still showing the original color and design of the smartphone with complete transparency.



## CRYSTAL CLEAR CASE

### FEATURE

- Scratch-resistant material
- 4-Side Fully Covered
- Optimal Camera Hole
- User-friendly design



Soft material (TPU)  
Hard material (polycarbonate)

### LINE UP



BASIC LOGO



BLACK LOGO



WHITE LOGO

Perfect transparency and grip.

# CRYSTAL SLIM FIT CASE V3

The National Geographic Crystal Slim Fit Case is made up of transparent PC material that shows perfect transparency from either side, and the slim fit provides the best grip on your hand. In addition, the National Geographic Yellowborder point symbol adds luxury.



# CRYSTAL SLIM FIT CASE V3

## FEATURE

- Transparent polycarbonate material with less yellowing
- 4-Side Fully Covered
- Easy to attach and detach with grooves in 4 corners of the case
- Sophisticated design of front screen and Camera Hole
- Luxurious intaglio logo



## LINE UP



CLEAR

Combination of a clean transparent case with a convenient card pocket

# CARD POCKET CASE

The National Geographic Card Pocket Case enhances convenience by adding a clean transparent case and a convenient card pocket. Original card pocket design is presented with a subtle gloss unique to the pu leather, a delicate logo imprint, and matte metal decoration.



## CARD POCKET CASE |

### | FEATURE |

- Convenient card pocket
- TPU+PC materials optimized for protection
- Sophisticated structure design
- Wireless charging available



### | LINE UP |



BLACK



NAVY



GRAY



BROWN

Powerful Magsafe Magnetism

# MAGSAFE CLEAR CASE

The National Geographic Magsafe Clear Case features a maximum hardness of 9H material and a more magnetic PC seat + magnet layer to provide robust retention and reliable wireless charging, while a soft TPU material wraps the side of the device to fully protect the device.



## MAGSAFE CLEAR CASE

### FEATURE

- Multi-structured design made of the best materials
- Perfect compatibility with a variety of MagSafe Acc.
- TPU bumper for shock protection
- Luxurious intaglio logo
- Sophisticated structure design



### LINE UP



iPhone 14

iPhone 14 Plus

iPhone 14 Pro

iPhone 14 Pro Max



born of nature

# NATURE WOOD CASE

The product is made of 100% natural wood with minimal processing, and the more it is used, the deeper the color becomes, and the longer the distinctive scent of the wood lasts.

Feel the natural scent of trees in the National Geographic Nature Wood Case.



There is a slight difference in the part of the key/end button depending on the model type.

## NATURE WOOD CASE

### FEATURE

- Eco-friendly Wood Case
- Harmony of materials
- Luxurious processing
- Optimal Camera Hole
- Sophisticated structure design



### LINE UP



GLOBAL SEAL

BIG LOGO

Magnetic cradle compatible

# METAL DECO

The National Geographic Metal Deco Case is a practical product that is compatible with a vehicle magnetic cradle. National Geographic's unique graphic on luxurious metal makes your Smartphone stand out.



# HARD SHELL CASE

It is designed with the most basic protection as the top priority, and is a practical product compatible with a magnetic cradle.

### FEATURE

- Double layered protection
- Optimal Camera Hole
- luxurious metal emblem
- Compatible with magnetic cradle



### LINE UP



# WOOD CASE

It is made of 100% natural wood with minimal processing, and the more it is used, the deeper the color becomes and the longer the distinctive scent of the wood lasts. Also, metal deco's magnetic cradle compatibility features make it practical.

### FEATURE

- 100% natural wood with minimal processing
- luxurious metal emblem
- Optimal Grip
- Compatible with magnetic cradle



### LINE UP

Side types may vary depending on the model.



Meet wild animals.

# INTO THE WILD

Meet a wide range of wildlife in a new graphic in a jelly hard case that perfectly protects the side of the device with urethane material while retaining the original design of the smartphone with the transparent material on the back and a double-protective case with the highest priority on protecting the smartphone.



## JELLY HARD CASE |

The urethane material perfectly protects the side of the device while the transparent material on the back preserves the original design of the smartphone.

### | FEATURE |

- Simple and clean
- Scratch-resistant material
- Side protection
- Optimal Camera Hole
- Sophisticated user-conscious design

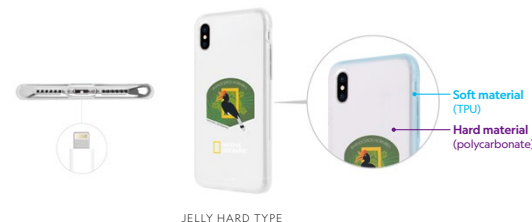

### | LINE UP |



## DOUBLE PROTECTIVE CASE |



We designed with the most basic protection as the top priority.

### | FEATURE |

- Focus Sound System (FSS) - Excluding Galaxy S7/S7 Edge/Note5
- Double layered protection
- User-friendly design



### | LINE UP |



Explore.

# TOPOGRAPHY/COMPASS

Topography, which informs explorers of the height of the terrain, becomes important information, and compasses become an important tool for pioneering new paths.

Don't you think holding this case will make you feel like an explorer?



## SLIM FIT CASE

It provides a slim and comfortable grip with a fitting that fits perfectly with a smartphone.

### FEATURE

- Slim design for comfortable grip
- Optimal Camera Hole
- User-friendly design



### LINE UP

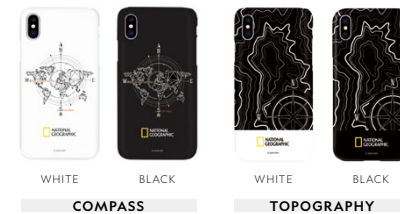

## DOUBLE PROTECTIVE CASE

We designed with the most basic protection as the top priority.

### FEATURE

- Focus Sound System (FSS) - Excluding Galaxy S7/S7 Edge/Note5
- Double layered protection
- User-friendly design



### LINE UP

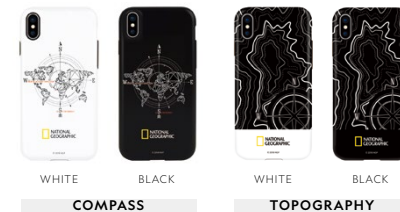

ICEBERGS ARE HOME

# ICEBERGS EDITION

Climate change is heating the Arctic hotter than anywhere else, and it reduces the Arctic sea ice by 14% every 10 years. For polar bears that consume an average of 12,325 kcal per day, traveling and swimming in search of shelter and food is a life-threatening act. We should try to stabilize the global climate as soon as possible to protect them.



## SLIM FIT CASE

It provides a slim and comfortable grip with a fitting that fits perfectly with a smartphone.

### FEATURE

- Slim design for comfortable grip
- Optimal Camera Hole
- User-friendly design



### LINE UP



POLAR BEAR

PENGUIN

## JELLY CASE

It shows the original design of the smartphone with soft and flexible TPU material.

### FEATURE

- Scratch-resistant material
- 4-Side Fully Covered Protection
- Optimal Camera Hole
- User-friendly design



### LINE UP



POLAR BEAR

PENGUIN

JELLY TYPE

For Galaxy Z Flip Series

# CRYSTAL CLEAR CASE

The National Geographic Z Flip Series Crystal Clear Case has a polycarbonate material back plate that is strong against shock and scratches, The combination of soft side TPU materials completely protects the device and perfectly shows the original color and design of the smartphone. In addition, you can feel a luxurious three-dimensional and vivid color using a multi-layered printing technique that does not come off easily.



# CRYSTAL CLEAR CASE

## FEATURE

- Transparent polycarbonate material back plate
- Perfect double protection (PC+TPU)
- Luxurious multi-layer printing technique
- User-friendly design



Camera Protection

## LINE UP



BASIC LOGO



ADVENTURE



CAMPING

For Galaxy Z Flip Series

# SLIM FIT RING STRAP CASE

The National Geographic Slim Fit Ring Strap Case applies a ring strap that perfectly matches a flip-type foldable device. It provides an optimal grip not only when the device is unfolded but also when folded. Also, the metal ring carabiner can be used in various ways to suit the needs of users.



## SLIM FIT RING STRAP CASE

### FEATURE

- Slim thickness
- Polycarbonate material resistant to shock and scratch
- Ring strap design for optimum grip
- Various customizations using metal carabiners
- Sophisticated structure design



### LINE UP



BLACK

For Galaxy Z Flip Series

# CRYSTAL SLIMFIT RING STRAP CASE

The National Geographic Crystal Slim Fit Ring Strap Case provides optimal grip by applying a clean, transparent, polycarbonate material that shows the natural color of your smartphone and the ring strap that best matches your flip-type foldable device. In addition, the metal ring carabiner can be used in a variety of ways to suit your needs.



# CRYSTAL SLIMFIT RING STRAP CASE

## FEATURE

- Transparent polycarbonate material with less yellowing
- Ring strap design for optimal grip
- Various customizations using metal carabiner
- Sophisticated structure design



## LINE UP



BLACK



BEIGE



For Galaxy Z Flip Series

# RING STRAP CASE

The National Geographic Ring Strap Case enhances convenience by adding metal ring to the case made of matte PC material optimized for slimness. National Geographic's original graphic of exploration, adventure, and discovery are presented in a luxurious way with special printing techniques.



# RING STRAP CASE

## FEATURE

- Slim thickness
- Polycarbonate material that is resistant to impact and scratches
- Ring strap design for optimal grip
- Various customizations using metal carabiner
- Sophisticated structure design

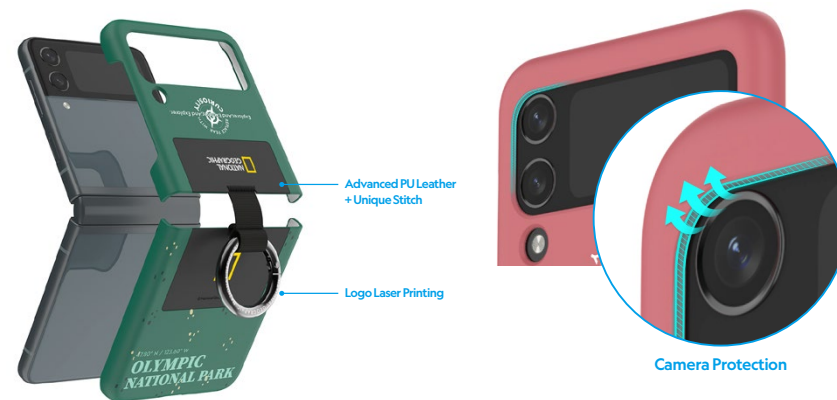

## LINE UP



HARDAP, NAMIBIA | SAHARA DESERT | EASTBOURNE, ENGLAND | DISKO BAY GREENLAND | EXUMA CAYS BAHAMAS | OLYMPIC NATIONAL PARK

For Galaxy Z Flip Series

# RING STRAP CRYSTAL CASE

The National Geographic Ring Strap Crystal Case enhances convenience by adding a metallic ring to a transparent PC case that fully shows the original color of the device. National Geographic's unique graphics are produced with 'Layered Printing' techniques to provide a luxurious color and a differentiated three-dimensional effect.



# RING STRAP CRYSTAL CASE

## FEATURE

- Slim thickness
- Polycarbonate material that is resistant to impact and scratches
- Ring strap design for optimal grip
- Various customizations using metal carabiner
- Sophisticated structure design

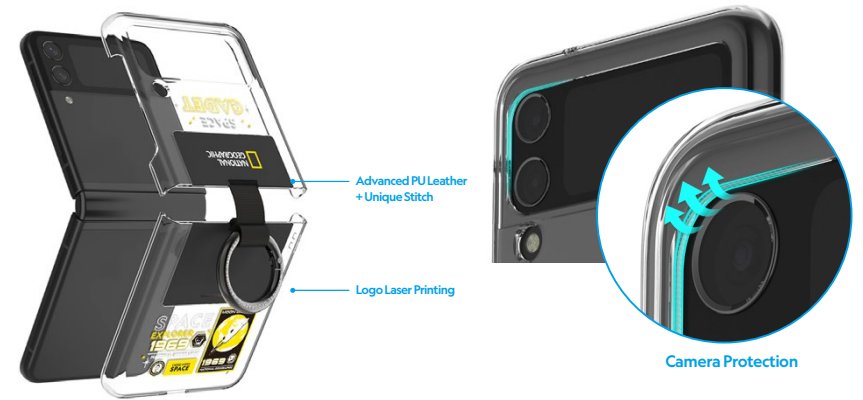

## LINE UP



EVEREST

MONT BLANC

WHITNEY

MOON LANDING

1969

SPACESHIP

For Galaxy Z Flip Series

# BUSINESS WALLET CASE

The National Geographic Business Wallet Case offers a luxurious design with leather's unique subtle gloss, delicate logo imprints, and yellow border metal decorations, and enhances convenience by applying versatile metal rings. Also, the unique pocket structure optimized for storage makes it easy and safe to store cards.



# BUSINESS WALLET CASE

## FEATURE

- Luxurious PU leather case and modern metal ring
- Environment-friendly artificial PU leather that passes harmful detection tests
- multipurpose card pocket (maximum of 3 cards)
- Stable and comfortable grip
- Sophisticated user-conscious design



## LINE UP



BLACK

GRAY

NAVY

BROWN

For Galaxy Z Flip Series

# SLIM FIT CASE V2

The National Geographic Z Flip Series Slim Fit Case offers a perfect fit and comfortable grip with 1.6mm thick slim fit, and the National Geographic logo's precise processing and UV printing bring out a three-dimensional and luxurious feel.



## Z FLIP SERIES SLIM FIT CASE V2

### FEATURE

- Slim thickness (1.6 mm)
- Luxurious processing with inking and UV printing
- Scratch-resistant, high-strength PC materials
- Optimal Camera Hole
- Sophisticated structure design
- Wireless charging available



### LINE UP



BASIC LOGO      GLOBAL SEAL      YELLOW BORDER



BASIC LOGO (WHITE CASE)      GLOBAL SEAL (WHITE CASE)      YELLOW BORDER (WHITE CASE)

For Galaxy Z Fold Series

# CRYSTAL SLIM FIT CASE

The National Geographic Z Fold Series Crystal Slim Fit Case is a clean, transparent polycarbonate material that perfectly shows the natural color and design of your smartphone, and offers a luxurious three-dimensional and vivid color experience with an easy-to-peel additive printing technique.



## CRYSTAL SLIM FIT CASE

### FEATURE

- Provides a slim fit & comfortable grip
- Clean and transparent polycarbonate (PC) material
- Luxurious additive printing techniques
- Sophisticated structure design
- Soft feeling of use
- Perfect adhesion without worrying about leaving
- Wireless charging available

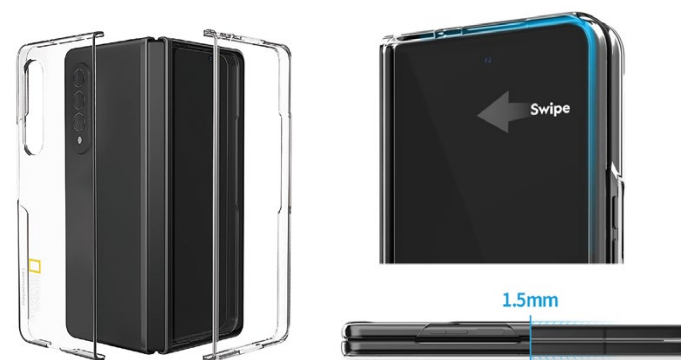

### LINE UP



BASIC LOGO

CAMPING

ADVENTURE

For Galaxy Z Fold Series

# SLIM FIT CASE V2

National Geographic Z Fold Series Slim Fit Case V2 offers a perfect fit and comfortable grip, and the inner non-slip fixing tape is perfectly adhered and folded several times. You can use it without moving the case even when you open it.



## Z FOLD SERIES SLIM FIT CASE V2

### FEATURE

- Provides a slim fit & comfortable grip
- Slim and simple for optimal value
- Perfect adhesion
- Soft feeling of use
- Optimal camera holes (lens protection, light smudging, anti-reflective)
- Sophisticated structure design



Camera Protection

### LINE UP



BASIC LOGO (WHITE CASE)    GLOBAL SEAL (WHITE CASE)    BIG LOGO (WHITE CASE)



BASIC LOGO    GLOBAL SEAL    BIG LOGO

For Galaxy Z Fold Series

# SLIMFIT CASE WITH S-PEN HOLDER

The National Geographic Z Fold Series Slim Fit Case with S Pen Holder has a Velcro method, so the holder can be removed and pasted according to the user's needs. Even when the pen holder is not used, the three-dimensional representation of the National Geographic lettering and the three-dimensional processed logo make the case stand out even more.



## SLIMFIT CASE WITH S-PEN HOLDER

### FEATURE

- Provides a slim fit & comfortable grip
- Slim and simple for optimal value
- Detachable pen holder with Velcro
- Soft feeling of use
- Optimal camera holes (lens protection, light smudging, anti-reflective)
- Sophisticated structure design
- Wireless charging available



### LINE UP



BASIC LOGO



S-PEN HOLDER

For Galaxy Z Fold 4

## BUSINESS WALLET CASE WITH S-PEN HOLDER

National Geographic Z Fold 4 Business Wallet Case with S Pen Holder is easy to remove and store separately when not using a pen. It is also an optimized case for businesses that can store business cards, cards, bills, or receipts using multi-purpose storage space.



## BUSINESS WALLET CASE WITH S-PEN HOLDER

### FEATURE

- PU leather that passed the harmful test
- Detachable S Pen Holder with Magnetic function
- Comfortable grip
- Luxurious design (Heating stamp logo, Metal Symbol)
- Business-optimized storage space



### LINE UP



COMPONENT

BLACK

NAVY

GRAY



Optimized for business.

# BUSINESS WALLET CASE

The National Geographic Business Wallet Case is made of PU leather that has been tested for harmfulness, and the cover is not separated and secured by magnetic closures to enhance unity. In addition, it is easy to store cards, banknotes, receipts, etc. using multipurpose pockets.



## BUSINESS WALLET CASE | for Galaxy Fold Series

It is made of fabric that has been tested for harmfulness and can be used safely from harmful substances.

### FEATURE

- PU leather (passed test for harmfulness by certification authority)
- User-friendly design
- Convenient grip
- Luxury design (Heating stamp logo, Metal Yellow border decoration)
- Multipurpose storage space

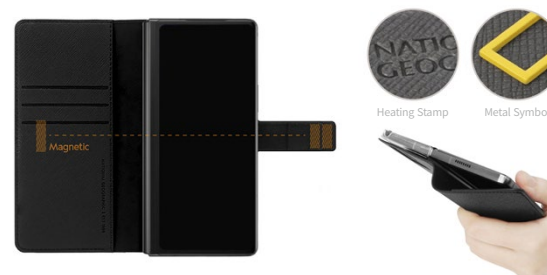

### LINE UP



SAFFIANO BLACK

## BUSINESS WALLET CASE | for Galaxy&iPhone Series

It is made of fabric that has been tested for harmfulness and can be used safely from harmful substances.

### FEATURE

- PU leather (passed test for harmfulness by certification authority)
- User-friendly design
- Convenient grip
- Luxury design (Heating stamp logo, Metal Yellow border decoration)
- Multipurpose storage space



### LINE UP



SAFFIANO BLACK

with a new graphic from National Geographic.

# GRAPHIC CASE

The National Geographic Graphics case protects the side of the device with urethane material while providing a complete color and design of the smartphone with transparent polycarbonate material on the back. Meet the new graphic case of National Geographic.



## WAPPEN JELLY HARD CASE

The urethane material protects the side of the device completely and provides a perfect grip with a slim design.

### FEATURE

- Dual-injection of 2 Materials (PC/TPU)
- Scratch-resistant
- 4-Side fully covered protection
- Optimal camera hole
- User-friendly design



### LINE UP



## MAGAZINE JELLY HARD CASE

The urethane material protects the side of the device completely and provides a perfect grip with a slim design.

### FEATURE

- Dual-injection of 2 Materials (PC/TPU)
- Scratch-resistant
- 4-Side fully covered protection
- Optimal camera hole
- User-friendly design



### LINE UP

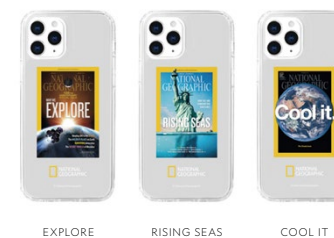

Soft and flexible. Perfect protection.

# PALETTE COLOR CASE

The National Geographic Palette Color Case prevents damage to the device even when removed or installed with excellent grip and flexible fit. Luxurious color expressions provide a pleasant variety depending on the style you want.



## PALETTE COLOR CASE |

### | FEATURE |

- Elegant and various colors
- Soft-touch TPU+liquid silicone coating
- Microfiber internal lining
- Full cover design that wraps all sides tightly



### | LINE UP |



Unique Wappen graphics and luxurious printing techniques.

# PALETTE COLOR WAPPEN CASE

The National Geographic Palette Color Wappen Case uses unique patch graphics and advanced printing techniques to prevent peeling off for a long time. It prevents damage to the device when used with excellent grip and flexible fit.



# PALETTE COLOR WAPPEN CASE

## FEATURE

- A combination of luxurious and various colors and unique wappen designs
- Soft-touch TPU+liquid silicone coating
- Microfiber internal lining
- Full cover design the wraps all sides tightly



## LINE UP



YOSEMITE BLACK



TOPOGRAPHY BLACK



EXPLORER ROSE RED



CURIOSITY NAVY



UNIVERSE BLACK



SURFING STONE BEIGE



CLIMBING GRAY BLUE



CAMPING FOREST GREEN

Smooth, flexible, complete protection

# SOFT CASE

National Geographic Soft Case prevents damage to the device even when removed or installed with excellent grip and flexible fit. In addition, the signature is expressed with a unique printing technique that reflects the angle of light.



## SOFT CASE

### FEATURE

- Unique printing technique
- Soft touch TPU+liquid silicone coating
- Sophisticated structure design
- Microfiber lining
- Wireless charging available
- Delicate full cover design that covers all sides seamlessly



### LINE UP



More than 50% of 'GRS certified' recycled materials are used for sustainable Earth

# EARTH DAY CASE

The National Geographic Earth Day Case celebrates Earth's Environmental Protection Day, which was established by conservationists, with a message informing them of the seriousness of the global environmental pollution problem. Protect the Earth's environment together with an Earth Day case using recycled plastic materials.



## EARTH DAY CASE

### FEATURE

- Use 50% plastic recycled material (GRS certification)
- TPU+PC materials optimized for protection
- 4-SIDE Full Cover
- Optimal Camera Hole
- Sophisticated structure design



### LINE UP



Comfortable Grip & Protection

# SILICONE CASE

The National Geographic silicone case is a combination of soft-touch liquid silicone and shock-resistant PC material, providing excellent shock protection and grip. Also, the soft suede lining inside the casing protects the mobile phone from scratches.



## SILICONE CASE

### FEATURE

- Combination of shock-resistant PCs with soft silicone
- Grip comfortably
- Careful protection with internal suede material
- Case exterior coating resistant to contamination and discoloration
- Sophisticated structure design



### LINE UP



WHITE

BLACK

PURPLE

MINT

PINK

GREEN

Unique & Trendy

# STRAP

The National Geographic strap case is easy to operate with one hand due to its easy size adjustment, and it combines design and practicality with a unique design that enhances the brand image of the product.



## SLIM FIT CASE

It provides a slim and comfortable grip with a fitting that fits perfectly with a smartphone.

### FEATURE

- Reliable and comfortable grip
- Unique design
- User-friendly design



### LINE UP



WHITE BLACK

LOGO PATCH



WHITE BLACK

SIGNATURE WEBBING

## DOUBLE PROTECTIVE CASE



The most basic feature, smartphone protection, is the top priority and provides a comfortable grip.

### FEATURE

- Focus Sound System (FSS) - Excluding Galaxy S7/S7 Edge/Note5
- Reliable and comfortable grip
- Unique design
- Double layered protection



Urethane  
PC (Polycarbonate)

### LINE UP



WHITE BLACK

LOGO PATCH



WHITE BLACK

SIGNATURE WEBBING



National Geographic

# GLOBAL SEAL

National Geographic continues various research and exploration for the development of Earth and humanity, and continues research and exploration for the Earth and humanity at this moment. Buying a product from National Geographic goes beyond simple consumption and joins the National Geographic journey for the Earth and humanity.



## ULTRA SLIM FIT CASE |

It has a 0.4mm ultra-slim case to provide a flawless fit. It maintains the original thickness of the smartphone with perfect fitting and is light.

### | FEATURE |

- 0.4mm ultra slim
- Ultra lightweight
- Optimal Camera Hole
- User-friendly design



### | LINE UP |



MATTE BLACK

## SLIM FIT CASE |

The slim design that can show the smartphone design as it provides adequate adherence and optimal grip.

### | FEATURE |

- Slim design for comfortable grip
- Optimal Camera Hole
- User-friendly design



### | LINE UP |



MATTE BLACK

National Geographic

# GLOBAL SEAL

National Geographic continues various research and exploration for the development of Earth and humanity, and continues research and exploration for the Earth and humanity at this moment. Buying a product from National Geographic goes beyond simple consumption and joins the National Geographic journey for the Earth and humanity.



## DOUBLE PROTECTIVE CASE

Designed with protection as a top priority, the focus sound system allows you to enjoy a clearer sound.

### FEATURE

- Combining scratch-resistant PC with flexible TPU
- Dual structure for shock protection
- Optimal camera hole and button design

### LINE UP



## CARD DOOR BUMPER CASE

Open type cover design makes it easy to store cards and enhances convenience by attaching high-quality mirrors with excellent reflectivity.

### FEATURE

- Open type cover design allows you to store cards easily (up to 2 cards)
- You can easily hold it anywhere by using the stored card
- Magnetic fixation allows safe storage
- Sophisticated design that considers users
- Wireless charging without interruption (only wireless charging models)

### LINE UP



MATTE BLACK

Exploration is near.

# EXPLORE FURTHER EDITION

The National Geographic Purder Edition has a message that exploration is waiting everywhere in our daily lives under the theme of 'Exploration is Close.' It is a smartphone case that contains individuality with a soft case that wraps the device with flexible materials, a sand case that expresses unique sand texture, and a slim fit case that gives a slim and comfortable grip.



## SLIM FIT CASE

The National Geographic Pudder Edition Slim Fit Case is a sleek design that offers a comfortable grip and is unique in its unique lettering representation.

### FEATURE

- Unique lettering and processing
- Slim design for comfortable grip
- Optimal Camera Hole
- User-friendly design



### LINE UP



WHITE BLACK

## SOFT CASE

Soft and flexible TPU material makes it easy to detach and completely wraps around your smartphone to protect both the sides and rear of your device at the same time. It also increases its uniqueness by lettering, which is reflected differently depending on the angle of light.

### FEATURE

- Soft and flexible TPU material
- Unique lettering and processing
- Soft curved parts and sophisticated design



### LINE UP



WHITE BLACK

## SANDY DOUBLE PROTECTIVE CASE



Designed with protection as a top priority, the focus sound system allows you to enjoy a clearer sound.

### FEATURE

- Focus Sound System (FSS)
  - Excluding Galaxy S7/S7 Edge/Note5
- Double layered protection
- Optimal Camera Hole
- User-friendly design
- Unique texture



### LINE UP



SANDY WHITE SANDY YELLOW SANDY BLACK

Corner Air Cushion Design

# CRYSTAL BUMPER TABLET CASE

The National Geographic Crystal Bumper Tablet Case is a clean, transparent TPU material that shows the device's original design, and the corner air cushion design effectively distributes the impact when it drops, helping to protect the device more completely. In addition, the enclosed National Geographic Wappen sticker allows you to make your case more special and unique.



# CRYSTAL BUMPER TABLET CASE

## FEATURE

- TPU material that does not break and is excellent for scratch and fingerprint protection
- Edge Air Cushion protects edges with tightness
- Sophisticated structure design
- National Geographic Customized Wappen Sticker with Removable Material Enclosed

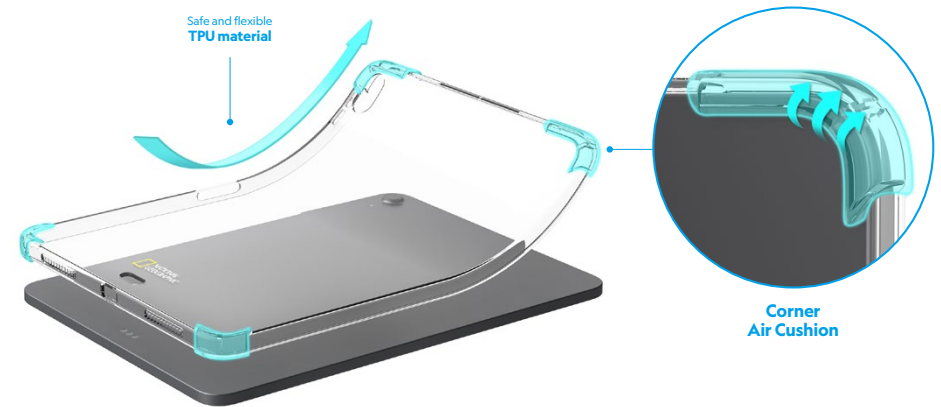

## LINE UP



CRYSTAL BUMPER TABLET CASE



WAPPEN STICKER

Tightly adhering to the device

# TWS CASE

The National Geographic AirPods/AirPods case is sleek and lightweight and portable. We've also enhanced the value of branding with National Geographic Original Logo.



## AIRPODS CASE

The National Geographic AirPods case comes in two types: soft and hard, and it is portable with a slim and light weight.

### FEATURE

- Tight adherence
- Soft type & Hard type with Slim fit
- Cap and body are separated for easy removal.
- Wireless charging available (AirPods 2nd generation wireless charging model only)
- Includes versatile carabiner

### LINE UP

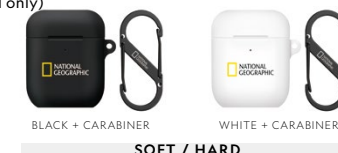

SOFT / HARD

## AIRPODS PRO 1&2 CASE

The National Geographic AirPod Pro case comes in two types, soft and hard, and is portable with a slim and light weight.

### FEATURE

- Tight adherence
- Soft type & Hard type with Slim fit
- Separated Cap and body for easy removal
- Wireless charging available
- Includes versatile carabiner

### LINE UP

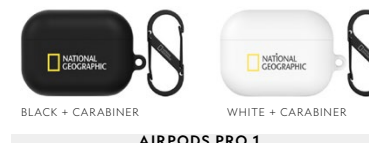

BLACK + CARABINER

WHITE + CARABINER

AIRPODS PRO 1

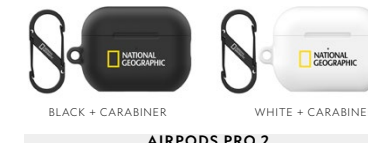

BLACK + CARABINER

WHITE + CARABINER

AIRPODS PRO 2

## AIRPODS 3 CASE

The National Geographic AirPods 3 case comes in two types: soft and hard, and it is portable with a slim and light weight.

### FEATURE

- Tight adherence
- Soft type & Hard type with Slim fit
- Separated Cap and body for easy removal
- Wireless charging available
- Includes versatile carabiner

### LINE UP

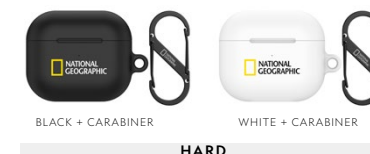

BLACK + CARABINER

WHITE + CARABINER

HARD

Tightly adhering to the device

# TWS CASE

The National Geographic Buds/Buds Live case is sleek and lightweight and portable. We've also enhanced the value of branding with National Geographic Original Logo.



## GALAXY BUDS CASE |

The National Geographic Buds case is of a solid hard type and is portable with a slim and light weight.

### | FEATURE |

- Comfortable grip
- Wireless charging available
- Includes versatile carabiner



### | LINE UP |



BLACK

WHITE

HARD

## GALAXY BUDS 2 PRO CASE |

The National Geographic Buds Live case is of a solid hard type and is portable with a slim and light weight.

### | FEATURE |

- Comfortable grip
- Wireless charging available
- Includes versatile carabiner
- Compatible with Galaxy Buds 2 Pro / Buds 2 / Buds Pro / Buds Live models



### | LINE UP |



BLACK

WHITE

HARD

Tightly adhering to the device

# CRYSTAL BUMPER CASE

The National Geographic TWS Crystal Bumper Case is a crystal-clear, transparent TPU material that show up the perfect device and design. In addition, the micro dot pattern inside the casing prevents the surface over pressure from developing and maintains a clean form clean.



## TWS CRYSTAL BUMPER CASE |

It is a soft TPU type in crystal form, and the micro dot pattern inside the case prevents surface over pressure and maintains a clean shape.

### | FEATURE |

- Microdot pattern for Prevent surface over pressure
- 360° Full Cover / Anti-Shock Bumper Design
- Soft and flexible TPU material
- Separated Cap and body for easy removal
- Wireless charging available (AirPods 2nd generation wireless charging model only)
- Includes versatile carabiner



### | LINE UP |

#### AIRPODS CASE |



CLEAR + CARABINER

#### AIRPODS PRO 1&2 CASE |



CLEAR + CARABINER

#### AIRPODS 3 CASE |



CLEAR + CARABINER

#### GALAXY BUDS 2 PRO CASE |

- Compatible with Galaxy Buds 2 Pro / Buds 2 / Buds Pro / Buds Live models



CLEAR + CARABINER

Complete protection of your device with air bumper

# CRYSTAL BUMPER WAPPEN CASE

The National Geographic TWS Crystal Bumper Wappen Case is an excellent case for shock protection with the application of TPU materials in a rigid crystal-type design. Experience a case of National Geographic's original Wappen graphics with transparency that shows the device as it is.



# CRYSTAL BUMPER WAPPEN CASE

It is a soft TPU type in crystal form, and the fine dot pattern inside the case prevents oil film phenomenon and maintains a clean shape.

## FEATURE

- Microdot pattern for Prevent surface over pressure
- 360° Full Cover / Anti-Shock Bumper Design
- Soft and flexible TPU material
- Separated Cap and body for easy removal
- Wireless charging available (AirPods 2nd generation wireless charging model only)
- Includes Yellowboard Strap

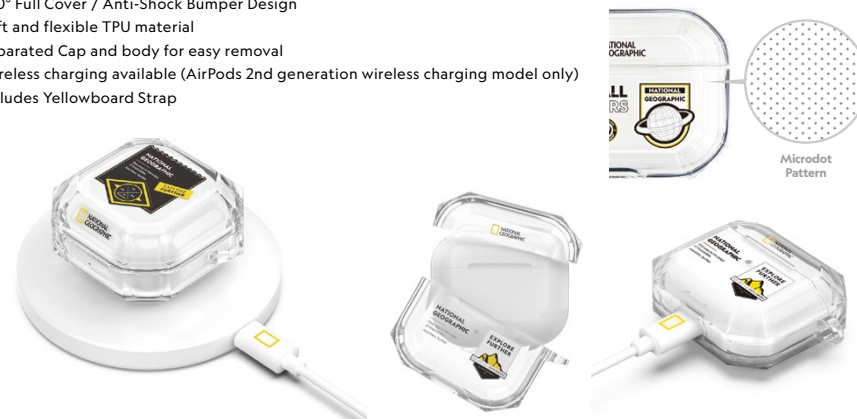

## LINE UP

### AIRPODS CASE



### AIRPODS PRO 1&2 CASE



### AIRPODS 3 CASE



### GALAXY BUDS 2 PRO CASE

- Compatible with Galaxy Buds 2 Pro / Buds 2 / Buds Pro / Buds Live models

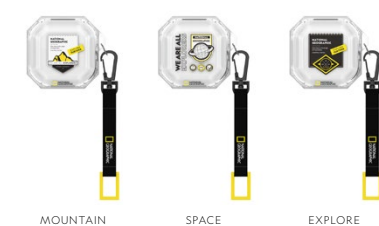



More than 50% of 'GRS certified' recycled materials are used for sustainable Earth

# TWS EARTH DAY CASE

The National Geographic Earth Day Case uses an artwork to commemorate the Earth's Environmental Protection Day established by nature conservationists to inform the seriousness of the global environmental pollution problem. Protect the Earth's natural environment with the Earth's Earth Day case using recycled plastic materials.



# TWS EARTH DAY CASE |

## | FEATURE |

- Use 50% or more of GRS certified recycled materials
- Transparent and clean TPU material
- Perfect shock protection
- Wireless charging available
- Includes versatile carabiner



## | LINE UP |

\* AIRPODS 3 / AIRPODS PRO 1&2 / BUDS 2 PRO / BUDS 2 / BUDS PRO / BUDS LIVE

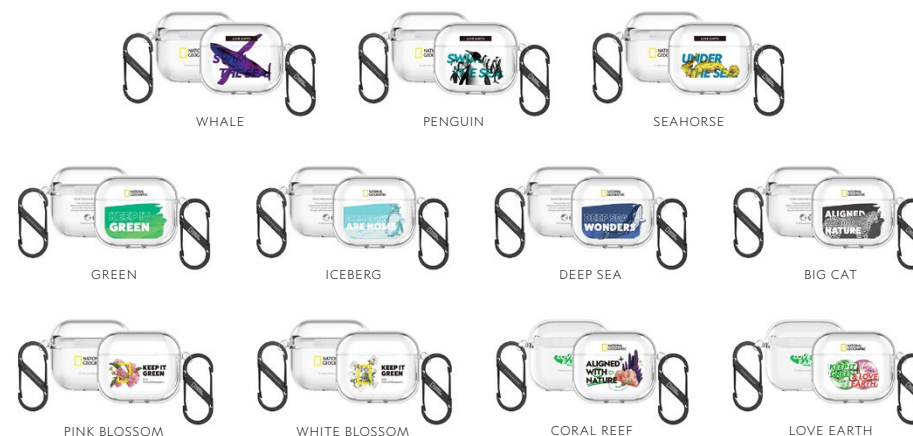

Protect your product more powerfully

# TWS RUGGED BUMPER CASE

The National Geographic TWS Rugged Bumper Case protects the product from external shocks and scratches with durable, soft TPU materials and rigid PC materials, and the bumper on the edge of the product disperses impact from falling and protects the device even more.



## TWS RUGGED BUMPER CASE

Soft TPU materials and rugged PC materials protect your product from external shocks and scratches and are portable with versatile carabiner.

### FEATURE

- Tight adherence
- Impact resistant edge bumper
- Separated Cap and body for easy removal
- Wireless Charging available (wireless charging model only)
- Includes versatile carabiner

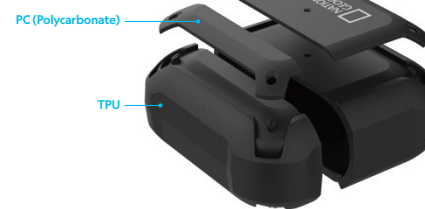

### LINE UP

#### AIRPODS CASE



BLACK + CARABINER    YELLOW + CARABINER

#### AIRPODS PRO 1&2 CASE



BLACK + CARABINER    YELLOW + CARABINER

#### AIRPODS 3 CASE



BLACK + CARABINER    YELLOW + CARABINER

#### GALAXY BUDS 2 PRO CASE

- Compatible with Galaxy Buds 2 Pro / Buds 2 / Buds Pro / Buds Live models



BLACK + CARABINER    YELLOW + CARABINER

Powerful and secure 'Lock' function to protect TWS case

# RUGGED BUMPER LOCK CASE

The National Geographic TWS Rugged Bumper Lock Case can only be opened and closed with the lock button held. It keeps the device safe without the risk of separation not only daily life but also extreme leisure situations.



While pressing the bottom of the lock button, you can open the device.



# TWS RUGGED BUMPER LOCK CASE

Soft TPU materials and rugged PC materials protect your product from external shocks and scratches and are portable with versatile carabiner.

## FEATURE

- Shock-resistant PC + Soft TPU Combination
- Bumper type design for perfect protection
- Lock Button for unit loss prevention
- Wireless charging available
- Includes versatile carabiner

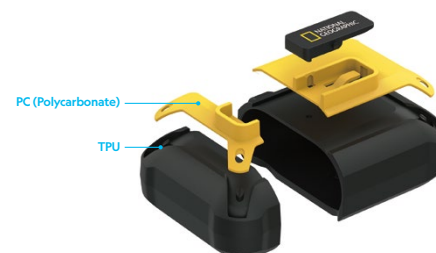

## LINE UP

### AIRPODS CASE



BLACK YELLOW GRAY SAND KHAKI

### AIRPODS PRO 1&2 CASE



BLACK YELLOW GRAY SAND KHAKI

### AIRPODS 3 CASE



BLACK YELLOW GRAY SAND KHAKI

### GALAXY BUDS 2 PRO CASE

- Compatible with Galaxy Buds 2 Pro / Buds 2 / Buds Pro / Buds Live models



BLACK YELLOW GRAY SAND KHAKI

Powerful and secure 'Lock' and auto-opening

# RUGGED BUMPER AUTOLOCK

The National Geographic TWS Rugged Bumper Auto Lock Case allows you to open and close the device only with the lock button held, ensuring that the device is safe from disconnection from everyday life to extreme leisure situations.



Press the bottom of the lock button to open automatically.



## AIRPODS PRO 1/2 CASE

It can effectively disperse shock and prevent device separation and unit loss from impact and fall.

### FEATURE

- Shock resistant PC + resilient TPU combined
- Bumper design for full protection
- Unit Loss Prevention Lock Button
- Wireless charging available
- Includes versatile carabiner



BLACK



YELLOW



GRAY



SAND KHAKI

### LINE UP

## AIRPODS 3 CASE

It can effectively disperse shock and prevent device separation and unit loss from impact and fall.

### FEATURE

- Shock resistant PC + resilient TPU combined
- Bumper design for full protection
- Unit Loss Prevention Lock Button
- Wireless charging available
- Includes versatile carabiner

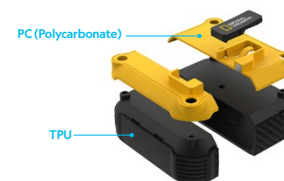

BLACK



YELLOW



GRAY



SAND KHAKI

### LINE UP

MOBILE ACCESSORY

with both design and practicality

# GRIPTOK

You can use your smartphone with one hand in a stable and comfortable manner, as well as stand functions and earphone arrangements as needed. Built-in metal plates are compatible with magnetic car mounts for easy mounting and ease of use.



## FEATURE

- Stable grip
- Available as a stand
- Compatible with magnetic car mounts
- Use semi-permanent gel pads



## LINE UP



WALNUT



CHERRY WOOD



ROSE WOOD



ALUMINUM  
BLACK



BASIC LOGO  
BLACK



BASIC LOGO  
WHITE

Triangle Structural Design & Use of Flexible TPU Material

# MOBILE GRIP TOK

National Geographic Mobile GripTok boasts solidity using high-end acrylic materials, and offers a more three-dimensional and brilliant color with an epoxy finish. Collect National Geographic's unique graphics in various forms of Griptok.



## MOBILE GRIP TOK

### FEATURE

- National Geographic's unique artwork
- Advanced Acrylic Material + Epoxy Finish
- Sophisticated, user-conscious design
- Design of the regular triangle structure of the genuine Griptok - optimum grip
- Reliable use of the cradle
- Powerful Special Gal (Gel) Adhesive Tape



### LINE UP

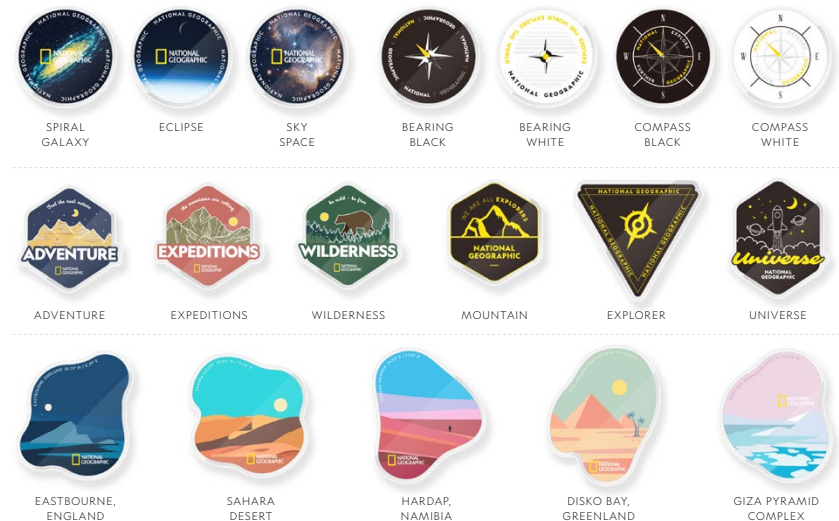

Modern and sporty design that goes well with everything

# SMART WATCH STRAP

The National Geographic Smart Watch strap is stylish with National Geographic's original graphic design and six colourful configurations, and uses high-quality TPU materials that are resistant to waterproofing and contamination and soft, providing comfort and excellent durability.



## SMART WATCH STRAP | APPLE / GALAXY

### FEATURE

- National Geographic's Original Graphics
- Flexible, soft, high-quality TPU material
- Excellent breathability in delicate projection design
- 2 mm Slim thickness
- a perfect sense of unity

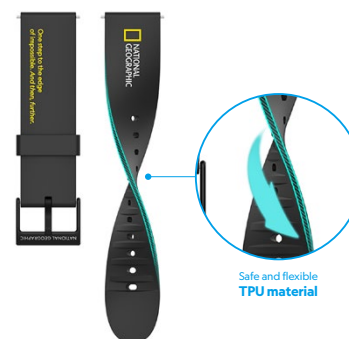

### LINE UP

#### APPLE WATCH STRAP

ADAPTER + STRAP ALL-IN



BASIC BLACK

TOPO PINK

TOPO BLACK

GRID WHITE

GRID GRAY

TOPO KHAKI

TOPO NAVY

#### GALAXY WATCH STRAP

SPRING CONNECT TYPE





Advanced TPU material prevents discoloration

# SMART WATCH CLEAR STRAP

The National Geographic Smart Watch Clear Strap has a trendy design that adds National Geographic's unique graphics to a sleek, glossy, transparent strap for fashionable wear. High-quality TPU material that is resistant to waterproofing and contamination in daily life and provides a comfortable fit and excellent durability.



## SMART WATCH CLEAR STRAP | APPLE / GALAXY

### FEATURE

- National Geographic's Unique Graphics
- Flexible, soft, high-quality TPU material
- Excellent anti-discolor protection
- 2 mm Slim thickness
- a perfect sense of unity



### LINE UP

APPLE WATCH STRAP		GALAXY WATCH STRAP	
ADAPTER + STRAP ALL-IN		SPRING CONNECT TYPE	
	TOPO WHITE		
	TOPO BLACK		
	TYPO WHITE		
	TYPO BLACK		

Free from anywhere

# CAR HEADREST CRADLE

National Geographic Car Headrest Cradle is easy to install and use on the head restraint of the driver or passenger seat of a typical vehicle. The Silicone pad of the holder can be used without slipping when mounting the device. and it is compatible with various sizes of smartphones and tablets.



# CAR HEADREST CRADLE

Easy to install and use on the head restraint of the driver or passenger seat of a typical vehicle. It also applies a folding holder to ensure safe use even if the device is not in use.

## FEATURE

- Compatible with various size of device (4.7 to 12.9 inches)
- Folding holder design enables safe use
- Protect the device by attaching a non-slip pad, preventing it from slipping
- 360 degree of rotation & free angle adjustment
- Convenient charging ports

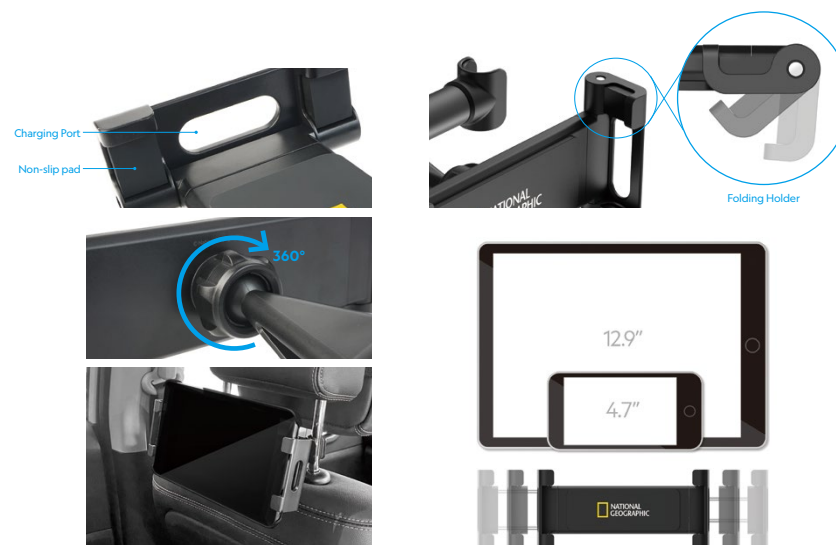

## COMPONENTS



SCREW CAP

SEAT CRADLE

CAR HEADREST CRADLE

Free Angle Control

# MAGNETIC CAR CRADLE

National Geographic Magnetic Car Cradle adds luxury by putting the brand's unique color and logo on the product. There are three types that can be positioned in the user's desired location, and it can be positioned quickly and easily with one hand due to its strong adsorption.



FEATURE

- Easy cradle
- Strong holding force
- Free angle adjustment
- Using semi-permanent available gel pads (DASH BOARD TYPE)
- Includes metal plate/protection film



LINE UP



Must have item for travel

# TRAVEL ADAPTER

The National Geographic Travel Adapter is slim and light, easy to carry and practical for use in more than 150 countries. It has a dedicated pouch that can be shock-protected for easy storage.



The National Geographic Travel Adapter is for overseas use only and cannot be used in Korea.

## TRAVEL ADAPTER\_S

This product can be charged simultaneously with two USB ports.

### FEATURE

- Slim Size
- Two USB ports can be charged simultaneously
- Extra fuse for overloading
- Includes dedicated pouch



### COMPONENTS

## TRAVEL ADAPTER\_EX

Two USB ports supporting up to 2.4A and C-Type terminals with 3A high-speed charging can be used simultaneously, and can be charged with iPad, iPhone, Android mobile, tablet, digital camera, MP3 and GPS.

### FEATURE

- Dual fuse (automatically shut off when overloaded)
- Includes dedicated pouch



### COMPONENTS

One-touch & Tube Type

# WATERPROOF BAG

It's a tube type that doesn't sink under water, and protects your smartphone with perfect waterproof four-locking structure. Soft TPU material provides a durable, natural touch.



FEATURE

- Floating TUBE TYPE
- Screen touch available (Photographs / Videos)
- Quadruple safety device
- Top-grade SGS IPX8 certification for waterproof protection



LINE UP



NECK STRAP

ARM BAND

COMPONENT

BLACK

WHITE

Optimized size for maximum mobile device size

# WATERPROOF BAG DX

The National Geographic Waterproof Bag DX, a tube-type that does not sink in water, protects your smartphone with a quadruple lock structure that completely blocks all directions without leaking water. It is optimized for the longest size of a mobile device, so even the longest mobile model can be used without any inconvenience.



FEATURE

- Compatible with Typical and Large size smartphone
- Floating TUBE TYPE
- Screen touch available (Photographs / Videos)
- Quadruple safety device
- Top-grade SGS IPX8 certification for waterproof protection



LINE UP



Waterproof

# MOBILE CROSS BAG

National Geographic Mobile Waterproof Crossbag is a tube-type product that does not sink in water, and it is a simple and safe quadruple lock structure that completely blocks water from penetrating and protects your smartphone. In addition, it is designed in a relaxed size to store not only large smartphones but also various belongings, and the strap that can be adjusted to the desired length according to the body type increases the completeness of the product with luxurious logo printing.



## FEATURE

- Floating TUBE TYPE
- Top-grade SGS IPX8 certification for waterproof protection
- Quadruple safety device
- Screen touch available (Photographs / Videos)
- Enough storage available
- Thin and powerful high-quality TPU material
- Straps that can be adjusted to the desired length



## LINE UP



BLACK

WHITE

YELLOW

Waterproof

# MOBILE SLIM CROSS BAG

National Geographic Mobile Waterproof Slim Crossbag is a practical product that can be worn in various ways, such as waist and shoulders, and can be stored in addition to smartphones. In addition, it is certified as SGS iPX8, the highest level of waterproof protection, so it can be waterproof up to 10m deep, and you can use your smartphone without worrying about it in the water.



FEATURE

- Easy and secure double Velcro lock
- Top-grade SGS IPX8 certification for waterproof protection
- Waterproof up to 10m deep
- Screen touch available (Photographs / Videos)
- Length-adjustable, detachable hard-type strap
- Thin and powerful high-quality TPU material



LINE UP



WHITE

BLACK



ELECTRIC ACCESSORY

Built-in capacity indicator

# QUICK PORTABLE CHARGER

National Geographic Quick Portable Charger is a Power Bank with a capacity of 10,000 mAh and a multi-port capable of fast charging up to 20 W. With its slim design, you can carry it with you in your daily life, camping, traveling, etc.



## QUICK PORTABLE CHARGER | 10,000mAh / PD 20W

It is a slim design auxiliary battery with a capacity of 10,000mAh and fast charging of up to 20W.

### FEATURE

- Slim design for easy to carry
- Charging speed up to 20W
- Multiple Multiports
- 3 units can be charged at the same time
- Indicate capacity remaining with LED indicators



Displaying battery capacity

### COMPONENT

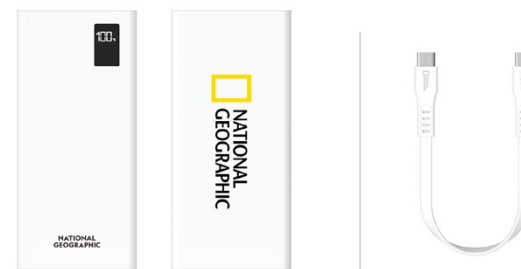

FRONT

BACK

CABLE(C-TYPE)

High Capacity Wireless Charging

# QUICK WIRELESS PORTABLE

National Geographic Quick Wireless Portable Charger is a slim design power bank with capacities of 10,000mAh and 20,000mAh, optimized for mobile devices that support various ports and wireless charging. Also, it can be used stably as an attachable suction pad.



## QUICK WIRELESS PORTABLE CHARGER | 10,000mAh / PD 22.5W

With a capacity of 10,000mAh and a slim design, it is an optimized secondary battery for mobile devices that support a wide range of ports and wireless charging.

### FEATURE

- Charging speed up to 22.5W
- Multi-port / Wireless charging available
- 4 units can be charged at the same time
- Display charging information with LED indicators



### COMPONENT



## QUICK WIRELESS PORTABLE CHARGER | 20,000mAh / PD 22.5W

With a high capacity of 20,000 mAh, the slim design is optimized for mobile devices that support a wide range of ports and wireless charging.

### FEATURE

- 20,000 mAh High Capacity
- Charging speed up to 22.5W
- Multi-port / Wireless charging available
- 4 units can be charged at the same time
- Display charging information with LED indicators



### COMPONENT



Seeking user convenience

# USB CABLE

National Geographic USB cable considered user convenience.



## BASIC CABLE DATA&CHARGING CABLE

The National Geographic Basic Cable, which consists of three types of five-pin, eight-pin, and C-type, is a stable 1.2-meter-long cable. It is the most basic cable.

### FEATURE

- Stable length of 1.2m
- Includes dedicated pouch

### LINE UP



## 90 DEGREE CABLE DATA&CHARGING CABLE

The National Geographic 90 degree cable has no restrictions on the direction of the 90 Degree shaped two-sided connector and can be selected from 50cm, 1m, or 2m. You can choose according to your convenience.

### FEATURE

- Fast Charging & Data Sync
- 90 Degree shape
- Includes dedicated pouch
- Fixed Velcro holder

### LINE UP



Bluetooth

# TRIPOD SELFIE STICK

The National Geographic Bluetooth tripod selfie stick is a selfie stick that can be used as a tripod because the handle part is designed in a folding structure. The ultra-slim design makes it easy to carry around, and the detachable Bluetooth remote control enables various filming.



## FEATURE

- Super slim size
- Can take selfies or tripods
- Detachable Bluetooth Remote Control
- 6 step length expansion
- Compatible with smartphones of various sizes



Detachable Bluetooth remote controller



SELFIE MODE



TRIPOD MODE

## LINE UP

Minimum length	187 mm
Maximum Length (Selfie Bar)	680 mm
Weight	132g
material	ABS, stainless steel
Bluetooth version	4.0
Maximum Operating Distance	About 10 meters

Product specifications are subject to change without notice to improve quality.



PARAMETERS



BLACK

Studio in my hand.

# BLUETOOTH SHUTTER

The National Geographic mobile Bluetooth shutter is an excellent grip ergonomic design, allowing you to use the shutter button with one hand to shoot a great moment, and with a detachable Bluetooth remote control, it's easy to shoot from afar.



## MOBILE BLUETOOTH SHUTTER

It has excellent grip, allowing you to use shutter buttons with one hand, and it is a convenient product that can be filmed from afar with a detachable Bluetooth remote control.

### FEATURE

- Bluetooth wireless button
- Convenient Grip for Photography
- Renewable Lithium Battery (CR2016)
- Compatible with Various size smartphone (62 to 83 mm)



Bluetooth Wireless button



BLACK

### LINE UP

## MOBILE BLUETOOTH SHUTTER + TRIPOD SET

It has excellent grip, allowing you to use shutter buttons with one hand, and it is a convenient product that can be filmed from afar with a detachable Bluetooth remote control.

You can use it in various ways depending on the situation by using a selfie stick and a tripod

### FEATURE

- Bluetooth wireless button
- Convenient Grip for Photography
- Include 2 Way Mini Tripod (Selfie /Tripod)
- Renewable Lithium Battery (CR2016)
- Compatible with Various size smartphone (62 to 83 mm)



BLACK

### LINE UP

Fast, reliable charging support

# DUAL QUICK CAR CHARGER

Optimized for automotive products, the two ports provide fast and reliable charging, while charging smart devices at the same time safely and quickly without losing power. Enhancement of product luxury is achieved by laser imprinting the logo on the aluminium housing.



# DUAL QUICK CAR CHARGER

When charging two smart devices at the same time, you can charge them safely and quickly without losing power.

## FEATURE

- Dual USB port allows simultaneous charging of 2 smart devices
- Compatible with any vehicle with inputs of 12 to 24V
- Easy to carry in compact size
- All devices compatible (including Type-C USB)
- High durability of aluminium materials



### DUAL QUICK CAR CHARGER

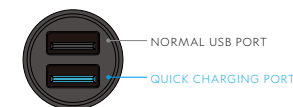

<b>INPUT</b>	DC 12-24V
<b>OUTPUT(STANDARD)</b>	5V=2.4A
<b>OUTPUT(QC 3.0)</b>	5V=2.4A, 9V=2A, 9V-12V=1.5A

### DUAL QUICK & PD CAR CHARGER

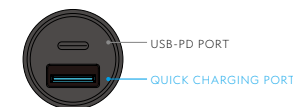

<b>INPUT</b>	DC 12-24V
<b>OUTPUT(STANDARD)</b>	5V=2.4A, 9V=2A, 9V-12V=1.5A
<b>OUTPUT(QC 3.0)</b>	5V=3A, 9V=2A, 12V=1.5A

## LINE UP



CABLE(C-TYPE) HOLDER

COMPONENT



DUAL QUICK CAR CHARGER

DUAL QUICK & PD CAR CHARGER

Two-way charging is possible with dual coils

# FAST WIRELESS CHARGER

National Geographic Fast Wireless Desk Mobile Charger is equipped with dual coils to allow wireless charging of devices in any direction. It is also equipped with an anti-slip safety pad for convenient and reliable use.



## FAST WIRELESS DESK MOBILE CHARGER

It can be easily installed and used in various places.

### FEATURE

- USB-PD compatible & QC 3.0 charger compatible
- Type-c cable included
- Dual coil installation for two-way charging
- Status can be checked in the LED display window (Recharge standby: Blue/Rechargeable: Green)
- Non-slip safety pad attached

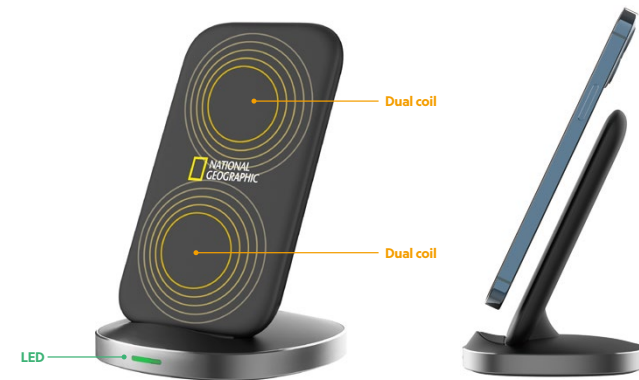

### COMPONENTS



WIRELESS CHARGING PAD



CABLE (C-TYPE)



MANUAL



Fast and accurate one-second grip

# FAST WIRELESS CAR CHARGER V2

National Geographic Fast Wireless Car Charger V2 is designed to be quiet and can be used automatically. It includes dashboard / air vent mount which can be used in any type of vehicles. Built-in the FOD recognition sensor, which detects only smartphones, prevents unintended opening and closing of the stand and supports safer automatic stand.



qi qi INTERNATIONAL WIRELESS CHARGING SPECIFICATION  
**CERTIFIED PRODUCT**

# FAST WIRELESS CAR CHARGER V2

When you put your smartphone on the stand, it is held automatically, and when you press the button on the side, you can easily take out your smartphone.

## FEATURE

- Easy, fast, simple stand.
- FOD recognition sensor
- Fast charging (maximum 15W)
- Noise minimization
- Free angle adjustment
- Include 2 types of install mount (dash board & air vent)



Anti-slip silicone.

Depending on the size of your smartphone, you can adjust the height by 4 steps (about 12mm).

Dashboard holder. Adjust the angle up to 180 degrees.

## COMPONENTS



SCREW CAP

CABLE (TYPE C)



DASH BOARD MOUNT



AIR VENT MOUNT



MANUAL



WIRELESS CHARGING PAD

Smart charging.

# FAST WIRELESS CAR CHARGER

National Geographic Fast Wireless Car Charger prevents unintentional opening and closing of the holder using the FOD response sensor and can be adjusted to the optimum angle for ease of use. The subtle lighting of the National Geographic logo also makes it easy to locate charging pads in the dark, and is good for interior.



# FAST WIRELESS CAR CHARGER

If you put your smartphone on the cradle, it will be automatically held, and you can easily take out your smartphone by pressing the side button.

## FEATURE

- Easy and fast easy-to-use arrangement
- FOD response sensors that only respond to digital signals
- Standby power for 3 minutes
- High speed charging possible (up to 15W)
- Free angle adjustment
- 2 in 1 Multi Cradle



## COMPONENTS

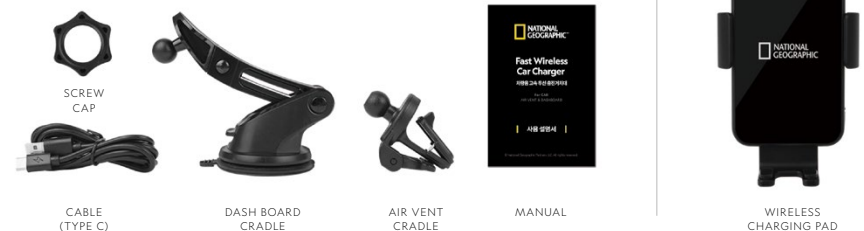

Fast Wireless

# WIDE HOLD CAR CHARGER

National Geographic Wide Hold Car Charger supports foldable phones and dual phones, which can be adjusted to the optimum angle that users want, making it easy to use.



It depends on the power remaining on the device and the vehicle, and can open and close 5 to 10 times on average.

STANDBY POWER FOR **3 MINUTES**

# WIDE HOLD FAST WIRELESS CAR CHARGER

If you put your smartphone on the cradle, it will be automatically held, and you can easily take out your smartphone by pressing the bottom button.

## FEATURE

- Compatible with Foldable phone / Dual phone (width 134mm - 177mm max)
- Fast and easy to use arrangement
- Standby power for 3 minutes.
- Fast Charging (Max. 15W)
- Free angle adjustment
- Sophisticated design
- Logo Lighting
- 2 in 1 Multi Cradle



## COMPONENTS



Dual coil

# FAST WIRELESS CAR CHARGER

National Geographic Dual Coil Fast Wireless Car Charger is compatible with most smartphones, including flip and foldable types, by increasing the range of charge voltage detection with two dual coils and supports faster and more efficient wireless charging of up to 15W.



# DUAL COIL FAST WIRELESS CAR CHARGER

You can open and close the cradle using both side opening and closing buttons, and the touch-type buttons provide excellent operation.

## FEATURE

- Plate up-and-down adjustable compatible with a variety of smartphone models
- Minimize noise during operation by applying 'stepper motor'
- 2-in-1 Multi-Cradle (Dashboard/Air Vent)
- Dual-coil ultra-fast 15W wireless charging available
- Vacuum adsorption allows for strong fixation
- Free angle adjustment
- FOD recognition sensor
- Standby power for 3 minutes



## COMPONENTS



Dual coil Fast Wireless

# WIDE HOLD CAR CHARGER

National Geographic Dual Coil Wide Hold Fast Wireless Car Charger is compatible with foldable device & small tablets, by increasing the range of charge voltage detection with two dual coils and supports faster and more efficient wireless charging of up to 15W.



It depends on the power remaining on the device and the vehicle, and can open and close 5 to 10 times on average. **STANDBY POWER FOR 3 MINUTES**

# DUAL COIL WIDE HOLD FAST WIRELESS CAR CHARGER

Dual-coil applications with a wide range of charge voltage detection and a wide design make it fully compatible with foldable devices and tablets.

## FEATURE

- Compatible with foldable devices and tablets (wireless rechargeable model/maximum width 174mm)
- Minimize noise during operation by applying 'stepper motor'
- 2-in-1 Multi-Cradle (Dashboard/Air Vent)
- Dual-coil ultra-fast 15W wireless charging available
- Free angle adjustment
- FOD recognition sensor
- Standby power for 3 minutes



## COMPONENTS



DASH BOARD CRADLE

AIR VENT CRADLE

CABLE (TYPE C)

WIRELESS CHARGING PAD

PC ACCESSORY

Bluetooth & 2.4GHz Wireless Multi-Device

# SLIM KEYBOARD

National Geographic Bluetooth Slim Keyboard is equipped with both Bluetooth and USB type receiver wireless connectivity functions, so it can be freely linked according to the device situation and user's convenience. It is also easy to carry around with its slim, compact size and light weight, relieves the burden on the wrist even when used for a long time, and helps create a luxurious desk setup.



FEATURE

- Slim and minimal design (lowest thickness 4.8 mm)
- Silent Keystroke with scissor mechanism
- 2-way connection support (Bluetooth and 2.4GHz wireless)
- Connect up to 3 devices simultaneously (2 Bluetooth + 1 wireless)
- Compatible with Windows, macOS, Android, iOS and more
- Easy and reliable 2.4GHz wireless connection
- Built-in battery for easy charging (70 hours after fully charging)
- Conformity assessment completed (Electromagnetic compatibility certification, electrical safety certification evaluation)

KEYBOARD SPECIFICATION

Support Systems	Windows, macOS, Android, iOS		
Size/weight	298 × 131 × 20.7 (mm) / 441g		
connection method	Bluetooth (V5.2), 2.4GHz Wireless Receiver (Dongle)		
Maximum distance used	10m	Number of keys	78
Battery type	Lithium battery 180mAh	Charging time	2h
Time of use after charging	70h	Sleep mode	3 minutes
Standby current	<0.8mA	Operating voltage	3.7V

**Wireless/Bluetooth Function Key**  
(Connection/switching of equipment)

**Connect up to 3 devices simultaneously**

- Two Bluetooth modes + one wireless mode
- Windows, macOS, Android, iOS etc
- Compatible with a wide variety of environments

**2.4-GHz wireless receiver**

- Confused by the application of 2.4 GHz frequency Reliable use without worry
- Can be stored by attaching it to the back of the keyboard

**Built-in battery**

- Charging time: 2h / Use time after buffering: 70h
- Automatic sleep mode: 30 minutes

\* The life of the battery depends on the time of use and it may vary depending on your computer's environment.

LINE UP

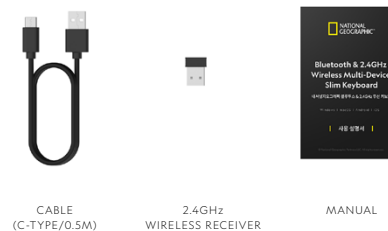

COMPONENT



WHITE



BLACK

Bluetooth & 2.4GHz Wireless

# SLIM MOUSE

National Geographic Bluetooth Slim Mouse has a modern and slim design of matte material to help create a luxurious desk setup and a solid and convenient design to provide a more pleasant working environment. In addition, both Bluetooth and USB-type receivers are equipped with wireless connection functions, so they can be freely linked depending on the device situation and user convenience.



FEATURE

- Slim and minimal design (lowest thickness 5.2 mm)
- Low noise button design
- 2-way connection support (Bluetooth and 2.4GHz Wireless)
- Connect up to 2 devices (1 Bluetooth mode + 1 wireless mode)
- Easy and reliable 2.4GHz wireless connection
- Efficient battery control (up to 100 hours)
- Conformity assessment completed (Electromagnetic compatibility certification, electrical safety certification evaluation)

MOUSE SPECIFICATION

Support Systems	Bluetooth - Windows 8 or later, macOS, etc. 2.4GHz Wireless Receiver - Windows, macOS, etc		
Size/weight	59 x 111 x 30 (mm) / 56g		
connection method	Bluetooth(V5.2), 2.4GHz Wireless Receiver(Dongle)		
Sensor resolution	1,200dpi		
Maximum distance used	10m	Sleep mode	10 minutes
Battery type	AAx1	Operating voltage	1.5V
Maximum usage time	100h (Based on 1500mah battery)		

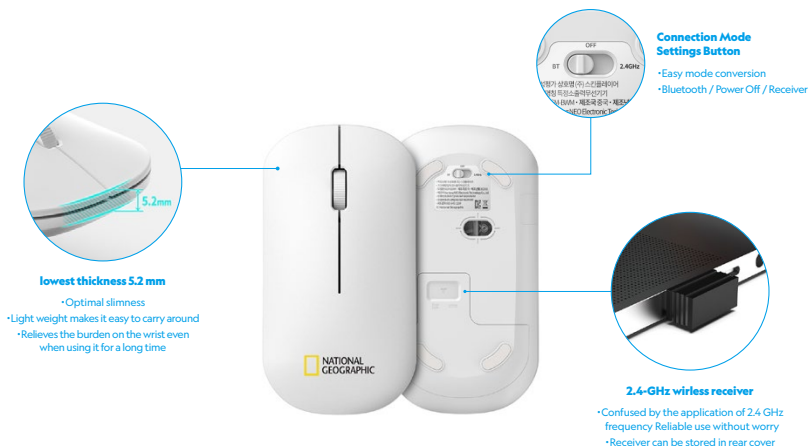

LINE UP

\* Includes Tea of AA batteries





Bluetooth & 2.4GHz Wireless Multi-Device Slim

# KEYBOARD & MOUSE SET

National Geographic Bluetooth & 2.4GHz Wireless Keyboard & Mouse Set combines a convenient interface wireless keyboard with ultra-light, quiet wireless mouse to help create a luxurious desk setup with a modern and slim matte design, and a more comfortable working experience with a sturdy and convenient design.



## FEATURE

- Slim and minimal design
- Silent Keystroke with scissor mechanism
- 2-way connection support (both Bluetooth and 2.4GHz wireless)
- Multiple devices can be connected
- Easy and reliable 2.4GHz wireless connection
- Compatible with Windows, macOS, Android, iOS and more
- Conformity assessment completed (Electromagnetic compatibility certification, electrical safety certification evaluation)

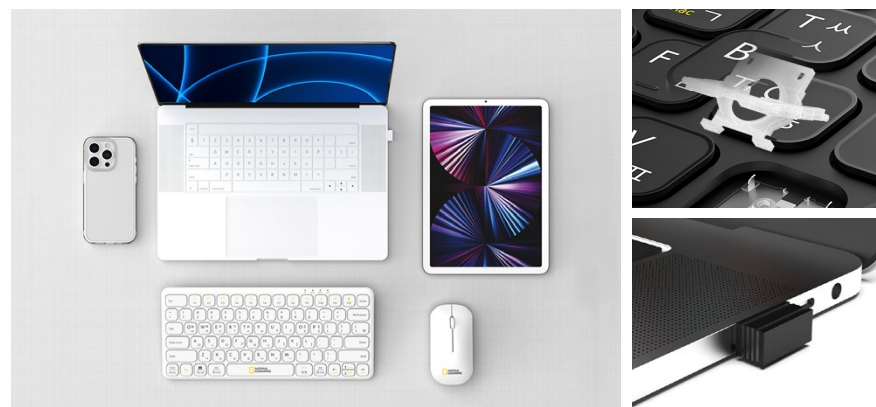

## LINE UP

\* Includes Tea of AA batteries



CABLE  
(C-TYPE/0.5M)



2.4 GHz  
WIRELESS RECEIVER



MANUAL

COMPONENT



WHITE (Wireless Keyboard & Mouse)



BLACK (Wireless Keyboard & Mouse)

# Thank you

[www.ringke.co.in](http://www.ringke.co.in)

MOBILE & CONSUMER ELECTRONICS ACCESSORY



## YOUR PURCHASE HAS PURPOSE

EVERY PURCHASE HELPS SUPPORT THE GLOBAL NONPROFIT  
NATIONAL GEOGRAPHIC SOCIETY IN ITS WORK TO  
PROTECT AND ILLUMINATE OUR WORLD THROUGH  
EXPLORATION, RESEARCH, AND EDUCATION.

---

**Exakteit Technologies**

Contact Us : [help@ringke.co.in](mailto:help@ringke.co.in) / +91-8825562742

Address: Ground Floor, SF No.119,2 Main Road, Door No-38,  
Vadaperumbakkam, Chennai, Tamil Nadu - 600060.