

USER MANUAL

Cheerble Ball

EN

IN THE BOX

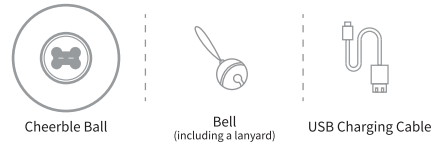

How to Install a bell(optional)

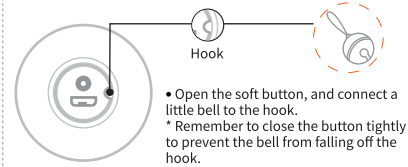

QUICK START GUIDE

1. Turn on and select an interactive mode.

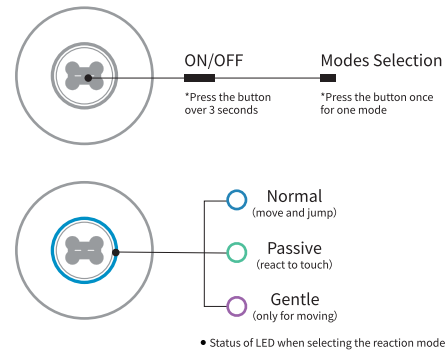

QUICK START GUIDE

2. Two ways to activate your Cheerble Ball after selecting the interactive mode.

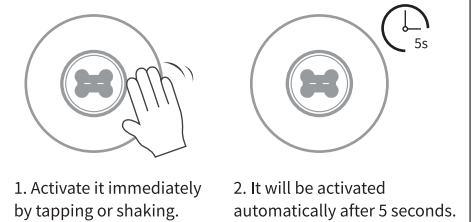

- ⚠ Before having fun with your cat, please check that your Cheerble Ball's surface is in good condition.
- ⚠ Supervision is required during the playtime to prevent your pet from swallowing.

STATUS OF LED INDICATOR

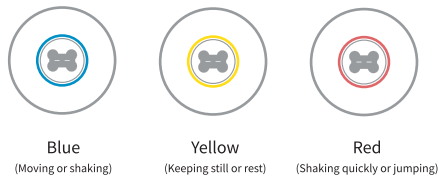

Tips Cheerble Ball will play with your cat for 10 minutes, then it will rest for 30 minutes. However, during the rest time, it can be re-activated by your cat's touch and play with your cat for another 10 minutes.

HOW TO CHARGE

1. Low battery

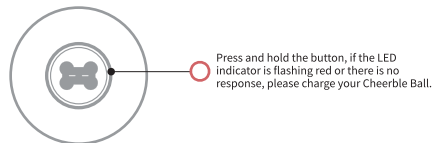

2. Opening the soft button to charge

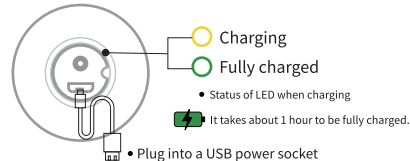

SPECIFICATIONS

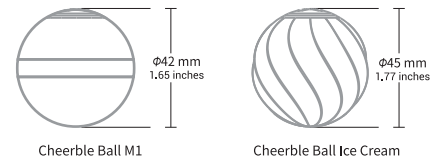

Model: C0419 / C0419-C
 Weight: 40 g / 45 g
 Dimensions: $\phi 42$ mm / $\phi 45$ mm
 Battery: Li-Polymer 3.7v 135mAh
 Operating Temperature: 0 ~ 40 °C / 32°F ~ 104°F

Warranty

Cheerble offers one-year warranty for Cheerble Ball against any quality-related defects. Warranty starts from the date you receive your item. Warranty claims for product defects expire 90 days after opening a warranty claim.

- Warranty are voided for/if:**
- wrong item/component returned to us
 - damage arising from improper use or maintenance (including, but not limited to: falls, extreme temperatures, operating devices improperly)
 - damage arising from accident or external causes
 - damage arising from abnormal wear and tear
 - damage arising from unauthorized repair, modification or customization
 - item used by other pets rather than the designated pets stated in product description (e.g. Cheerble Ball used by a dog)
 - normal wear down of the outershell, battery of Cheerble Ball

- Warranty are also voided for/if:**
- lost or stolen items
 - items that have expired their warranty period
 - free products
 - products that have been fully refunded
 - any consumable items / parts supplied with the warranty item
 - any accessories not being part or component of the warranty item
 - proof of purchase is not provided by buyer
 - items purchased from an unauthorized seller

More warranty details can be found at: www.cheerble.com