

8171/201 8171/202 8171/203 8171/204

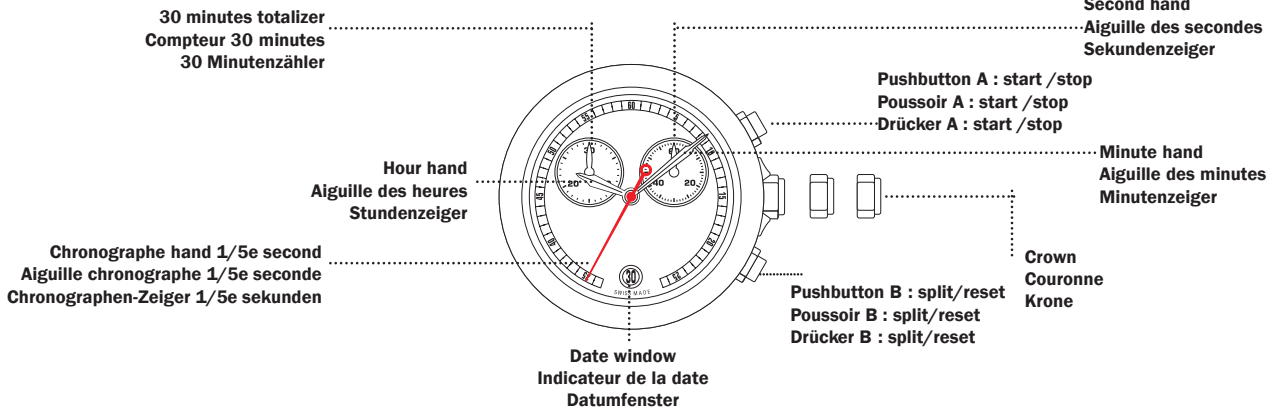

PRESENTATION – PRÉSENTATION – ANSICHT

8171/201



REGLAGES - SETTINGS - EINSTELLUNG

**SETTING THE TIME
HOUR AND MINUTE**

**REGLAGE DE
L'HEURE ET MINUTE**

**EINSTELLEN DER
ZEITANZEIGE STUNDEN
UND MINUTEN**

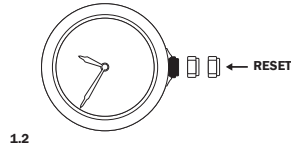
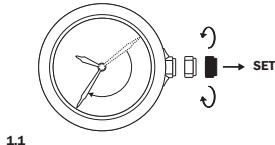

**SETTING THE DATE
CAUTION: NEVER CORRECT DATE
BETWEEN 9 PM AND 0.30 AM.**

**CORRECTION DE LA DATE
ATTENTION: LA CORRECTION
DE LA DATE NE PEUT PAS SE
FAIRE ENTRE 21H00 ET 0H30.**

**EINSTELLEN DES DATUMS
ACHTUNG: DATUM NICHT
ZWISCHEN 21 UHR UND 0
UHR 30 EINSTELLEN.**

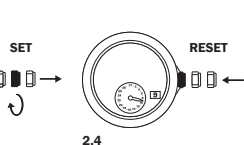
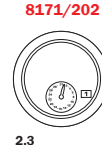
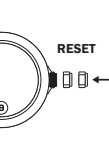
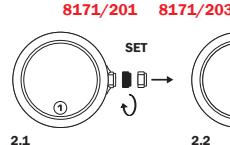

8171/204

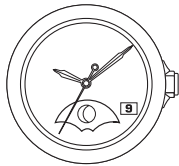

TO CORRECT THE MOONPHASE
SET THE DATE ACCORDING TO THE LAST FULL MOON.
AFTERWARDS ADAPT LIKE STEPS 2.1 AND 2.2

CORRECTION DE LA PHASE DE LUNE
RÉGLER LA DATE D'APRÈS LA DERNIÈRE PLEINE
LUNE. ENSUITE, ADAPTER COMME ÉTAPE S 2.1 ET 2.2

KORREKTUR DER MONDPHASE
EINSTELLUNG DES DATUMS VOM LETZTEM VOLLMOND.
DANACH, ANPASSEN WIE PUNKT 2.1 UND 2.2

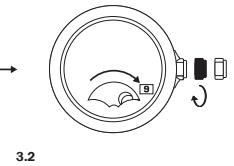
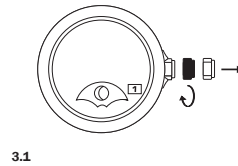

FUNCTIONS -- FONCTIONS -- FUNKTIONEN

MEASURING CUMULATIVE TIMES

MESURE DE TEMPS CUMULÉS

MESSUNG DER KUMULIERTEN ZEIT

AFTER 2 HOURS OF CONTINUOUS RUNNING, THE CHRONO STOPS AND RESETS AUTOMATICALLY TO SAVE THE BATTERY

APRÈS 2 HEURES DE MARCHÉ, LE CHRONO S'ARRÊTE ET SE REMET À ZÉRO AUTOMATIQUÉMENT AFIN D'ÉCONOMISER LA PILE.

NACH 2 LAUFSTUNDEN STOPPT DER CHRONO UND GEHT AUTOMATISCH AUF DIE NULLSTELLUNG ZURÜCK, UM DIE BATTERIESTROM ZU SPAREN.

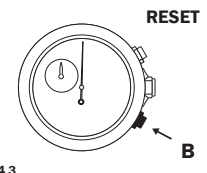
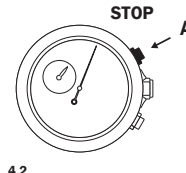
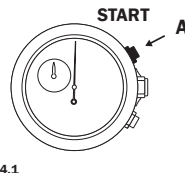

MEASURING SPLIT TIMES

MESURE DE TEMPS INTERMÉDIAIRES

MESSUNG VON ZWISCHENZEITEN

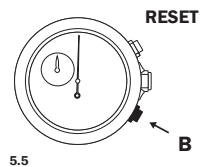
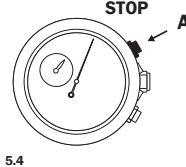
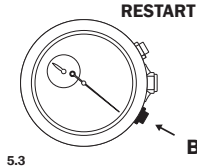
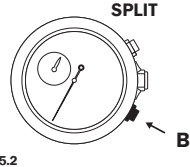
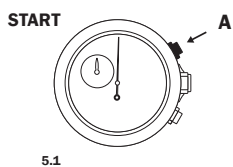

CALIBRATION -- INITIALISATION
EICHEN

**AFTER BATTERY EXCHANGE
OR MISHANDLING ONLY**

**SEULEMENT APRÈS CHANGEMENT DE
LA PILE OU MAUVAISE MANIPULATION**

**NUR NACH BATTERIEWECHSEL
ODER UNKORREKTER HANDHABUNG**

TO RESET CHRONOGRAPH,
MINUTE AND SECOND CHRONOGRAPH

INITIALISATION CHRONOGRAPHE,
MINUTE ET SECONDE CHRONOGRAPHE

INITIALISIEREN DES CHRONOGRAPH,
MINUTEN UND SEKUNDEN, CHRONOGRAPH

