

# VD75 Japanese Quartz Movement User Manual

Time display: Hour and minute hands with small-second hand  
 Calendar display: Date and day of the week hands

## DISPLAY AND CROWN/BUTTONS

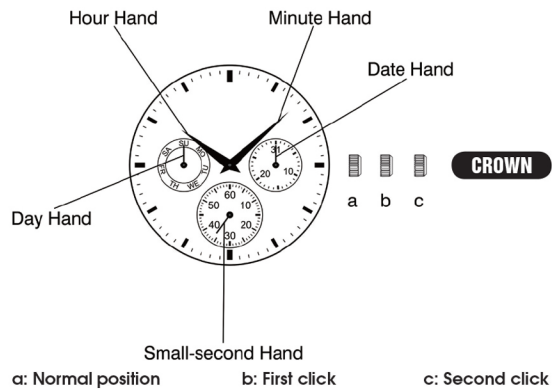

## TIME/CALENDAR SETTING

### DAY AND TIME SETTING

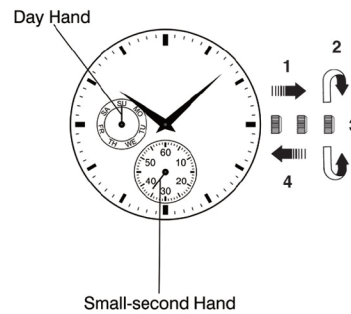

#### CROWN

- 1 Pull out to second click when small-second hand is at the 12 o'clock position.
- 2 Turn clockwise to advance Hour and Minute hands until Day hand is set to the desired day of the week.
- 3 Turn to set the time.
- 4 Push back completely in accordance with a time signal.

### DATE SETTING

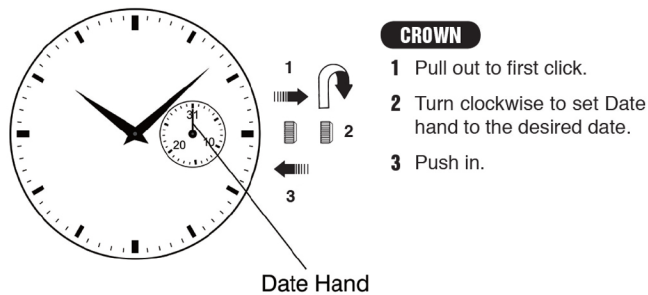

#### CROWN

- 1 Pull out to first click.
- 2 Turn clockwise to set Date hand to the desired date.
- 3 Push in.

### DAY AND TIME SETTING

- To advance the day hand quickly, turn back the hour and minute hands 4 to 5 hours beyond the point the day normally changes, and then advance them again until the day hand is set to the next.
- \* The day hand will not move back by turning the crown counterclockwise.
- When adjusting the day hand, turn the crown slowly.
- When setting the time, check that AM/PM is set correctly.
- When setting the minute hand, advance it 4 to 5 minute ahead of the desired time and then turn it back to the exact minute.
- The 24-hour hand (or 24-hour rotating wheel) turns full circle in one day.

### DATE SETTING

- Do not set the date between 10:00 p.m. and 2:00 a.m. Otherwise, it may not turn properly.
- While setting the date hand, check that it moves properly in one-day increments.
- It is necessary to adjust the date on the first day after a 30-day month and February.