

# AB12050

## 12V-5Ah (20hr)

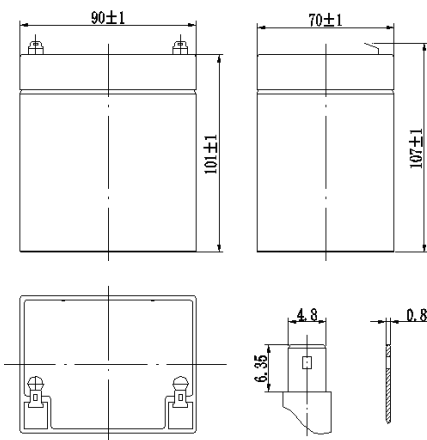

### 5A/H SERIES

5A/H SERIES High rate model batteries are specially designed for applications where need high power output. By optimum design or battery grids and plate paste formula, the High rate model batteries can deliver up to more power than normal series batteries.

### Application

- Alarm System
- Cable Television
- Power tools
- Emergency Power System
- Security System
- Medical Equipment
- UPS
- Power tools
- Control Equipment
- Toys

### General Features

- Sealed and maintenance free operation.
- Non-Spillable construction design.
- ABS containers and covers (UL94HB, UL94V-0) optional.
- Safety valve installation for explosion proof.
- High quality and high reliability.
- Exceptional deep discharge recovery performance.
- Low self discharge characteristic.
- Flexibility design for multiple install positions.

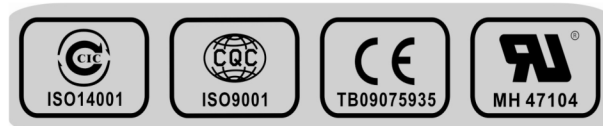

### CONSTRUCTION

Component	Positive plate	Negative plate	Container	Cover	Safety valve	Terminal	Separator	Electrolyte
Raw material	Lead dioxide	Lead	ABS	ABS	Rubber	Copper	Fiberglass	Sulfuric acid

### TECHNOLOGY PARAMETER

Battery model	AB12050			
Designed Floating Life	3~5 Years			
Capacity (25°C)	10min wattage@1.6V	20hR(0.25A, 10.5V)	10hR(0.497A, 10.5V)	1hR(3.62A, 9.60V)
	30W/cell	5.0Ah	4.97Ah	3.62Ah
Dimensions	Length	Width	Height	Total Height
	90±1mm	70±1mm	101±1mm	107±1mm
Approx. weight (±5%)	1.80Kg (3.97 lbs)			
Internal resistance	Full charged at 25°C: Approx. 34mOhms			
Self discharge	3% of capacity declined per month at 25°C (average)			
Capacity Affected by Temp.(20HR)	40 °C	25 °C	0 °C	-15 °C
	102%	100%	85%	65%
Charge Voltage (25°C)	Cycle use		Float use	
	14.5-14.9V(-30mV/°C), max. Current: 1.5A		13.6-13.8V(-20mV/°C)	

## AB12050 12V-5Ah (20hr)

Constant current discharge ratings-amperes at 25°C

End Point Volts/Cell	5min	10min	15min	30min	1h	3h	5h	10h	20h
1.60V	22.4	15.7	11.2	6.28	3.62	1.52	0.99	0.523	0.272
1.65V	21.3	15.0	10.6	6.03	3.55	1.47	0.96	0.514	0.267
1.70V	20.1	14.2	10.1	5.77	3.46	1.42	0.94	0.504	0.261
1.75V	18.8	13.3	9.53	5.48	3.31	1.36	0.91	0.497	0.250
1.80V	17.5	12.6	8.98	5.21	3.15	1.30	0.88	0.487	0.246

Constant power discharge ratings-watts at 25°C

End Point Volts/Cell	5min	10min	15min	30min	1h	3h	5h	10h	20h
1.60V	42.6	30.0	21.4	12.1	7.02	2.96	1.94	1.03	0.54
1.65V	40.3	28.5	20.3	11.6	6.85	2.85	1.88	1.01	0.53
1.70V	37.7	26.8	19.1	11.0	6.64	2.74	1.81	0.98	0.51
1.75V	35.1	25.0	18.0	10.4	6.33	2.60	1.75	0.96	0.49
1.80V	32.4	23.5	16.8	9.79	5.96	2.46	1.68	0.94	0.47

(NOTE) The above characteristics data are average values obtained within three charge/discharge cycles not the minimum values.

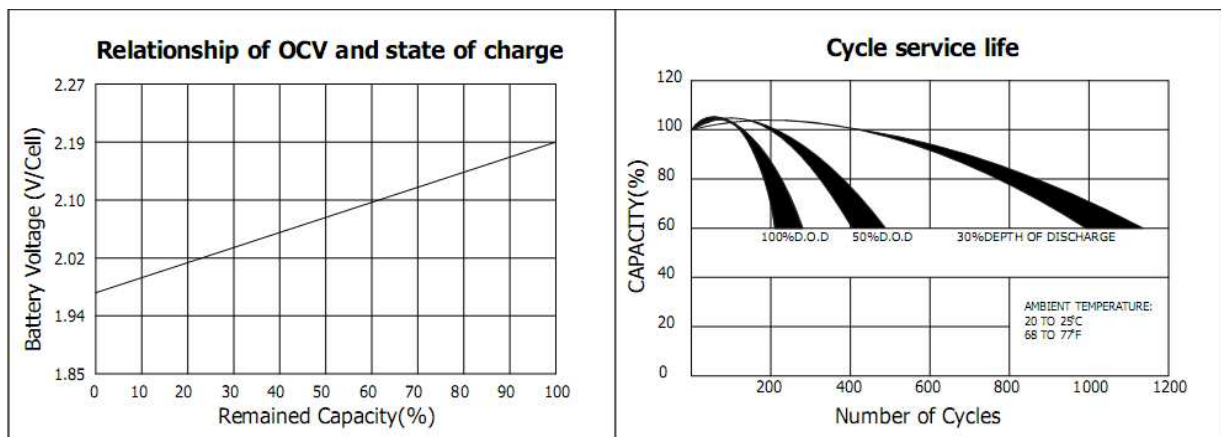
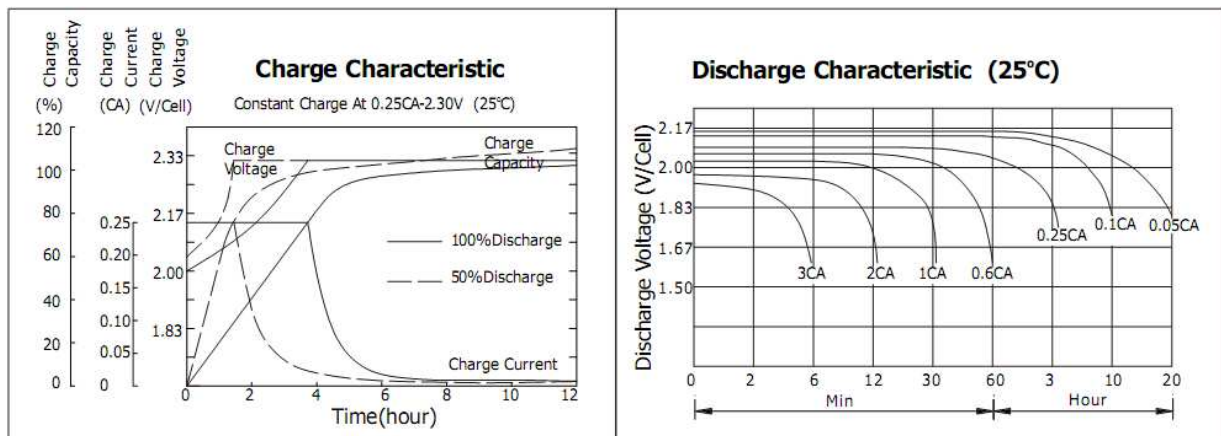

\*Product specifications are subject to change without further notice

\*Image is for illustration purposes only