

# SwingSnap Banner Stretch™ pre-installation instructions and overview Installation for Building sides and Trucks

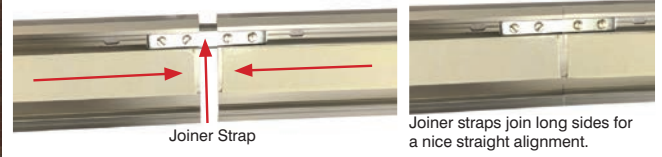

Only our frame offers perfect linear alignment with our included "Joiner Straps." Longer sections join easily and perfectly for the best results!



**Beautiful Banner Display, Wrinkle free, Drum Tight, Won't blow out in any winds, perfect for Semi Trailer use.**

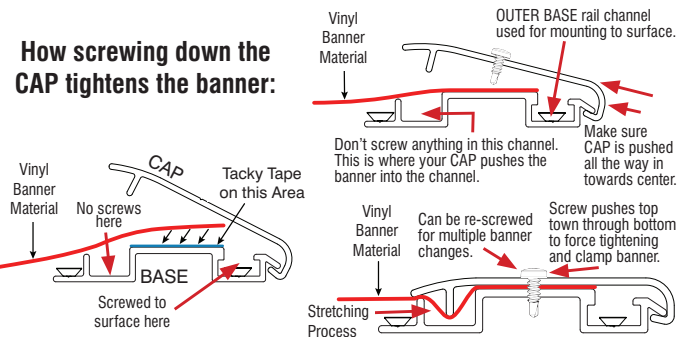

The tacky tape is used for positioning only. Once CAP is screwed down, the CAP and screw tightly compress down to hold vinyl banner in place within the frame.

## Before you begin installing your banner frame, please check the following:

- 1. Your banner must be sized 1.50 inches less than the OD of your frame. The trim size of your banner will match the 1 inch wide tacky area in your frame.**

After the banner is stretched, some of your banner all around will be covered by the screwed down CAP. When banner is printed, graphics and images should be a minimum 2.75" inches away from all 4 edges of the cut banner material. This will leave about a .75~1 inch dead space between the inside edge of the screwed down CAP and where your graphics begin – "live area." For example, if you order a 48" x 96" OD frame, your raw cut edge banner must be 46.50" x 94.50". Your live or viewable area for this example will be approximately 41" x 89". To order by "Live Area" add 5.50 inches to your desired live area length and width to obtain raw cut dimensions of banner needed. Add an additional 1.50 inches to length and width to obtain the OD of banner frame needed. So, if you want a live area of 48" x 96", cut size of banner will be 53.50" x 101.50" and OD of frame will be 55" x 103".

- 2. Your banner material should ideally be 18 oz. banner for the best results. Solid vinyl scrim, not mesh material.**
- 3. Your banner must ONLY have raw cut edges, no hems, fold overs, no grommets.**

**Max suggested frame sizes: This frame is best for banner sizes that are not more than 96" wide of high on one of the sides x any length It is great for any semi trailer sides. This frame can be used for much larger sizes, but you may not get a perfect, wrinkle free stretch, although the banner will still look great.**

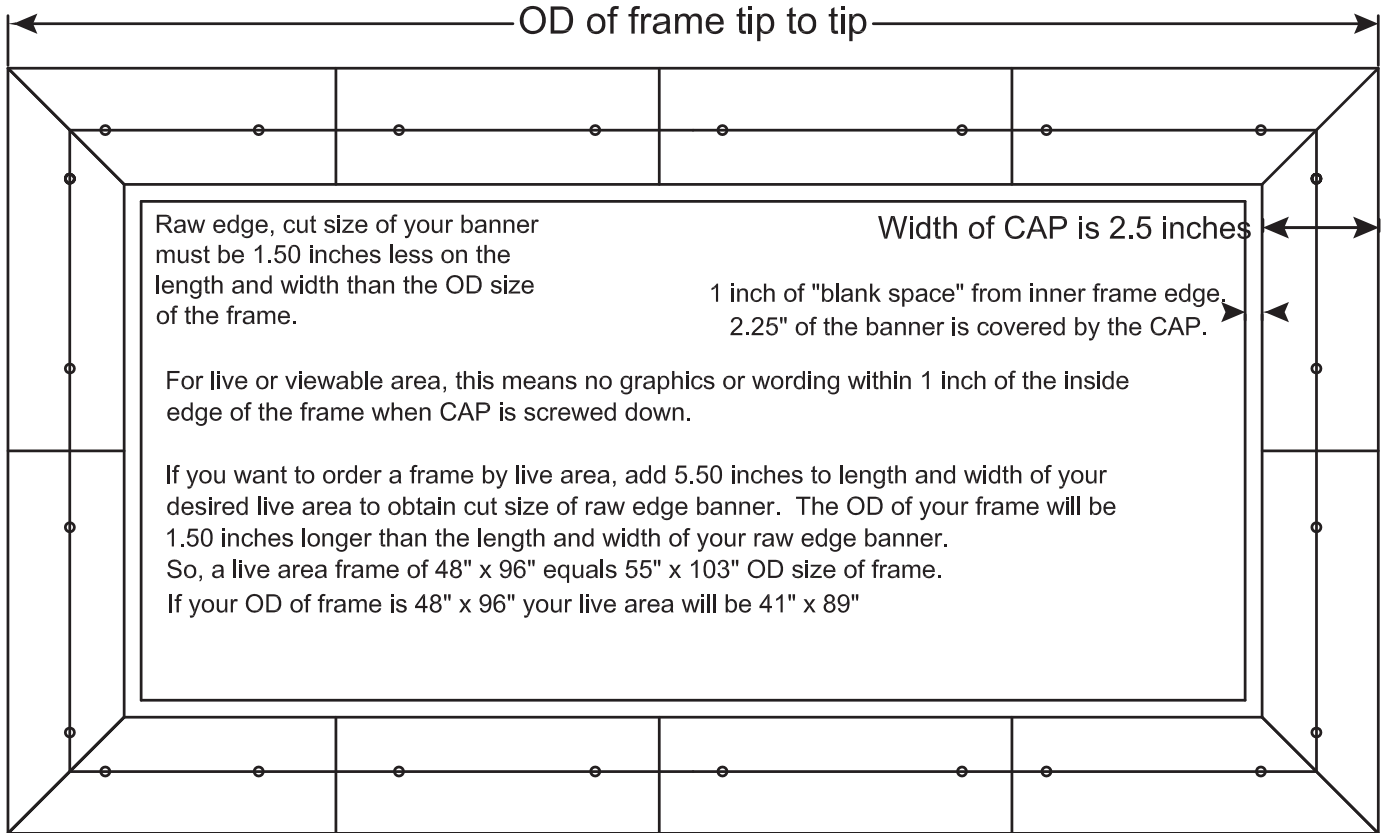

**How screwing down the CAP tightens the banner:**

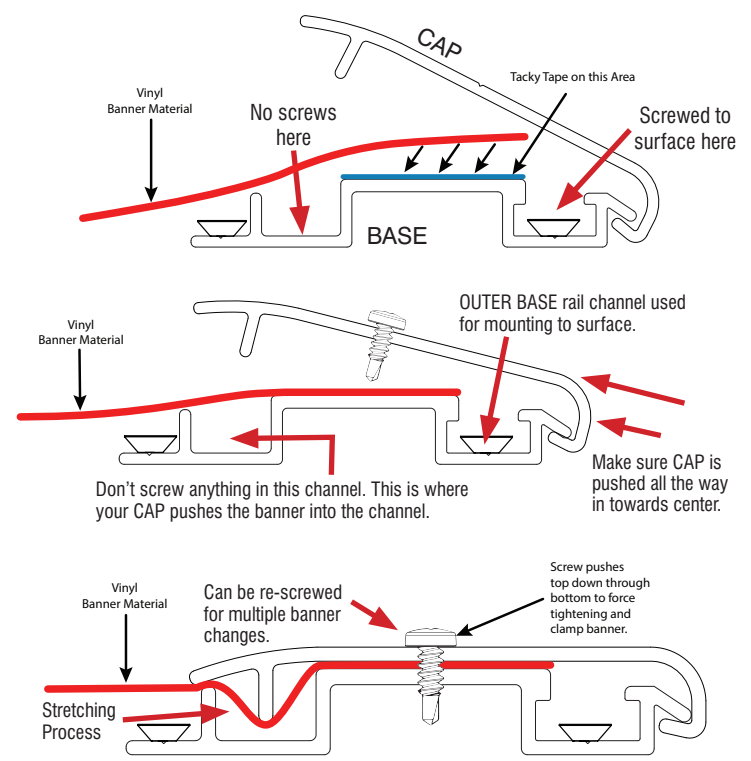
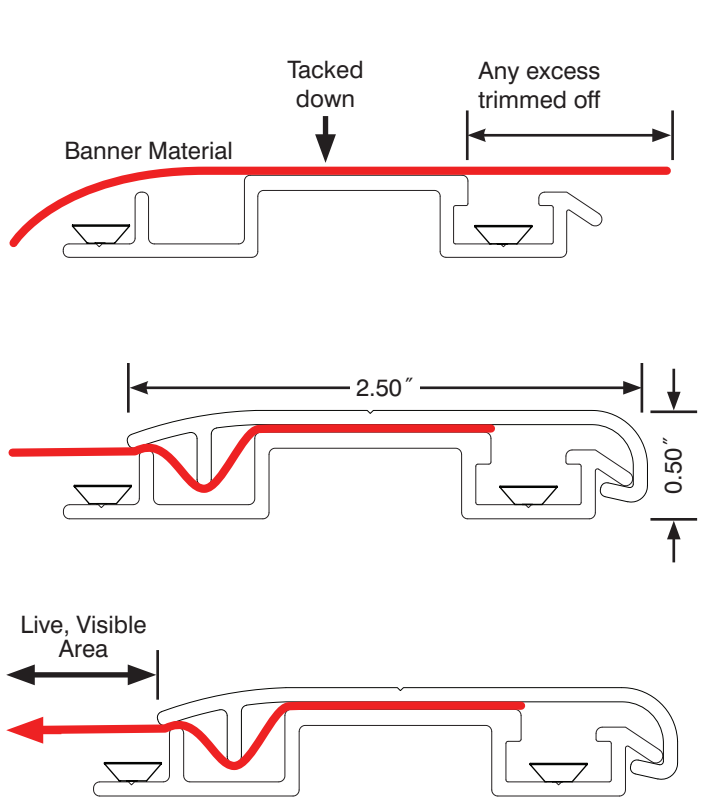

The tacky tape is used for positioning only. Once CAP is screwed down, the CAP and screw tightly compress down to hold vinyl banner in place within the frame.

# Installation for walls or truck trailer sides

Depending on whether you're installing on masonry wall, drywall, or truck trailer side, you will be provided all these parts and tools, except for the cordless drills. Installation shown below is for masonry wall installation using Tapcon screws, or screwing to truck trailer sides. For drywall (not shown) you will be provided anchors and screws.



CAP rails (tops)

BASE rails with tacky tape applied (bottoms)

Tacky tape is super sticky but is removable. It can be used over and over. Ideally, temperatures 45 to 90 degrees F. If the exposed tacky tape gets rained on/wet during your installation, after the rain stops, let it dry out and it will be super sticky again. Once your banner material is tacked down, the tacky tape will hold in the wet condition until you screw CAPs on. You can get additional rolls of tacky tape, part no. BSFM27X

**BSFM27X tacky tape is pre-applied on your frames**



Flat Head Screwdriver

Tapped Slotted Corner Hardware

joiner straps

backplates

Cordless drill that has hammer drill setting for drilling into masonry.

1/4 size magnetic tipped screw holder for #8 x 1/2 410SS 1/4 hex head self drilling screws

The magnetic tipped screw holder holds the screws before you start drilling. This is especially handy when you're up in the air installing the banner.

## INSTALLATION GUIDELINES FOR SHARKIE SCREW ANCHORS

### Solid Base Material

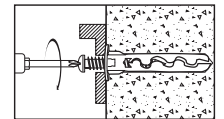
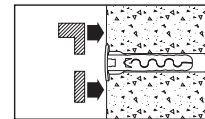
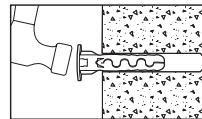
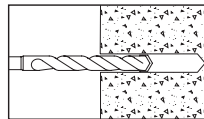

1. Drill hole into solid wall. 2. Push in anchor and tap flush to wall.

3a. Place item over anchor. Jaws will compress against base material.

4a. Insert screw and tighten flush with item.

### Hollow Base Material

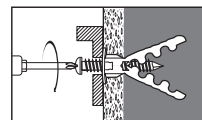
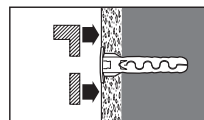

3b. Place item over anchor 4b. Insert screw and tighten flush with item. Jaws will lever and wedge open.



**Sharkie Wall Anchor**



**#10 x 1.25" Flat Head Screw**



Small cordless driver with clutch setting on low number

1/4 size nut driver for precise tightening #8 screws for CAPS

Your banner frame sides will come in 1 piece if smaller, but likely in segments that you'll join with our Joiner Straps. You can mount segments, 1 by 1 on your surface, using a bubble level and making sure segments are aligned with each other.

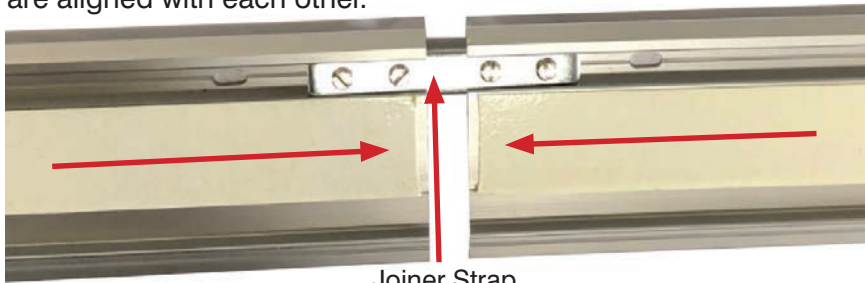

Joiner Strap

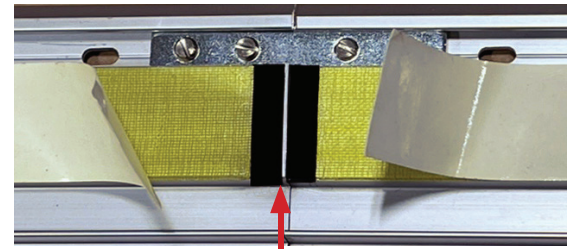

Joiner straps join long sides for a nice straight alignment.

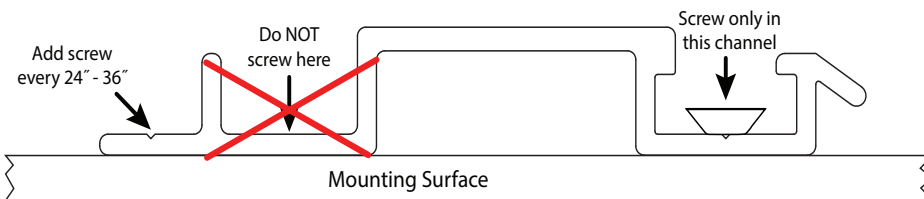

The tacky tape is "covered" at the joiner areas and miter edges with a black tape. Do NOT remove this black tape. Its purpose is to prevent the tacky tape from lifting off the frame bottom when lifting off the banner material for repositioning or change-out.

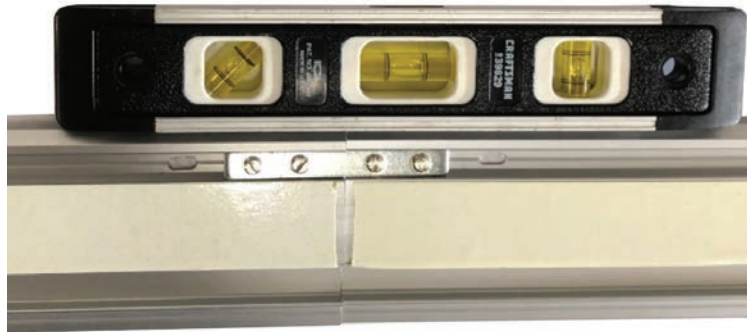

Use a bubble level, only on building walls, to make sure your horizontal top BASE rail segments are mounted "level."

For trailers or box trucks, do not use a level. Align with top trailer edge.



Outer screw and corner joiner/channel.

Inside channel. Do not wall mount or drill into this channel. This is where your CAP pushes the banner into the channel.

1. First attach top BASE rail to surface. Make sure you know how high to mount and where bottom of frame will end up. Use only the outer channel in the BASE rail screw for mounting, do NOT add any screws to inside channel of BASE rail.

- a. If 1 piece BASE, drill hole in approx center and install screw.
- b. If 2 or more BASE rails, you can screw 1 rail at a time on your surface, and add additional BASE rails with included Joiner Straps.

**For either a. or b., use a level to make sure BASE rail is mounted level, and follow this:**

**For masonry:** Drill pilot hole in the middle of the 1st segment of BASE rail, through the slotted hole. Attaching to your wall in the "middle" of the BASE rail will allow for easy leveling before 2nd hole is drilled. Use a hammer drill and masonry drill bit to drill pilot hole for the Sharkie anchor. Install white nylon Sharkie anchor into surface hole first, then drive screw through frame channel into the wall mounted Sharkie. Use a level before adding a second screw to secure the top portion of the BASE rail to the surface.

## For mounting on Tractor Trailer sides:

Most all Box trucks and 48' to 53' tractor trailers' outer sides are either an approx. .050 thick painted aluminum or similar thickness sheet metal. This outer skin is riveted to vertical steel hat channels "legs" hence why riveting is in pairs on the outer trailer. The inside panels of the trailer are usually plywood, which is typically screwed to bottom flat of vertical steel hat channel or post. There will be a gap between the back of the outer aluminum skin and plywood for the approx. thickness of the hat channel/post, typically  $\frac{3}{4}$  to 1.25". On smaller box trucks, the sides may be fiberglass or similar.



## For truck trailer mounting, you will:

a. Holes in Base for Truck trailer mounting are not added, because you'll have to mark the unique location where the **vertical hat channels or posts are**. **Screw the BASE rails to the sides of the trailer very close to rivets on the hat channels/posts so you're screwing to the hat channel flanges**. Use the included #10 flat head, SS, 1 inch long self drilling screws.

Our banner system will cover up all ugly rivets, gouges, and dents for a smooth, professional appearance!



The outer alum or steel "skin" is riveted to "Hat" channels inside trailer.

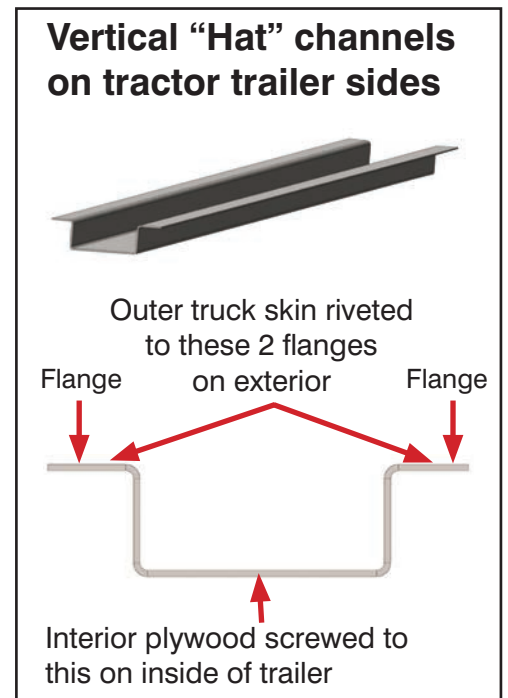

## Mounting BASE rail to truck sides:

1. On Vertical hat channels/posts on Trailer: Top horizontal BASE rail is screwed to your vertical hat channels/posts using Flat head #10x 1" long 410SS hex head self-drilling screws (should be included if ordered, or we can supply). You will have to add your own holes in the BASE rail where the hat channels/posts are, as it's very important you screw the BASE rail to the vertical hat channels/posts area for a strong/secure hold to the trailer. Add screws between the vertical posts on trailer if 24" apart or greater. Add the left and right vertical BASE sides and bottom BASE using the Corners and Joiner Straps BEFORE screwing these remaining 3 sides. You will likely have multiple BASE rail segments for each side and bottom.

## Optional Riveting BASE rail to Trailer side:

Most semi-trailer sides are not smooth, but have rivet heads and uneven surfaces, and corrugations. So, because the BASE rail will not sit flush on the trailer sides in all areas, determining the proper clinch thickness is difficult. Rivets can be used, but you'd have to evaluate for your truck. Rivets are fine for smooth, uniform, smaller box truck sides that don't have corrugations on the sides and often have fiberglass or similar truck skins.

## Optional 3M VHB mounting:

The other option is thoroughly cleaning truck side and bottom of BASE rail with rubbing alcohol where you'd attach an industrial grade 3M Brand VHB tape with about .12 in thickness to accommodate for the wavy surface and rivet heads. Please ask for more information from us before mounting this method.

## For Truck Trailers only:

Because of the rivet heads and corrugations on truck trailer sides, the BASE rail will not sit tight and flush to most areas of the trailer sides.

This means wind will get under the BASE rail and rattle your banner. You don't want wind to get under your banner.

You need to add a bead of caulk as shown below so that wind does not enter the backside of the banner as the truck goes down the highway.

### Caulk before the CAP is installed.

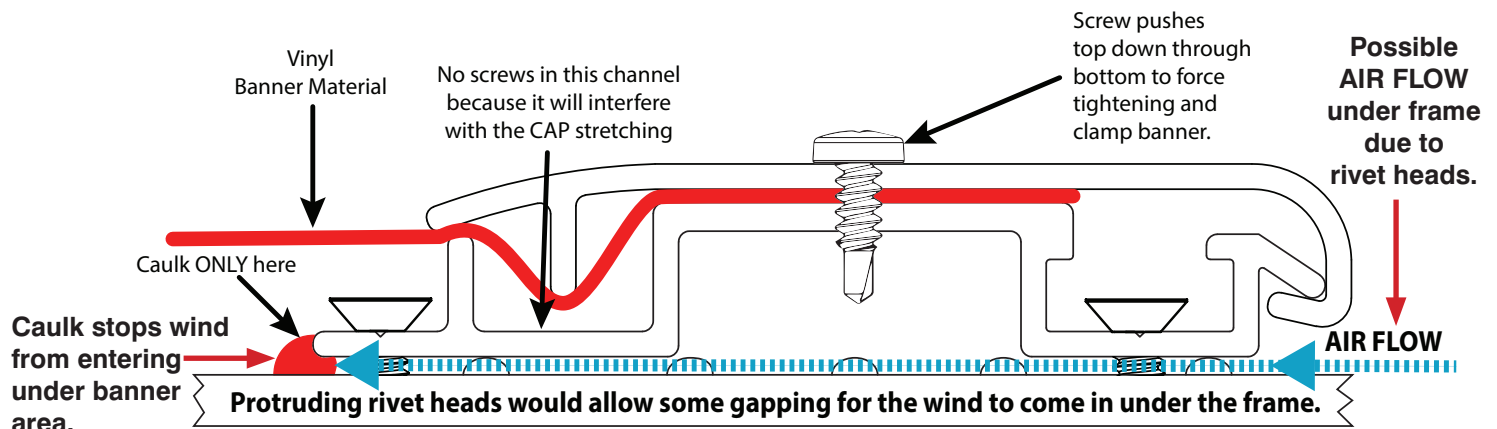
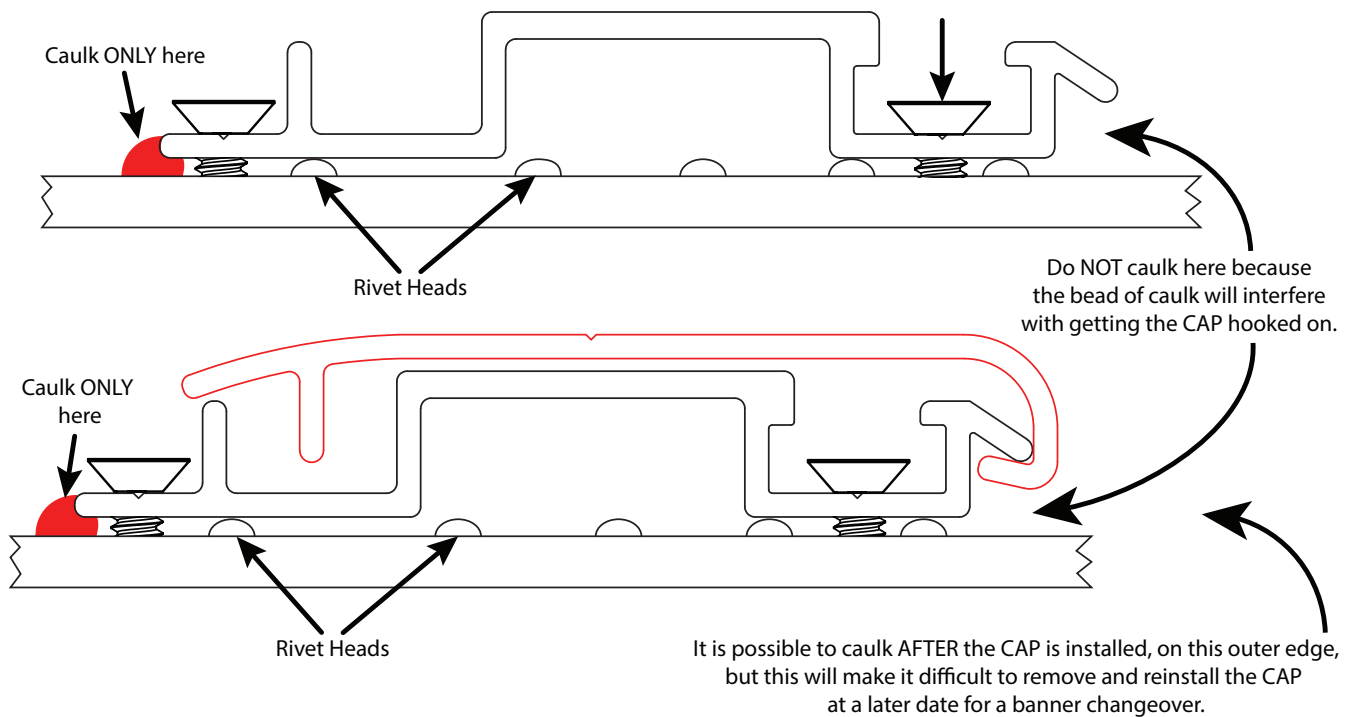

Once BASE rail has been installed on either your Wall or your Truck Trailer, the following instructions are the same for installing the banner.

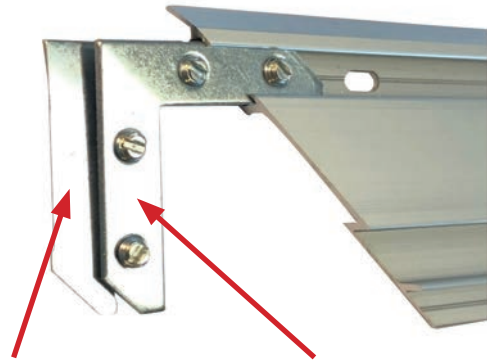

Use the backplate under the tapped corner angle. Insert all the way and tighten.

Now add the right and left side rails to the "top" BASE rail and tighten corner screws.

Add the bottom BASE rail to left and right sides, tighten corners.



Only AFTER you've added the left, right sides, and bottom to top BASE rail screw these remaining 3 BASE rails to your wall.



Peel off protective masking from the Tacky tape on ONLY the top BASE rail.

Tacky tape is super sticky but is removable. It can be used over and over. Ideally, temperatures 45 to 90 degrees F. If the exposed tacky tape gets rained on/wet during your installation, after the rain stops, let it dry out and it will be super sticky again. Once your banner material is tacked down, the tacky tape will hold in the wet condition until you screw CAPs on. You can get additional rolls of tacky tape, part no. BSFM27X



With 2 people, tack down the banner as snugly and hand tight as you can on ONLY the top BASE horizontal rail, with no wrinkles. You can pull off and reposition the banner from the tacky tape. Ideally, start on 1 side, and work your way down to the other side.

Peel off liner to expose sticky tape. Tack top of banner to tacky tape. Make sure to position level and aligned in the corner. You can remove and reposition as needed so that banner is tacked onto the BASE of the frame as smoothly, hand tight, and wrinkle free as possible.

The tacky tape is "covered" at the joiner areas and miter edges with a black tape. Do NOT remove this black tape. Its purpose is to prevent the tacky tape from lifting off the frame bottom when lifting off the banner material for repositioning or change-out.

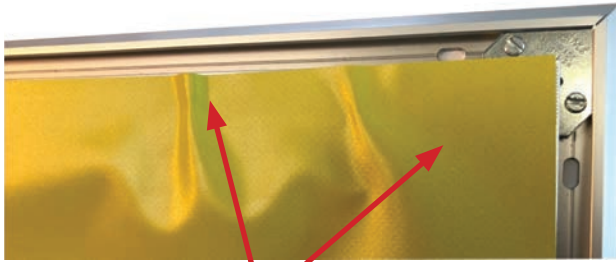
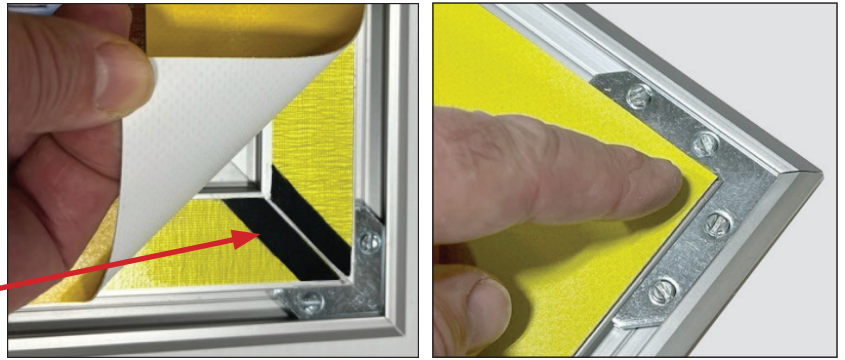

Don't leave bunchups and wrinkles like this.



Make banner tight and smooth.



The banner must be as tight as possible, across the top and centered on the BASE rail.



Remove masking. Tack down banner on left and right vertical BASE rails and pull tight.



Make sure to trim off any excess banner material off the outer edge of the tacky area by inserting a box cutter knife into the channel and cutting off. This is important so that excess banner does not interfere with the CAP top rail installation.

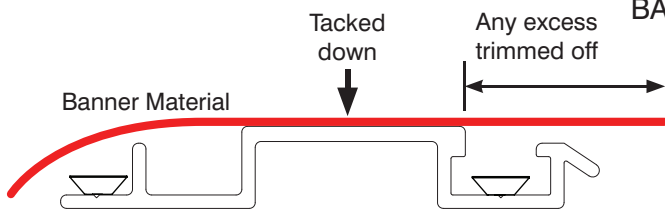

Tack down bottom of banner by pulling down snug and smooth.



To achieve a wrinkle free banner, you must have the banner tacked to all 4 BASE rail sides in a smooth, tight, wrinkle free manner before putting the CAPS on. You can pull off the banner from the tacky tape and reposition as needed.





Banner is tacked down onto tape tight and smooth on all 4 sides.



Using #8 x 1/4 hex head 410SS self drilling screws, hook CAP top rail onto BASE rail, angle down and ALIGN the miter edge with BASE miter edge (very important).

CAP miters should line up with miters on BASE rail

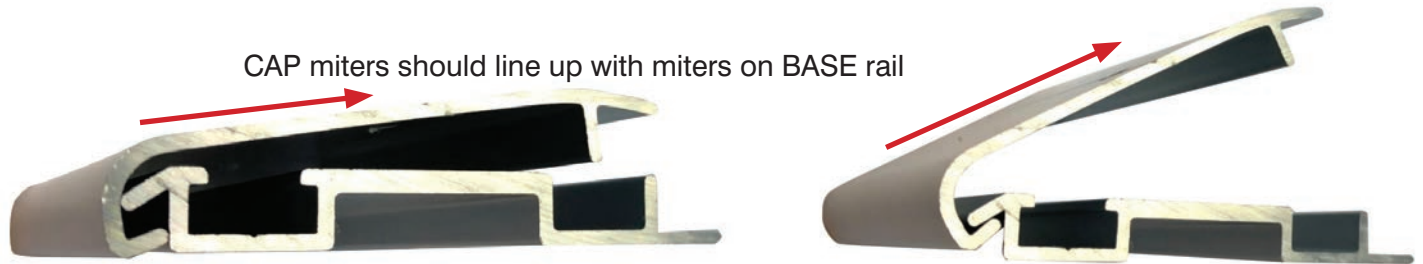

Top must be "hooked" onto the BASE rail and pushed inwards towards center as you angle down for screwing.



Mitered 45 degree edges on BASE rails

Installing the 1st "top" CAP rail is very important for alignment. If the CAP is not screwed down with the miters lining up with each other, it will affect how the other side and bottom CAPS line up.

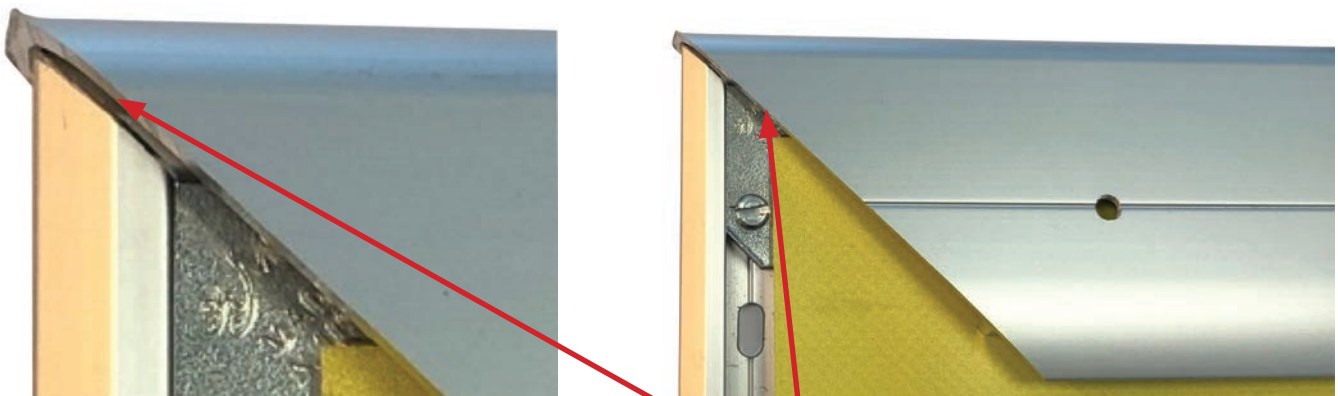

Make sure CAP miter edge is lined up with BASE miter edge BEFORE you screw down CAP.

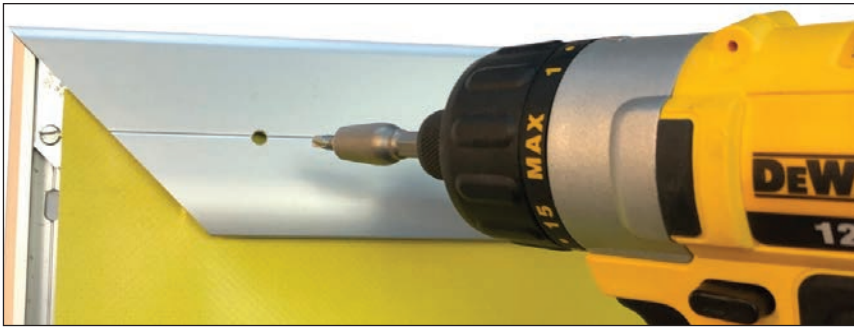

With miters lined up, gently push down CAP and drill down into BASE rail. This process stretches and banners while at the same time clamping the banner material down to the BASE rail.

Use a cordless screwdriver with the clutch setting on "low."

### How screwing down the CAP tightens the banner:

Screw down left and right CAP rails, and then bottom CAP rail to finish.

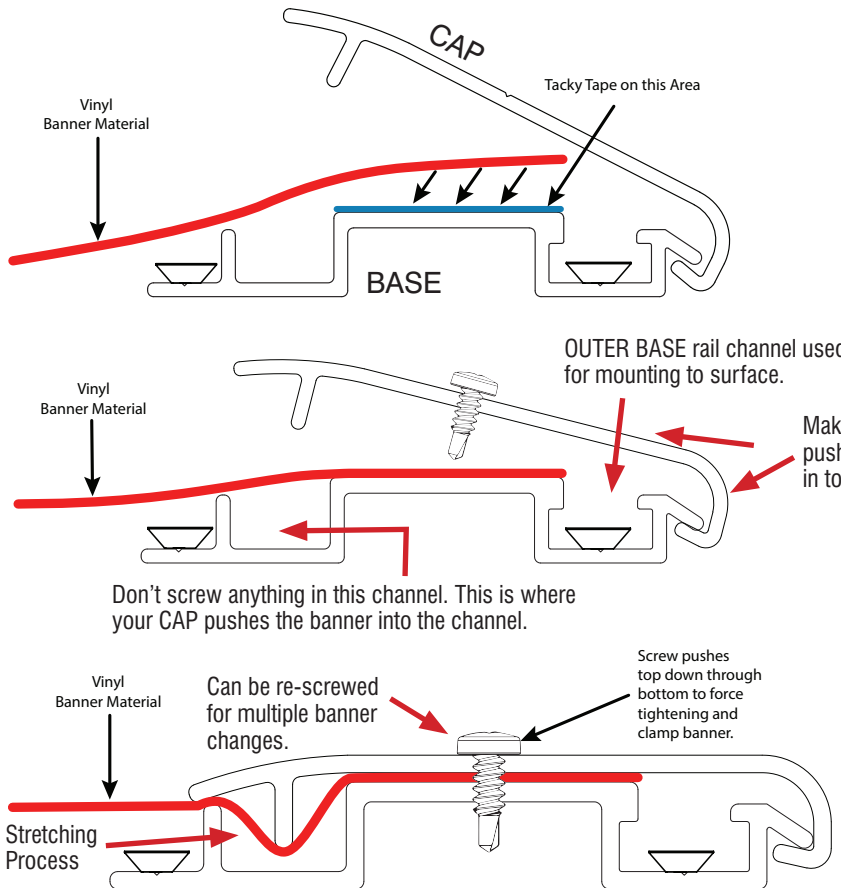

Don't screw anything in this channel. This is where your CAP pushes the banner into the channel.



The tacky tape is used for positioning only. Once CAP is screwed down, the CAP and screw tightly compress down to hold vinyl banner in place within the frame.





After you have screwed down all the CAPS with your cordless screwdriver on a low clutch number setting (to avoid stripping the screw), you can use the 1/4" HEX hand tool to finesse and tighten down as necessary for a perfect stretch.





**Beautiful Banner Display, Wrinkle free, Drum Tight, Won't blow out in any winds, perfect for Semi Trailer use**

The CAPs have pre-drilled holes about 12" apart. When you screw down all 4 frame sides, your banner will stretch drum-tight about 1/4" from the mounting surface. So, the bricks, any small bumps or minor wall imperfections will not show through the banner. The banner will NOT blow out in the highest strongest winds and for highway semi trailer use! The screws although visible closer-up, are almost invisible further away.

You will have a beautiful banner display. Frame is 2.56" wide and only about 1/2" projecting from the wall and with its bull nose edges, totally aerodynamic for semi trailer use.

---

Call or email us. Intelligent, informed staff will answer right away  
(no computers answering phones). We get you the answers and pricing fast.

**Access Display Group, Inc.**

151 S. Main St • Freeport, NY 11520

Tel: 1-800-289-1539

info@displays4sale.com

displays4sale.com

**American Owned**



**American Made**