

### VALUE LINE Floor Display Stand with Rotating Sign Frame (for 11" x 17" Menus, Posters & Signs)

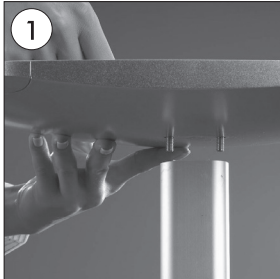

- Complete the stand by screwing the classical base to the elips profile.

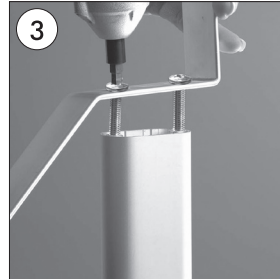
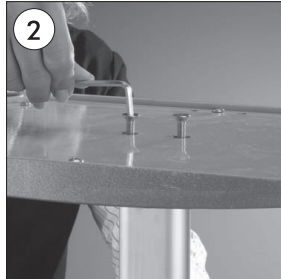

- Fix the frame connector to the elips profile.

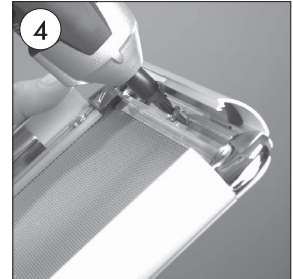

- Fix the frame through holes to the frame connector.

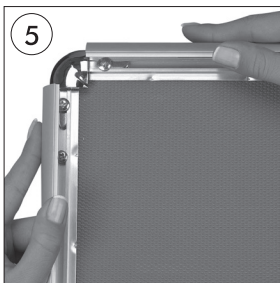

- Open all profiles.

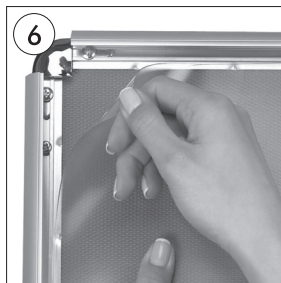

- Take-off the anti-reflex cover.



- Place the poster in.

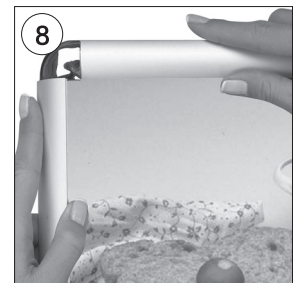

- After placing the cover back on the poster, close the profiles.

