

RADIO-CONTROLLED CLOCK WITH OUTDOOR WIRELESS TEMPERATURE AND MOON PHASE

Instruction Manual

TABLE OF CONTENTS

	Pages
Glossary of Common Terms	2
Features	3
Battery Installation & Change	4-5
Setting-Up	5
Function Keys	6
LCD Screen Descriptions	6
Moon Phase Symbols	7
Manual Settings	7-11
TIME ZONE	8
DST (DAYLIGHT SAVING TIME) ON/OFF	8
LANGUAGE DISPLAY	9
MANUAL TIME	9-10
YEAR, MONTH, DATE, AND WEEKDAY	10
12/24 HOUR TIME DISPLAY	10
°F OR °C TEMPERATURE	10-11
Changing Display Mode	11
Alarm Setting and Deactivating	11-12
Outdoor Temperature Transmitter	12-13
Positioning	13-15
Troubleshooting	15-16
Care and Maintenance	16
Specifications	16-17
Warranty and Contact Information	17-19

GLOSSARY OF COMMON TERMS

NIST*

The National Institute of Standards and Technology maintains the primary frequency standard for the United States. The NIST also coordinates the United States time and frequency standards with other world standards. The NIST provides time and frequency services for United States clientele.

WWVB*

The WWVB is an AM radio station in Ft. Collins, Colorado, managed by the NIST. The WWVB's function is to broadcast time-of-day information derived from the NIST atomic clock, located in Boulder, Colorado.

ATOMIC CLOCK*

An atomic clock is an extremely accurate time device measuring time by the movements of electrons in cesium atoms. The NIST atomic clock is one of the most precise clocks in the world, accurate to 10 billionths of one second. The NIST's atomic clock contributes to the international group of clocks calculating the Coordinated Universal Time (UTC)—the official world time.

RADIO-CONTROLLED TIME*

A radio-controlled time device is often confused with an atomic clock. However, a radio-controlled time device receives its time information *from* the atomic clock each day through an internal antenna. The radio-controlled time device searches for an exact time signal every night when the signal from the WWVB is the strongest. The signal can be received up to 2,000 miles away through a radio-controlled time device.

LCD

"LCD" is an acronym for "Liquid Crystal Display". This is a common type of display screen used in televisions, computers, watches, and digital clocks.

CELSIUS (°C)

Celsius is metric system's unit of measurement used to calculate temperature.

FAHRENHEIT (°F)

Fahrenheit is the common unit of measurement used to calculate temperature in the United States.

*For more information regarding the NIST, WWVB, atomic clock, and radio controlled time, please visit the NIST official website: <http://www.boulder.nist.gov/timefreq/stations/wwvb.htm>

FEATURES

RADIO-CONTROLLED CLOCK:

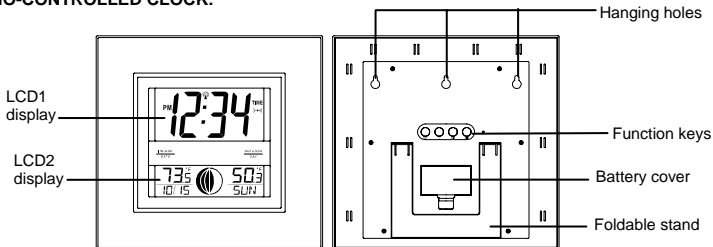

- WWVB Radio-controlled time with manual time setting
- 12/24 hour time display
- Time zone setting
- Daylight savings time ON/OFF option (DST)
- Time display: hour, minute, second
- Alarm setting with snooze function
- °F or °C temperature display selectable
- Indoor temperature display
- Outdoor temperature display via 433MHz transmission
- Calendar display
- Weekday display (4 languages to choose from: English, French, Spanish and German)
- Current moon phase display
- Wall mount or freestanding

OUTDOOR TEMPERATURE TRANSMITTER:

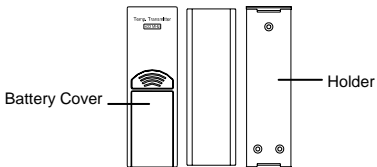

- Remote transmission of outdoor MHz signals
- Wall mounting case

TO INSTALL AND REPLACE BATTERIES IN THE TEMPERATURE TRANSMITTER (INSTALL BATTERIES IN TRANSMITTER BEFORE INSTALLING BATTERIES IN RADIO-CONTROLLED CLOCK)

The transmitter uses 2 x AA, Alkaline batteries. To install and replace the batteries, please follow the steps below:

1. Remove the battery cover by pushing down towards bottom of transmitter and sliding cover out.
2. Insert the batteries, observing the correct polarity (see marking inside battery compartment).
3. Replace the battery cover on the unit.

ALKALINE BATTERIES ARE RECOMMENDED FOR USE IN BOTH UNITS. AVOID USING RECHARGEABLE BATTERIES.

TO INSTALL AND REPLACE BATTERIES IN THE RADIO-CONTROLLED CLOCK

The radio-controlled clock uses 2 x AA, Alkaline batteries. To install and replace the batteries, please follow the steps below:

1. Remove the battery cover.
2. Insert batteries observing the correct polarity (see marking inside battery compartment).
3. Replace compartment cover.

DO NOT SET THE CLOCK.

Note:

In the event of changing batteries of the unit, ensure that the batteries do not spring free from the contacts. Always wait at least 15 minutes after removing the batteries before reinserting, otherwise start up and transmission problems may occur.

REPLACEMENT OF BATTERIES

For best performance, batteries should be replaced at least once a year to maintain the best running accuracy. Ensure that the batteries used are new and the correct size.



Please help in the preservation of the environment and return used batteries to an authorized depot.

WARNING!

- Do not mix old and new batteries.
- Do not mix alkaline, standard (carbon-zinc), or rechargeable (nickel cadmium) batteries.

SETTING-UP:

NOTE: Do not set the clock until the outdoor temperature is displayed.

1. **Place batteries in the outdoor transmitter first, then into the radio-controlled clock.**
2. **DO NOT PRESS ANY BUTTONS FOR 15 MINUTES.**
3. After 15 minutes both the Indoor and Outdoor areas on your clock should have a temperature showing. If not, remove both sets of batteries, wait 15 minutes and repeat step one.
4. **After the clock receives the outdoor temperature, and 15 minutes have elapsed, set your time zone. The default time zone is Eastern Standard Time (EST). If you live in the Eastern Time zone move to step 6.**
5. To set the time zone:
 - Push and release the **"SET"** function button.
 - The time zone (LCD2) will start flashing (Default setting -5EST).
 - Push the **(+)** function button to change the default setting (-5EST) to the desired time zone.
 - 6 CST (Central Time Zone)
 - 7 MST (Mountain Time Zone)
 - 8 PST (Pacific Time Zone)

(See "Time Zone Setting" if you live outside the USA)
6. After the clock receives the outdoor temperature the WWVB time code reception will automatically start. The clock will automatically set itself to the exact time, day and date after receipt of the WWVB time code reception. This typically takes over night. For best reception place your clock next to a window facing Colorado over night. Once a successful reception is received the Radio Reception (📶) icon will appear above the blinking colons. Once a successful reception is received relocate your clock to a desired location. The clock will then automatically attempt to receive the WWVB time from 12:00 am through 6:00 am each day (attempts WWVB reception every full hour within this time frame). When this is successful, the received time will override the

manually set time. The date is also updated with the received time (Please refer to notes on "Manual time setting").

ICON DESCRIPTION

Successful reception of WWVB time signal



Currently searching for the WWVB time signal (tower blinking)

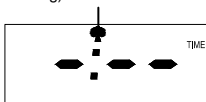

Unsuccessful reception of WWVB signal. Will work as normal quartz clock. Will search for the WWVB time signal overnight.



FUNCTION KEYS

The radio-controlled clock has 4 easy to use keys:

- SET** key : To enter into the set mode for the following functions: time zone, DST ON/OFF (daylight saving time), language, hour, minute, year, month, day, weekday, 12/24 hour, °C or °F temperature display
- +** key : To toggle between the seconds, temperature or weekday display
To change any values in manual set mode
- ALM** key : To enter into the alarm set mode
To set the alarm ON/OFF
- SNZ** key : To activate the snooze function during alarm
To display the alarm time in normal mode display
To exit the setting modes

LCD SCREEN DESCRIPTIONS

The radio-controlled clock's LCD is divided into 2 sections. When batteries are inserted, all the segments will light up briefly before displaying the information for time, date, and indoor and outdoor temperatures.

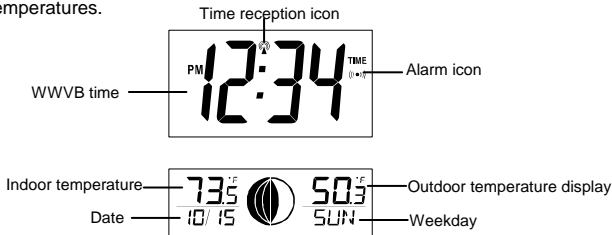

MOON PHASE SYMBOLS:

The radio-controlled clock automatically calculates and updates the moon phase diagram on LCD2. The phase display will change approximately every 2 days, 11 hours. Whenever the date or time is changed manually, the radio-controlled clock will display the updated moon phase within a few minutes. 12 stages of the moon's phases are represented.



New Moon



Small Waxing
Crescent



Large Waxing
Crescent



First Quarter



Small Waxing
Gibbous



Large Waxing
Gibbous



Full Moon



Large Waning
Gibbous



Small Waning
Gibbous



Last Quarter



Large Waning
Crescent



Small Waning
Crescent

Note: The moon phase visible in the sky is noted by a darkening of the LCD screen. Therefore, a full moon is a complete dark circle.

MANUAL SETTINGS

Note:

If the radio-controlled clock has already successfully received the WWVB time signal and displays the correct time and date, then the Manual settings can be skipped.

After completion of the above described procedures in "Setting up" the manual setting modes can be entered by pressing and holding the **SET** key for 3 seconds. The following settings can now be programmed:

- Time zone setting
- DST ON/OFF
- Language display setting
- Manual time setting
- Year setting
- Month setting

- Date setting
- Weekday setting
- 12/24 hour time display setting
- °C or °F temperature setting

TIME ZONE SETTING

After entering the manual setting mode as described above, the time zone can be set using the number of hours different from Greenwich Mean Time (GMT) range in LCD2. To do this:



1. The time zone (LCD2) will start flashing (Default setting "-5h"). Select the desired time zone by pressing and releasing the **+** key.

Note: The time zones from -4 to -10 hours will be displayed with 3 characters abbreviations:

- -4 ATL (Atlantic time),
 - -5 EST (Eastern time; default time zone),
 - -6 CST (Central time),
 - -7 MST (Mountain time),
 - -8 PST (Pacific time),
 - -9 ALA (Alaska time),
 - -10 HAW (Hawaii time).
2. "GMT" will be displayed if set to GMT (0).
 2. Press and release the **SET** key to enter the "**DST Setting**".

DST SETTING (daylight saving time)

1. The ON digit will start flashing on LCD1. Set the DST ON or OFF by pressing the **+** key.
2. Press and release the **SET** key to enter the "**Language Setting**".

Note:

The DST default is "ON", meaning that the WWVB will automatically change the time according to Daylight Saving Time in the spring and fall. For areas that do not recognize DST changes (Arizona and parts of Indiana) turn the DST "OFF".

LANGUAGE SETTING

The weekdays can be displayed in LCD2 with the pre-set languages: English, French, Spanish and German.

US = English

F = French

E = Spanish (Español)

D = German (Deutsch)

1. Set the desired language for the weekday display in LCD 2 by use of the + key.
2. Press and release the **SET** key to enter the mode “**Manual Time Setting**”.

MANUAL TIME SETTING

In case the radio-controlled clock is not able to detect the WWVB-signal (disturbances, transmitting distance, etc.), the time can be manually set. The clock will then work as a normal Quartz clock.

Note: In 12 hours mode the time will be displayed with an additional “PM” for the time from 12:00 noon until 11:59 pm.

1. The hour digits will start flashing on LCD1.
2. Set the desired hours by pressing and releasing the + key followed by pressing the **SET** key.
3. Now the minute digits will start flashing.
4. Set the desired minutes by pressing and releasing the + key. If the + key is held, the units will increase by 5.
5. Press and release the **SET** key to move to the “**Year Setting**”.

Note:

The unit will still try to receive the signal every day despite it being manually set. When it does receive the signal, it will change the manually set time to the received time. During reception attempts, the WWVB tower icon will flash. If reception has been unsuccessful, then the WWVB tower icon will not appear but reception will still be attempted the following hour.

WWVB time reception takes place from 12:00 am through 6:00 am each day (attempts WWVB reception every full hour within this time frame). When the time signal is received for example at 1:00 am, the radio-controlled clock will not attempt to receive the WWVB signal for the remaining hours until 6:00 am. Therefore, the next signal attempt will take place

between 12:00 am and 6:00 am the next day. The other times WWVB reception takes place, are upon setup and after manual time set exiting mode. Reception is generally not possible during daylight hours due to the interference of the sun.

YEAR SETTING

The year can be selected sequentially from 2000 to 2049 and will then start over again (default setting 2000). Only the last 2 digits of the year will be visible on LCD2.

1. The year digits will start flashing on LCD2. Select the desired year by use of the + key.
2. Press and release the **SET** key to switch to the "**Month Setting**".

MONTH SETTING

1. The month digits on LCD2 will start flashing. Set the desired month by use of the + key.
2. Press and release the **SET** key to move to the mode "**Date Setting**".

DATE SETTING

1. The digits for the date will start flashing on LCD2 (Default setting 1). Set the desired date by use of the + key.

Note: The date can only be set in conjunction with the selected month. For example, it is not possible to set the date 30 if the month of February is selected.

2. Press and release the SET key to enter the "**Weekday Setting**".

WEEKDAY SETTING

1. The weekday symbols will be displayed flashing on LCD2 in the pre-set language section. Set the desired weekday by use of the + key.
2. Press and release the **SET** key to enter the mode "**12/24 Hours Time Display Setting**".

12/24 HOURS TIME DISPLAY SETTING

1. The "**12**" or "**24**" will start flashing in LCD1 (Default setting 12h). Select the desired time display mode by use of the + key.
2. Press and release the **SET** key to enter the "**°C/°F Temperature Setting**".

°C OR °F TEMPERATURE SETTING

1. The characters “°C” or “°F” will start flashing on LCD1 (Default setting °F). By use of the + key select “°C” for temperature display in degrees Celsius or “°F” for degrees Fahrenheit.
2. Press and release the **SET** key to exit the setting mode and switch back to the normal display mode.

EXIT THE MANUAL SETTING MODES

- To return to the normal display mode from anywhere in manual setting mode simply press the **SNZ** key anytime.
- If no keys are pressed for at least 15 seconds in setting mode, the radio-controlled clock will automatically switch back to normal display mode.

CHANGING THE DISPLAY MODE (DAY, SECONDS, AND TEMPERATURES)

There are 4 possible display modes to view the day, seconds, and temperatures. The *month&date/weekday/indoor temperature/outdoor temperature* is the default.

To change the display:

1. Press the + key. The display should now show the *month&date/weekday/seconds/outdoor temperature*.
2. Press the + key a second time and the display will now show the *month&date/weekday/indoor temperature/seconds*.
3. Press the + key a third time and the display will now show the *month&date/seconds/indoor temperature/outdoor temperature*
4. Press the + key a 4th time and the display will return to the default display.

ALARM SETTING

To enter into the alarm setting mode:

1. Hold the **ALM** key for 4 seconds. The hour digits start flashing.
2. Press and release the + key to set the hour.
3. Press and release the **ALM** key to set the minutes. The minute digits start flashing.
4. Press and release the + key to set the minutes.
5. Press and release again the **ALM** key to exit the Alarm setting mode or wait for 15 seconds automatic timeout.

TO DEACTIVATE THE ALARM:





The alarm will be automatically ON when the alarm time is set. To deactivate the alarm (OFF), press and release once the **ALM** key in normal mode display. The alarm icon will disappear, the alarm is now off.

SNOOZE SETTING

The snooze button can only be used while the alarm is sounding. The snooze period is 10 minutes long. After the 10 minute snooze period, the alarm with sound again.

OUTDOOR TEMPERATURE TRANSMITTER:

The temperature is measured and transmitted to the radio-controlled clock every 1 minute. The radio-controlled clock will update the temperature display every 5 minutes. The range of the outdoor temperature transmitter may be affected by the temperature. At cold temperatures the transmitting distance may be decreased. Please bear this in mind when positioning the transmitter. Also the batteries may be reduced in power during periods of extreme cold temperatures.

433MHz RECEPTION CHECK FOR OUTDOOR TEMPERATURE TRANSMITTER

The radio-controlled clock will receive the temperature data within 15 minutes. If the temperature data is not received 15 minutes after setting up (the display shows "--"), then please check the following points:

1. The distance of the radio-controlled clock or outdoor temperature transmitter should be at least 6 feet away from any interfering sources such as computer monitors or TV sets.
2. Avoid placing the receiver onto or in the immediate proximity of metal window frames.
3. Using other electrical products such as headphones or speakers operating on the same signal frequency (433MHz) may prevent correct signal transmission and reception.
4. Neighbors using electrical devices operating on the 433MHz signal frequency can also cause interference.

Note:

When the 433 MHz signal is received correctly, do not re-open the battery cover of either the outdoor temperature transmitter or radio-controlled clock, as the batteries may spring free from the contacts and force a false reset. Should this happen accidentally then reset all units (see **Setting-up** above) otherwise transmission problems may occur.

The maximum transmission range is **330 feet** from the outdoor temperature transmitter to the radio-controlled clock (in open space). However, this depends on the surrounding environment and interference levels. If no reception is possible despite the observation of these factors, all system units have to be reset (see **Setting-up**).

POSITIONING

Before permanently mounting ensure that the radio-controlled clock is able to receive WWVB signals from the desired location. Also, extreme and sudden changes in temperature will decrease the accuracy of the radio-controlled clock, and changes in elevation will result with inaccurate temperatures readings for the next 12 to 24 hours. These changes will require a 12 to 24 hour wait before obtaining reliable data.

POSITIONING THE RADIO-CONTROLLED CLOCK:

There are 2 possible ways to mount the radio-controlled clock:

- use of the foldout table stand, or
- wall mounting

FOLDOUT TABLE STAND

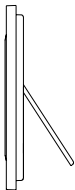

The foldout table stand leg is located on the backside of the atomic clock. Once the foldout table stands is extended, place the atomic clock in an appropriate location.

WALL MOUNTING

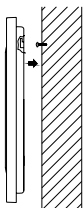

- 1) Using a straight edge, horizontally space at 3-15/16 of an inch (100 mm) three screw positions on a wall.
- 2) Install three mounting screws (not included) into a wall —leaving approximately 3/16 of an inch (5mm) extended from the wall.
- 3) Place the atomic clock onto the screws, using the hanging holes on the backside. Gently pull the atomic clock down to lock the screws into place.

Note:

Always ensure that the atomic clock locks onto the screws before releasing.

POSITIONING THE OUTDOOR TEMPERATURE TRANSMITTER

To achieve a true temperature reading, avoid mounting where direct sunlight can reach the outdoor temperature transmitter. It is recommended to mount the outdoor temperature transmitter on a North-facing wall or in any well-shaded area. The maximum transmitting range is **330 feet** obstacles such as walls, concrete, and large metal objects can reduce the range.

Place both units in their desired location, and wait approximately 15 minutes before permanently mounting to ensure that there is proper reception. The outdoor temperature transmitter is not waterproof and should not be placed where it will be directly in the rain.

The outdoor temperature transmitter can be mounted in two ways:

- with the use of screws, or
- using the adhesive tape.

MOUNTING WITH SCREWS

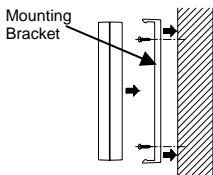

- 1) Remove the mounting bracket from the outdoor temperature transmitter.

- 2) Place the mounting bracket over the desired location. Through the three screw holes of the bracket, mark the mounting surface with a pencil.
- 3) Where marked, start the provided screws into the mounting surface.
- 4) Screw mounting bracket onto the mounting surface. Ensure that the screws are flush with the bracket.

MOUNTING WITH ADHESIVE TAPE

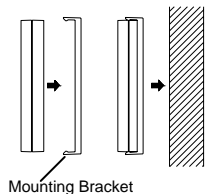

- 1) With a nonabrasive solution, clean and dry the back of the mounting bracket and the mounting surface to ensure a secure hold. The mounting surface should be smooth and flat.
- 2) Remove the protective strip from one side of the tape. Adhere the tape to the middle of the backside of the mounting bracket
- 3) Remove the protective strip from the other side of the tape. Position the outdoor temperature transmitter in the desired location, ensuring that the radio-controlled clock can receive the signal.

Note: Adhesive tape should only be used temporarily while acquiring signal reception from the atomic clock. The adhesive tape is not a permanent mounting solution.

TROUBLESHOOTING

Problem:	The LCD is faint.
Solution:	1) Replace the batteries.
Problem:	No reception of WWVB signal
Solution:	<ol style="list-style-type: none"> 1) It may help reception to face the front or back of the radio-controlled clock in the general direction of Ft. Collins, Colorado. 2) Wait overnight for signal. 3) Be sure the radio-controlled clock is at least 6 feet (2 meters) from any electrical devices, i.e. TV sets, computers, or other radio controlled clocks. 4) Remove batteries for 15 minutes. See Setting-up.
Problem:	Hour is incorrect (minute and date are correct).

Solution:	1) Be sure the correct time zone and daylight saving time are selected.
Problem:	"OF.L" appears in the indoor temperature section of the LCD
Solution:	1) Move the radio-controlled clock to an area with warmer or cooler surrounding temperature. Current surrounding temperatures are outside measuring range.
Problem:	"--." appears in the outdoor temperature section of the LCD.
Solution:	<ol style="list-style-type: none"> 1) Remove the batteries of both units for ten minutes, then reinsert them again. Make sure the batteries are new and fresh. See setting-up. 2) Move the radio-controlled clock closer to the transmitter or place the transmitter closer to the radio-controlled clock. Make sure the clock is at a receivable range from the transmitter. 3) Move the units to another location. Interferences from other electrical devices operating on the same signal frequency (433MHz) may prevent correct signal transmission and reception.
Problem:	"OF.L" appears in the outdoor temperature section of the LCD.
Solution:	1) Wait until the current surrounding temperature cools down or increases. Current temperature is outside of the measuring range of the transmitter or has temporary affected battery strength. The outdoor temperature will be displayed again once the current surrounding temperature is within the range of the transmitter.

CARE AND MAINTENANCE

- Avoid placing the units in areas prone to vibration and shock as these may cause damage.
- Avoid areas where the units can be exposed to sudden changes in temperature, i.e. direct sunlight, extreme cold and wet/moist conditions as these will lead to rapid changes which reduces the accuracy of readings.
- When cleaning the LCD and casing, use a soft damp cloth only. Do not use solvents or scouring agents.
- Do not submerge the units into water.
- Immediately remove all low powered batteries to avoid leakage and damage. Replace only with new batteries of the recommended size.

- Do not make any repairs to the units. Please return it to the original point of purchase. Opening and tampering with the units may invalidate the warranty.

SPECIFICATIONS

Temperature measuring range

Indoor:	+32°F to +122°F with 0.2°F resolution 0°C to +50°C with 0.1°C resolution ("OF.L" displayed if outside this range)
Outdoor :	-21.8°F to +157.8°F with 0.2°F resolution -29.9°C to +69.9°C with 0.1°C resolution ("OF.L" displayed if outside this range)

Temperature checking interval

Indoor:	every 10 seconds
Outdoor:	every 5 minutes

Transmission distance

maximum **330 feet** in open field, depending upon surrounding structures, mounting location and possible interfering sources

Power source (alkaline batteries recommended)

Radio-controlled clock :	2 x AA, 1.5V batteries
Transmitter:	2 x AA, 1.5V batteries
Battery life:	about 12 months

Dimensions (H x L x W)

Radio-controlled clock:	8.57" x 10.32" x 1.18" / 217.9 x 262.1 x 30mm
Transmitter:	5.04" x 1.57" x 0.9" / 128 x 40 x 23 mm

WARRANTY INFORMATION

La Crosse Technology, Ltd provides a 1-year limited warranty on this product against manufacturing defects in materials and workmanship.

This limited warranty begins on the original date of purchase, is valid only on products purchased and used in North America and only to the original purchaser of this product. To receive warranty service, the purchaser must contact La Crosse Technology, Ltd for problem determination and service procedures. Warranty service can only be performed by a La Crosse Technology, Ltd authorized service center. The original dated bill of sale must be

presented upon request as proof of purchase to La Crosse Technology, Ltd or La Crosse Technology, Ltd's authorized service center.

La Crosse Technology, Ltd will repair or replace this product, at our option and at no charge as stipulated herein, with new or reconditioned parts or products if found to be defective during the limited warranty period specified above. All replaced parts and products become the property of La Crosse Technology, Ltd and must be returned to La Crosse Technology, Ltd. Replacement parts and products assume the remaining original warranty, or ninety (90) days, whichever is longer. La Crosse Technology, Ltd will pay all expenses for labor and materials for all repairs covered by this warranty. If necessary repairs are not covered by this warranty, or if a product is examined which is not in need of repair, you will be charged for the repairs or examination. The owner must pay any shipping charges incurred in getting your La Crosse Technology, Ltd product to a La Crosse Technology, Ltd authorized service center. La Crosse Technology, Ltd will pay ground return shipping charges to the owner of the product to a USA address only.

Your La Crosse Technology, Ltd warranty covers all defects in material and workmanship with the following specified exceptions: (1) damage caused by accident, unreasonable use or neglect (including the lack of reasonable and necessary maintenance); (2) damage occurring during shipment (claims must be presented to the carrier); (3) damage to, or deterioration of, any accessory or decorative surface; (4) damage resulting from failure to follow instructions contained in your owner's manual; (5) damage resulting from the performance of repairs or alterations by someone other than an authorized La Crosse Technology, Ltd authorized service center; (6) units used for other than home use (7) applications and uses that this product was not intended or (8) the products inability to receive a signal due to any source of interference.. This warranty covers only actual defects within the product itself, and does not cover the cost of installation or removal from a fixed installation, normal set-up or adjustments, claims based on misrepresentation by the seller or performance variations resulting from installation-related circumstances.

LA CROSSE TECHNOLOGY, LTD WILL NOT ASSUME LIABILITY FOR INCIDENTAL, CONSEQUENTIAL, PUNITIVE, OR OTHER SIMILAR DAMAGES ASSOCIATED WITH THE OPERATION OR MALFUNCTION OF THIS PRODUCT. THIS PRODUCT IS NOT TO BE USED FOR MEDICAL PURPOSES OR FOR PUBLIC INFORMATION. THIS PRODUCT IS NOT A TOY. KEEP OUT OF CHILDREN'S REACH.

This warranty gives you specific legal rights. You may also have other rights specific to your State. Some States do not allow the exclusion of consequential or incidental damages therefore the above exclusion of limitation may not apply to you.

For warranty work, technical support, or information contact:

La Crosse Technology, Ltd
2809 Losey Blvd. S.
La Crosse, WI 54601
Phone: 608.782.1610
Fax: 608.796.1020

e-mail:
support@lacrossetechnology.com
(warranty work)

sales@lacrossetechnology.com
(information on other products)

web:
www.lacrossetechnology.com

Questions? Instructions? Please visit:
www.lacrossetechnology.com/8318

All rights reserved. This handbook must not be reproduced in any form, even in excerpts, or duplicated or processed using electronic, mechanical or chemical procedures without written permission of the publisher.

This handbook may contain mistakes and printing errors. The information in this handbook is regularly checked and corrections made in the next issue. We accept no liability for technical mistakes or printing errors, or their consequences.
All trademarks and patents are acknowledged.