

Replace Wind Vane | Wind Cups

Replace Directional Vane

1. Gently remove the plastic cap in the top center of the vane to reveal the screw that holds the vane to the transmitter.
2. Remove the screw.
3. Gently pull the vane straight up and off the transmitter.
4. Carefully place the new vane on the transmitter; notice the groove to seat it properly.
5. Insert screw through the vane to the transmitter and tighten properly.

Note: do not over tighten.

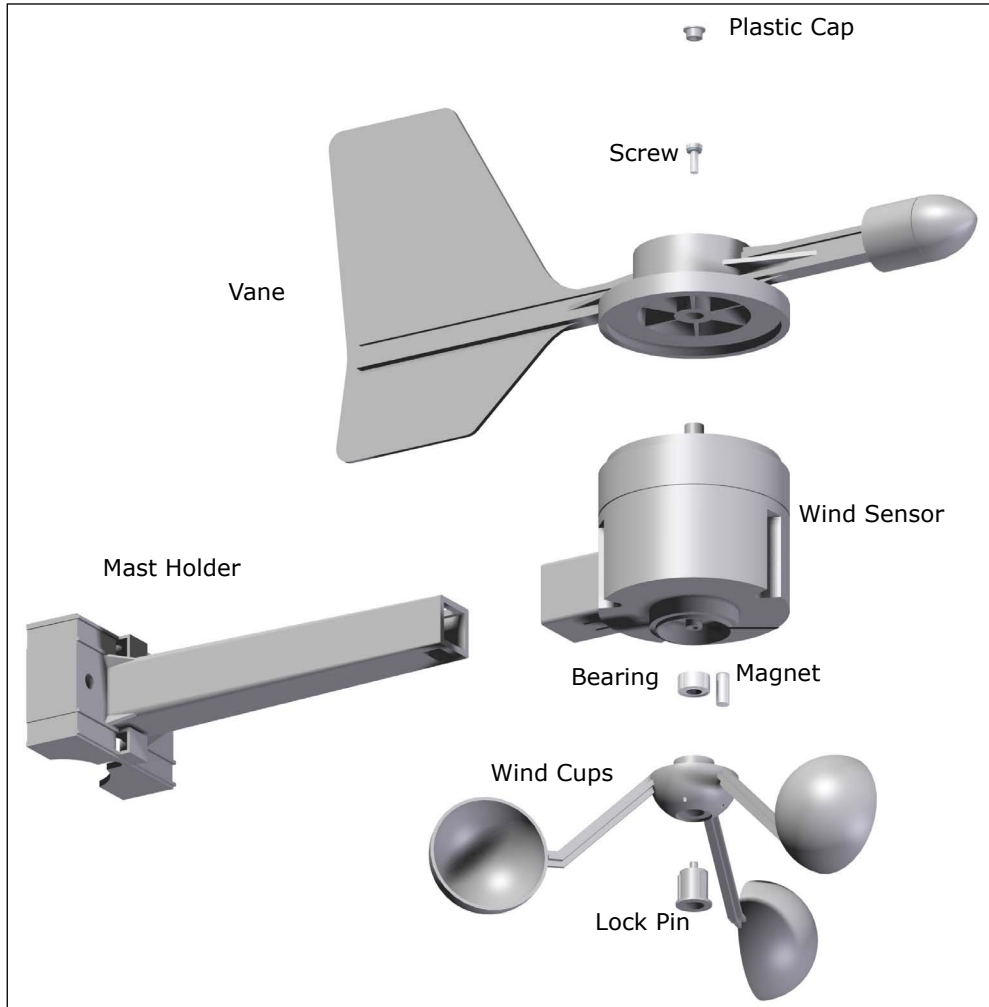

Replace Wind Cups

1. In the bottom center of the wind cups is a plastic lock pin. Gently pry the lock pin out of the wind cups.
2. Firmly grasp the wind cups and pull straight off the transmitter.
3. Check that the metal magnet is in the wind cups.
4. Check to be sure there is a metal bearing in the wind cups or on the stem of the transmitter where the cups attach.
5. Look at your new wind cups and be sure there is a bearing and magnet in place.
6. Install the cups onto the wind transmitter and press firmly.
7. Insert a new lock pin into the cups and push firmly until the lock pin is flush with the bottom of the cups.

Model: TX23WCA | TX23WV
DC: 030817