

LA CROSSE[®]
TECHNOLOGY

ATOMIC DIGITAL WALL CLOCK

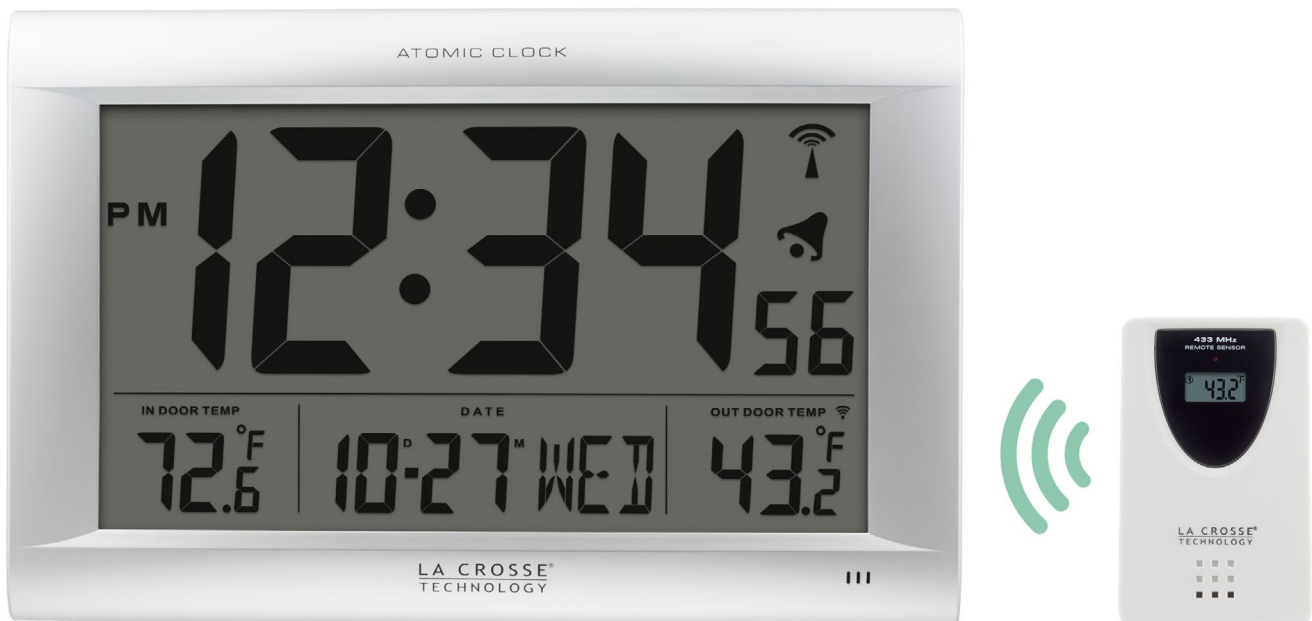

Model: 513-1311OTN
DC: 102618

POWER UP

1. Insert 2 new “AAA” batteries into the outdoor sensor. Observe correct polarity. The red LED will flash when transmitting.
2. Insert 3 new “C” batteries (not included) into the clock. Observe the correct polarity.
- 3 After 5 minutes place sensor outside in a shaded location.

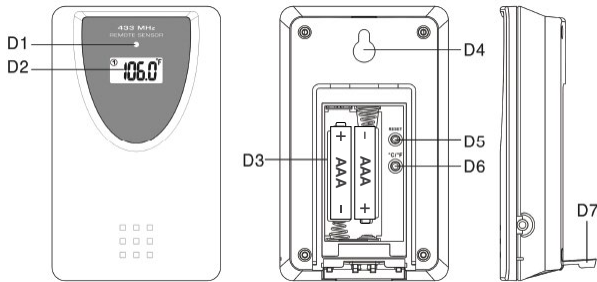

D1: Transmission Indication LED
D2: Outdoor Temperature
D3: Battery Compartment
D4: Wall Mount Hole
D5: “RESET” button
D6: °C/°F button
D7: Stand

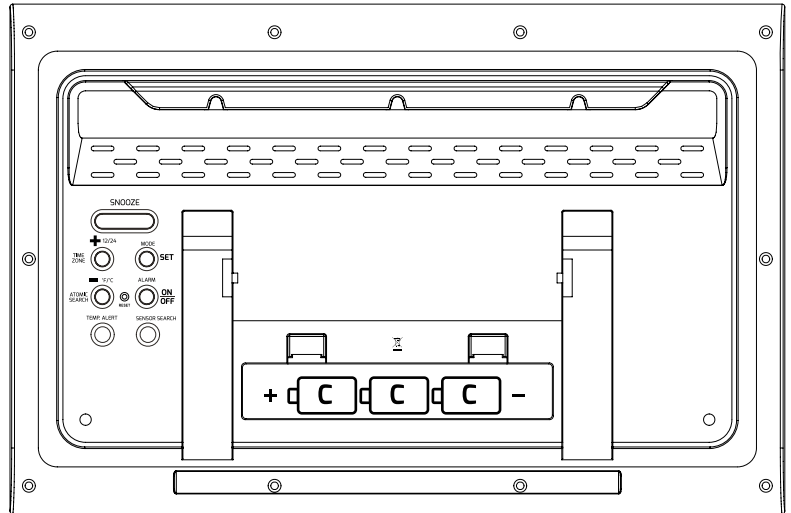

WWVB ATOMIC TIME

IMPORTANT: When the clock is searching for the WWVB Atomic Time signal, the buttons will not work. To use the buttons simply hold the - °C/°F button to stop the clock from searching. Buttons will now work.

- Hold the - °C/°F button to start or stop a manual search for the WWVB Atomic Time signal.
- WWVB Tower Icon will flash when searching.
- For information about WWVB Atomic Time visit: <http://bit.ly/AtomicTime>

SETTINGS

- Hold the MODE/SET button to enter the setting mode.
- Press the + or – buttons to adjust a value.
- Press the MODE/SET button to confirm adjustment and move to the next item.

Setting order:

1. Hour
2. Minutes
3. Seconds
4. Year
5. Month/Date format (M/D or D/M)
6. Month
7. Date
8. DST indicator

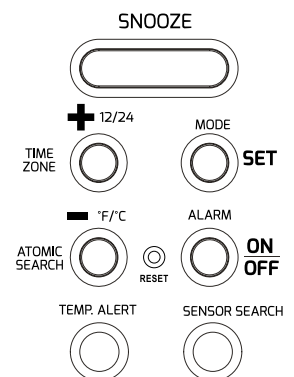

Note: Weekday will set automatically when Year, Month and Date are set.

Note: The clock will default back to time display if no buttons are pressed for 30 seconds.

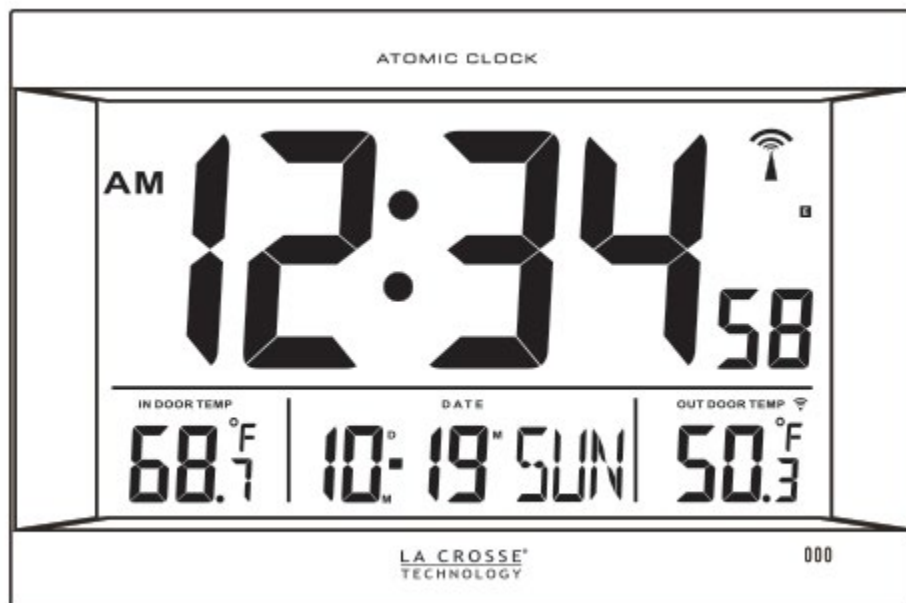

12/24 HOUR & TIME ZONE SELECTION

- Press the + 12/24 button to select 12 hour or 24 hour time format. Default is 12 hour time.
- Hold the +12/24 button to select the time zone.
- Time zones:

- P** Pacific
- M** Mountain
- C** Central
- E** Eastern

FAHRENHEIT | CELSIUS TEMPERATURE DISPLAY

- Press the - °C/°F button to change the temperature display from Fahrenheit to Celsius.

TIME ALARM

1. Press the MODE/SET button to view alarm time. The letters AL will replace the seconds.
2. Hold the MODE/SET button and the Hour will flash.
3. Use the + or - buttons to adjust the hour.
4. Press the MODE/SET button to confirm and move to the minutes. Minutes will flash.
5. Use the + or - buttons to adjust the minutes. Press the MODE/SET button to confirm and exit.

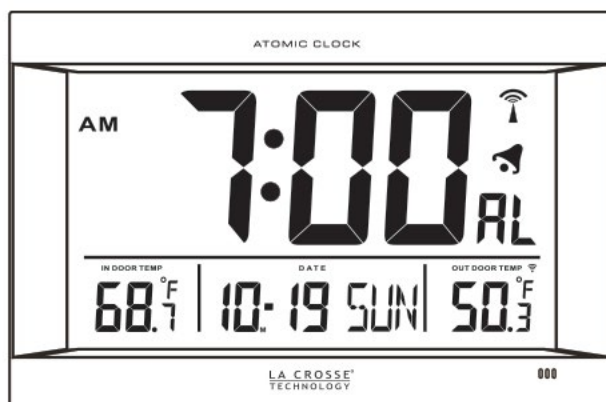

DEACTIVATE/ACTIVATE ALARM

- Press the AL ON/OFF button to activate the alarm.
- The bell icon will appear when alarm is active.
- Press the ALARM ON/OFF button to deactivate the alarm.
- The bell icon will disappear.

SNOOZE

- When the alarm sounds, press the SNOOZE button to trigger snooze alarm for 5 minutes.
- The snooze icon Zz will flash above the time.
- The snooze function can be repeated up to seven times.

OUTDOOR TEMPERATURE ALERTS

- Hold the ALERT button for 3 seconds to enter high alert setting.
- Press the + or - button to select the high alert value.
- Press the ALERT button to enter low alert setting.
- Press the + or - button to select the low alert value.
- Press and release the ALERT button to confirm and exit.
- Press the ALERT button to turn the outdoor temperature alert OFF or ON.



OUTDOOR SENSOR SEARCH & RECEPTION

Hold the SEARCH button to search for the outdoor sensor.

Solid icon: Connected to sensor

Flashing icon: Searching for sensor

RESET BUTTON

- If your clock is not responding to buttons, use a pen or paper clip to press the RESET button one time.
- This will reset the clock to default settings.

WE'RE HERE TO HELP!

JOIN THE CONVERSATION

Ask questions, watch detailed setup videos, and provide feedback on our social media outlets!



NEED MORE HELP?

If you require additional support, call our friendly customer support representatives based out of our office in La Crosse, Wisconsin.

Phone: 1.608.782.1610

Our knowledgeable customer support team is available Monday-Friday, 8am-6pm CST.

WARRANTY INFO

La Crosse Technology, Ltd. provides a 1-year limited time warranty (from date of purchase) on this product relating to manufacturing defects in materials & workmanship.

For Full Warranty Details, Visit: www.lacrossetechnology.com/support

CARE + MAINTENANCE

- Do not mix old and new batteries.
- Do not mix Alkaline, Lithium, standard, or rechargeable batteries.
- Always purchase the correct size and grade of battery most suitable for intended use;
- Clean the battery contacts and also those of the device prior to battery installation;
- Ensure the batteries have with correct polarity (+ / -)
- Remove batteries from equipment that will not to be used for an extended period.
- Promptly remove expired batteries.

SPECIFICATIONS

Indoor Temperature Range: 32°F to 122°F (0°C to 50°C)

Outdoor Temperature Range: -4°F to 122°F (-20°C to 50°C)

Transmission Range: over 330 ft. (100 meters) in open air RF 433MHz

Power Requirements:

Clock: 3-C, IEC, LR14 batteries (not included)

KW9177T sensor: 2-AAA, IEC, LR3 batteries (not included)

Battery Life:

Clock: over 12 months with reputable batteries

KW9177T sensor: over 12 months with reputable batteries

Dimensions:

Clock: 16.14" L x 1.69" W x 10.63" H (41.0cm L x 4.3cm W x 27.0cm H)

KW9177T: 2.44"L x 0.94"W x 3.98" H (6.2cm L x 2.4cm W x 10.1cm H)

FCC STATEMENT

This equipment has been tested and found to comply with the limits for a Class B digital device, pursuant to part 15 of the FCC Rules. These limits are designed to provide reasonable protection against harmful interference in a residential installation. This equipment generates, uses and can radiate radio frequency energy and, if not installed and used in accordance with the instructions, may cause harmful interference to radio communications. However, there is no guarantee that interference will not occur in a particular installation.

If this equipment does cause harmful interference to radio or television reception, which can be determined by turning the equipment off and on, the user is encouraged to try to correct the interference by one or more of the following measures:

- Reorient or relocate the receiving antenna.
- Connect the equipment into an outlet on a circuit different from that to which the receiver is connected.
- Increase separation between equipment & receiver.
- Consult the dealer or an experienced radio/TV technician for help.

This device must not be co-located or operating in conjunction with any other antenna or transmitter.

Operation is subject to the following two conditions:

- (1) This device may not cause harmful interference, and
- (2) This device must accept any interference received, including interference that may cause undesired operation.

Caution!

The manufacturer is not responsible for any radio or TV interference caused by unauthorized changes or modifications to this equipment. Such changes or modifications could void the user authority to operate the equipment.

All rights reserved. This manual may not be reproduced in any form, even in part, or duplicated or processed using electronic, mechanical or chemical process without the written permission of the publisher.

This booklet may contain errors or misprints. The information it contains is regularly checked and corrections are included in subsequent editions. We disclaim any responsibility for any technical error or printing error, or their consequences. All trademarks and patents are recognized.

CANADA STATEMENT

This device complies with CNR Industry Canada license -exempt devices.

Operation is subject to the following two conditions:

- (1) This device may not cause interference; and
- (2) This device must accept any interference, including interference that may cause undesired operation of the device.