

ASSEMBLY INSTRUCTIONS

Jewelry & Candy Dish



What's included:



Handle



Screw



Foam Washers



Metal Washer

- All hardware is included with your piece along with extra foam washers, just in case!
- Silicone bumpers may also be included. Apply as needed to the bottom of your piece for extra stability.
- Screwdriver not included.

THANK YOU FOR YOUR PURCHASE

Tag us in your pics!

@thebrooklynteacup | hello@thebrooklynteacup



ASSEMBLY INSTRUCTIONS

Jewelry & Candy Dish



1. Add metal washer plus a foam washer to screw
2. Insert through saucer or small plate.
3. Add foam washer followed by the decorative handle. Twist until tight.

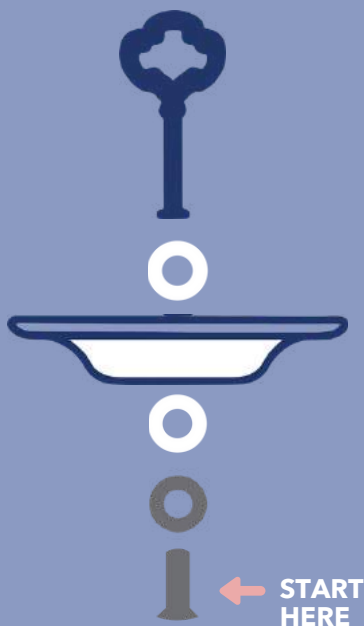

OPTIONAL: USE A SCREWDRIVER TO TIGHTEN AND SECURE FROM THE BOTTOM. APPLY SILICONE BUMPONS TO THE BOTTOM TIER.