

Halloween & Fall 2023



Cookie Decorating Collages

Hello and Happy Decorating!

This document contains a collage with the decorating steps from the Halloween and Fall Cookie Cutter release. I hope this is helpful as you decorate these cookies!

Each Collage shows a feature photo and then the step-by-step process photos. To create these collages, it requires hundreds of photos to be taken. As a result a few photos are missed. In that case a note is made on the collage page and a written instruction is provided.

I have provided a list of the icing colors used in each set's palette. Unless otherwise noted, royal icing colors are used in both a piping and flooding icing consistency. I used a tip #2 on the piping bags for outlines and details. If I used a different tip, I made a note on the collage page!

Comic Halloween Cutter Set

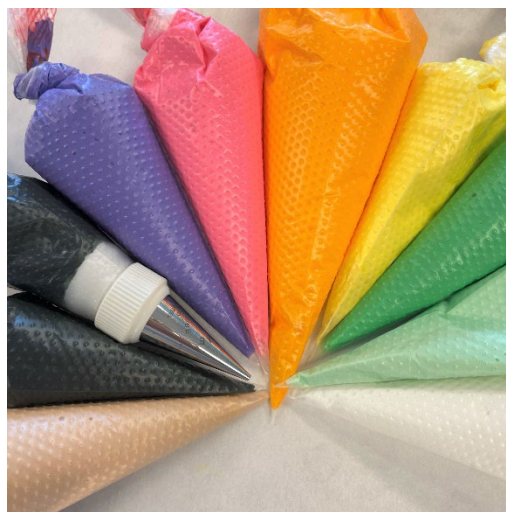

Comic Halloween Icing Colors: Cookie Countess Tuxedo Black (pipe and Flood). I also used the Sugar Art Colors for the rest of the colors and used them only in the flood icing consistency: True Brown, Violet, Hot Pink, Orange, Sunshine, and Emerald Green.

Comic Ghost

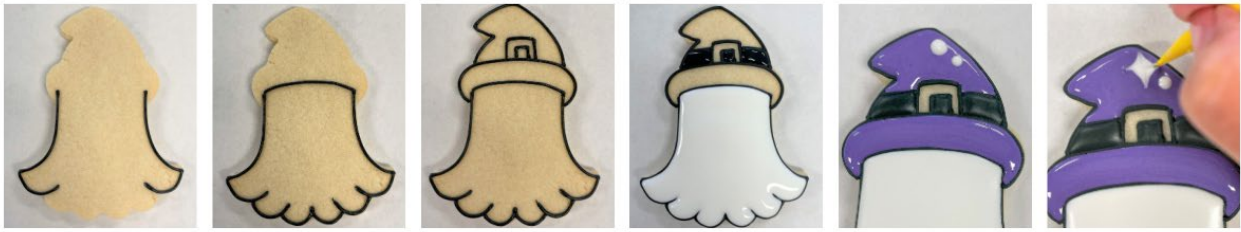

The outlines were done using tip #2, but I used PME tip #1.5 with the black to keep the details small. I used black flood to add the eyes and mouth.

Comic Pumpkin



I used the Comic Halloween Stencil to create the Jack-o-Lantern face. The outlines were done using tip #2, but I used PME tip #1.5 with the black to keep the details small.

Comic Potion Bottle



The outlines were done using tip #2, but I used PME tip #1.5 with the black to keep the details small. I used the Comic Halloween Stencil to add the skull and bones to the label.

Comic Skull



I used the Comic Halloween Stencil to create the Skull face. The outlines were done using tip #2, but I used PME tip #1.5 with the black to keep the details small.

Spooky Sweets Cutter Set



Spooky Sweets Icing Colors (Chefmaster): Black Diamond, Buckeye Brown, Purple, Leaf Green and White.

Witch Cupcake



The outlines were done using tip #2, but I used PME tip #1.5 with the to keep the details small.

Spooky Candy



The outlines were done using tip #2, but I used PME tip #1.5 for the lettering to keep it small.

Ice Cream Cone



I used tip #13 for the texture on the bottom of each scoop.

Gummy Juice Drink



Fall Coffee Date Cutter Set



Fall Coffee Date Icing Colors: I added a little black icing (tuxedo black) to white icing to make the gray shade. I used Chefmaster white, Chefmaster Buckeye Brown, Sugar Art Ivory, Cookie Countess Woodland Brown (for the darker brown coffee color), Sugar Art Pumpkin Orange, and Chefmaster Tulip Red.

Ice Latte Glass



The main section of the glass is wet-on-wet.

Campfire Mug



I mixed a dot of White gel with the Sugar Art Color Solution to flick specks onto the mug. I used a small fan brush. Wear a glove to keep your hands clean.

Frappuccino

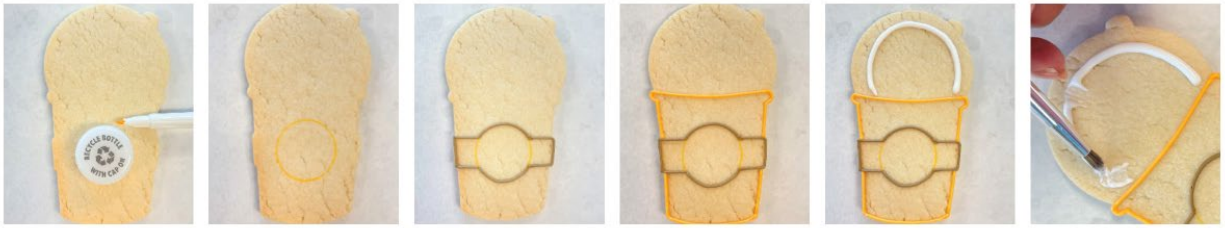

I painted the background of the dome using white flood icing to great the dimension in that section of the cookie.

Coffee Mug Top View

