

COOLER KING

WWW.COOLER.BIKE



Cooler Kub - Owners Manual

February 2024

If you're reading this, you're probably just unpacking your brand new Cooler Kub electric bike.

Lots of people don't bother with manuals, make mistakes and then contact us to ask why the thing they skipped in the manual is happening. Thank you for reading, we're glad you're not one of them xx

If you require support after reading this manual please email our expert support team at care@coolerking.co

If you feel there's something you'd like to add to your Cooler Kub, check out [these essentials](#).

Now the fun starts...

Open the box and take out your Cooler Kub carefully.
The package has following items:

BIKE	CHARGER	PEDALS	BATTERY
------	---------	--------	---------

Remove all zip ties and packing material. Be careful when it comes to the edge of the frame, tyres and rims.

Now follow steps to assemble your Cooler Kub, or skip ahead to Page 5 if you've already put it together.

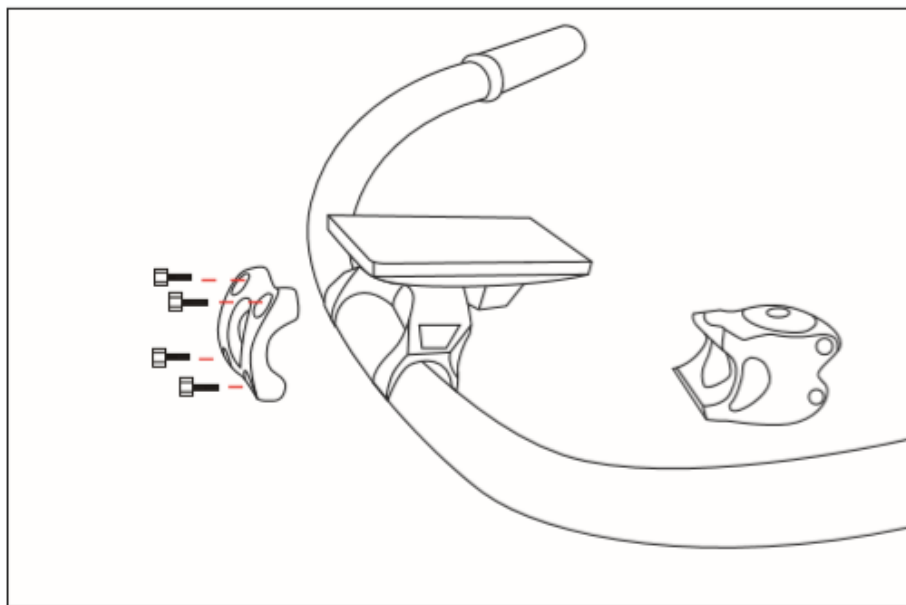

Install The Handlebars

Make sure the handlebar bracket is turned outwards, so the opening is facing frontwards if it is not already. The two screws on each side of the bracket can be loosened before and tightened after turning it.

To install the handlebars, loosen the screws to put the handlebar in between the bracket and the clasp. Add the handlebars and replace the clasp.

Adjust handlebar angle and fasten the 4 screws one by one with a 4mm Allen key to 20N.M.

Later you may wish to adjust the rake for comfort, but for now, just fit them securely. Be careful not to pitch them too low so that they hit the tank battery cover.

Install the Pedals

Use the pedal marked with an “L” on the left side and the right pedal marked with an “R” on the right side (side with drivetrain gears).

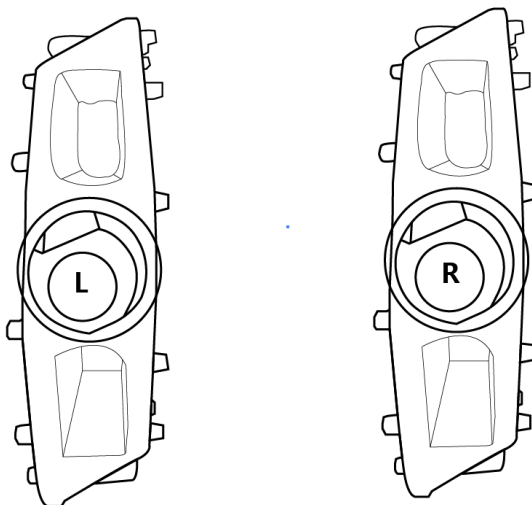

The right-side pedal has a right-hand thread (removes counterclockwise, installs clockwise); **the left side pedal has a left-hand thread (removes clockwise, installs counterclockwise).**

Be careful to not cross thread the pedals.

Tyre Pressure

Your tyres have the Max Pressure stamped on them. Keep below the Max Pressure, up to 90% is a good rule of thumb. So if your tyre says 'Max Pressure 30PSI, try 27PSI and see how it feels to ride.

Be careful when pumping your tyres that the tyre edge remains beneath the rim. You can rotate or squeeze it into place as you inflate, or keep it off the ground.

If you need a pump, [check our website](#) for something suitable.

Opening The Tank

To open the tank and get to the top battery, reach underneath and twist the turnscrew anti clockwise (or clockwise as you're looking down on it - if that helps!).

Turn the handlebars to one side, push the tank rearwards and carefully lift the front of the tank upwards to remove it.



Do the opposite to reinstall.

There is a small extension cable on the right hand side, pointing forwards if you prefer to leave the tank battery cover on and charge the upper battery in situ.



Charge Battery before Your First Ride

Switch your battery off and plug the charger lead into the battery socket.

Your intelligent battery charger has an indicator and a red light means that the battery is charging. It will turn to green when it's finished charging.

You can leave it on unattended, it won't overcharge.

The battery has LED indicator lights to show what state of charge it is in. Switch the battery on and push the button to test it.

Keys

Each battery comes with a numbered set of keys. Make sure your battery is securely locked on to the cradle before setting off, or it could fall off and damage the battery and the cradle.

Batteries and Chargers

If you require an additional or replacement battery or charger, please choose the correct one for your Cooler Kub.

[Cooler Kub 250S Chargers and Batteries](#)

[Cooler Kub 750S Chargers and Batteries](#)

Some Battery Tips

- Lithium battery capacity drops down over time.
- Samsung battery cells provide 600~800 charging cycles.
- Stay away from extreme environments. The most suitable temperature for the battery is -10°C~45°C. Do not approach heat, fire, or fierce zombies and try to prevent the battery from being dropped or getting wet. Do not insert metal into the battery. Ever.
- The battery indicator bar on the LCD display can sometimes be a bit flakey on ebikes. If you are not getting an accurate indication, try to totally run down the battery then charge it to full. The Battery Management System will reset the indicator.
- Just like a car, frequent accelerating and braking will drain your battery faster and give less range than taking it easy. You probably already knew that.
- 8 hours of non-use still consumes around 5% of battery capacity to support the battery management system. If you don't use the battery for a long time, give it longer than usual to recharge again.
- If you can, try not to not use the battery when it has less than 10% capacity left. Charge it when you can, to prolong the battery life.
- Your Cooler Kub is waterproof but don't take it swimming please. It's splash proof for sure, but it's not a diver's watch.
- If your battery hasn't charged to full after more than 12 hrs on charge, stop charging contact care@coolerking.co



The Top Secret Master Switches

At the rear of your Kub, under the seat are two electric isolator switches. One (Red) is to enable the battery that lives in the fuel tank, the other (Blue) is for the lower frame battery.

If both switches are off, there'll be no power to your bike. So, choose the correct switch for the battery you want to use and switch it to the other when you swap.

Both switches can't be on, but both can be off.

Make sure to switch it on before your ride, and off after your ride. It helps protect the battery from draining itself and turns all the lights off.

(You can also use this switch on the sly when someone asks for a ride that you don't want to lend it to. Flick the switch and tell them, "Sorry, it's out of power")

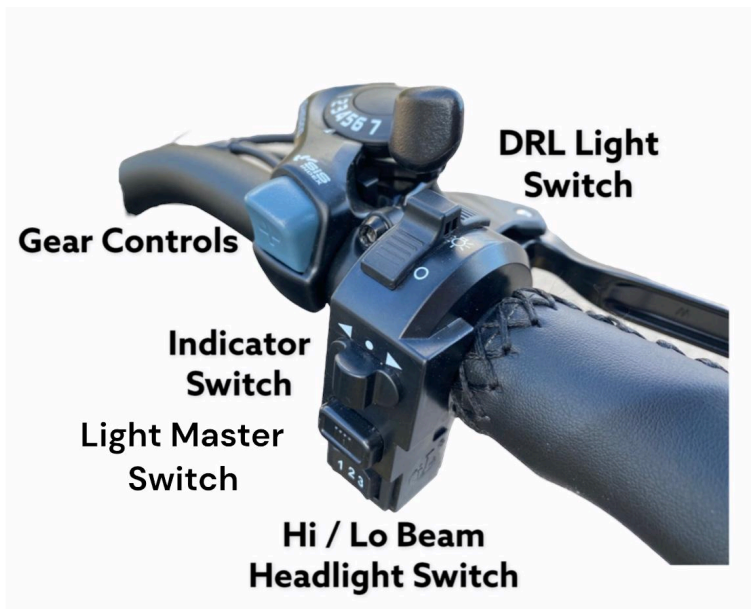

Headlight Control

On the handle bar, there are two switches for the headlight. The headlights have a three way function for the LED daytime running light, low beam and full beam. Use your Daytime Running Light (DRL) light in daytime please. It's safer and because it's LED, hardly uses any power.

Light Master Control

Headlights, DRL and Rear Lights can all be turned on and off using the large button beneath the indicator switch.

Rear Indicators

On the headlight switch panel is the switch for the rear indicators. Flick it left or right, depending where you're heading and off after you're turned.

Rear Light and Brake Light

The rear LED light is on as long as there is power coming from the battery and the Light Master Switch is on. If you hit the display ON/OFF it will change the rear light from static to flashing.

The brake light automatically flashes when the brake is applied.

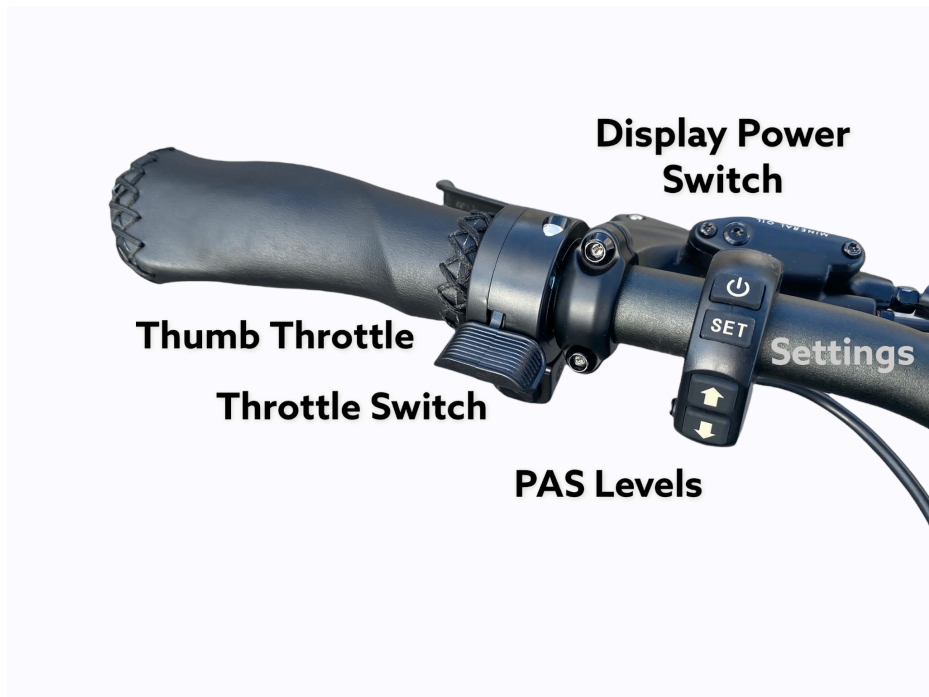

Thumb Throttle

The thumb throttle is beside the handlebar grip. Beneath the throttle itself is an On / Off switch. This disables the throttle for when you might need to. If your Kub is not reacting to the throttle, it's most likely the switch is turned off.

If your screen is powered up but there's no response from the throttle, it's most likely that the throttle switch is off.

*Some countries do not allow riding with a thumb throttle on the road, so check your local laws to see whether the thumb throttle can be used.



Display and Control Keypad

To fire up your Cooler Kub hold the power switch on the left handlebar. Repeat this action to switch it off.

Your Kub runs in three different mode settings. POW, ECO and LGL.

LGL limits your speed to 25km/h, limits the power supply to the motor to give a max power of 250w and limits the thumb throttle so that your bike is purely pedal assisted. (Your bike may be stickered already to represent this limited restricted power setting).

POW is all the power unleashed. It's full on, you don't need to hack it. (It's not road legal in some parts of the world, so please check local laws).

To switch mode between LGL to POW, stay on the Home Screen, hold the  key for three seconds and release. Repeat to access ECO or LGL again.

To switch between MPH and KM/H settings:

1. Press SET for 3 seconds to enter Settings
2. Password: 0118
3. Navigate to Units
4. Select MPH or KMH

5. Press SET to highlight the unit, then + to choose your preferred unit, SET, save and exit.

6. MENU page press: 4. Save Exit

Pedal Assist Setting

Press + or – to adjust PAS speed level.

There are 5 PAS levels by default. Each level adjusts the rate of power and violence that the motor kicks as you peddle.

For your first ride, we suggest PAS Level 1 and working up.

PAS 5 can be brutal if you're unprepared.

For more technical detail on the display, the manufacturers manual is [here](#).

Home Maintenance

You should ensure the nuts on the bike are regularly checked for tightness. Start at the front wheel and handlebars.

Servicing

Every 12 months or 1500 miles / 2500 kms have your local bike shop service the bike, checking the brakes, gears, crank and lubrication points. The electrical parts need no servicing.

Troubleshooting

If you have trouble setting off, please make sure all of the following are ready:

Battery charged, securely fastened and locked on.

Battery switched on.

Secret Isolator Switch under the seat is on.

Screen is switched on.

Thumb throttle switch is on.

If there are errors occurring, an error code will appear automatically. (We hope you won't need this bit and recommend that an experienced technician carries out any changes).

Error Code	Definition	Solution
1	Current error or MOS damaged	Replace controller
2	Throttle Abnormality	Disconnect throttle wire (located in the controller box, or in front of the handlebar if the bike has a waterproof quick release connector) to see whether the ERROR code disappears. If it disappears, replace the throttle.
3	Motor Abnormality	Re-connect motor wire (located underneath chain stay at right side). If it still doesn't work, replace the motor.
4	Motor Hall Abnormality	Turn off and on again (really!) If this doesn't work, contact Cooler King as you may have to return the rear wheel to replace a motor rotor.
5	Brake Abnormality	Disconnect 2 brake lever wires (located in front of the handlebars to see whether the ERROR code disappears. If it does, replace the brake lever and

		reconnect brake lever wire to the controller.
6	Under voltage	Fully charge the battery
7	Motor stalling	Do not block the motor from rotating freely
8	Communication controller receiving error	Disconnect all wires (brake lever, display, throttle, and motor) then reconnect. Check all connectors are in good condition.
9	Communication display receiving error	

COOLER KING

WWW.COOLER.BIKE

CK Ebikes Ltd., London

Phone UK: +44 20 3329 2981 / US +1 401 213 9900

Instagram [@cooler_king](#) [#coolerkub](#)

Support Team: care@coolerking.co

Sales Team: info@cooler.bike

WhatsApp [+1 401 213 9900](tel:+14012139900)

Parts: cooler.bike/collections/parts

Accessories: cooler.bike/collections/cooler-king-accessories