

Product Information

Product Name	Ultrasonic humidifier
Model Number	KC-MH-028
Voltage	110V/120V
Frequency	60Hz
Power	28W
Maximum Mist Output	280mL/h
Water Tank Capacity	9L
Packing Size	730x260x260mm
Noise	≤35dB(A)

KEECOON

Ultrasonic Humidifier

KC-MH-028

Instruction Manual

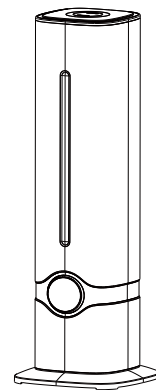

V1.0

Thank you for your purchase.
Please read the instruction manual before use.
If you have any questions about the product, please
send email to **service@keecoan.com**.

Thank you for choosing our ultrasonic humidifier. The ultrasonic humidifier uses ultrasonic waves to generate 1.7 million high-frequency oscillations per second. The water is atomized into ultra-fine particles of 1 to 5 microns, and the water mist is diffused to the air through the air moving device. Thereby achieving the purpose of evenly humidifying the air. The humidifier keeps the room at the desired humidity and prevents static electricity.

From here, feel the healthy breathing brought by the ultrasonic humidifier.

Products and accessories:

1 humidifier, 2 user manual, 3 remote control, 4 cleaning brush (gift)

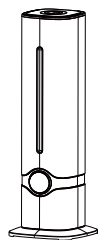

1



2



3



4

Please check carefully whether the contents of the package are complete. If there is any missing or damaged, please promptly give feedback to the salesperson for more after-sales questions.

1

Components

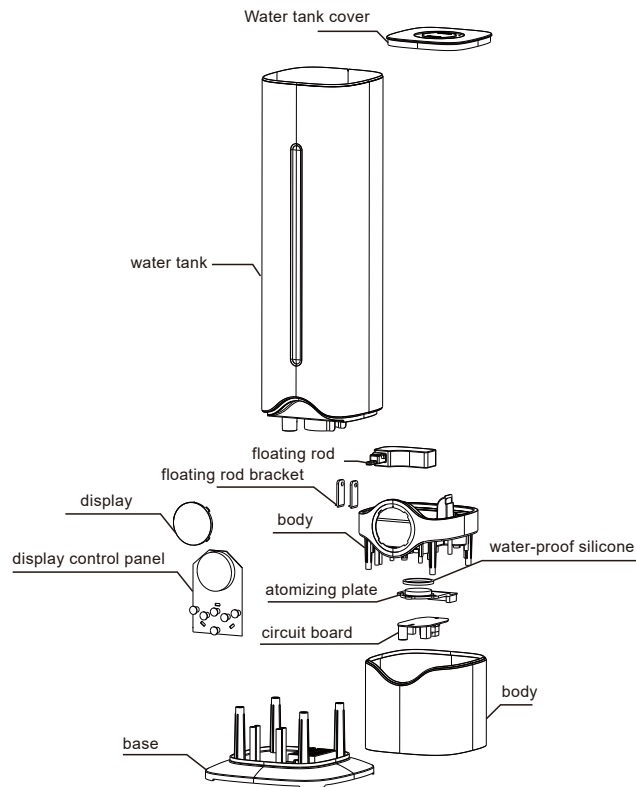

2

Control Panel



POWER

After turning on the power, touch to turn on the screen, and touch again to turn it off.



MAX-MIN

The product is divided into low/medium/high mist volume and the mist volume can be adjusted. Touch the mist button each time for cycle adjustment.



CONSTANT HUMIDITY

Touch the button for the first time to enter into the constant humidity function. The default humidity is 40%; touch this button again to adjust the presethumidity, the maximum is 90%. When adjusting, the screen shows the setting humidity, touch again to turn off the constant humidity function. (humidity value is 5% increment)



TIMER

This product has the appointment timer shutdown function. Touch this button to set the shutdown time. Each time to touch the button, the screen will display the setting time. The product can continue to work for 12 hours and then automatically shut down. The automatic shutdown time is set in units of one hour, and the user can select settings from thirteen levels.



ANION

Touch the anion button to turn on and touch again to turn off.



SLEEP

Touch the sleep button to turn off the screen. Touch again to light up the screen.

Instructions



1. Take out the sponge inside the base.



5. Can be operated with the remote control.



2. Uncover the water tank cover and add water.



6. If you need to clean the water tank, add water and brush the inner wall of the water tank. If there is more scale, you can drip in the slight amount of white vinegar. Shake the water tank, then pour off the water and let it dry.



3. After plugging in, touch the power button to turn it on.



4. Remove the plastic sheet at the bottom before using the remote control.

Contents



water tank, water tank cover, base, user manual (including remote control), cleaning brush

Wrong way X



Don't add water from the mist outlet!



Please scan QR code for more operation details.

▲ **WARNING:** Before cleaning the water tank and the base, be sure to turn off the power and unplug the power cord from the socket to prevent electric leakage or fire. For more operation details, please kindly check the website at <https://youtu.be/42Hlu2qpV8E>

Safety guide

Please read this user manual carefully before using the product and keep it for future reference.

Danger

- Do not allow liquids such as water or (flammable) detergent to enter the bottom part area of the product to avoid electric shock or fire.
- Do not immerse the product in water or any other liquid or (flammable) detergent to avoid electric shock or fire.

Caution

- Before connecting the product to the power supply, first confirm whether the voltage labeled on the product matches with the local voltage.
- Please keep away from heat sources, avoid direct sunlight, and leave other electrical products more than 2 meters to avoid moisture.
- This product is not designed for use by persons (including children) who are physically impaired, have sensory or mental disabilities, or lack relevant experience and knowledge, unless they are supervised or instructed by the person responsible for their safety.
- Children should be taken care of to ensure that they do not play with this product.
- Do not block the air inlet and outlet.

Note

- The product should be placed at room temperature for 30 minutes before use.
- Please use clean water with a temperature below 40 degrees.
- If the power socket connecting the product is not in good contact, the plug of the product may get hot. Make sure the socket you are connecting is in good contact.
- Always place and use this product on a dry, firm, flat surface.
- Do not place the product directly under the air conditioner to prevent condensation from dripping onto the product.
- Do not place books or other wet-proof objects in the outlet of the product or under the product.
- Please use the product at normal room temperature (temperature 5 °C ~ 40 °C, relative temperature <80% RH).
- Before turning on the product, make sure the water tank is properly installed and add water as required.
- Do not hit the product with a hard object.
- Do not insert your fingers or other objects into the air inlet and outlet.
- Do not use this product near gas appliances, heating devices or stoves.
- Always unplug the power cord after use and before cleaning the product.
- Do not use this product in a humid or hot environment such as a bathroom, toilet or kitchen.

Important

- Unplug when filling and cleaning;
- If the power cord is damaged, it must be replaced by the manufacturer or professional service personnel in order to avoid danger. It must not be replaced by yourself.

Routine maintenance

In some places, the tap water is "hard" (the content of calcium and magnesium ions is high) and some areas use water purifying agents such as bleaching powder. Therefore, when using humidifier, a part of calcium and magnesium ions are sprayed together with the water mist, spreading on the surface of the object and on the ground. After drying, it forms a water-alkali like white powder. Due to the impure water, a part of the precipitate forms scale on the transducer and the surface of base, which affects the humidification effect of the humidifier.

1. Keep the humidifier clean.

- Humidify with pure water;
- Clean the transducer, water tank and base every week;
- Replace the old water in the water tank frequently to keep the humidifier clean;
- When the humidifier is not used for a long time, do not store water in the water tank and base;
- When collecting, please wash and dry the parts and store them.

2. Method of cleaning the transducer and the base.

- Before cleaning, please turn off the power and unplug the power socket;
- Pour the detergent into the machine base, then add warm water of about 60° to dissolve completely, soaking for 5-10 minutes;
- Then brush the surface of the transducer with a cleaning brush until the scale is removed;
- Clean the base at the same time, rinse the base and the surface of the transducer with clean water.

Common problems

Abnormal phenomenon	Cause analysis	Solution
Product water shortage alarm in case of water inside the water tank	Whether the water shortage protection float is installed and works normally without jamming	Install the water shortage protection float in place
Suddenly stop working during product use	Room humidity has reached the set humidity	If you need to continue humidifying, please turn off the constant humidity function or adjust the temperature setting
	Product failure	Contact after-sales service center
Small humidification mist	Long-term use of water containing more calcium and magnesium ions, resulting in excessive scale	Follow the instructions to clean the product and transducer
	The product uses the low mist level	Adjust the mist and choose the high-level mist
Water leakage around the mist outlet or around the water tank and the base	The mist nozzle is not placed properly. The water tank and the base are not placed properly.	Place the mist nozzle or water tank properly

Remarks: If the fault of the product is not listed in the above table or the fault can not solved by the above methods, please contact the after-sales service center. It is strictly forbidden for non-professionals to disassemble the product.

Q&A

Q: The product can't be started, always accompanied by a humming sound and displaying the words of "88"?

A: 1) Check the base first, need to take out the sponge inside the base before use.

2) Check if the base and the water tank have enough water. If there is water shortage, please add water.

Q: After the sponge is removed from base, it can be used for a period of time. After about 15-20 minutes, the screen displays "88" and then there is a humming sound again.

A: 1) Because the long-distance transportation causes the spring in the water tank to shift and cannot rebound, the water in the water tank cannot flow into the base, thus causing the water shortage of the base.

2) Reverse the water tank, rinse spring with water and press it several times to reset.

Q: After the humidifier has been used for a while, the water leaks slowly from the joint between the water tank and the base. What should I do?

A: 1) Due to the long-distance transportation, the spring in the water tank is loosened and displaced, so that the silicone gasket cannot be completely closed. Therefore, the water in the water tank is continuously drained into the base, and this slow leakage occurs.

2) Reverse the water tank, rinse spring with water and press it several times to reset.



Q&A

Q: How to clean the water tank and the base?

- A: 1) The product does not need to be cleaned frequently, because the ABS antibacterial material is used. If the product is not used for a long time, pour off the water in the water tank and the base and let it dry.
- 2) If there is scale inside the water tank, it is recommended to clean the water tank with white vinegar. Drip a certain proportion of white vinegar and clean water, shake the water tank, it can be cleaned and sterilized.
- 3) The atomized sheet in the base also can be cleaned with white vinegar and water.

Q: After using for a period of time at same level, the mist volume is getting smaller?

- A: The product is based on the principle of ultrasonic atomization. Due to the water quality and other reasons (in some areas, the water quality is "hard"), after using for a period of time, there will be scale on the atomized sheet, which will lead to the abnormal humidification. The product can continue to be used as long as the scale on the surface of the atomized sheet is wiped off (if not, drop slight amount of white vinegar).

Q: When the weather is cold, the humidification becomes longer, or the mist volume becomes smaller?

- A: 1) If the temperature in your area is low in winter, there may be a case that the humidification becomes longer or the mist volume becomes smaller. Because the temperature is too low, the mist will condense in the process of rising through mist tube. This is a normal phenomenon, not a product failure.
- 2) When the temperature is low, the water temperature is also low. In this case, you can add some warm water to make the product humidify normally.

Q: The remote control cannot be used normally?

- A: Please check whether the plastic sheet at the bottom of remote control is removed or not. After the removal, the remote control can be used normally.

Q: Can the direction of mist outlet be adjusted?

- A: It is not possible for the time being. We will continue to improve this feature in the future for better use.

Warranty Policy

Warranty period

- The humidifier shall have a non-human damage performance failure within 30 days from the date of receipt by the user, and may choose to return, exchange or repair;
- Man-made damage, damaged packaging, missing spare parts, and used products are not included in the 30-day free return. Therefore, the round-trip freight shall be borne by the user;
- Within 1 year from the date of signing in, if there is any non-human damage performance failure, users can enjoy the free replacement service. The round-trip freight shall be borne by the seller.

Non-warranty policy

The following conditions are not covered by the warranty and require the user to pay for repairs.

- The warranty period has expired;
- Damage caused by human causes;
- Damage caused by force majeure factors;
- Any damage caused by use, maintenance, and adjustment not in accordance with the requirements of the User Manual;
- Failure or damage caused by forced use of this product beyond normal use conditions;
- The user disassembles or repairs the product without authorization.