

Package Includes

- (1) SiriusXM™ PowerConnect™ Vehicle Cradle
- (1) SiriusXM™ 5 Volt Hardwired Power Adapter
- (1) Handlebar Clamp Mount
- (1) RAM Ball Mount Adapter (25 MM)
- (1) Weatherproof Protective Case
- (1) SiriusXM™ Antenna
- (1) Auxiliary Cable
- (1) L-Bracket with AMPS Plate & Lock Ring
- (1) AMPS Plate (Male Dual Notch) with Screws

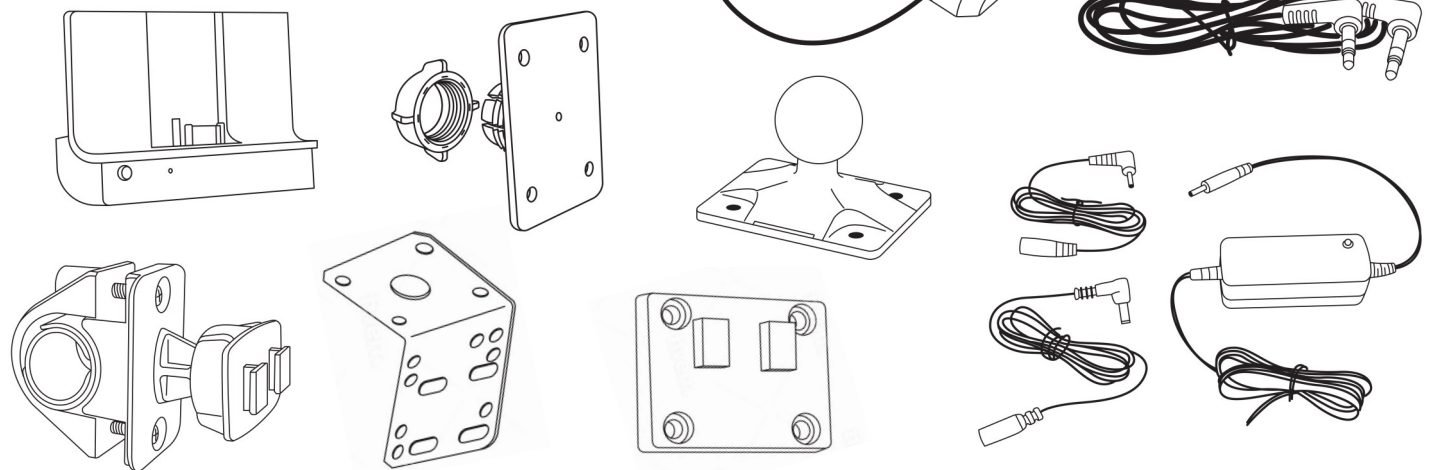

Step 1 - Install Clamp Mount

Before getting started, it is important to select an installation location for the protective case with receiver. After selecting the installation location for the protective case, loosen the two screws on the handlebar clamp mount all the way out and separate it from the back side of the clamp mount. Place the clamp mount on the handlebars, line up the screw holes and tighten the screws to mount the clamp. Use the supplied rubber strips to increase the grip of the mount.

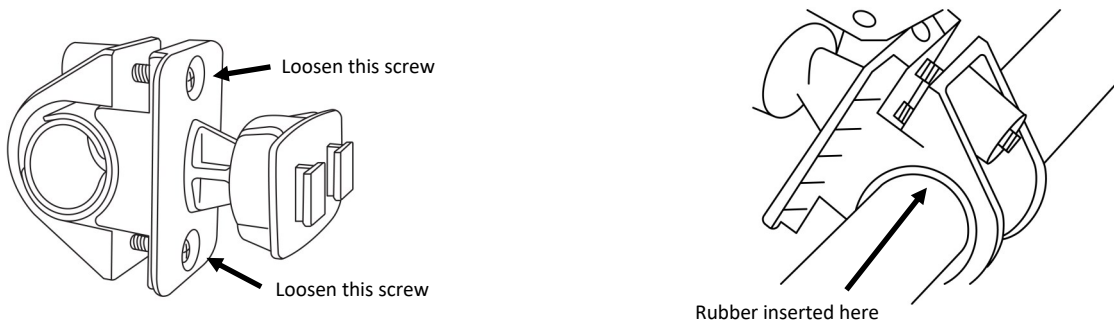

BACK PLATE ASSEMBLY

Locate the bag containing the parts shown below.

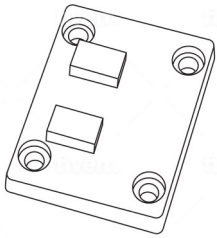

Dual Male AMPS Plate

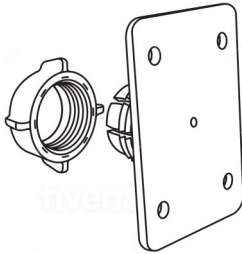

AMPS Socket Plate with Lock Ring

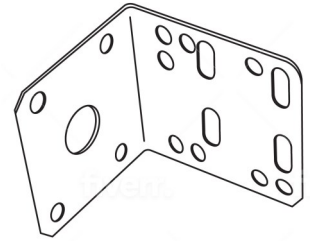

Metal L-bracket

Step 2 - Place the parts as pictured below. Take the AMPS Socket Plate and place it on one side of the L-bracket. Next place the Dual Male AMPS Plate on the opposite side as the AMPS Socket Plate and line up the screw holes. Please note the positioning of the Dual Male AMPS Plate with the notches at the bottom. The dual notches must be positioned at the bottom in order to properly seat into the back of the case. Use the supplied screws and nuts to secure the plates to the L-bracket. The mount can be assembled with the top plate of the L-bracket facing forward or backwards to fit your installation needs. Next, slide the L-bracket assembly onto the back of the protective case. The case should slide down over the dual notches.

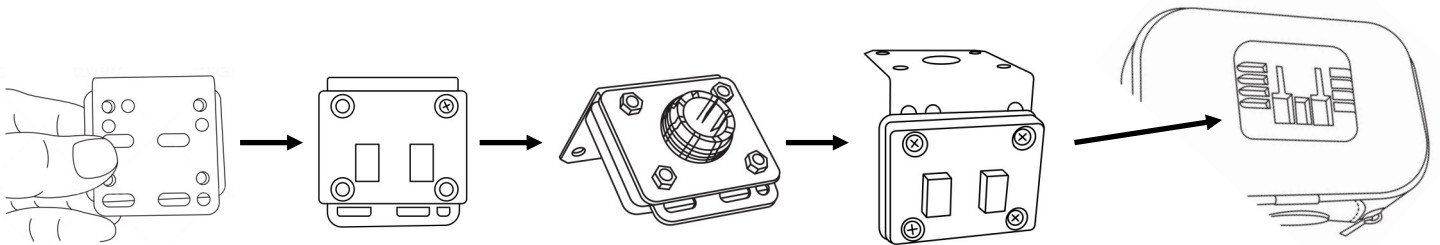

Optional - RAM Mount Assembly

To install the kit onto a RAM mount, use the RAM Mount Adapter Plate located in the supplied parts bag. Screw the RAM Mount Adapter Plate to the L-bracket with the Dual Male AMPS Plate on one side and the RAM Mount Adapter Plate on the other side. The mount can be assembled with the top plate of the L-bracket facing forward or backwards to fit your installation needs. Next, slide the L-bracket assembly onto the back of the protective case. The case should slide down over the dual notches.

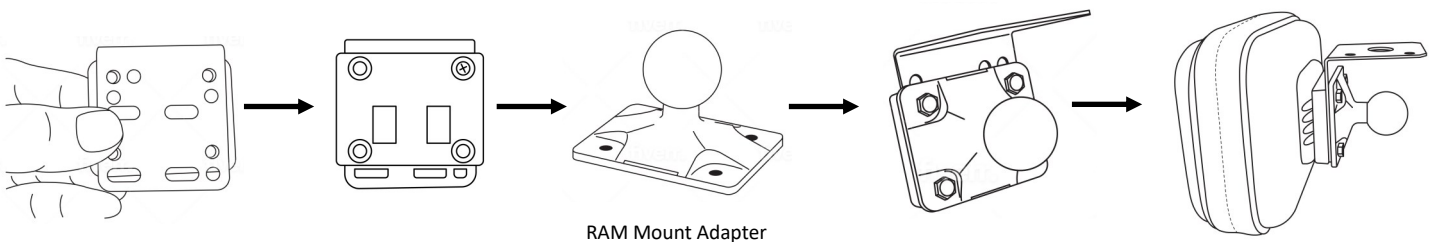

RAM Mount Adapter

Step 3 - Connect Mount to Back Plate and Mount Antenna

To connect the handlebar or strap mount to the back plate, insert the ball joint into the AMPS Female Socket Plate with the Lock Ring having the wide end facing towards the socket plate. Push the mount into the socket until it clicks. Once the ball joint is firmly in place, screw the Lock Ring clockwise until it tightens all the way. To change the angle of the case, loosen the ring and pivot the case then retighten the Lock Ring to secure. Do not over tighten the Lock Ring to avoid damaging it. Next, place the antenna on the metal L-bracket and run the antenna wire through the bottom of the case connecting it to the antenna port on the dock.

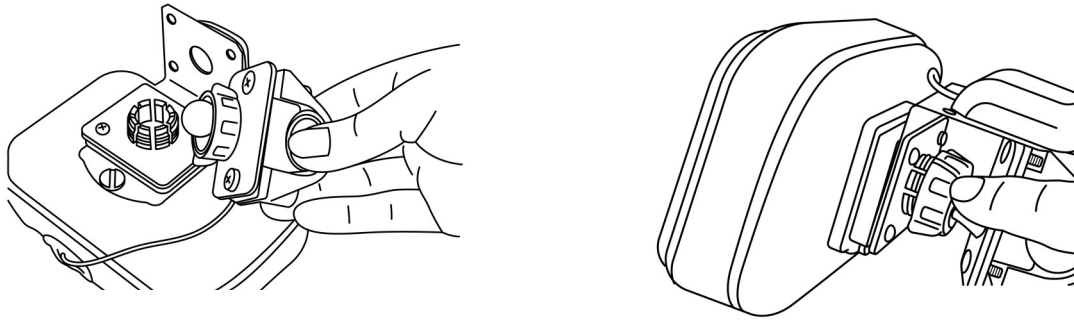

Step 4 - Connect Power

Included in the package is a hardwired power adapter. Find a power source on the motorcycle, either in a fuse box or an auxiliary power source on the motorcycle. The hardwired power adapter comes with two interchangeable cables, one older Sirius and XM receivers and one for newer SiriusXM™ PowerConnect™ receivers. For installations with an older 5 volt Sirius or XM receiver (non PowerConnect™), use the cable with the smaller connector tip. For installations using the supplied PowerConnect™ docking cradle, you will use the cable with the larger tip.

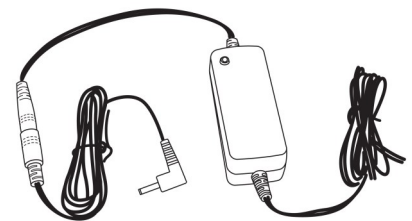
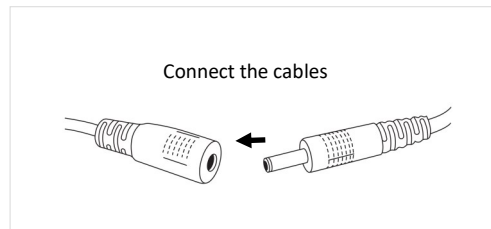
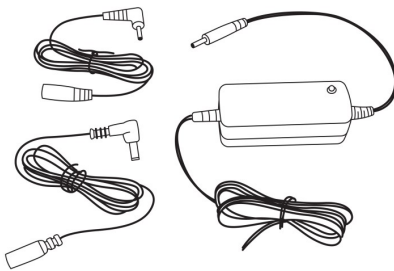

Adapter fully assembled

Step 4 - Connect Audio

Included in the kit is an auxiliary cable for audio. Connect the auxiliary cable to the aux input on the motorcycle sound system, headset or other audio system. Run the auxiliary cable to the location of the mount and leave the cable loose.

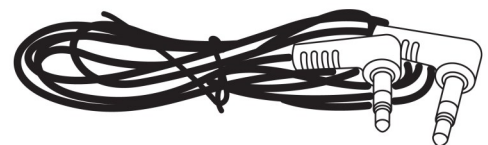

If you are installing a Bluetooth dock, FMDA25, or using wireless FM transmission, refer to that products user guide for installation.

Step 6 - Connecting Docking Cradle

After all cables have been run to the protective case, feed the wires up through the bottom of the case shown in the image on the right. Pull enough cable through to allow for extra play in the wire in case a cable is pulled. If there is extra antenna wire, it is recommended to wrap up the excess antenna wire inside the protective case.

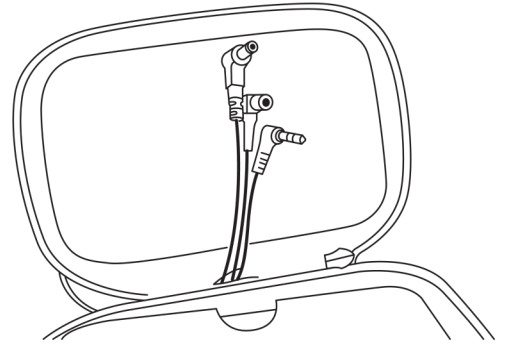

Next, connect each cable to the corresponding port on the dock. (Some docks may have the connections on the sides and not the back as shown in the figure to the right)

Note: If installing a Bluetooth SiriusXM™ Dock, only power and antenna are required. The FM port on the dock is not used unless installing the FMDA25 Direct Wire Audio Adapter.

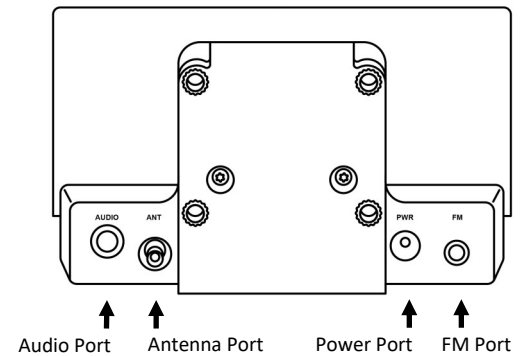

After all connections have been made, slide the receiver down onto the dock and power on the unit. If installing a new SiriusXM™ receiver, follow the instructions on how to activate the receiver provided in the receivers user guide.

To learn more on how to operate your specific receiver refer to the SiriusXM Radio user manual that came with the receiver.