

**Package Includes**

- (1) SiriusXM™ Rody BT Display Controller
- (1) Intelligent Power Adapter
- (1) Display Cable
- (1) Handlebar Clamp Mount
- (1) RAM Ball Mount Adapter (25 MM)
- (1) Weatherproof Protective Case
- (1) SiriusXM™ Antenna
- (1) Auxiliary Cable
- (1) L-Bracket with AMPS Plate & Lock Ring
- (1) AMPS Plate (Male Dual Notch) with Screws

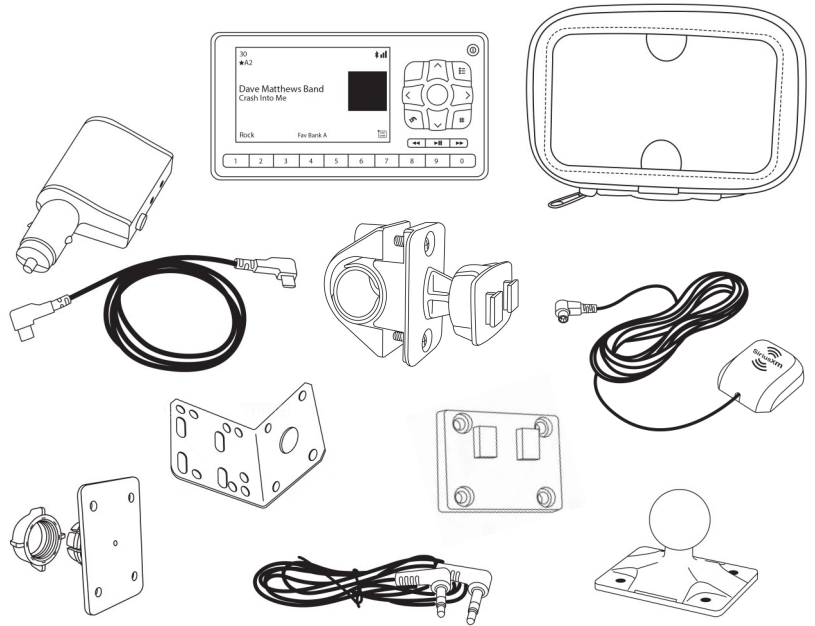

**Step 1 - Install Clamp Mount**

Before getting started, it is important to select an installation location for the protective case with receiver. After selecting the installation location for the protective case, loosen the two screws on the handlebar clamp mount all the way out and separate it from the back side of the clamp mount. Place the clamp mount on the handlebars, line up the screw holes and tighten the screws to mount the clamp. Use the supplied rubber strips to increase the grip of the mount.

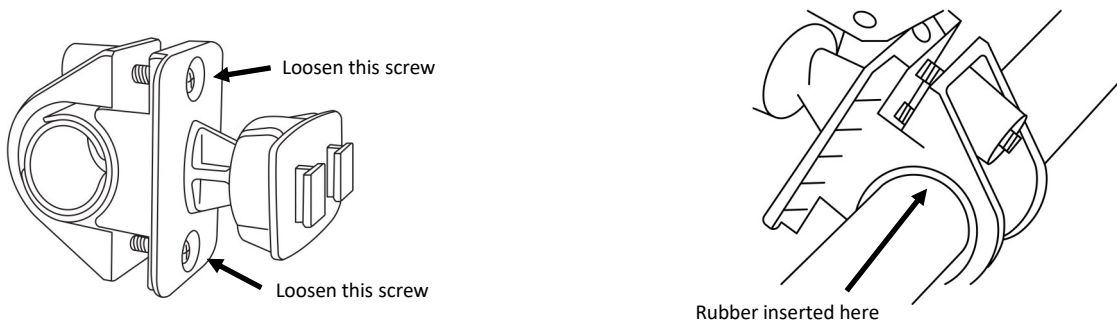

**BACK PLATE ASSEMBLY**

Locate the bag containing the parts shown below.

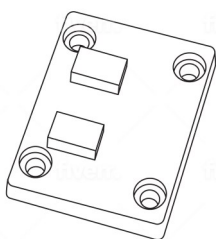

Dual Male AMPS Plate

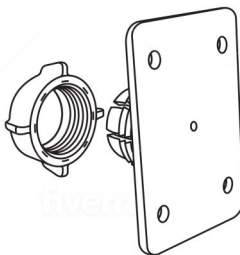

AMPS Socket Plate with Lock Ring

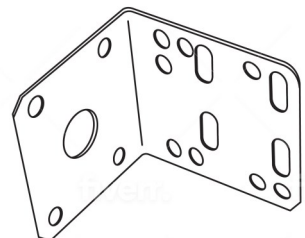

Metal L-bracket

Place the parts as pictured below. Take the AMPS Socket Plate and place it on one side of the L-bracket. Next, place the Dual Male AMPS Plate on the opposite side as the AMPS Socket Plate and line up the screw holes. Please note the positioning of the Dual Male AMPS Plate with the notches at the bottom. The dual notches must be positioned at the bottom in order to properly seat into the back of the case. Use the supplied screws and nuts to secure the plates to the L-bracket. The mount can be assembled with the top plate of the L-bracket facing forward or backwards to fit your installation needs. Next, slide the L-bracket assembly onto the back of the protective case. The case should slide down over the dual notches.

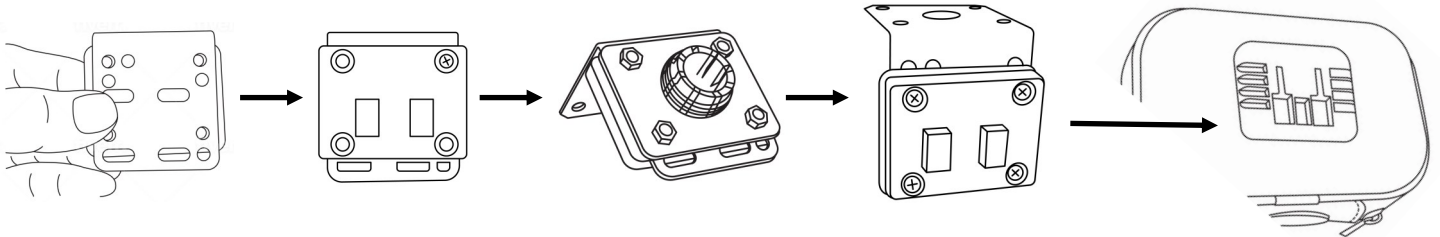

### Optional - RAM Mount Assembly

To install the kit onto a RAM mount, use the RAM Mount Adapter Plate located in the supplied parts bag. Screw the RAM Mount Adapter Plate to the L-bracket with the Dual Male AMPS Plate on one side and the RAM Mount Adapter Plate on the other side. The mount can be assembled with the top plate of the L-bracket facing forward or backwards to fit your installation needs. Next, slide the L-bracket assembly onto the back of the protective case. The case should slide down over the dual notches.

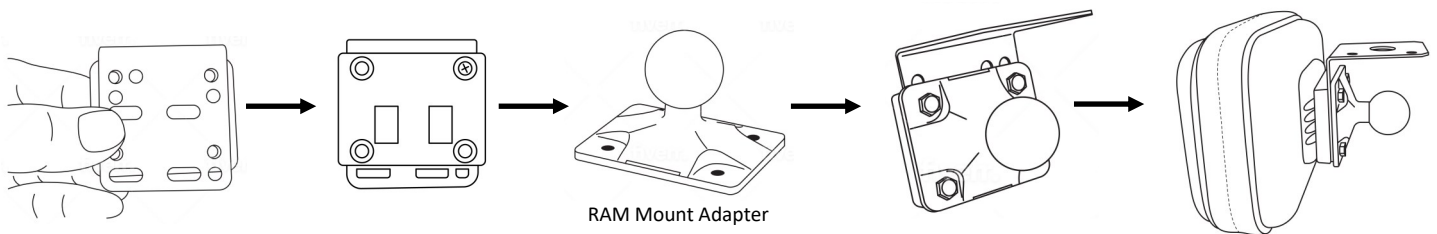

### Step 2 - Connect Mount to Back Plate and Mount Antenna

To connect the handlebar or strap mount to the back plate, insert the ball joint into the AMPS Female Socket Plate with the Lock Ring having the wide end facing towards the socket plate. Push the mount into the socket until it clicks. Once the ball joint is firmly in place, screw the Lock Ring clockwise until it tightens all the way. To change the angle of the case, loosen the ring and pivot the case, then retighten the Lock Ring to secure. Do not over tighten the Lock Ring to avoid damaging it. Next, place the antenna on the metal L-bracket and run the antenna wire through the bottom of the case connecting it to the antenna port on the dock.

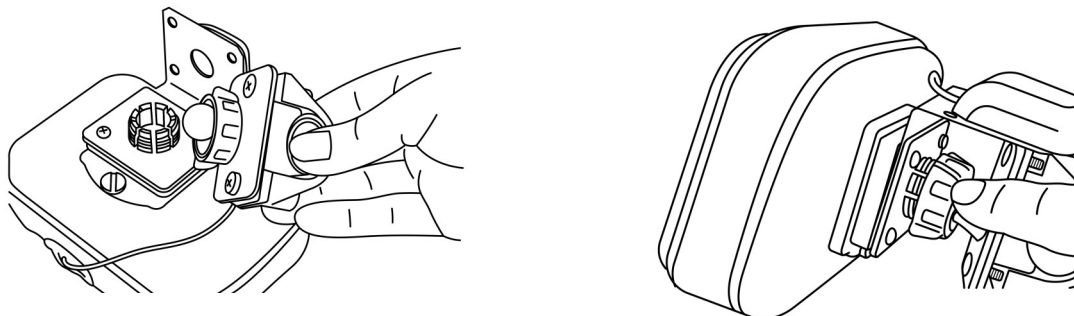

## Roady BT Intelligent Power Adapter

Unlike SiriusXM Dock and Play receivers, the tuner for the Roady BT is built into the Intelligent Power Adapter (cigarette lighter power adapter). This means you will need to bring the display controller **and** power adapter with you when moving the unit from motorcycle to car or other location. The power adapter also has all the connections that would normally be on a docking cradle for older Sirius, XM and SiriusXM receivers. This means that you will need to route all cables to the power adapter except the display controller cable. This will be the only cable that will route to the protective case. The next set of instructions are provided as a basic reference for installing the Roady BT with the motorcycle kit parts. Refer to the Roady BT user guide for more detailed instructions on how to install and operate the Roady BT.

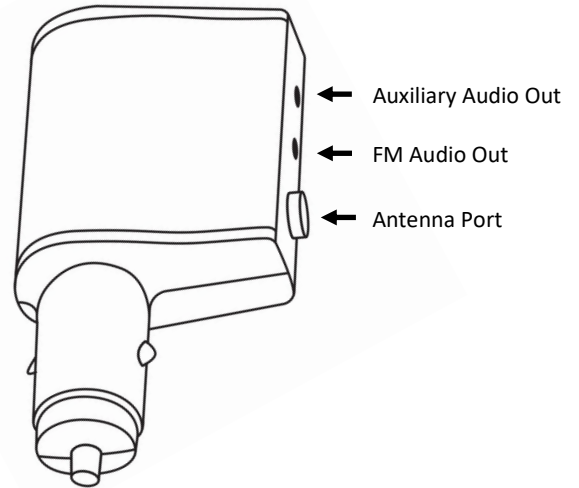

## Connecting to the Intelligent Power Adapter

### Step 1 - Connect Antenna Cable

In previous steps, we installed the magnetic antenna to the L-bracket. Run the antenna cable from the L-bracket to the location of the power adapter and plug the antenna cable into the antenna port on the power adapter. Be sure to leave some slack in the line after routing the cable from the case to the power adapter.

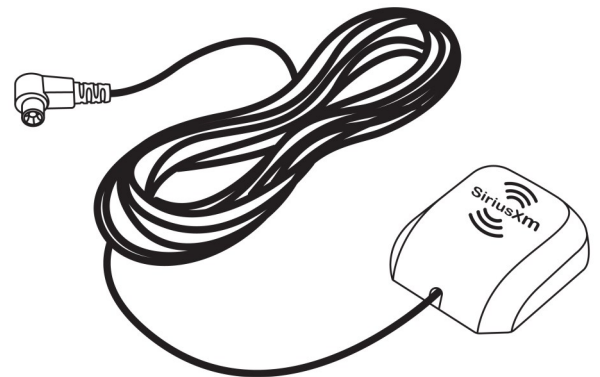

### Step 2 - Audio Connection

The Roady BT has several different audio options including Bluetooth®, Auxiliary, FM transmission and direct FM relay via the FMDA25. Each option requires a different setup. Refer to the Roady BT user guide for detailed installation instructions on connecting audio. If you are connecting via Bluetooth® or FM transmission, you will start the process once the system is powered on. If you are connecting via AUX or an FMDA25, you will make your connections to the power adapter before plugging in the adapter.

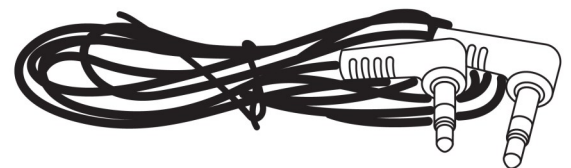

### Step 3 - Connect Display Controller

Included in the package is a micro USB to micro USB cable that powers the display controller. Run that cable from the power adapter to the protective case. Feed the wire up through the bottom of the case as shown in the figure to the right. The case has several different sized spacers. Use the spacer that best mounts the display controller inside the case.

**Note:** Using all spacers will give you the best results when pressing buttons. The spacers will push the controller to the front of the case, making it easier to press the buttons on the controller.

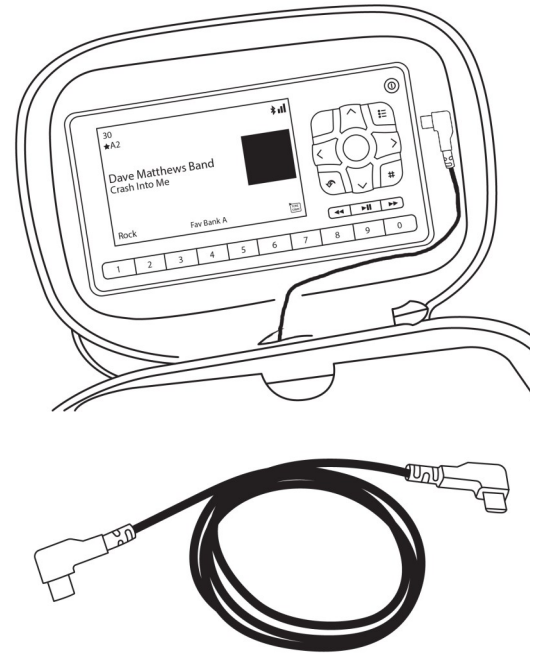

### Fully Assembled

When fully assembled, the unit should look like the images below.

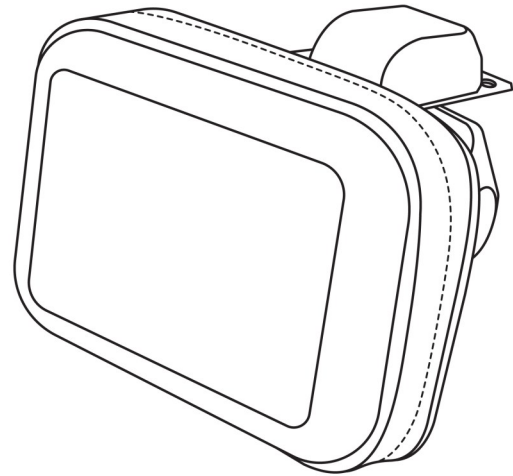
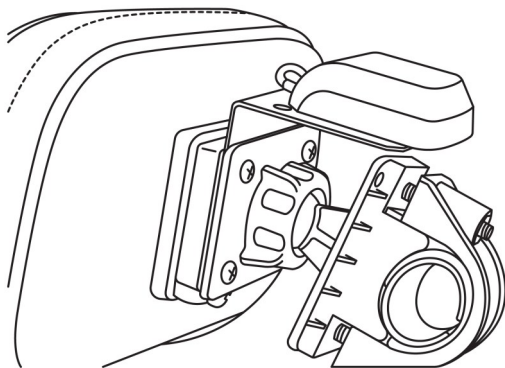

### Additional Resources

Roady BT Quick Start Guide



Roady BT Quick Start Guide

