Helios Touch
Touch-Sensitive Modular Lighting



THE NEW Helios Touch SHINES THROUGH WITH INNOVATION AND DESIGN

Helios Touch is a modular wall light that uses moveable hexagon panels to design a unique artwork. Turn the interior architecture of any space into the light source, swipe the wall and illuminate the path of your hand as it swipes across the surface. Match the mood by illuminating only the areas you touch.

- **Modular design:**
Hexagon tiles join together with magnet connections to share a single power source, create any shape you require.
- **Self supporting, adjustable shape:**
With only the central tiles fixed to the wall, the outer tiles can be detached and relocated to change the layout of the lights.
- **Touch sensitive control:**
Touch the individual tiles to turn them on or off. Adjust the overall brightness by altering the number of lit tiles.
- **Tactile experience:**
Swipe the wall, illuminating the path of your touch for an engaging sensation.
- **Comfortable lighting:**
With a colour temperature of 4500K and each tile producing 80 lumens, the light produced is suitable for office, home and workstations.
- **Safe:**
Low voltage internal circuit, cool to touch.
- **Long Service life and maintenance free:**
Low power consumption with 12 premium LEDs in each tile and an energy efficient 48W power adapter.



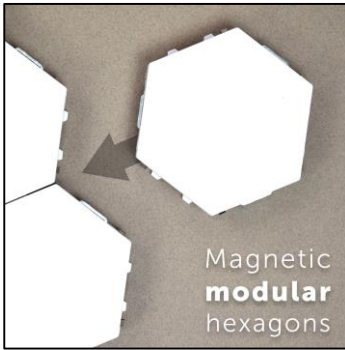

Modular Design
Magnet connections to join the tiles and change the shape

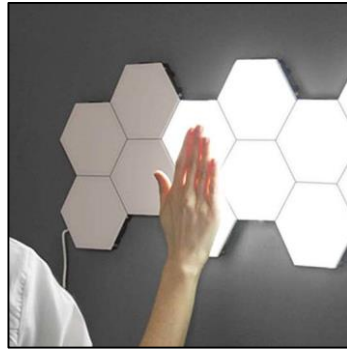

Touch Sensitive
Adjust the shape of the light by swiping the structure

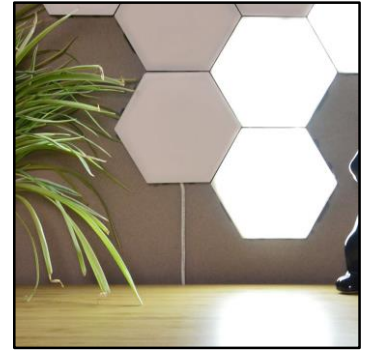

Shared power
A single power adapter operates over 60 tiles

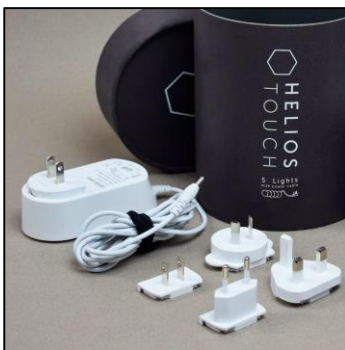

International Power Adapters
USA, UK, Europe, Australia style plugs included



Starter Pack
5 tiles
Power adapter



Expansion Pack
10 tiles

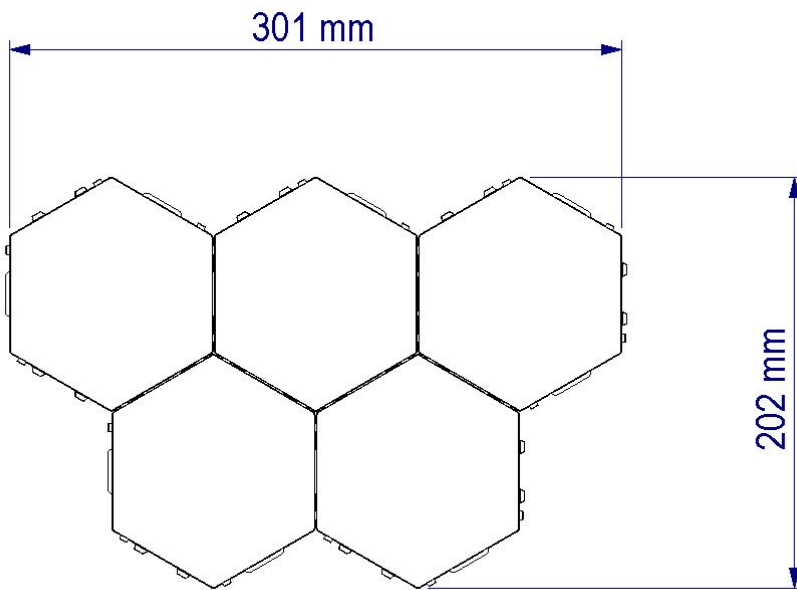
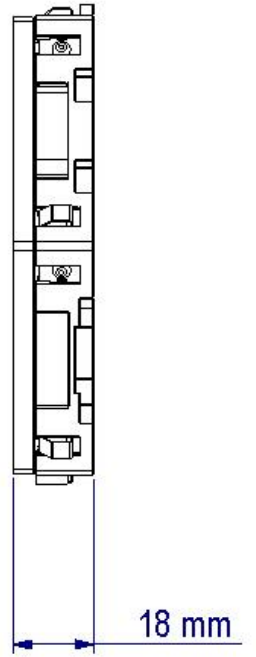
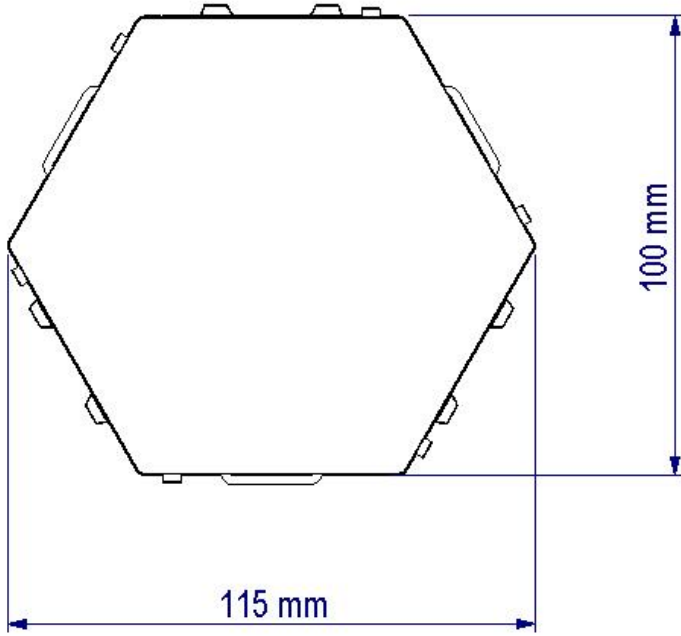



Supplied with international power adapter

Plug types included: USA, UK, Australia, EU
Operates on 110 / 220 / 240v 50 / 60hz
Max input 1.5 A

Internal voltage 24v

65 tiles can be powered from 1 supply

Not suitable for dimming systems.
(The internal touch sensitive circuit needs constant power)

LED Spec

Colour Temperature : 3200k
Output per tile: 80 lumens

Sold in 2 pack sizes

Each shipped in coloured coded tubes
Tube dimensions 13cm diameter x 21 cm long



Starter Pack

Black Tube
5 tile modules
International power supply
2m Cable
Interchangeable plug adapters

Expansion Pack

White Tube
10 tile modules



www.heliostouch.com

info@heliostouch.com



Purchasing and Shipping

Sold through Dyena Ltd in the UK.

Wholesale orders are shipped direct from Warehouse in Dongguan, China.

Good available ex factory, for your shippers to collect, or delivered via our couriers.

Customer responsible for import duty and associated costs.

Products details:

Helios Touch, White, 5 pack with power supply

SKU 01-76-001-5-W

EAN 0700461899501

Package size 13 x 13 x 21cm

Weight 1kg

Helios Touch, White, 10 tile expansion pack (NO power supply)

Model Number 01-76-001-10-W

SKU 01-76-001-10-W

EAN 0700461899518

Package size 13 x 13 x 21cm

Weight 1.25kg

Goods made in China

Harmonisation code: 9405409000

Dyena Ltd

Suite 115

South Western House, Southampton

SO14 3AL

UK

+44 (0) 2380 231 991

info@dyena.com

www.dyena.com

© Dyena 2018. All Rights Reserved.

Specifications subject to change without notice

Registered in England and Wales 07940390

www.heliostouch.com

info@heliostouch.com



HELIOS TOUCH

Instruction Manual

Please use the following steps provided to help with your helios touch installation, or visit helios-touch.com to watch the installation video.

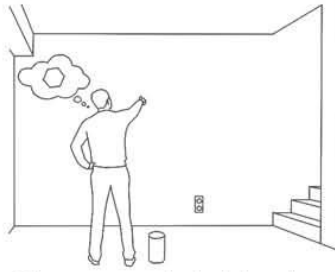

Choose your desired location. Ensure close enough distance to an outlet.

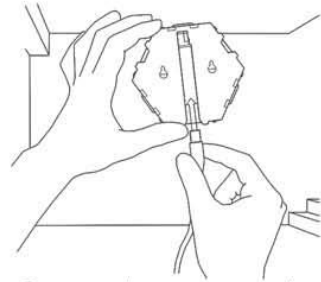

Connect the power supply to the rear of a single hexagon.

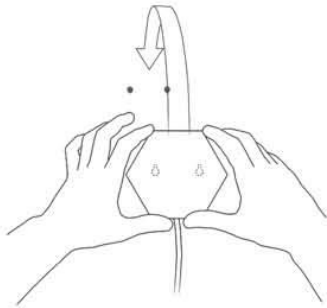

Anchor the first hexagon to the wall by using the nail holes on the back.

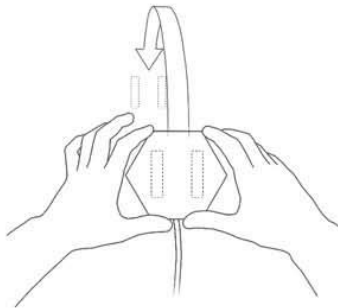

...Or use strong sticky tabs. The more you stick down the more secure the structure!

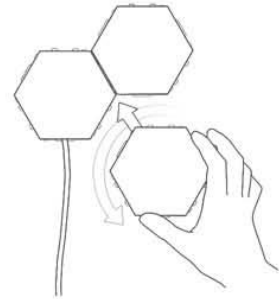

Slide each hexagon together. (Hint: The hexagon may need rotating to fit correctly)

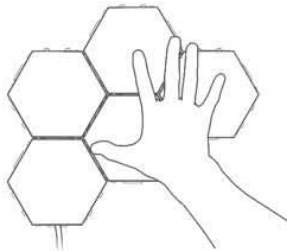

Touch to illuminate. The more of your hand the better the sensitivity.

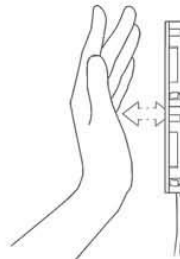

No need to press so hard. The hexagons detect the distance of your body.

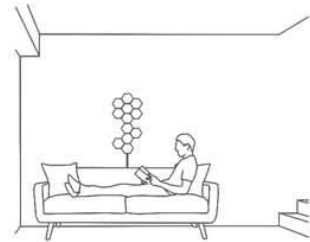

Create your desired structure and start swiping. Tag us in your designs at [@helios-touch](https://twitter.com/helios-touch)

Before use this product must be properly installed and located in accordance with the installation instructions in this manual. This product is not intended for use by young children or infirm persons without supervision.

Do

Do read these instructions thoroughly before using Helios Touch and save them for future reference.
Do replace the power cord if it is damaged in any way.

Do Not

Do not unplug the product by pulling on the power cord. Always grip the plug firmly and pull it straight out from the outlet.
Do not tamper with any internal components. There are no user serviceable parts inside the unit and opening the product will invalidate the warranty.
Do not attempt to repair the product yourself. Contact your retailer or our customer service department if the product requires servicing.
Do not locate any part of the product or its cords near heat sources such as radiators, cookers, etc.
Do not use outdoors, in a bathroom, near water or in areas subject to high moisture levels.
Do not let any cord lie or hang where it could be pulled on or tripped over accidentally.
Do not use Helios Touch for anything other than the intended use.
Do not use this product near emergency / intensive care medical equipment.
Do not use this product where the use of radio frequency products can cause malfunction in other equipment (for instance hospitals, aircraft, etc)
Do not allow liquids to spill into the units or subject the units to excessive smoke, dust, mechanical vibration or shock.

Caring for your product

Before cleaning any part of the product disconnect it from the mains supply. Use a damp cloth. Do not use liquid or aerosol cleaning agents, thinners, abrasive or corrosive materials.
Do not scratch hard objects against the housing as this may cause damage.
The technical specifications for this product and the contents of the user manual are subject to change without notice.

EU Declaration of Conformity

Product	Helios Touch
Model	01-76-001-5-W / 01-76-001-10-W
Manufacturer	Dyena Ltd
Registered Address	Suite 115, South Western House, Southampton, SO14 3AL, UK

Dyena Ltd declares that the object of the described above is in conformity with the relevant Union harmonisation legislation. Conformity is shown by compliance with the applicable requirements and other relevant provisions of Directive 1999/5/EC. A copy of the Declaration of conformity is available on request.





HELIOS
TOUCH

For the best experience, we recommend using the template to place nails for the top 2 tiles.
This will provide support for expanding the structure using the magnetic joints between the tiles.
Add more nails around the structure if required.

Nail installation template

