



SHERLE WAGNER INTERNATIONAL

KEYSTONE | DORIAN

INSTALLATION GUIDE

WALLMOUNT BASIN AND TUB SET

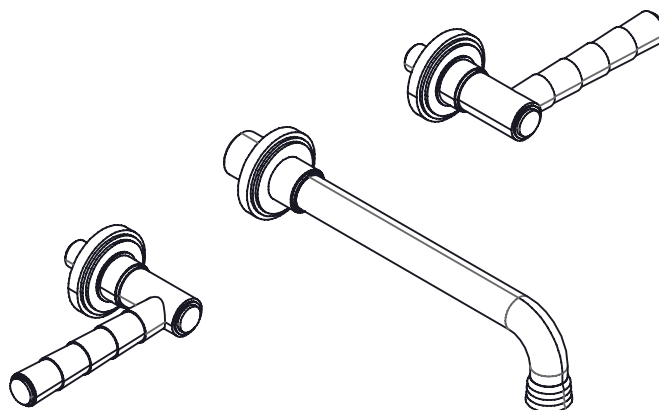

INSTALLATION TOOLS THAT MAY BE NEEDED:

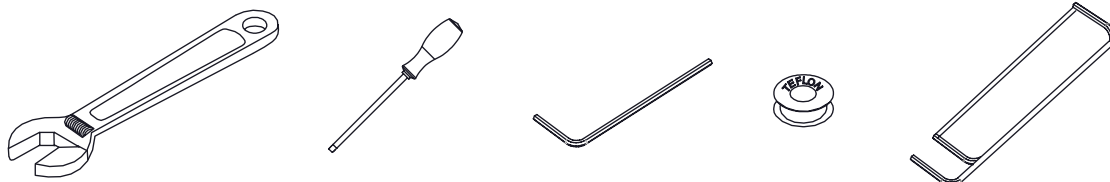

WALLMOUNT VOLUME CONTROL HANDLE INSTALLATION

1

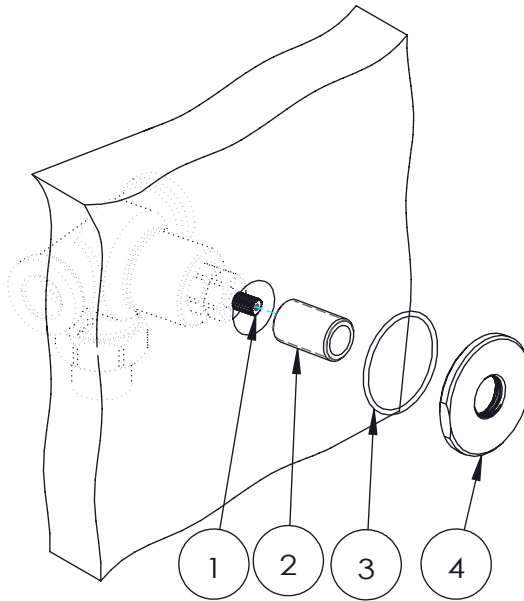

NOTE: REFERENCE 14368 INSTALLATION INSTRUCTIONS FOR INSTALLING VALVES AND PLUMBING IN THE WALL.

1. INSERT THE GASKET (3) IN THE GROOVE ON THE UNDERSIDE OF THE FLANGE (4).
2. THREAD THE ALL THREAD (2) INTO THE WALL VALVE (1).
3. TO CHECK THE LENGTH OF THE ALL THREAD (2), THREAD THE FLANGE (4) TO THE ALL THREAD (2) SO THAT THE FLANGE (4) AND GASKET (3) ARE TIGHT AGAINST THE WALL. THE ALL THREAD (2) SHOULD NOT PROTRUDE FROM THE TOP OF THE THREADED HOLE IN THE FLANGE (4) AFTER TIGHTENING TO THE WALL.
4. IF AFTER TIGHTENING TO THE WALL THE ALL THREAD (2) PROTRUDES FROM THE TOP OF THE THREADED HOLE IN THE FLANGE (4), REMOVE THE ALL THREAD (2) AND TRIM TO THE APPROPRIATE LENGTH BEFORE REINSTALLING.

WALLMOUNT VOLUME CONTROL HANDLE INSTALLATION

2

HANDLE TRIM

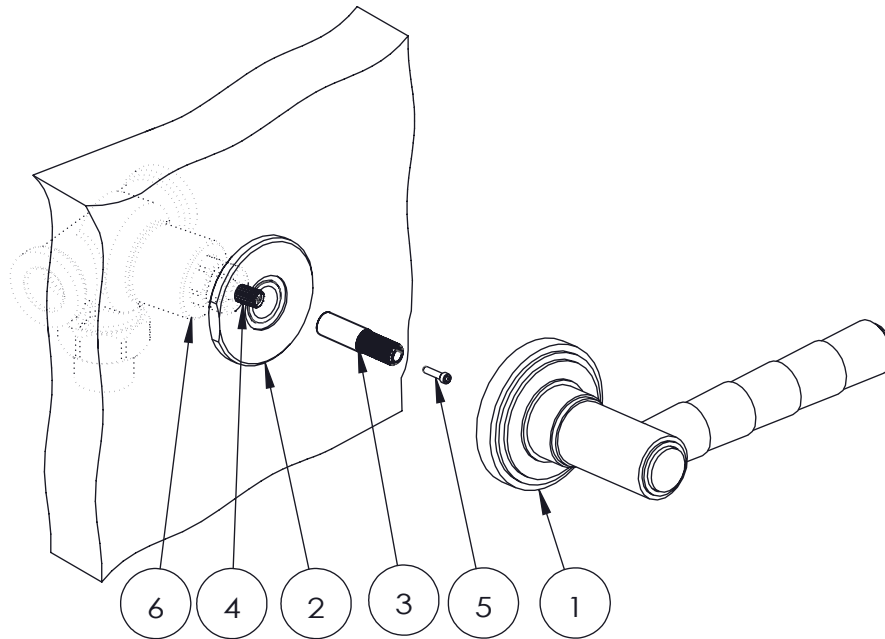

1. MOUNT THE STEM EXTENSION (3) ONTO VALVE STEM (4) IN WALL AND SECURE WITH SCREW (5). THE TIP OF THE STEM EXTENSION (3) MUST PROTRUDE 3/4" TO 1" FROM FLANGE (2). TRIM IF NEEDED.
2. POSITION AND FIT THE HANDLE ASSEMBLY (1) ONTO THE STEM EXTENSION (3) AND THREAD ESCUTCHEON (5) FULLY ONTO FLANGE (2), TO SEAT AGAINST WALL.

TROUBLESHOOTING:

THE LEVER SHOULD HOLD ITS POSITION THROUGHOUT THE FULL RANGE OF MOTION. IF THE WEIGHT OF THE SELECTED LEVER HANDLE IS TOO HEAVY TO HOLD POSITION, THE TENSION ON THE VALVE CARTRIDGE MUST BE INCREASED.

TO DO SO, REMOVE TRIM AND MOUNTING HARDWARE. THEN INSERT A 3/4" SOCKET THROUGH THE HOLE IN THE WALL ONTO THE OUTER NUT (6) OF THE VALVE CARTRIDGE. TURN CLOCKWISE TO INCREASE THE TENSION. VERIFY THE LEVER HOLDS POSITION AND REINSTALL TRIM.

QUICK CONNECT SPOUT INSTALLATION

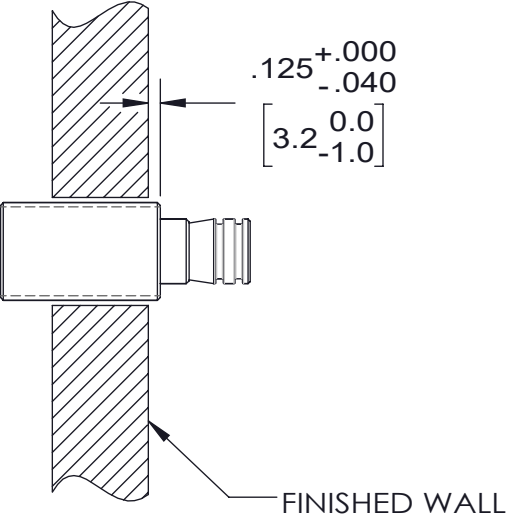
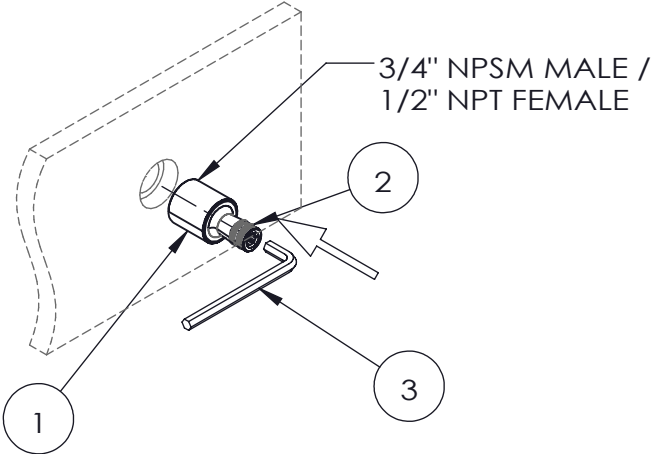
1	2
 <p>Diagram 1 shows a cross-section of a wall with a quick connect spout installed. The spout is shown protruding from the wall. Dimensions are given for the wall thickness and the spout's position relative to the finished wall surface.</p> <p>$.125^{+.000}_{-.040}$ $\left[\begin{matrix} 3.2 & 0.0 \\ & -1.0 \end{matrix} \right]$</p> <p>FINISHED WALL</p>	 <p>Diagram 2 shows the assembly of the quick connect spout. It illustrates the spout (1) being threaded into a fitting inside the wall using a hex wrench (3). O-rings (2) are shown seated in grooves on the spout.</p> <p>3/4" NPSM MALE / 1/2" NPT FEMALE</p> <p>1, 2, 3</p>
<p>1. THE QUICK CONNECT MUST BE INSTALLED RELATIVE TO THE FINISHED WALL PER DIMENSIONS SHOWN ABOVE.</p>	<p>1. APPLY SEALANT TO THREADS ON QUICK CONNECT (1) , THEN THREAD ONTO FITTING INSIDE THE WALL USING HEX WRENCH (3) (NOT SUPPLIED).</p> <p>2. CHECK THAT QUICK CONNECTOR (1) IS FIRMLY ON WALL AND O-RINGS (2) ARE PROPERLY SEATED IN GROOVES.</p>

QUICK CONNECT SPOUT INSTALLATION

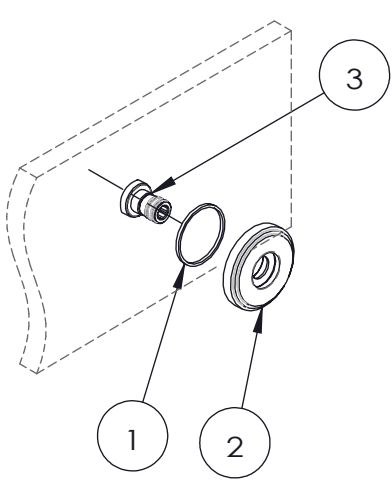
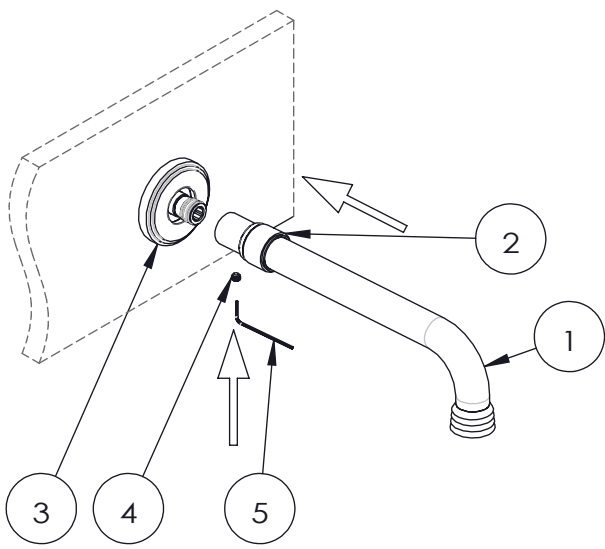
3	4
	
<p>1. INSERT THE GASKET (1) IN THE GROOVE ON THE UNDERSIDE OF THE WALL ESCUTCHEON (2).</p> <p>2. THREAD WALL ESCUTCHEON (2) ONTO QUICK CONNECT (3).</p>	<p>1. BEING CAREFUL TO AVOID SCRATCHING THE SPOUT (1), SLIDE ESCUTCHEON COLLAR (2) OVER SPOUT (1) AND SLIDE ONTO SHANK OF QUICK CONNECT (3) UNTIL IT IS FIRMLY SEATED.</p> <p>2. TIGHTEN SET SCREW (4) WITH A HEX WRENCH (5).</p>

QUICK CONNECT SPOUT INSTALLATION

5

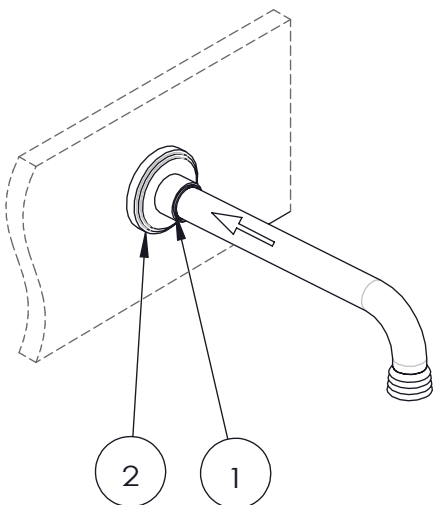

1. THREAD ESCUTCHEON COLLAR (1) TIGHTLY ONTO THE ESCUTCHEON (2).

6

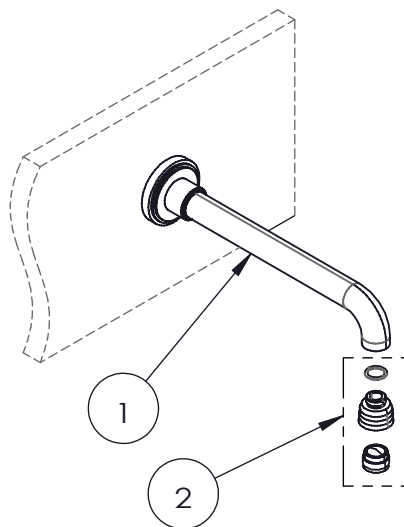

1. REMOVE AERATOR ASSEMBLY (1) FROM SPOUT (2).
2. TURN ON WATER TO FLUSH LINES AND TO CHECK FOR LEAKS.
3. RE-INSTALL AERATOR AND TURN ON WATER TO CHECK FOR PROPER AERATOR INSTALLATION.

WALLMOUNT PARTS LIST

XXXXTUB0806 PART LIST

ITEM	PART NUMBER	DESCRIPTION
1	27773	TUB QUICK CONNECT
2	10018	GASKET
3	27935	SET SCREW
4	27434	FULL FLOW AERATOR
5	12797	ALL THREAD
6	12172	O-RING
7	29577	ADPTER

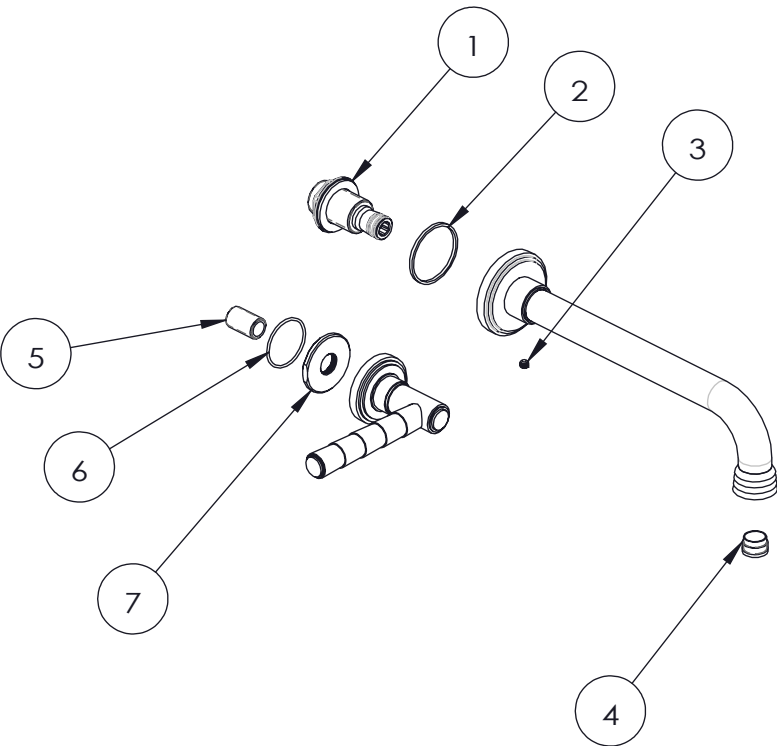

XXXXWBS0806 PART LIST

ITEM	PART NUMBER	DESCRIPTION
1	27795	BASIN QUICK CONNECT
2	10018	GASKT
3	27935	SET SCREW
4	22617	1.0GPM AERATOR
5	12797	ALL THREAD
6	12172	O-RING
7	29577	ADPTER

