

SHERLE WAGNER INTERNATIONAL

AQUEDUCT WITH MOLECULE KNOB DECK MOUNT TUB SET 2005DKT302-XX



PRODUCT FEATURES

- o Available in all Sherle Wagner International finishes
- o Solid brass/bronze construction
- o Full flow
- o Includes (2) 1/2" washerless 1/4 turn ceramic valves
- o Includes (2) 72" braided hose 1/2" FNPT to 3/4" FNPT for diverter
- o Optional: (2) 3/4" valves for increased flow, contact sales associate for details

AVAILABLE METAL FINISHES

PN Polished Nickel	OB Oil Rubbed Brass	ES English Silver	AG Antique Gold
CP Polished Chrome	PB Polished Brass	BS Butler Silver	SP Satin Platinum
BN Brushed Nickel	GP Gold Plate	AP Antique Pewter	HP High Polished Platinum
BC Brushed Chrome	AL Almond Gold	PE Black Pearl	BP Burnished Platinum
SB Satin Brass	RG Rose Gold	BG Burnished Gold	

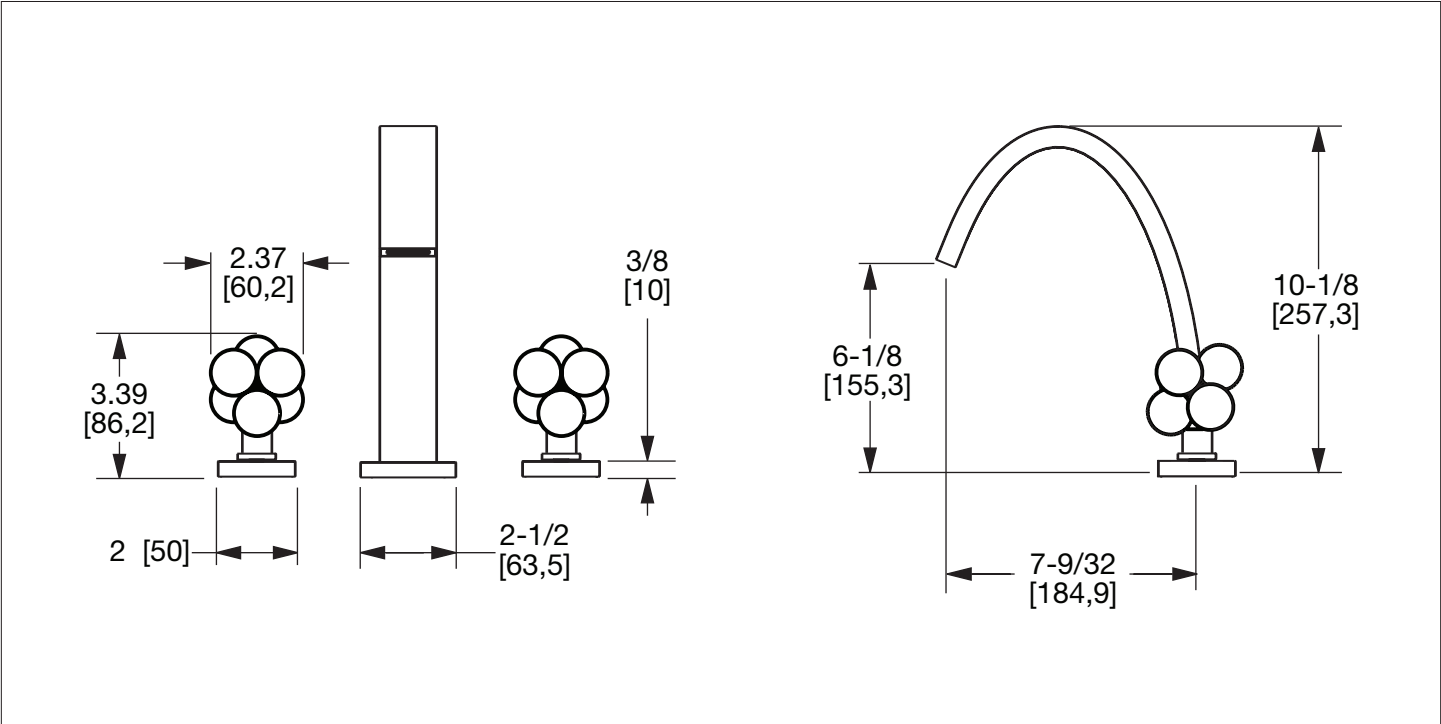

The measurements shown are for reference only. Products and specifications shown are subject to change without notice.

Rev A