

S H E R L E

W A G N E R
INTERNATIONAL

INSTALLATION GUIDE

HANDSHOWER WAND WITH WALLMOUNT SUPPLY HOOK

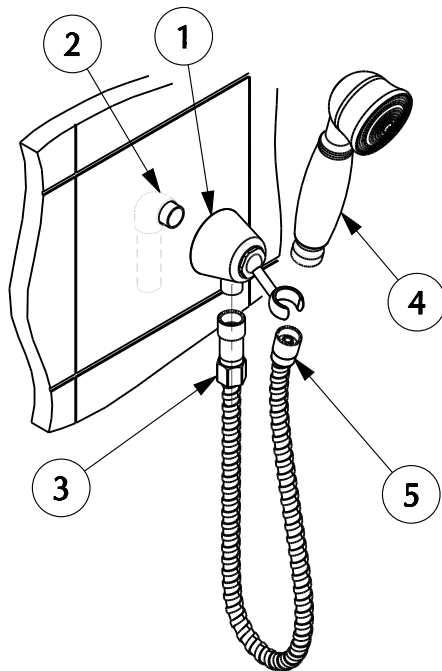

1. Install wallmount support (1) to 1/2" supply pipe (2). 1/2" supply pipe to protrude approximately 3/8" from finished wall surface.
BE SURE TO USE PROPER THREAD SEALANT ON 1/2" PIPE THREAD.

2. Thread check valve housing end (3) of spiral hose assembly to outlet of wallmount support (2).

3. Thread hand shower wand (4) onto conical nut (5) of spiral hose assembly.

Installation tools that may be needed:

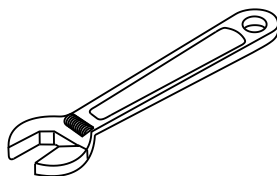

Handshower Wand With Wallmount Supply Hook Parts List

ITEM	PART NUMBER	DESCRIPTION
1	11531*	Classic HS Wand
2	11722*	Spiral Hose
3	11733*	Check Valve
4	11545*	1/2" Supply Hoom
5	13194*	Knurled Wand
6	13206*	Fluted Wand
7	10697*	Cylindrical Wand
8	21407*	1/2" Supply

* SPECIFY FINISH WHEN ORDERING

