

# INSTRUCTIONS FOR INSTALLATION OF TUBULAR LOCKSETS

INSTALLATION ILLUSTRATIONS ARE SHOWN WITH ENTRY MODELS. PROCEDURE IS IDENTICAL FOR PRIVACY, CLOSET AND EXIT MODELS IN ANY ,KNOB DESIGN.

## 1. MARK DOOR

**A.** Start approximately 36" from floor. Fold and apply template to high edge of door bevel and mark center of door edge as indicated on template.

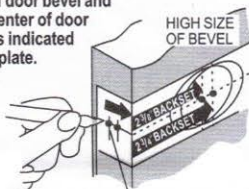

MARK FOR 31/32" OR 1" HOLE IN DOOR EDGE

**B.** Mark center hole on door face through guide on template for 2-3/8" (60mm) or 2-3/4" (70mm) backset.

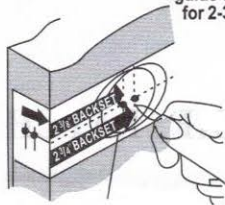

MARK FOR 2" OR 2-1/8" HOLE IN DOOR FACE

## 4. INSTALL STRIKE

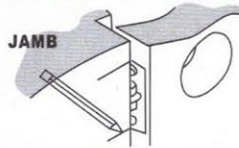

**A.** Insert end of template against flat of latch bolt and close door against stop. Mark template from edge of jamb and locate strike opening. Move 1/4" for plain latch and 3/4" for deadlatch toward door stop to locate center line for screws and 1" hole

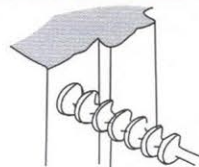

**B.** Drill 31/32" or 1" hole 1/2" deep in door jamb on Center line of screws CAUTION To assure proper lockset function hole in jamb must be doing fall 1/2" deep.

## 2. DRILL HOLES

**A.** Drill 2" or 2-1/8" hole through door face as marked for lockset: It is recommended that holes be drilled from both sides to prevent splitting

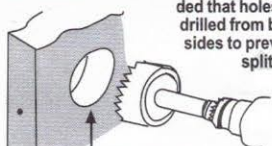

2" OR 2-1/8" HOLE

**B.** Drill 31/32" or 1" hole in center of door edge for latch. Check template for correct size for your latch application

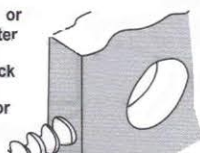

31/32" OR 1" HOLE

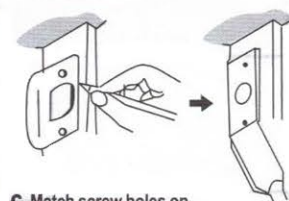

**C.** Match screw holes on strike with center line on jamb. Outline outside edges of strike Chisel 1/16" deep for strike.

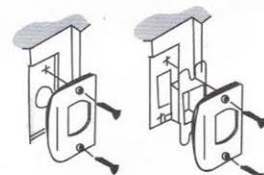

**D.** Install strike and tighten screws (Adjustable lang on strike permit bending in or out to eliminate too loose fit between door and door stop) when a strike box is required mount under strike as shown.

## 3. INSTALL LATCH

**A.** Insert latch in hole keeping it parallel to face of door. Mark outline and remove latch.

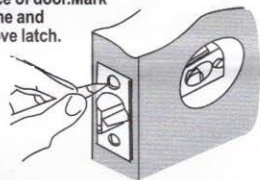

**B.** Chisel 1/8" deep or until latch face is flush with door edge.

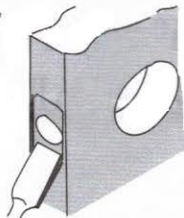

**C.** Insert latch and tighten screws.

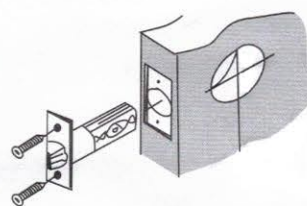

**D.** Note for drive in latch DRILL HOLE size indicated on template and PRESS latch until it is flush with door edge

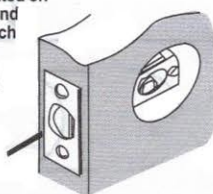

## 5. INSTALL EXTERIOR MECHANISM

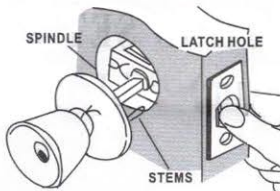

Insert knob with spindle into latch making certain that stems are positioned correctly through latch holes press flush against door.

## 6. INSTALL INTERIOR MECHANISM

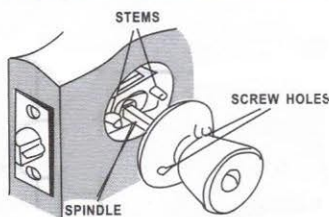

Install interior knob and rose by placing on spindle and aligning screw holes with stems push flush against the door insert screws and tighten until lockset is form.

Suitable for door thickness:  
1-3/8" (35mm) to 1-3/4" (45mm)

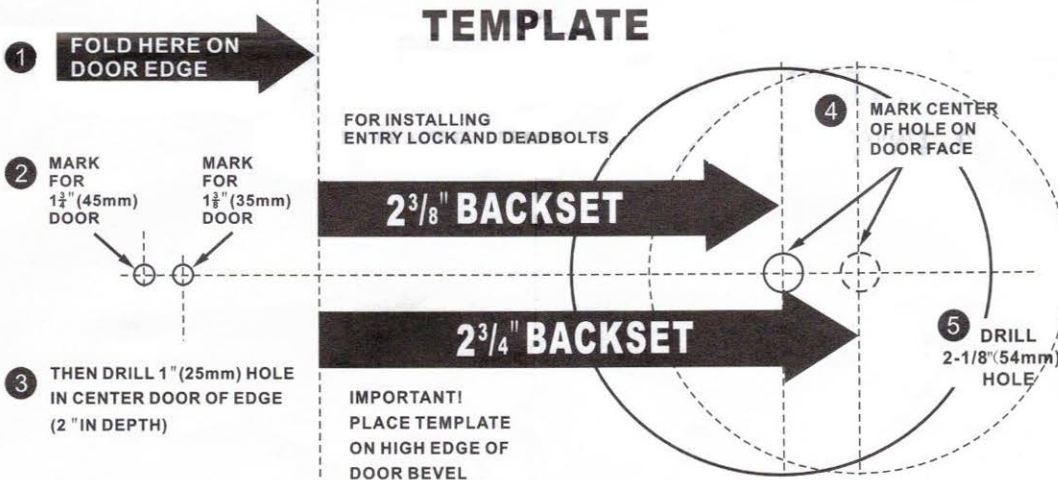

## HOW TO ADJUST THE LATCH

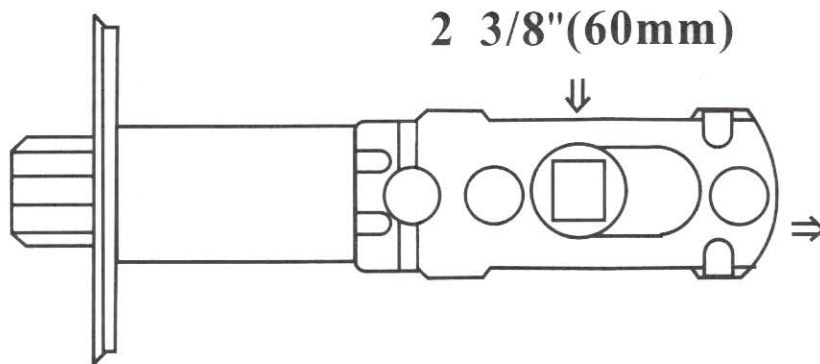

THE LATCH IS SET  $2 \frac{3}{8}$ " (60mm) TO ADJUST TO  
 $2 \frac{3}{4}$ " (70mm) PULL OUT THE REAR PART

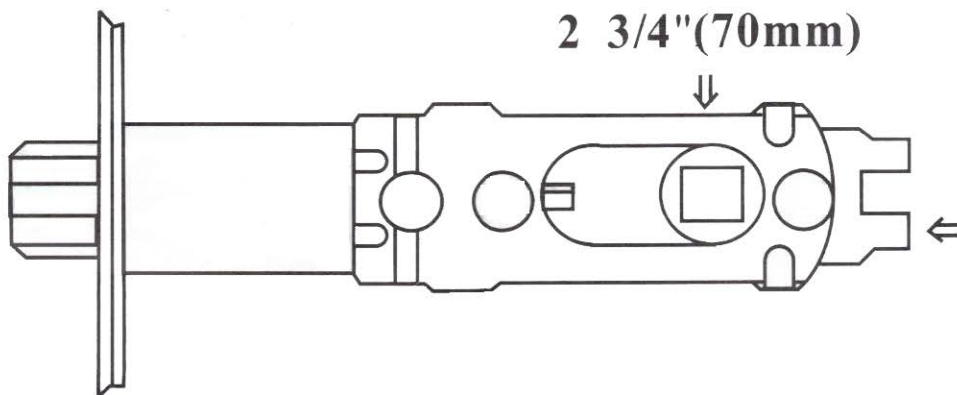

THE LATCH IS SET  $2 \frac{3}{4}$ " (70mm) TO ADJUST TO  
 $2 \frac{3}{8}$ " (60mm) PULL IN THE REAR PART