

#7003; 3-Point Entrance Mortise Mechanism Stainless Steel With Roller Cams

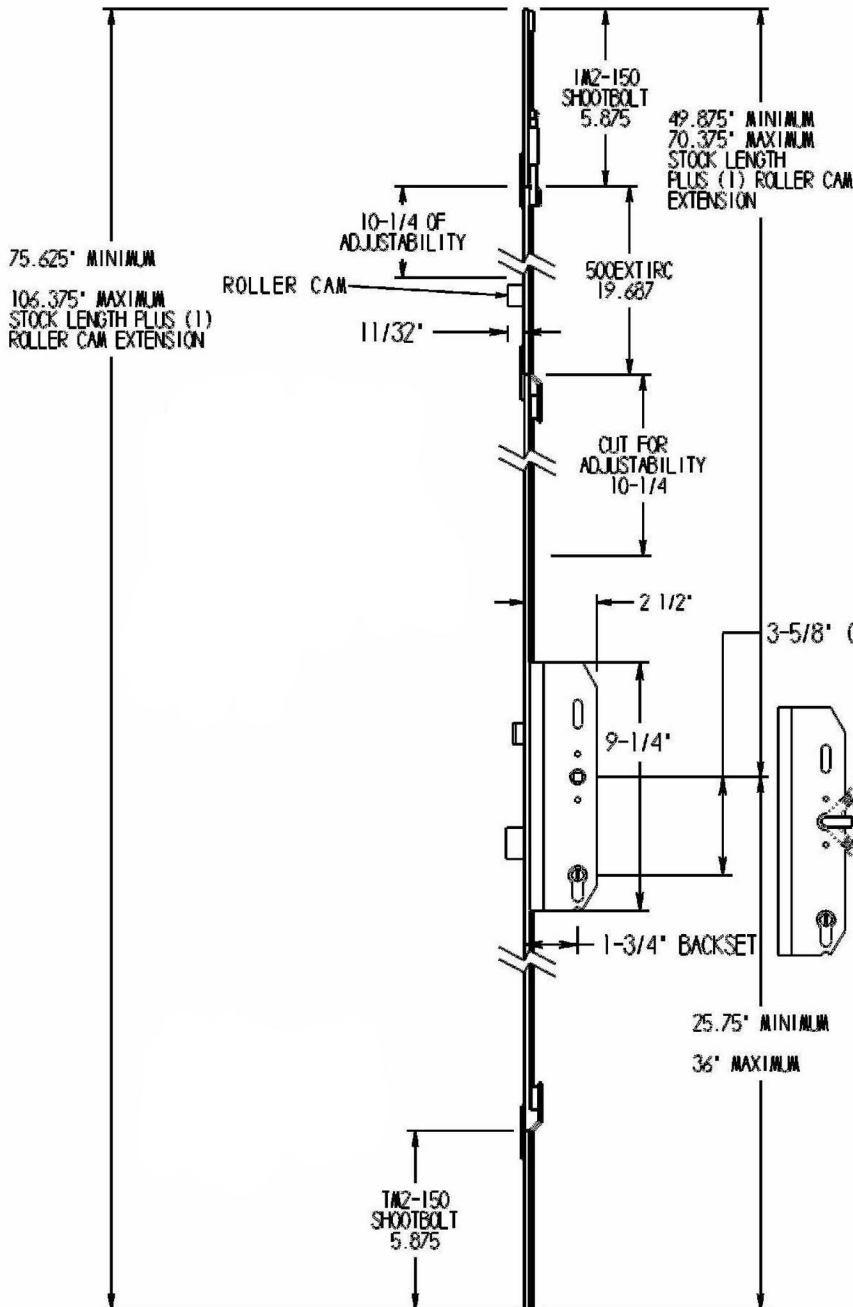

* ALL DADDO GROOVES MUST BE FREE OF ANY PARTICULATE OR SAWDUST BEFORE AND AFTER INSTALLATION.

*Four locking points consisting of latch, deadbolt, top and bottom shootbolts and roller cam. Additional roller cam extensions can be added for more locking points.

*Use for active door or window.

*Material: Stainless Steel.

Function: to lock:

*Lifting the lever up engages deadbolt, roller cam and shootbolts. Turning the cylinder locks all points into place.

To unlock:

*Turn cylinder to unlock all points. Pushing the lever down will disengage roller cam, deadbolt and shootbolts. Note latch functions in unlocked position.

* 1-3/4" (45mm) Backset

Faceplate:

* 5/8" (16mm) width

*With (1) roller cam extension:
Minimum height door: 75.625"
Maximum height door: 106.375"

Extensions available for taller doors. See pages 173 & 198 for more information.
For 10' doors add two (2) 19 11/16" [500. mm] extension with roller cam (500 EXTIRC) or without roller cam (500 EXT1).
For doors taller than 10 feet, simply add more extensions with or without roller cams.

7003 GROOVE
DETAIL ONLY.

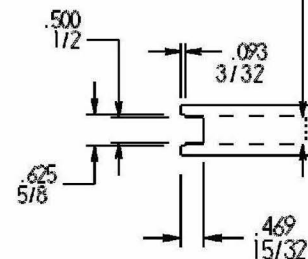

FOR MECHANISM, CUT WIDTH .5625" (9/16") X 9-1/8" FOR LOCK BOX HOUSING.

NOTE: 7002 2-POINT INACTIVE ENTRANCE MORTISE IS SLIGHTLY DEEPER FOR SHOOTBOLTS TO BE FLUSH WITH THE EDGE OF THE DOOR BEFORE ASTRAGAL IS INSTALLED.