

SQUARE STAINLESS STEEL DOOR PULLS - 24" & 36" OVERALL

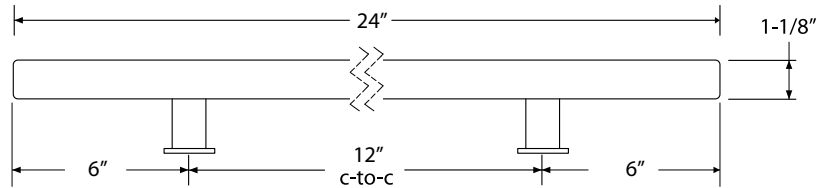

24" Square Door Pull
86191

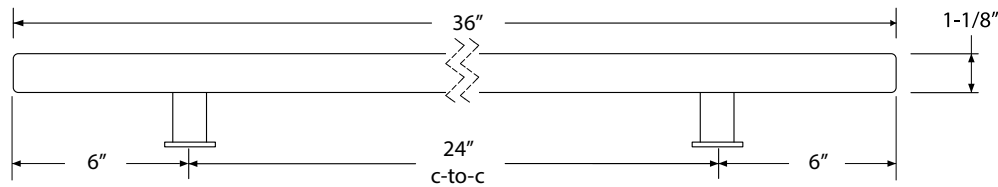
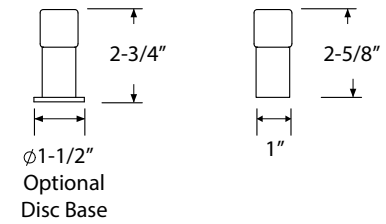

36" Square Door Pull
86192

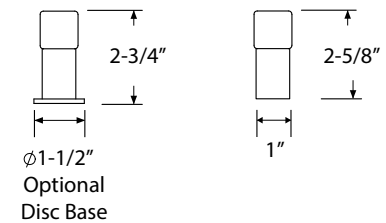

Standard Mounting

Thru-Bolt with
Decorative Caps

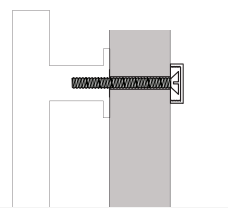

Optional Mounting

Concealed Surface
CS

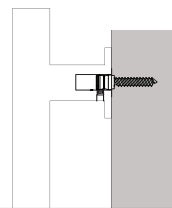

Back to Back
BTB

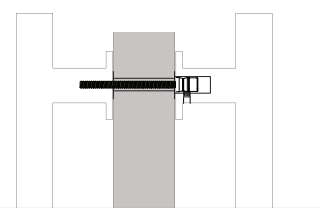

Fits Door Thickness: 1-3/4" to 2-1/4". Specify if thicker.

NOT DRAWN TO SCALE