

# sparklypets

## EXTENDED DOG AGILITY SET



### USER MANUAL GUIDELINE

Learn how to use and set your new SparklyPets Agility Set in a fun way!

THE USER MANUAL  
MAGAZINE

### DOG AGILITY

What it is and what you need to know.

PAGE 26

5

ARTICLE AT PAGE 28

DOG BREEDS THAT NEED  
A LOT OF EXERCISES

**BONUS**

For even more tips and tricks on making the most of your SparklyPets agility set, follow this link:

[WWW.SPARKLYPETS.COM/BONUS](http://WWW.SPARKLYPETS.COM/BONUS)

PAGE 29

### DOG AGILITY

4 Blank agility course sheets for your own agility course build!



...and much more interesting stuff!



## PARTS FOR THE SPARKLYPETS DOG AGILITY SET

*Thank you for selecting SparklyPets for your agility journey!*

For a detailed breakdown of the components included in each designated bag, please refer to the product index below, where we specify the contents of each bag.

**SHOULD YOU EVER ENCOUNTER ANY MISSING PARTS,  
PLEASE DON'T HESITATE TO REACH OUT TO US FOR PROMPT RESOLUTION.**

### BLUE STRING BAG

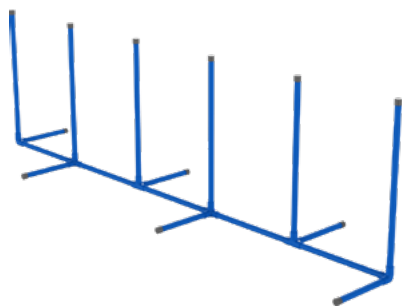

### CONTENT OF THE BAG

- 6 x Blue weave poles with gray caps (D)
- 5 x Intermediate blue base poles with clips on both sides (E)
- 4 x Tee-Shaped Blue Base Poles with Gray Caps (F)
- 2 x L-Shaped Blue Base Poles with Gray Caps (G)
- 3 x U-shaped ground pegs (H)

## CONTENT OF THE BAG

### ORANGE STRING BAG

- 1 x Intermediate white base pole with clips on both sides (J)
- 2 x Cross shape blue base pole with blue caps (K)
- 2 x Blue base pole extensions (L)
- 1 x Blue stand pole for the lower side (M)
- 1 x Blue stand pole for the upper side (N)
- 4 x U shaped ground pegs (H)

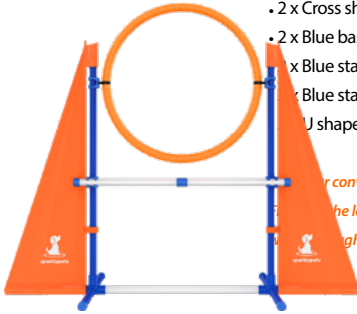

*For convenience and efficient logistics, the two Orange String Bags should be placed on the left and right sides of the 2in1 Dog Agility Frame and be tightly placed directly inside the box.*

### TUNNEL BAG

### CONTENT OF THE BAG

- 1 x Main SparklyPets Carrying Bag
- 1 x Pause Box
- 1 x Dog Tunnel
- 2 x Orange Hose (S) for Tire Jump
- 10 x Ground Pegs  
(4 x for Pause Box & 6 x for Dog Tunnel) (B)



## CLOSED TUNNEL BAG

## CONTENT OF THE BAG

- 6 x Ground Pegs Dog Tunnel (B)
- 1 x Closed Dog Tunnel (X)

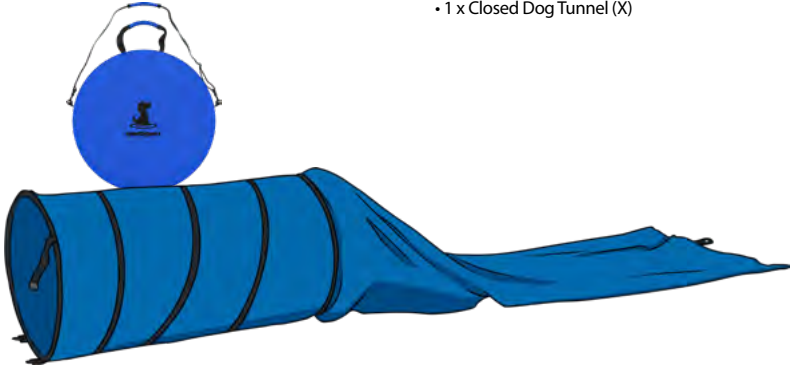

## RED STRING BAG

## CONTENT OF THE BAG

- 2 x U-shaped ground pegs (H)
- 2 x Blue base pole extensions (L)
- 2 x Blue stand pole for the lower side (M)
- 2 x Blue stand pole for the upper side (N)
- 4 x Jump Hurdle Connectors (O)
- 2 x L-shaped blue base pole with blue caps (T)
- 2 x Hurdle blue bars with caps on both sides (U)
- 1 pc x Orange wall fabric (V)



*\*For your convenience and efficient logistics, the two Orange Flags for the left and right sides of the Jump Over and Under element will be thoughtfully placed directly inside the box.*



Learn how to use and set your new SparklyPets Agility EXTENDED Set in a fun way!

## USER MANUAL GUIDELINE

### CONFIGURING THE DOG AGILITY PAUSE BOX

1 x Dog Agility Pause Box (A)

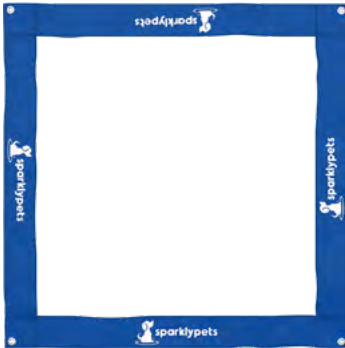

4 x Ground pegs (B)



#### HOW TO UTILIZE A DOG AGILITY PAUSE BOX?

The dog agility pause box, also known as a pause table, serves as an effective tool for instructing your canine companion on when and where to pause and rest during an agility course in a controlled manner. It's a common feature in many agility courses.

Compared to a traditional pause table, the pause box offers a space-saving, easily transportable, and cost-effective alternative, making it ideal for those with limited space or budget constraints.

Position your pause box at the center of your agility course to teach your dog to either lie down, come to a stop, or simply sit within the designated square.

#### SIZE SPECIFICATIONS

When fully extended, it covers an area of 10 square feet.

## STEP 1

### PLACING THE PAUSE BOX ON THE GROUND

Select a flat, open ground space and position the Pause Box (A) with the SparklyPets logo facing outward, just as shown in the picture.

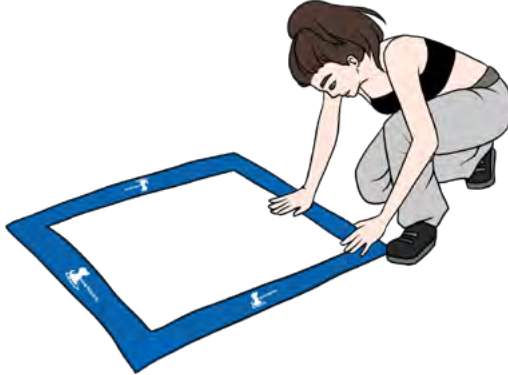

## STEP 2

### SECURING THE PAUSE BOX WITH GROUND PEGS

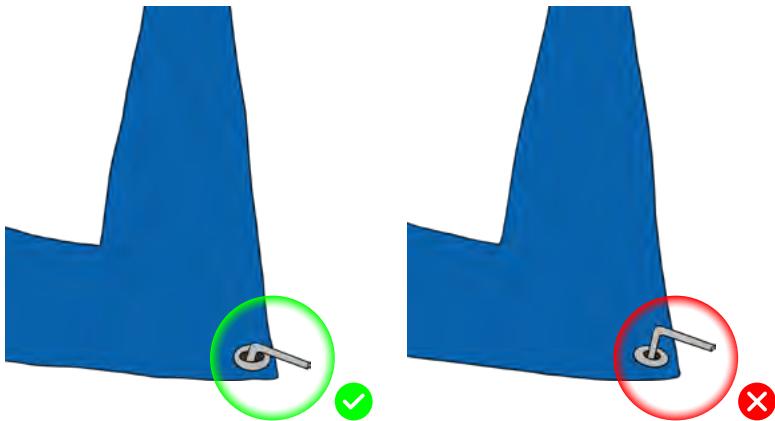

Next, if feasible, secure the Pause Box to the ground by anchoring it with 4 pegs (B), one at each designated corner.

**!** **WARNING!** Ensure that the ground pegs are firmly anchored into the ground to prevent injuries during course use. Please refer to the picture for visual guidance.

## PREPARING THE DOG AGILITY TUNNEL

1 x Dog Agility Tunnel (C)

6 x Ground pegs (B)

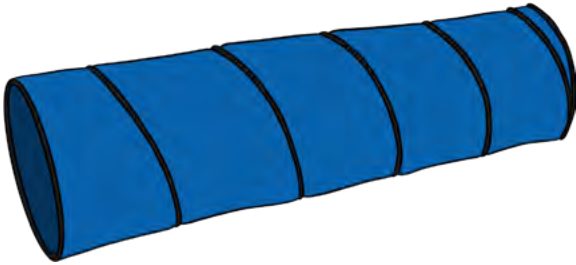

### HOW TO UTILIZE A DOG AGILITY TUNNEL?

The Dog Agility Tunnel, often referred to as a 'pipe,' is one of the most enjoyable obstacles on the agility course for your dog to interact with.

Tunnels are typically cylindrical and can vary in length from 4 feet to 20 feet, with a standard diameter of 24 inches.

Position the tunnel within your course so that your dog can easily enter and exit through the opening, smoothly transitioning to the next obstacle in your course.

### SIZE SPECIFICATIONS

6.5 feet in length, with a 24-inch diameter opening.

#### STEP 1

#### EXTEND THE TUNNEL AND POSITION IT PROPERLY

Unfasten the two laces that secure the Tunnel (C) in its bundled form and lay it on a level, open ground surface.

Ensure that you've positioned the tunnel correctly by verifying that its base aligns with the ground, as shown in the picture from the next page.



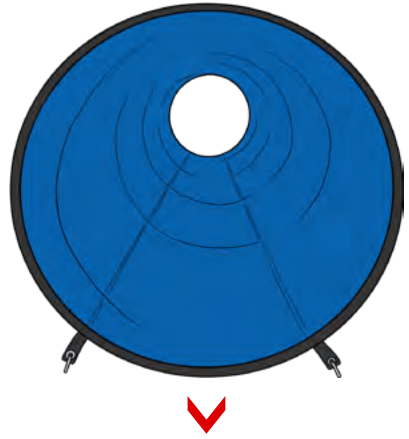

## STEP 2

### SECURING THE TUNNEL WITH GROUND PEGS

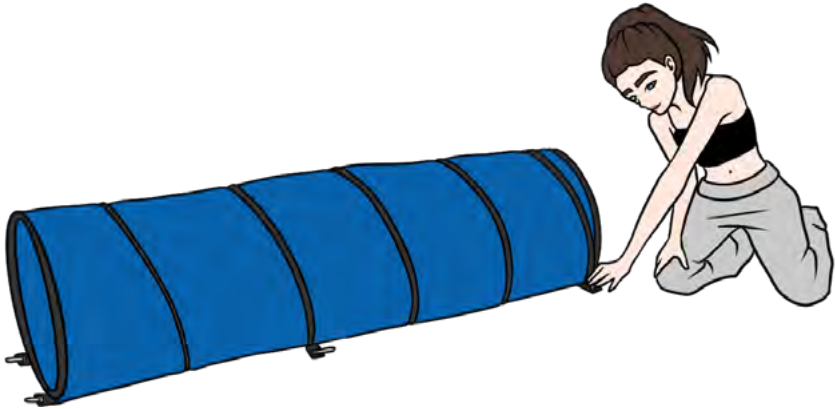

Now, if feasible, secure the Dog Tunnel (C) to the ground by anchoring it with 6 pegs (B): two in the front, two at the middle of the tunnel, and two at the rear, just as shown in the picture.

 **WARNING!** Ensure that the ground pegs are firmly anchored into the ground to prevent injuries during course use. Please refer to the picture for visual guidance.



## PREPARING THE DOG AGILITY CLOSED TUNNEL "THE CHUTE"

1 x Dog Agility Closed Tunnel (X)

6 x Ground pegs (B)



### HOW TO UTILIZE A DOG AGILITY CLOSED TUNNEL?

The Dog Agility Closed Tunnel, affectionately known as the Chute, is among the most entertaining obstacles for your furry companion on the agility course.

Unlike the standard Dog Agility Tunnel, this one is better tailored for more advanced dogs who are at ease entering a tunnel without a visible exit. We suggest introducing this tunnel after your dog has become accustomed to the standard version.

To begin training with the Chute, teach your dog to enter the tunnel, and initially, stand at the end while holding up the opening to help them grow more comfortable. With time, gradually lower the opening to the ground, allowing your dog to enter and exit independently.

When setting up the tunnel in your course, position it in a straight line, allowing your dog to effortlessly enter and exit, ensuring a seamless transition to the next obstacle.

### SIZE SPECIFICATIONS

9.18 feet in length, with a 24-inch diameter opening.

## STEP 1

### EXTEND THE TUNNEL AND POSITION IT PROPERLY

Unfasten the two laces that secure the Tunnel (X) in its bundled form and lay it on a level, open ground surface.

Ensure that you've positioned the tunnel correctly by verifying that its base aligns with the ground, as shown in the picture.

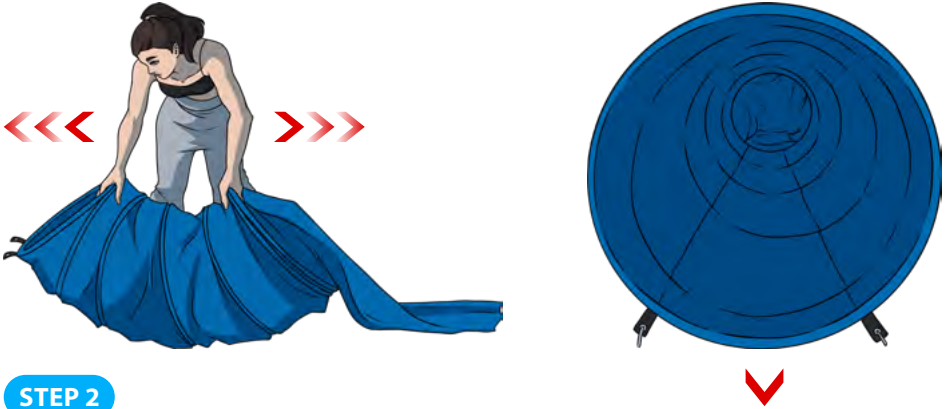

## STEP 2

### SECURING THE TUNNEL WITH GROUND PEGS



Now, if feasible, secure the Dog Tunnel (X) to the ground by anchoring it with 6 pegs (B): two in the front, two at the middle of the tunnel, and two at the rear fabric, just as shown in the picture.

**!** **WARNING!** Ensure that the ground pegs are firmly anchored into the ground to prevent injuries during course use. Please refer to the picture for visual guidance.

## PREPARING THE DOG AGILITY WEAVE POLES

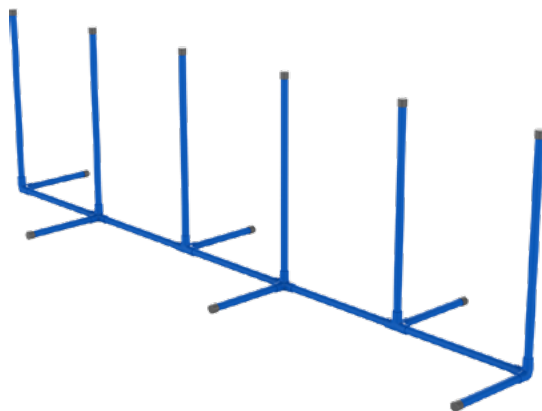

- 6 x Blue weave poles with gray caps (**D**)
- 5 x Intermediate blue base poles with clips on both sides (**E**)
- 4 x Tee-Shaped Blue Base Poles with Gray Caps (**F**)
- 2 x L-Shaped Blue Base Poles with Gray Caps (**G**)
- 3 x U-shaped ground pegs (**H**)

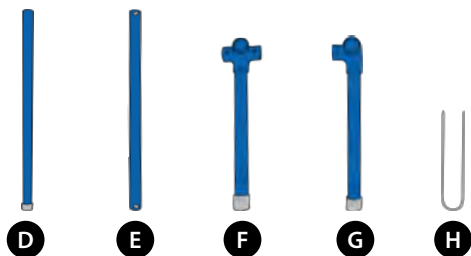

### HOW TO UTILIZE THE DOG AGILITY WEAVE POLES?

A Dog Agility Weave Pole set typically consists of anywhere from 4 to 12 poles. In most competitive settings, you'll encounter a standard configuration of 12 poles, evenly spaced at least 24 inches apart.

The primary goal is to train your dog to navigate a zig-zag path through the poles until reaching the end and proceeding to the next obstacle in your agility course.

Teaching your dog the art of weaving through these poles often requires practice, which may involve the use of dog treats and your patience.

## SIZE SPECIFICATIONS

Total Dog Agility Weave Pole Set Length: 9.8 feet  
Pole Height: 27 inches  
Distance Between Poles: 25.5 inches

### STEP 1

#### BEGIN ASSEMBLING THE BASE POLES IN A SINGLE DIRECTION

To commence, retrieve the bag labeled with the blue string containing the components specific to this set (D, E, F, G, H). You'll require a level open ground area of approximately 32 square feet for the setup.

Always initiate the assembly from one end by first connecting an L-Shaped base pole (G) to one of the clips on an Intermediate base pole (E). A successful connection will produce an audible 'Click!' sound, indicating a correct attachment.

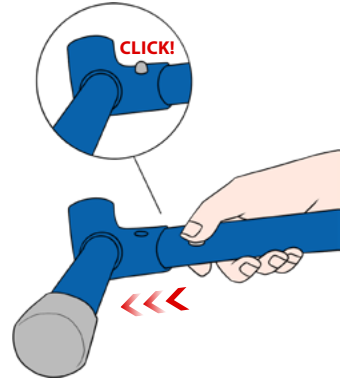

### STEP 2

#### PROGRESS BY INCORPORATING SUPPORT BASE POLES IN A ZIG-ZAG PATTERN

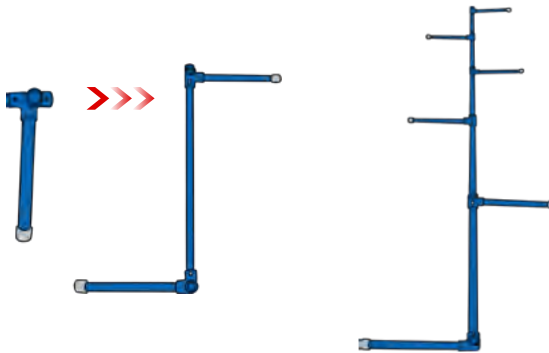

Next, attach the other end of the Intermediate base pole (E) in a zig-zag configuration with a Tee-Shaped base pole (F).

Continue this pattern by adding Intermediate base poles (E) and connecting them with Tee-Shaped base poles (F) until you reach the conclusion, where you'll affix the final L-Shaped base pole (G), mirroring the arrangement depicted in the picture.

### STEP 3

#### AFFIX THE WEAVE POLES TO THE BASE

With the base assembled, it's now time to secure the standing weave poles (D) to the base of the set.

Each junction point of the L or Tee-shaped base pole features a hole; simply place the weave poles into these holes for attachment.



### STEP 4

#### SECURING THE DOG AGILITY WEAVE WITH GROUND PEGS

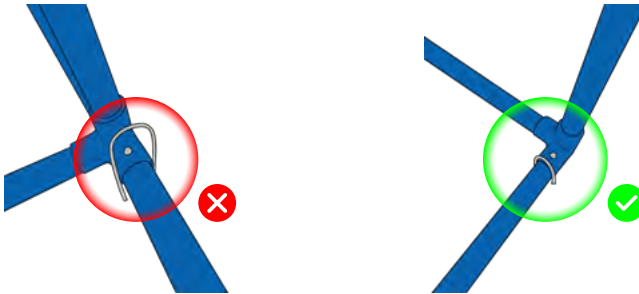

If feasible, anchor the Dog Agility Weave poles set to the ground using U-shaped pegs (H): one at the front, one in the middle of the set, and one at the rear, as shown in the picture.

**!** **WARNING!** Ensure that the ground pegs are securely fastened to the ground to prevent injuries during course usage. Please refer to the picture for visual guidance.

## CONFIGURING THE DOG AGILITY TIRE JUMP OR THE DOG AGILITY HURDLE JUMP

The SparklyPets Dog Agility set offers a unique combination of two agility obstacle equipment within a single frame. Depending on your preferences and your dog's agility level, you have the option to install either the Dog Agility Tire Jump or the Dog Agility Hurdle Jump.

For those just starting, we recommend beginning with the Dog Agility Hurdle Jump. Once your dog becomes proficient with it, you can progress to the Dog Agility Tire Jump.

In the upcoming steps, we will demonstrate how to set up the SparklyPets Agility Frame for both options. First, we will cover the setup for the Dog Agility Hurdle Jump, followed by instructions for the Dog Agility Tire Jump.

### PREPARING THE SPARKLYPETS AGILITY FRAME

- 2 x SparklyPets Orange Flags (I)
- 1 x Intermediate white base pole with clips on both sides (J)
- 2 x Cross shape blue base pole with blue caps (K)
- 2 x Blue base pole extensions (L)
- 2 x Blue stand pole for the lower side (M)
- 2 x Blue stand pole for the upper side (N)
- 2 x U-shaped ground pegs (H)

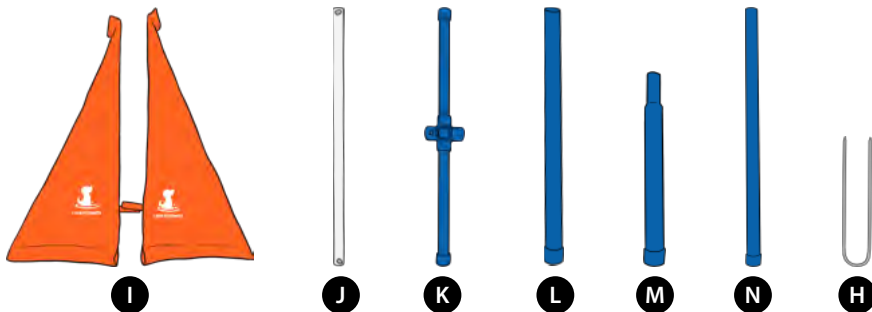

#### SIZE SPECIFICATIONS

- Stand Poles Size: 36 inches
- Interior Jump Space Size: 26 inches

Ensure you have access to a flat, open area for this assembly. The primary components, including the poles and connectors, can be found in the bag with the orange string, while some more oversized items, like flags and the hose for the tire jump, may either be in the tunnel bag or directly within the box.

## STEP 1

### ASSEMBLING THE FRAME BASE

Take hold of the Intermediate white base pole (J) and attach a Cross-shaped blue base (K) to each end.

When you hear a 'Click!' sound, it indicates a successful connection.

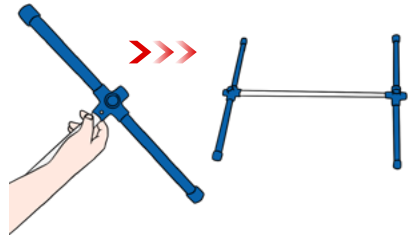

## STEP 2

### AFFIX THE STANDING POLES TO THE FRAME BASE

Once the frame base is prepared, it's time to secure the standing poles in place.

The junction points of the base Cross-shaped pole feature holes. Begin by inserting the blue lower-side stand pole (M) into these holes, followed by the blue upper-side stand pole (N) on top of them.

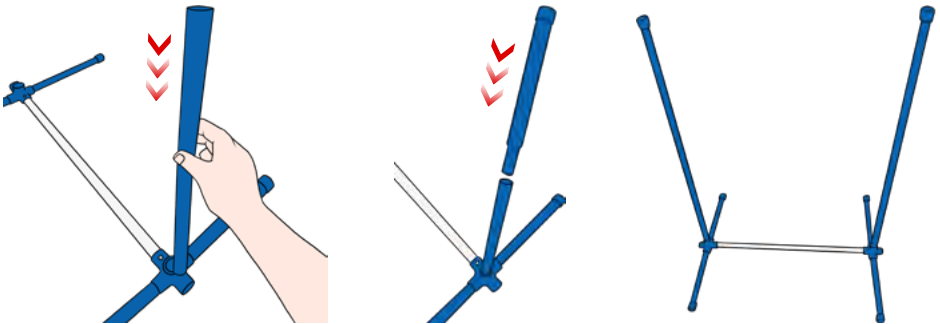

## STEP 3

### ATTACHING THE FLAGS TO THE POLES

Take an Orange Flag (I); you'll see it has a loop at the tip. Place this loop over one of the standing poles, then slide it down the pole to secure it in place with the Velcro near the standing pole.

Repeat the same procedure with the second Orange Flag on the opposite side. Ensure that the flags are positioned on the outer part of the frame, as shown in the picture.





## STEP 4

### SECURING THE FLAGS ONTO THE BLUE BASE POLE EXTENSIONS

Each Orange Flag (I) features a dedicated space (hole) at the bottom where you should insert the blue base pole extensions (L).

After inserting the poles into the bottom of the flag, connect them to the rest of the frame using the outer hole at the base Cross-shaped pole, following the illustration.

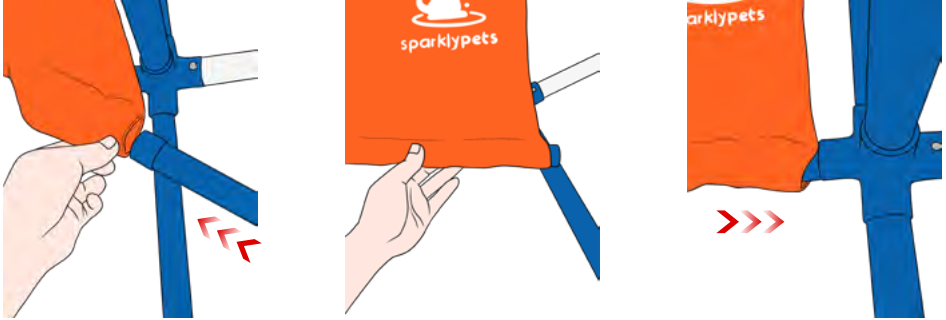

## STEP 5

### SECURING THE SPARKLYPETS AGILITY FRAME WITH GROUND PEGS

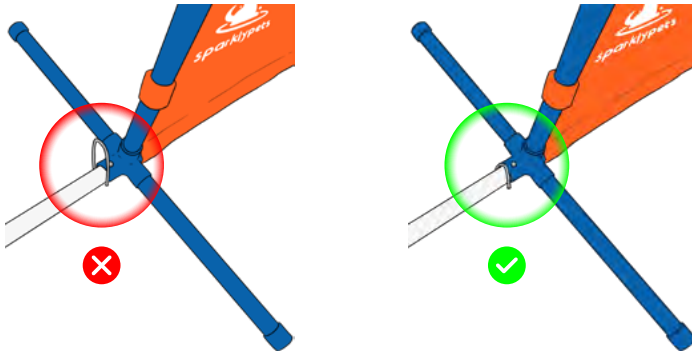

If feasible, anchor the frame to the ground using U-shaped pegs (H). Position them within the interior of the base, near the Cross-shaped junctions, as depicted in the picture.

**!** **WARNING!** Ensure that the ground pegs are firmly driven into the ground to prevent injuries during course usage. Please refer to the picture for visual guidance.

## CONFIGURING THE DOG AGILITY HURDLE JUMP ON THE SPARKLYPETS AGILITY FRAME



- 1 x SparklyPets Agility Frame (made in previous steps)
- 2 x Jump hurdle connectors (O)
- 1 x White hurdle bar V1 (P)
- 1 x White hurdle bar V2(Q)



SparklyPets Agility Frame

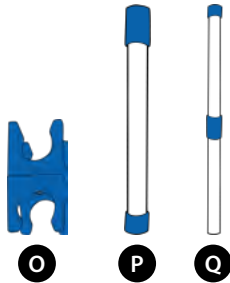

### HOW TO UTILIZE A DOG AGILITY HURDLE?

While you often spot them in agility competitions, you don't need to be part of a formal show to enjoy them with your dog. In essence, dog hurdles are exactly what they sound like – obstacles that dogs leap over.

Dog Agility Hurdles are suitable for dogs of all sizes, from small to large. The key consideration is adjusting the jump bar to an appropriate height based on your dog's jumping ability.

For newcomers, we suggest positioning the jump hurdle just below your dog's elbow. Now, kickstart your training sessions and enjoy some outdoor fun in your backyard!

## SIZE SPECIFICATION

Adjustable hurdle jump ranging from 3.9 inches to 35 inches

### STEP 1

#### ASSEMBLING THE HURDLE BAR

Grab the two White hurdle bars, labeled P and Q, and connect them as illustrated in the picture.

### STEP 2

#### ATTACHING THE JUMP HURDLE CONNECTORS TO THE STAND POLES

Position the Jump Hurdle connectors (O) onto the standing poles, ensuring they are placed behind the flags, as shown in the picture.

### STEP 3

#### ATTACHING THE HURDLE BAR TO THE FRAME

Now, take the hurdle bar you assembled earlier and secure it onto the two hurdle connectors (O).

Step back and ensure the connectors are at an even height, and the hurdle is horizontally straight.

Depending on your dog's jumping ability, adjust the connectors up or down on the standing poles for the appropriate jump height.

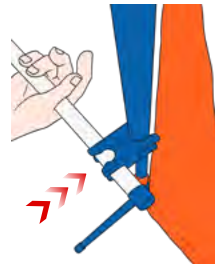
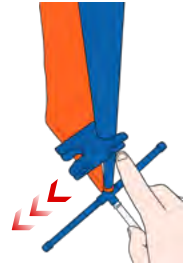
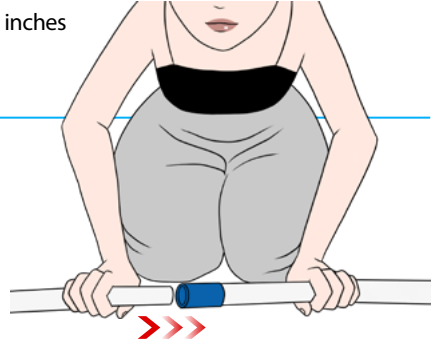

## CONFIGURING THE DOG AGILITY TIRE JUMP ON THE SPARKLYPETS AGILITY FRAME



**NOTE:** Before proceeding to the next steps, please remove the hurdle jump bar and its connectors from the frame.

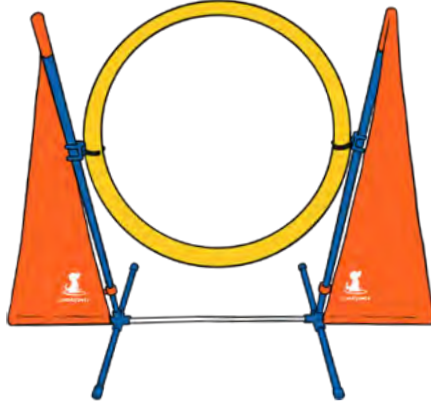

- 1 x SparklyPets Agility Frame (made in previous steps)
- 2 x Tire Jump connectors (R)
- 2 x Orange hose (S)



SparklyPets Agility Frame



R



S

### HOW TO UTILIZE A DOG AGILITY TIRE JUMP?

The tire jump, also known as the agility ring, is a professional-level agility course obstacle, essentially an advanced variation of the jump hurdle bar. As its name suggests, the tire jump resembles a tire and is constructed from hoses placed within a frame to create a sizable hoop for your dog to leap through.

### SIZE SPECIFICATION

Tire jump diameter: 20 inches

## STEP 1

### BUILDING THE RING WITH THE ORANGE HOSES

Take the two orange hoses (S) and join them by inserting the narrower end of one hose into the wider end of the other, following the illustration.



## STEP 2

### SHAPING THE HOSE CIRCLE INTO A ROUNDER FORM

Begin twisting and bending the orange circle to give it a more rounded shape, as depicted in the picture.

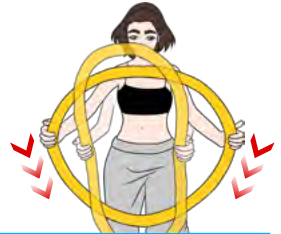

## STEP 3

### ATTACHING THE TIRE JUMP CONNECTORS TO THE STAND POLES

Position the Tire Jump connectors (R) onto the standing poles, ensuring they are placed inside the frame, as shown in the picture.



## STEP 4

### ATTACHING THE TIRE JUMP TO THE FRAME

Now, take the orange circle you assembled earlier and attach it to the two tire jump connectors (R). Step back and ensure that the connectors are evenly positioned.

Adjust the connectors up or down on the standing poles, depending on your dog's jumping ability, to enable them to jump through the circle.

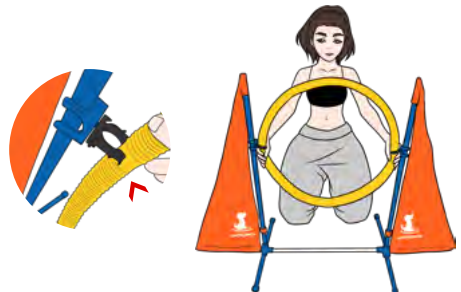

## CONFIGURING THE SPARKLYPETS JUMP OVER AND UNDER ELEMENT

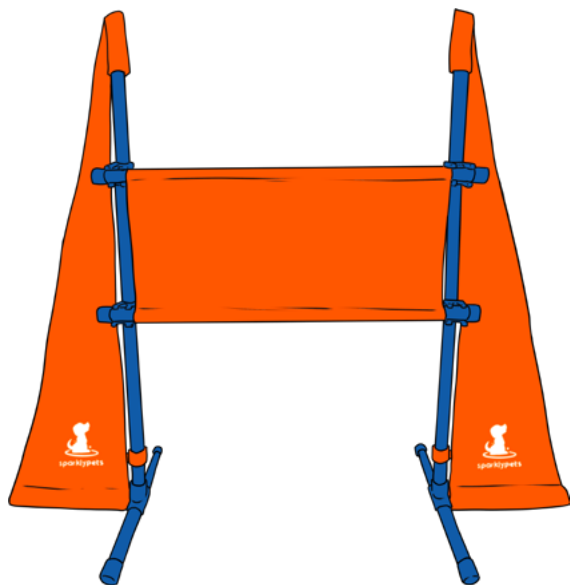

This element boasts a unique feature that can significantly enhance your dog's focus and decision-making abilities by compelling them to choose between jumping over or going under it.

You have the flexibility to adjust the element to suit your preferences. Lower the wall if you want to encourage your dog to leap over it, or raise the wall if you prefer them to duck underneath.

The Jump Over and Under element is designed to accommodate dogs of all sizes, from small to large. The crucial factor is to adapt the wall height to match your dog's jumping capability.

For those just starting their agility journey, we recommend setting the wall lower to teach them to Jump Over. Conversely, raise the wall if you wish to train them to go Under.

## PREPARING THE SPARKLYPETS JUMP OVER AND UNDER ELEMENT

- 2 x SparklyPets Orange Flags (I)
- 2 x Blue base pole extensions (L)
- 2 x Blue stand pole for the lower side (M)
- 2 x Blue stand pole for the upper side (N)
- 2 x U-shaped ground pegs (H)
- 4 x Jump Hurdle Connectors (O)
- 2 x L-shaped blue base pole with blue caps (T)
- 2 x Hurdle blue bars with caps on both sides (U)
- 1 pc x Orange wall fabric (V)



I



V



L



M



N



H



O



U



T

### SIZE SPECIFICATIONS

Wall Size: 21 inches in width and 10 inches in height



## STEP 1

### ASSEMBLING THE POLE BASES FOR THE FRAME

To begin, locate the bag with the red string. Within this bag, you'll find the components for constructing the Jump over and Under Element.

To construct the bases that will provide stability for the frame, take the L-shaped blue base poles with blue caps (T) and attach the standing poles to them. Commence with the Blue stand pole for the lower side (M), then position the Blue stand poles for the upper side (N) on top of them. Once this step is complete, set the bases aside temporarily and proceed to the next step.

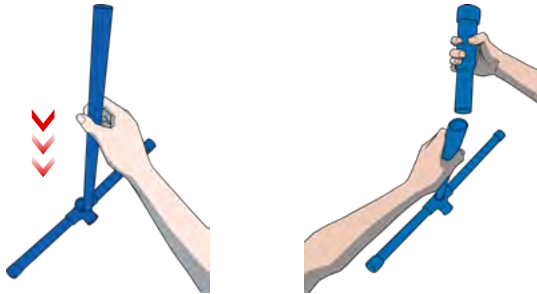

## STEP 2

### CONSTRUCTING THE FABRIC WALL

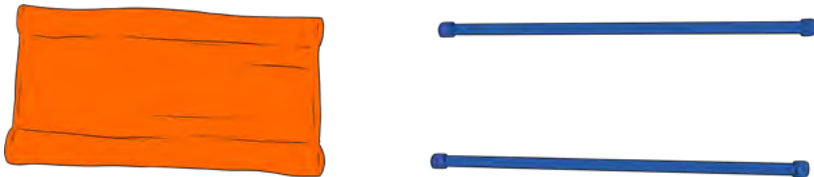

Thread two Hurdle blue bars with caps on both sides (U) through the Orange fabric wall (V) openings following the illustration.

## STEP 3

### ATTACHING THE WALL TO THE FRAME

Begin by retrieving one of the constructed bases and fitting a Jump Hurdle Connector (O) onto the standing pole. Next, grab the upper hurdle bar of the assembled wall fabric and attach it to the base frame by the Hurdle Connector (O). Repeat this process on the other side by taking the second constructed base, attaching the Hurdle Connector (O), and securing the opposite side of the wall fabric.

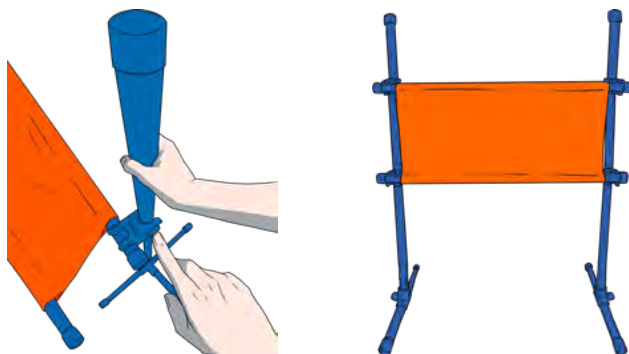

Upon completing the placement of the upper bar wall fabric, continue by fitting below the next Jump Hurdle Connectors (O) and then replicate the previous steps for the upper section. As a result, your element at this stage will resemble the illustration.

#### STEP 4

### ATTACHING THE FLAGS TO THE POLES

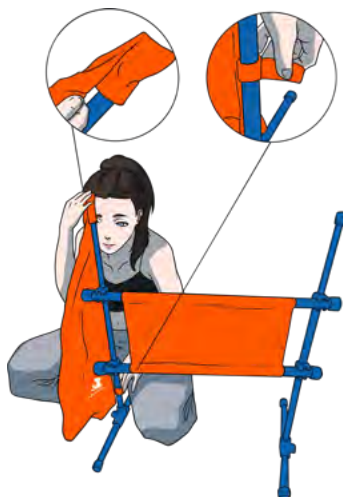

Take an Orange Flag (I) from the main box; you'll see it has a loop at the tip. Place this loop over one of the standing poles, then slide it down the pole to secure it in place with the Velcro near the standing pole.

Repeat the same procedure with the second Orange Flag on the opposite side.

Ensure that the flags are positioned on the outer part of the frame, as shown in the picture.

## STEP 5

### SECURING THE FLAGS AND THE BLUE BASE POLE EXTENSIONS

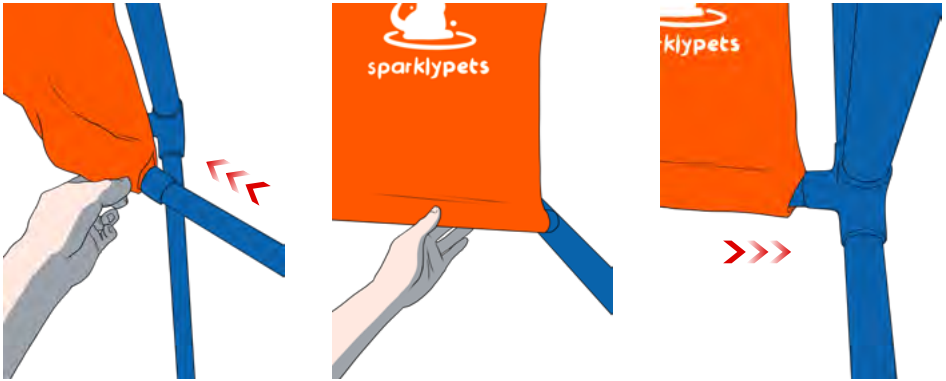

Each Orange Flag (I) features a dedicated space (hole) at the bottom where you should insert the blue base pole extensions (L).

After inserting the poles into the bottom of the flag, connect them to the rest of the frame using the outer hole at the base Cross-shaped pole, following the illustration.

## STEP 6

### SECURING THE JUMP OVER AND UNDER ELEMENT WITH GROUND PEGS

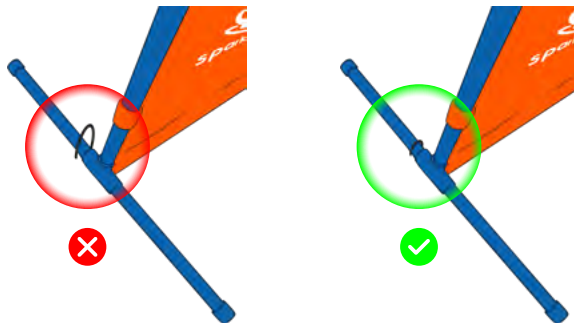

If feasible, anchor the frame to the ground using U-shaped pegs (H). Position them on the L-shaped base, as depicted in the picture.

**!** **WARNING!** Ensure that the ground pegs are firmly driven into the ground to prevent injuries during course usage. Please refer to the picture for visual guidance.

# 'What it is and what you need to know'

Do you imagine yourself and your dog on one of those dog agility contests that are fun to watch?

**IF YOU ARE, YOU'RE NOT ALONE!**

Considering agility training can have many long-term benefits for your pup, so why not give it a try?

Let's explore what agility actually is, what it helps with and what you need to know before you make the decision to train your dog for agility.

### WHAT IS DOG AGILITY?

To put it simply, dog agility is a sport. To put it in more details, it's a obstacle course race where a handler and a dog try to complete a preset track filled with different obstacles like tunnels, seesaws or weave poles. The team has to do this in a time efficient manner while having coordination and efficacy in mind as well.

The handler, or the owner, should be able to have complete control over the dog's actions, without having to incentivize him or her with treats or rewards. Actually, throughout the competition, the handler is only allowed to use voice commands and gestures to help their dog overcome all of the obstacles. The owner is not allowed to touch neither the dog nor the obstacles throughout the entire race.

### HOW DOES DOG AGILITY HELP MY DOG?

Dog agility can be to a dog what a puzzle is to a human. It can spark interest and boost brain functions. It's an interesting way of exploring curiosity and improving mental health, for one. It's also a good way to get rid of boredom and keep yourself and your dog entertained.

On the other hand, dog agility is a good way to have your dog stay in shape. After all, it's a sport, right? All that jumping and running around is bound to increase muscle strength and speed and keep your pup in tip top shape.

Another benefit is that it can work on improving your bond with your dog. Your dog will learn to trust you and that will in turn improve the bond that you two have. This will not only make both your lives easier, but also more fun, as you'll rely on one another for various activities.

Last but not least, it will improve your dog's behavior. Because this sport is so reliant on dogs listening to their handler's commands, it will inevitably lead to your dog having an increased response to your commands, especially when it comes to obedience training.

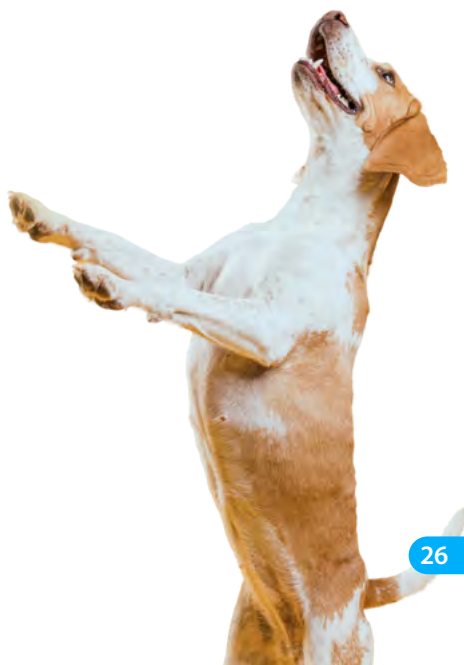

# DOG AGILITY

## WHAT DO I NEED TO KNOW BEFORE STARTING TRAINING?

There are a few things you need to take into account before you start working with your dog to compete in dog agility courses.

- Check in with your vet first. Your dog should be clinically healthy in order to be able to complete the course safely and for this type of exercise to be beneficial to him or her.
- Investigate any known medical conditions specific to each breed. For example, some dog breeds tend to have back problems or posture problems, which is why veterinarians usually recommend that they avoid jumping. In this case, a dog agility course would not prove to be beneficial for your dog.
- Master the basics. Before you even consider taking up dog agility training, you and your dog must have a strong hold on the basic obedience commands, such as stay, sit and come. Only after these are achieved without the help of treats or incentives, you can start thinking about dog agility.
- Make sure your dog has a good attention span to start with. You will need to improve your dog's attention span as you progress, but you also need to make sure it's at a good starting point before you begin. Otherwise, your dog might get distracted and won't listen to your vocal commands throughout the race.
- Make sure your dog can do an array of movements. The obstacles will require your dog to have increased mobility and understanding of how his or her body moves. This means that before you start working on agility training, you need to do some basic training to teach your dog to jump, walk backwards, position paws in different places or walk in between objects.
- Keep in mind your dog's energy levels. Because this is such a time efficient sport, your dog will need to move quickly. So, regardless of whether you have a small breed dog or a large one, make sure your dog is naturally energetic. A slower-moving dog might not do well with a time crunch.



*All things considered, dog agility races have a lot of benefits for both you and your dog and, if all requirements are met. You can have a lot of fun while doing this type of activity. Would you consider dog agility training?*

# 5 DOG BREEDS THAT NEED A LOT OF EXERCISE



Just like us, dogs come in many shapes and sizes. Some dogs need more exercise, some need bigger meals, some are perfect for cuddling on the couch on a rainy day. And sure, some of these traits come from each dog's personality, but some are breed specific.

If you're looking to get a new pup, make sure you can keep up with his exercise needs and make sure he can keep up with yours! Here are some of the breeds that need more exercise, so that you can take this into account if you're considering them as a pet.

## BORDER COLLIE

Border Collies are excellent sheep herders, extensively used in Australia for this reason, along with the Australian Shepherd Dog. Being herder, this type of dog is accustomed to running long distances to make sure the herds stay together.

Because of their herding nature, Border Collies excel at training commands, so Lassie will be an excellent competitor in dog agility competitions.

This is one of the types of breeds that has a lot of stamina and energy, so make sure you provide at least 60 minutes of intense exercise per day.

## GOLDEN RETRIEVER

Everyone's favorite, the Golden Retriever needs to...well...retrieve! They are very well capable of keeping up with you on a hike, on a run or when you're on a casual walk.

Playing fetch is also a great option for a Golden Retriever, since retrieving is one of their favorite activities.

Make sure to get up to 2 hours of quality exercising every day, to keep them happy and healthy.

## GERMAN SHEPHERD

The German Shepherd is THE breed you think about when thinking Police Dog, or Military Dog, or Bomb Detection Dog. They are very easy to train, which can make them very good at what they do. If you think about it, a police dog might run to catch an assailant, or attack a bad person at their human officer's command, so they really need to be in good shape.

Regardless of whether your Rex is in the force or not, you still need to make sure you get at least a full hour of moderate and high intensity workouts for him to spend some energy.

## ALASKAN MALAMUTE

Just like the Siberian Husky, the Alaskan Malamute is a dog breed for working. If you can grasp that the dog's main working purpose was to pull on a heavy sleigh through huge amounts of snow, in the cold, for thousands of miles at a time, then you can imagine that such a breed would require a lot of exercise to burn off some of that energy.

Ideal for an athlete owner, this breed requires at least 60 minutes of intense exercise per day, but you can safely go up to 2 hours of exercising daily.

## POINTER

As with the other breeds we've mentioned in our article so far, the pointer was bred with hunting abilities in mind, as the name might suggest. That means this dog breed, and others that are similar, need to be agile, fast runners so that they can catch up with the hunted prey (either ducks or rabbits, deer and so on) and lead their owner, the hunter, to it. Depending on the prey, they would need to be quick, slim and fast on his feet.

While you can adjust his form from the foods he's consuming, you also need to adjust his energy levels making sure they exercise on a daily basis. Aim for 60 to 90 minutes of medium or high intensity exercises each day, whether it's an intense hike, jogging or just a plain walk.

As you can see, there's a lot of things you should consider when it comes to picking the right pup for you. That being said, if you're an active person or an athlete, and you want to involve your doggo in your workouts, consider one of the breeds we mentioned above, or here are some other good options as well: Akita, Schnauzer, Rottweiler, Doberman, Bloodhound, Jack Russel Terrier, Labrador and many more. Regardless of what you decide to get in the end, make sure that you can commit to offering them the amount of exercise they need to live happy and healthy lives.

# SPARKLYPETS AGILITY COURSE BLANK GRID

FOR 40 FT BY 50 FT

Utilize this grid to sketch your personalized dog agility course, employing the elements included in this set and adjusting their placement as desired.

Note that you have the flexibility to arrange them as you see fit, and there's no obligation to incorporate all the elements if your dog is new to agility training.

10	20	30	
40			40
30			30
20			20
10			10
10	20	30	



---

---

---



# SPARKLYPETS AGILITY COURSE BLANK GRID

FOR 40 FT BY 50 FT

Utilize this grid to sketch your personalized dog agility course, employing the elements included in this set and adjusting their placement as desired.

Note that you have the flexibility to arrange them as you see fit, and there's no obligation to incorporate all the elements if your dog is new to agility training.

	10	20	30	
40				40
30				30
20				20
10				10
	10	20	30	



---

---

---

# SPARKLYPETS AGILITY COURSE BLANK GRID

FOR 80 FT BY 100 FT

Utilize this grid to sketch your personalized dog agility course, employing the elements included in this set and adjusting their placement as desired.

Note that you have the flexibility to arrange them as you see fit, and there's no obligation to incorporate all the elements if your dog is new to agility training.

	10	20	30	40	50	60	70	
90								90
80								80
70								70
60								60
50								50
40								40
30								30
20								20
10								10
	10	20	30	40	50	60	70	



---

---

---

# SPARKLYPETS AGILITY COURSE BLANK GRID

FOR 80 FT BY 100 FT

Utilize this grid to sketch your personalized dog agility course, employing the elements included in this set and adjusting their placement as desired.

Note that you have the flexibility to arrange them as you see fit, and there's no obligation to incorporate all the elements if your dog is new to agility training.

	10	20	30	40	50	60	70	
90								90
80								80
70								70
60								60
50								50
40								40
30								30
20								20
10								10
	10	20	30	40	50	60	70	



---

---

---

THE SPARKLYPETS  
AGILITY DIPLOMA



**THIS CERTIFICATES THAT**

CHAMPION'S NAME

---

CHAMPION'S BREED NAME

---

HAS BEEN OFFICIALLY RECORDED AS A

**BACKYARD AGILITY DOG EXPERT**

RAISED BY  
OWNER'S NAME

---

THE DIPLOMA  
WAS RECEIVED ON

---

CERTIFIED AND PAW APPROVED BY  
SPARKLY FROM SPARKLYPETS





### WARRANTY

As a testament to our confidence in our products, each product is backed by a 3-year warranty from the date of purchase.



### WARNING

Failure to adhere to these instructions may lead to severe injury for both you and your dogs.

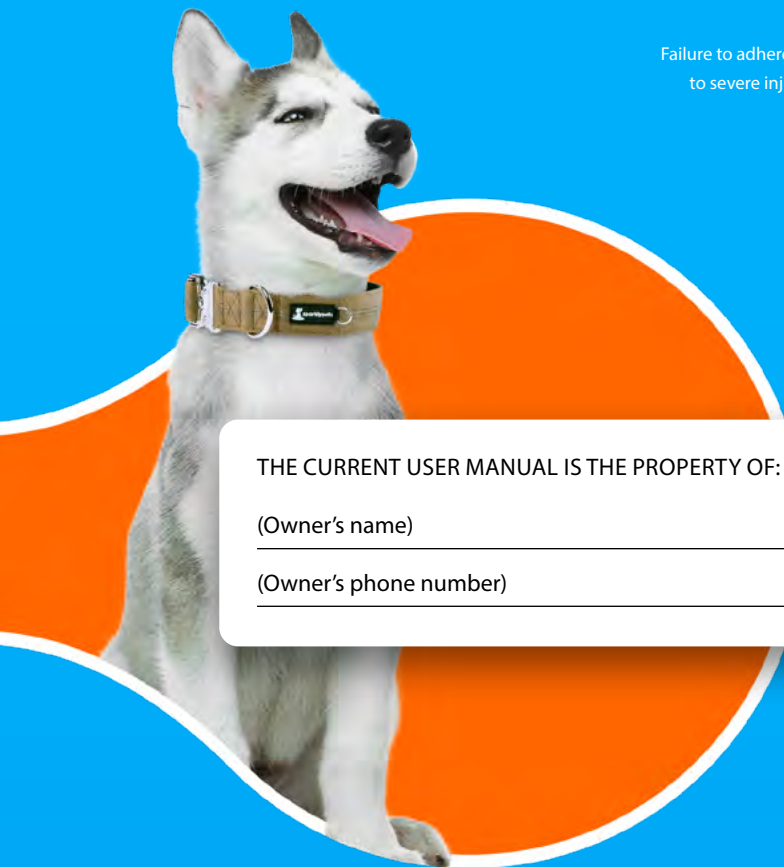

THE CURRENT USER MANUAL IS THE PROPERTY OF:

(Owner's name)

---

(Owner's phone number)

---



## CONTACT

For support, inquiries, or suggestions for improvement, please reach out to us via e-mail at [info@sparklypets.com](mailto:info@sparklypets.com) or at +1(252) 220-0094.

© Copyright Sparkly Innovation. SparklyPets and all associated logos are trademarks.