

# sparklypets

[WWW.SPARKLYPETS.COM](http://WWW.SPARKLYPETS.COM)

SIGN IN AND GET A 10% DISCOUNT COUPON ON YOUR NEXT SPARKLYPETS ORDER! (PAGE 1 - 2)

## DOG AGILITY SET

### The User Manual Magazine



#### USER MANUAL GUIDELINE

Learn how to use and set your new SparklyPets Agility Set in a fun way!

PAGE 03

#### BONUS!

For more free training tips follow this link:

[WWW.SPARKLYPETS.COM/BONUS](http://WWW.SPARKLYPETS.COM/BONUS)



#### DOG AGILITY

What it is and what you need to know.

ARTICLE AT PAGE 18

#### 5 DOG BREEDS THAT NEED A LOT OF EXERCISES

ARTICLE AT PAGE 20

#### EXCLUSIVE

**sparklypets**

recommendations for Dog Agility Course Layouts.

PAGE 21

#### UNIQUE TEMPLATES!

Five blank agility course sheets for your own agility course build!

PAGE 23



...AND MUCH MORE INTERESTING STUFF!



# sparklypets

## LEASHES



HANDS-FREE LEASH

HANDS-FREE LEASH FOR TWO DOGS

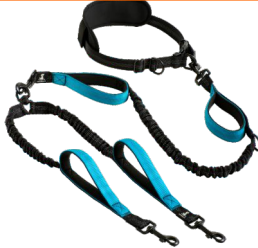

PREMIUM HANDS-FREE LEASH



ROPE LEASH



ROPE LEASH FOR TWO DOGS

TWO DOGS BUNGEE EXTENSION



TWO DOGS ADJUSTABLE BUNGEE EXTENSION

DOUBLE HANDLE LEASH



SUBSCRIBE TO OUR NEWSLETTER AND GET A **10%** DISCOUNT COUPON ON YOUR NEXT SPARKLYPETS ORDER.



# sparklypets

## BARK COLLARS



**2 PACK BARK COLLARS NO SHOCK**  
(BATTERY VERSION)



**2 PACK BARK COLLARS NO SHOCK**  
(RECHARGEABLE VERSION)



**RECHARGEABLE BARK COLLAR**  
**WITH SHOCK Q9**



**RECHARGEABLE BARK COLLAR**  
**NO SHOCK V1**



SUBSCRIBE TO OUR NEWSLETTER AND GET A **10%**  
DISCOUNT COUPON ON YOUR NEXT SPARKLYPETS ORDER.



Learn how to use and set your new **sparklypets AGILITY SET** in a fun way!



## USER MANUAL GUIDELINE

### SETTING THE DOG AGILITY PAUSE BOX

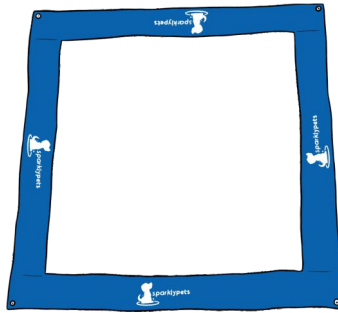

1 X DOG AGILITY PAUSE BOX (A)

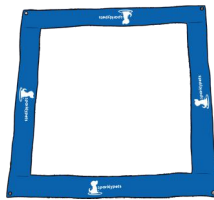

4 X GROUND PEGS (B)



#### HOW TO USE A DOG AGILITY PAUSE BOX?

The pause box or pause table is a great way to teach your dog where to stop and rest on the agility course in a controlled way. You will find the pause box in most agility courses.

In comparison with a pause table, if you don't have enough space, the pause box is a great space-saving, easily transportable, and inexpensive alternative.

Set your pause box in the middle of your agility course to teach your dog to lie down, stop, or just sit inside the designated square.



#### SIZE SPECIFICATIONS

When stretched occupies 10 ft<sup>2</sup>



# 1 STEP 1 - PLACING THE PAUSE BOX ON THE GROUND

Choose a flat open ground space and place the Pause Box (A) with the SparklyPets logo sides on the exterior, as in the picture.

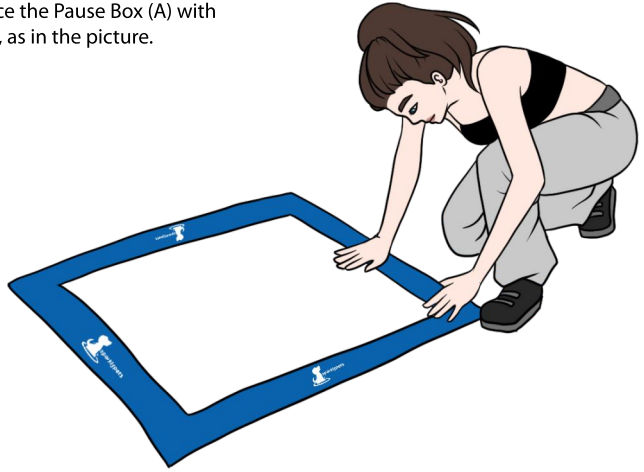

# 2 STEP 2 - FIXING THE PAUSE BOX WITH GROUND PEGS

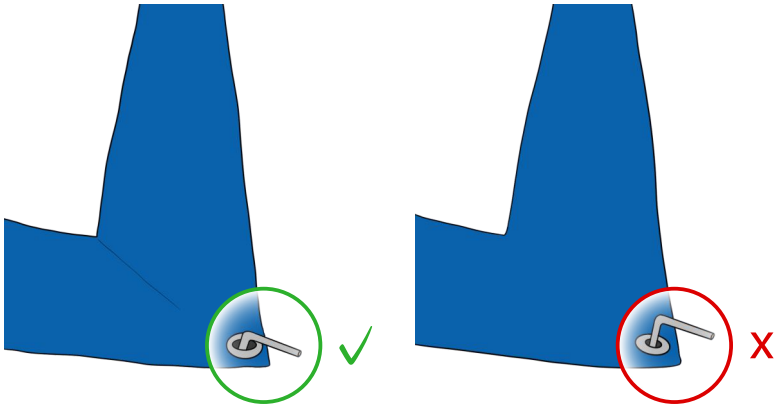

Now, if it's possible, fix the Pause Table to the ground by grounding it in 4 pegs (B) in each designated corner.



The ground pegs need to be fixed till the end on the ground to avoid injuries when using the course, please check the picture for reference.



## SETTING THE DOG AGILITY TUNNEL

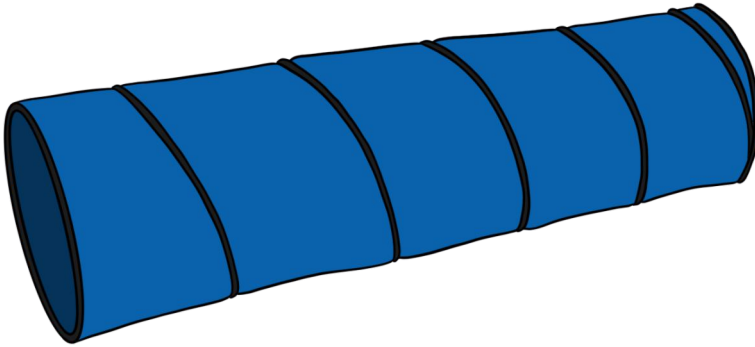

1 X DOG AGILITY TUNNEL (C)

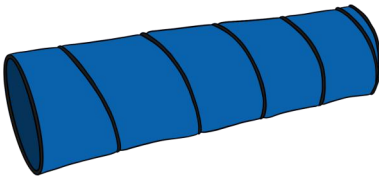

6 X GROUND PEGS (B)



### ? HOW TO USE A DOG AGILITY TUNNEL?

The Dog Agility Tunnel, also called pipe, is one of the most enjoyable obstacles from the agility course for your dog to play with.

Tunnels usually are circular and can range from 4ft to 20ft in length and usually are 24 inches in diameter.

Set your tunnel on your course so that your dog can get through an opening and get out smoothly to the next obstacle from your course.

### SIZE SPECIFICATIONS

6.5 ft, with an opening of 24-inch diameter.



## 1 STEP 1 - STRETCH THE TUNNEL AND PLACE IT IN THE CORRECT POSITION

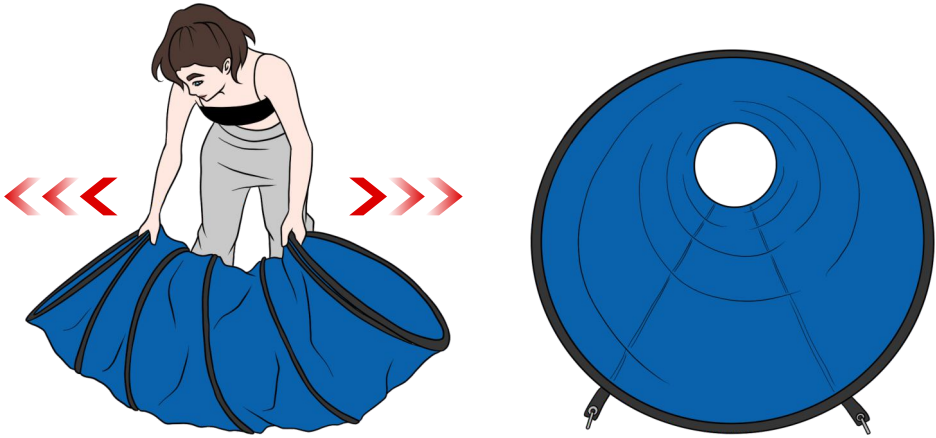

Untie the two laces that keep the Tunnel (C) together and place it on flat open ground space. Make sure that you placed the tunnel correctly, check if the base of the tunnel is at the base of the ground as in the picture.

## 2 STEP 2 - FIXING THE TUNNEL WITH GROUND PEGS

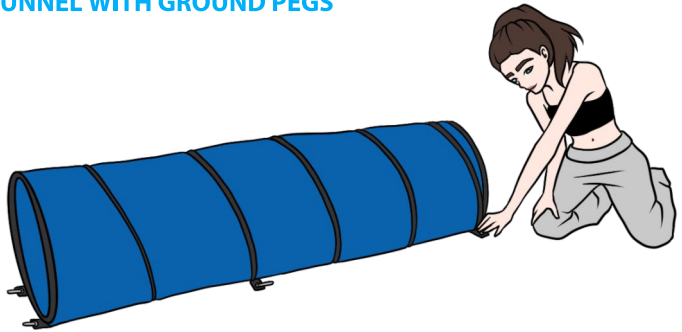

Now, if it's possible, fix the Dog Tunnel (C) to the ground by grounding it in 6 pegs (B), two in front, two at the middle of the tunnel, and two at the end of the tunnel, as in the picture.



The ground pegs need to be fixed till the end on the ground to avoid injuries when using the course, please check the picture for reference.



## SETTING THE DOG AGILITY WEAVE POLES



6 X BLUE WEAVE POLES WITH GRAY CAPS (D)

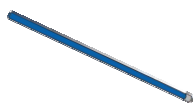

5 X INTERMEDIATE BLUE BASE POLES WITH CLIPS ON BOTH SIDES (E)

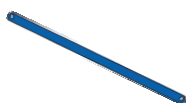

4 X TEE'S SHAPE BLUE BASE POLES WITH GRAY CAPS (F)



2 X L'S SHAPE BLUE BASE POLES WITH GRAY CAPS (G)

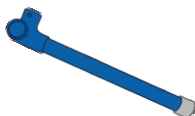

3 X U SHAPED GROUND PEGS (H)

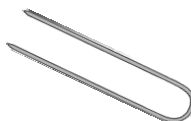

### ? HOW TO USE THE DOG AGILITY WEAVE POLES?

The number of poles used in a Dog Agility Weave Pole set can be between 4 to 12 poles. In main competitions, you will usually find 12 poles spaced between 24 inches apart.

The objective is to teach your dog to zig-zag through the poles till the end and go to the next obstacle of your agility course.

To teach your dog how to zig-zag through the wave poles we recommend a lot of practice that may involve dog treats and patience from you.

### SIZE SPECIFICATIONS

Total Dog Agility Weave pole set length: 9.8 ft

Pole height: 33.4 inches

Length between poles: 24.4 inches





## 1 STEP 1 - START CONNECTING THE BASE POLES FROM ONE DIRECTION

First, we select from the package the components dedicated for this set (D, E, F, G, H). For the setup, we will need a flat open ground space of approximately 32ft<sup>2</sup>.

Always start from one side by connecting first an L's shape base pole (G) by one of the clips of an Intermediate base pole (E). When you hear a 'Click!' sound, it means that you correctly connected them.

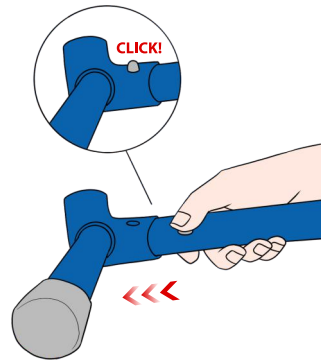

## 2 STEP 2 - CONTINUE BY ADDING THE SUPPORT BASE POLES IN A ZIG-ZAG FORM

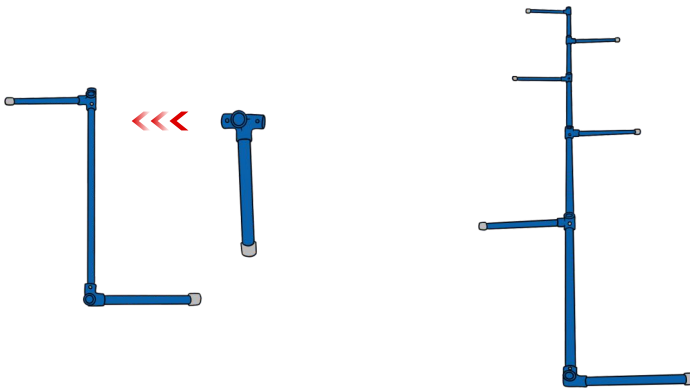

Now clip by the other end of the intermediate base pole (E) in a zig-zag position a Tee shape base pole (F).

Continue to add intermediate base poles (E), then connect them by Tee shape base poles (F), till you reach the end, where you will add the last L shape base pole (G), as in the picture.



### 3 STEP 3 - ATTACH THE WEAVE POLES TO THE BASE OF THE SET

Once the base is ready, it's time to attach the standing wave poles (D) to the base of the set.

Each junction of the base L or Tee shape pole has a hole on it, now easily place the wave poles into the holes.



### 4 STEP 4 - FIXING THE DOG AGILITY WEAVE WITH GROUND PEGS

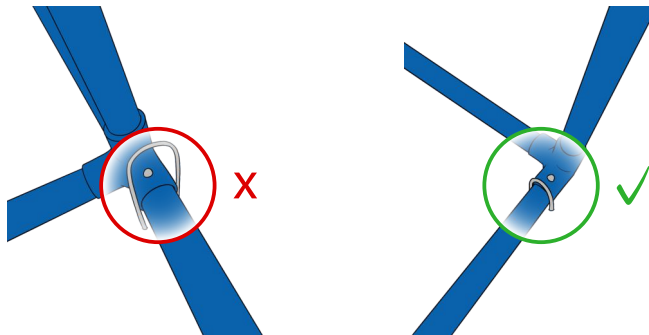

Now, if it's possible, fix the Dog Agility Weave poles set to the ground by grounding them with U-shaped pegs (H), one in front, one at the middle of the set, and one at the end, as in the picture.



The ground pegs need to be fixed till the end on the ground to avoid injuries when using the course, please check the picture for reference.



# SETTING THE DOG AGILITY TIRE JUMP OR THE DOG AGILITY HURDLE JUMP

This unique SparklyPets Dog Agility set combines two agility obstacles equipment into one frame. Depending on your preferences and your dog's agility experience, you can either mount the Dog Agility Tire Jump or the Dog Agility Hurdle Jump.

For beginners, we recommend setting first the Dog Agility Hurdle Jump, and once your dog masters it, you can go for the Dog Agility Tire Jump. In the next steps, you will first be shown how to set up the SparklyPets Agility Frame for the sets, and after that, we will continue to add the elements for the specific ones, first for the Dog Agility Jump Hurdle and after that for the Dog Agility Tire Jump.

## SETTING THE DOG AGILITY FRAME

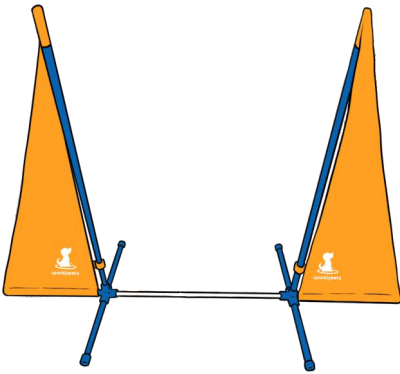

### SIZE SPECIFICATIONS

Stand poles size: 40 inches  
Interior jump space size: 26 inches

**2 X ORANGE FLAGS FOR THE LEFT SIDE AND RIGHT SIDE (I)**



**1 X INTERMEDIATE WHITE BASE POLE WITH CLIPS ON BOTH SIDES (J)**



**2 X CROSS SHAPE BLUE BASE POLE WITH BLUE CAPS (K)**

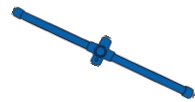

**2 X BLUE BASE POLE EXTENSIONS (L)**



**2 X BLUE STAND POLE FOR THE LOWER SIDE (M)**

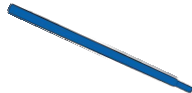

**2 X BLUE STAND POLE FOR THE UPPER SIDE (N)**

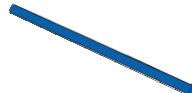

**2 X U SHAPED GROUND PEGS (H)**



## 1 STEP 1 - SETTING THE BASE OF THE FRAME

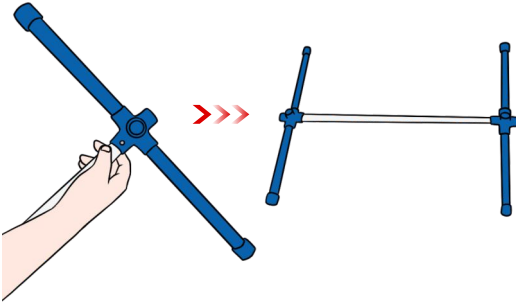

Grab the Intermediate white base pole (J) and connect on each end a Cross shape blue base (K), When you hear a 'Click!' sound, it means that you correctly connected them.

For this setup, you will need a flat open space.

## 2 STEP 2 - ATTACH THE STANDING POLES TO THE BASE OF THE FRAME

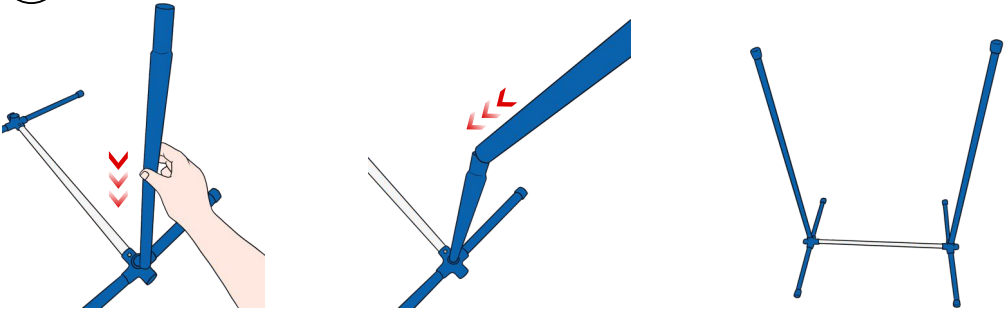

Once the base of the frame is ready, it's time to attach the standing poles to the base.

The junctions of the base Cross shape pole have a hole on them. Place into the holes first the blue stand pole for the lower side (M), then on top of them the blue stand pole for the upper side (N).

## 3 STEP 3 - ADDING THE FLAGS ON THE POLES

Grab an Orange Flag (I), you will notice that it has a loop in the tip, place that loop over one of the standing poles, now slide down the pole to attach the velcro by the standing pole as well.

Repeat the same process with the second Orange Flag on the other side as well. Make sure that the flags are on the exterior part of the frame, as in the picture.

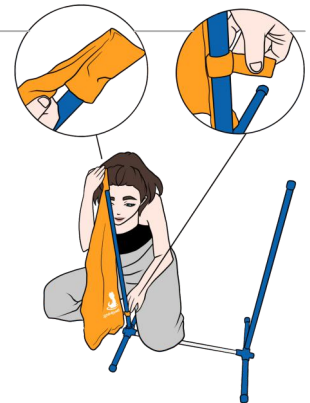

#### 4 STEP 4 - FIXING THE FLAGS ON THE BLUE BASE POLE EXTENSIONS

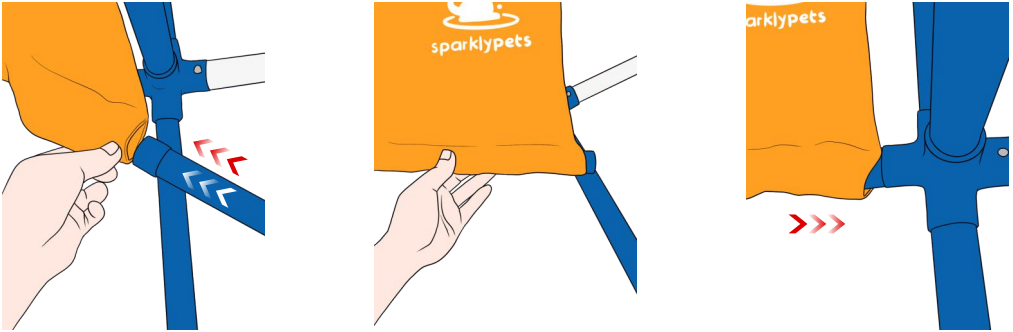

Each Orange Flag (I) has at the bottom a dedicated space (hole) where you need to introduce the blue base pole extensions (L).

Once you have inserted the poles into the area from the bottom of the flag, connect them to the rest of the frame by the outer hole at the base Cross shape pole, as in the picture.

#### 5 STEP 5 - FIXING THE SPARKLYPETS AGILITY FRAME WITH GROUND PEGS

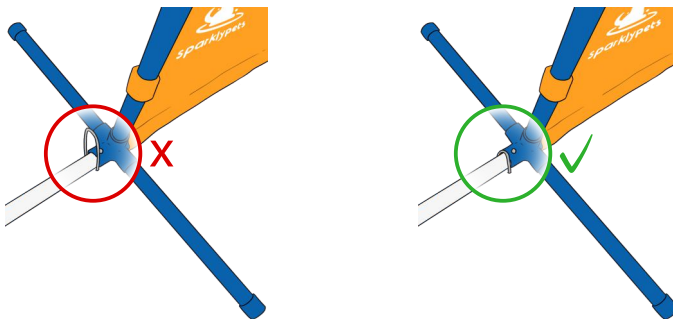

Now, if it's possible, fix the frame to the ground by grounding them with U-shaped pegs (H). Place them in the interior of the base close to the Cross shape junctions, as in the picture.



The ground pegs need to be fixed till the end on the ground to avoid injuries when using the course, please check the picture for reference.



## SETTING THE DOG AGILITY HURDLE JUMP ON THE AGILITY FRAME

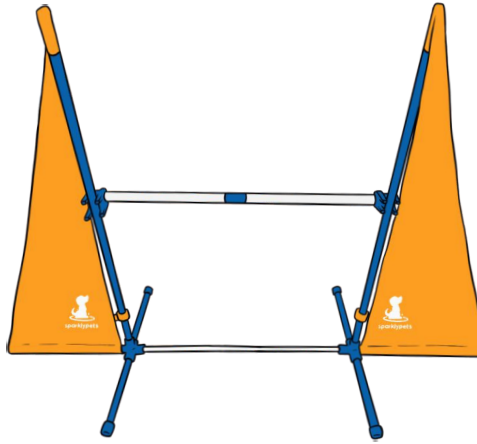

**1 X SPARKLYPETS  
AGILITY FRAME**  
(MADE IN PREVIOUS STEPS)

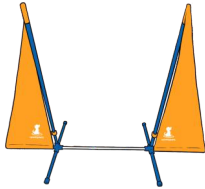

**2 X JUMP HURDLE  
CONNECTORS (O)**



**1 X WHITE  
HURDLE BAR V1 (P)**



**1 X WHITE  
HURDLE BAR V2(Q)**



### HOW TO USE THE DOG AGILITY WEAVE POLES?

You can see them in all agility competitions, but of course, you don't need to participate in a show to use them with your dog. To keep it simple, dog hurdles are what they sound like, hurdles that dogs jump over.

Dog Agility Hurdles are suited for all dog breeds, from small to big. The only aspect you need to keep in mind is setting the jump bar at an optimum position based on your dog's jumping experience. For beginners, we recommend placing the jump hurdle below your dog's elbow.

*Now, start your training and have fun in your backyard!*



### SIZE SPECIFICATIONS

Adjustable hurdle jump size between 3.9 inches to 38 inches



## 1 STEP 1 - SETTING THE HURDLE BAR TOGETHER

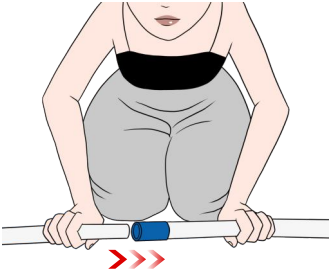

Grab the two White hurdle bars, the P and Q ones, and connect them like in the picture.

## 2 STEP 2 - PUT THE JUMP HURDLE CONNECTORS ON THE STAND POLES

Place the Jump hurdle connectors (O) on the standing poles.

Make sure you position them at the back of the flags, as in the picture.

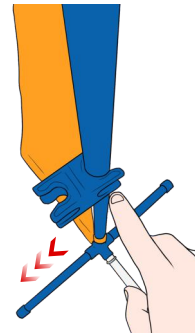

## 3 STEP 3 - ADDING THE HURDLE BAR ON THE FRAME

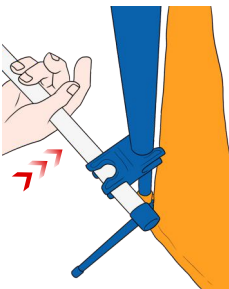

Now take the hurdle bar you just made and fix it on the two hurdle connectors (O).

Take a step back and look if the connectors are even and the hurdle is straight horizontal.

Depending on your dog's jumping experience, slide the connectors down or up the standing poles for him to jump.



## SETTING THE DOG AGILITY TIRE JUMP ON THE AGILITY FRAME

**NOTE!** Please detach the hurdle jump bar and its connectors from the frame, before going to the next steps.

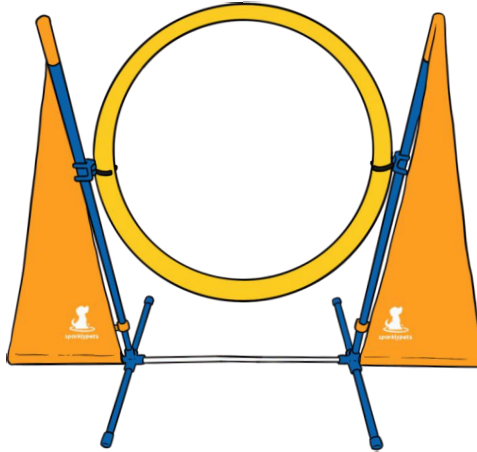

**1 X SPARKLYPETS  
AGILITY FRAME**  
(MADE IN PREVIOUS STEPS)

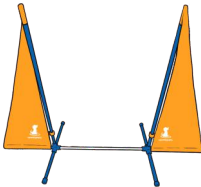

**2 X TIRE JUMP  
CONNECTORS (R)**

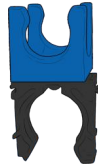

**2 X ORANGE HOSE (S)**



### ? HOW TO USE A DOG AGILITY TIRE JUMP?

The tire jump or agility ring is a pro agility course obstacle, basically is an advanced jump hurdle bar.

Resembles a tire, therefore the name tire jump, that is constructed from hoses that are placed in the middle of a frame to make a large hoop through which your dog jumps.

### SIZE SPECIFICATIONS

Tire jump diameter: 24 inches





**1 STEP 1 - CONSTRUCTING THE RING, FROM THE ORANGE HOSES**

+

**2 STEP 2 - FLEXING THE HOSE CIRCLE TO BECOME MORE ROUND**

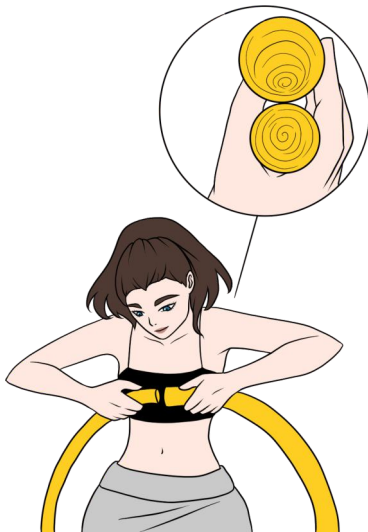

**1** Grab the two orange hoses (S), and connect them together by inserting the smaller end of the hose through the wider hose end, like in the picture.

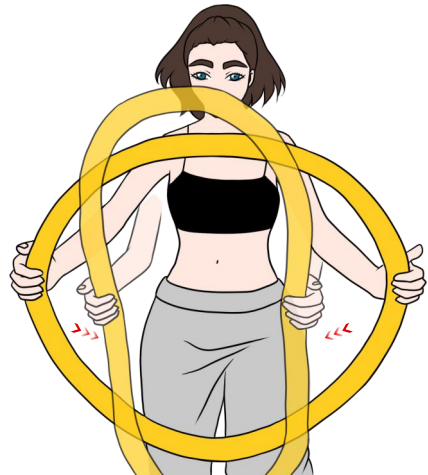

**2** Start twisting and flexing the orange circle to form a more rounded shape, like in the picture.

**3 STEP 3 - PUT THE TIRE JUMP CONNECTORS ON THE STAND POLES**

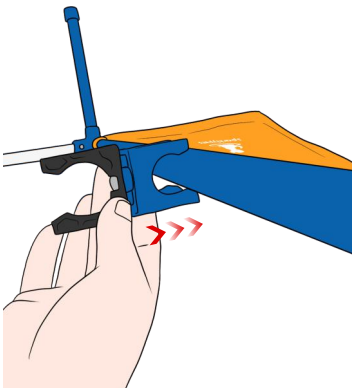

Place the Tire Jump connectors (R) on the standing poles.

Make sure you position them in the interior of the frame, as in the picture.



## 4 STEP 4 - ADDING THE TIRE JUMP ON THE FRAME

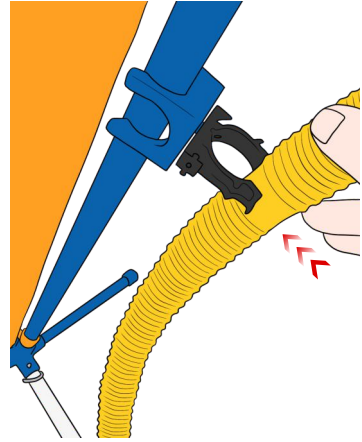
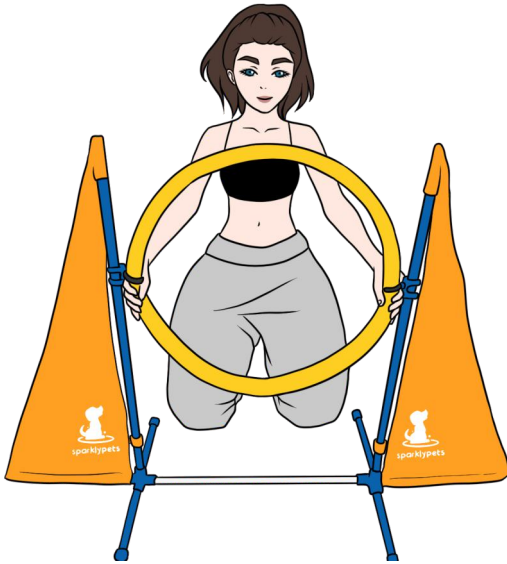

Now take the orange circle you just made and fix it on the two tire jump connectors (R).  
Take a step back and look if the connectors are at an even range.

Depending on your dog's jumping experience, slide the connectors  
down or up the standing poles for him to jump through the circle.

**YOU'RE DONE!**

**START ENJOYING YOUR NEW  
SPARKLYPETS DOG AGILITY COURSE!**



# *‘What it is and what you need to know’*

Do you imagine yourself and your dog on one of those dog agility contests that are fun to watch?

**IF YOU ARE, YOU'RE NOT ALONE!**

Considering agility training can have many long-term benefits for your pup, so why not give it a try?

Let's explore what agility actually is, what it helps with and what you need to know before you make the decision to train your dog for agility.

### WHAT IS DOG AGILITY?

To put it simply, dog agility is a sport. To put it in more details, it's a obstacle course race where a handler and a dog try to complete a preset track filled with different obstacles like tunnels, seesaws or weave poles. The team has to do this in a time efficient manner while having coordination and efficacy in mind as well.

The handler, or the owner, should be able to have complete control over the dog's actions, without having to incentivize him or her with treats or rewards. Actually, throughout the competition, the handler is only allowed to use voice commands and gestures to help their dog overcome all of the obstacles. The owner is not allowed to touch neither the dog nor the obstacles throughout the entire race.

### HOW DOES DOG AGILITY HELP MY DOG?

Dog agility can be to a dog what a puzzle is to a human. It can spark interest and boost brain functions. It's an interesting way of exploring curiosity and improving mental health, for one. It's also a good way to get rid of boredom and keep yourself and your dog entertained.

On the other hand, dog agility is a good way to have your dog stay in shape. After all, it's a sport, right? All that jumping and running around is bound to increase muscle strength and speed and keep your pup in tip top shape.

Another benefit is that it can work on improving your bond with your dog. Your dog will learn to trust you and that will in turn improve the bond that you two have. This will not only make both your lives easier, but also more fun, as you'll rely on one another for various activities.

Last but not least, it will improve your dog's behavior. Because this sport is so reliant on dogs listening to their handler's commands, it will inevitably lead to your dog having an increased response to your commands, especially when it comes to obedience training.

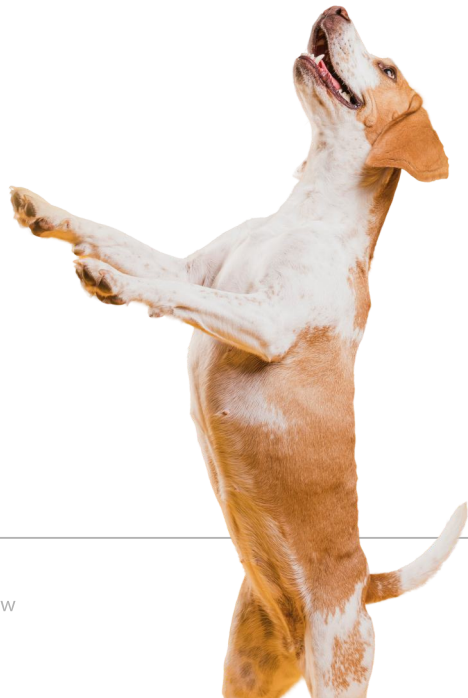

# DOG AGILITY

## WHAT DO I NEED TO KNOW BEFORE STARTING TRAINING?

There are a few things you need to take into account before you start working with your dog to compete in dog agility courses.

- Check in with your vet first. Your dog should be clinically healthy in order to be able to complete the course safely and for this type of exercise to be beneficial to him or her.
- Investigate any known medical conditions specific to each breed. For example, some dog breeds tend to have back problems or posture problems, which is why veterinarians usually recommend that they avoid jumping. In this case, a dog agility course would not prove to be beneficial for your dog.
- Master the basics. Before you even consider taking up dog agility training, you and your dog must have a strong hold on the basic obedience commands, such as stay, sit and come. Only after these are achieved without the help of treats or incentives, you can start thinking about dog agility.
- Make sure your dog has a good attention span to start with. You will need to improve your dog's attention span as you progress, but you also need to make sure it's at a good starting point before you begin. Otherwise, your dog might get distracted and won't listen to your vocal commands throughout the race.
- Make sure your dog can do an array of movements. The obstacles will require your dog to have increased mobility and understanding of how his or her body moves. This means that before you start working on agility training, you need to do some basic training to teach your dog to jump, walk backwards, position paws in different places or walk in between objects.
- Keep in mind your dog's energy levels. Because this is such a time efficient sport, your dog will need to move quickly. So, regardless of whether you have a small breed dog or a large one, make sure your dog is naturally energetic. A slower-moving dog might not do well with a time crunch.



*All things considered, dog agility races have a lot of benefits for both you and your dog and, if all requirements are met. You can have a lot of fun while doing this type of activity. Would you consider dog agility training?*



# 5 DOG BREEDS THAT NEED A LOT OF EXERCISE



Just like us, dogs come in many shapes and sizes. Some dogs need more exercise, some need bigger meals, some are perfect for cuddling on the couch on a rainy day. And sure, some of these traits come from each dog's personality, but some are breed specific.

If you're looking to get a new pup, make sure you can keep up with his exercise needs and make sure he can keep up with yours! Here are some of the breeds that need more exercise, so that you can take this into account if you're considering them as a pet.

## BORDER COLLIE

Border Collies are excellent sheep herders, extensively used in Australia for this reason, along with the Australian Shepherd Dog. Being herder, this type of dog is accustomed to running long distances to make sure the herds stay together.

Because of their herding nature, Border Collies excel at training commands, so Lassie will be an excellent competitor in dog agility competitions.

This is one of the types of breeds that has a lot of stamina and energy, so make sure you provide at least 60 minutes of intense exercise per day.

## GOLDEN RETRIEVER

Everyone's favorite, the Golden Retriever needs to...well...retrieve! They are very well capable of keeping up with you on a hike, on a run or when you're on a casual walk.

Playing fetch is also a great option for a Golden Retriever, since retrieving is one of their favorite activities.

Make sure to get up to 2 hours of quality exercising every day, to keep them happy and healthy.

## GERMAN SHEPHERD

The German Shepherd is THE breed you think about when thinking Police Dog, or Military Dog, or Bomb Detection Dog. They are very easy to train, which can make them very good at what they do. If you think about it, a police dog might run to catch an assailant, or attack a bad person at their human officer's command, so they really need to be in good shape.

Regardless of whether your Rex is in the force or not, you still need to make sure you get at least a full hour of moderate and high intensity workouts for him to spend some energy.

## ALASKAN MALAMUTE

Just like the Siberian Husky, the Alaskan Malamute is a dog breed for working. If you can grasp that the dog's main working purpose was to pull on a heavy sleigh through huge amounts of snow, in the cold, for thousands of miles at a time, then you can imagine that such a breed would require a lot of exercise to burn off some of that energy.

Ideal for an athlete owner, this breed requires at least 60 minutes of intense exercise per day, but you can safely go up to 2 hours of exercising daily.

## POINTER

As with the other breeds we've mentioned in our article so far, the pointer was bred with hunting abilities in mind, as the name might suggest. That means this dog breed, and others that are similar, need to be agile, fast runners so that they can catch up with the hunted prey (either ducks or rabbits, deer and so on) and lead their owner, the hunter, to it. Depending on the prey, they would need to be quick, slim and fast on his feet.

While you can adjust his form from the foods he's consuming, you also need to adjust his energy levels making sure they exercise on a daily basis. Aim for 60 to 90 minutes of medium or high intensity exercises each day, whether it's an intense hike, jogging or just a plain walk.

As you can see, there's a lot of things you should consider when it comes to picking the right pup for you. That being said, if you're an active person or an athlete, and you want to involve your doggo in your workouts, consider one of the breeds we mentioned above, or here are some other good options as well: Akita, Schnauzer, Rottweiler, Doberman, Bloodhound, Jack Russel Terrier, Labrador and many more. Regardless of what you decide to get in the end, make sure that you can commit to offering them the amount of exercise they need to live happy and healthy lives.



# EXCLUSIVE sparklypets

## RECOMMENDATIONS FOR DOG AGILITY COURSE LAYOUTS

Go through the next layout recommendations for some inspiration on how to layout your own Agility SparklyPets Course. You will find that the next two obstacle setups are of 40 ft by 50 ft space. If you have more backyard space, extend the space between the obstacles to increase your speed and the challenges for your dog.

### SPARKLYPETS DOG AGILITY COURSE LAYOUT

#1

*For the first one you will need to set up:*

**The Tunnel | The Weave Poles | The Hurdle Jump | The Pause box**

Place them in the given order, and start from the first set till the fourth one.

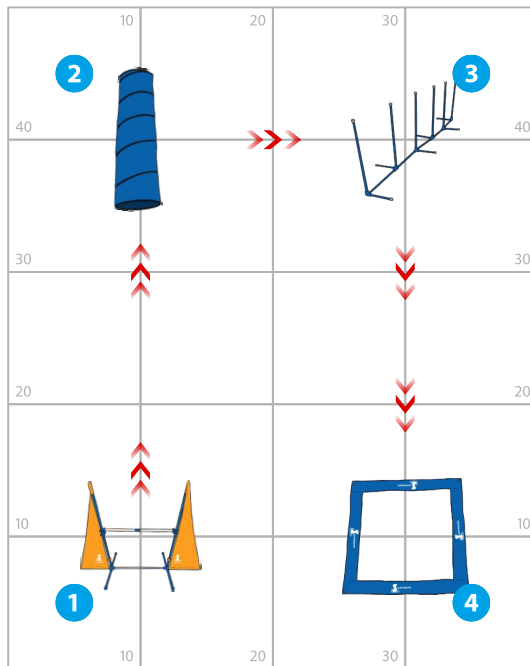



---

---

---

---



# EXCLUSIVE sparklypets

## RECOMMENDATIONS FOR DOG AGILITY COURSE LAYOUTS

### SPARKLYPETS DOG AGILITY COURSE LAYOUT #2

For the first one you will need to set up:

**The Tunnel | The Weave Poles | The Tire Jump | The Pause box**

Place them in the given order, and start from the first set till the eighth one.

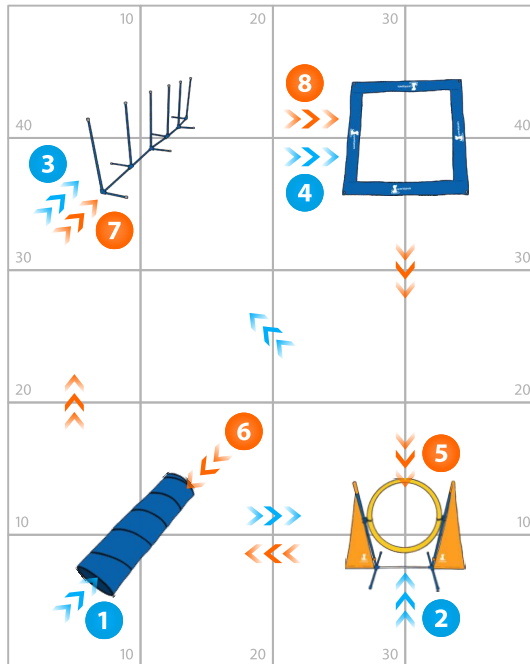

Handwriting practice lines consisting of seven horizontal lines.



# SPARKLYPETS AGILITY COURSE BLANK GRID

FOR 40 FT BY 50 FT

## ELEMENTS YOU CAN INCLUDE

**PAUSE BOX**

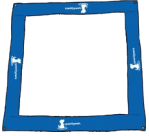

**AGILITY TUNNEL**

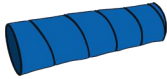

**HURDLE JUMP**

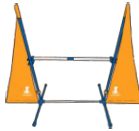

**TIRE JUMP**

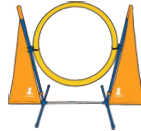

**WEAVE POLES**



	10	20	30	
40				40
30				30
20				20
10				10
	10	20	30	



---



---



---





# SPARKLYPETS AGILITY COURSE BLANK GRID

FOR 40 FT BY 50 FT

## ELEMENTS YOU CAN INCLUDE

**PAUSE BOX**

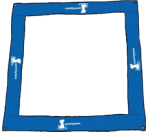

**AGILITY TUNNEL**

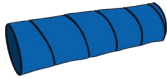

**HURDLE JUMP**



**TIRE JUMP**

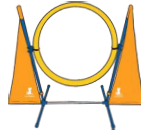

**WEAVE POLES**



	10	20	30	
40				40
30				30
20				20
10				10
	10	20	30	



---



---



---



# SPARKLYPETS AGILITY COURSE BLANK GRID

FOR 80 FT BY 100 FT

## ELEMENTS YOU CAN INCLUDE

**PAUSE BOX**

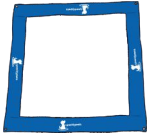

**AGILITY TUNNEL**

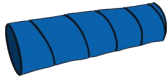

**HURDLE JUMP**

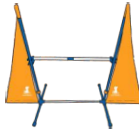

**TIRE JUMP**

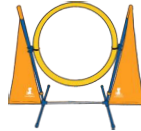

**WEAVE POLES**



	10	20	30	40	50	60	70	
90								90
80								80
70								70
60								60
50								50
40								40
30								30
20								20
10								10
	10	20	30	40	50	60	70	



---



---



---



# SPARKLYPETS AGILITY COURSE BLANK GRID

FOR 80 FT BY 100 FT

## ELEMENTS YOU CAN INCLUDE

**PAUSE BOX**

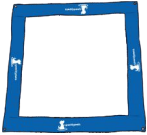

**AGILITY TUNNEL**

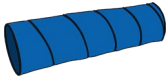

**HURDLE JUMP**

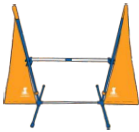

**TIRE JUMP**

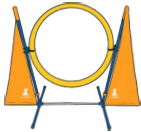

**WEAVE POLES**



	10	20	30	40	50	60	70	
90								90
80								80
70								70
60								60
50								50
40								40
30								30
20								20
10								10
	10	20	30	40	50	60	70	



---



---



---



# SPARKLYPETS AGILITY COURSE BLANK GRID

FOR 80 FT BY 100 FT

## ELEMENTS YOU CAN INCLUDE

**PAUSE BOX**

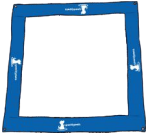

**AGILITY TUNNEL**

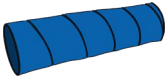

**HURDLE JUMP**

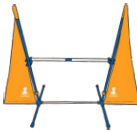

**TIRE JUMP**

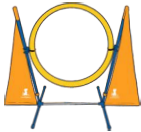

**WEAVE POLES**



	10	20	30	40	50	60	70	
90								90
80								80
70								70
60								60
50								50
40								40
30								30
20								20
10								10
	10	20	30	40	50	60	70	



---



---



---



THE SPARKLYPETS  
AGILITY DIPLOMA



sparklypets

**THIS CERTIFICATES THAT**

CHAMPION'S NAME

\_\_\_\_\_

CHAMPION'S BREED NAME

\_\_\_\_\_

HAS BEEN OFFICIALLY RECORDED AS A

**BACKYARD AGILITY DOG EXPERT**

RAISED BY  
OWNER'S NAME

THE DIPLOMA  
WAS RECEIVED ON

\_\_\_\_ / \_\_\_\_ / \_\_\_\_

CERTIFIED AND PAW APPROVED BY  
SPARKLY FROM SPARKLYPETS





THE PRESENT USER MANUAL IS THE PROPRIETY OF:

OWNER'S PHONE NUMBER \_\_\_\_\_

OWNER'S NAME \_\_\_\_\_



### WARRANTY

Because we stand by our products, our product is covered by a 3 years warranty per product, starting from the day it was purchased.



### WARNING

Failure to follow these instructions could result in serious injury for you and your dogs.



### CONTACT

For any support, inquiries, or improvements, please:  
write to us  [info@sparklypets.com](mailto:info@sparklypets.com) or call us  **+1(252) 220-0094**



© Copyright Sparkly Innovation.  
SparklyPets and all associated logos are trademarks.

