

CONFIER

Smart Scalp Massager



User Manual

CF-4902BLK



READ ALL INSTRUCTIONS BEFORE USE. SAVE THESE INSTRUCTIONS FOR FUTURE REFERENCE.

- ALWAYS unplug the appliance from the electrical outlet immediately after using and before cleaning.
- This item is NOT A TOY. Close supervision is necessary when this appliance is used by, on, or near children or disabled persons.
- NEVER leave an appliance unattended when plugged in.
- NEVER insert pins or other metallic fasteners into the appliance.
- Use this appliance for the intended use as described in this booklet. DO NOT use attachments not provided by COMFIER.
- NEVER operate the appliance if it has a damaged cord or plug, if it is not working properly, if it has been dropped or damaged. Return it to the COMFIER Service Centre for examination and repair.
- Keep cord away from heated surfaces.
- Excessive use could lead to the product's excessive heating and shorter life. Should this occur, discontinue use and allow the unit to cool before operating.
- NEVER drop or insert any object into any opening.
- DO NOT operate where aerosol (spray) products are being used or where oxygen is being administered.
- DO NOT attempt to repair the appliance. All servicing of this appliance must be performed by authorised Comfier service personnel only.
- Do not place or store appliance where it can fall or be pulled into a bath or sink. Do not place in or drop into water or other liquid.
- Do not use this product for medical treatment.

If you suffer from any of the medical conditions listed below, consult with a doctor before using this relaxation massage device.

If you:

- suffer from a heart condition
 - have a sensory disorder or pacemaker
 - suffer from osteoporosis or diabetes
 - have a malignant tumor
 - have neurological disorder or perceptual disorder on head
 - have fractured or head surgery of your massaging area
 - head skin disease and allergic dermatitis
 - suffering from acute diseases or are undergoing medical treatment
- we advise you to consult with your doctor before using this massager.
- Failure to follow the above may result in the risk of injury.

Features

1. Built-in Lithium battery
2. One control button
3. 10 minutes timer
4. Automatically protect function
5. 2 massage speeds
6. 2 massage modes
7. Android Micro USB cable
8. IPX7 waterproof
9. 3D head massage

CONTENTS

- Smart Scalp Massager
- Charge Base
- USB cable



Charge Base



USB cable



TECHNICAL DATA

Model:	CF-4902BLK
Product Input:	DC5V 1.0A
Rated Power:	5W
Automatic runtime:	10 minutes

Instructions for use

Please Make sure to relax before using this machine, Hold the device and put the massage heads onto scalp to massage.

1. Press the control button to turn on the device.
Press and hold on 3 seconds to turn off the device.
2. Short press continuously can switch massage speed low/high and cyclically switch of massage modes (Clockwise & Counterclockwise).

-  Charge icon: while charging, LED green light is on.
-  Adjust speed, it will turn red; switch speed, it will shine in short time
-  Cyclically switch of scratching, It will turn blue; switch modes, it will shine in short time

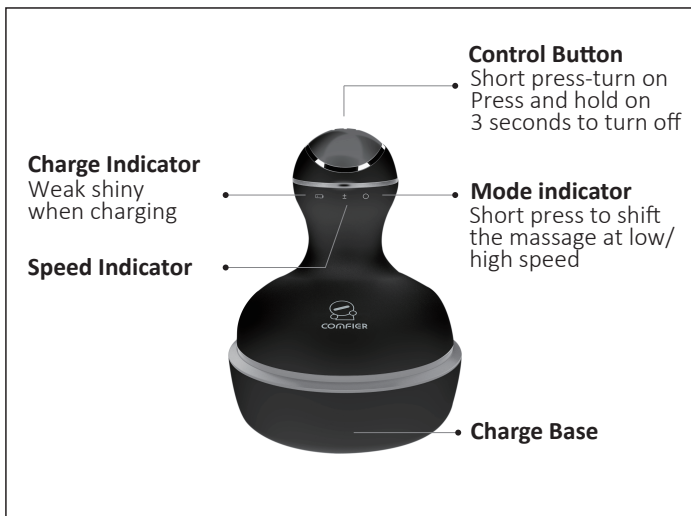

Battery Charging :

Connect the USB cable to any USB charger, it can be plugged in the portable power bank, mobile phone battery chargers, laptop and any USB port.

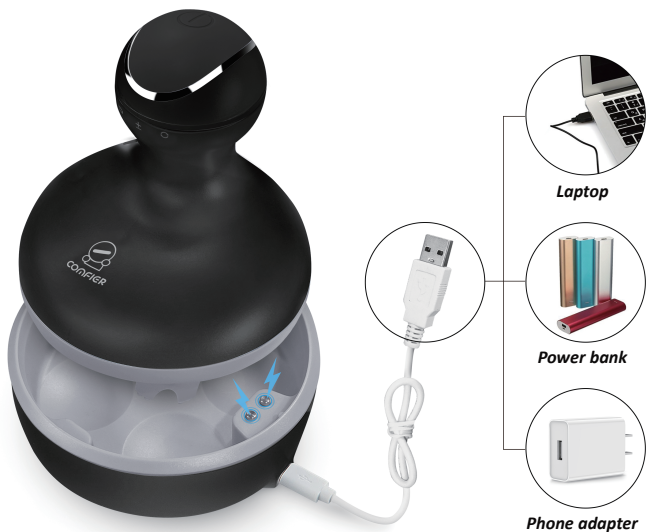

1. When recharging, green light indicator will be shining.
2. When full charge, the indicate light will turn green.
3. Normally it takes about 2 hours to fully charge.
4. Machine will stop when charging

Troubleshooting

Trouble	Reason/Solution
Can not start the massager	Battery Low/ Please charge it before using
The massager stoped abnormally	Battery runs out of power/ charge the battery Self-timed 10 mins is out/ restart the product
Massager slight noise	It is normal working noise of the internal mechanism

Notes and Maintenance

Notes

1. It is waterproof device, you can use cleaning fluid and water to clean it (do not sink it into water for a very long time).
2. Please use dampcloth or neutral detergent to clean the product and wipe dry afterwards.
3. Do not use sharp brush, sharp tool, gasoline and diesel to clean it.

Maintenance

1. Please keep it into a box and keep in a safe, dry and cool place.
2. Do not keep it in any place with high temperature, near fire or direct sunlight,or it may faded or damaged
3. Do not contact benzene, dilient or any other corrosive liquid.

Warranty

If you have any issue about the product, please feel free to contact us by sending email to supportus@comfier.com We will strive to provide the best service possible within 24 hours.

30 days unconditionally Return

Comfier product can be returned to receive a full refund for any reason within 30 days. Please contact our customers service (supportus@comfier.com), our staff will contact you within 24 hours.

90 days refund/replace

Comfier product can be returned / replaced within 90 days if the product break down in the period of proper use.

12 months Warranty

If the product break down within 12 months in the period of proper use, customers can enjoy the relevant warranty to get them replaced.

Attention!

No warranty will be given to any force majeure and man-made causes to a defective product, such as improper care, personal tear down and willful damage, etc.

Extend Warranty for Free

1) Enter the following URL or scan the QR code below to find COMFIER facebook page and like it, enter "Warranty" to messenger to extend your warranty from 1 year to 3 years.



<https://www.facebook.com/comfiermassager>

OR 2) Send message "Warranty" and email us supportus@comfier.com to extend your warranty from 1 year to 3 years.

Have question ?

 **Tel:** (248) 819-2623
Monday-Friday 9:00AM-4:30PM

 **Email:** supportus@comfier.com

FCC STATEMENT

NOTE: This equipment has been tested and found to comply with the limits for a Class B digital device, pursuant to Part 15 of the FCC Rules. These limits are designed to provide reasonable protection against harmful interference in a residential installation. This equipment generates, uses and can radiate radio frequency energy and, if not installed and used in accordance with the instructions, may cause harmful interference to radio communications. However, there is no guarantee that interference will not occur in a particular installation. If this equipment does cause harmful interference to radio or television reception, which can be determined by turning the equipment off and on, the user is encouraged to try to correct the interference by one or more of the following measures:

- Reorient or relocate the receiving antenna.
- Increase the separation between the equipment and receiver.
- Connect the equipment into an outlet on a circuit different from that to which the receiver is connected.
- Consult the dealer or an experienced radio / TV technician for help.

This device complies with Part 15 of the FCC Rules. Operation is subject to the following two conditions: (1) this device may not cause harmful interference, and (2) this device must accept any interference received, including interference that may cause undesired operation.

WARNING: Changes or modifications to this unit is not expressly approved by the party responsible for compliance could void the user's authority to operate the equipment.



COMFIER TECHNOLOGY CO.,LTD.
Address:573 BELLEVUE RD
NEWARK, DE 19713 USA
www.facebook.com/comfiermassager
supportus@comfier.com
www.comfier.com