

Maytag Refrigerator Door Shelf Support

Assembly Instructions

1. Remove shelf by pulling it up, then tipping the back end down. Then pull the shelf out.



2. Gather the required tools: Drill + 1/8" bit or a center hole punch. 2mm Allen Wrench (Included).



3. Drill out the center rivet of the old hook or use a center hole punch to remove the rivet.

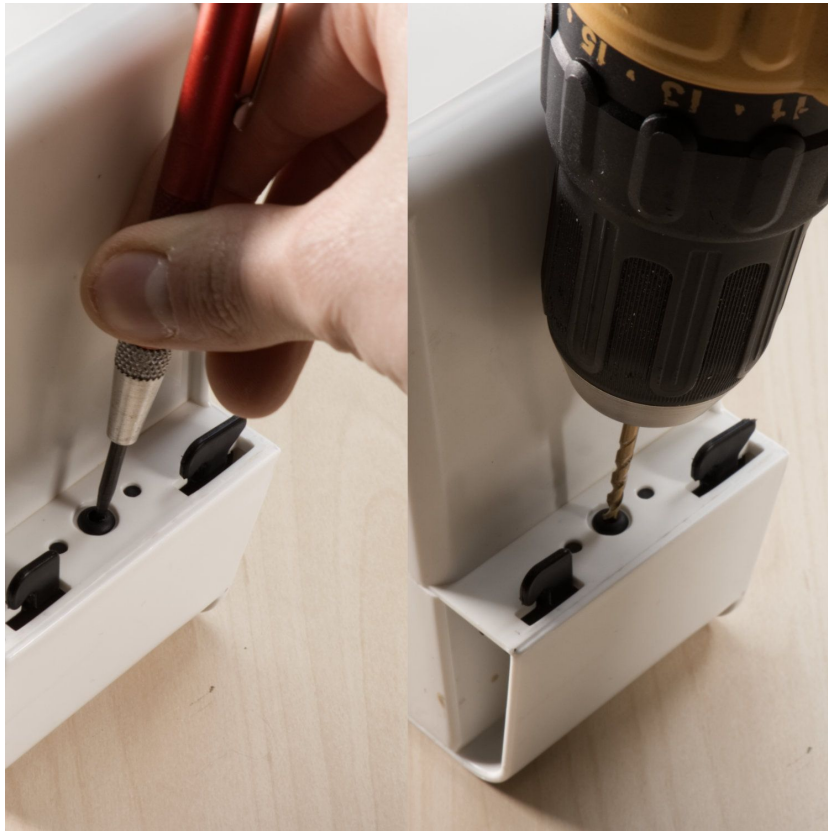

4. Swap in the new hook, making sure to point the hooks toward the bottom of the shelf. Make sure the two pegs line up in the holes.



5. Fasten the hook to the shelf using the one of the supplied 6mm screws into the brass threading.



6. Attach the shelf back into the fridge and you're done!