

# **2017-2020 Infiniti Q60 Redsport BIG MOUTH Intake Installation Guide**

# Kit Contents

Please review this document before attempting installation.

You will need basic hand tools and about 1-1.5 hours of installation time.

Please review the table below and make sure you have received the kit contents.

Description	Qty in kit
	#
M6 x 30mm socket head cap screw	5
M6 x 40mm socket head cap screw	2
M6 large washer	8
M6 small washer	1
M6 lock nuts	6
Aluminum spacer	1
Foam Strip (1")	1
Pair of Orientation Blocks ("F" and "B")	1
VT Aluminum Bracket	1



# Bumper Removal

Perform a YouTube Search using the term “How To Remove Your Infiniti Q60's Front Bumper Properly” and follow the steps for bumper removal.

Once you remove the bumper, please continue with this installation guide

# Big Mouth Installation

**If you DO NOT own a Technology package car**, follow this slide by unbolting the horn as shown and relocating it to the screw hole on the crash bar as shown. **If you own a Tech package**, see next slide.

**3.** Using the same horn bracket, relocate it here and bolt it down using the OEM bolt.

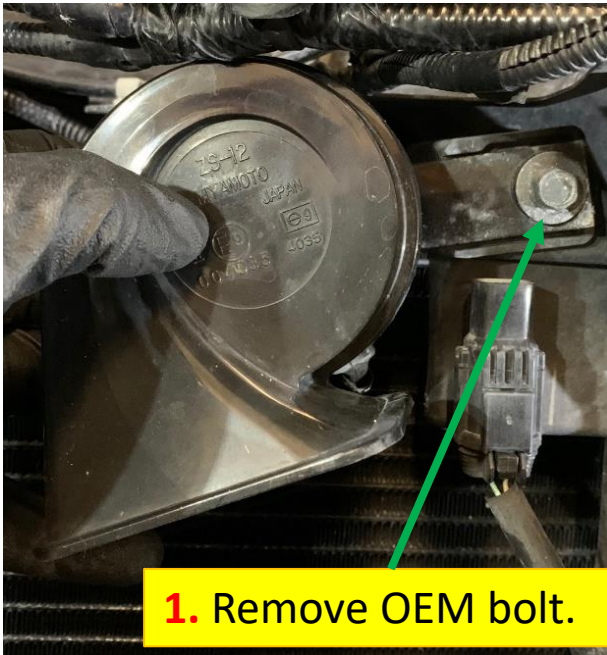

**1.** Remove OEM bolt.

**2.** You will need to loosen the nut on the back of the horn, rotate the ground wire such that the wire loom is not under tension in step 3. Re-tighten the wire onto the horn using the nut.



# Big Mouth Installation

If you own a tech package car, follow this slide. Unbolt the horn as shown. **Do not re-use the OEM** bolt to fasten to crash bar. Use the supplied M6 hardware.

Remove the OEM bolt from this hole and see the next slide. **The spacer and small washer will be used here.**

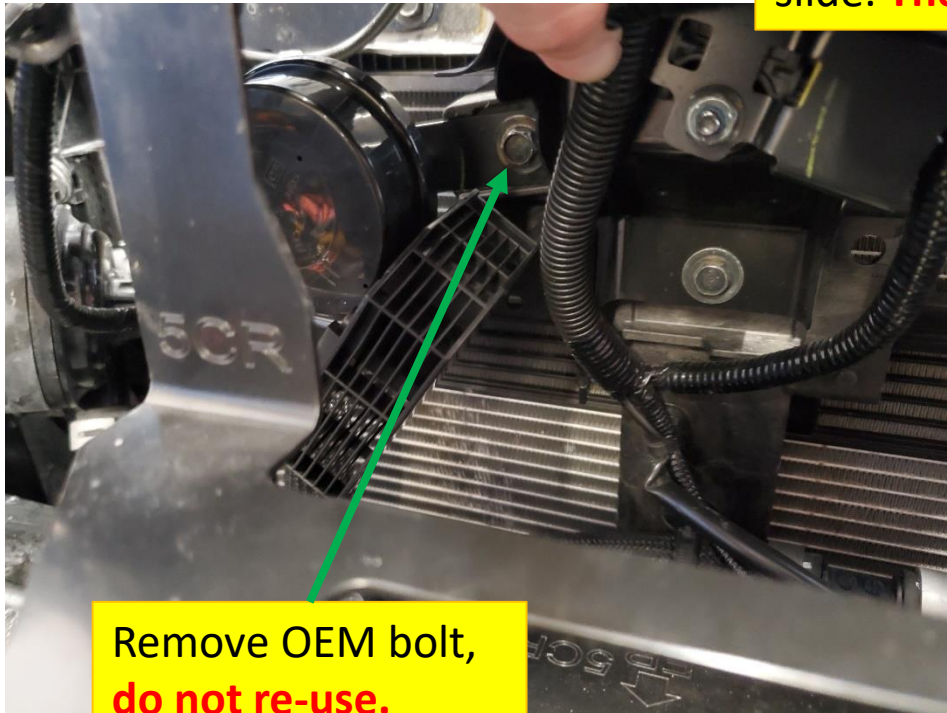

Remove OEM bolt, **do not re-use.**



This sensor frame is present on tech package cars.

# Big Mouth Installation

Fasten the horn to the crash bar using an M6x30 screw, the small M6 washer and the aluminum spacer as shown. Choose an orientation of the horn that does not strain the wire loom.

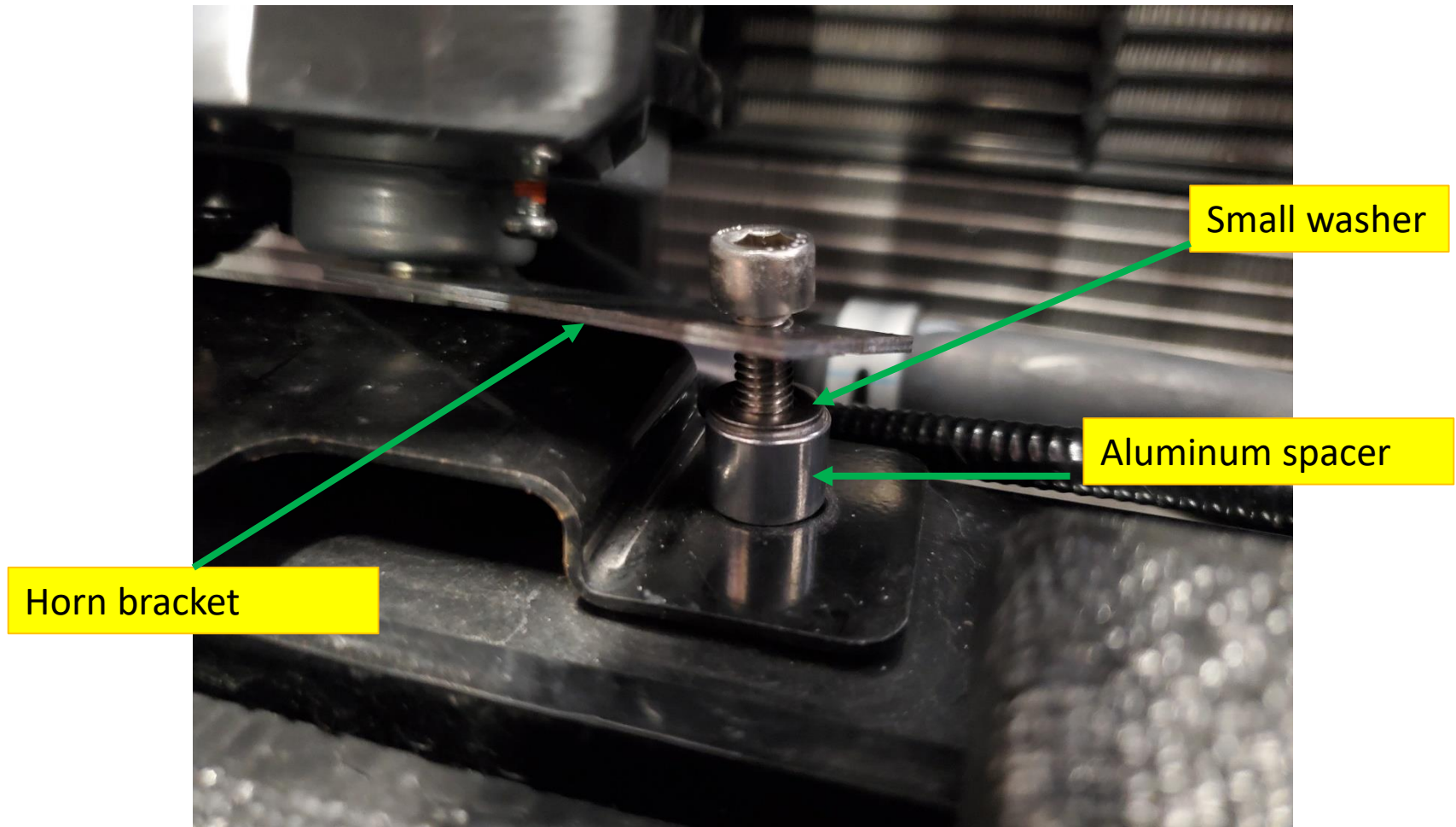

# Pump Reorientation

Undo clip that retains the wire loom for the pump shield. Then remove the nuts that retain the shield. The shield will **not** be reused.

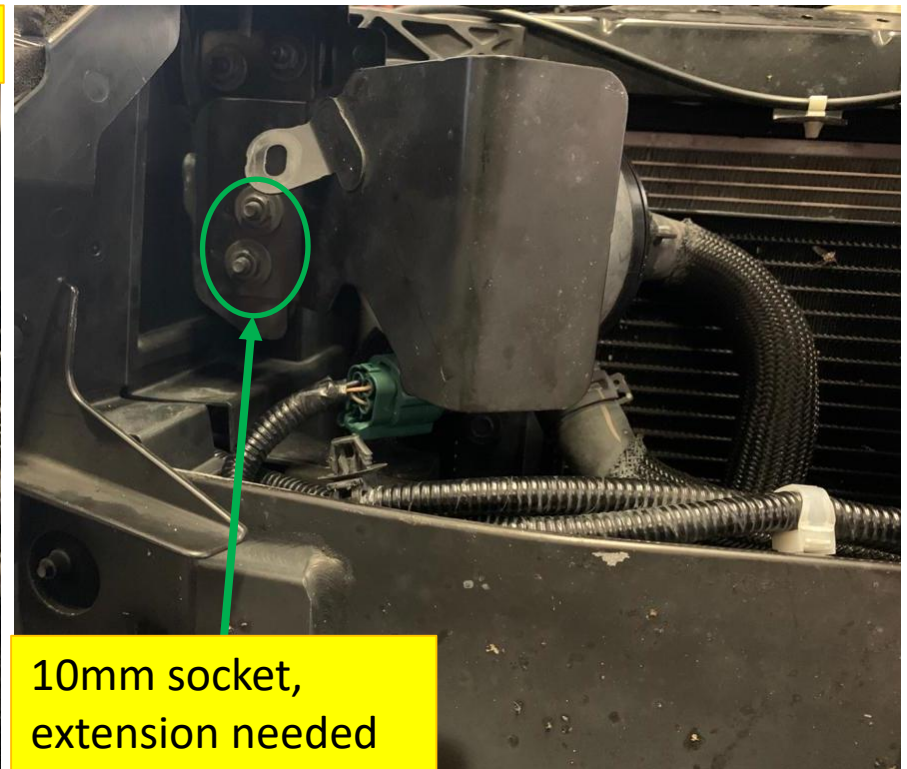
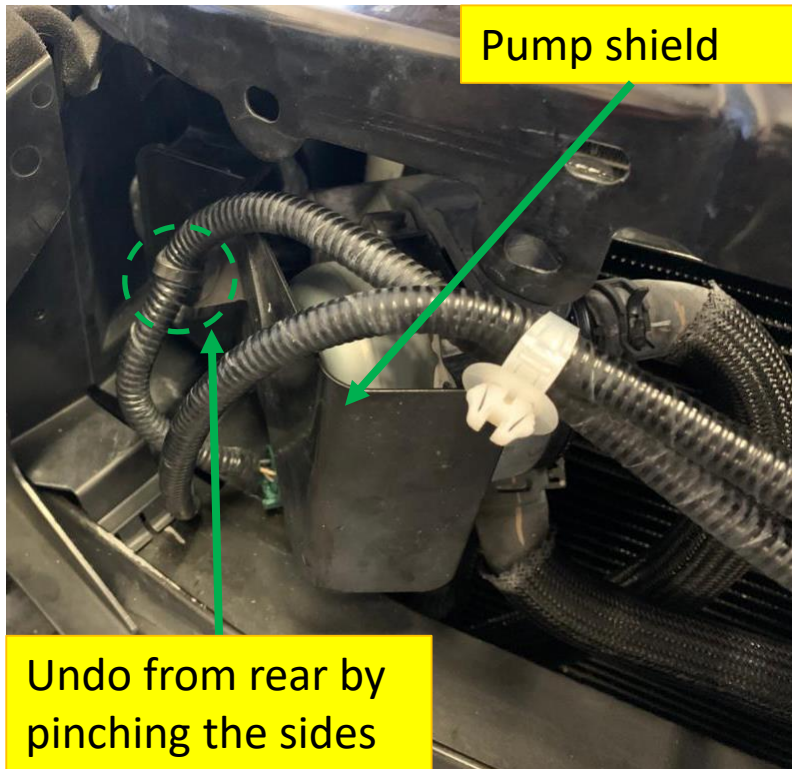

# Pump Reorientation

Shown below is the water pump after being reoriented, the following slides will outline the process.

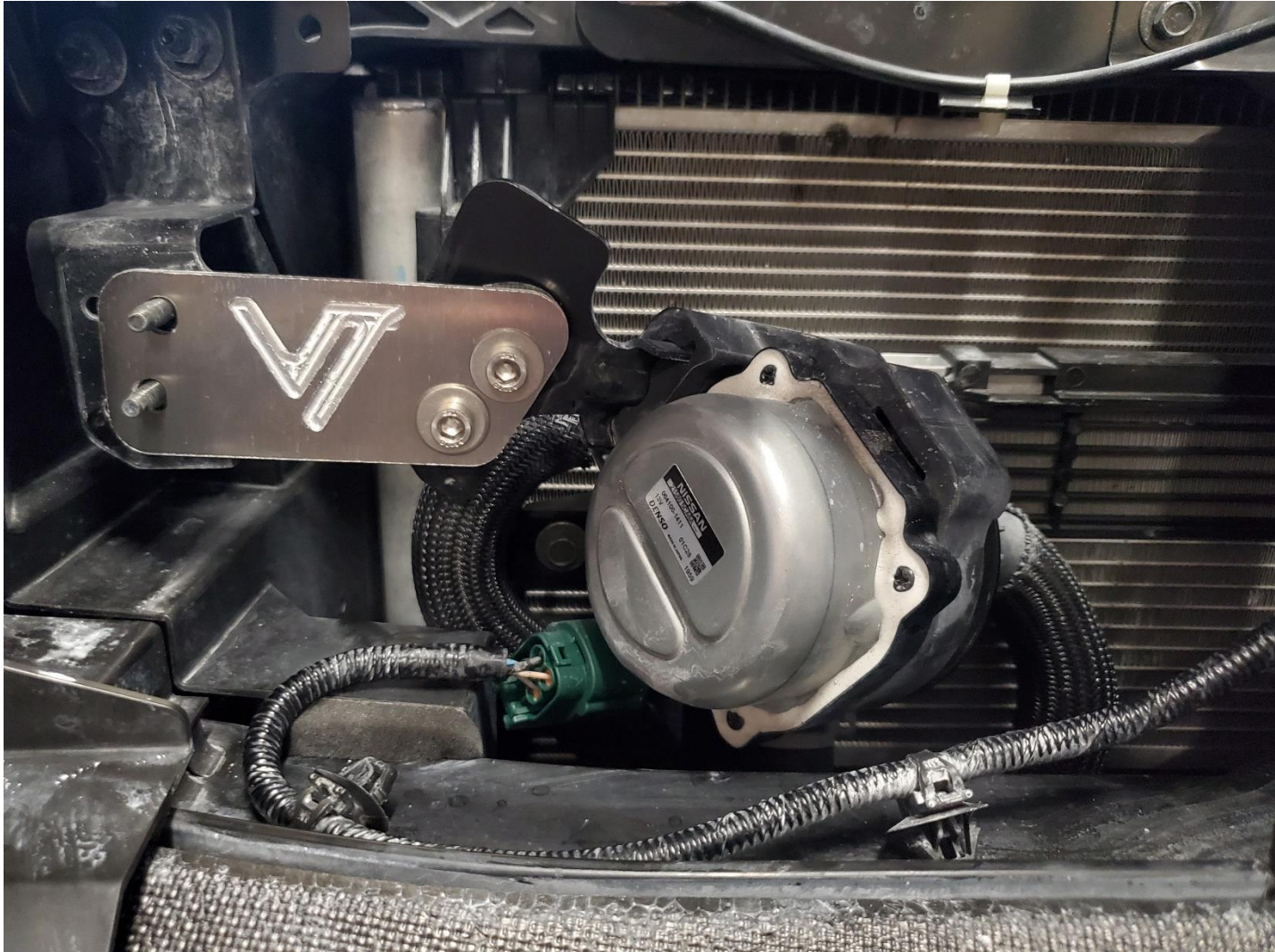



# Pump Reorientation – “F” Block

The first step is to group the aluminum bracket with the “F” (Front) block as shown below. Use the supplied M6x40 screws and 2 large washers to keep the assembly in place, do not fasten yet.

Slide the “F” block onto the back of the aluminum bracket with the “F” lettering upright.

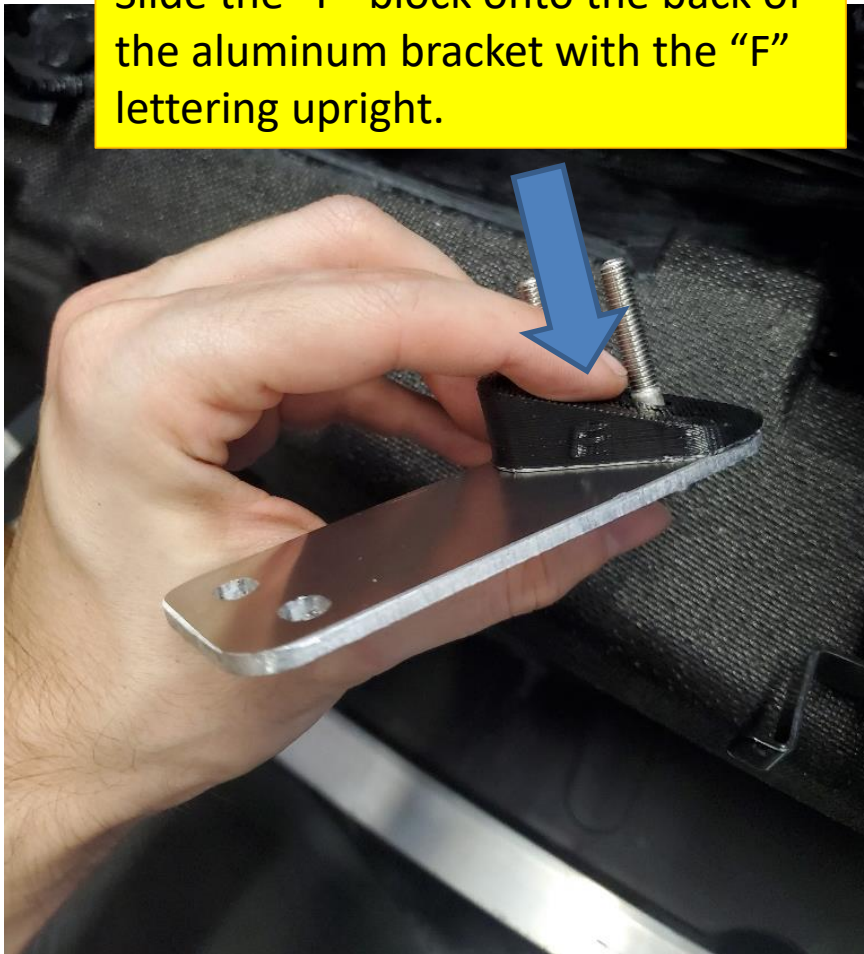

Logo is on front of bracket

Thin end of block towards top

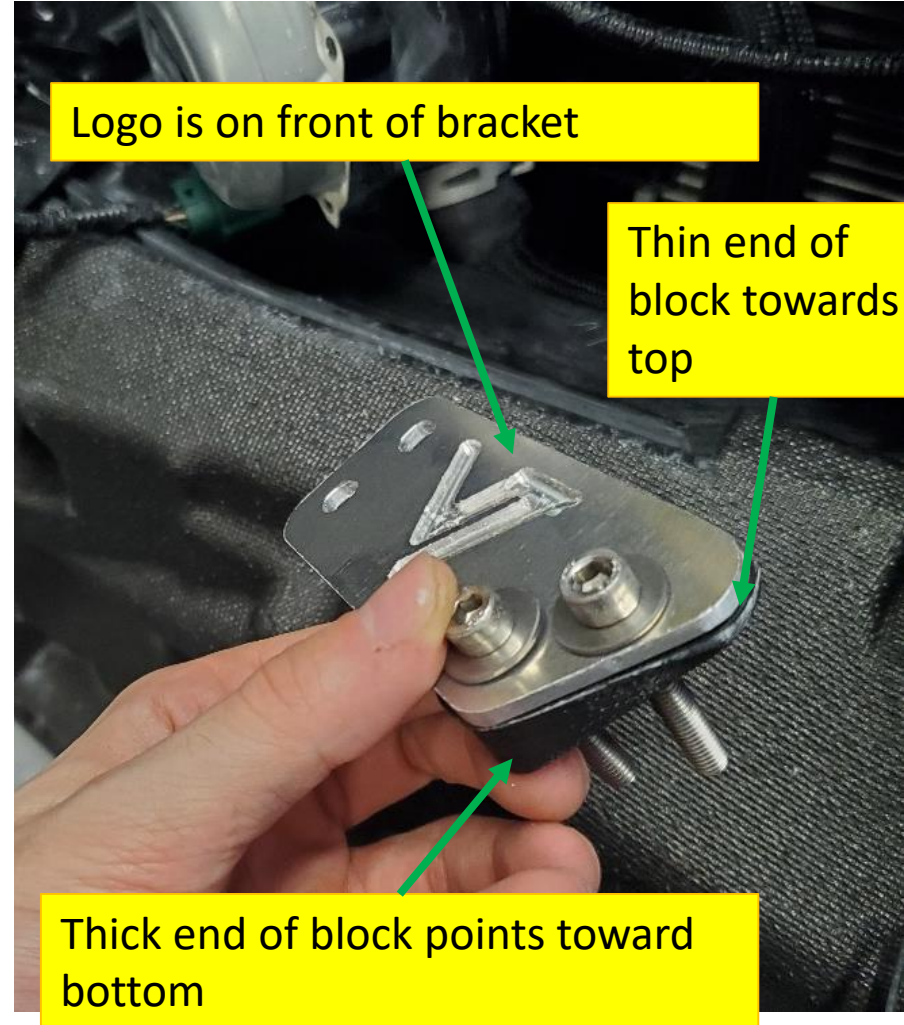

Thick end of block points toward bottom

# Pump Reorientation – Sandwich

The next step is to position the pump mounting bracket behind the “F” block. Do not fasten yet.

Slide pump bracket behind the sandwiched “F” block and aluminum bracket.

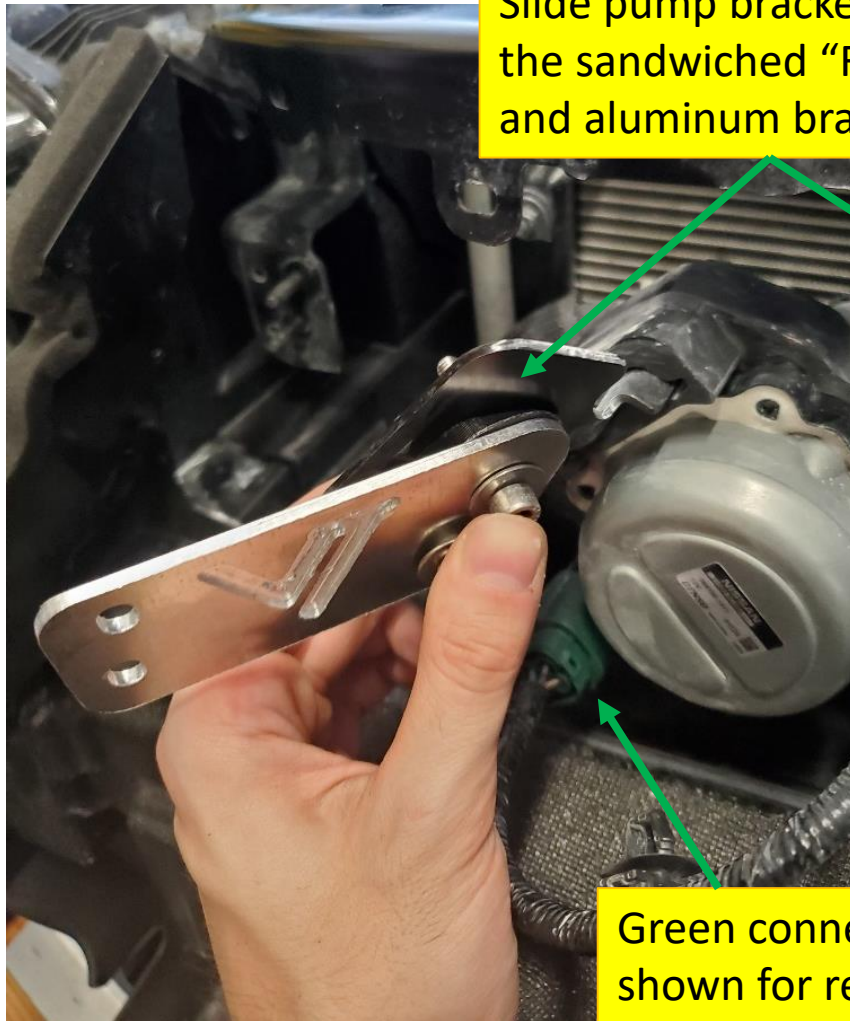

Green connector shown for reference

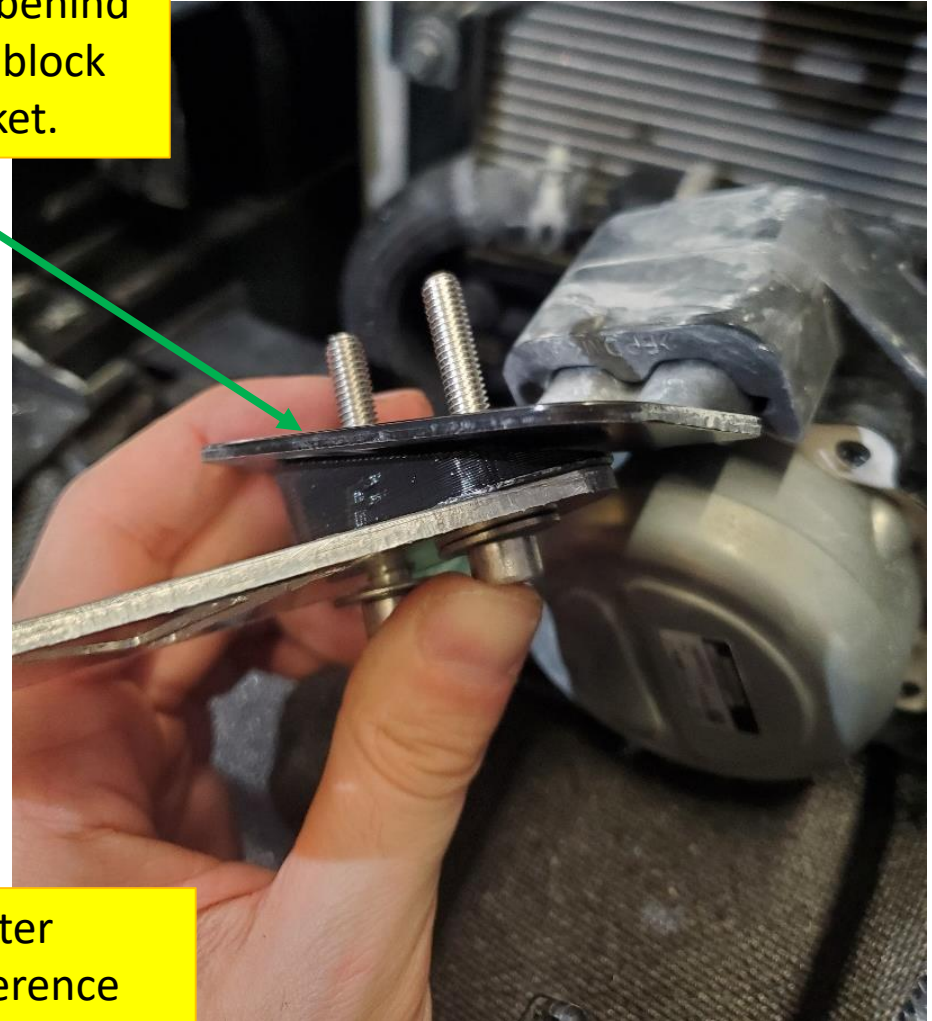

## Pump Reorientation – “B” Block

Lastly, slide the “B” (Back) block onto the assembly and fasten using a large M6 washer and M6 lock nut on each screw. **DO NOT OVERTIGHTEN.**

“B” block slides over the back of the pump bracket to complete the sandwich. “F” and “B” blocks cause the pump to tilt forward, but; their outer faces should be parallel. You should be able to read the letters from a top view when the sandwich is complete.

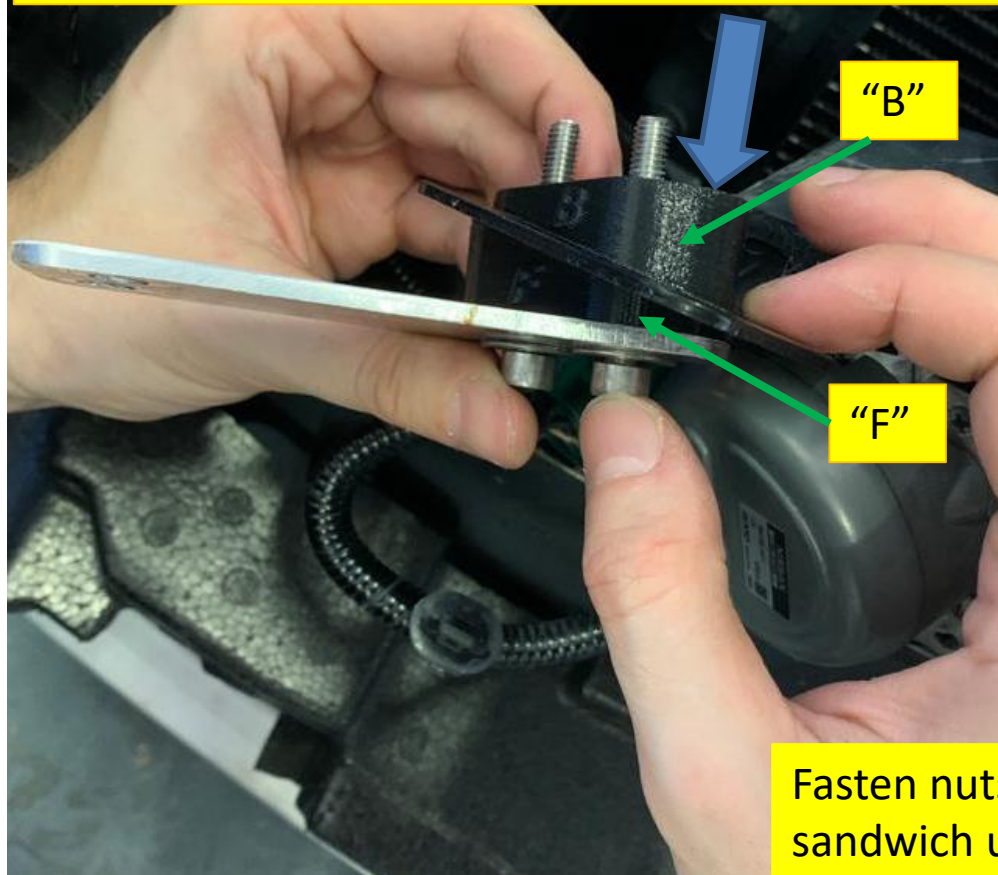

Fasten nuts with large washers on the back of the sandwich using a 10mm wrench and 5mm hex key.

# Pump Reorientation

If you followed the steps in the previous slides, the pump will not touch the crash bar. It will have a natural forward tilt. The aluminum bracket holes are slightly oversized to allow for small adjustment; use as needed.

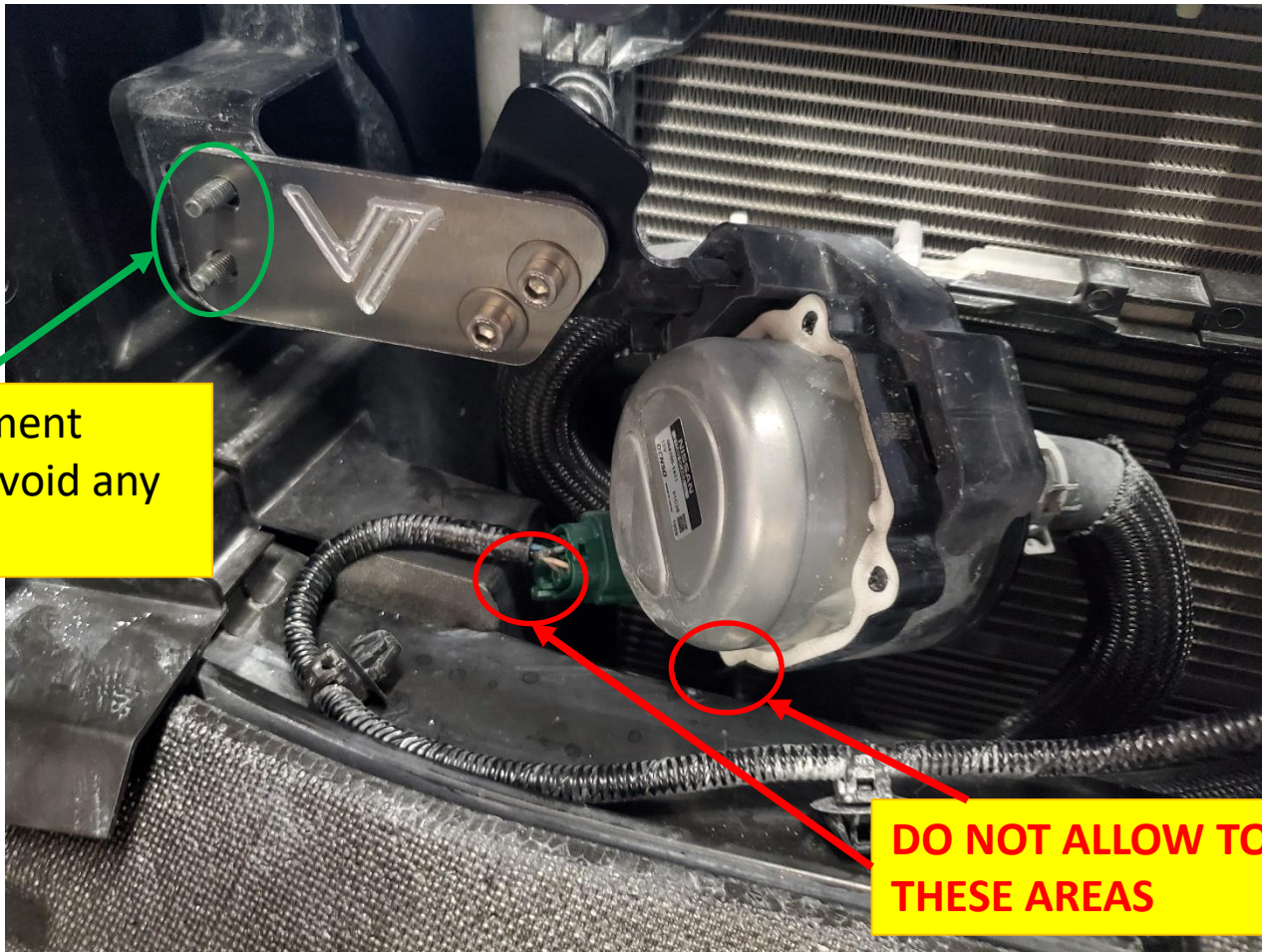

Slight adjustment available to avoid any touching.

**DO NOT ALLOW TOUCHING IN THESE AREAS**

# Pump Reorientation

Once the correct position for the pump has been chosen, fasten the pump assembly to the car using the OEM nuts. Apply the supplied foam strip onto the pump on the area indicated below.

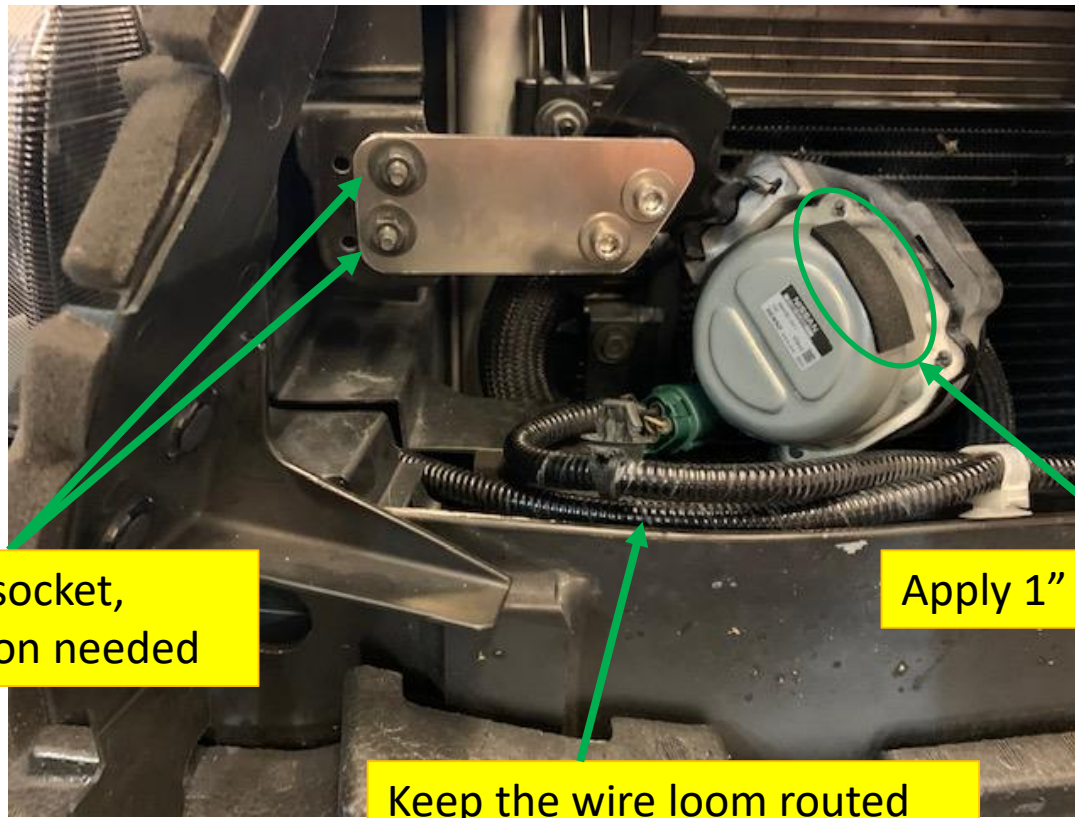

10mm socket,  
extension needed

Apply 1" foam strip here

Keep the wire loom routed  
along the crash bar

# Pump Reorientation Overview

After the pump has been reoriented, it should have a slight forward tilt and plenty of clearance.

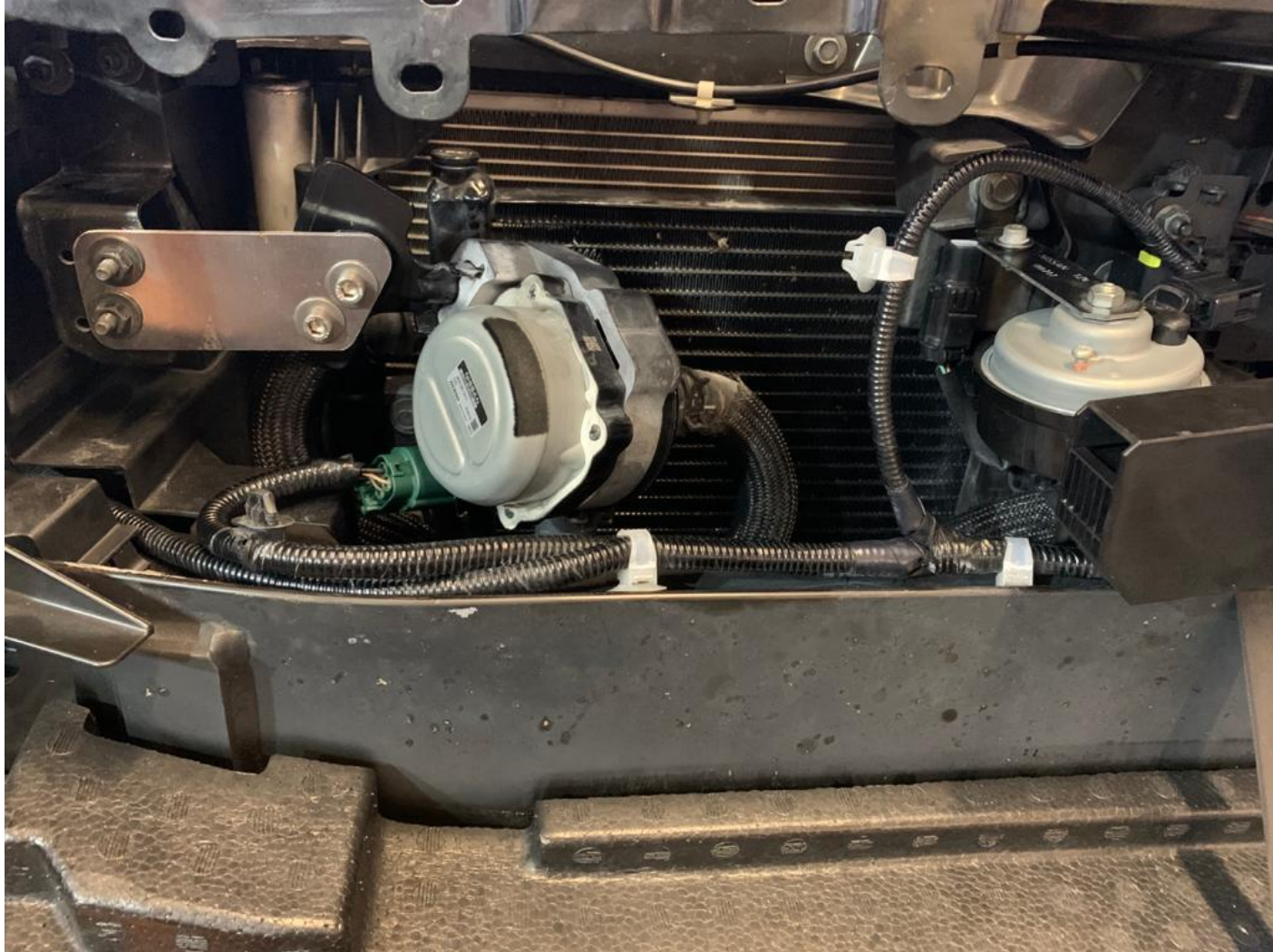

# Big Mouth Installation

If your stock heat exchanger has this small shroud located on the driver side, remove it by extracting the indicated pop clips.

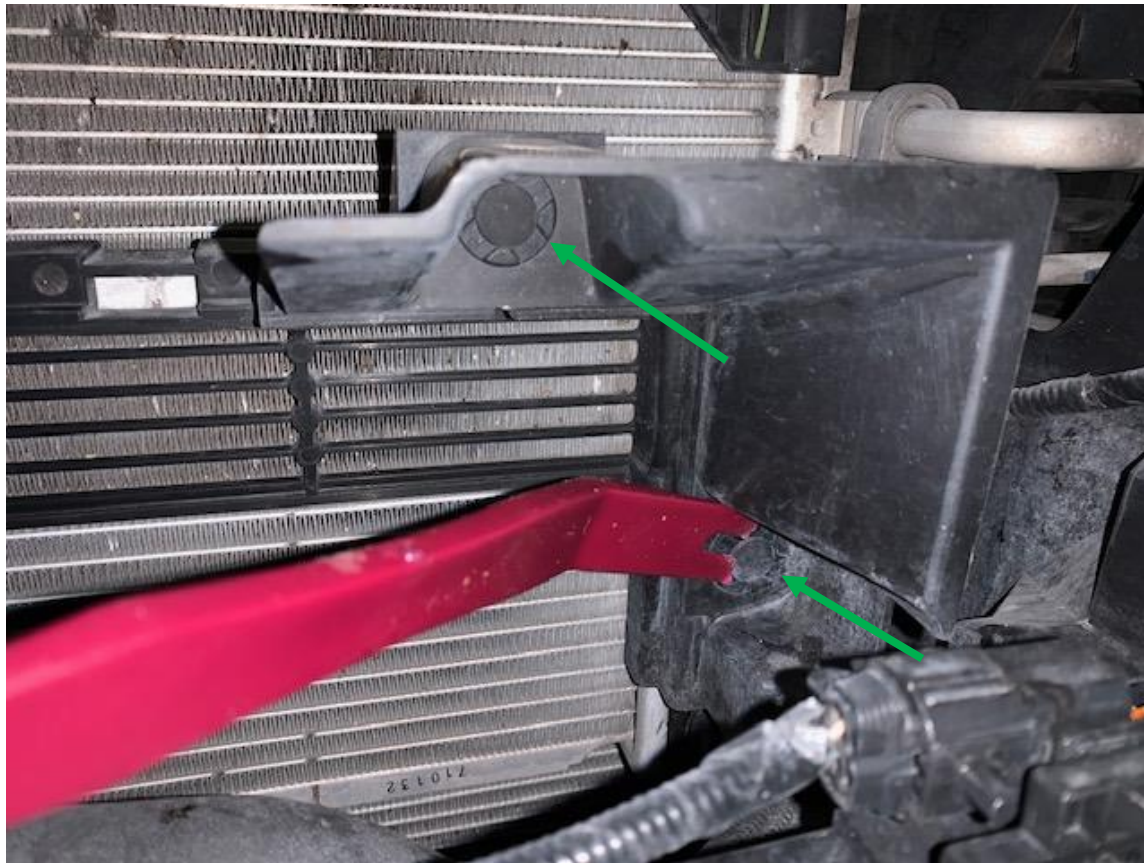

# Big Mouth Installation

Insert the Big Mouth in an upward sweeping motion as indicated. Align the holes and use the supplied M6 x 30mm bolts + 6mm large washers (front) and M6 locknuts (rear) to fasten. Turn by hand at first in order to avoid cross threading, use a 5mm hex key and 10mm wrench for tightening. Install both Big Mouth intakes this way.

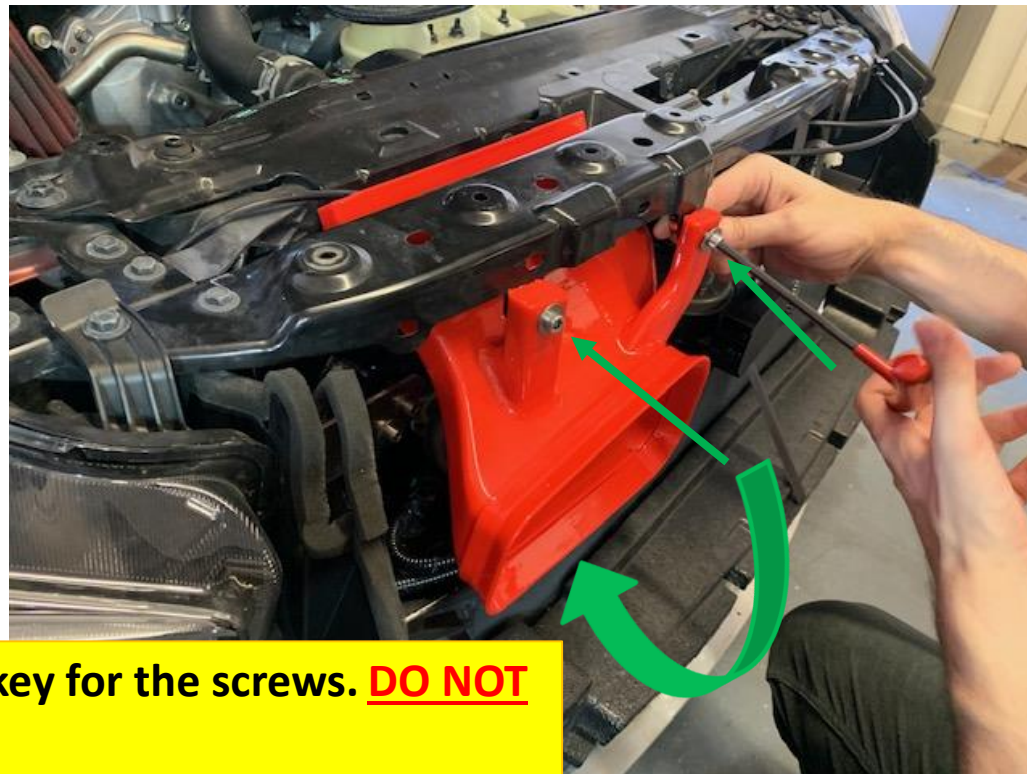

Use a 5mm hex key for the screws. **DO NOT OVERTIGHTEN.**



# Finalize

Re-install the bumper the same way it was removed and ENJOY!

