



Hyundai Elantra GT BIG MOUTH Intake Installation Guide



Kit Contents

Please review this document before attempting installation.

You will need basic hand tools and about 2 hours of installation time.

Please review the table below and make sure you have received the kit contents.

Description	Qty in kit
M6 X 20mm socket head cap screw	1
M6 x 30mm socket head cap screw	1
M4 x 20mm socket head cap screw	2
6mm washers	2





Stock Components Removal

REMOVE BUMPER PRIOR TO ATTEMPTING INSTALLATION!!!

Stock Components Removal

Once the bumper is removed, you will need to remove the transition tube that connects the cowl to the airbox or air filter feed.

1. Push down on the center of these pins and gently remove the clips; there should be no resistance to remove these clips once the pins are depressed.

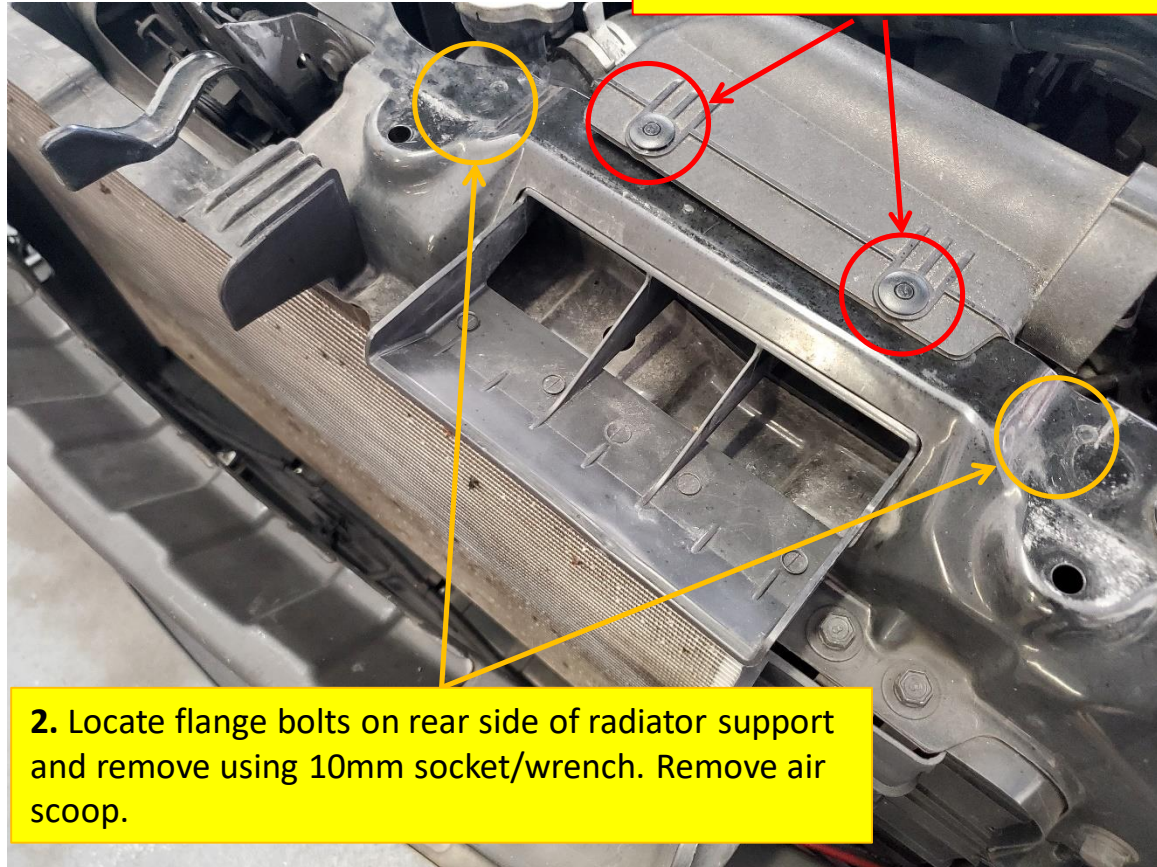

2. Locate flange bolts on rear side of radiator support and remove using 10mm socket/wrench. Remove air scoop.

Big Mouth Installation

Slide the big mouth into the available opening



There is no fastening at this point; the snorkel should sit in the opening by its own weight alone.

Big Mouth Installation

The flange component is inserted from the back in the orientation shown below.

These holes must face upward

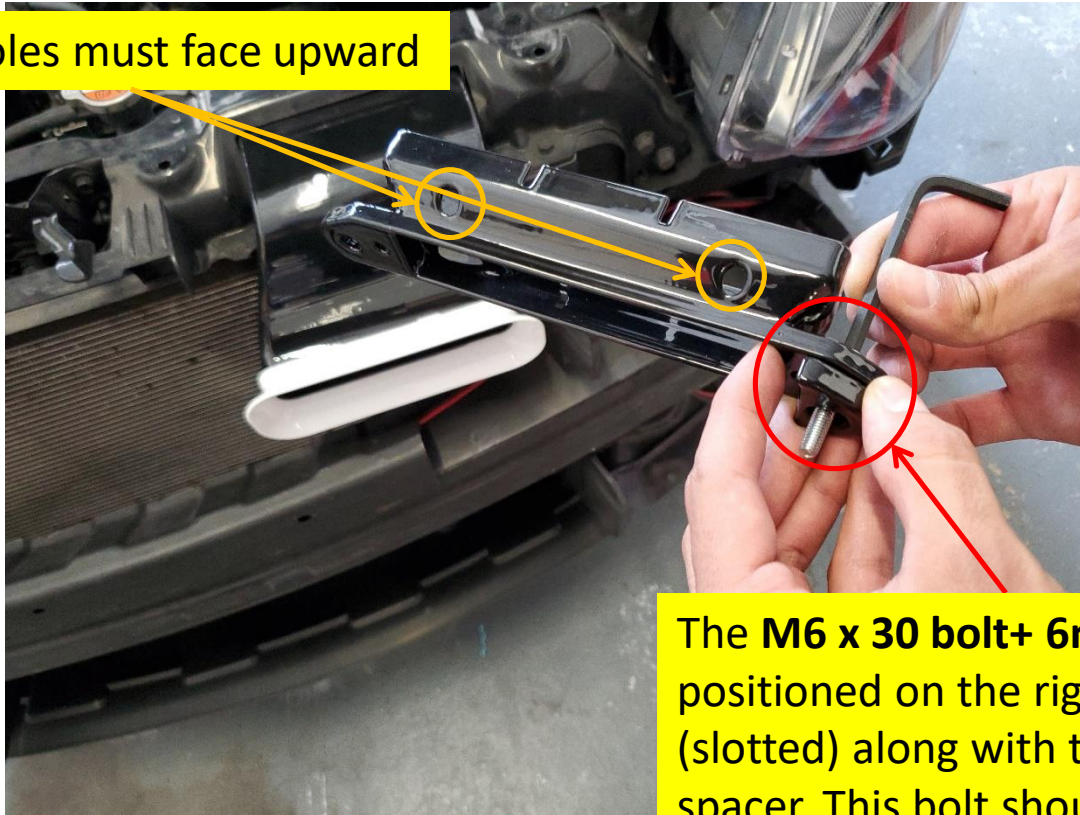

The **M6 x 30 bolt+ 6mm washer** is positioned on the right-hand hole (slotted) along with the provided spacer. This bolt should be threaded first.

Big Mouth Installation

Use 5mm hex key to fasten flange (not tight) component to radiator support.

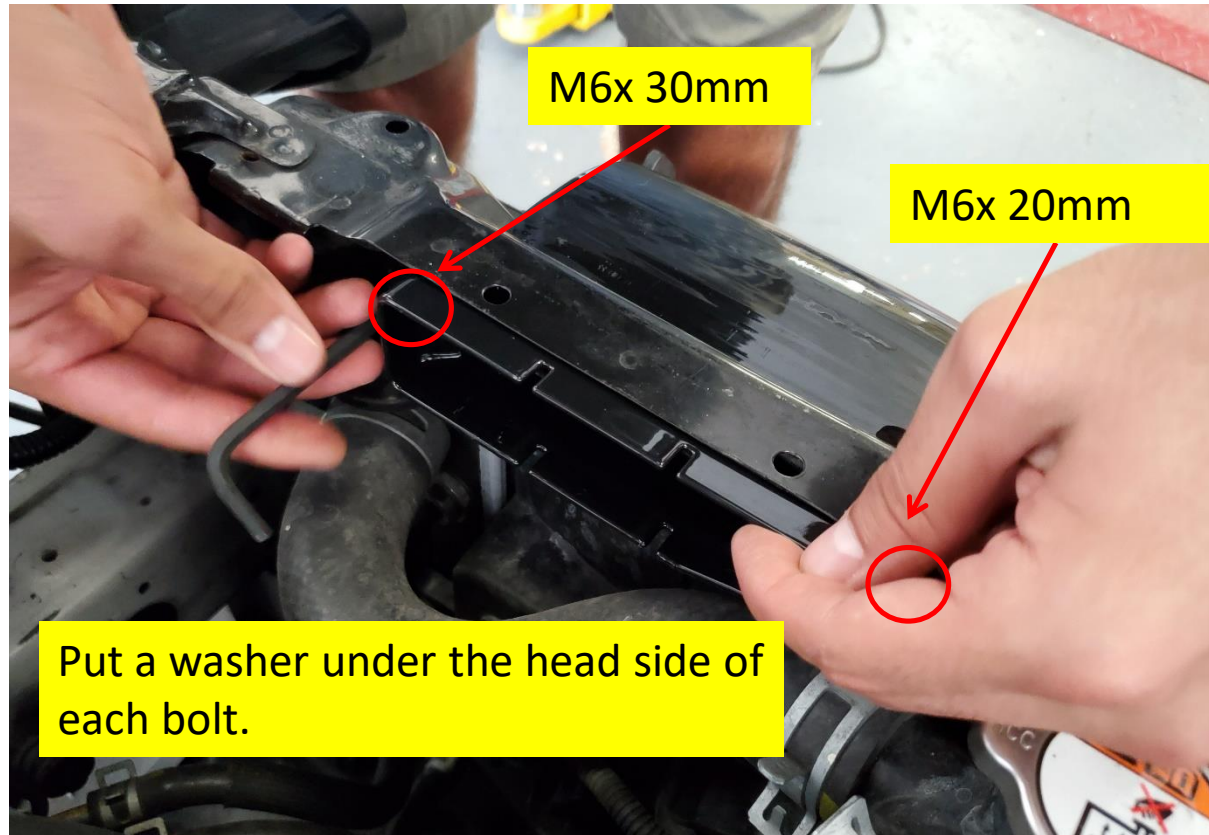

Thread the bolts into the stock threads but **DO NOT TIGHTEN**. It should be loosely attached to allow for incremental movement.

Big Mouth Installation

Attach the snorkel to the flange component using the M4 x 20mm screws. These are inserted at an angle into a threaded insert within the snorkel. Tool is a 3mm hex key.

The M4 x 20mm screws should meet little resistance prior to meeting insert. Once the screw has met the insert, **do not tighten all the way.**

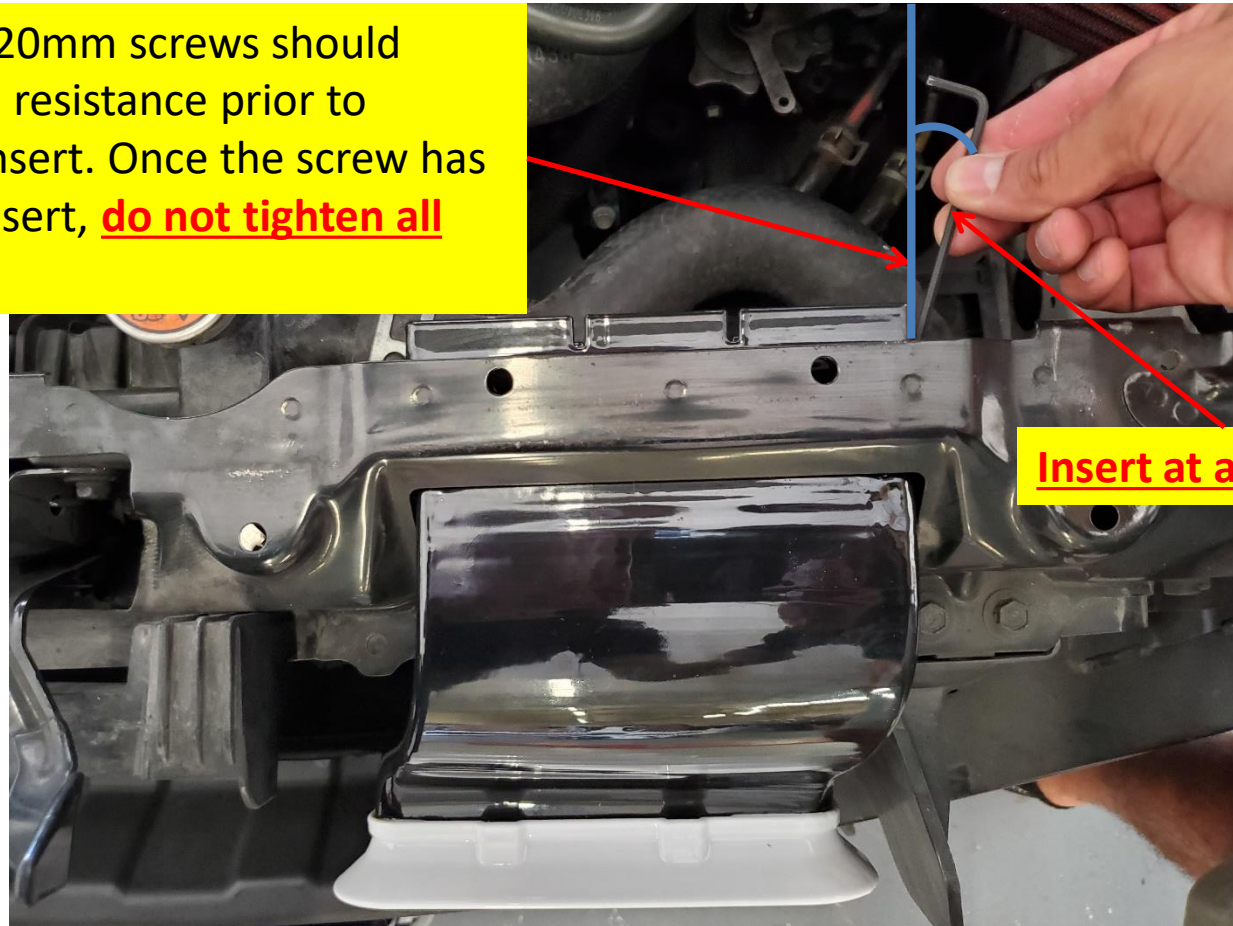

Insert at an angle.

Big Mouth Installation

Proceed to thread second M4 x 20mm into the snorkel's insert.

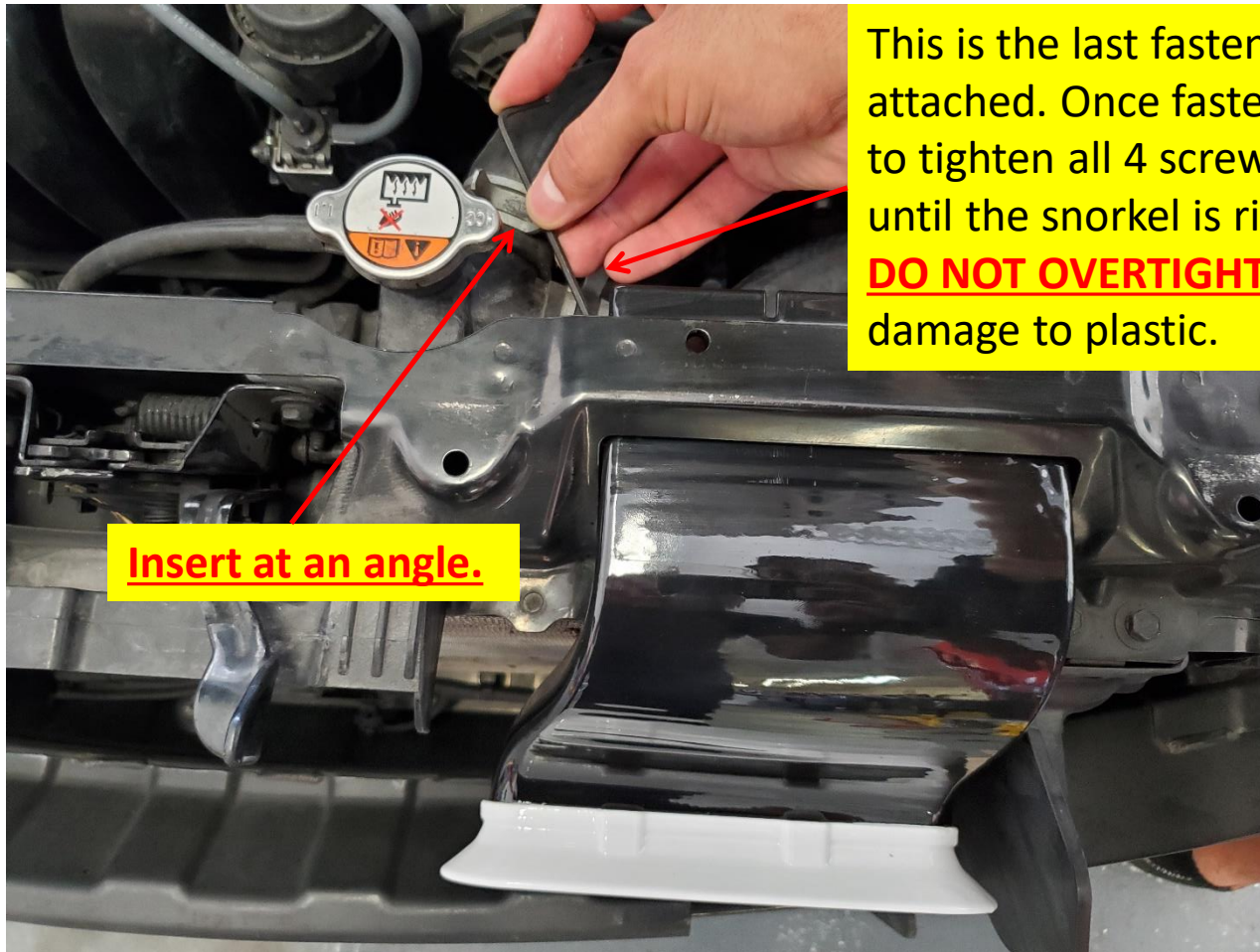

This is the last fastener to be attached. Once fastened, proceed to tighten all 4 screws incrementally until the snorkel is rigidly attached. **DO NOT OVERTIGHTEN** to prevent damage to plastic.

Insert at an angle.

Stock Components Reattach

Pins must be half-removed prior to insertion. Once placed in the holes, push the pins down.





Finalize

Re-install the bumper the same way it was removed and ENJOY!

