

OYSTER Sconce

Nestled safely along a coastal berm, the oyster produces an iridescent pearl. The plated or powdercoated shell of the sconce shelters a soft acrylic glow within its mantle.

DIMENSIONS + ELEVATION VIEWS

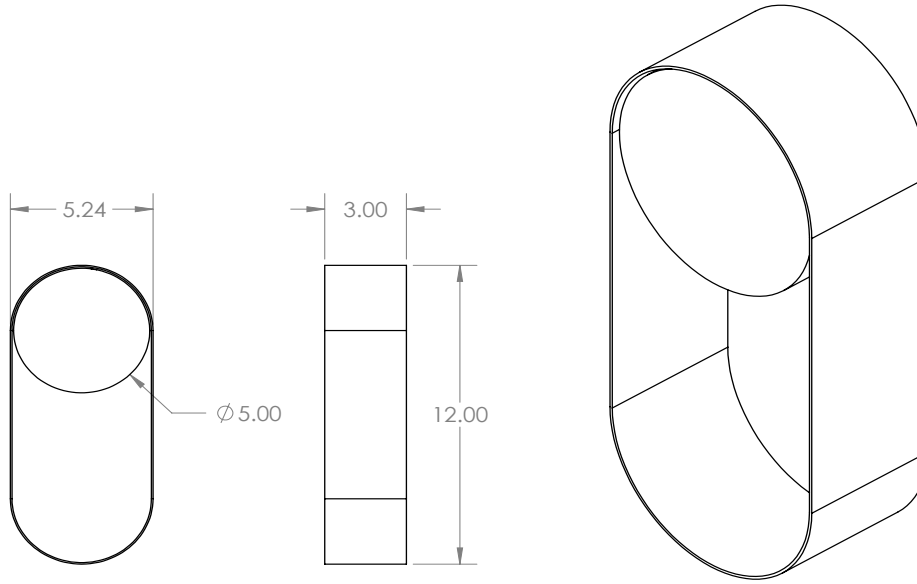

PRODUCT DETAILS



MATERIALS

- Metal
- Acrylic
- COB LED

COLOR TEMP

- 3000K
- *Custom upon request

POWER CONSUMPTION

- 8W

INPUT

- 120V AC 50/60HZ (Canada+US)

OUTPUT

- 800 Lumens

DIMMING

- TRIAC / ELV / 0-10 dimmable

MOUNTING

- Junction box connection
- Surface mount
- 3ft power cord length
- *Custom lengths upon request

FIXTURE WEIGHT

- 5 lbs

PRODUCT CODE

- OSTRsconce

METAL

- Brushed Brass
- Brushed Stainless Steel
- Brushed Copper

- Powder-coated White
- Powder-coated Black

LENS

- Frosted Acrylic
- Patterned Acrylic

DESIGN

2023

CERTIFICATION



ORDER SPECIFICATIONS

| | | |
|------------|-------|------|
| OSTRsconce | | |
| MODEL | METAL | LENS |