



D-14 Headlight Bracket

Harley Davidson Road Glide
DNL.D14.10200.K

Thank you for choosing DENALI

We know you would rather be riding your bike than wrenching on it, so we go the extra mile to make sure our instructions are clear and as easy to understand as possible. If you have any questions, comments, or suggestions don't hesitate to give our gear experts a call at 401.360.2550 or visit WWW.DENALIELECTRONICS.COM

Please Read Before Installing

DENALI products should always be installed by a qualified motorcycle technician. If you are unsure of your ability to properly install a product, please have the product installed by your local motorcycle dealer. DENALI takes no responsibility for damages caused by improper installation. **Caution:** When installing electronics it is extremely important to pay close attention to how wires are routed, especially when mounting products to the front fender, front forks, or fairing of your motorcycle. Always be sure to turn the handlebars fully left, fully right, and fully compress the suspension to ensure the wires will not bind and have enough slack for your motorcycle to operate properly.

Installation Tips

We strongly recommend using medium strength liquid thread locker on all screws, nuts, and bolts. It is also important to ensure that all hardware is tightened to the proper torque specifications as listed in your owner's manual. For included accessory hardware please refer to the default torque specifications provided below. Inspect all hardware after the first 30 miles to ensure proper torque specifications are maintained.

Bolt Size	in-lbs	ft-lbs	Nm
M3	10.0 in-lbs	-	1.0 Nm
M4	23.0 in-lbs	-	2.5 Nm
M5	44.5 in-lbs	3.5 ft-lbs	5.0 Nm
M6	78.0 in-lbs	6.5 ft-lbs	9.0 Nm
M8	-	13.5 ft-lbs	18.0 Nm
M10	-	30.0 ft-lbs	41.0 Nm
M12	-	52.0 ft-lbs	71.0 Nm

Hardware Sizing Guide

Not sure what size bolt you have? Use this ruler to measure screws, bolts, spacers, etc. Remember, the length of a screw or bolt is measured from the start of the "mounting surface" to the end of the screw, so only include the screw head when measuring countersunk screws.

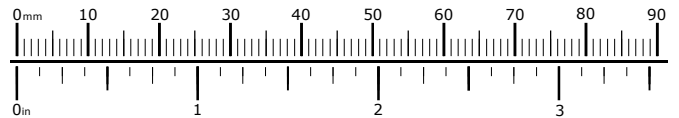

What's In The Box?

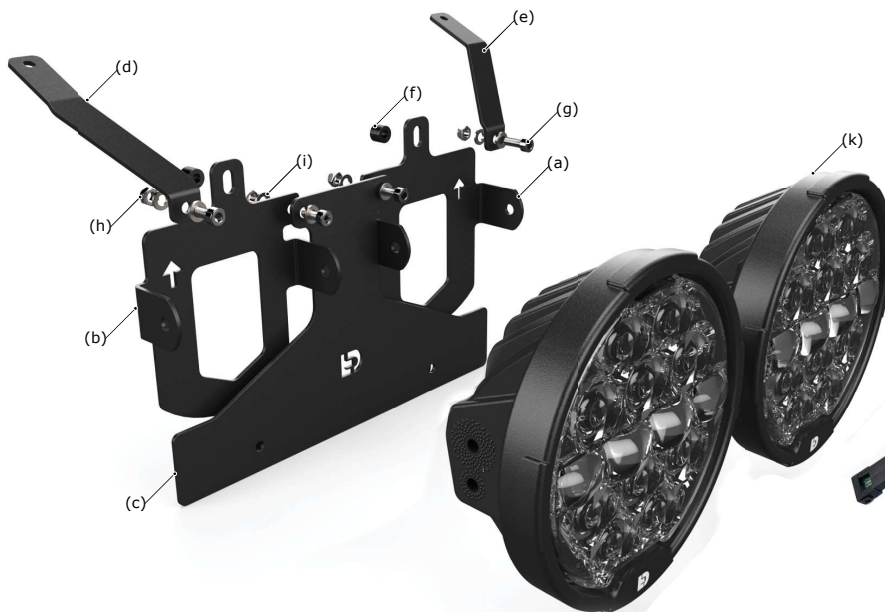

Tools Required:

1. Metric and SAE Allen wrench set
2. 12mm socket & wrench
3. Torqx bit set
4. Scew Driver set

Kit Contents

- (a) Clutch Side Light Bracket (LAH.23.10900-01).....Qty 1
- (b) Throttle Side Light Bracket (LAH.23.10900-02).....Qty 1
- (c) Center Light Panel (LAH.23.10900-03).....Qty 1
- (d) Throttle Side Headlight Bezel Support (LAH.23.10900-04).....Qty 1
- (e) Clutch Side Headlight Bezel Support (LAH.23.10900-05).....Qty 1
- (f) 6mm x 9.5mm spacers.....Qty 4

- (g) M6 x 16mm Bolts.....Qty 4
- (h) M6 Nylock Nuts.....Qty 4
- (i) M6 Washers.....Qty 8
- (j) Headlight Harness (DNL.WHS.2600)Qty 1
- (k) D14 DOT Headlights.....Qty 2

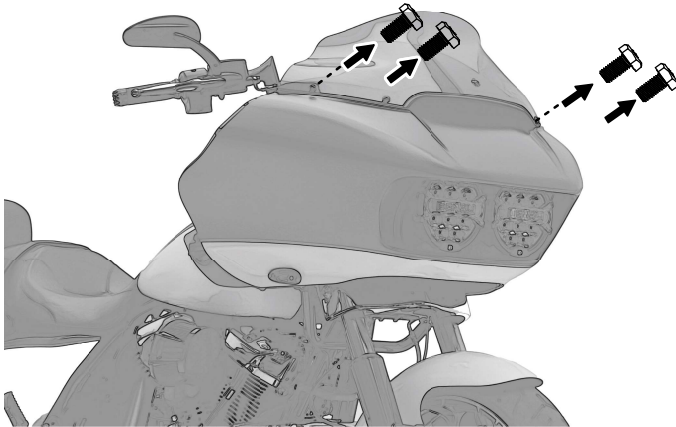

1.1 - Remove The Windscreen

Step One: Remove the windscreen by removing the 4x phillips head screws that hold it to the front fairing.

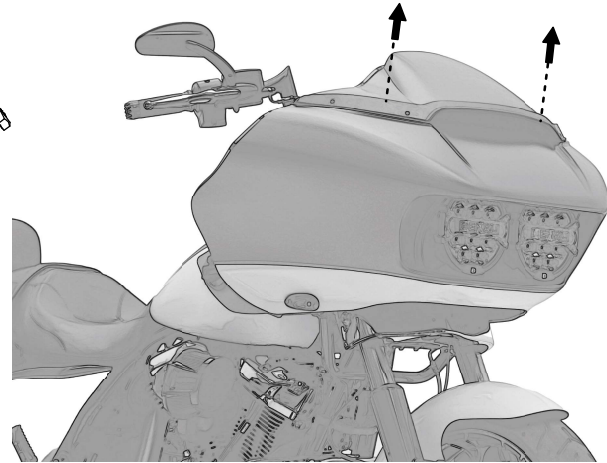

1.2 - Remove the Cowel and Speaker Grills

Step One: Remove the upper cowl by simply pulling upward and forward to release it from its two plastic clips.

Step Two: The speaker Grills will need to be removed to access other hardware. To do this, use a trim panel tool to gently pop the edges free from its plastic clips and remove it from the dash.

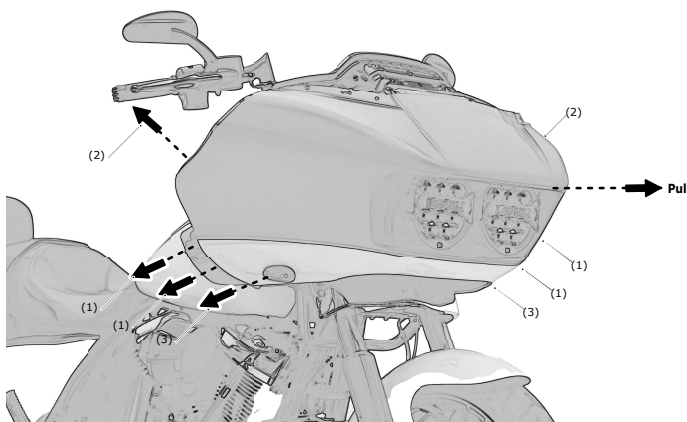

1.3- Remove The Front Fairing

Step One: To remove the front Fairing. There will be for screws to remove on each side. First remove the two T25 Torx screws (1) holding the side wind deflecotrs to the fairing.

Step Two: Remove the T30 Torx screw (2) next to the speaker

Step Three: Remove the 3/16" Allen screw (3) to remove the turn signal from the fairing.

Step Four: Disconnect the turn signal harnesses and remove the front fairing by pulling it forward off the bike.

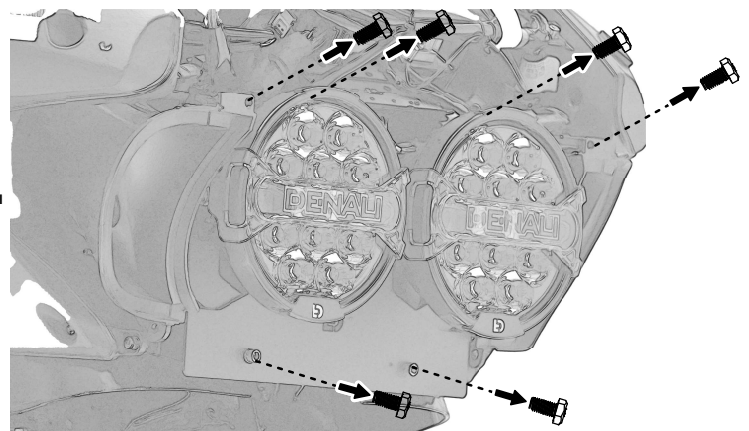

1.4 - Remove The Factory Headlights

Step One: Remove the 4x Allen screws that hold the factory headlight housing to the bike. And remove the 4x T25 Torx screws that hold the headlight to the headlight Bezels.

Step Two: Disconnect the main headlight connector and remove the headlight housing.

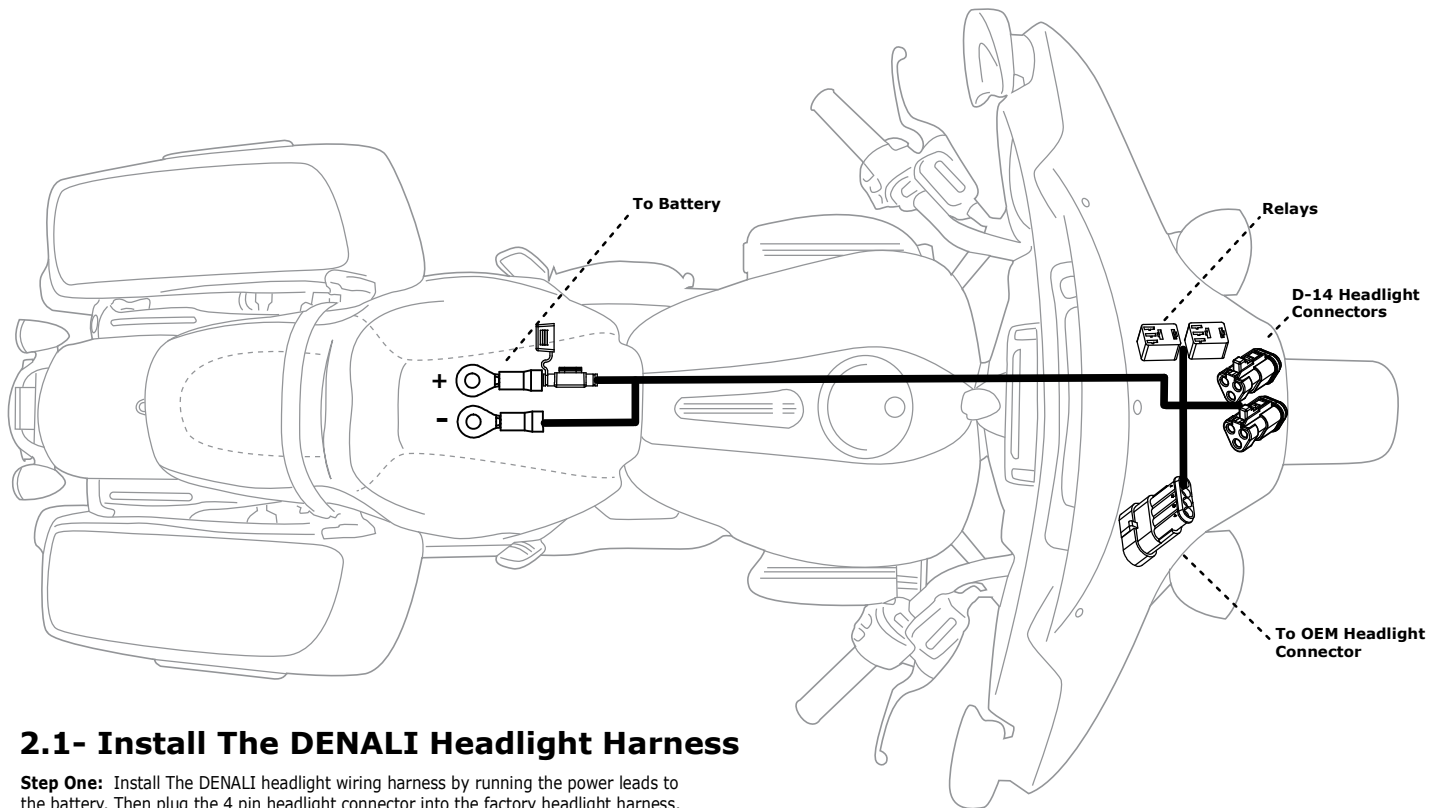

2.1- Install The DENALI Headlight Harness

Step One: Install The DENALI headlight wiring harness by running the power leads to the battery. Then plug the 4 pin headlight connector into the factory headlight harness.

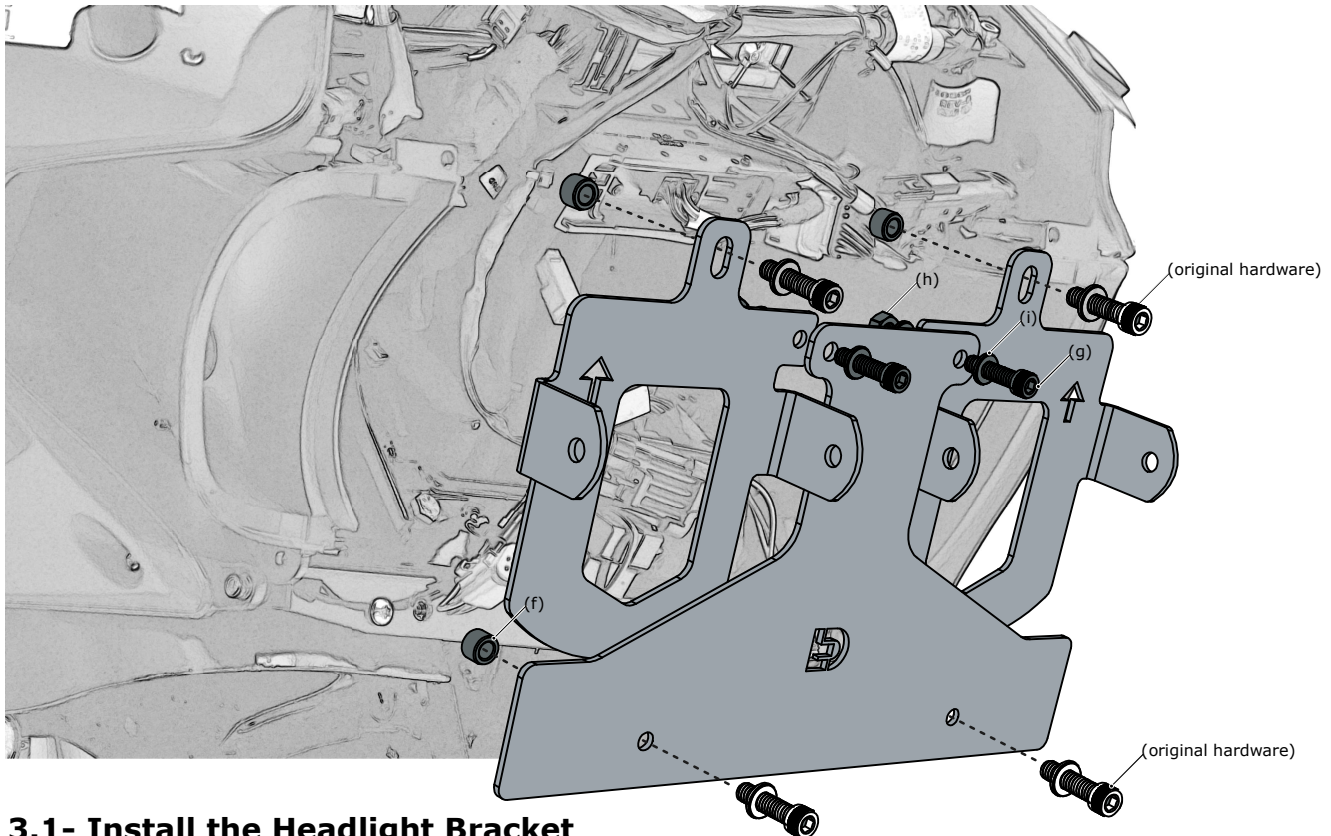

3.1- Install the Headlight Bracket

Step One: Use the included M6 bolts (g), washers (i), and nuts (h) to fasten the front cover plate to the left and right brackets as shown.

Step Two: Position the bracket assembly and use original hardware along with the included spacers to fasten the brackets to the bike.

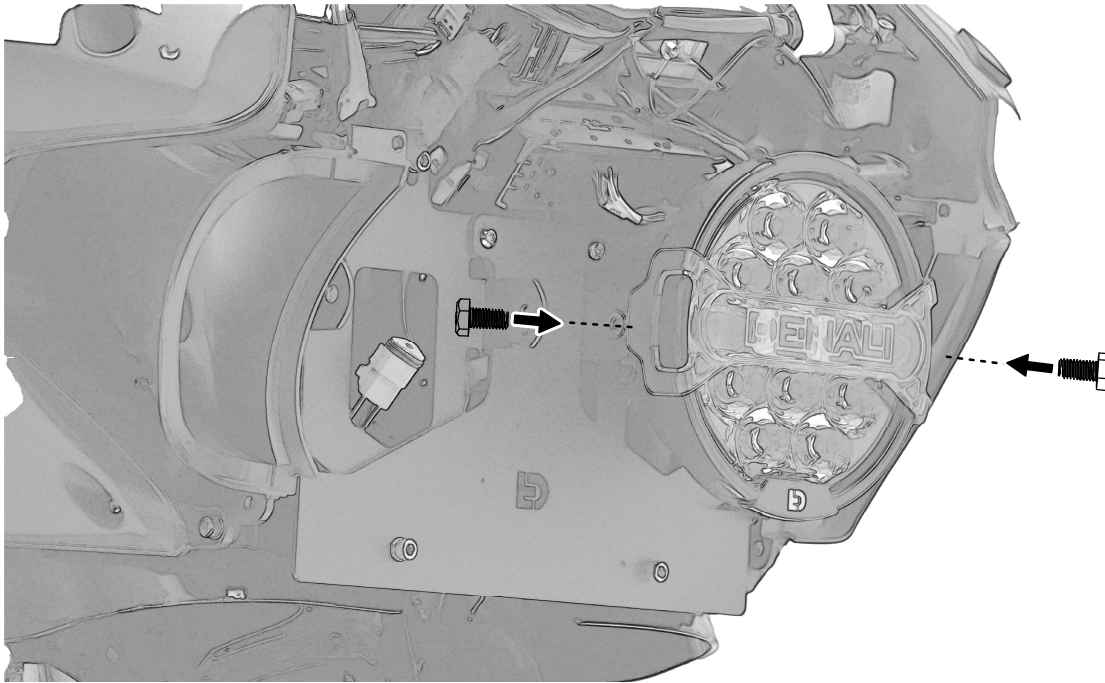

3.2 - Install The Headlights

Step One: First, connect the lights to the harness, then use the M8x20 Bolts included with the lights, fasten the headlights to the brackets.

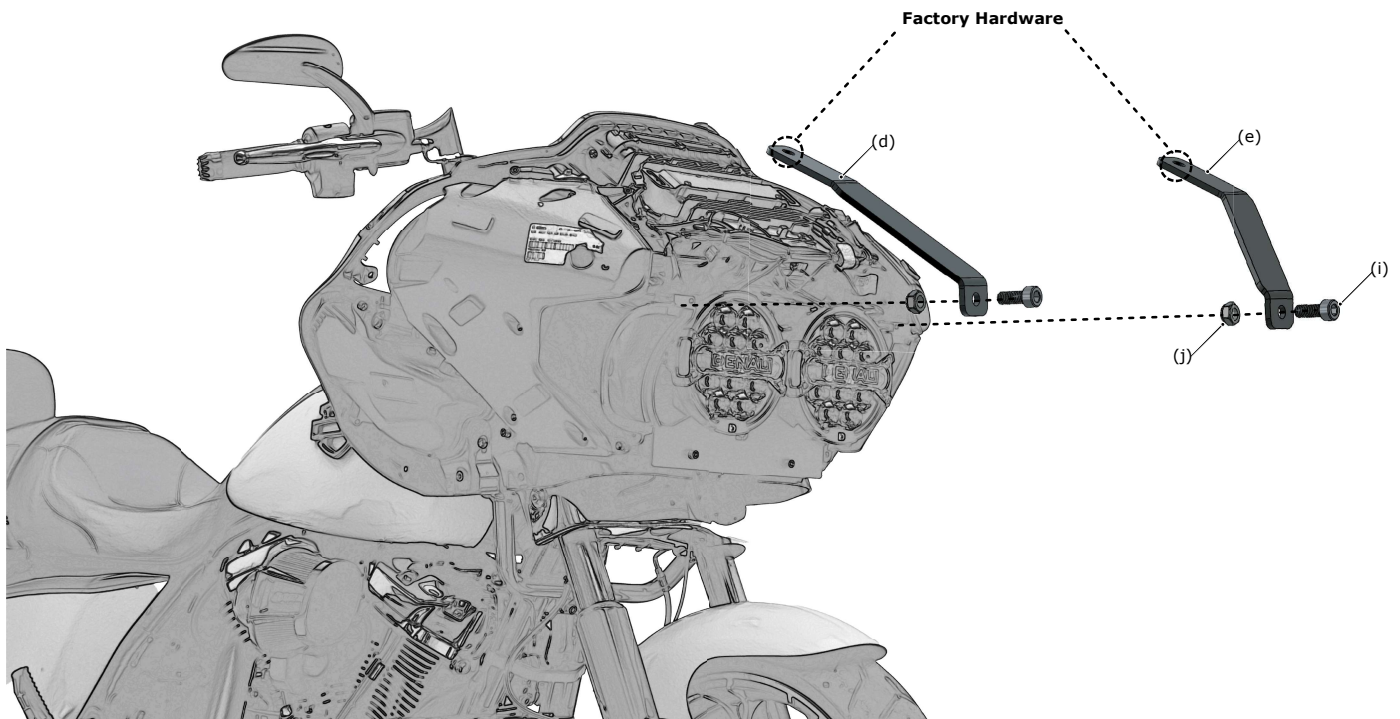

3.3- Install the Vent Supports

Step One: Using the supplied and factory hardware (i), Install the bezel support brackets (e,d) as shown.

Step Two: To reassemble, reverse the steps outlined in section 1.